

FED. ROAD DIST. NO.	STATE	PROJ. NO.	FISCAL YEAR	SHEET NO.	TOTAL SHEETS
HAWAII	HAW.	750A-01-82M	1982	9	24

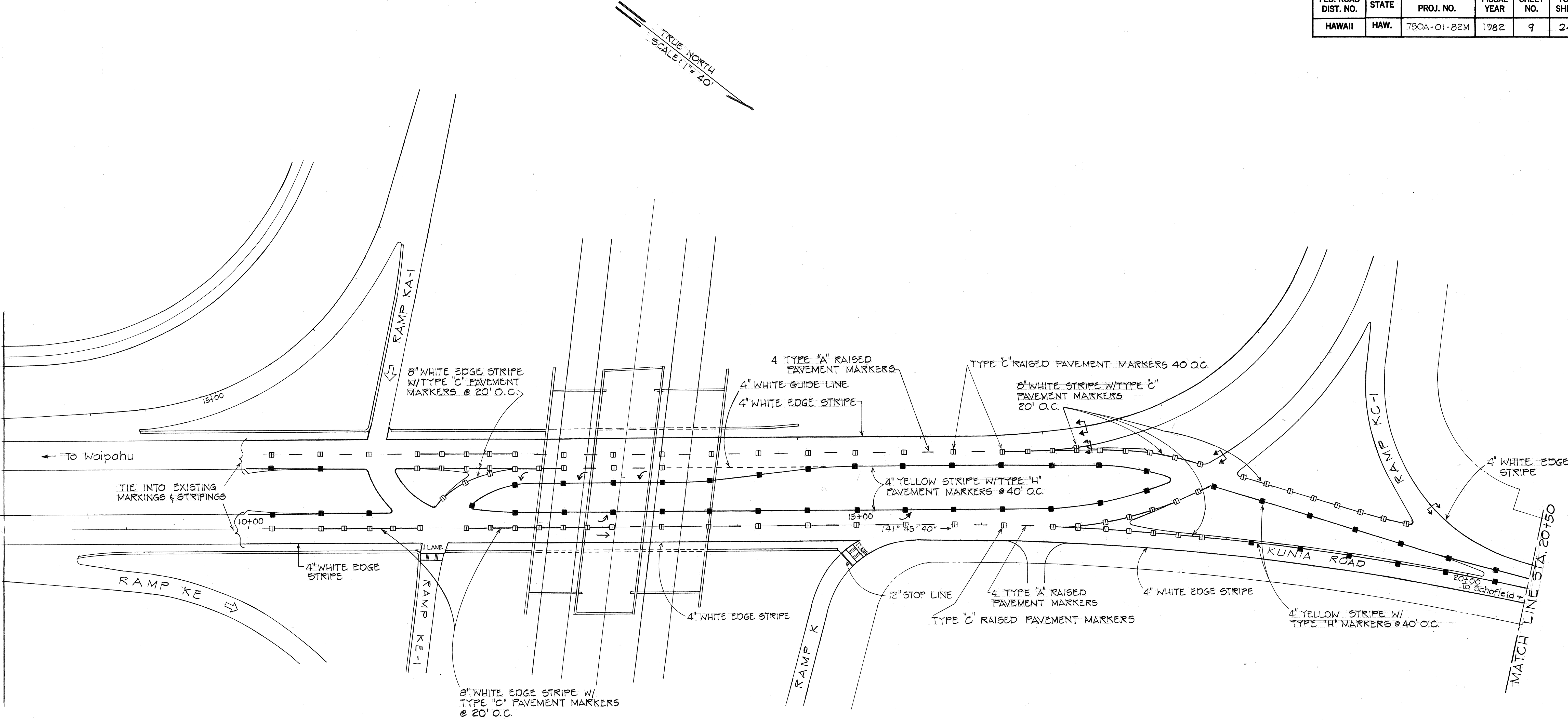

SURVEY PLOTTED BY	DATE
DRAWN BY	
TRACED BY	
DESIGNED BY	
CHECKED BY	
NOTE BOOK	
No.	

STATE OF HAWAII  
DEPARTMENT OF TRANSPORTATION  
LAND TRANSPORTATION FACILITIES DIVISION

PAVEMENT MARKING & STRIPING PLAN  
  
KUNIA ROAD RESURFACING  
PROJ. No. 750A-01-82M  
SCALE: 1"=40'      DATE: Feb., 1982  
SHEET NO. 1 OF 3 SHEETS

FED. ROAD DIST. NO.	STATE	PROJ. NO.	FISCAL YEAR	SHEET NO.	TOTAL SHEETS
HAWAII	HAW.	750A-01-82M	1982	10	24

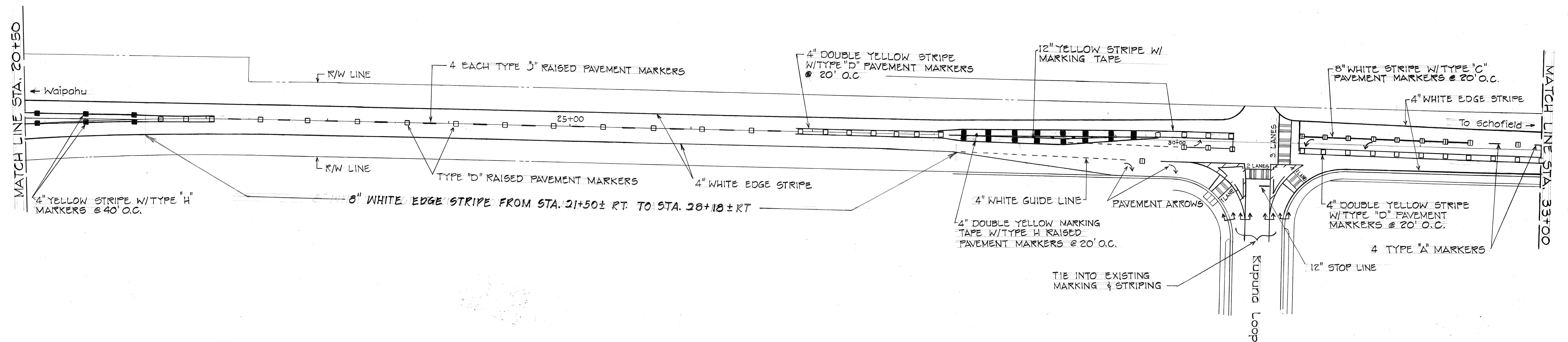

ORIGINAL PLAN	SURVEY PLOTTED BY	DATE
NO. 1	DRAWN BY	" "
2	DESIGNED BY	" "
3	CHECKED BY	" "
4	CHECKED BY	" "

STATE OF HAWAII  
DEPARTMENT OF TRANSPORTATION  
LAND TRANSPORTATION FACILITIES DIVISION

**PAVEMENT MARKING & STRIPING PLAN**

KUNIA ROAD RESURFACING  
PROJ. No. 750A-01-82M

SCALE: 1"=40'      DATE: Feb., 1982

**SHEET No. 2 OF 3 SHEETS**



SUMMARY OF PAVEMENT MARKING & SUMMARY  
STA. 10+00 TO 38+40

DESCRIPTION	QUANTITY
PAVEMENT STRIPING (PAINT)	5,500 L.F.
PAVEMENT MARKING TAPE (4")	3,600 L.F.
PAVEMENT MARKING TAPE (8")	1,600 L.F.
PAVEMENT MARKING TAPE (12")	200 L.F.
CROSSWALK MARKING (TAPE)	8 LANES
PAVEMENT ARROWS (TAPE)	12 EA.
TYPE "A" PAVEMENT MARKERS	112 EA.
TYPE "C" PAVEMENT MARKERS	100 EA.
TYPE "D" PAVEMENT MARKERS	65 EA.
TYPE "H" PAVEMENT MARKERS	65 EA.
TYPE "J" PAVEMENT MARKERS	50 EA.

FED. ROAD DIST. NO.	STATE	PROJ. NO.	FISCAL YEAR	SHEET NO.	TOTAL SHEETS
HAWAII	HAW.	750A-01-82M	1982	11	24

GENERAL NOTES

- LOCATIONS OF ALL NEW PAVEMENT MARKERS AND STRIPINGS SHALL BE STAKED OUT BY THE CONCRACTOR FOR APPROVAL BY THE ENGINEER PRIOR TO INSTALLATION.
- EXISTING PAVEMENT MARKINGS NOT INCORPORATED IN THE FINAL TRAFFIC PATTERN SHALL BE REMOVED AS DIRECTED BY THE ENGINEER, COSTS SHALL BE INCIDENTAL TO THE VARIOUS CONTRACT ITEMS.
- RAISED PAVEMENT MARKERS SHALL NOT BE PLACED WITHIN CROSSWALKS.
- PAVEMENT MARKERS AND STRIPING SHALL CONFORM TO THE LATEST "MANUAL ON UNIFORM TRAFFIC CONTROL DEVICES FOR STREETS AND HIGHWAYS" AND AS AMENDED.
- FOR ADDITIONAL PAVEMENT MARKING DETAILS, REFER TO STANDARD DETAIL DT-300.
- PAVEMENT MARKING TAPE SHALL BE USED FOR ALL PAVEMENT MARKINGS AND STRIPING EXCEPT FOR 4" WHITE EDGE STRIPE WHICH SHALL BE PAINTED.

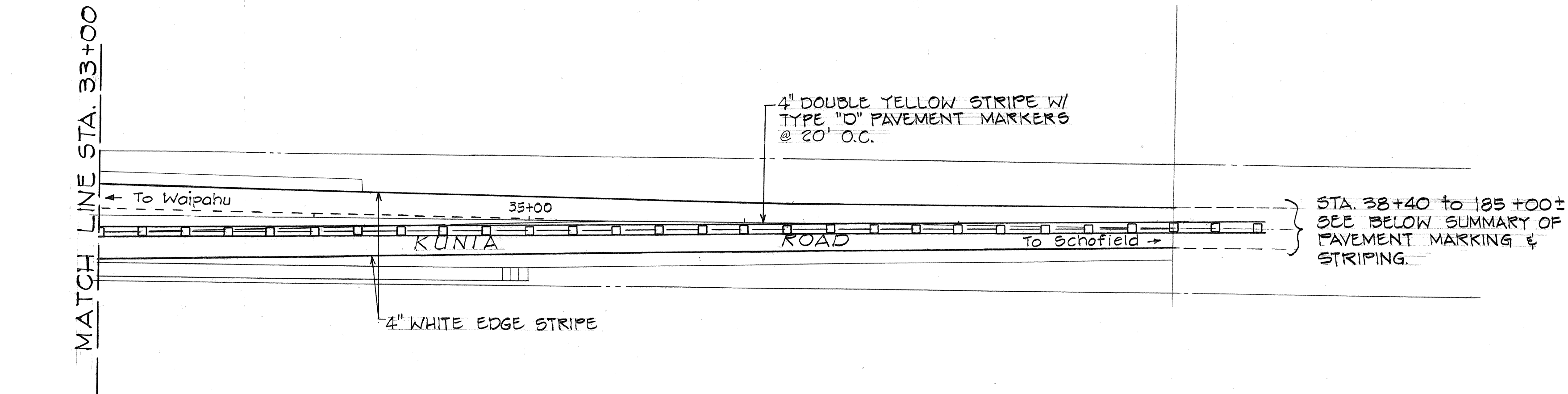

LEGEND

- 4 TYPE J RAISED PAVEMENT MARKERS
- TYPE D PAVEMENT MARKERS
- 4 TYPE A RAISED PAVEMENT MARKERS
- TYPE C PAVEMENT MARKERS
- 4" DOUBLE YELLOW MARKING W/TYPE D RAISED PAVEMENT MARKERS @ 20' O.C.
- 4" DOUBLE YELLOW MARKING TAPE W/TYPE H RAISED PAVEMENT MARKERS @ 20' O.C.
- 12" YELLOW MARKING TAPE
- 4" WHITE EDGE STRIPE
- 3 LANES CROSS & STOP LINES (ALL STOP LINES 8'-0" FROM CROSSWALK UNLESS OTHERWISE NOTED). USE MARKING TAPE FOR ALL CROSSWALKS & STOP LINES.
- 12" STOP LINE
- PAVEMENT ARROW (USE MARKING TAPE)
- 4" YELLOW STRIPE W/TYPE H PAVEMENT MARKERS

SUMMARY OF PAVEMENT MARKING & STRIPING STA. 38+40 to 185+00±

APPROXIMATE STATION TO STATION	YELLOW & (L.F.)	OUTBOUND (TO SCHOFIELD)	INBOUND (TO WAIPAHU)	WHITE EDGE STRIPE	PAVEMENT MARKERS		
					TYPE "D"	TYPE "H"	TYPE "J"
38+40 - 70+60		PASS	PASS	6,440	83		324
70+60 - 78+60	800	NO PASS	PASS	1,600	22	22	88
78+60 - 82+88	800	NO PASS	NO PASS	1,600	22	22	88
82+88 - 137+20		PASS	PASS	10,520	134		536
137+20 - 144+50	530	NO PASS	PASS	1,060	15	13	52
144+50 - 149+80	530	PASS	NO PASS	1,060	15	13	52
149+80 - 158+00		PASS	PASS	1,640	24		88
158+00 - 181+00		PASS	PASS	4,600	58		232
181+00 - 185+00±	400	NO PASS	PASS	800	11	11	44
TOTAL	3,060			29,320	384	81	1,504