

FED. ROAD DIST. NO.	STATE	FED. AID PROJ. NO.	FISCAL YEAR	SHEET NO.	TOTAL SHEETS
HAWAII	HAW.	M-7600 (2)	1980	26	244

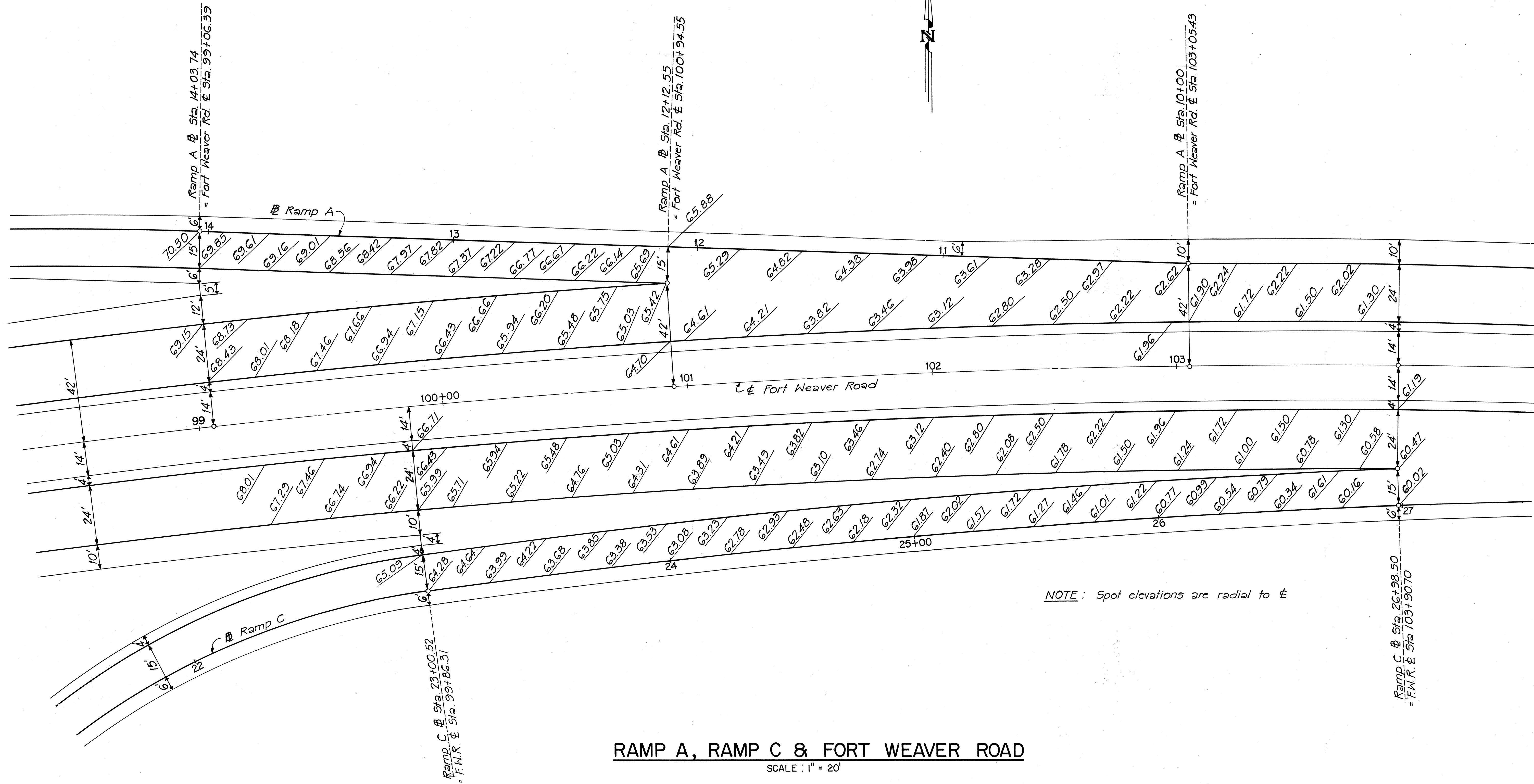

ORIGINAL PLAN	SURVEY PLOTTED BY	DATE
NOTE BOOK	DRAWN BY	
	TRACED BY	
	QUANTITIES BY	
	CHECKED BY	

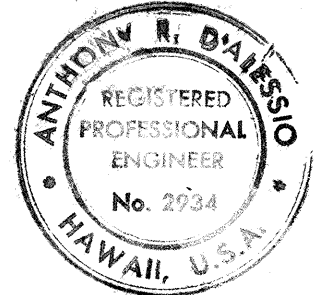

THIS WORK WAS PREPARED BY ME OR UNDER MY SUPERVISION.

STATE OF HAWAII
DEPARTMENT OF TRANSPORTATION
HIGHWAYS DIVISION

RAMP TERMINAL DETAILS
RAMP A & C

FORT WEAVER ROAD
SOUTH OF FARRINGTON HIGHWAY
TO THE VICINITY OF RENTON ROAD

SCALE: 1" = 20' DATE: SEPT 1979

SHEET NO. 1 OF 1 SHEETS