

FED. ROAD DIST. NO.	STATE	FED. AID PROJ. NO.	FISCAL YEAR	SHEET NO.	TOTAL SHEETS
HAWAII	HAW.	NH-072-1(47)	2000	54	91

Kalani High School

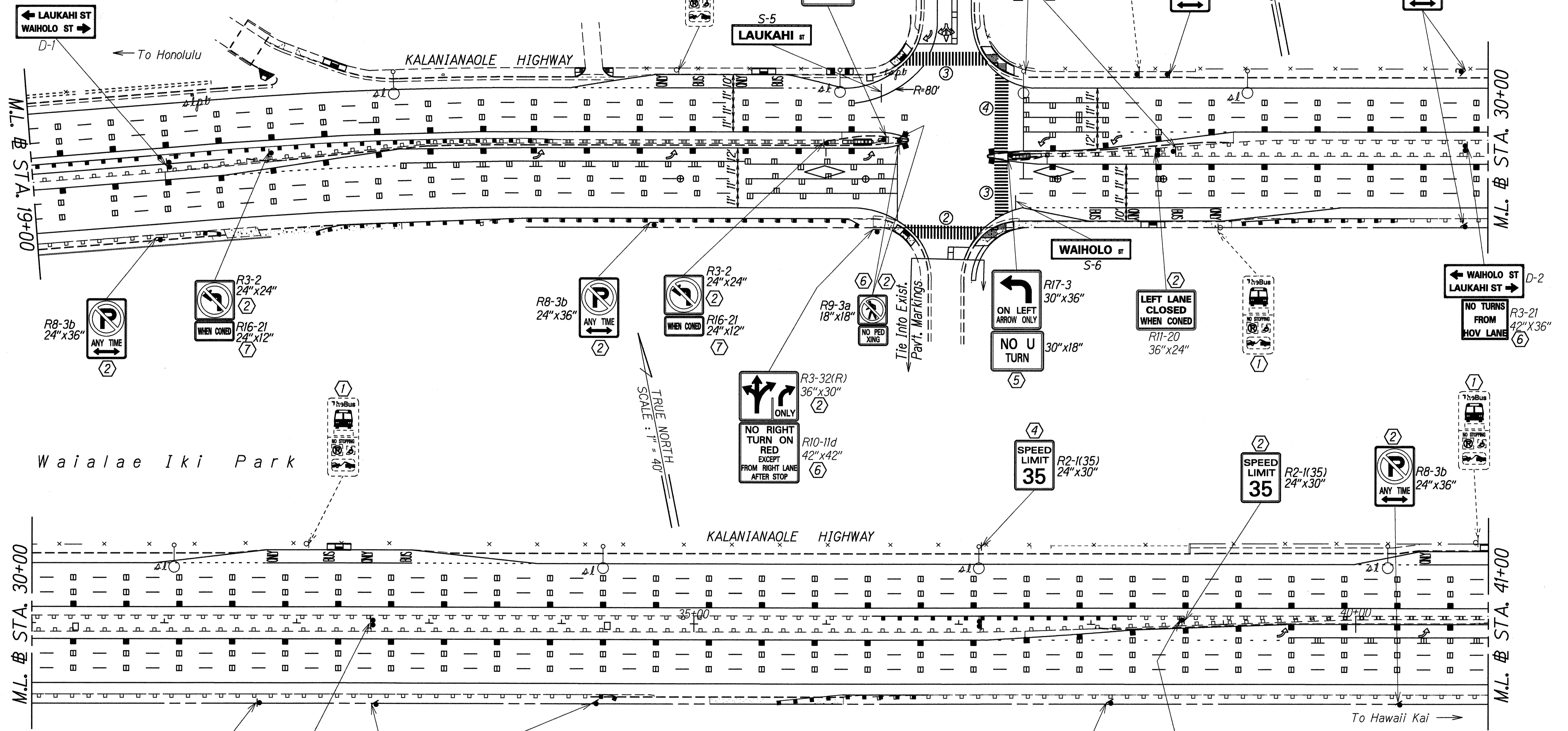

- KEY:**
- ① Exist. Sign(s) & Post(s) to Remain
 - ② Remove Exist. Sign(s) & Post(s) & Intall New w/Post(s)
 - ③ Remove Exist. Sign & Post(s) & Install New on Exist. Post(s)
 - ④ Remove Exist. Sign & Install New on Hwy. Light Pole
 - ⑤ Remove Exist. Sign & Install New on Traffic Signal Pole
 - ⑥ Remove Exist. Sign(s) & Install New
 - ⑦ Install New Sign
 - ⑧ Remove Exist. Sign

SURVEY PLOTTED BY	DATE
DRAWN BY	
DESIGNED BY	
QUANTITIES BY	
CHECKED BY	
ORIGINAL PLAN	
NOTE BOOK	
FILE NO.	
DATE	

STATE OF HAWAII
DEPARTMENT OF TRANSPORTATION
HIGHWAYS DIVISION

**PAVEMENT MARKING &
SIGNING PLAN**

KALANIANA'OLE HIGHWAY RESURFACING
Ainakoa Avenue to West Hind Drive
Federal Aid Project No. NH-072-1(47)

Scale: 1"=40' Date: June, 1999

SHEET No. 73 OF 23 SHEETS

FED. ROAD DIST. NO.	STATE	FED. AID PROJ. NO.	FISCAL YEAR	SHEET NO.	TOTAL SHEETS
HAWAII	HAW.	NH-072-1(47)	2000	56	91

- KEY:**
- ① Exist. Sign(s) & Post(s) to Remain
 - ② Remove Exist. Sign(s) & Post(s) & Intall New w/Post(s)
 - ③ Remove Exist. Sign & Post(s) & Install New on Exist. Post(s)
 - ④ Remove Exist. Sign & Install New on Hwy. Light Pole
 - ⑤ Remove Exist. Sign & Install New on Traffic Signal Pole
 - ⑥ Remove Exist. Sign(s) & Install New
 - ⑦ Install New Sign
 - ⑧ Remove Exist. Sign

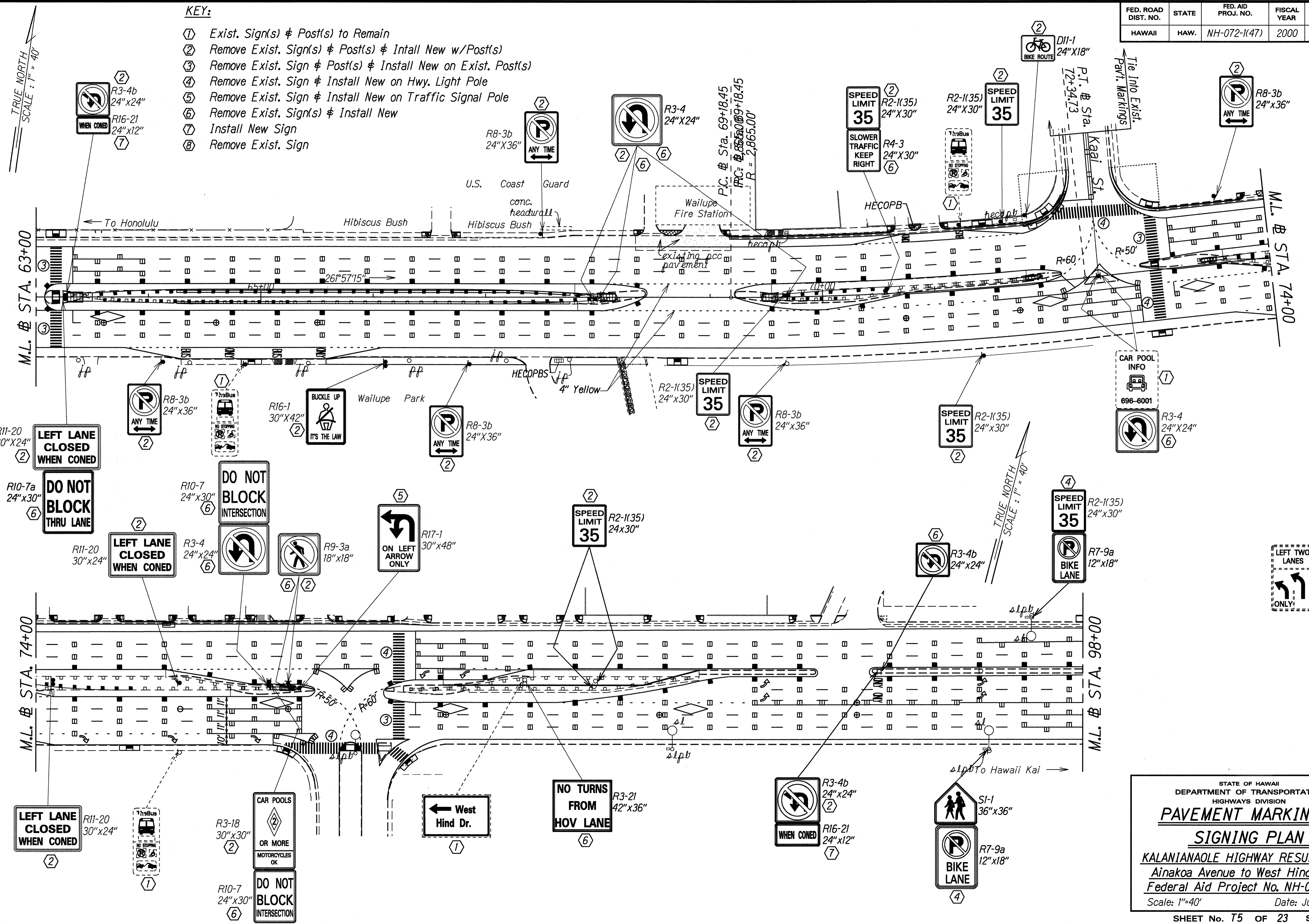

SURVEY PLOTTED BY	DATE
DRAWN BY	
DESIGNED BY	
IN CHARGE BY	
QUANTITIES BY	
CHECKED BY	
ORIGINAL PLAN	
NOTE BOOK	
102.may	
No. 261174	

STATE OF HAWAII
DEPARTMENT OF TRANSPORTATION
HIGHWAYS DIVISION

PAVEMENT MARKING & SIGNING PLAN

KALANIANA'OLE HIGHWAY RESURFACING
Ainako'a Avenue to West Hind Drive
Federal Aid Project No. NH-072-1(47)

Scale: 1"=40' Date: June, 1999

SHEET No. 75 OF 23 SHEETS

FED. ROAD DIST. NO.	STATE	FED. AID PROJ. NO.	FISCAL YEAR	SHEET NO.	TOTAL SHEETS
HAWAII	HAW.	NH-072-1(47)	2000	57	91

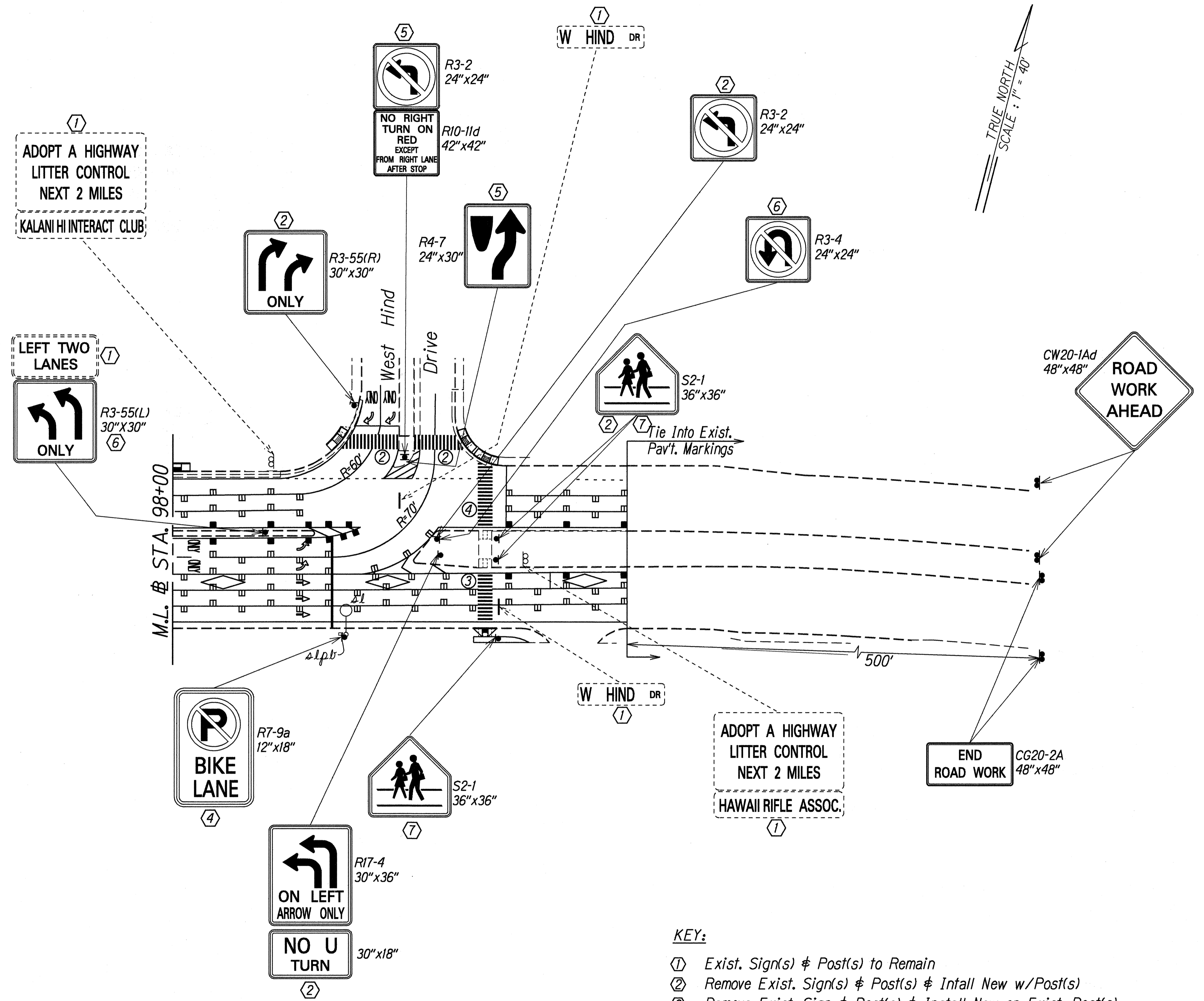

SURVEY PLOTTED BY	DATE
DRAWN BY M. Takahagi	X
TRACED BY Steven Yoshida	
QUANTITIES BY	
CHECKED BY	
ORIGINAL PLAN	
NOTE BOOK	
142 May	
N. 26/105	

STATE OF HAWAII
DEPARTMENT OF TRANSPORTATION
HIGHWAYS DIVISION
PAVEMENT MARKING & SIGNING PLAN
KALANIANA'OLE HIGHWAY RESURFACING
Ainako'a Avenue to West Hind Drive
Federal Aid Project No. NH-072-1(47)
Scale: 1"=40' Date: June, 1999
SHEET No. 76 OF 23 SHEETS