

FED. ROAD DIST. NO.	STATE	FED. AID PROJ. NO.	FISCAL YEAR	SHEET NO.	TOTAL SHEETS
HAWAII	HAW.	F-072-1(34)-A	1990	3	186

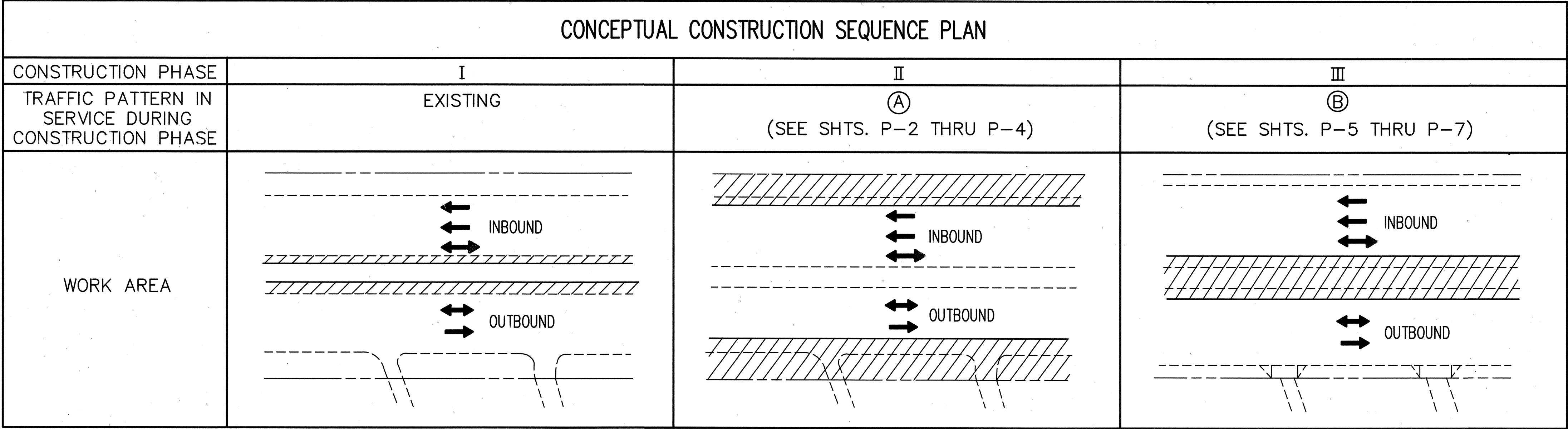

LEGEND

- MAIN WORK AREA
- TRAFFIC LANE
- CONTRA-FLOW LANE

CONCEPTUAL CONSTRUCTION SCHEDULE

NOTE: THIS SCHEDULE IS PROVIDED ONLY FOR GENERAL INFORMATION. THE CONTRACTOR IS FULLY RESPONSIBLE FOR THE DEVELOPMENT OF PROGRESS SCHEDULE AND CONSTRUCTION PHASING.

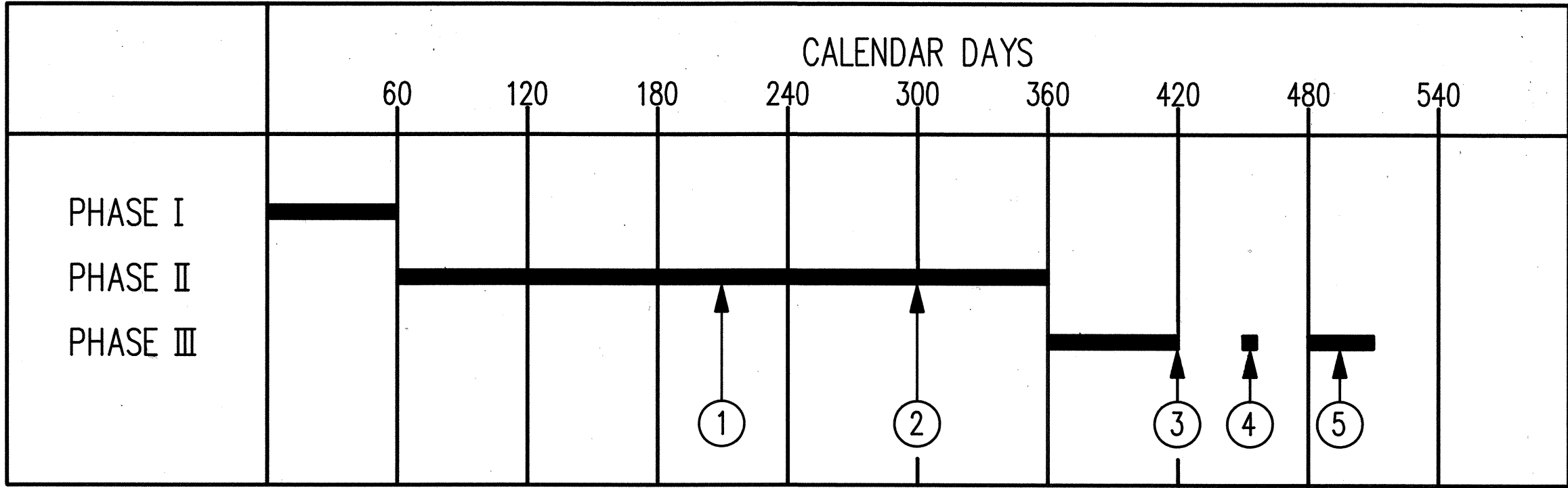

- ① ALL CONSTRUCTION WORK FOR HECO AND CABLE TV FACILITIES BETWEEN WAILUPE CIRCLE AND STA.110+50 COMPLETE (INCL. FACILITIES AT WEST HIND DRIVE)
- ② ALL CONSTRUCTION WORK FOR HECO, HECO AND CABLE TV FACILITIES COMPLETE.
- ③ ALL CONSTRUCTION WORK COMPLETE (EXCEPT WORK RELATED TO ④ AND ⑤ )
- ④ ENERGIZE UNDERGROUND POWER SUPPLY FOR CONTROLLERS AND LIGHTING AFTER HECO ENERGIZES UNDERGROUND ELECTRIC SYSTEM. REMOUNT TEMPORARY LUMINARIES IN MEDIAN ON MAKAI SIDE OF POLES. REMOVE EXISTING LIGHTING FACILITIES ON UTILITY POLES.
- ⑤ COMPLETE LIGHTING SYSTEM ON MAKAI SIDE UPON REMOVAL OF AERIAL UTILITY FACILITIES BY UTILITY COMPANIES. FILL POLE HOLES AND PATCH PAVEMENTS.

MAJOR CONSTRUCTION ACTIVITIES BY PHASES

- PHASE I
- CONSTRUCT DETOUR PAVEMENT IN MEDIAN
  - CONSTRUCT ALL FACILITIES (ROADWAY, DRAINAGE, UTILITIES, LIGHTING, ETC.) ON MAUKA SIDE OF HIGHWAY FROM STA. 98+40 TO STA. 104+85
  - CONSTRUCT TEMPORARY LIGHTING SYSTEM
  - CONSTRUCT NEW TRAFFIC SIGNAL CONTROLLERS AND TEMPORARY CONTROLLER INTERCONNECT SYSTEM
  - REMOVE TREES IN MEDIAN
  - CONSTRUCT TRAFFIC PATTERN A (TEMPORARY)
  - CONSTRUCT UTILITY FACILITIES AT WEST HIND DRIVE AND OTHER AREAS NOT IN CONFLICT WITH EXISTING TRAFFIC PATTERN
- PHASE II
- CONSTRUCT WAILUPE STREAM BRIDGE WIDENINGS
  - CONSTRUCT ROADWAY FACILITIES (DRAINAGE, PAVEMENTS, SIDEWALKS, ETC.)
  - CONSTRUCT UTILITY FACILITIES
  - CONSTRUCT PROPERTY ADJUSTMENTS INCLUDING UTILITY SERVICE CONNECTIONS
  - CONSTRUCT FINAL TRAFFIC SIGNAL SYSTEM AND CONTROLLER INTERCONNECT SYSTEM
  - CONSTRUCT LIGHTING SYSTEM
  - CONSTRUCT TRAFFIC PATTERN B (TEMPORARY)
- PHASE III
- CONSTRUCT ROADWAY FACILITIES IN MEDIAN
  - CONSTRUCT LANDSCAPING AND IRRIGATION FACILITIES
  - CONSTRUCT TRAFFIC PATTERN C (PERMANENT)



THIS WORK WAS PREPARED BY ME  
OR UNDER MY SUPERVISION.  
*Werner Beugert*

STATE OF HAWAII  
DEPARTMENT OF TRANSPORTATION  
HIGHWAYS DIVISION

CONSTRUCTION PHASING

KALANIANA'OLE HIGHWAY  
Wailupe Circle to East Hind Drive  
F.A. PROJECT NO. F-072-1(34)-A

SCALE: DATE: June 30, 1990

SHEET No. K-1 OF 1 SHEETS