

FED. ROAD DIST. NO.	STATE	PROJ. NO.	FISCAL YEAR	SHEET NO.	TOTAL SHEETS
HAWAII	HAW.	72B-01-13M	2013	ADD. 8	34

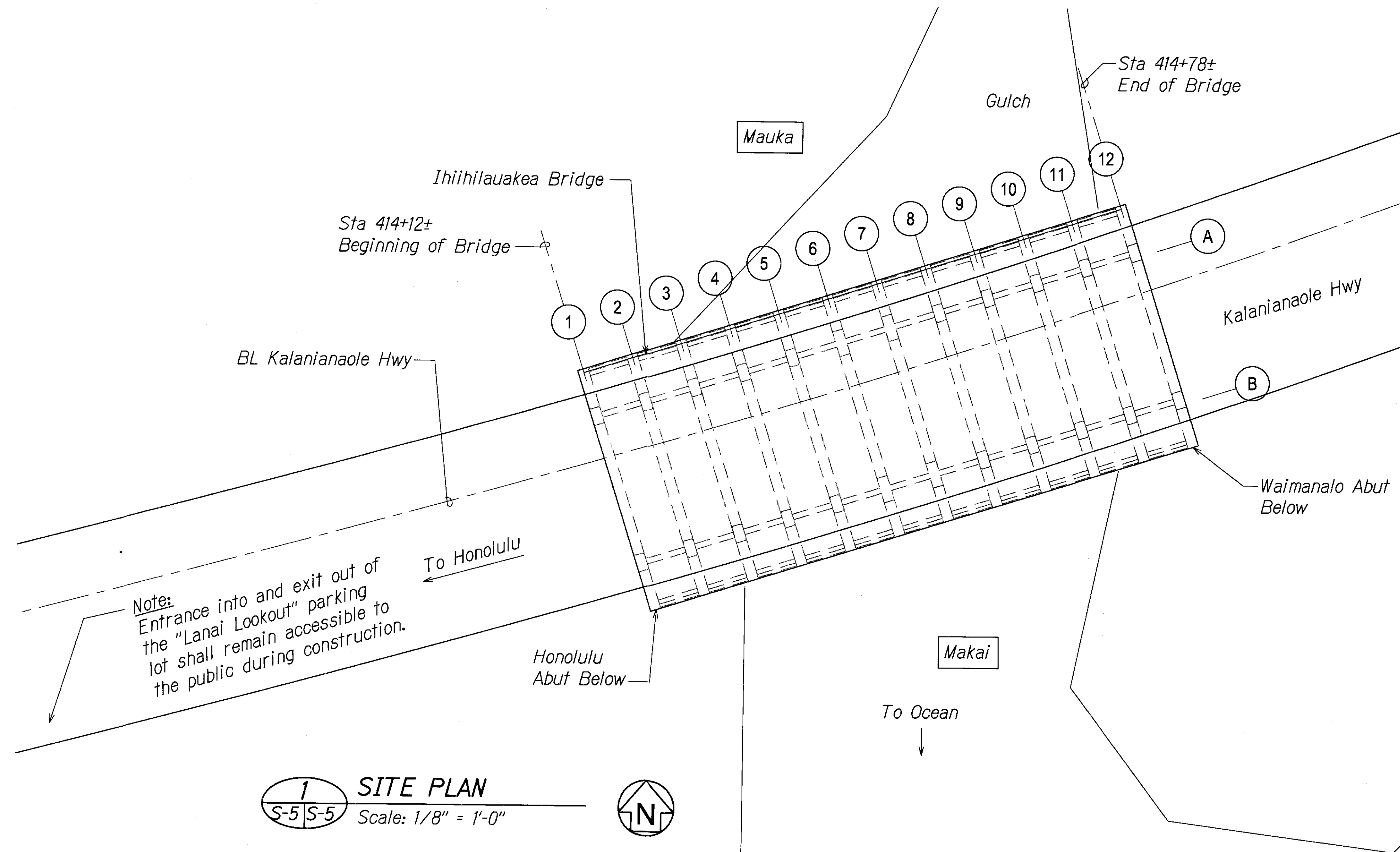

1 SITE PLAN
 Scale: 1/8" = 1'-0"

- Notes:**
- Construction site, including Contractor's staging area and work area, shall be limited to less than one acre.
 - Existing channel below bridge is a dry gulch and is not subject to tidal water influences. The U.S. Army Corps of Engineers has determined that a Department of the Army (DA) permit is not required for this project. Construction materials, scaffolding, shoring, etc. that is temporarily placed in the dry gulch shall not enter the ocean. Refer to General Notes on sheet S-1, Water Pollution and Erosion Control Notes on sheets S-2 and S-3, and Structural Notes on sheet S-4.
 - Existing concrete and wood debris, and other items as directed by the Engineer, in channel below bridge shall be removed and disposed of off-site at a proper disposal site. This item shall be paid for on a Force Account basis. Refer to Special Provisions Section 202 "Removal of Structures and Obstructions."

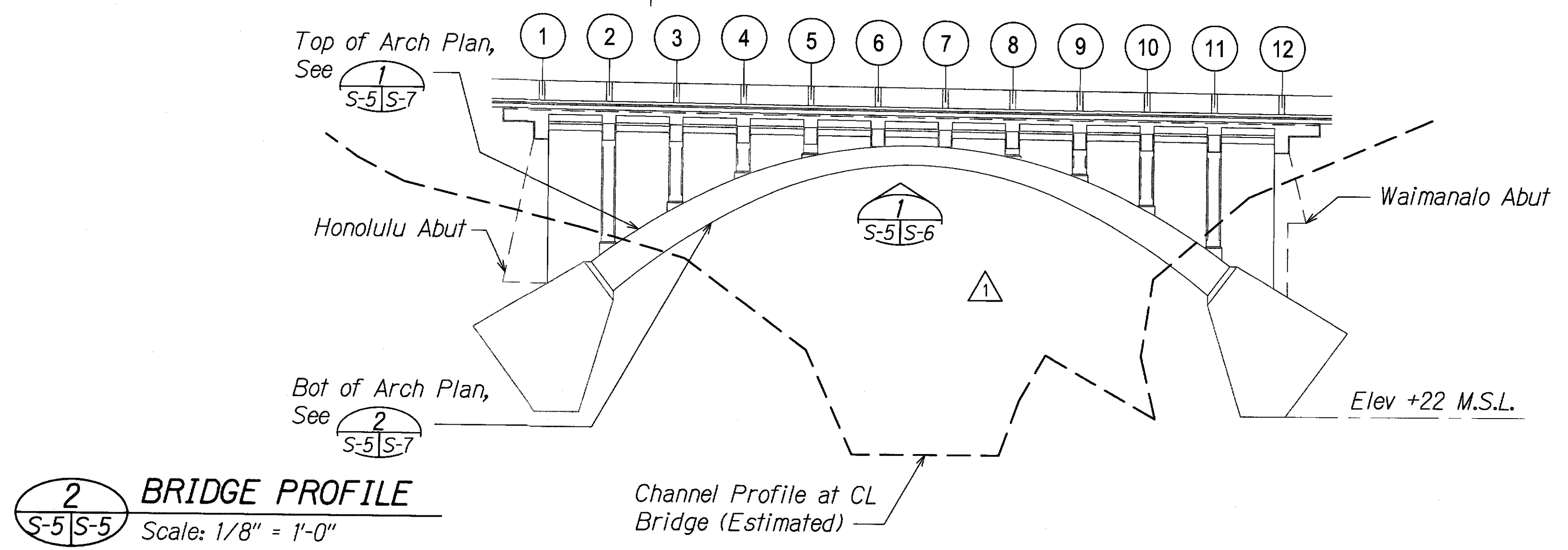

2 BRIDGE PROFILE
 Scale: 1/8" = 1'-0"

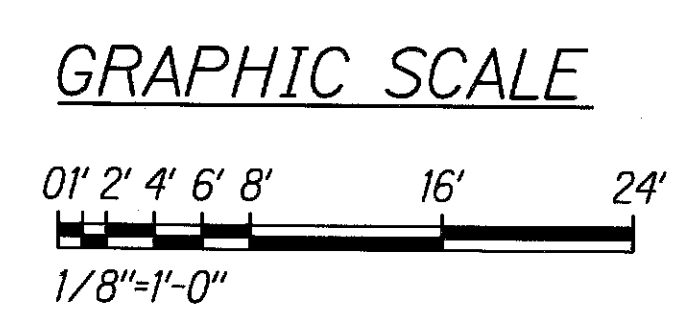

	2/20/13 DATE	Revised Bridge Profile and Notes REVISION
	STATE OF HAWAII DEPARTMENT OF TRANSPORTATION HIGHWAYS DIVISION SITE PLAN & PROFILE KALANIANA'OLE HIGHWAY Emergency Repairs of Ihiihilauea Bridge Project No. 72B-01-13M Scale: As Shown Date: Jan. 16, 2013 SHEET No. S-5 OF 26 SHEETS	

SURVEY PLOTTED BY	DATE
DRAWN BY	
DESIGNED BY	
CHECKED BY	
ORIGINAL PLAN	
NOTES	
NO.	

Spall Repair As-Built

FED. ROAD DIST. NO.	STATE	PROJ. NO.	FISCAL YEAR	SHEET NO.	TOTAL SHEETS
HAWAII	HAW.	72B-01-13M	2013	ADD-8-S-1	34

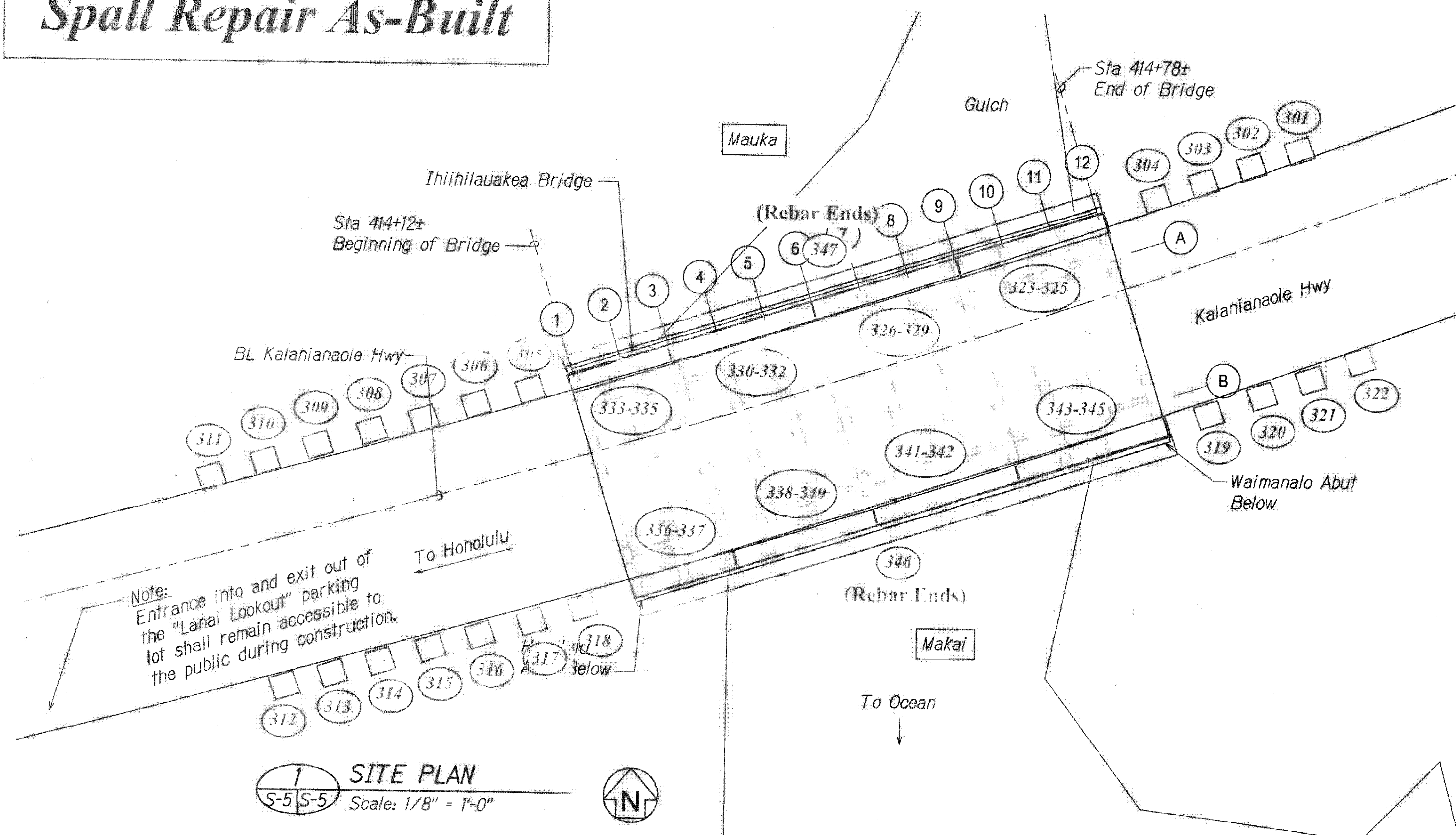

Notes:

1. Construction site, including Contractor's staging area and work area, shall be limited to less than one acre.
2. Estimated high-water mark due to rain storms and/or high surf shall be verified by Contractor. Construction materials, scaffolding, shoring, etc shall not be placed below estimated high-water mark.

LEGEND FOR AS-BUILT POSTINGS	
	Squiggly line for as-built deletion
	Double line for as-built deletion
Roadway	Text for as-built posting

AS-BUILT DRAWINGS

This certifies that the dimensions and details on these sheets reflect the dimensions, details, and specifications as constructed in the field.

Certified by: _____
Ideal Construction, Inc.

Signature: _____
Date: _____

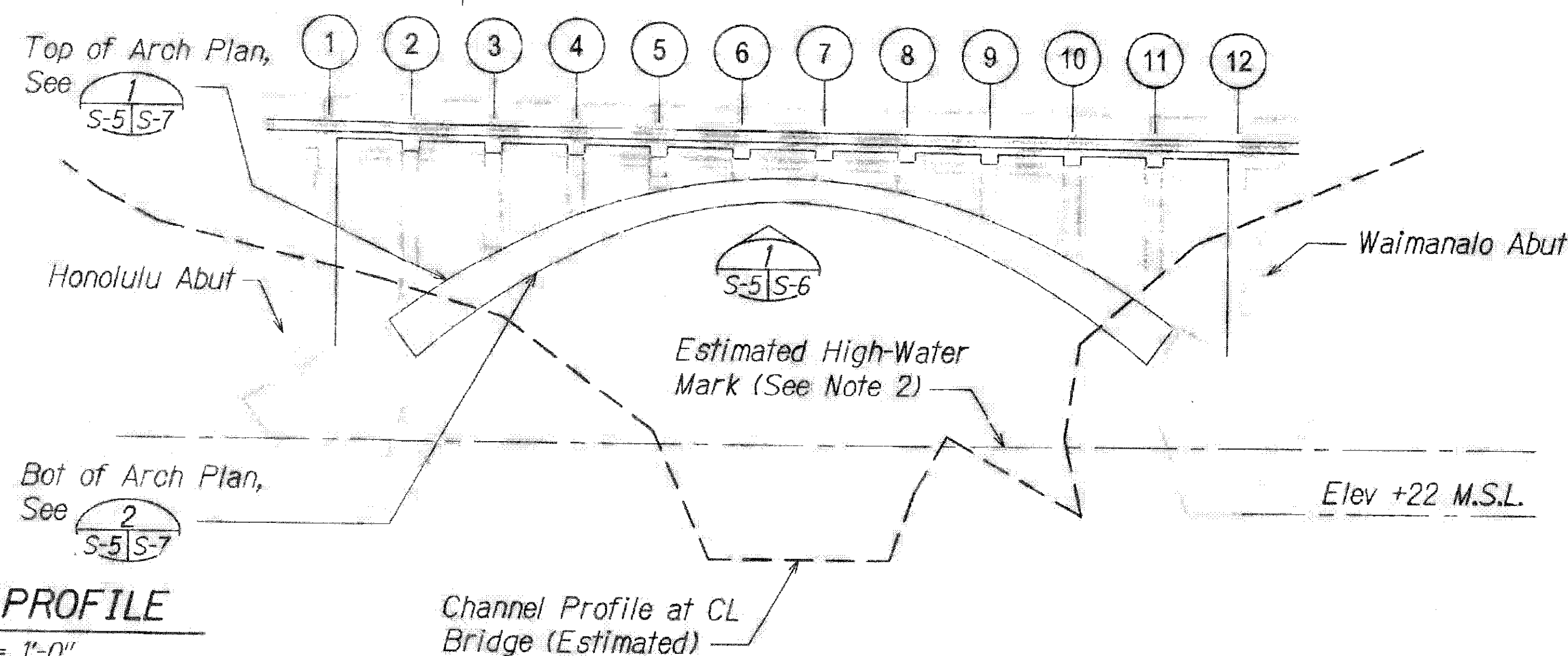

GRAPHIC SCALE

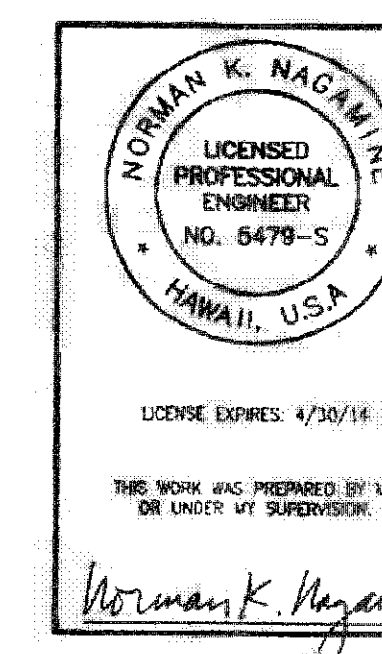
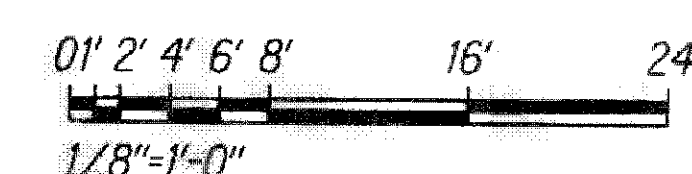

STATE OF HAWAII
DEPARTMENT OF TRANSPORTATION
HIGHWAYS DIVISION

SITE PLAN & PROFILE

KALANIANA'OLE HIGHWAY
Emergency Repairs of Ihihilauea Bridge
Project No. 72B-01-13M

Scale: As Shown Date: Jan. 16, 2013

SHEET No. S-5 OF 26 SHEETS

"AS-BUILT"

S-5A ADD. 8 S-1

FED. ROAD DIST. NO.	STATE	PROJ. NO.	FISCAL YEAR	SHEET NO.	TOTAL SHEETS
HAWAII	HAW.	72B-01-13M	2013	ADD. 8 S-2	34

Cracks Repair As-Built

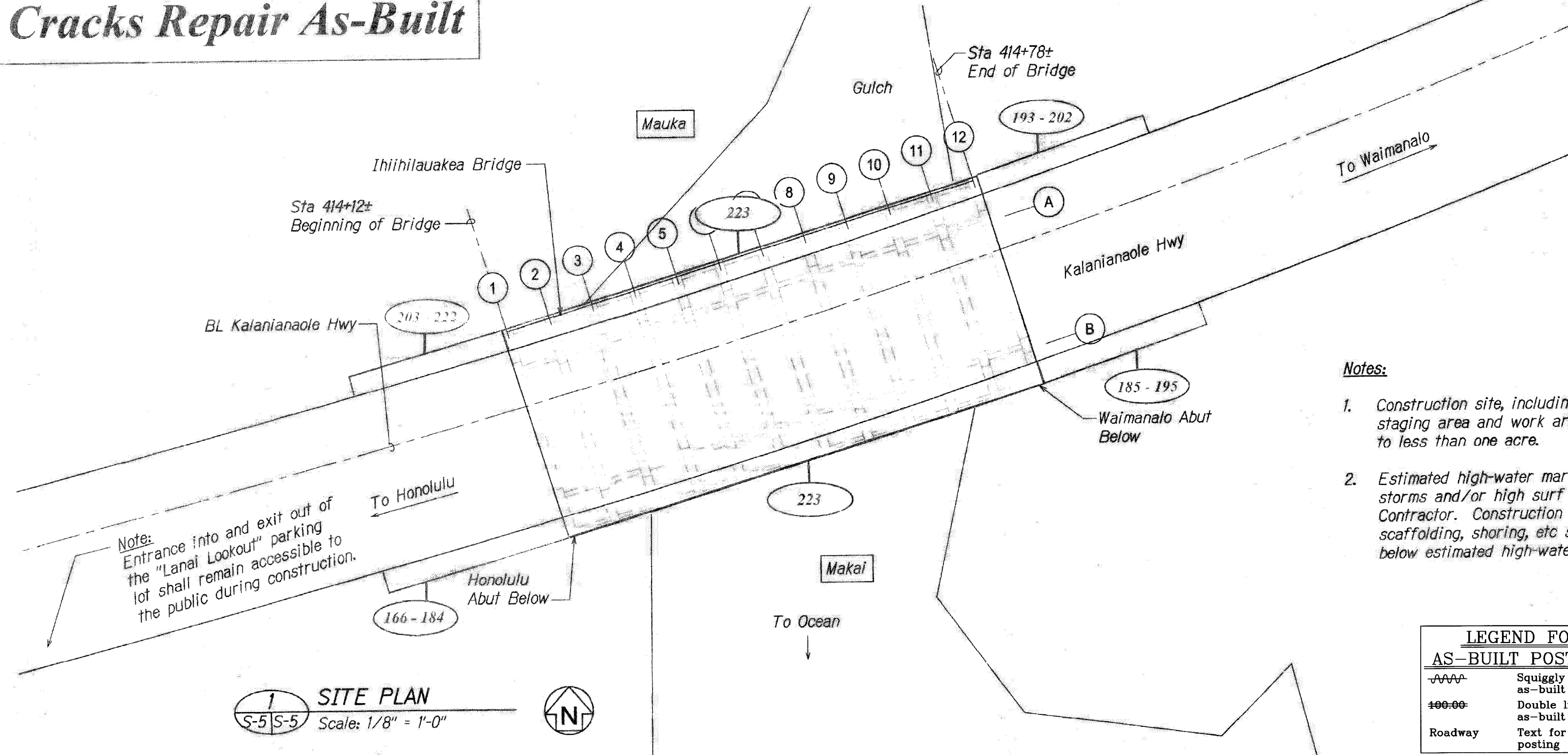

Notes:

1. Construction site, including Contractor's staging area and work area, shall be limited to less than one acre.
2. Estimated high-water mark due to rain storms and/or high surf shall be verified by Contractor. Construction materials, scaffolding, shoring, etc shall not be placed below estimated high-water mark.

LEGEND FOR AS-BUILT POSTINGS	
	Squiggly line for as-built deletion
	Double line for as-built deletion
Roadway	Text for as-built posting

GRAPHIC SCALE

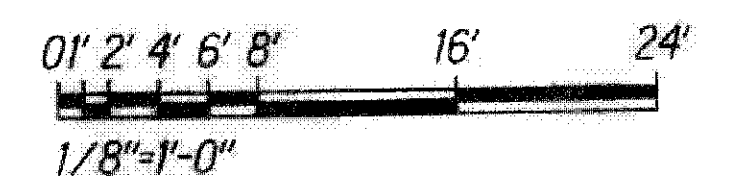

1 SITE PLAN
Scale: 1/8" = 1'-0"

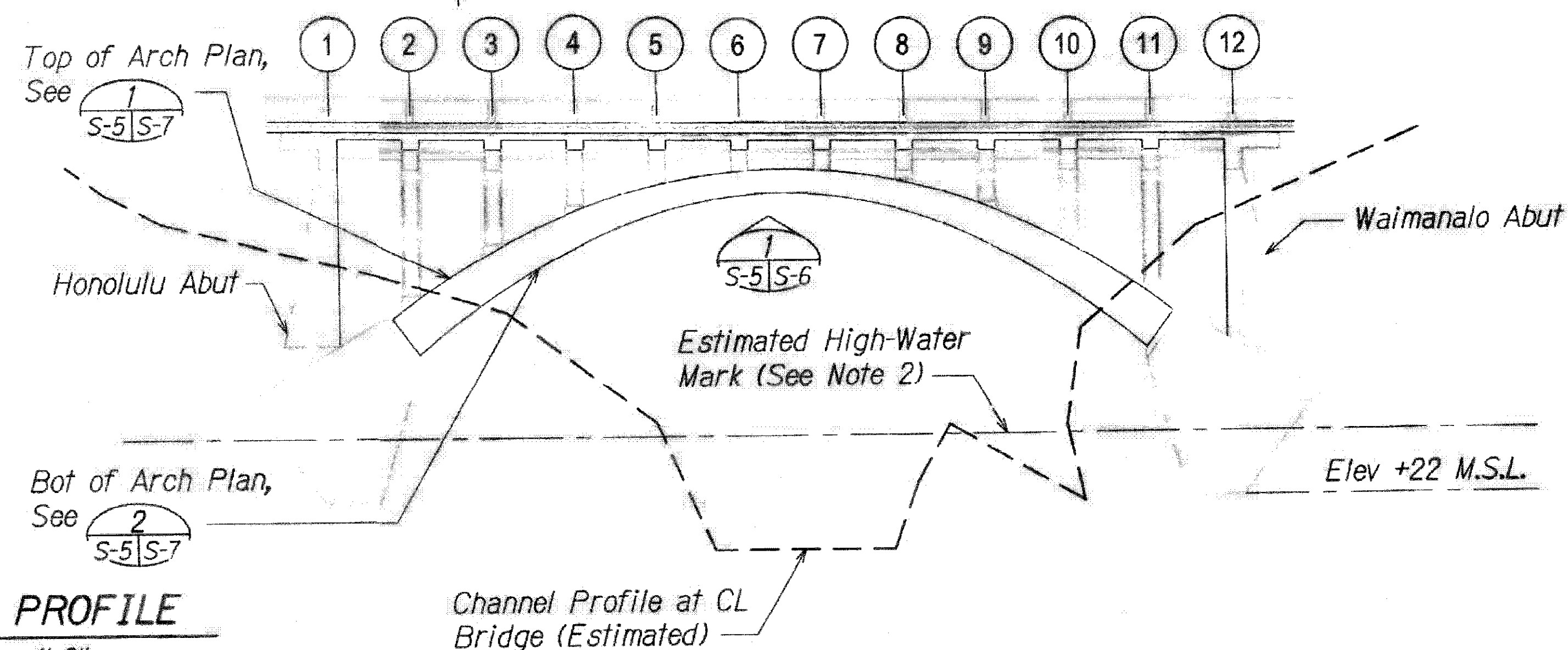

2 BRIDGE PROFILE
Scale: 1/8" = 1'-0"

AS-BUILT DRAWINGS

This certifies that the dimensions and details on these sheets reflect the dimensions, details, and specifications as constructed in the field.

Certified by: Shawn Cross
Ideal Construction, Inc.

Date: 1/16/13

LICENSE EXPIRES: 4/30/14
THIS WORK WAS PREPARED BY ME OR UNDER MY SUPERVISION
Norman K. Nagamine

STATE OF HAWAII
DEPARTMENT OF TRANSPORTATION
HIGHWAYS DIVISION

SITE PLAN & PROFILE

KALANIANAʻOLE HIGHWAY
Emergency Repairs of Ihiihilauakea Bridge
Project No. 72B-01-13M

Scale: As Shown Date: Jan. 16, 2013
SHEET No. S-5 OF 26 SHEETS

"AS-BUILT"

S-5B ADD. 8 S-2

FED. ROAD DIST. NO.	STATE	PROJ. NO.	FISCAL YEAR	SHEET NO.	TOTAL SHEETS
HAWAII	HAW.	72B-01-13M	2013	ADD.8S-3	34

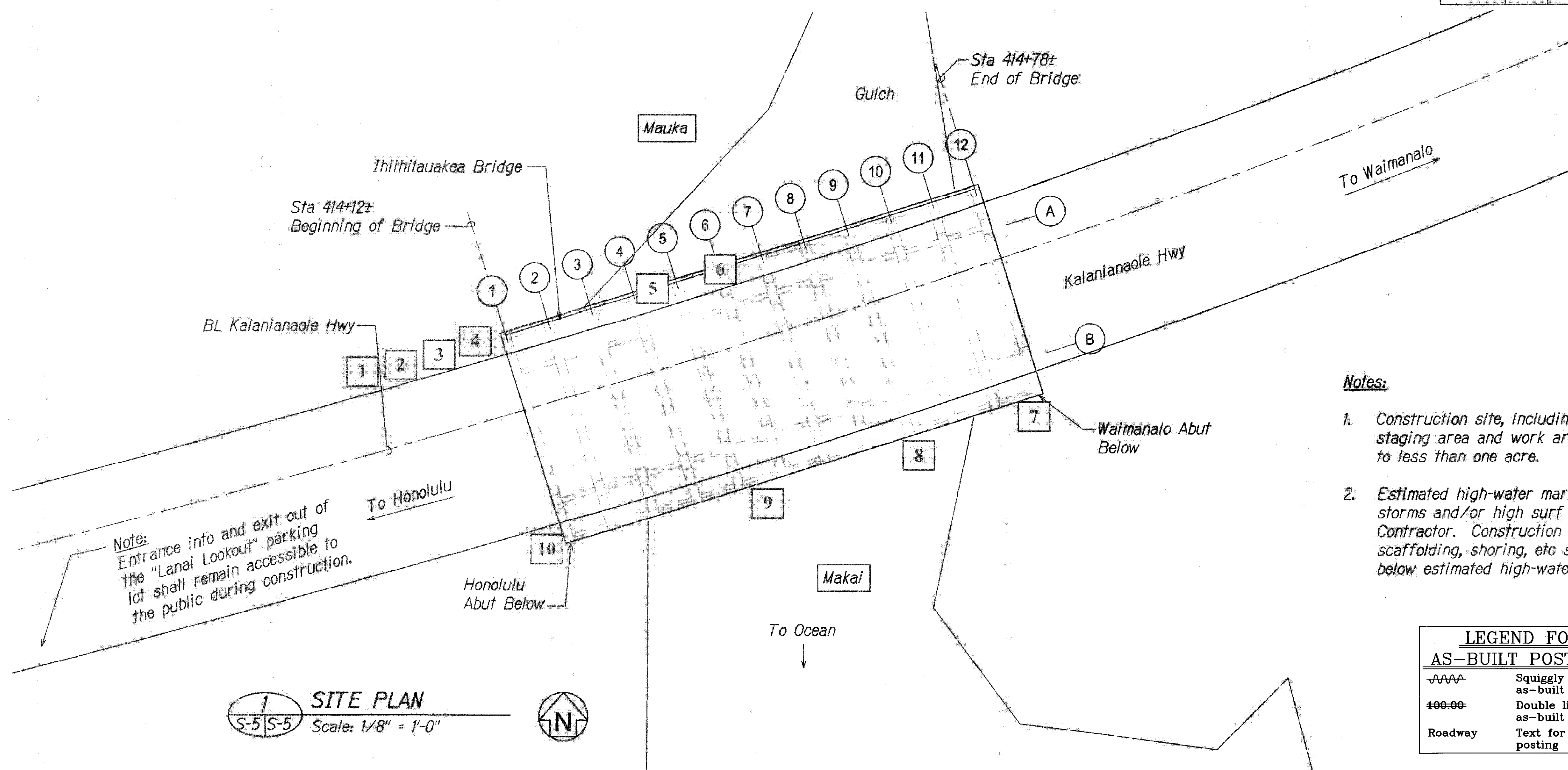

1 SITE PLAN
Scale: 1/8" = 1'-0"

- Notes:**
1. Construction site, including Contractor's staging area and work area, shall be limited to less than one acre.
 2. Estimated high-water mark due to rain storms and/or high surf shall be verified by Contractor. Construction materials, scaffolding, shoring, etc shall not be placed below estimated high-water mark.

LEGEND FOR AS-BUILT POSTINGS	
	Squiggly line for as-built deletion
	Double line for as-built deletion
Roadway	Text for as-built posting

GRAPHIC SCALE



AS-BUILT DRAWINGS

This certifies that the dimensions and details on these sheets reflect the dimensions, details, and specifications as constructed in the field.

Certified by: *Shawn Bus*
Ideal Construction, Inc.

Signature: *Shawn Bus*
Date: _____

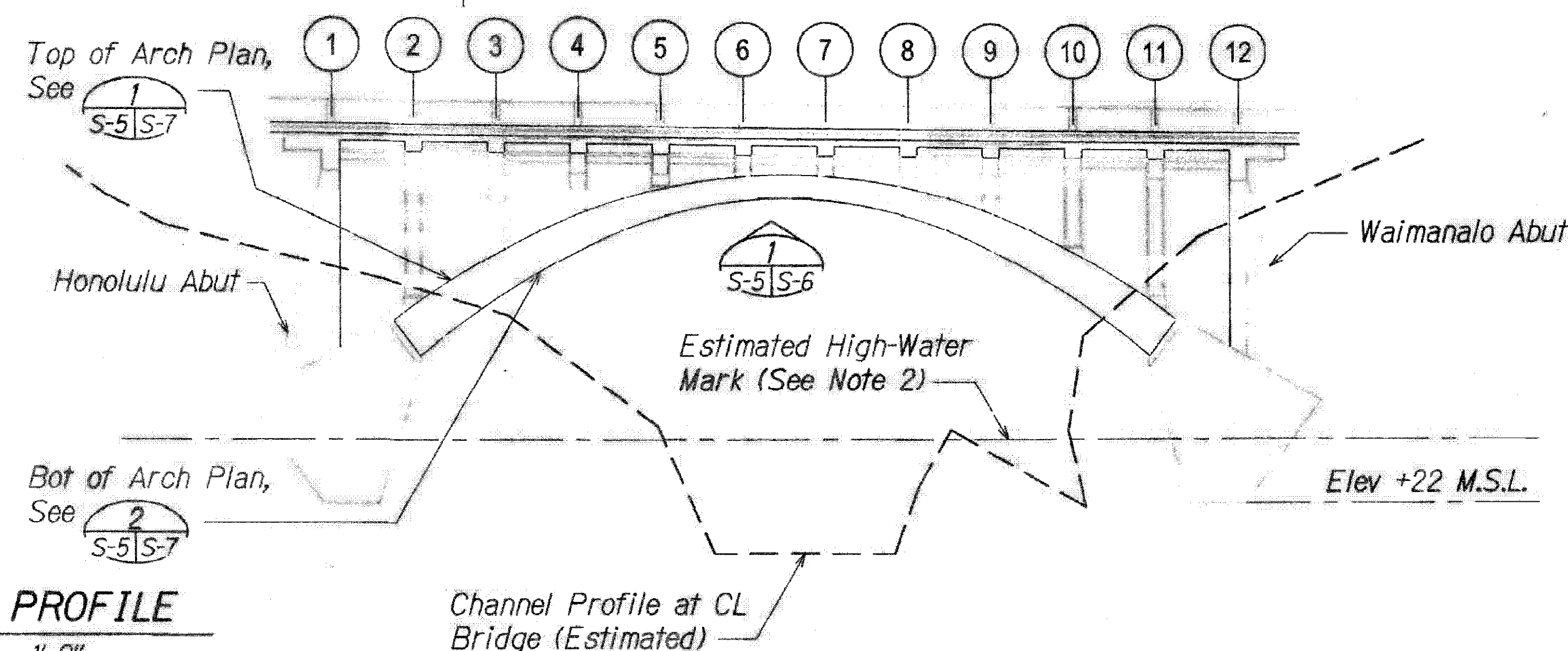

2 BRIDGE PROFILE
Scale: 1/8" = 1'-0"

STATE OF HAWAII
DEPARTMENT OF TRANSPORTATION
HIGHWAYS DIVISION

SITE PLAN & PROFILE

KALANIANA'OLE HIGHWAY
Emergency Repairs of Ihiihilauea Bridge
Project No. 72B-01-13M

Scale: As Shown Date: Jan. 16, 2013

SHEET No. **S-5** OF 26 SHEETS

"AS-BUILT"

S-5C ADD.8 S-3