

**STATE OF HAWAII
DEPARTMENT OF TRANSPORTATION
HIGHWAYS DIVISION**

**ADDENDUM NO. 2
for
KALANIANA'OLE HIGHWAY IMPROVEMENTS PHASE 1
OLOMANA GOLF COURSE TO VICINITY OF POALIMA STREET
NH-072-1(53)**

The following amendments shall be made to the Bid Documents:

A. SPECIAL PROVISIONS

1. Replace Table of Contents dated 10/2/2015 with the attached Table of Contents dated 10/28/2015.
2. Replace Section 107 – Legal Relations and Responsibility to Public, pages 107-1a to 108-4a dated 7/23/15 with the attached Section 107 – Legal Relations and Responsibility to Public, pages 107-1a to 107-6a dated 10/23/15.
3. Replace Federal Wage Rates dated 07/10/2015, with the attached Federal Wage Rates dated 09/11/2015.

B. PROPOSAL SCHEDULE

1. Replace page P-8 to P-15 dated 8/6/2015, with the attached pages P-8 through P-15 dated 10/23/2015.

C. PLANS

1. Replace Sheet Nos. 22, 68, 99, 100, 102, 106, 107, 111, 112, 113, 114, 115, 116, and 117; with the attached Plan Sheets No. ADD. 22, ADD. 68, ADD. 99, ADD. 100, ADD. 102, ADD. 106, ADD. 107, ADD. 111, ADD. 112, ADD. 113, ADD. 114, ADD. 115, ADD. 116, and ADD. 117.
2. Sheet 36, Plan Sta 11+45.00; O/S 18.09' Rt: Call out, revise "New CB (Type D) Per SDOT Std. Plan No. H-02D" to "New CB (Type D) Per SDOT Std. Plan No. H-01D".

D. REPORT

1. Attached are the selected pages from Geotechnical Services, A/C Pavement Evaluation and Design, Kalanianaʻole Highway Improvements Olomana Golf Course to Poalima Street, Waimanalo, Hawaii, prepared by Masa Fujioka and Associates dated November 11, 2013, showing coring locations and existing pavement information.

PRE-BID MEETING AGENDA & MINUTES AND RESPONSES TO REQUEST FOR INFORMATION

1. Attached are the October 20, 2015 pre-bid meeting summary and attendance sheet for your information. Responses to all RFIs received to date have been enclosed at the end of the meeting summary.

Please acknowledge receipt of this Addendum No. 2 by recording the date of its receipt in the space provided on page P-4 of the Proposal.

FORD N. FUCHIGAMI
Director of Transportation

TABLE OF CONTENTS

Notice To Bidders

Instructions for Contractor's Licensing

Notice of Requirement for Affirmative Action to Ensure
Equal Employment Opportunity (Executive Order 11246)

Disadvantaged Business Enterprise (DBE) Requirements

Required Contract Provisions Federal-Aid Construction Contracts

Special Provisions Title Page

Special Provisions:

DIVISION 100 – GENERAL PROVISIONS		
Section	Description	Pages
102	Bidding Requirements and Conditions	102-1a – 102-8a
103	Award And Execution of Contract	103-1a – 103-5a
104	Scope of Work	104-1a – 104-2a
105	Control of Work	105-1a – 105-3a
106	Material Restrictions and Requirements	106-1a
107	Legal Relations and Responsibility To Public	107-1a – 107-6a
108	Prosecution And Progress	108-1a – 108-2a
109	Measurement and Payment	109-1a – 109-2a

DIVISION 200 EARTHWORK		
Section	Description	Pages
203	Excavation And Embankment	203-1a
209	Temporary Water Pollution, Dust, and Erosion Control	209-1a – 209-34a

DIVISION 300 BASES		
Section	Description	Pages
301	Hot Mix Asphalt Base Course	301-1a – 301-2a

DIVISION 400 – PAVEMENTS		
Section	Description	Pages
401	Hot Mix Asphalt Pavement	401-1a – 401-4a
415	Cold Planing of Existing Pavement	415-1a

DIVISION 500 – STRUCTURES		
Section	Description	Pages
509	CRM Veneer	509-1a – 509-6a

DIVISION 600 - INCIDENTAL CONSTRUCTION		
Section	Description	Pages
602	Reinforcing Steel	602-1a
603	Culverts and Storm Drains	603-1a
613	Centerline and Reference Survey Monuments	613-1a
619	Planting	619-1 – 619-2
622	Roadway Lighting System	622-1a – 622-8a
624	Water System	624-1a
626	Manholes and Valve Boxes for Water and Sewer Systems	626-1a
629	Pavement Markings	629-1a – 629-2a
630	Traffic Control Guide Signs	630-1a
631	Traffic Control Regulatory, Warning, and Miscellaneous Signs	631-1a
641	Hydro-Mulch Seeding	641-1 – 641-2
650	Curb Ramps	650-1a
652	Archaeological Monitoring	652-1a – 652-3a
695	Project Educational Campaign	695-1a – 695-4a
699	Mobilization	699-1a

DIVISION 700 – MATERIALS		
Section	Description	Pages
702	Bituminous Materials	702-1a
712	Miscellaneous Frames, Grates, Covers and Ladder Rungs	712.07-1a
717	Cullet And Cullet-Made Materials	717-1a – 717-2a
750	Traffic Control Sign and Marker Materials	750-1a – 750-2a
755	Pavement Marking Materials	755-1
761	Light Emitting Diode (LED) Roadway Lighting Systems Materials	761-1 – 761-4

Requirement of Chapter 104, HRS
Wages and Hours of Employees on Public Works Law

Federal Wage Rates

Proposal Title Page

Proposal	P-1 – P-7
Proposal Schedule	P-8 - P-17

Confirmation by DBE

Surety Bid Bond

Sample Forms

Contract

Performance Bond (Surety)

Performance Bond

Labor and Material Payment Bond (Surety)

Labor and Material Payment Bond

Disclosure of Lobbying Activities
Standard Form - LLL and LLL-A

Statement of Compliance
Form WH-348

DBE Participation Report & Prompt Payment Certification

Chapter 104, HRS Compliance Certificate

END OF TABLE OF CONTENTS

1 **SECTION 107 - LEGAL RELATIONS AND RESPONSIBILITY TO PUBLIC**

2
3 Make the following amendments to said Section:

4
5 **(I) Amend Section 107.01 Insurance Requirements** from lines 5 to 81 to
6 read as follows:

7
8 **“(A) Obligation of Contractor.** Contractor shall not commence any
9 work until it obtains, at its own expense, all required insurance described
10 herein. Such insurance shall be provided by an insurance company
11 authorized by the laws of the State to issue such insurance in the State of
12 Hawaii. Coverage by a “Non-Admitted” carrier is permissible provided the
13 carrier has a Best’s Rating of “A-VII” or better. The Contractor shall
14 maintain and ensure all insurance policies are current for the full period of
15 the contract until final acceptance of the work by the State.
16

17 The Certificate of Insurance shall contain: a clause that it is agreed
18 that any insurance maintained by the State of Hawaii will apply in excess
19 of, and not contribute with, insurance provided by this policy; and shall be
20 accompanied by endorsement form CG2010 or equivalent naming the
21 State as an additional insured to the policy which status shall be
22 maintained for the full period of the contract until final acceptance of the
23 work by State.
24

25 The Contractor shall obtain all required insurance as part of the
26 contract price. Where there is a requirement for the State of Hawaii and
27 its officers and employees to be named as additional insureds under any
28 Contractor’s insurance policy, before the State of Hawaii issues the Notice
29 to Proceed, the Contractor shall obtain and submit to the Engineer a
30 Certificate of Insurance and a written policy endorsement that confirms the
31 State of Hawaii and its officers and employees are additional insureds for
32 the specific State project number and project title under such insurance
33 policies. The written policy endorsement must be issued by the insurance
34 company insuring the Contractor for the specified policy type or by an
35 agent of such insurance company who is vested with the authority to issue
36 a written policy endorsement. The insurer’s agent shall also submit
37 written confirmation of such authority to bind the insurer. Any delays in
38 the issuance of the Notice to Proceed attributed to the failure to obtain the
39 proof of the State of Hawaii and its officers and employees’ additional
40 insured status shall be charged to the Contractor.
41

42 A mere Certificate of Insurance issued by a broker who represents
43 the Contractor (but not the Contractor’s insurer), or by any other party who
44 is not authorized to contractually name the State as an additional insured
45 under the Contractor’s insurance policy, is not sufficient to meet the
46 Contractor’s insurance obligations.

47
48
49
50
51
52
53
54
55
56
57
58
59
60
61
62
63
64
65
66
67
68
69
70
71
72
73
74
75
76
77
78
79
80
81
82
83
84
85
86
87
88
89
90
91

Certificates shall contain a provision that coverages being certified will not be cancelled or materially changed without giving the Engineer at least thirty (30) days prior written notice. Contractor will immediately provide written notice to the Director should any of the insurance policies evidenced on its Certificate of Insurance form be cancelled, reduced in scope or coverage, or not renewed upon expiration. Should any policy be canceled before final acceptance of the work by the State, and the Contractor fails to immediately procure replacement insurance as specified, the State, in addition to all other remedies it may have for such breach, reserves the right to procure such insurance and deduct the cost thereof from any money due or to become due to the Contractor.

Nothing contained in these insurance requirements is to be construed as limiting the extent of Contractor's responsibility for payment of damages resulting from its operations under this contract, including the Contractor's obligation to pay liquidated damages, nor shall it affect the Contractor's separate and independent duty to defend, indemnify and hold the State harmless pursuant to other provisions of this contract. In no instance will the State's exercise of an option to occupy and use completed portions of the work relieve the Contractor of its obligation to maintain the required insurance until the date of final acceptance of the work.

All insurance described herein shall be primary and cover the insured for all work to be performed under the contract, all work performed incidental thereto or directly or indirectly connected therewith, including but not limited to traffic detour work, barricades, warnings, diversions, lane closures, and other work performed outside the work area and all change order work.

The Contractor shall, from time to time, furnish the Engineer, when requested, satisfactory proof of coverage of each type of insurance required covering the work. Failure to comply with the Engineer's request may result in suspension of the work, and shall be sufficient grounds to withhold future payments due the Contractor and to terminate the contract for Contractor's default.

(B) Types of Insurance. Contractor shall purchase and maintain insurance described below which shall provide coverage against claims arising out of the Contractor's operations under the contract, whether such operations be by the Contractor itself or by any subcontractor or by anyone directly or indirectly employed by any of them or by anyone for whose acts any of them may be liable.

92 **(1) Workers' Compensation.** The Contractor shall obtain
93 worker's compensation insurance for all persons whom they
94 employ in carrying out the work under this contract. This insurance
95 shall be in strict conformity with the requirements of the most
96 current and applicable State of Hawaii Worker's Compensation
97 Insurance laws in effect on the date of the execution of this contract
98 and as modified during the duration of the contract.
99

100 **(2) Auto Liability.** The Contractor shall obtain Auto Liability
101 Insurance covering all owned, non-owned and hired autos with a
102 Combined single Limit of not less than \$1,000,000 per occurrence
103 for bodily injury and property damage with the State of Hawaii
104 named as additional insured. Refer to SPECIAL CONDITIONS for
105 any additional requirements.
106

107 **(3) General Liability.** The Contractor shall obtain General
108 Liability insurance with a limit of not less than \$2,000,000 per
109 occurrence and in the Aggregates for each of the following:
110

- 111 (a) Products - Completed/Operations Aggregate,
- 112
- 113 (b) Personal & Advertising Injury, and
- 114
- 115 (c) Bodily Injury & Property Damage
116

117 The General Liability insurance shall include the State as an
118 Additional Insured. The required limit of insurance may be provided
119 by a single policy or with a combination of primary and excess
120 policies. Refer to SPECIAL CONDITIONS for any additional
121 requirements."
122

123 **(C) Right-of-Entry and Rental Agreement.**

124 **(1) CONTRACTOR's Responsibility.**

125 The CONTRACTOR shall include GRANTOR as additional insured
126 on the insurance policies (comprehensive Personal Injury and
127 Property Damage Liability; Automobile Bodily Injury and Property
128 Damage; and Worker's Compensation) that will be prescribed by
129 the proposed Project construction contract. Said insurance policies
130 shall also provide a waiver of subrogation in GRANTOR's favor.
131 The CONTRACTOR shall provide written verification of compliance
132 in the form of an insurance certification to the GRANTOR prior to
133 the start of Project construction.
134

135 **(2) Indemnification by Contractor.** The CONTRACTOR shall
136 execute an agreement whereby the CONTRACTOR shall indemnify
137
138

139 the GRANTOR against any liability, including all loss, damages,
140 costs, expenses and attorney's fees, for any damage to real or
141 personal property, if any, or injury to or death of persons when such
142 damage, injury or death is caused by the negligence, gross
143 negligence or willful action of the CONTRACTOR in the exercise of
144 the rights granted under the Right-of-Entry and Rental Agreement;
145 provided that the CONTRACTOR shall not be obligated to
146 indemnify the GRANTOR if and to the extent that such damage,
147 injury or death is caused by the negligence of the GRANTOR or
148 any of the GRANTOR's officers, employees, agents,
149 representatives, or guests.

150
151 **(3) Notification to GRANTOR.** The CONTRACTOR shall
152 give the owner a 30-day written notice prior to start of construction.
153

154
155 **(II)** Amend **Section 107.03 Working Hours; Night Work** by adding
156 the following after line 143 :
157

158 "No night work shall be allowed from September 15 through December
159 15, due to the Newell's Shearwater nesting season.
160

161 The State has received approval for a Noise Variance for the project
162 through the Department of Health according to Chapter 342F, Hawaii Revised
163 Statutes, for night work. Should the Department of Health modify, suspend, or
164 revoke the request for Noise Variance, the State will have the right to have part
165 or all of the contract work done during the day.
166

167 The Noise Variance application requests permission for the Contractor to
168 work from:
169

170 Sunday and Holidays	Midnight to midnight
171	
172 Monday through Friday	Midnight to 5:00 a.m. and
173	7:00 p.m. to midnight
174	
175 Saturday	Midnight to 8:00 a.m. and
176	8:30 p.m. to midnight
177	

178 subject to the following restrictions and conditions during the variance hours:
179

180 (1) The variance shall be granted to perform roadway work
181 along Kalaniana'ole Highway, from Olomana Golf Course to the
182 Vicinity of Poalima Street, Waimanalo, Oahu.
183

184 (2) The variance shall be granted from March 1, 2016 to
185 February 28, 2017.

- 186 (3) The use of the hoe ram, the walk behind saw and handheld
187 jackhammers, shall be prohibited after 8:00 p.m. within 500 feet of
188 residences.
189
- 190 (4) The use of cold planers, shall be prohibited after 10:00 p.m.
191 within 500 feet of residences.
192
- 193 (5) The use of Hitachi EX225, excavators, backholes, loaders,
194 and vibratory rollers shall be prohibited after midnight within 500
195 feet of residences.
196
- 197 (6) The applicant shall notify the Indoor and Radiological Health
198 Branch as to the date and time of any variance hour activity as
199 soon as the dates are confirmed, and when the project is
200 completed.
201
- 202 (7) Residents and businesses that may be impacted by the
203 activity shall be given sufficient notice regarding the project. The
204 notification for the planned nighttime activity shall contain the name
205 and telephone number of the job-site inspector. In addition, a copy
206 of any notifications, a map of the distribution area, as well as
207 progress reports shall be sent to the Indoor and Radiological Health
208 Branch.
209
- 210 (8) The applicant shall make every effort to minimize noise
211 emanating from the project.
212
- 213 (9) The use of reverse signal alarms shall be prohibited from
214 8:00 pm to 7:00 a.m. Alternative methods such as utilizing a ground
215 guide for signaling shall be employed.
216
- 217 (10) Traffic noise from heavy vehicles travelling to and from the
218 project site shall be minimized near residences.
219
- 220 (11) The applicant shall have a job-site inspector to whom
221 immediate complaints can be forwarded for prompt response, and
222 who shall have the general responsibility of monitoring quiet work
223 procedures.
224
- 225 (12) If the noise level is such that numerous complaints are
226 received by the Department, the applicant shall cease operations
227 upon receipt of an order and complete the project during hours on
228 weekdays and weekends as directed.
229
- 230 (13) Pursuant to Section 342F-5(d)(3), H.R.S., the applicant shall
231 be required to perform noise sampling during the variance hours

232 and report the results of such sampling to the Indoor and
233 Radiological Health Branch.
234
235 (14) Should the duration of the project continue beyond the
236 expiration date, the applicant shall submit a request for extension
237 along with an updated work schedule prior to February 28, 2017.”
238
239 (III) Add the following **Section 107.18 Community Noise Permit** after
240 line 745:
241
242 **“107.18 Community Noise Permit.** The State has received approval
243 for a Community Noise Permit For Construction Activities for the project through
244 the Department of Health according to the provisions of Chapter 342F, Hawaii
245 Revised Statutes and Chapter 11-46, Hawaii Administrative Rules.
246
247 The Contractor shall follow the Permit restrictions and conditions.
248
249 Use of the Hoe-ram, Vacuum truck, Walk behind saw, Cold planer, EVAC
250 (Ditch Witch), Hand-held jack-hammer and Core drilling machine shall be limited
251 to 9:00 a.m. to 5:30 p.m., Monday through Friday. The Contractor shall notify the
252 surrounding impacted area prior to Hoe-ram activity.”
253
254
255
256
257
258
259
260
261
262 **END OF SECTION 107**

>

General Decision Number: HI150001 09/11/2015 HI1

Superseded General Decision Number: HI20140001

State: Hawaii

Construction Types: Building, Heavy (Heavy and Dredging),
Highway and Residential

Counties: Hawaii Statewide.

BUILDING CONSTRUCTION PROJECTS; RESIDENTIAL CONSTRUCTION
PROJECTS (consisting of single family homes and apartments up
to and including 4 stories); HEAVY AND HIGHWAY CONSTRUCTION
PROJECTS AND DREDGING

Note: Executive Order (EO) 13658 establishes an hourly minimum
wage of \$10.10 for 2015 that applies to all contracts subject
to the Davis-Bacon Act for which the solicitation is issued on
or after January 1, 2015. If this contract is covered by the
EO, the contractor must pay all workers in any classification
listed on this wage determination at least \$10.10 (or the
applicable wage rate listed on this wage determination, if it
is higher) for all hours spent performing on the contract. The
EO minimum wage rate will be adjusted annually. Additional
information on contractor requirements and worker protections
under the EO is available at www.dol.gov/whd/govcontracts.

Modification Number	Publication Date
0	01/02/2015
1	01/16/2015
2	01/23/2015
3	02/06/2015
4	02/27/2015
5	03/06/2015
6	03/13/2015
7	03/27/2015
8	05/29/2015
9	07/03/2015
10	07/10/2015
11	08/07/2015
12	08/21/2015
13	08/28/2015
14	09/04/2015
15	09/11/2015

ASBE0132-001 08/29/2010

	Rates	Fringes
Asbestos Workers/Insulator		
Includes application of		
all insulating materials,		
protective coverings,		
coatings and finishes to		

all types of mechanical
systems. Also the
application of
firestopping material for
wall openings and
penetrations in walls,
floors, ceilings and
curtain walls.....\$ 36.65

22.24

BOIL0627-005 01/01/2013

	Rates	Fringes
BOILERMAKER.....	\$ 35.20	27.35

BRHI0001-001 09/03/2012

	Rates	Fringes
BRICKLAYER		
Bricklayers and Stonemasons..	\$ 35.35	22.92
Pointers, Caulkers and		
Weatherproofers.....	\$ 35.60	22.92

BRHI0001-002 09/02/2013

	Rates	Fringes
Tile, Marble & Terrazzo Worker		
Terrazzo Base Grinders.....	\$ 35.29	23.22
Terrazzo Floor Grinders		
and Tenders.....	\$ 32.24	23.22
Tile, Marble and Terrazzo		
Workers.....	\$ 37.10	23.22

* CARP0745-001 08/31/2015

	Rates	Fringes
Carpenters:		
Carpenters; Hardwood Floor		
Layers; Patent Scaffold		
Erectors (14 ft. and		
over); Piledrivers;		
Pneumatic Nailers; Wood		
Shinglers and Transit		
and/or Layout Man.....	\$ 43.90	20.92
Millwrights and Machine		
Erectors.....	\$ 44.15	20.92
Power Saw Operators (2		
h.p. and over).....	\$ 44.05	20.92

* CARP0745-002 08/31/2015

	Rates	Fringes
Drywall and Acoustical		
Workers and Lathers.....	\$ 44.15	20.92

ELEC1186-001 08/22/2015

	Rates	Fringes
Electricians:		
Cable Splicers.....	\$ 47.36	28.53
Electricians.....	\$ 43.05	27.22
Telecommunication worker....	\$ 26.30	11.58

ELEC1186-002 08/22/2015

	Rates	Fringes
Line Construction:		
Cable Splicers.....	\$ 47.36	28.53
Groundmen/Truck Drivers.....	\$ 32.29	23.93
Heavy Equipment Operators...	\$ 38.75	25.91
Linemen.....	\$ 43.05	27.22
Telecommunication worker....	\$ 26.30	11.58

ELEV0126-001 01/01/2015

	Rates	Fringes
ELEVATOR MECHANIC.....	\$ 53.07	28.38

a. VACATION: Employer contributes 8% of basic hourly rate for 5 years service and 6% of basic hourly rate for 6 months to 5 years service as vacation pay credit.

b. PAID HOLIDAYS: New Year's Day, Memorial Day, Independence Day, Labor Day, Veterans' Day, Thanksgiving Day, the Friday after Thanksgiving Day and Christmas Day.

ENGI0003-002 09/01/2014

	Rates	Fringes
Diver (Aqua Lung) (Scuba)		
Diver (Aqua Lung) (Scuba)		
(over a depth of 30 feet)...	\$ 61.50	27.06
Diver (Aqua Lung) (Scuba)		
(up to a depth of 30 feet)...	\$ 52.13	27.06
Stand-by Diver (Aqua Lung)		
(Scuba).....	\$ 42.75	27.06
Diver (Other than Aqua Lung)		
Diver (Other than Aqua Lung).....	\$ 61.50	27.06
Diver Tender (Other than Aqua Lung).....	\$ 39.72	27.06
Stand-by Diver (Other than Aqua Lung).....	\$ 42.75	27.06
Helicopter Work		
Airborne Hoist Operator for Helicopter.....	\$ 41.30	27.06
Co-Pilot of Helicopter.....	\$ 41.44	27.06
Pilot of Helicopter.....	\$ 41.61	27.06
Power equipment operator - tunnel work		
GROUP 1.....	\$ 37.74	27.06

GROUP 2.....	\$ 37.85	27.06
GROUP 3.....	\$ 38.02	27.06
GROUP 4.....	\$ 38.29	27.06
GROUP 5.....	\$ 38.60	27.06
GROUP 6.....	\$ 39.25	27.06
GROUP 7.....	\$ 39.57	27.06
GROUP 8.....	\$ 39.68	27.06
GROUP 9.....	\$ 39.79	27.06
GROUP 9A.....	\$ 40.02	27.06
GROUP 10.....	\$ 40.08	27.06
GROUP 10A.....	\$ 40.23	27.06
GROUP 11.....	\$ 40.38	27.06
GROUP 12.....	\$ 40.74	27.06
GROUP 12A.....	\$ 41.10	27.06
Power equipment operators:		
GROUP 1.....	\$ 37.44	27.06
GROUP 2.....	\$ 37.55	27.06
GROUP 3.....	\$ 37.72	27.06
GROUP 4.....	\$ 37.99	27.06
GROUP 5.....	\$ 38.30	27.06
GROUP 6.....	\$ 38.95	27.06
GROUP 7.....	\$ 39.27	27.06
GROUP 8.....	\$ 39.38	27.06
GROUP 9.....	\$ 39.49	27.06
GROUP 9A.....	\$ 39.72	27.06
GROUP 10.....	\$ 39.78	27.06
GROUP 10A.....	\$ 39.93	27.06
GROUP 11.....	\$ 40.08	27.06
GROUP 12.....	\$ 40.44	27.06
GROUP 12A.....	\$ 40.80	27.06
GROUP 13.....	\$ 37.72	27.06
GROUP 13A.....	\$ 37.99	27.06
GROUP 13B.....	\$ 38.30	27.06
GROUP 13C.....	\$ 38.95	27.06
GROUP 13D.....	\$ 39.27	27.06
GROUP 13E.....	\$ 39.38	27.06

POWER EQUIPMENT OPERATORS CLASSIFICATIONS

GROUP 1: Fork Lift (up to and including 10 tons); Partsman (heavy duty repair shop parts room when needed).

GROUP 2: Conveyor Operator (Handling building material); Hydraulic Monitor; Mixer Box Operator (Concrete Plant).

GROUP 3: Brakeman; Deckhand; Fireman; Oiler; Oiler/Gradechecker; Signalman; Switchman; Highline Cableway Signalman; Bargeman; Bunkerman; Concrete Curing Machine (self-propelled, automatically applied unit on streets, highways, airports and canals); Leveeman; Roller (5 tons and under); Tugger Hoist.

GROUP 4: Boom Truck or dual purpose "A" Frame Truck (5 tons or less); Concrete Placing Boom (Building Construction); Dinky Operator; Elevator Operator; Hoist and/or Winch (one drum); Straddle Truck (Ross Carrier, Hyster and similar).

GROUP 5: Asphalt Plant Fireman; Compressors, Pumps, Generators and Welding Machines ("Bank" of 9 or more, individually or collectively); Concrete Pumps or Pumpcrete

Guns; Lubrication and Service Engineer (Grease Rack);
Screedman.

GROUP 6: Boom Truck or Dual Purpose "A"Frame Truck (over 5 tons); Combination Loader/Backhoe (up to and including 3/4 cu. yd.); Concrete Batch Plants (wet or dry); Concrete Cutter, Groover and/or Grinder (self-propelled unit on streets, highways, airports, and canals); Conveyor or Concrete Pump (Truck or Equipment Mounted); Drilling Machinery (not to apply to waterliners, wagon drills or jack hammers); Fork Lift (over 10 tons); Loader (up to and including 3 and 1/2 cu. yds); Lull High Lift (under 40 feet); Lubrication and Service Engineer (Mobile); Maginnis Internal Full Slab Vibrator (on airports, highways, canals and warehouses); Man or Material Hoist; Mechanical Concrete Finisher (Large Clary, Johnson Bidwell, Bridge Deck and similar); Mobile Truck Crane Driver; Portable Shotblast Concrete Cleaning Machine; Portable Boring Machine (under streets, highways, etc.); Portable Crusher; Power Jumbo Operator (setting slip forms, etc., in tunnels); Rollers (over 5 tons); Self-propelled Compactor (single engine); Self-propelled Pavement Breaker; Skidsteer Loader with attachments; Slip Form Pumps (Power driven by hydraulic, electric, air, gas, etc., lifting device for concrete forms); Small Rubber Tired Tractors; Trencher (up to and including 6 feet); Underbridge Personnel Aerial Platform (50 feet of platform or less).

GROUP 7: Crusher Plant Engineer, Dozer (D-4, Case 450, John Deere 450, and similar); Dual Drum Mixer, Extend Lift; Hoist and/or Winch (2 drums); Loader (over 3 and 1/2 cu. yds. up to and including 6 yards.); Mechanical Finisher or Spreader Machine (asphalt), (Barber Greene and similar) (Screedman required); Mine or Shaft Hoist; Mobile Concrete Mixer (over 5 tons); Pipe Bending Machine (pipelines only); Pipe Cleaning Machine (tractor propelled and supported); Pipe Wrapping Machine (tractor propelled and supported); Roller Operator (Asphalt); Self-Propelled Elevating Grade Plane; Slusher Operator; Tractor (with boom) (D-6, or similar); Trencher (over 6 feet and less than 200 h.p.); Water Tanker (pulled by Euclids, T-Pulls, DW-10, 20 or 21, or similar); Winchman (Stern Winch on Dredge).

GROUP 8: Asphalt Plant Operator; Barge Mate (Seagoing); Cast-in-Place Pipe Laying Machine; Concrete Batch Plant (multiple units); Conveyor Operator (tunnel); Deckmate; Dozer (D-6 and similar); Finishing Machine Operator (airports and highways); Gradesetter; Kolman Loader (and similar); Mucking Machine (Crawler-type); Mucking Machine (Conveyor-type); No-Joint Pipe Laying Machine; Portable Crushing and Screening Plant; Power Blade Operator (under 12); Saurman Type Dragline (up to and including 5 yds.); Stationary Pipe Wrapping, Cleaning and Bending Machine; Surface Heater and Planer Operator, Tractor (D-6 and similar); Tri-Batch Paver; Tunnel Badger; Tunnel Mole and/or Boring Machine Operator Underbridge Personnel Aerial Platform (over 50 feet of platform).

GROUP 9: Combination Mixer and Compressor (gunite); Do-Mor Loader and Adams Elegrader; Dozer (D-7 or equal); Wheel

and/or Ladder Trencher (over 6 feet and 200 to 749 h.p.).

GROUP 9A: Dozer (D-8 and similar); Grader (when required by the Contractor to work from drawings, plans or specifications without the direct supervision of a foreman or superintendent); Push Cat; Scrapers (up to and including 20 cu. yds); Self-propelled Compactor with Dozer; Self-Propelled, Rubber-Tired Earthmoving Equipment (up to and including 20 cu. yds) (621 Band and similar); Sheep's Foot; Tractor (D-8 and similar); Tractors with boom (larger than D-6, and similar).

GROUP 10: Chicago Boom; Cold Planers; Heavy Duty Repairman or Welder; Hoist and/or Winch (3 drums); Hydraulic Skooper (Koehring and similar); Loader (over 6 cu. yds. up to and including 12 cu. yds.); Saurman type Dragline (over 5 cu. yds.); Self-propelled, rubber-tired Earthmoving Equipment (over 20 cu. yds. up to and including 31 cu. yds.) (637D and similar); Soil Stabilizer (P & H or equal); Sub-Grader (Gurries or other automatic type); Tractors (D-9 or equivalent, all attachments); Tractor (Tandem Scraper); Watch Engineer.

GROUP 10A: Boat Operator; Cable-operated Crawler Crane (up to and including 25 tons); Cable-operated Power Shovel, Clamshell, Dragline and Backhoe (up to and including 1 cu. yd.); Dozer D9-L; Dozer (D-10, HD41 and similar) (all attachments); Gradall (up to and including 1 cu. yd.); Hydraulic Backhoe (over 3/4 cu. yds. up to and including 2 cu. yds.); Mobile Truck Crane Operator (up to and including 25 tons) (Mobile Truck Crane Driver Required); Self-propelled Boom Type Lifting Device (Center Mount) (up to and including 25 tons) (Grove, Drott, P&H, Pettibone and similar); Trencher (over 6 feet and 750 h.p. or more); Watch Engineer (steam or electric).

GROUP 11: Automatic Slip Form Paver (concrete or asphalt); Band Wagon (in conjunction with Wheel Excavator); Cable-operated Crawler Cranes (over 25 tons but less than 50 tons); Cable-operated Power Shovel, Clamshell, Dragline and Backhoe (over 1 cu. yd. up to 7 cu. yds.); Gradall (over 1 cu. yds. up to 7 cu. yds.); DW-10, 20, etc. (Tandem); Earthmoving Machines (multiple propulsion power units and 2 or more Scrapers) (up to and including 35 cu. yds., "struck" m.r.c.); Highline Cableway; Hydraulic Backhoe (over 2 cu. yds. up to and including 4 cu. yds.); Leverman; Lift Slab Machine; Loader (over 12 cu. yds); Master Boat Operator; Mobile Truck Crane Operator (over 25 tons but less than 50 tons); (Mobile Truck Crane Driver required); Pre-stress Wire Wrapping Machine; Self-propelled Boom-type Lifting Device (Center Mount) (over 25 tons m.r.c); Self-propelled Compactor (with multiple-propulsion power units); Single Engine Rubber Tired Earthmoving Machine (with Tandem Scraper); Tandem Cats; Trencher (pulling attached shield).

GROUP 12: Clamshell or Dipper Operator; Derricks; Drill Rigs; Multi-Propulsion Earthmoving Machines (2 or more Scrapers) (over 35 cu. yds "struck"m.r.c.); Operators (Derricks, Piledrivers and Cranes); Power Shovels and Draglines (7 cu.

yds. m.r.c. and over); Self-propelled rubber-tired Earthmoving equipment (over 31 cu. yds.) (657B and similar); Wheel Excavator (up to and including 750 cu. yds. per hour); Wheel Excavator (over 750 cu. yds. per hour).

GROUP 12A: Dozer (D-11 or similar or larger); Hydraulic Excavators (over 4 cu. yds.); Lifting cranes (50 tons and over); Pioneering Dozer/Backhoe (initial clearing and excavation for the purpose of providing access for other equipment where the terrain worked involves 1-to-1 slopes that are 50 feet in height or depth, the scope of this work does not include normal clearing and grubbing on usual hilly terrain nor the excavation work once the access is provided); Power Blade Operator (Cat 12 or equivalent or over); Straddle Lifts (over 50 tons); Tower Crane, Mobile; Traveling Truss Cranes; Universal, Liebherr, Linden, and similar types of Tower Cranes (in the erection, dismantling, and moving of equipment there shall be an additional Operating Engineer or Heavy Duty Repairman); Yo-Yo Cat or Dozer.

GROUP 13: Truck Driver (Utility, Flatbed, etc.)

GROUP 13A: Dump Truck, 8 cu.yds. and under (water level); Water Truck (up to and including 2,000 gallons).

GROUP 13B: Water Truck (over 2,000 gallons); Tandem Dump Truck, over 8 cu. yds. (water level).

GROUP 13C: Truck Driver (Semi-trailer. Rock Cans, Semi-Dump or Roll-Offs).

GROUP 13D: Truck Driver (Slip-In or Pup).

GROUP 13E: End Dumps, Unlicensed (Euclid, Mack, Caterpillar or similar); Tractor Trailer (Hauling Equipment); Tandem Trucks hooked up to Trailer (Hauling Equipment)

BOOMS AND/OR LEADS (HOURLY PREMIUMS):

The Operator of a crane (under 50 tons) with a boom of 80 feet or more (including jib), or of a crane (under 50 tons) with leads of 100 feet or more, shall receive a per hour premium for each hour worked on said crane (under 50 tons) in accordance with the following schedule:

Booms of 80 feet up to but not including 130 feet or Leads of 100 feet up to but not including 130 feet	0.50
Booms and/or Leads of 130 feet up to but not including 180 feet	0.75
Booms and/or Leads of 180 feet up to and including 250 feet	1.15
Booms and/or Leads over 250 feet	1.50

The Operator of a crane (50 tons and over) with a boom of 180 feet or more (including jib) shall receive a per hour premium for each hour worked on said crane (50 tons and

over) in accordance with the following schedule:

Booms of 180 feet up to and including 250 feet	1.25
Booms over 250 feet	1.75

ENGI0003-004 09/01/2014

	Rates	Fringes
Dredging: (Boat Operators)		
Boat Deckhand.....	\$ 37.72	27.06
Boat Operator.....	\$ 39.93	27.06
Master Boat Operator.....	\$ 40.08	27.06
Dredging: (Clamshell or Dipper Dredging)		
GROUP 1.....	\$ 40.44	27.06
GROUP 2.....	\$ 39.78	27.06
GROUP 3.....	\$ 39.38	27.06
GROUP 4.....	\$ 37.72	27.06
Dredging: (Derricks)		
GROUP 1.....	\$ 40.44	27.06
GROUP 2.....	\$ 39.78	27.06
GROUP 3.....	\$ 39.38	27.06
GROUP 4.....	\$ 37.72	27.06
Dredging: (Hydraulic Suction Dredges)		
GROUP 1.....	\$ 40.08	27.06
GROUP 2.....	\$ 39.93	27.06
GROUP 3.....	\$ 39.78	27.06
GROUP 4.....	\$ 39.72	27.06
GROUP 5.....	\$ 37.88	26.76
Group 5.....	\$ 39.38	27.06
GROUP 6.....	\$ 37.77	26.76
Group 6.....	\$ 39.27	27.06
GROUP 7.....	\$ 36.22	26.76
Group 7.....	\$ 37.72	27.06

CLAMSHELL OR DIPPER DREDGING CLASSIFICATIONS

GROUP 1: Clamshell or Dipper Operator.
GROUP 2: Mechanic or Welder; Watch Engineer.
GROUP 3: Barge Mate; Deckmate.
GROUP 4: Bargeman; Deckhand; Fireman; Oiler.

HYDRAULIC SUCTION DREDGING CLASSIFICATIONS

GROUP 1: Leverman.
GROUP 2: Watch Engineer (steam or electric).
GROUP 3: Mechanic or Welder.
GROUP 4: Dozer Operator.
GROUP 5: Deckmate.
GROUP 6: Winchman (Stern Winch on Dredge)
GROUP 7: Deckhand (can operate anchor scow under direction of
Deckmate); Fireman; Leveeman; Oiler.

DERRICK CLASSIFICATIONS

GROUP 1: Operators (Derricks, Piledrivers and Cranes).

GROUP 2: Saurman Type Dragline (over 5 cubic yards).
 GROUP 3: Deckmate; Saurman Type Dragline (up to and including 5 yards).
 GROUP 4: Deckhand, Fireman, Oiler.

 ENGI0003-044 09/02/2013

	Rates	Fringes
Power Equipment Operators		
(PAVING)		
(10) Cold Planer.....	\$ 38.25	26.98
(10) Loader (2 1/2 cu. yds. and under).....	\$ 37.42	26.98
(10) Soil Stabilizer.....	\$ 38.25	26.98
(11) Loader (over 2 1/2 cu. yds. to and including 5 cu. yds.).....	\$ 37.74	26.98
(3) Roller Operator (five tons and under).....	\$ 36.19	26.98
(5) Screed Person.....	\$ 37.42	26.98
(6) Combination Loader/Backhoe (up to 3/4 cu.yd.).....	\$ 35.48	26.98
(6) Concrete Saws and/or Grinder (self-propelled unit on streets, highways, airports and canals).....	\$ 37.42	26.98
(6) Roller Operator (over five tons).....	\$ 37.62	26.98
(7) Combination Loader/Backhoe (over 3/4 cu.yd.).....	\$ 36.46	26.98
(8) Asphalt Plant Operator..	\$ 37.89	26.98
Asphalt Concrete Material Transfer.....	\$ 37.42	26.98
Asphalt Raker.....	\$ 36.46	26.98
Asphalt Spreader Operator...	\$ 37.94	26.98
Grader.....	\$ 38.25	26.98
Laborer, Hand Roller.....	\$ 35.96	26.98

 IRON0625-001 09/01/2014

	Rates	Fringes
Ironworkers:.....	\$ 35.75	29.01
a. Employees will be paid \$.50 per hour more while working in tunnels and coffer dams; \$1.00 per hour more when required to work under or are covered with water (submerged) and when they are required to work on the summit of Mauna Kea, Mauna Loa or Haleakala.		

 LABO0368-001 08/31/2015

	Rates	Fringes
Laborers:		
Driller.....	\$ 35.35	17.51
Final Clean Up.....	\$ 25.75	13.34

Gunite/Shotcrete Operator		
and High Scaler.....	\$ 34.85	17.51
Laborer I.....	\$ 34.35	17.51
Laborer II.....	\$ 31.75	17.51
Mason Tender/Hod Carrier....	\$ 34.85	17.51
Powderman.....	\$ 35.35	17.51
Window Washer (bosun chair).\$	33.85	17.51

LABORERS CLASSIFICATIONS

Laborer I: Air Blasting run by electric or pneumatic compressor; Asphalt Laborer, Ironer, Raker, Luteman, and Handroller, and all types of Asphalt Spreader Boxes; Asphalt Shoveler; Assembly and Installation of Multiplates, Liner Plates, Rings, Mesh, Mats; Batching Plant (portable and temporary); Boring Machine Operator (under streets and sidewalks); Buggymobile; Burning and Welding; Chainsaw, Faller, Logloader, and Bucker; Compactors (Jackson Jumping Jack and similar); Concrete Bucket Dumpman; Concrete Chipping; Concrete Chuteman/Hoseman (pouring concrete) (the handling of the chute from ready-mix trucks for such jobs as walls, slabs, decks, floors, foundations, footings, curbs, gutters, and sidewalks); Concrete Core Cutter (Walls, Floors, and Ceiling); Concrete Grinding or Sanding; Concrete: Hooking on, signaling, dumping of concrete for tremie work over water on caissons, pilings, abutments, etc.; Concrete: Mixing, handling, conveying, pouring, vibrating, otherwise placing of concrete or aggregates or by any other process; Concrete: Operation of motorized wheelbarrows or buggies or machines of similar character, whether run by gas, diesel, or electric power; Concrete Placement Machine Operator: operation of Somero Hammerhead, Copperheads, or similar machines; Concrete Pump Machine (laying, coupling, uncoupling of all connections and cleaning of equipment); Concrete and/or Asphalt Saw (Walking or Handtype) (cutting walls or flatwork) (scoring old or new concrete and/or asphalt) (cutting for expansion joints) (streets and ways for laying of pipe, cable or conduit for all purposes); Concrete Shovelers/Laborers (Wet or Dry); Concrete Screeding for Rough Strike-Off: Rodding or striking-off, by hand or mechanical means prior to finishing; Concrete Vibrator Operator; Coring Holes: Walls, footings, piers or other obstructions for passage of pipes or conduits for any purpose and the pouring of concrete to secure the hole; Cribbers, Shorer, Lagging, Sheeting, and Trench Jacking and Bracing, Hand-Guided Lagging Hammer Whaling Bracing; Curbing (Concrete and Asphalt); Curing of Concrete (impervious membrane and form oiler) mortar and other materials by any mode or method; Cut Granite Curb Setter (setting, leveling and grouting of all precast concrete or stone curbs); Cutting and Burning Torch (demolition); Dri Pak-It Machine; Environmental Abatement: removal of asbestos, lead, and bio hazardous materials (EPA and/or OSHA certified); Falling, bucking, yarding, loading or burning of all trees or timber on construction site; Forklift (9 ft. and under); Gas, Pneumatic, and Electric tools; Grating and Grill work for drains or other purposes; Green Cutter of concrete or aggregate in any form, by hand, mechanical means, grindstone or air and/or water; Grout: Spreading for any purpose; Guinea Chaser (Grade Checker)

for general utility trenches, sitework, and excavation; Headerboard Man (Asphalt or Concrete); Heat Welder of Plastic (Laborers' AGC certified workers) (when work involves waterproofing for waterponds, artificial lakes and reservoir) heat welding for sewer pipes and fusion of HDPE pipes; Heavy Highway Laborer (Rigging, signaling, handling, and installation of pre-cast catch basins, manholes, curbs and gutters); High Pressure Nozzleman - Hydraulic Monitor (over 100# pressure); Jackhammer Operator; Jacking of slip forms: All semi and unskilled work connected therewithin; Laying of all multi-cell conduit or multi-purpose pipe; Magnesite and Mastic Workers (Wet or Dry) (including mixer operator); Mortar Man; Mortar Mixer (Block, Brick, Masonry, and Plastering); Nozzleman (Sandblasting and/or Water Blasting): handling, placing and operation of nozzle; Operation, Manual or Hydraulic jacking of shields and the use of such other mechanical equipment as may be necessary; Pavement Breakers; Paving, curbing and surfacing of streets, ways, courts, under and overpasses, bridges, approaches, slope walls, and all other labor connected therewith; Pilecutters; Pipe Accessment in place, bolting and lining up of sectional metal or other pipe including corrugated pipe; Pipelayer performing all services in the laying and installation of pipe from the point of receiving pipe in the ditch until completion of operation, including any and all forms of tubular material, whether pipe, HDPE, metallic or non-metallic, conduit, and any other stationary-type of tubular device used for conveying of any substance or element, whether water, sewage, solid, gas, air, or other product whatsoever and without regard to the nature of material from which tubular material is fabricated; No-joint pipe and stripping of same, Pipewrapper, Caulker, Bander, Kettlemen, and men applying asphalt, Laykold, treating Creosote and similar-type materials (6-inch pipe and over); Piping: resurfacing and paving of all ditches in preparation for laying of all pipes; Pipe laying of lateral sewer pipe from main or side sewer to buildings or structure (except Contactor may direct work be done under proper supervision); Pipe laying, leveling and marking of the joint used for main or side sewers and storm sewers; Laying of all clay, terra cotta, ironstone, vitrified concrete, HDPE or other pipe for drainage; Placing and setting of water mains, gas mains and all pipe including removal of skids; Plaster Mortar Mixer/Pump; Pneumatic Impact Wrench; Portable Sawmill Operation: Choker setters, off bearers, and lumber handlers connected with clearing; Posthole Digger (Hand Held, Gas, Air and Electric); Powderman's Tender; Power Broom Sweepers (Small); Preparation and Compaction of roadbeds for railroad track laying, highway construction, and the preparation of trenches, footings, etc., for cross-country transmission by pipelines, electrical transmission or underground lines or cables (by mechanical means); Raising of structure by manual or hydraulic jacks or other methods and resetting of structure in new locations, including all concrete work; Ramming or compaction; Rigging in connection with Laborers' work (except demolition), Signaling (including the use of walkie talkie) Choke Setting, tag line usage; Tagging and Signaling of building materials into high rise units; Riprap, Stonepaver, and Rock Slinger

(includes placement of stacked concrete, wet or dry and loading, unloading, signaling, slinging and setting of other similar materials); Rotary Scarifier (including multiple head concrete chipping Scarifier); Salamander Heater, Drying of plaster, concrete mortar or other aggregate; Scaffold Erector Leadman; Scaffolds: (Swing and hanging) including maintenance thereof; Scaler; Septic Tank/Cesspool and Drain Fields Digger and Installer; Shredder/Chipper (tree branches, brush, etc.); Stripping and Setting Forms; Stripping of Forms: Other than panel forms which are to be re-used in their original form, and stripping of forms on all flat arch work; Tampers (Barko, Wacker, and similar type); Tank Scaler and Cleaners; Tarman; Tree Climbers and Trimmers; Trencher (includes hand-held, Davis T-66 and similar type); Trucks (flatbed up to and including 2 1/2 tons when used in connection with on-site Laborers' work; Trucks (Refuse and Garbage Disposal) (from job site to dump); Vibra-Screed (Bull Float in connection with Laborers' work); Well Points, Installation of or any other dewatering system.

Laborer II: Asphalt Plant Laborer; Boring Machine Tender; Bridge Laborer; Burning of all debris (crates, boxes, packaging waste materials); Chainman, Rodmen, and Grade Markers; Cleaning, clearing, grading and/or removal for streets, highways, roadways, aprons, runways, sidewalks, parking areas, airports, approaches, and other similar installations; Cleaning or reconditioning of streets, ways, sewers and waterlines, all maintenance work and work of an unskilled and semi-skilled nature; Concrete Bucket Tender (Groundman) hooking and unhooking of bucket; Concrete Forms; moving, cleaning, oiling and carrying to the next point of erection of all forms; Concrete Products Plant Laborers; Conveyor Tender (conveying of building materials); Crushed Stone Yards and Gravel and Sand Pit Laborers and all other similar plants; Demolition, Wrecking and Salvage Laborers: Wrecking and dismantling of buildings and all structures, with use of cutting or wrecking tools, breaking away, cleaning and removal of all fixtures, All hooking, unhooking, signaling of materials for salvage or scrap removed by crane or derrick; Digging under streets, roadways, aprons or other paved surfaces; Driller's Tender; Chuck Tender, Outside Nipper; Dry-packing of concrete (plugging and filling of she-bolt holes); Fence and/or Guardrail Erector: Dismantling and/or re-installation of all fence; Finegrader; Firewatcher; Flagman (Coning, preparing, establishing and removing portable roadway barricade devices); Signal Men on all construction work defined herein, including Traffic Control Signal Men at construction site; General Excavation; Backfilling, Grading and all other labor connected therewith; Digging of trenches, ditches and manholes and the leveling, grading and other preparation prior to laying pipe or conduit for any purpose; Excavations and foundations for buildings, piers, foundations and holes, and all other construction. Preparation of street ways and bridges; General Laborer: Cleaning and Clearing of all debris and surplus material. Clean-up of right-of-way. Clearing and slashing of brush or trees by hand or mechanical cutting. General Clean up: sweeping, cleaning, wash-down, wiping of construction

facility and equipment (other than "Light Clean up (Janitorial) Laborer. Garbage and Debris Handlers and Cleaners. Appliance Handling (job site) (after delivery unloading in storage area); Ground and Soil Treatment Work (Pest Control); Gunite/Shotcrete Operator Tender; Junk Yard Laborers (same as Salvage Yard); Laser Beam "Target Man" in connection with Laborers' work; Layout Person for Plastic (when work involves waterproofing for waterponds, artificial lakes and reservoirs); Limbers, Brush Loaders, and Pilers; Loading, Unloading, carrying, distributing and handling of all rods and material for use in reinforcing concrete construction (except when a derrick or outrigger operated by other than hand power is used); Loading, unloading, sorting, stockpiling, handling and distribution of water mains, gas mains and all pipes; Loading and unloading of all materials, fixtures, furnishings and appliances from point of delivery to stockpile to point of installation; hooking and signaling from truck, conveyance or stockpile; Material Yard Laborers; Pipelayer Tender; Pipewrapper, Caulker, Bander, Kettlemen, and men applying asphalt, Laykold, Creosote, and similar-type materials (pipe under 6 inches); Plasterer Laborer; Preparation, construction and maintenance of roadbeds and sub-grade for all paving, including excavation, dumping, and spreading of sub-grade material; Prestressed or precast concrete slabs, walls, or sections: all loading, unloading, stockpiling, hooking on of such slabs, walls or sections; Quarry Laborers; Railroad, Streetcar, and Rail Transit Maintenance and Repair; Roustabout; Rubbish Trucks in connection with Building Construction Projects (excluding clearing, grubbing, and excavating); Salvage Yard: All work connected with cutting, cleaning, storing, stockpiling or handling of materials, all cleanup, removal of debris, burning, back-filling and landscaping of the site; Sandblasting Tender (Pot Tender): Hoses and pots or markers; Scaffolds: Erection, planking and removal of all scaffolds used for support for lathers, plasters, brick layers, masons, and other construction trades crafts; Scaffolds: (Specially designed by carpenters) laborers shall tend said carpenter on erection and dismantling thereof, preparation for foundation or mudsills, maintenance; Scraping of floors; Screeds: Handling of all screeds to be reused; handling, dismantling and conveyance of screeds; Setting, leveling and securing or bracing of metal or other road forms and expansion joints; Sheet Piling/trench shoring (handling and placing of skip sheet or wood plank trench shoring); Ship Scalers; Shipwright Tender; Sign Erector (subdivision traffic, regulatory, and street-name signs); Sloper; Slurry Seal Crews (Mixer Operator, Applicator, Squeegee Man, Shuttle Man, Top Man); Snapping of wall ties and removal of tie rods; Soil Test operations of semi and unskilled labor such as filling sand bags; Stripper (Asphalt, Concrete or other Paved Surfaces); Tool Room Attendant (Job Site); Traffic Delineating Device Applicator; Underpinning, lagging, bracing, propping and shoring, loading, signaling, right-of-way clearance along the route of movement, The clearance of new site, excavation of foundation when moving a house or structure from old site to new site; Utilities employees; Water Man; Waterscape/Hardscape Laborers; Wire Mesh Pulling (all concrete pouring operations); Wrecking,

stripping, dismantling and handling concrete forms an false work.

LABO0368-002 09/01/2014

	Rates	Fringes
Landscape & Irrigation		
Laborers		
GROUP 1.....	\$ 23.20	10.11
GROUP 2.....	\$ 23.70	10.11
GROUP 3.....	\$ 19.70	10.11

LABORERS CLASSIFICATIONS

GROUP 1: Installation of non-potable permanent or temporary irrigation water systems performed for the purposes of Landscaping and Irrigation architectural horticultural work; the installation of drinking fountains and permanent or temporary irrigation systems using potable water for Landscaping and Irrigation architectural horticultural purposes only. This work includes (a) the installation of all heads, risers, valves, valve boxes, vacuum breakers (pressure and non-pressure), low voltage electrical lines and, provided such work involves electrical wiring that will carry 24 volts or less, the installation of sensors, master control panels, display boards, junction boxes, conductors, including all other components for controllers, (b) and metallic (copper, brass, galvanized, or similar) pipe, as well as PVC or other plastic pipe including all work incidental thereto, i.e., unloading, handling and distribution of all pipes fittings, tools, materials and equipment, (c) all soldering work in connection with the above whether done by torch, soldering iron, or other means; (d) tie-in to main lines, thrust blocks (both precast and poured in place), pipe hangers and supports incidental to installation of the entire irrigation system, (e) making of pressure tests, start-up testing, flushing, purging, water balancing, placing into operation all irrigation equipment, fixtures and appurtenances installed under this agreement, and (f) the fabrication, replacement, repair and servicing of landscaping and irrigation systems. Operation of hand-held gas, air, electric, or self-powered tools and equipment used in the performance of Landscape and Irrigation work in connection with architectural horticulture; Choke-setting, signaling, and rigging for equipment operators on job-site in the performance of such Landscaping and Irrigation work; Concrete work (wet or dry) performed in connection with such Landscaping and Irrigation work. This work shall also include the setting of rock, stone, or riprap in connection with such Landscape, Waterscape, Rockscape, and Irrigation work; Grubbing, pick and shovel excavation, and hand rolling or tamping in connection with the performance of such Landscaping and Irrigation work; Sprigging, handseeding, and planting of trees, shrubs, ground covers, and other plantings and the performance of all types of gardening and horticultural work relating to said planting; Operation of flat bed trucks (up to and including 2 1/2 tons).

GROUP 2. Layout of irrigation and other non-potable irrigation water systems and the layout of drinking fountains and other potable irrigation water systems in connection with such Landscaping and Irrigation work. This includes the layout of all heads, risers, valves, valve boxes, vacuum breakers, low voltage electrical lines, hydraulic and electrical controllers, and metallic (coppers, brass, galvanized, or similar) pipe, as well as PVC or other plastic pipe. This work also includes the reading and interpretation of plans and specifications in connection with the layout of Landscaping, Rockscape, Waterscape, and Irrigation work; Operation of Hydro-Mulching machines (sprayman and driver), Drillers, Trenchers (riding type, Davis T-66, and similar) and fork lifts used in connection with the performance of such Landscaping and Irrigation work; Tree climbers and chain saw tree trimmers, Sporadic operation (when used in connection with Landscaping, Rockscape, Waterscape, and Irrigation work) of Skid-Steer Loaders (Bobcat and similar), Cranes (Bantam, Grove, and similar), Hoptos, Backhoes, Loaders, Rollers, and Dozers (Case, John Deere, and similar), Water Trucks, Trucks requiring a State of Hawaii Public Utilities Commission Type 5 and/or type 7 license, sit-down type and "gang" mowers, and other self-propelled, sit-down operated machines not listed under Landscape & Irrigation Maintenance Laborer; Chemical spraying using self-propelled power spraying equipment (200 gallon capacity or more).

GROUP 3: Maintenance of trees, shrubs, ground covers, lawns and other planted areas, including the replanting of trees, shrubs, ground covers, and other plantings that did not "take" or which are damaged; provided, however, that re-planting that requires the use of equipment, machinery, or power tools shall be paid for at the rate of pay specified under Landscape and Irrigation Laborer, Group 1; Raking, mowing, trimming, and runing, including the use of "weed eaters", hedge trimmers, vacuums, blowers, and other hand-held gas, air, electric, or self-powered tools, and the operation of lawn mowers (Note: The operation of sit-down type and "gang" mowers shall be paid for at the rate of pay specified under Landscape & Irrigation Laborer, Group 2); Guywiring, staking, propping, and supporting trees; Fertilizing, Chemical spraying using spray equipment with less than 200 gallon capacity, Maintaining irrigation and sprinkler systems, including the staking, clamping, and adjustment of risers, and the adjustment and/or replacement of sprinkler heads, (Note: the cleaning and gluing of pipe and fittings shall be paid for at the rate of pay specified under Landscape & Irrigation Laborer(Group 1); Watering by hand or sprinkler system and the performance of other types of gardening, yardman, and horticultural-related work.

LAB00368-003 08/31/2015

	Rates	Fringes
Underground Laborer		

GROUP 1.....	\$ 34.95	17.51
GROUP 2.....	\$ 36.45	17.51
GROUP 3.....	\$ 36.95	17.51
GROUP 4.....	\$ 37.95	17.51
GROUP 5.....	\$ 38.30	17.51
GROUP 6.....	\$ 38.55	17.51
GROUP 7.....	\$ 39.00	17.51

GROUP 1: Watchmen; Change House Attendant.

GROUP 2: Swamper; Brakeman; Bull Gang-Muckers, Trackmen; Dumpmen (any method); Concrete Crew (includes rodding and spreading); Grout Crew; Reboundmen

GROUP 3: Chucktenders and Cabletenders; Powderman (Prime House); Vibratorman, Pavement Breakers

GROUP 4: Miners - Tunnel (including top and bottom man on shaft and raise work); Timberman, Retimberman (wood or steel or substitute materials thereof); Blasters, Drillers, Powderman (in heading); Microtunnel Laborer; Headman; Cherry Pickerman (where car is lifted); Nipper; Grout Gunmen; Grout Pumpman & Potman; Gunite, Shotcrete Gunmen & Potmen; Concrete Finisher (in tunnel); Concrete Screed Man; Bit Grinder; Steel Form Raisers & Setters; High Pressure Nozzleman; Nozzleman (on slick line); Sandblaster-Potman (combination work assignment interchangeable); Tugger

GROUP 5: Shaft Work & Raise (below actual or excavated ground level); Diamond Driller; Gunite or Shotcrete Nozzleman; Rodman; Groundman

GROUP 6: Shifter

GROUP 7: Shifter (Shaft Work & Raiser)

PAIN1791-001 07/01/2015

	Rates	Fringes
Painters:		
Brush.....	\$ 34.85	26.45
Sandblaster; Spray.....	\$ 34.85	26.45

PAIN1889-001 07/01/2015

	Rates	Fringes
Glaziers.....	\$ 34.78	27.37

PAIN1926-001 03/01/2015

	Rates	Fringes
Soft Floor Layers.....	\$ 31.15	25.75

PAIN1944-001 01/01/2015

	Rates	Fringes
--	-------	---------

Taper.....\$ 41.00 20.50

PLAS0630-001 08/31/2015

	Rates	Fringes
PLASTERER.....	\$ 37.90	25.33

PLAS0630-002 08/31/2015

	Rates	Fringes
Cement Masons:		
Cement Masons.....	\$ 37.90	25.33
Trowel Machine Operators....	\$ 38.05	25.33

PLUM0675-001 07/05/2015

	Rates	Fringes
Plumber, Pipefitter, Steamfitter & Sprinkler Fitter...	\$ 39.85	24.46

* ROOF0221-001 09/06/2015

	Rates	Fringes
Roofers (Including Built Up, Composition and Single Ply).....	\$ 38.85	17.53

SHEE0293-001 08/01/2015

	Rates	Fringes
Sheet metal worker.....	\$ 42.96	20.58

SUHI1997-002 09/15/1997

	Rates	Fringes
Drapery Installer.....	\$ 13.60	1.20
FENCE ERECTOR (Chain Link Fence).....	\$ 9.33	1.65

WELDERS - Receive rate prescribed for craft performing
operation to which welding is incidental.

Unlisted classifications needed for work not included within
the scope of the classifications listed may be added after
award only as provided in the labor standards contract clauses
(29CFR 5.5 (a) (1) (ii)).

The body of each wage determination lists the classification and wage rates that have been found to be prevailing for the cited type(s) of construction in the area covered by the wage determination. The classifications are listed in alphabetical order of "identifiers" that indicate whether the particular rate is a union rate (current union negotiated rate for local), a survey rate (weighted average rate) or a union average rate (weighted union average rate).

Union Rate Identifiers

A four letter classification abbreviation identifier enclosed in dotted lines beginning with characters other than "SU" or "UAVG" denotes that the union classification and rate were prevailing for that classification in the survey. Example: PLUM0198-005 07/01/2014. PLUM is an abbreviation identifier of the union which prevailed in the survey for this classification, which in this example would be Plumbers. 0198 indicates the local union number or district council number where applicable, i.e., Plumbers Local 0198. The next number, 005 in the example, is an internal number used in processing the wage determination. 07/01/2014 is the effective date of the most current negotiated rate, which in this example is July 1, 2014.

Union prevailing wage rates are updated to reflect all rate changes in the collective bargaining agreement (CBA) governing this classification and rate.

Survey Rate Identifiers

Classifications listed under the "SU" identifier indicate that no one rate prevailed for this classification in the survey and the published rate is derived by computing a weighted average rate based on all the rates reported in the survey for that classification. As this weighted average rate includes all rates reported in the survey, it may include both union and non-union rates. Example: SULA2012-007 5/13/2014. SU indicates the rates are survey rates based on a weighted average calculation of rates and are not majority rates. LA indicates the State of Louisiana. 2012 is the year of survey on which these classifications and rates are based. The next number, 007 in the example, is an internal number used in producing the wage determination. 5/13/2014 indicates the survey completion date for the classifications and rates under that identifier.

Survey wage rates are not updated and remain in effect until a new survey is conducted.

Union Average Rate Identifiers

Classification(s) listed under the UAVG identifier indicate that no single majority rate prevailed for those classifications; however, 100% of the data reported for the classifications was union data. EXAMPLE: UAVG-OH-0010 08/29/2014. UAVG indicates that the rate is a weighted union average rate. OH indicates the state. The next number, 0010 in the example, is an internal number used in producing the wage

determination. 08/29/2014 indicates the survey completion date for the classifications and rates under that identifier.

A UAVG rate will be updated once a year, usually in January of each year, to reflect a weighted average of the current negotiated/CBA rate of the union locals from which the rate is based.

WAGE DETERMINATION APPEALS PROCESS

1.) Has there been an initial decision in the matter? This can be:

- * an existing published wage determination
- * a survey underlying a wage determination
- * a Wage and Hour Division letter setting forth a position on a wage determination matter
- * a conformance (additional classification and rate) ruling

On survey related matters, initial contact, including requests for summaries of surveys, should be with the Wage and Hour Regional Office for the area in which the survey was conducted because those Regional Offices have responsibility for the Davis-Bacon survey program. If the response from this initial contact is not satisfactory, then the process described in 2.) and 3.) should be followed.

With regard to any other matter not yet ripe for the formal process described here, initial contact should be with the Branch of Construction Wage Determinations. Write to:

Branch of Construction Wage Determinations
Wage and Hour Division
U.S. Department of Labor
200 Constitution Avenue, N.W.
Washington, DC 20210

2.) If the answer to the question in 1.) is yes, then an interested party (those affected by the action) can request review and reconsideration from the Wage and Hour Administrator (See 29 CFR Part 1.8 and 29 CFR Part 7). Write to:

Wage and Hour Administrator
U.S. Department of Labor
200 Constitution Avenue, N.W.
Washington, DC 20210

The request should be accompanied by a full statement of the interested party's position and by any information (wage payment data, project description, area practice material, etc.) that the requestor considers relevant to the issue.

3.) If the decision of the Administrator is not favorable, an interested party may appeal directly to the Administrative Review Board (formerly the Wage Appeals Board). Write to:

Administrative Review Board
U.S. Department of Labor
200 Constitution Avenue, N.W.
Washington, DC 20210

4.) All decisions by the Administrative Review Board are final.

=====

END OF GENERAL DECISION

PROPOSAL SCHEDULE					
ITEM NO.	ITEM	APPROX. QUANTITY	UNIT	UNIT PRICE	AMOUNT
201.0100	Clearing and Grubbing	L.S.	L.S.	L.S.	\$ _____
202.0100	Removal of Existing Concrete Curb, Gutter and Sidewalk	L.S.	L.S.	L.S.	\$ _____
202.0200	Removal of Existing PCC Driveways	L.S.	L.S.	L.S.	\$ _____
202.0300	Removal of Existing Wheel Chair Ramps	L.S.	L.S.	L.S.	\$ _____
202.0400	Removal of Existing Catch Basins, Manholes, Inlets and Headwalls	L.S.	L.S.	L.S.	\$ _____
202.0500	Removal of Existing Guardrails and End Terminals	L.S.	L.S.	L.S.	\$ _____
202.0600	Removal of Existing Concrete Siphons	L.S.	L.S.	L.S.	\$ _____
202.0700	Removal of Existing Concrete Stairs and Handrails	L.S.	L.S.	L.S.	\$ _____
202.0800	Removal of Existing CRM Wall	L.S.	L.S.	L.S.	\$ _____
202.0900	Removal of Existing 18-Inch Drain Pipe	L.S.	L.S.	L.S.	\$ _____
202.1000	Removal of Existing AC Driveways	L.S.	L.S.	L.S.	\$ _____
203.0100	Roadway Excavation	4725	C.Y.	\$ _____	\$ _____
203.0200	Borrow Excavated Material	540	C.Y.	\$ _____	\$ _____
205.0100	Structural Backfill for Retaining Walls	L.S.	L.S.	\$ _____	\$ _____
205.0200	Structural Excavation for Retaining Walls	L.S.	L.S.	\$ _____	\$ _____
205.0300	Filter Material	L.S.	L.S.	\$ _____	\$ _____
206.0100	Excavation for Drainage Facilities	L.S.	L.S.	L.S.	\$ _____
209.0100	Installation, Maintenance, Monitoring, and Removal of BMP	L.S.	L.S.	L.S.	\$ _____

PROPOSAL SCHEDULE					
ITEM NO.	ITEM	APPROX. QUANTITY	UNIT	UNIT PRICE	AMOUNT
209.0200	Additional Water Pollution, Dust, and Erosion Control	F.A.	F.A.	F.A.	\$ <u>100,000.00</u>
301.0100	Hot Mix Asphalt Base Course	4010	Ton	\$ _____	\$ _____
304.0100	Aggregate Base	L.S.	L.S.	L.S.	\$ _____
305.0100	Aggregate Subbase	L.S.	L.S.	L.S.	\$ _____
401.0100	Hot Mix Asphalt Pavement, Mix No. IV	3150	Ton	\$ _____	\$ _____
415.0100	Cold Planing	L.S.	L.S.	L.S.	\$ _____
503.0100	Concrete Retaining Walls	L.S.	L.S.	L.S.	\$ _____
503.0200	Concrete Stairs	L.S.	L.S.	L.S.	\$ _____
507.0100	Steel Railing	L.S.	L.S.	L.S.	\$ _____
508.0100	Cement Rubble Masonry	L.S.	L.S.	L.S.	\$ _____
509.0100	CRM Veneer	L.S.	L.S.	L.S.	\$ _____
603.0100	24-Inch Reinforced Concrete Pipe, Class III	L.S.	L.S.	L.S.	\$ _____
603.0200	Reinforced Concrete Collar	L.S.	L.S.	L.S.	\$ _____
603.0300	Clean Existing Culverts	F.A.	F.A.	F.A.	\$ <u>10,000.00</u>

PROPOSAL SCHEDULE					
ITEM NO.	ITEM	APPROX. QUANTITY	UNIT	UNIT PRICE	AMOUNT
603.0400	Bed Course Material for Culverts	L.S.	L.S.	L.S.	\$ _____
604.0100	Type A Catch Basin, 4 Feet to 6 Feet	1	EA	\$ _____	\$ _____
604.0200	Type B Catch Basin, 3 Feet to 8 Feet	2	EA	\$ _____	\$ _____
604.0300	Type B1 Catch Basin, 3 Feet to 5 Feet	1	EA	\$ _____	\$ _____
604.0400	Type C Catch Basin, 3 Feet to 5 Feet	1	EA	\$ _____	\$ _____
604.0500	Type D Catch basin, 4 Feet to 8 Feet	2	EA	\$ _____	\$ _____
604.0600	Type D1 Catch Basin, 4 Feet to 6 Feet	1	EA	\$ _____	\$ _____
604.0700	Type D (Modified) Catch Basin, 8 Feet to 10 Feet	1	EA	\$ _____	\$ _____
604.0800	Type (1A-9P) Grated Drain Inlet, 4 Feet to 6 Feet	1	EA	\$ _____	\$ _____
604.0900	Type (2A-9P) Grated Drain Inlet, 4 Feet to 6 Feet	1	EA	\$ _____	\$ _____
606.0100	Reset Guardrail	L.S.	L.S.	L.S.	\$ _____
606.0200	Guardrail Type 3, Strong Post W-Beam with 6'-0" Steel Post	L.S.	L.S.	L.S.	\$ _____
606.0300	Guardrail Type 3, Strong Post W-Beam (Double Nested)	L.S.	L.S.	L.S.	\$ _____
606.0400	Guardrail Type 3 – Strong Post Thrie Beam with 6'-0" Steel Post	L.S.	L.S.	L.S.	\$ _____

PROPOSAL SCHEDULE					
ITEM NO.	ITEM	APPROX. QUANTITY	UNIT	UNIT PRICE	AMOUNT
606.0500	Guardrail Type 3, Strong Post Thrie Beam (Double Nested)	L.S.	L.S.	L.S.	\$ _____
606.0600	Guardrail Type 3, Transition Section Strong Post Thrie Beam	L.S.	L.S.	L.S.	\$ _____
606.0700	Guardrail Type 3, Strong Post W-Beam (Rubrail)	L.S.	L.S.	L.S.	\$ _____
606.6100	Terminal Section Type "G" Modified	L.S.	L.S.	L.S.	\$ _____
606.6200	Terminal Section Type SKT-S-TL2-2	L.S.	L.S.	L.S.	\$ _____
607.0100	4 Feet, Chain Link Fence	L.S.	L.S.	L.S.	\$ _____
613.0100	Centerline and Reference Survey Monuments	L.S.	L.S.	L.S.	\$ _____
613.0200	Adjusting Centerline and Reference Survey Monuments	2	EA	\$ _____	\$ _____
616.0100	Temporary Irrigation System	L.S.	L.S.	L.S.	\$ _____
617.0100	Imported Planting Soil	L.S.	L.S.	L.S.	\$ _____
619.0100	Loulu Palm (12' Brown Trunk Height)	L.S.	L.S.	L.S.	\$ _____
619.0200	Mauu Aki Aki Grass	L.S.	L.S.	L.S.	\$ _____
619.0300	Bermuda Grass	L.S.	L.S.	L.S.	\$ _____
619.0400	Loulu Palm (4' Brown Trunk Height)	L.S.	L.S.	L.S.	\$ _____

PROPOSAL SCHEDULE					
ITEM NO.	ITEM	APPROX. QUANTITY	UNIT	UNIT PRICE	AMOUNT
622.0100	Roadway Lighting System	L.S.	L.S.	L.S.	\$ _____
624.0100	Adjusting Fire Hydrant	L.S.	L.S.	L.S.	\$ _____
624.0200	Fire Hydrant Assembly	L.S.	L.S.	L.S.	\$ _____
624.0300	Relocating Existing 8" Waterline	L.S.	L.S.	L.S.	\$ _____
624.0400	Relocating Existing 4" Waterline	L.S.	L.S.	L.S.	\$ _____
624.0500	Relocating Existing 2 1/2" Waterline	L.S.	L.S.	L.S.	\$ _____
626.0100	Adjusting Sewer Manhole Frame and Cover	L.S.	L.S.	L.S.	\$ _____
626.0200	Adjusting Water Manhole Frame and Cover	L.S.	L.S.	L.S.	\$ _____
626.0300	Adjusting Water Standard Meter Box	L.S.	L.S.	L.S.	\$ _____
626.0400	Adjusting Water Standard Valve Box	L.S.	L.S.	L.S.	\$ _____
629.1010	4-Inch Pavement Striping (Tape, Type II or Thermoplastic Extrusion) (White)	L.S.	L.S.	L.S.	\$ _____
629.1020	8-Inch Pavement Striping (Tape, Type I or Thermoplastic Extrusion) (White)	L.S.	L.S.	L.S.	\$ _____
629.1030	12-Inch Pavement Striping (Tape, Type III or Thermoplastic Extrusion) (White)	L.S.	L.S.	L.S.	\$ _____
629.1040	2-Foot Broken Pavement Striping (Tape, Type I or Thermoplastic Extrusion) (White)	L.S.	L.S.	L.S.	\$ _____

PROPOSAL SCHEDULE					
ITEM NO.	ITEM	APPROX. QUANTITY	UNIT	UNIT PRICE	AMOUNT
629.1050	Crosswalk Marking (Tape, Type III or Thermoplastic Extrusion) (White)	L.S.	L.S.	L.S.	\$ _____
629.1060	Pavement Arrow (Tape, Type III or Thermoplastic Extrusion)	L.S.	L.S.	L.S.	\$ _____
629.1070	4-Inch Pavement Striping (Tape, Type I or Thermoplastic Extrusion) (Yellow)	L.S.	L.S.	L.S.	\$ _____
629.1080	12-Inch Pavement Striping (Tape, Type III or Thermoplastic Extrusion) (Yellow)	L.S.	L.S.	L.S.	\$ _____
629.1090	Double 4-Inch Pavement Striping (Tape, Type II or Thermoplastic Extrusion) (Yellow)	L.S.	L.S.	L.S.	\$ _____
629.1100	8-Inch Pavement Striping (Tape, Type II or Thermoplastic Extrusion) (White)	L.S.	L.S.	L.S.	\$ _____
629.2010	Type "C" Pavement Markers	L.S.	L.S.	L.S.	\$ _____
629.2020	Type "D" Pavement Markers	L.S.	L.S.	L.S.	\$ _____
629.2030	Type "F" Pavement Markers	L.S.	L.S.	L.S.	\$ _____
629.2040	Type "H" Pavement Markers	L.S.	L.S.	L.S.	\$ _____
629.2050	Type "J" Pavement Markers	L.S.	L.S.	L.S.	\$ _____
631.0100	Relocation of Existing Regulatory Sign	L.S.	L.S.	L.S.	\$ _____
631.0200	Relocation of Existing Street Name Sign	L.S.	L.S.	L.S.	\$ _____
631.0300	Regulatory Sign (10 Square Feet or Less) with Post	L.S.	L.S.	L.S.	\$ _____

PROPOSAL SCHEDULE					
ITEM NO.	ITEM	APPROX. QUANTITY	UNIT	UNIT PRICE	AMOUNT
631.0400	Regulatory Sign (10 Square Feet or Less) without Post	L.S.	L.S.	L.S.	\$ _____
631.0500	Warning Sign (10 Square Feet or Less) with Post	L.S.	L.S.	L.S.	\$ _____
631.0600	Warning Sign (10 Square Feet or Less) without Post	L.S.	L.S.	L.S.	\$ _____
631.0700	Miscellaneous Sign (10 Square Feet or Less) with Post	L.S.	L.S.	L.S.	\$ _____
631.0800	Miscellaneous Sign (10 Square Feet or Less) without Post	L.S.	L.S.	L.S.	\$ _____
631.0900	Sign Post	L.S.	L.S.	L.S.	\$ _____
632.0255	Reflector Marker (RM-2) (Bi-Dir) with Post	L.S.	L.S.	L.S.	\$ _____
632.0355	Type III Object Marker with Post	L.S.	L.S.	L.S.	\$ _____
632.0455	Reflector Marker (RM-3) with Post	L.S.	L.S.	L.S.	\$ _____
634.0100	Portland Cement Concrete Sidewalk	L.S.	L.S.	L.S.	\$ _____
638.0100	Curb, Type 2D	L.S.	L.S.	L.S.	\$ _____
638.0200	Curb and Gutter, Type 2DG	L.S.	L.S.	L.S.	\$ _____
641.0100	Hydro-Mulch Seeding	L.S.	L.S.	L.S.	\$ _____
643.0100	Maintenance of Existing Landscape Areas	F.A.	F.A.	F.A.	\$ 50,000.00

PROPOSAL SCHEDULE					
ITEM NO.	ITEM	APPROX. QUANTITY	UNIT	UNIT PRICE	AMOUNT
645.0100	Traffic Control	L.S.	L.S.	L.S.	\$ _____
645.0200	Additional Police Officers, Additional Traffic Control Devices, And Advertisement	F.A.	F.A.	F.A.	\$ <u>200,000.00</u>
648.0100	Field-Posted Drawings	L.S.	L.S.	L.S.	\$ _____
650.0100	Curb Ramp, Type B	L.S.	L.S.	L.S.	\$ _____
650.0200	Curb Ramp, Transition Ramp	L.S.	L.S.	L.S.	\$ _____
650.0300	Access Ramp	L.S.	L.S.	L.S.	\$ _____
652.0100	Archaeological Monitoring	F.A.	F.A.	F.A.	\$ <u>50,000.00</u>
695.0100	Project Educational Campaign	F.A.	F.A.	F.A.	\$ <u>75,000.00</u>
696.0100	Field Office Trailer (Not to Exceed \$32,000.00)	L.S.	L.S.	L.S.	\$ _____
696.0200	Maintenance of Trailer	F.A.	F.A.	F.A.	\$ <u>40,000.00</u>
698.0100	Training (4 Trainees)	_____	Hours	\$ 0.80	\$ _____
699.1000	Mobilization (Not to exceed 6 percent of the sum of all items excluding the bid price of this item)	L.S.	L.S.	L.S.	\$ _____
	SUM OF ALL ITEMS				\$ _____

Table 12. Subgrade R-Values and full-depth AC for non-structural rehabilitation

Road Section	R-Value	Required thickness of AC if full-depth AC is used
Station 139+25 to 142+01.40	34	12.0 inches
Station 143+00.20 to 15+01.50	42	11.5 inches
Station 16+00.10 to 23+00.50	32	12.0 inches
Station 25+50.70 to 30+75.40	25	13.0 inches

4.2.5. Pavement design

Existing pavement sections follow, along with the minimum required thickness of an AC overlay for a 10-year design life.

There is minor surface cracking on the road. Although it does not require structural rehabilitation, we recommend an overlay even in areas for which calculations indicate that no overlay is required. For these areas, we recommend 1-inch milling with a minimum 2-inch overlay.

The equivalent thickness of AC removed by cold planing should be added to the thickness in each table below as part of the overlay.

Table 13. AC Overlay design for R-Value of 34

R-Value	34
Station	139+25
MFA Core	C1
Required thickness of AC overlay for 10-year design life	None required
Existing AC	8.7 inches
Existing base	6 inches
Existing subbase	6 inches

Table 14. AC Overlay design for R-Value of 42

R-Value	42	
Station	15+01.50	145+00.20
MFA Core	C3	C2
Required thickness of AC overlay for 10-year design life	3.5 inches	None required
Existing AC	5 inches	8.0 inches
Existing base	2 inches	13.0 inches
Existing subbase	6 inches	0.0 inches

Table 15. AC Overlay design for R-Value of 32

R-Value	32
Station	19+01.60
MFA Core	C4
Required thickness of AC overlay for 10-year design life	None required
Existing AC	6 inches
Existing base	24 inches
Existing subbase	0 inches

Table 16. AC Overlay design for R-Value of 25

R-Value	25		
Station	25+50.70	28+38.00	26+00
MFA Core	C5	C7	C6
Required thickness of AC overlay for 10-year design life	4.0 inches	4.0 inches	8.0 inches
Existing AC	9 inches	8 inches	4 inches
Existing base	2 inches	5 inches	5 inches
Existing subbase	0 inches	0 inches	0 inches

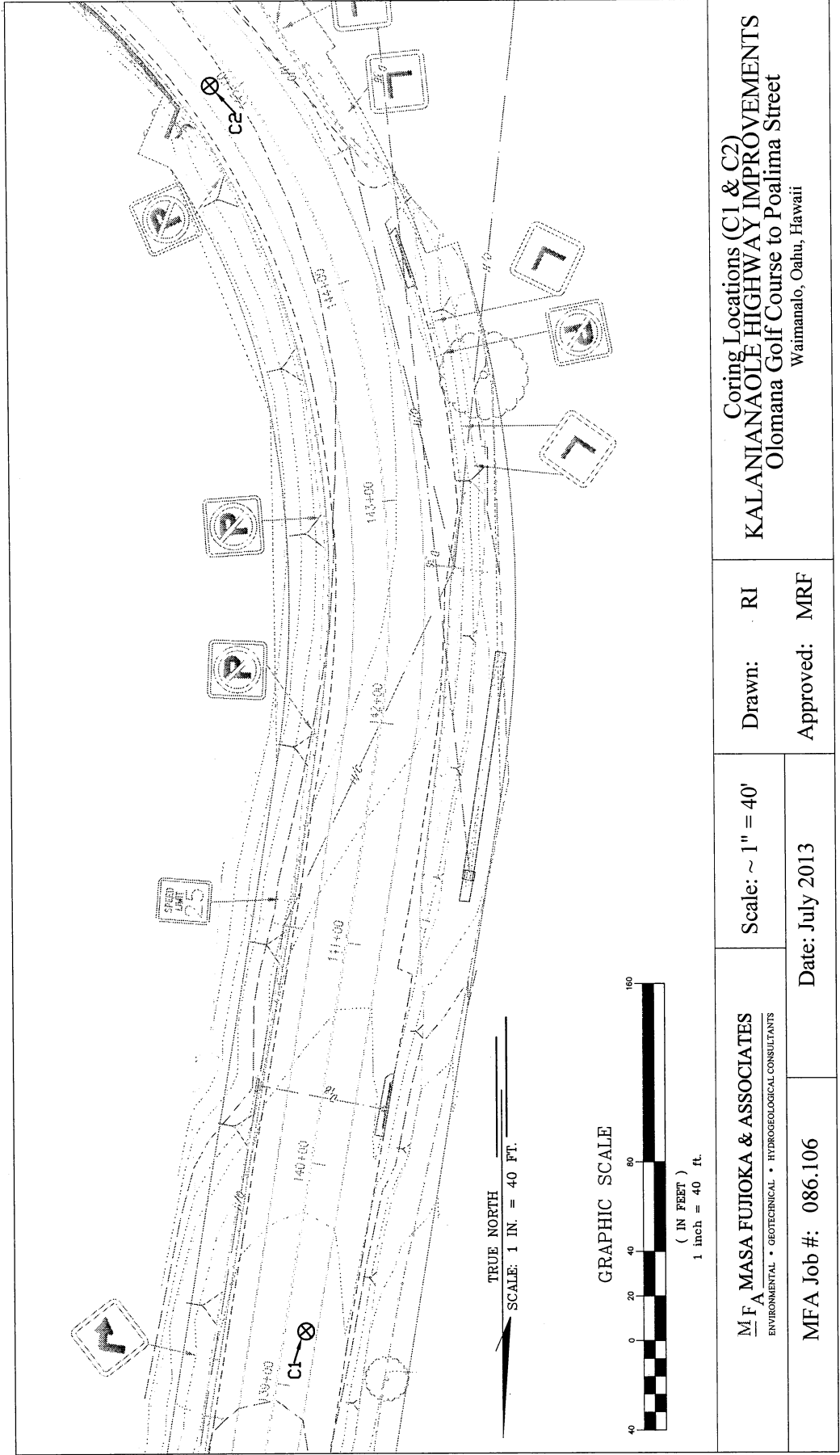

M F A MASA FUJIOKA & ASSOCIATES ENVIRONMENTAL • GEOTECHNICAL • HYDROGEOLOGICAL CONSULTANTS		Scale: ~ 1" = 40'	Drawn: RI Approved: MRF	Coring Locations (C1 & C2) KALANIANA'OLE HIGHWAY IMPROVEMENTS Olomana Golf Course to Poalima Street Waimanalo, Oahu, Hawaii
MFA Job #:	086.106	Date: July 2013		

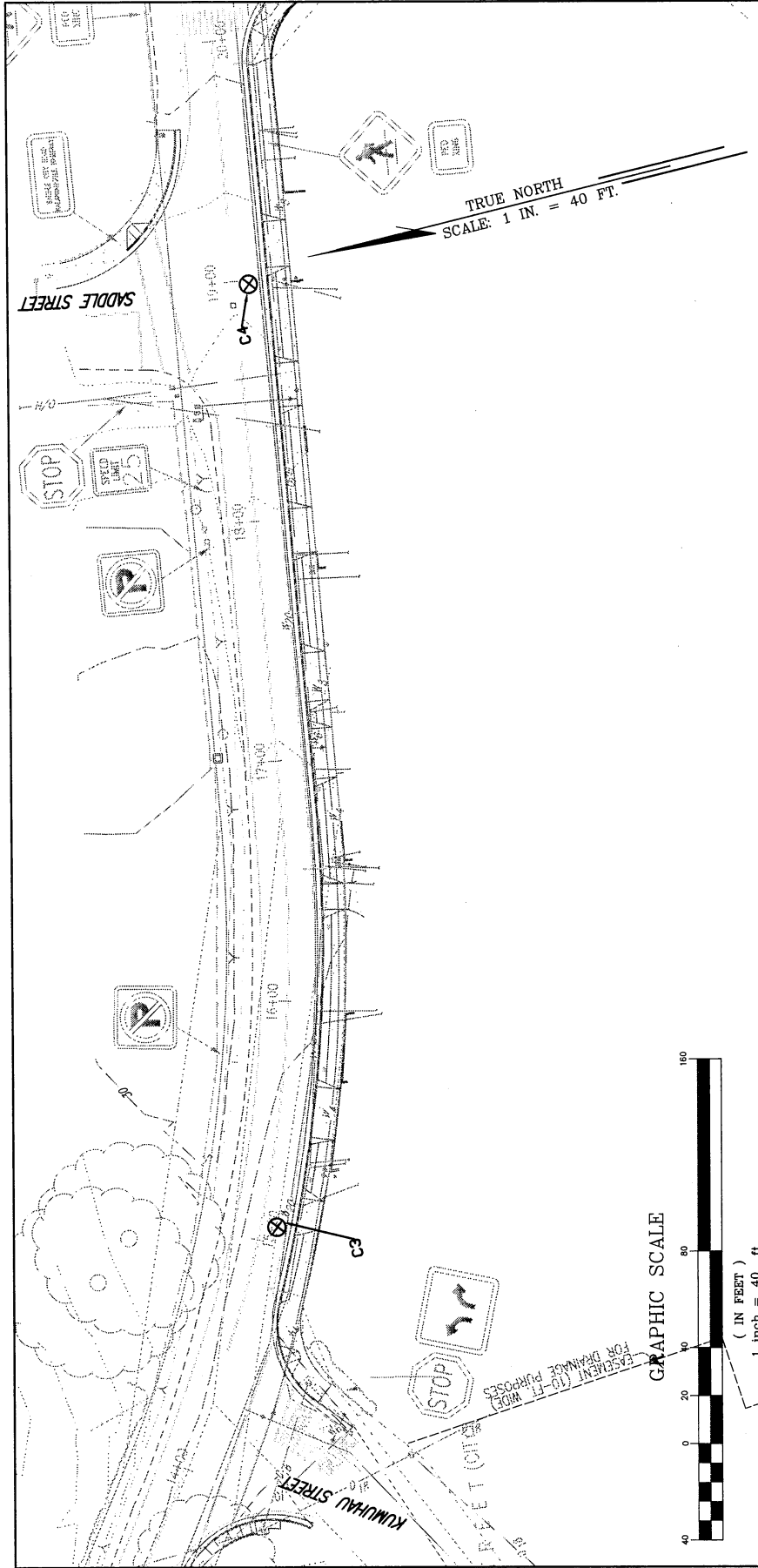

<p>M F A MASA FUJIOKA & ASSOCIATES <small>ENVIRONMENTAL • GEOTECHNICAL • HYDROGEOLOGICAL CONSULTANTS</small></p>	<p>Scale: ~ 1" = 40'</p>	<p>Drawn: RJ</p>	<p>Coring Locations (C3 & C4) KALANIANAʻOLALE HIGHWAY IMPROVEMENTS Olomana Golf Course to Poalima Street Waimanalo, Oahu, Hawaii</p>
<p>MFA Job #: 086.106</p>	<p>Date: July 2013</p>	<p>Approved: MRF</p>	

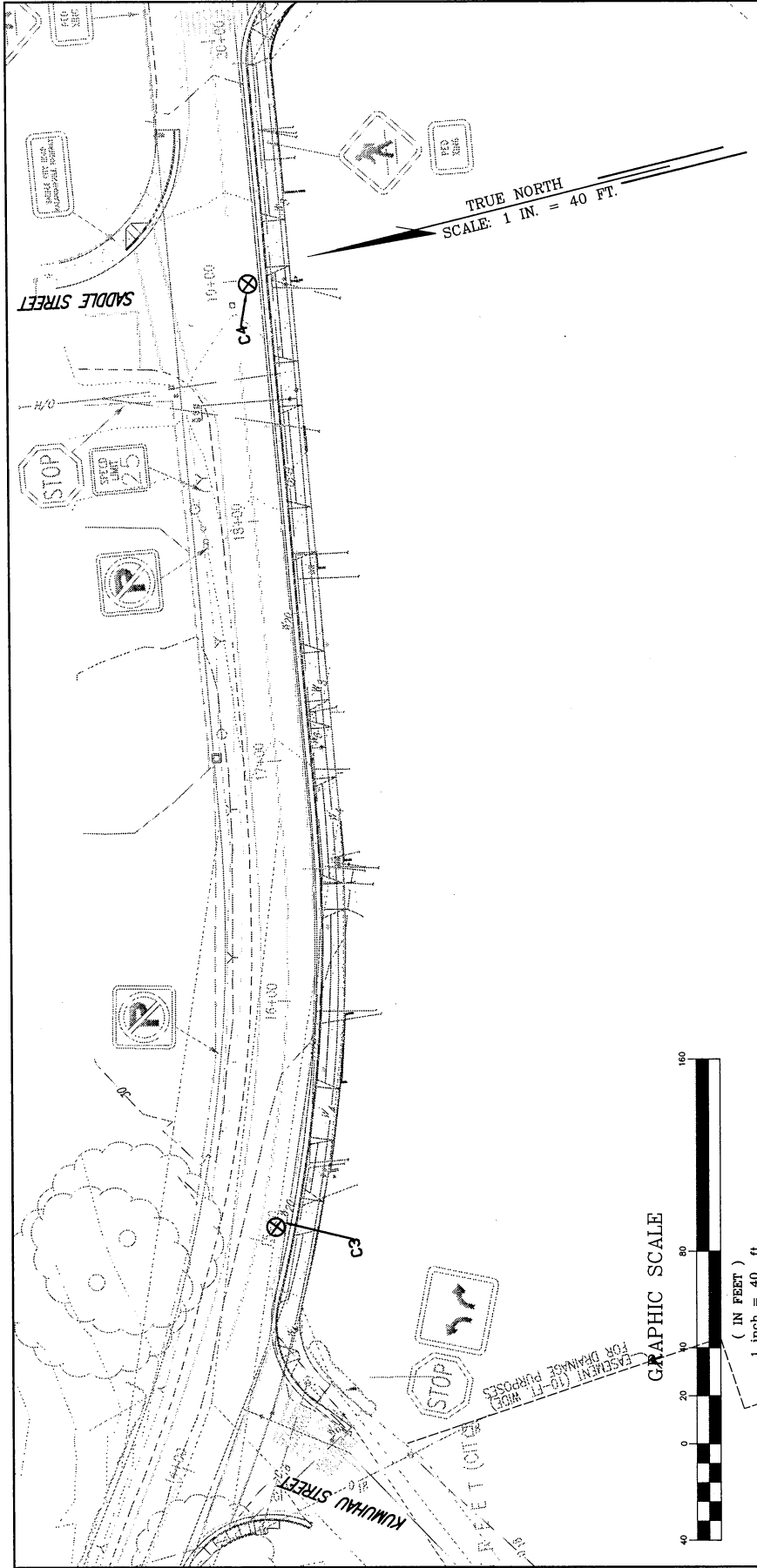

<p>Coring Locations (C3 & C4)</p> <p>KALANIANA'OLE HIGHWAY IMPROVEMENTS</p> <p>Olomana Golf Course to Poalima Street</p> <p>Waimanalo, Oahu, Hawaii</p>	<p>Drawn: RI</p> <p>Approved: MRF</p>	<p>Scale: ~ 1" = 40'</p>	<p>M F A MASA FUJIOKA & ASSOCIATES</p> <p>ENVIRONMENTAL • GEOTECHNICAL • HYDROGEOLOGICAL CONSULTANTS</p>
		<p>Date: July 2013</p>	<p>MFA Job #: 086.106</p>

PRE-BID MEETING AGENDA

Kalanianaʻole Highway Improvements Phase 1 Olomana Golf Course to Vicinity of Poalima Street Federal-Aid Project No. NH-072-1(53)

District of Koolaupoko, Island of Oahu

Date/Time: October 20, 2015; 9:00 a.m.

Location: 601 Kamokila Boulevard, Room 611, Kapolei, Hawaii

Item to discuss:

1. Anything said at this meeting is for clarification only, the bid documents shall govern over anything said today and discrepancies shall be clarified by addendum.
2. Meeting agenda, minutes and attendance will be included as part of an addendum.
3. Some items to be aware of:
 - a. Entrance/access onto the privately owned property will require execution of an Indemnification Agreement.
 - b. Construction parcel owners shall be named as additional insured on the insurance policies (Comprehensive Personal Injury and Property Damage Liability, Automobile Bodily Injury and Property Damage, and Worker's Compensation).
 - c. Contractor shall give the private property owner a 30-day written notice prior to start of construction.
4. Conditions from environmental process and permits:
 - a. NPDES Permits
 - b. Final Archeological Monitoring Report (June 2010)
 - c. Community Noise Permit
 - d. Pending Noise Variance
 - e. No night work is allowed from September 15 through December 15 due to the Newell's Shearwater nesting season.
 - f. Contractor shall be responsible to obtain all required City & County permits including but not limited to the Grading Permit.
5. Open to Questions

PRE-BID MEETING MINUTES

Kalanianaʻole Highway Improvements Phase 1 Olomana Golf Course to Vicinity of Poalima Street Federal-Aid Project No. NH-072-1(53)

District of Koolaupoko, Island of Oahu

Date/Time: October 20, 2015; 9:10 a.m.

Location: 601 Kamokila Boulevard, Room 611, Kapolei, Hawaii

Attendees:

Jason Barayuga – Jas W. Glover Ltd.
Francis Hirkami – MK Engineers
Matt Mooney – Road and Highway Builders, LLC
Qihau Wu – Delta Construction Corp.
Kevin Yamabayashi – Grace Pacific
Randy Matsumoto – Grace Pacific
Mark Kawakami – Goodfellow Brothers
R. Horiuw –DCC
Justin Choy – HDOT
Victor Valdez – SSFM
Paul Chung – SSFM
Darian Chun- Delta Construction Corp.
Robert Shin – HDOT
Marvin Luckfield – HDOT
Mel Chung – HDOT

Mel Chung briefed the following items:

1. Anything said at this meeting is for clarification only, the bid documents shall govern over anything said today and discrepancies shall be clarified by addendum.
2. Meeting agenda, minutes and attendance will be included as part of an addendum.
3. Some items to be aware of:
 - a. Entrance/access onto the privately owned property will require execution of an Indemnification Agreement. See Spec Section 107.
 - b. Construction parcel owners shall be named as additional insured on the insurance policies (Comprehensive Personal Injury and Property Damage Liability, Automobile Bodily Injury and Property Damage, and Worker's Compensation). See Spec Section 107.

- c. Contractor shall give the private property owner a 30-day written notice prior to start of construction. See Spec Section 107.
- 4. Conditions from environmental process and permits:
 - a. NPDES Permits Included in Bid Documents
 - b. Final Archeological Monitoring Report (June 2010) Included in Bid Documents
 - c. Community Noise Permit approved this week, will included as Addendum No. 2;
 - d. Pending Noise Variance approval. Please bid accordingly.
 - e. No night work is allowed from September 15 through December 15 due to the Newell's Shearwater nesting season.
 - f. All lights used at night shall be shielded.
 - g. Contractor shall be responsible to obtain all required City & County permits including but not limited to the Grading Permit.

5. Questions from prospective bidders.

Question 1: Is Archeological Monitoring included?

Response: yes, a Force Account allowance is included, Item 652.0100.

Question 2: Where is the drain that is connected to the existing siphon at Sta17+00?

Response: Based on available information, inlet could not be found, assuming drainline flow mauka to Makai, similar to other siphon crossing.

Question 3: What are Night Work hours?

Response: 8:30pm to 5:00 am (need to verify with permit).

Question 4: Roadway profile indicates raising grades in a few areas, what governs?

Response: Finish grades to govern holding the proposed pavement section.

Question 5: What is the existing pavement section over Kahawai Stream?

Response: Do not have cores/borings at that location; however, based upon the topo, existing roadway grade is approximately 16.5' and the top of culvert is approximately 13'.

Question 6: What are the lanes closures for retaining walls?

Response: See traffic control plans 54-57.

Question 7: Are detours available?

Response: A traffic management study was found that detours are not feasible and will not be allowed.

The meeting ended when the prospective bidders had no additional questions at approximately 9:30 pm.

Sign In Sheet

Subject: Pre-Bid Meeting
 Project: Kalaniana'ole Highway Improvements Phase 1
 Olomana Golf Course to Vicinity of Poalima Street
 Project No: NH-072-1(53)
 Date: 10/20/2015
 Time: 9:00 AM
 Location: 601 Kamokilo Boulevard, Room 611, Kapolei HI 96707

Name	Company	Email
Jason Barayuga	Jas. W. Glover, Ltd.	maren@gloverltd.com
Francis Hirakawa	MK ENGINEERS	francis@mkhawaii.com
Matt Mooney	Road & Highway Builders, LLC	Matthew.Mooney@stlco.com
Dihau Wu	Delta Construction Corp.	qwu@deltaconstcorp.com
Kevin Yamabayashi	Grace Pacific	kyamabayashi@gracepacific.com
Randy Matsumoto	Grace Pacific	rmatsumoto@gracepacific.com
MARK KAWAKAMI	GOODFELLOW BROS	MARKK@GOODFELLOWBROS.COM
R. Hernandez	DCC	—
J. CHOI	DOT	jchoi@s.choi@hawaii.gov
Vitor Valdez	SSFM	vvaldez@ssfm.com
PAUL M. CHUN	SSFM	patuna@ssfm.com
Davian Chun	Delta	dchun@deltaconstcorp.com
Bob J	SDOT	robert.shin@hawaii.gov
Marvin Luckfield	HDOH - HWY-20	marvin.luckfield@hawaii.gov
Mel Chung	HDOH	mungfa.chung@hawaii.gov

**REQUEST FOR INFORMATION RESPONSES
FOR
KALANIANA'OLE HIGHWAY IMPROVEMENTS PHASE 1
OLOMANA GOLF COURSE TO VICINITY OF POALIMA STREET
FEDERAL-AID PROJECT NO.: NH-072-1(53)**

The following Requests for Information were received:

1. Per sheet 22 of the plans please clarify exactly what will be required for the approval for the layout of the Modified type G Flare end Terminal. The note states "detailed drawings" then states that "the contractor shall layout the proposed Type G Modified end terminal and receive approval" what is required, both drawings and layout or can approval be given in the field with just a layout?

Response:

Type "G" Flare End Terminal Note on sheet 22 will be revised to "During construction, the Contractor shall layout the proposed Type "G" Modified End Terminal and receive approval from the Construction Engineer prior to installation".

2. Per sheet 23 of the plans. Do we have to follow these details for the SKT-TL2? The current design is different and federally approved for use. Will the State allow deviation from the plans as long as the system is federally approved? Attached is a current drawing of the SKT-TL2 for your review.

Response:

Yes, the attached current drawing of the SKT-TL2 is acceptable.

3. Per sheet 60 of the plans, please clarify the requirement for the installation of the W1-8 signs. The plan shows 2 signs mounted on a single post, yet the angle of the signs are not parallel with each other. The post is square so there is no way to mount the signs this way without the signs being parallel to each other. Will 2 posts be required in order to get the angle shown on the plans or is it acceptable to mount on a single post with the signs not at the angle as shown?

Response:

The intent is to have one post for each sign as indicated in the bubble note #1. Sign summary to be revised.

4. Per sheet 62 of the plans. How is the "Bridge" sign mounted? On the same post as the OM3?

Response:

The intent is to have the two (2) signs mounted on a single post.

5. Per sheet 64 of the plans. Please clarify how the stop sign at Kumuhau Street is to be mounted. With the added signs on the same post the total area of the signs appears to be more than 10 sf. Can we still mount on a single 2" square post? Will there be a pay item added for this sign or do we consider this under the existing pay items?

Response:

Two (2) signs to be installed on a single post.

6. Per sheet 68 of the plans, there is a note stating that Object Markers are to be installed on all trees and poles. What type of Object Markers are required? Will there be a pay item for this work? Since it cannot be determined by the plans where the state right of way is can the state provide a quantity for bidding purposes?

Response:

Twenty-three (23) utility poles (see Electrical sheets 69-81) and two (2) on trees (see Tree Disposition Plans sheets 82-89, indicated with a "C" – Trees to Remain and Protected). Tree to remain that are protected behind guardrails or beyond the curbed areas should not require markers. Sign summary to be revised.

7. Please confirm if there any paved swales within this project.

Response:

No paved swales.

8. Please provide grading plans.

Response:

No grading plans will be provided. Typical sections, roadway plan & profiles and cross sections are provided with grading information.

9. Please provide cut and fill quantities for the cross sections.

Response:

Cut and fill quantities for the cross section will be provided in Addendum 2.

10. Please provide existing a.c. thickness and core data.

Response:

Existing A.C. thickness and coring locations will be provided in Addendum 2.

11. For the areas that requires the removal of existing siphon and culvert, please clarify if there is any demolition work required under/across the roadway. Is the removal work limited to the above ground structure?

Response:

See Demolition and Erosion Control Plan – C26, Sta 8+50+/- & Sta 17+00, “demolish and remove existing siphon AND CULVERT” and “demolish and remove existing siphon and PIPE SECTION within r/w”.

12. Please provide larger cross sections, the current scales of Horizontal: 1" = 20' and Vertical: 1" = 10' is difficult to view.

Response:

Larger cross sections will not be provided; however, we will provide cut and full quantities for each cross section.

13. Please forward a copy of the geotechnical report for the referenced project.

Response:

Selected pages (Pavement Design section and Coring Locations) from the geotechnical report will be provided in Addendum 2.

14. Regarding Sheet C36, please confirm that the new catch basin at Sta. 11+45.00 should be a Type D1 catch basin.

Response:

The Type D is appropriate.

15. The proposal seems to be missing an item for the relocation of existing 6" waterline.

Response:

The 6" waterline relocation is included in the Item 624.0200 – fire Hydrant Assembly.

16. The new catch basin at Sta. 11+45.00 on Sheet 36 reference SDOT Std. Plan No. H-02D, which is a Type D1 catch basin.

The proposal schedule shows Item No. 604.0500 Type D = 1 EA and Item No. 604.0600 Type D1 = 2 EA, but the current plans callout
Sta. 11+45.00 Type D (Std. Plan H-02D), Sheet 36
Sta. 21+12.83 Type D (Std. Plan H-01D), Sheet 38
Sta. 22+96.89 Type D1 (Std. Plan H-02D), Sheet 39

Response:

Sheet 36, Plan Sta 11+45.00; O/S 18.09' Rt: Call out, revise "New CB (Type D) Per SDOT Std. Plan No. H-02D" to "New CB (Type D) Per SDOT Std. Plan No. H-01D".
Proposal schedule revised accordingly.