

FED. ROAD DIST. NO.	STATE	FED. AID PROJ. NO.	FISCAL YEAR	SHEET NO.	TOTAL SHEETS
HAWAII	HAW.	NH-072-1(50)	2007	21	24

TRAFFIC CONTROL NOTES:

1. Minimum width of traffic lane through work area is 10'.
2. Relocation and/or removal of temporary signs and posts used for traffic control shall be considered incidental to various contract items.
3. Damage to signs, temporary pavement markers, delineators, barricades and lamps caused by the public shall be repaired or replaced by the Contractor as soon as possible or as directed by the Engineer. This work shall be paid for under Item No. 645.2000 - Additional Police Officers, Additional Traffic Control Devices and Advertisements. Damage caused by the Contractor's negligence shall be repaired or replaced at the Contractor's expense.
4. Work required in the Traffic Control Plan will be paid under applicable contract items or otherwise specified herein. All other traffic control work shall be in accordance with Section 645.1000 - Traffic Control. Work required for lane closures during the working day will not be paid for but shall be considered incidental to Item No. 645.1000 - Traffic Control. Advance Construction Warning Signs as required under Section 645 of the Special Provisions shall be installed on all approaches to construction areas. This work shall be considered incidental to Item No. 645.1000 - Traffic Control.
5. The Contractor shall publish "Notice to Motorists" 1 week prior to the start of construction. Public notice shall be coordinated with the Department of Transportation, Highways Division.
6. The Contractor shall notify Lowell Tom (848-4578) at Oahu Transit Authority (The Bus) 4 weeks prior to start of construction.
7. The Permittee shall make minor adjustments of intersections to fit field conditions.
8. Traffic control devices shall be installed such that the sign or device farthest from the work area shall be placed first. The others shall then be placed progressively toward the work area.
9. Regulatory and warning signs within the construction zone that are in conflict with the Traffic Control Plans shall be removed or covered. All signs shall be restored upon completion of the work.
10. All construction warning signs shall be promptly removed or covered whenever the message is not applicable or not in use.
11. The backs of all signs used for traffic control shall be appropriately covered to preclude the display of inapplicable sign messages (i.e., when signs have messages on both faces).
12. Lane closure shall be limited only to the extent of accomplishing each day's work. As soon as each day's work is completed, the Permittee shall remove all traffic control devices no longer needed to permit free and safe passage of public traffic. Removal shall be in the reverse order of installation. Existing faded or obliterated pavement markings that are necessary for safe traffic flow in the construction area shall be replaced with temporary or permanent markings before opening the roadway to public traffic each day.
13. Replace permanent pavement markings and traffic signs upon completion of each phase of work.
14. Buffer and taper areas on approach to any work area shall be kept clear of vehicles and equipment.
15. "No Parking" signs shall be posted within any work area and for the buffer and taper areas approaching the work area.

LEGEND

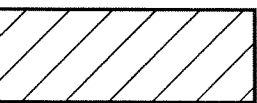

Work Area

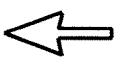

Detour Traffic Direction



Sign

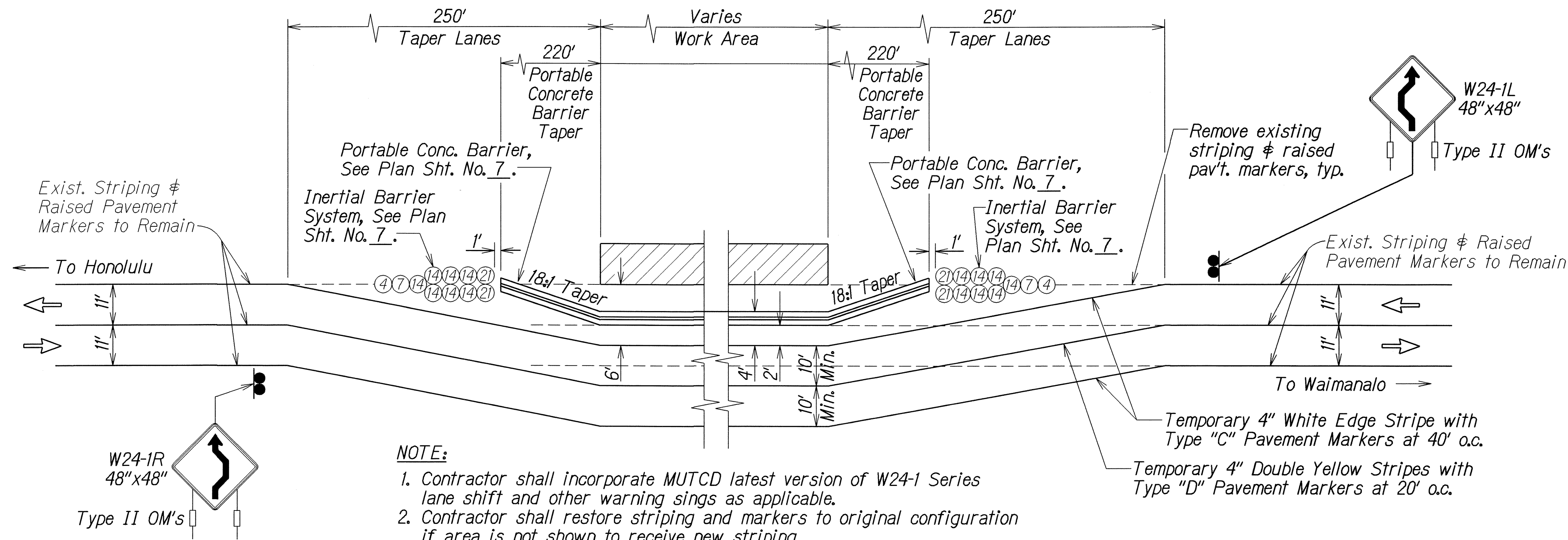

TEMPORARY STRIPING PLAN - LANE SHIFT ON 2 LANE ROAD

Not to Scale

DESIGNED BY	DATE
DRAWN BY	3/30/06
NOTED BY	
QUANTITIES BY	
CHECKED BY	

STATE OF HAWAII
DEPARTMENT OF TRANSPORTATION
HIGHWAYS DIVISION

TRAFFIC CONTROL PLAN

KALANIANA'OLE HIGHWAY
Intersection Improvements
at Hanauma Bay Road
Fed. Aid Project No. NH-072-1(50)

Scale: As Shown Date: July 2006

SHEET No. 1 OF 1 SHEETS