

FED. ROAD DIST. NO.	STATE	FED. AID PROJ. NO.	FISCAL YEAR	SHEET NO.	TOTAL SHEETS
HAWAII	HAW.	F-072-1(28)	1984	18	34

LEGEND

- - □ TYPE A 4 EACH
- - □ TYPE A & C MARKERS
- TYPE C
- ← Direction of Traffic 4" YELLOW STRIPE (PAINT) w/ TYPE H MARKERS @ 40' O.C.
- 4" WHITE EDGE STRIPE
- DOUBLE 4" YELLOW STRIPE (TAPE) WITH TYPE D MARKERS @ 20' O.C.
- - - 4" GUIDE LINES (TAPE) WHITE OR YELLOW AS NOTED.
- 12" YELLOW STRIPE (PAINT)
- TYPE D TRANSVERSE MEDIAN MARKING
- TYPE H
- 4" YELLOW STRIPE (PAINT)

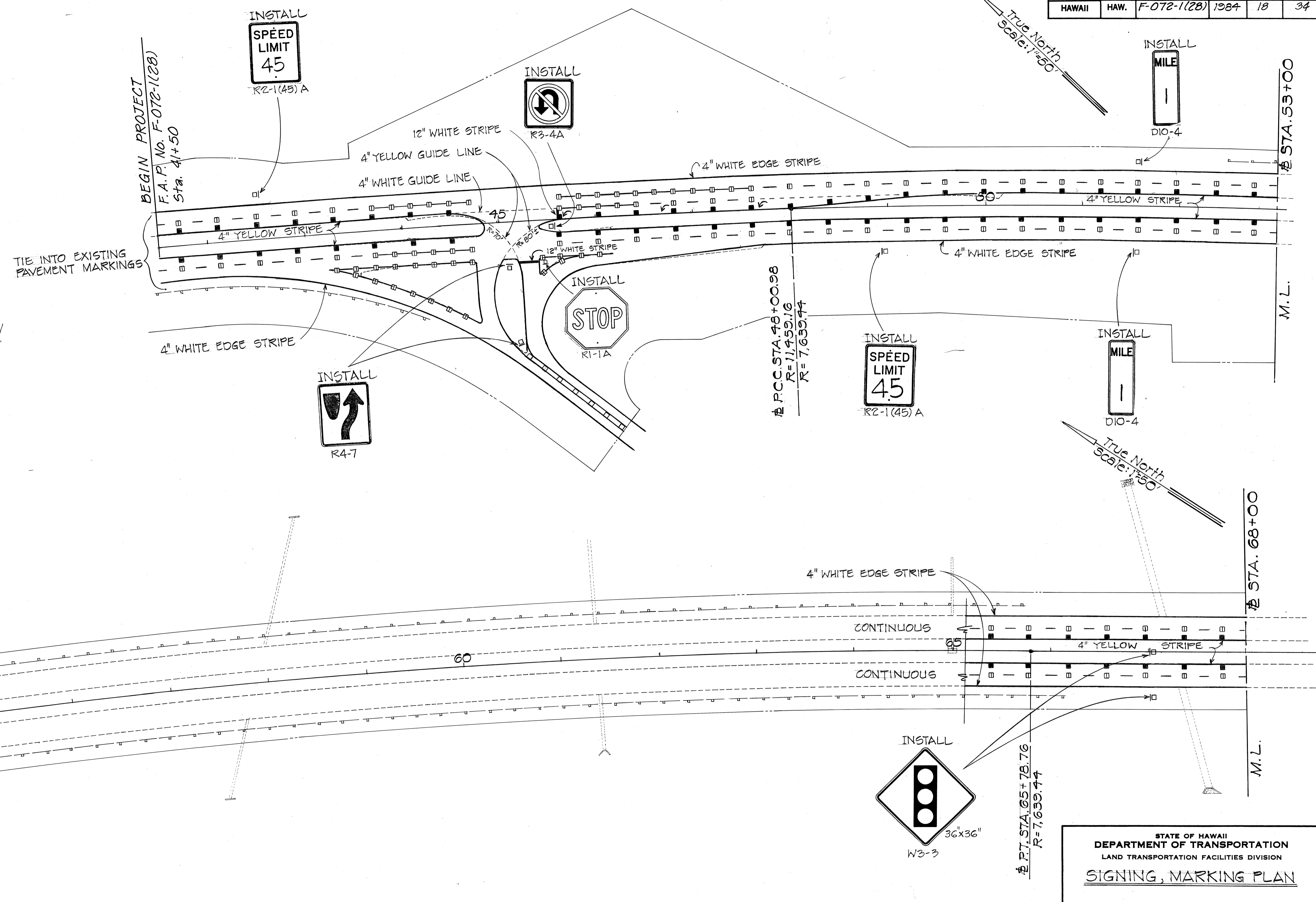

SURVEY PLOTTED BY	DATE
DESIGNED BY	
TRACED BY	
NOTE BOOK	
QUANTITIES BY	
CHECKED BY	
No.	

STATE OF HAWAII
DEPARTMENT OF TRANSPORTATION
LAND TRANSPORTATION FACILITIES DIVISION
SIGNING, MARKING PLAN
KALANIANA'OLE HIGHWAY RESURFACING
C & C Corporation Yard
Towards Waimanalo
F.A. PROJECT No. F-072-1(28)
SCALE: 1" = 50' DATE: MAY, 1984
SHEET No. 1 OF 4 SHEETS

FED. ROAD DIST. NO.	STATE	FED. AID PROJ. NO.	FISCAL YEAR	SHEET NO.	TOTAL SHEETS
HAWAII	HAW.	F-072-1(28)	1984	19	34

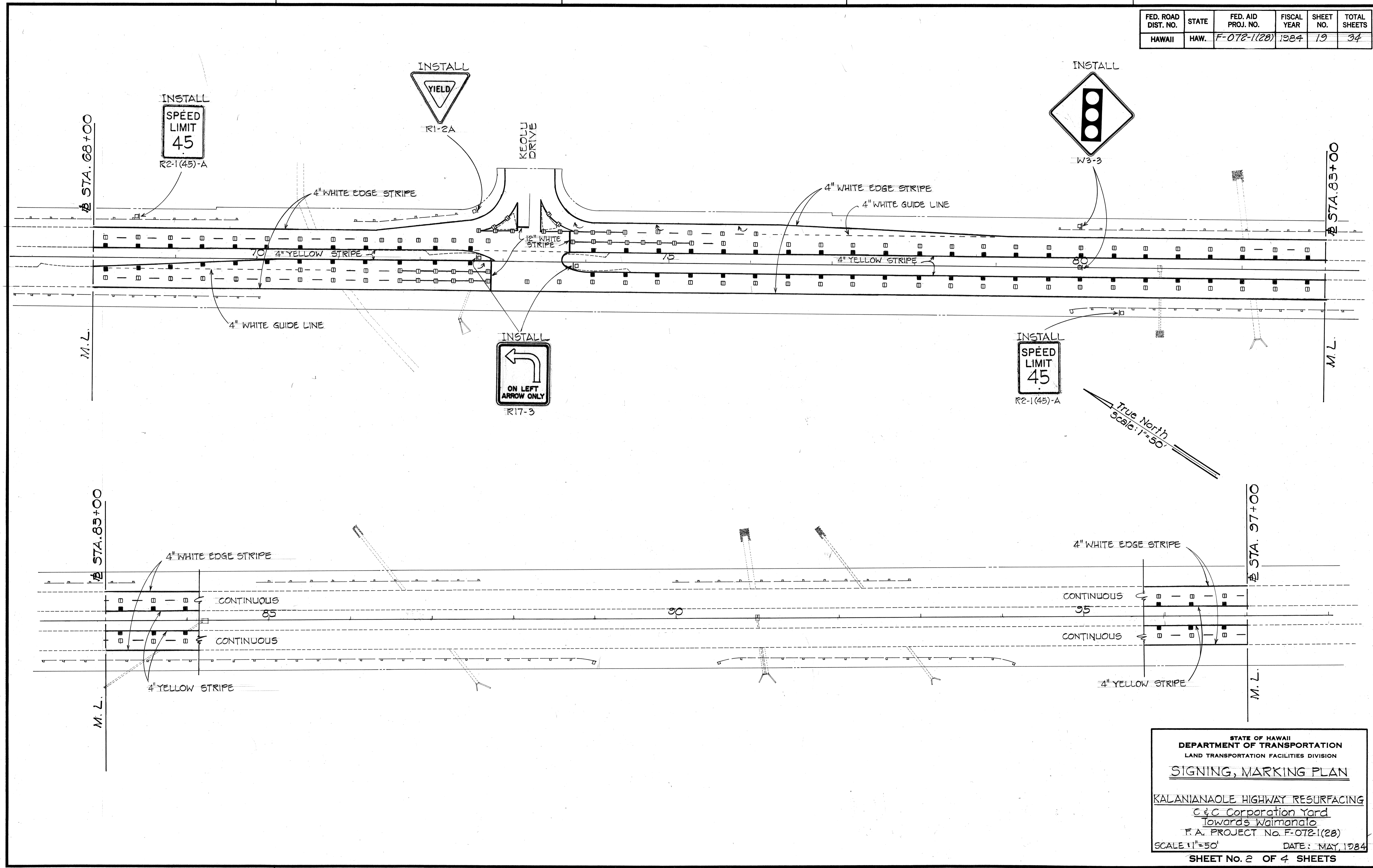

DATE	_____
DESIGNED BY	_____
TRACED BY	_____
DESIGNED BY	_____
QUANTITIES BY	_____
CHECKED BY	_____
NO.	_____

STATE OF HAWAII
DEPARTMENT OF TRANSPORTATION
LAND TRANSPORTATION FACILITIES DIVISION
SIGNING, MARKING PLAN
KALANIANA'OLE HIGHWAY RESURFACING
C & C Corporation Yard
Towards Waimanalo
F.A. PROJECT No. F-072-1(28)
SCALE: 1"=50' DATE: MAY, 1984
SHEET No. 2 OF 4 SHEETS

FED. ROAD DIST. NO.	STATE	FED. AID PROJ. NO.	FISCAL YEAR	SHEET NO.	TOTAL SHEETS
HAWAII	HAW.	F-072-1(28)	1984	20	34

True North
Scale: 1"=50'

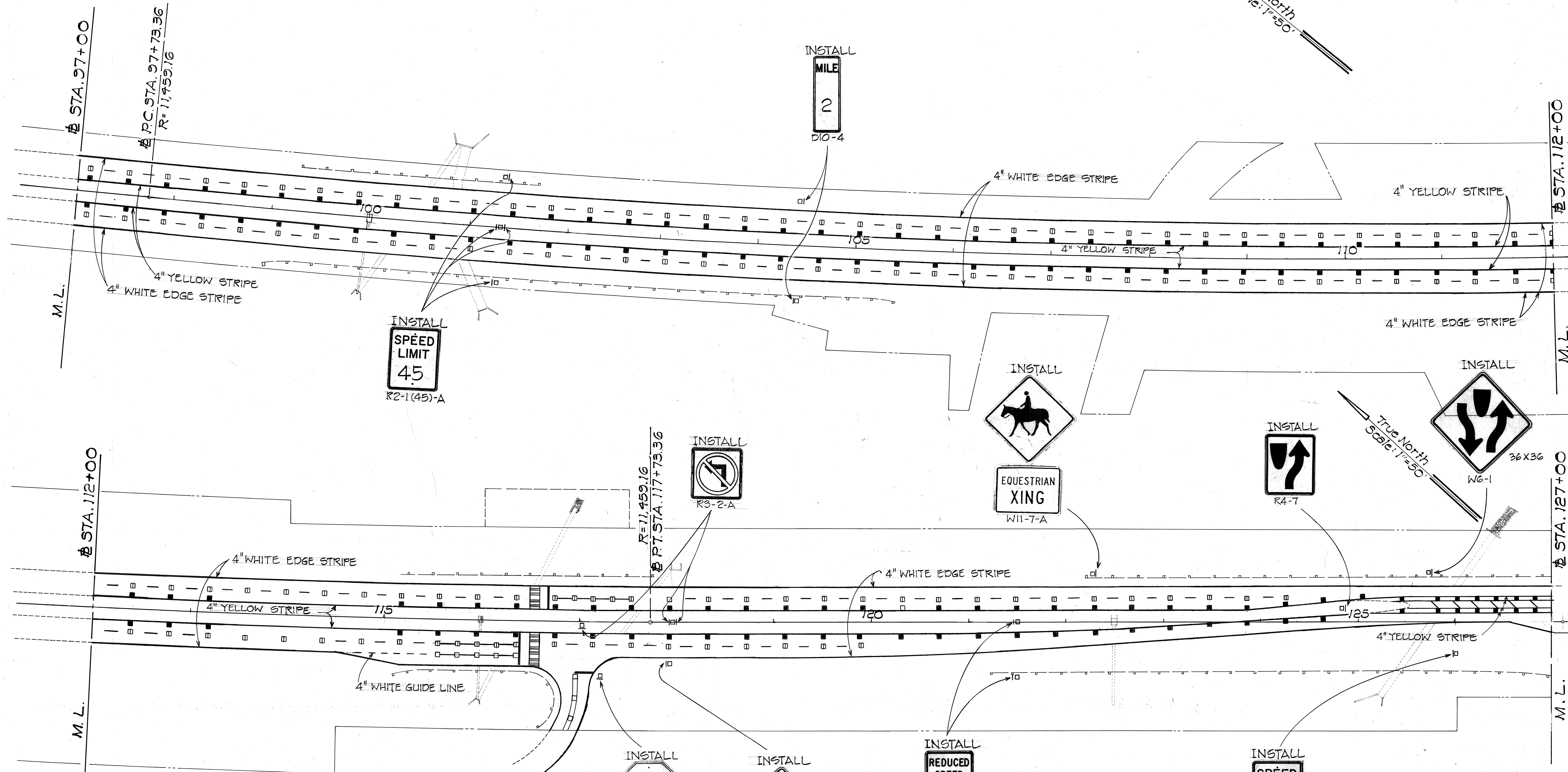

DATE	_____
SURVEY ELICITED BY	_____
DRAWN BY	_____
TRACED BY	_____
DESIGNED BY	_____
QUANTITIES BY	_____
CHECKED BY	_____
ORIGINAL PLAN	_____
NOTE BOOK	_____
No.	_____

STATE OF HAWAII
DEPARTMENT OF TRANSPORTATION
LAND TRANSPORTATION FACILITIES DIVISION
SIGNING, MARKING PLAN
KALANIANA'OLE HIGHWAY RESURFACING
C & C Corporation Yard
Towards Waimanalo
F.A. PROJECT No F-072-1(28)
SCALE: 1"=50' DATE: MAY, 1984
SHEET No. 3 OF 4 SHEETS

FED. ROAD DIST. NO.	STATE	FED. AID PROJ. NO.	FISCAL YEAR	SHEET NO.	TOTAL SHEETS
HAWAII	HAW.	F-072-1(28)	1984	21	34

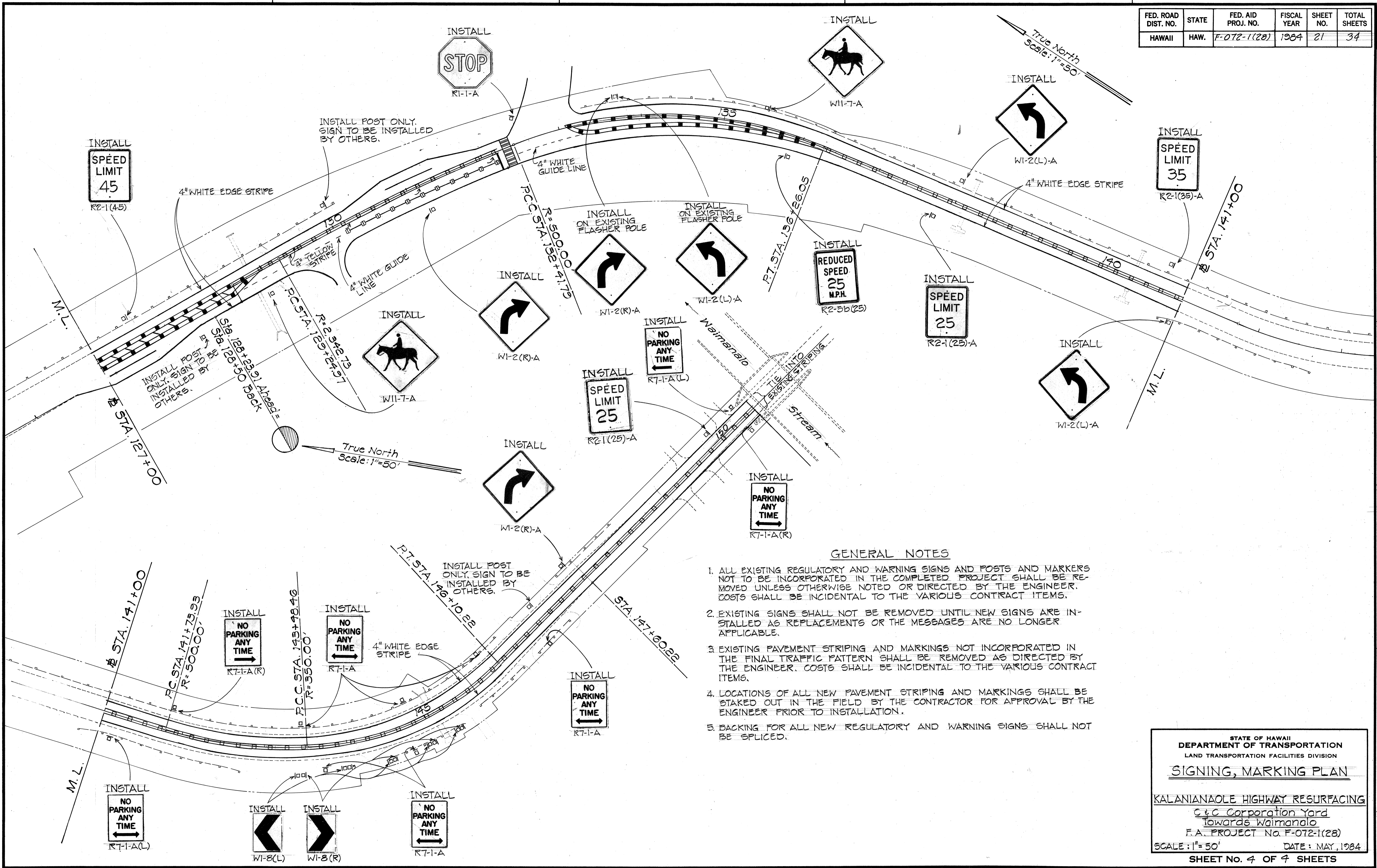

GENERAL NOTES

1. ALL EXISTING REGULATORY AND WARNING SIGNS AND POSTS AND MARKERS NOT TO BE INCORPORATED IN THE COMPLETED PROJECT SHALL BE REMOVED UNLESS OTHERWISE NOTED OR DIRECTED BY THE ENGINEER. COSTS SHALL BE INCIDENTAL TO THE VARIOUS CONTRACT ITEMS.
2. EXISTING SIGNS SHALL NOT BE REMOVED UNTIL NEW SIGNS ARE INSTALLED AS REPLACEMENTS OR THE MESSAGES ARE NO LONGER APPLICABLE.
3. EXISTING PAVEMENT STRIPING AND MARKINGS NOT INCORPORATED IN THE FINAL TRAFFIC PATTERN SHALL BE REMOVED AS DIRECTED BY THE ENGINEER. COSTS SHALL BE INCIDENTAL TO THE VARIOUS CONTRACT ITEMS.
4. LOCATIONS OF ALL NEW PAVEMENT STRIPING AND MARKINGS SHALL BE STAKED OUT IN THE FIELD BY THE CONTRACTOR FOR APPROVAL BY THE ENGINEER PRIOR TO INSTALLATION.
5. BACKING FOR ALL NEW REGULATORY AND WARNING SIGNS SHALL NOT BE SPLICED.

ORIGINAL PLAN	DATE
SURVEY PLOTTED BY	
DRAWN BY	
DESIGNED BY	
CHECKED BY	
NO.	

STATE OF HAWAII
DEPARTMENT OF TRANSPORTATION
LAND TRANSPORTATION FACILITIES DIVISION

SIGNING, MARKING PLAN

KALANIANA'OLE HIGHWAY RESURFACING
C & C Corporation Yard
Towards Waimanalo
F.A. PROJECT No. F-072-1(28)

SCALE: 1"=50' DATE: MAY, 1984

SHEET No. 4 OF 4 SHEETS