

FED. ROAD DIST. NO.	STATE	FED. AID PROJ. NO.	FISCAL YEAR	SHEET NO.	TOTAL SHEETS
HAWAII	HAW.	5-0630(10) 5-0630(7)	1970	16	153

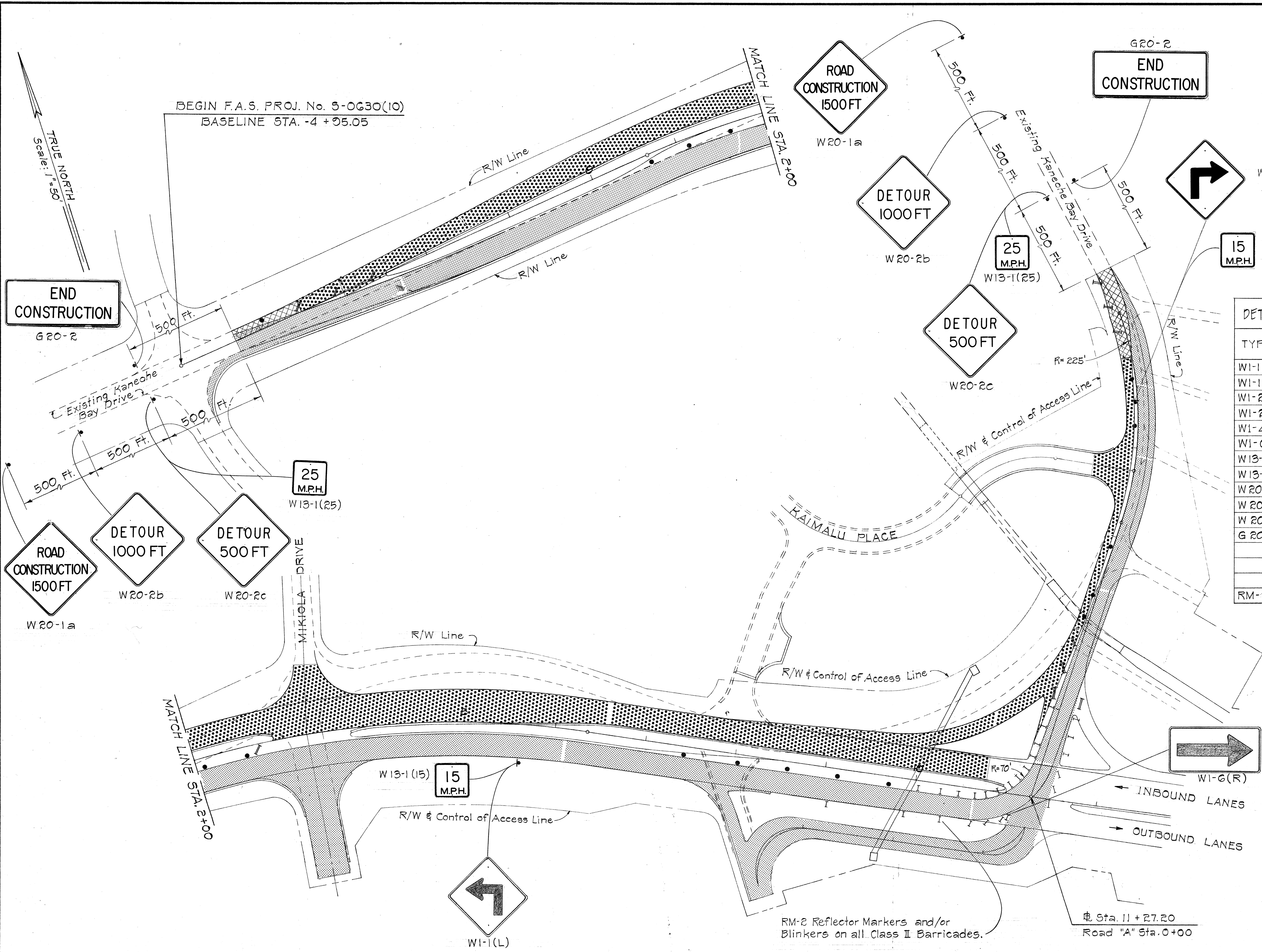

DETOUR ROAD TRAFFIC SIGN SUMMARY			
TYPE	DESCRIPTION	QUANTITY	
		W/ POST	W/O POST
W1-1 (R)		1	
W1-1 (L)		1	
W1-2 (R)		1	
W1-2 (L)		1	
W1-4 (R)		1	
W1-6 (R)			1
W13-1 (25)	25 M.P.H.		4
W13-1 (15)	15 M.P.H.		2
W20-1a	Road Construction 1500 Ft.	2	
W20-1b	Detour 1000 Ft.	2	
W20-1c	Detour 500 Ft.	2	
G 20-2	End Construction	2	
	50-Gallon Steel Drum		10
	Class I Barricade		12
	Class II Barricade		26
RM-2	Reflector Markers (on Class II Barricades)		26

- LEGEND:
- Detour, Phase 2.
 - Construct new pavement, Phase 2.
 - Resurface as needed for smooth connection.

STATE OF HAWAII
DEPARTMENT OF TRANSPORTATION
HIGHWAYS DIVISION

DETOUR PLAN
MOKAPU SADDLE ROAD
F.A.S. PROJ. No. 5-0630(10)
F.A.S. PROJ. No. 5-0630(7)
Scale: As Shown Date: Nov. 1968
SHEET No. 2 OF 2 SHEETS

DATE	
SURVEY PLANNED BY	
DRAWN BY	
DESIGNED BY	
QUANTITIES BY	
CHECKED BY	
ORIGINAL PLAN	
NOTE BOOK	
No.	