

FED. ROAD DIST. NO.	STATE	FED. AID PROJ. NO.	FISCAL YEAR	SHEET NO.	TOTAL SHEETS
HAWAII	HAW.	NH-063-1(023)	2015	76	111

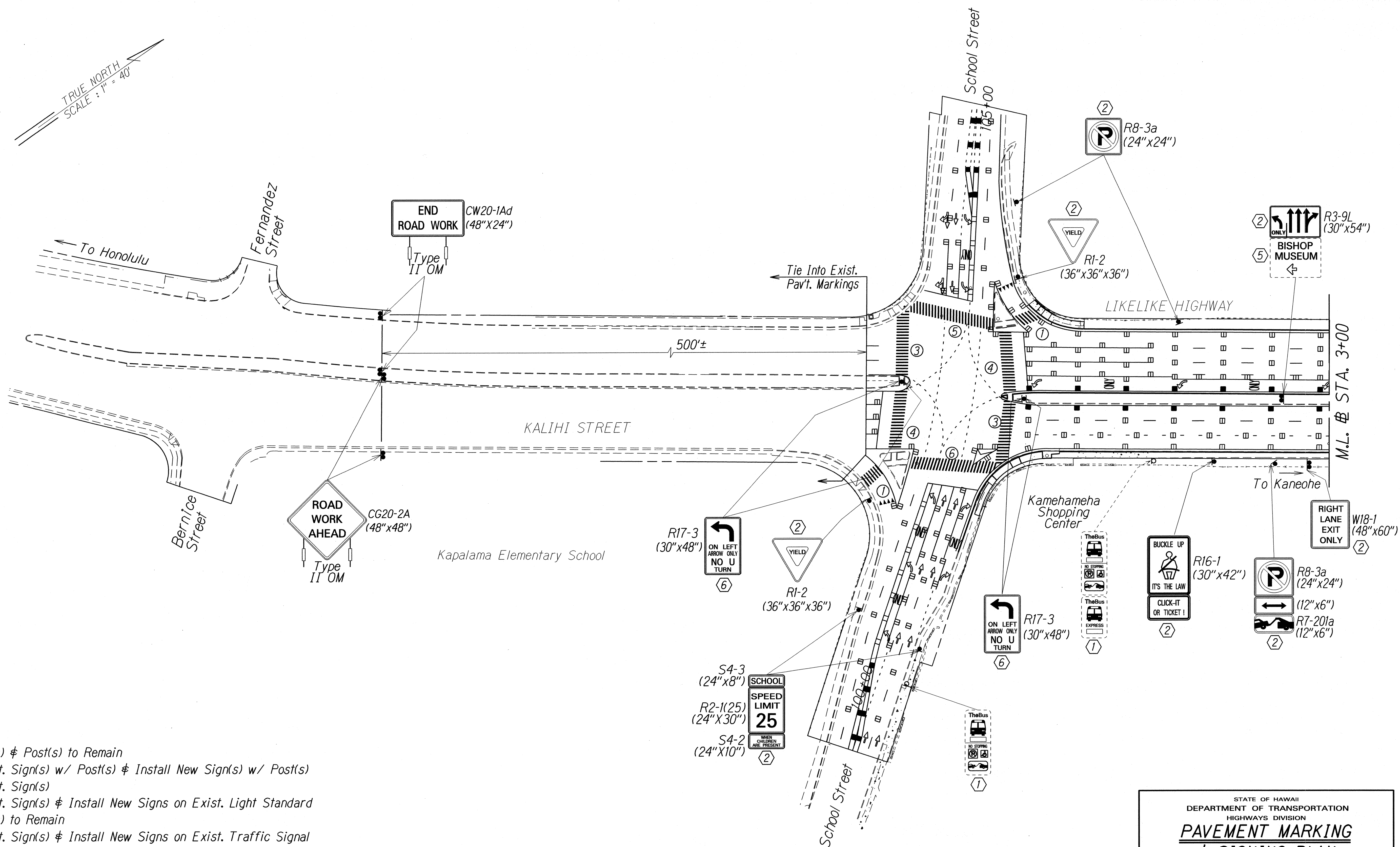

KEY:

- ① Exist. Sign(s) & Post(s) to Remain
- ② Remove Exist. Sign(s) w/ Post(s) & Install New Sign(s) w/ Post(s)
- ③ Remove Exist. Sign(s)
- ④ Remove Exist. Sign(s) & Install New Signs on Exist. Light Standard
- ⑤ Exist. Sign(s) to Remain
- ⑥ Remove Exist. Sign(s) & Install New Signs on Exist. Traffic Signal
- ⑦ Remove Exist. Sign(s) & Install New Sign(s)
- ⑧ Install New Sign(s) w/ Post(s)
- ⑨ Remove Exist. Sign(s) w/ Post(s)
- ⑩ Remove Exist. Sign(s) on Traffic Signal & Install New Sign(s) w/ Post(s)

* Fluorescent Yellow-Green Sign Sheeting

SURVEY PLOTTED BY	DATE
DESIGNED BY	
TRACED BY	
NOTE BOOK	
DESIGNED BY	
QUANTITIES BY	
CHECKED BY	
N.	

STATE OF HAWAII
DEPARTMENT OF TRANSPORTATION
HIGHWAYS DIVISION

**PAVEMENT MARKING
& SIGNING PLAN**

*LIKELIKE HIGHWAY RESURFACING
School Street to Emmeline Place
Federal Aid Project No. NH-063-1(023)*

Scale: 1" = 40' Date: October 2014

FED. ROAD DIST. NO.	STATE	FED. AID PROJ. NO.	FISCAL YEAR	SHEET NO.	TOTAL SHEETS
HAWAII	HAW.	NH-063-K023	2015	77	111

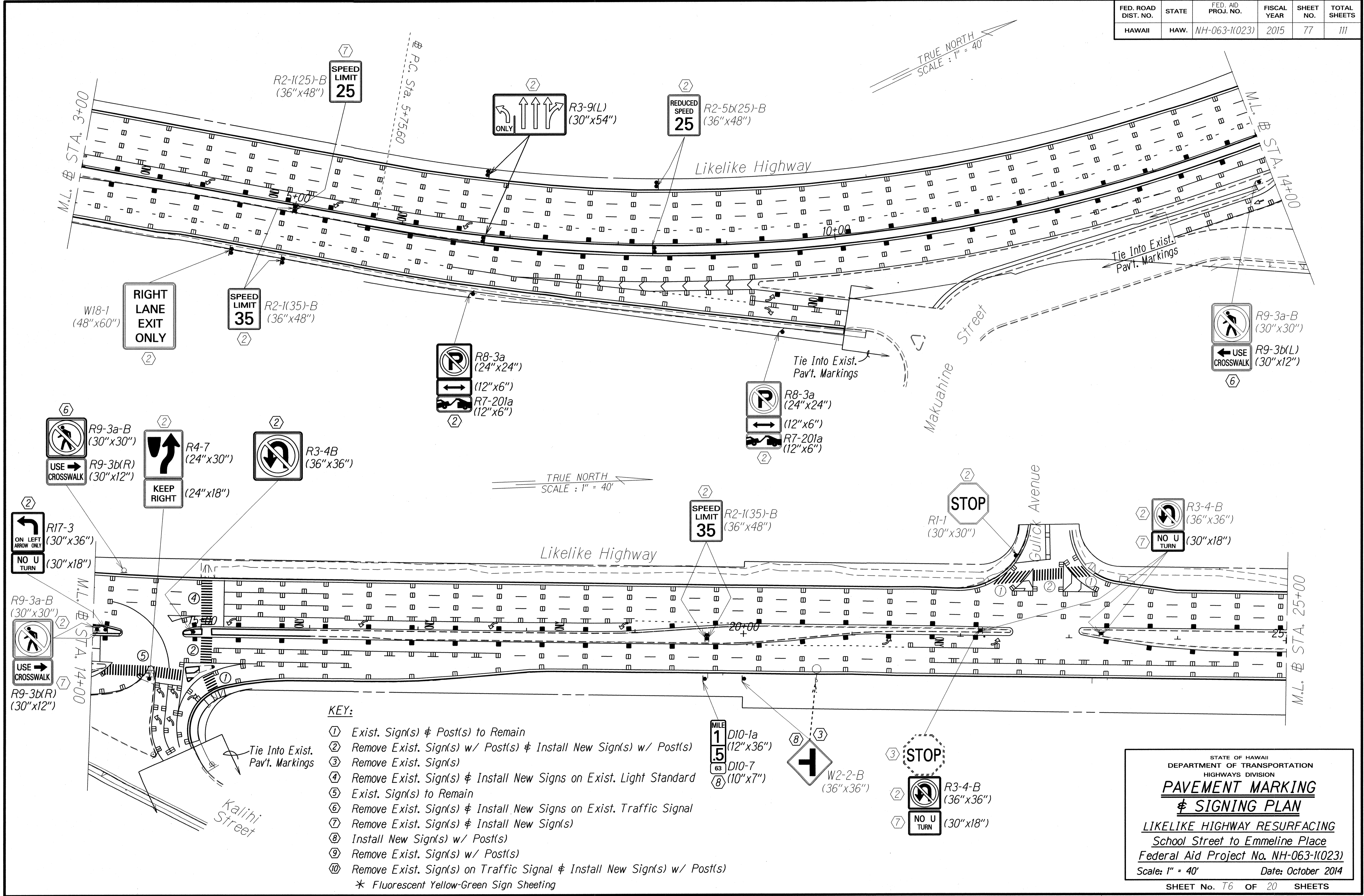

- KEY:**
- ① Exist. Sign(s) & Post(s) to Remain
 - ② Remove Exist. Sign(s) w/ Post(s) & Install New Sign(s) w/ Post(s)
 - ③ Remove Exist. Sign(s)
 - ④ Remove Exist. Sign(s) & Install New Signs on Exist. Light Standard
 - ⑤ Exist. Sign(s) to Remain
 - ⑥ Remove Exist. Sign(s) & Install New Signs on Exist. Traffic Signal
 - ⑦ Remove Exist. Sign(s) & Install New Sign(s)
 - ⑧ Install New Sign(s) w/ Post(s)
 - ⑨ Remove Exist. Sign(s) w/ Post(s)
 - ⑩ Remove Exist. Sign(s) on Traffic Signal & Install New Sign(s) w/ Post(s)
- * Fluorescent Yellow-Green Sign Sheeting

DATE	_____
SURVEY PLOTTED BY	_____
DESIGNED BY	_____
TRACED BY	_____
NOTE BOOK	_____
DESIGNED BY	_____
QUANTITIES BY	_____
CHECKED BY	_____
DATE	_____
ORIGINAL PLAN	_____
NOTE BOOK	_____
DESIGNED BY	_____
QUANTITIES BY	_____
CHECKED BY	_____

STATE OF HAWAII
DEPARTMENT OF TRANSPORTATION
HIGHWAYS DIVISION

**PAVEMENT MARKING
& SIGNING PLAN**

*LIKELIKE HIGHWAY RESURFACING
School Street to Emmeline Place
Federal Aid Project No. NH-063-K023
Scale: 1" = 40' Date: October 2014*

SHEET No. T6 OF 20 SHEETS

FED. ROAD DIST. NO.	STATE	FED. AID PROJ. NO.	FISCAL YEAR	SHEET NO.	TOTAL SHEETS
HAWAII	HAW.	NH-063-1(023)	2015	78	111

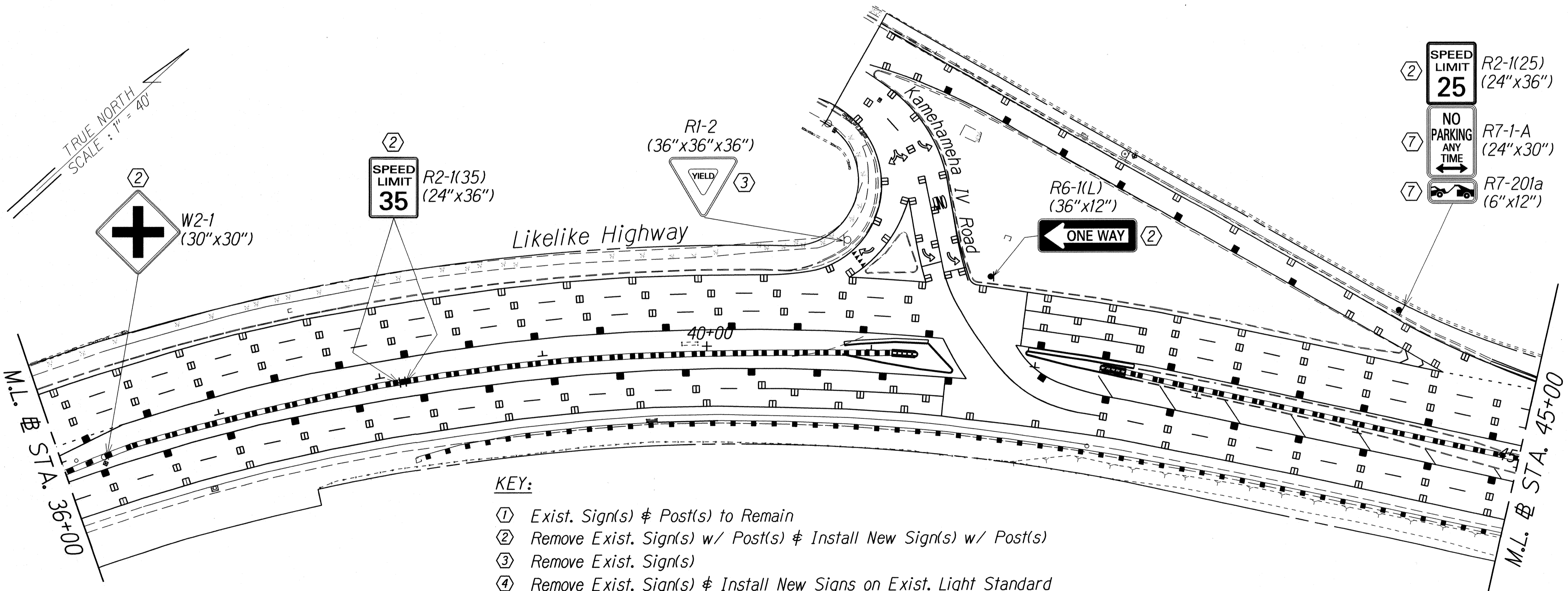
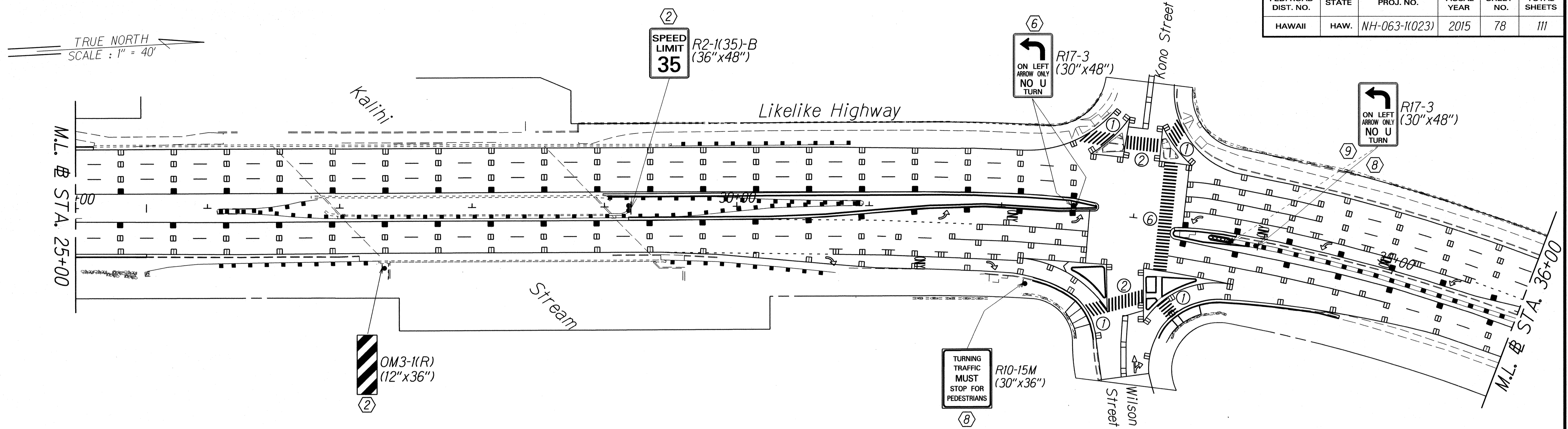

KEY:

- ① Exist. Sign(s) & Post(s) to Remain
- ② Remove Exist. Sign(s) w/ Post(s) & Install New Sign(s) w/ Post(s)
- ③ Remove Exist. Sign(s)
- ④ Remove Exist. Sign(s) & Install New Signs on Exist. Light Standard
- ⑤ Exist. Sign(s) to Remain
- ⑥ Remove Exist. Sign(s) & Install New Signs on Exist. Traffic Signal
- ⑦ Remove Exist. Sign(s) & Install New Sign(s)
- ⑧ Install New Sign(s) w/ Post(s)
- ⑨ Remove Exist. Sign(s) w/ Post(s)
- ⑩ Remove Exist. Sign(s) on Traffic Signal & Install New Sign(s) w/ Post(s)

* Fluorescent Yellow-Green Sign Sheeting

SURVEY PLOTTED BY	DATE
DESIGNED BY	
TRACED BY	
NOTE BOOK	
QUANTITIES BY	
CHECKED BY	
N. 7/10/03	

STATE OF HAWAII
DEPARTMENT OF TRANSPORTATION
HIGHWAYS DIVISION

**PAVEMENT MARKING
& SIGNING PLAN**

LIKELIKE HIGHWAY RESURFACING
School Street to Emmeline Place
Federal Aid Project No. NH-063-1(023)
Scale: 1" = 40' Date: October 2014

SHEET No. 77 OF 20 SHEETS

FED. ROAD DIST. NO.	STATE	FED. AID PROJ. NO.	FISCAL YEAR	SHEET NO.	TOTAL SHEETS
HAWAII	HAW.	NH-063-1(023)	2015	79	111

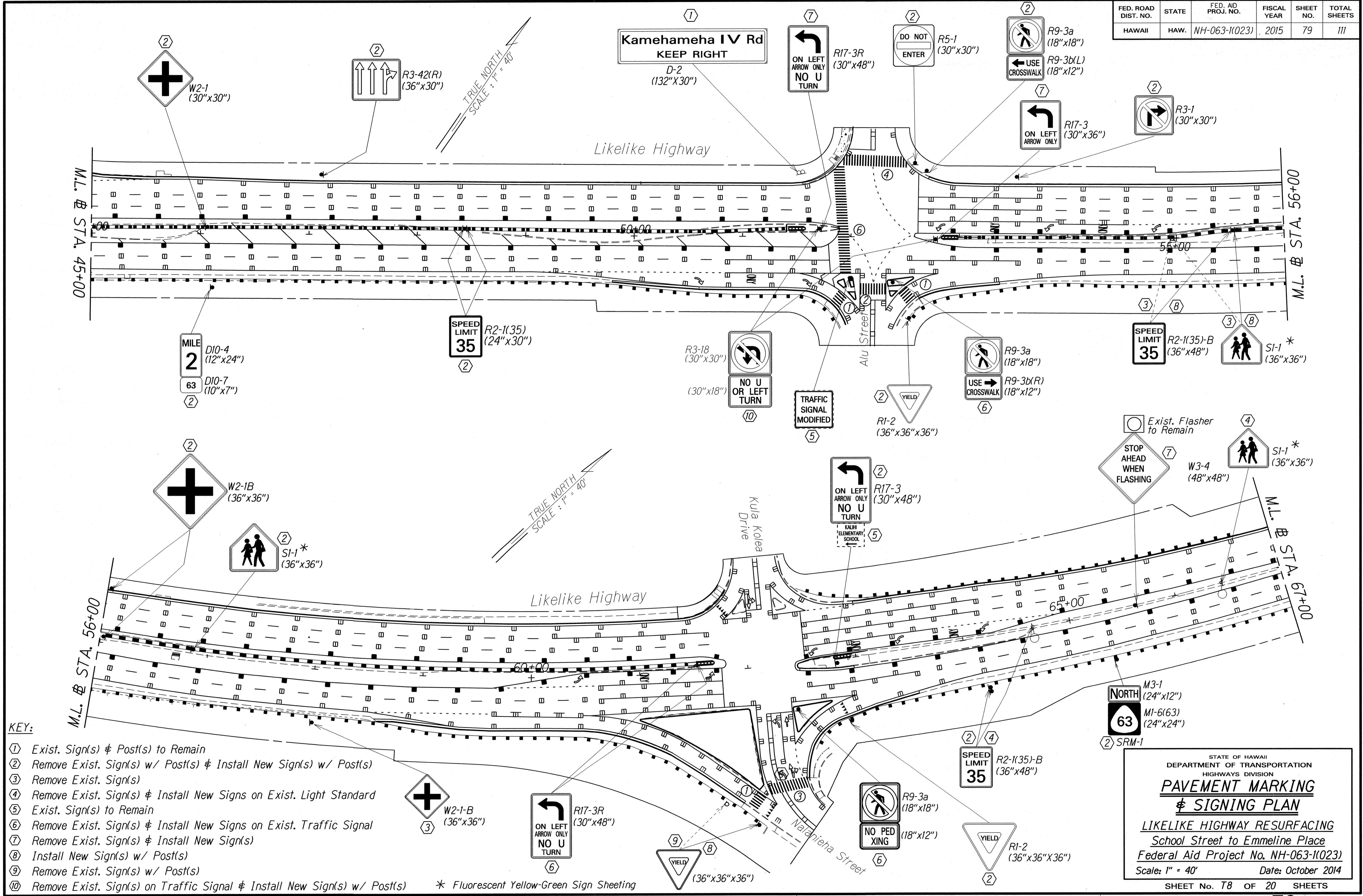

KEY:

- ① Exist. Sign(s) & Post(s) to Remain
- ② Remove Exist. Sign(s) w/ Post(s) & Install New Sign(s) w/ Post(s)
- ③ Remove Exist. Sign(s)
- ④ Remove Exist. Sign(s) & Install New Signs on Exist. Light Standard
- ⑤ Exist. Sign(s) to Remain
- ⑥ Remove Exist. Sign(s) & Install New Signs on Exist. Traffic Signal
- ⑦ Remove Exist. Sign(s) & Install New Sign(s)
- ⑧ Install New Sign(s) w/ Post(s)
- ⑨ Remove Exist. Sign(s) w/ Post(s)
- ⑩ Remove Exist. Sign(s) on Traffic Signal & Install New Sign(s) w/ Post(s)

* Fluorescent Yellow-Green Sign Sheeting

SURVEY PLOTTED BY	DATE
DESIGNED BY	
TRACED BY	
NOTE BOOK	
QUANTITIES BY	
CHECKED BY	
N. 11/10/14	

STATE OF HAWAII
DEPARTMENT OF TRANSPORTATION
HIGHWAYS DIVISION

**PAVEMENT MARKING
& SIGNING PLAN**

LIKELIKE HIGHWAY RESURFACING
School Street to Emmeline Place
Federal Aid Project No. NH-063-1(023)
Scale: 1" = 40' Date: October 2014

SHEET No. T8 OF 20 SHEETS

FED. ROAD DIST. NO.	STATE	FED. AID PROJ. NO.	FISCAL YEAR	SHEET NO.	TOTAL SHEETS
HAWAII	HAW.	NH-063-1(023)	2015	80	111

TRUE NORTH
SCALE: 1" = 40'

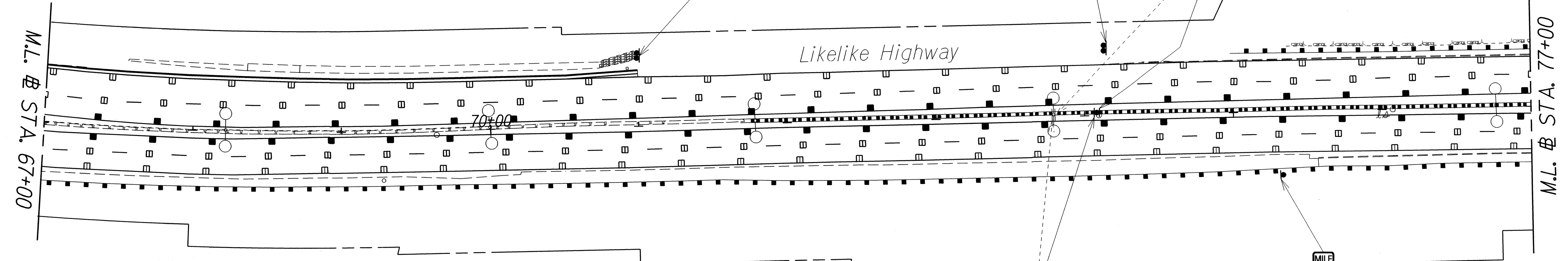

END PROJECT
Project No. NH-063-1(023)
Sta. 80+50

TRUE NORTH
SCALE: 1" = 40'

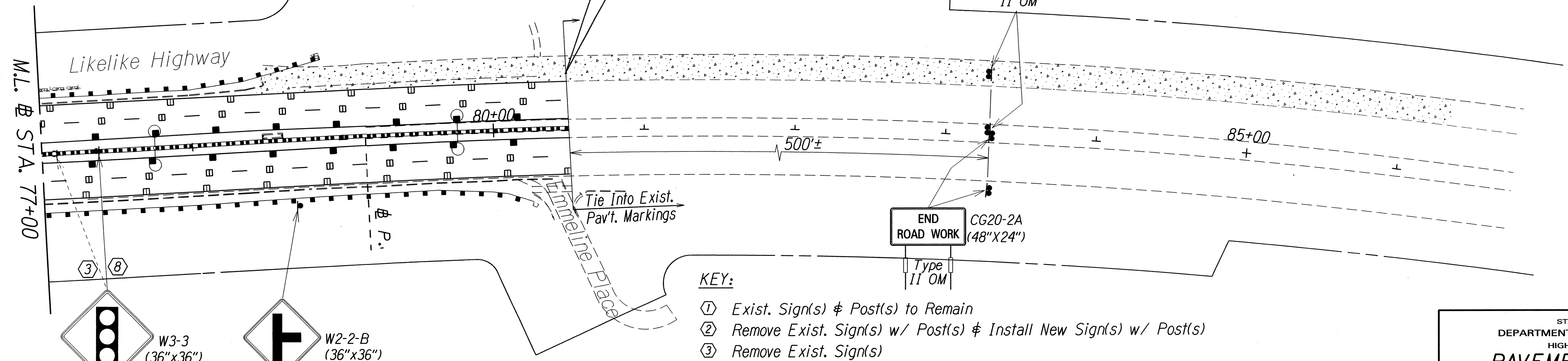

- KEY:
- ① Exist. Sign(s) & Post(s) to Remain
 - ② Remove Exist. Sign(s) w/ Post(s) & Install New Sign(s) w/ Post(s)
 - ③ Remove Exist. Sign(s)
 - ④ Remove Exist. Sign(s) & Install New Signs on Exist. Light Standard
 - ⑤ Exist. Sign(s) to Remain
 - ⑥ Remove Exist. Sign(s) & Install New Signs on Exist. Traffic Signal
 - ⑦ Remove Exist. Sign(s) & Install New Sign(s)
 - ⑧ Install New Sign(s) w/ Post(s)
 - ⑨ Remove Exist. Sign(s) w/ Post(s)
 - ⑩ Remove Exist. Sign(s) on Traffic Signal & Install New Sign(s) w/ Post(s)

SURVEY PLOTTED BY	DATE
DESIGNED BY	
TRACED BY	
NOTE BOOK	
QUANTITIES BY	
CHECKED BY	
N. 10/15/15	

* Fluorescent Yellow-Green Sign Sheeting

STATE OF HAWAII
DEPARTMENT OF TRANSPORTATION
HIGHWAYS DIVISION
**PAVEMENT MARKING
& SIGNING PLAN**
LIKELIKE HIGHWAY RESURFACING
School Street to Emmeline Place
Federal Aid Project No. NH-063-1(023)
Scale: 1" = 40' Date: October 2014
SHEET No. T9 OF 20 SHEETS