

FED. ROAD DIST. NO.	STATE	PROJ. NO.	FISCAL YEAR	SHEET NO.	TOTAL SHEETS
HAWAII	HAW.	63A-01-14M	2014	0	0

BEGIN PROJECT
Project No. 63A-01-14M
Sta. 1+10

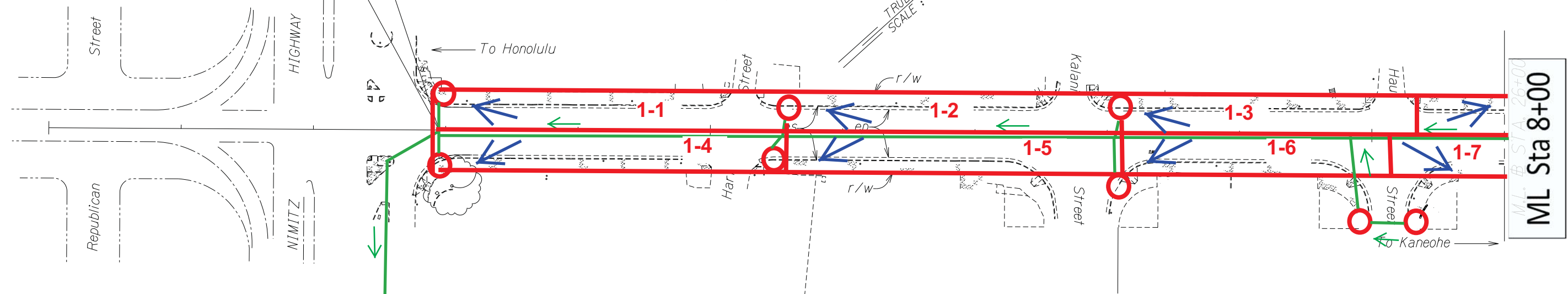

To Outfall 1
(Impaired)
Honolulu
Harbor

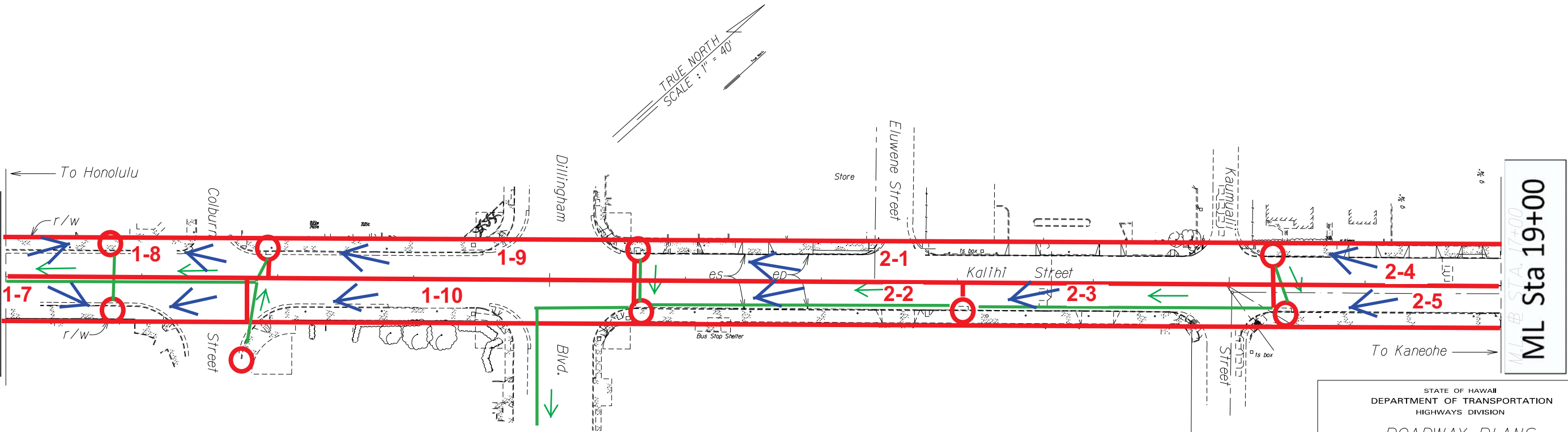

To Outfall 2
(Impaired)
Kapalama
Canal

STATE OF HAWAII
DEPARTMENT OF TRANSPORTATION
HIGHWAYS DIVISION

ROADWAY PLANS

KALIHI STREET RESURFACING
Nimitz Highway to School Street
Project No. 63A-01-14M

Scale: 1" = 40' Date: Oct, 2013

SHEET No. 1 OF 4 SHEETS

SURVEY PLOTTED BY	DATE
DRAWN BY	
INCHES BY	
QUANTITIES BY	
CHECKED BY	

ORIGINAL PLAN	N.
NOTE BOOK	

FED. ROAD DIST. NO.	STATE	PROJ. NO.	FISCAL YEAR	SHEET NO.	TOTAL SHEETS
HAWAII	HAW.	63A-01-14M	2014	0	0

ORIGINAL PLAN	SURVEY PLOTTED BY	DATE
NOTE BOOK	DRAWN BY	
	INCHES BY	
	QUANTITIES BY	
	CHECKED BY	

ML Sta 19+00

ML Sta 30+00

ML Sta 30+00

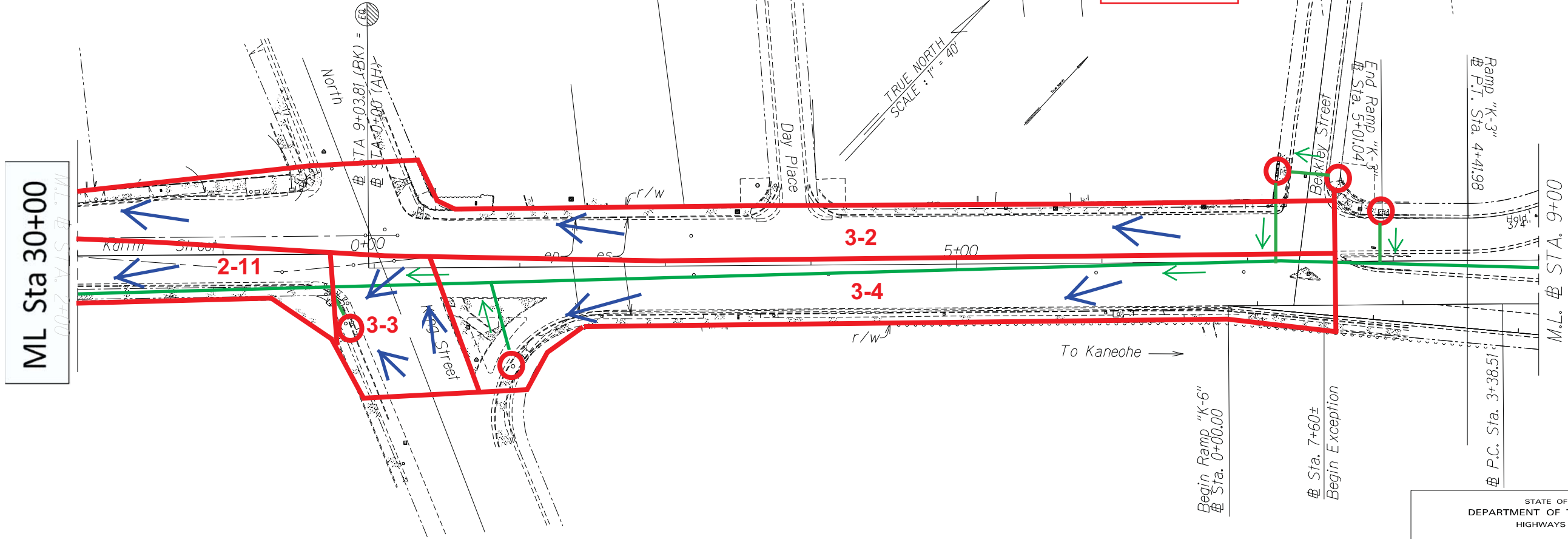

STATE OF HAWAII
DEPARTMENT OF TRANSPORTATION
HIGHWAYS DIVISION

ROADWAY PLANS

KALIHI STREET RESURFACING
Nimitz Highway to School Street
Project No. 63A-01-14M

Scale: 1" = 40' Date: Oct, 2013

SHEET No. 2 OF X SHEETS

FED. ROAD DIST. NO.	STATE	PROJ. NO.	FISCAL YEAR	SHEET NO.	TOTAL SHEETS
HAWAII	HAW.	63A-01-14M	2014	0	0

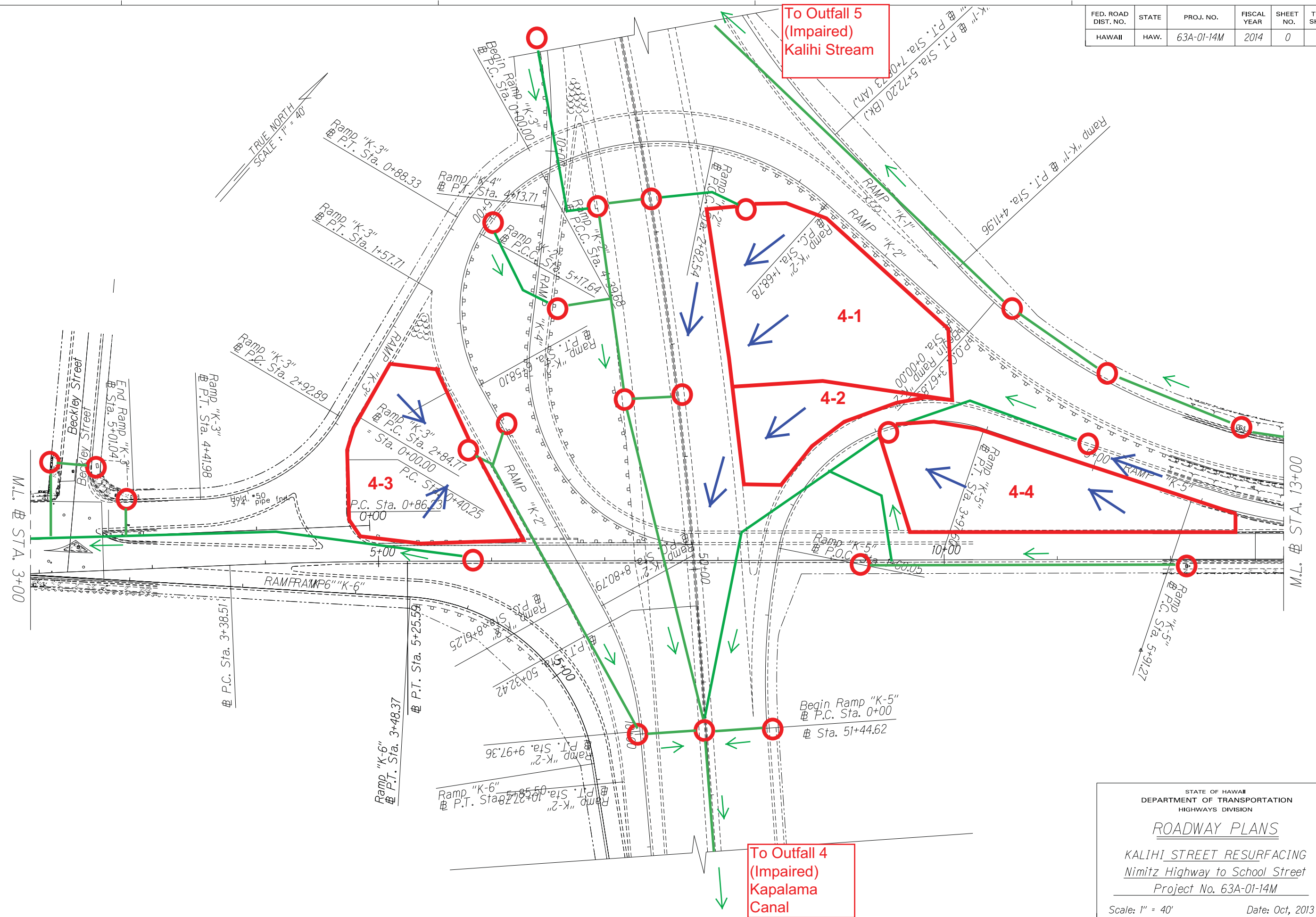

ORIGINAL PLAN	SURVEY PLOTTED BY _____	DATE _____
NOTE BOOK	DRAWN BY _____	•
	TRACED BY _____	•
	DESIGNED BY _____	•
	QUANTITIES BY _____	•
No. _____	CHECKED BY _____	•

STATE OF HAWAII
DEPARTMENT OF TRANSPORTATION
HIGHWAYS DIVISION

ROADWAY PLANS

KALIHI STREET RESURFACING
Nimitz Highway to School Street
Project No. 63A-01-14M

Scale: 1" = 40' Date: Oct, 2013

SHEET No. 3 OF X SHEETS

