

FED. ROAD DIST. NO.	STATE	FED. AID PROJ. NO.	FISCAL YEAR	SHEET NO.	TOTAL SHEETS
HAWAII	HAW.	STP-063-1(22)	2003	43	69

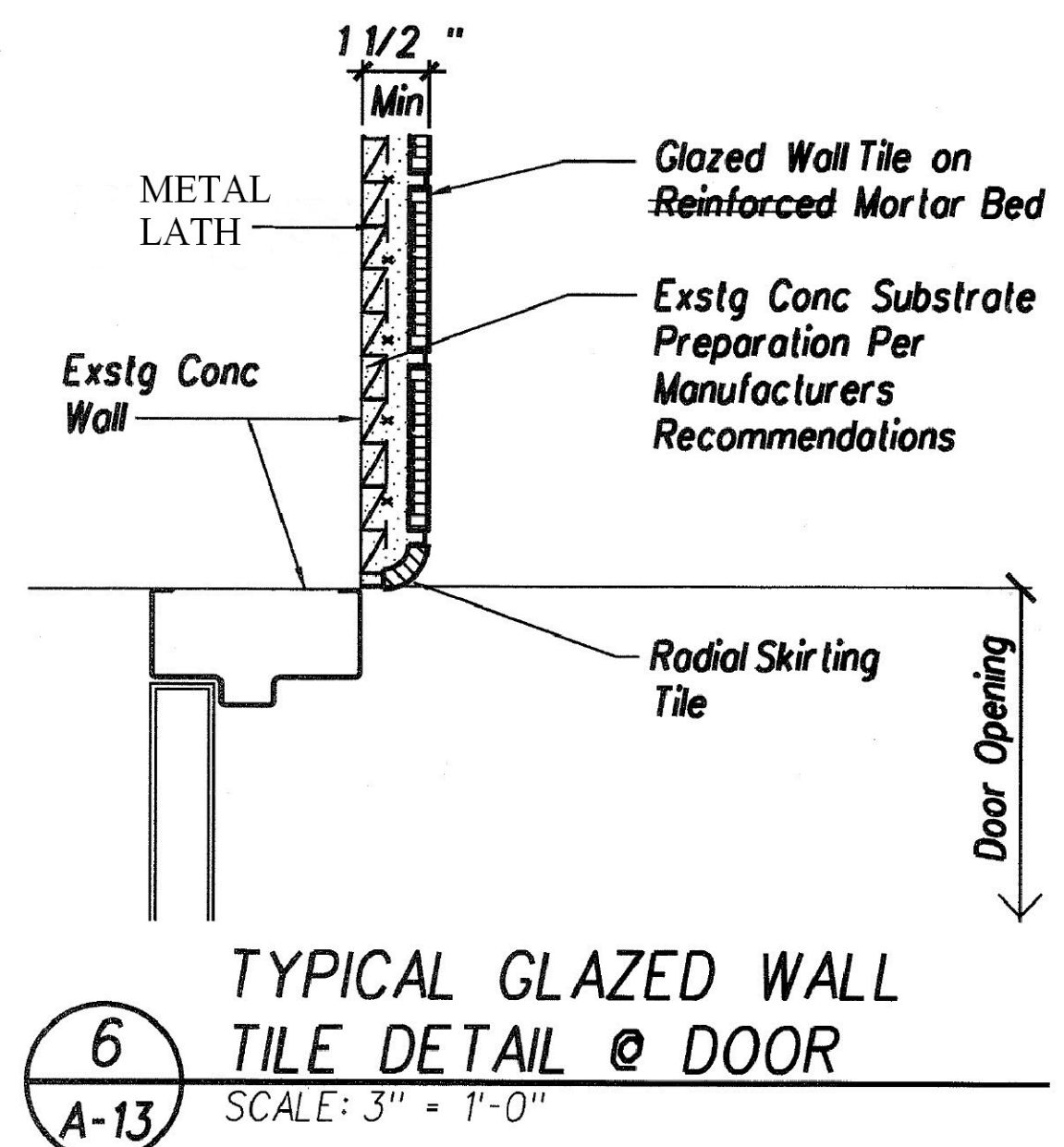
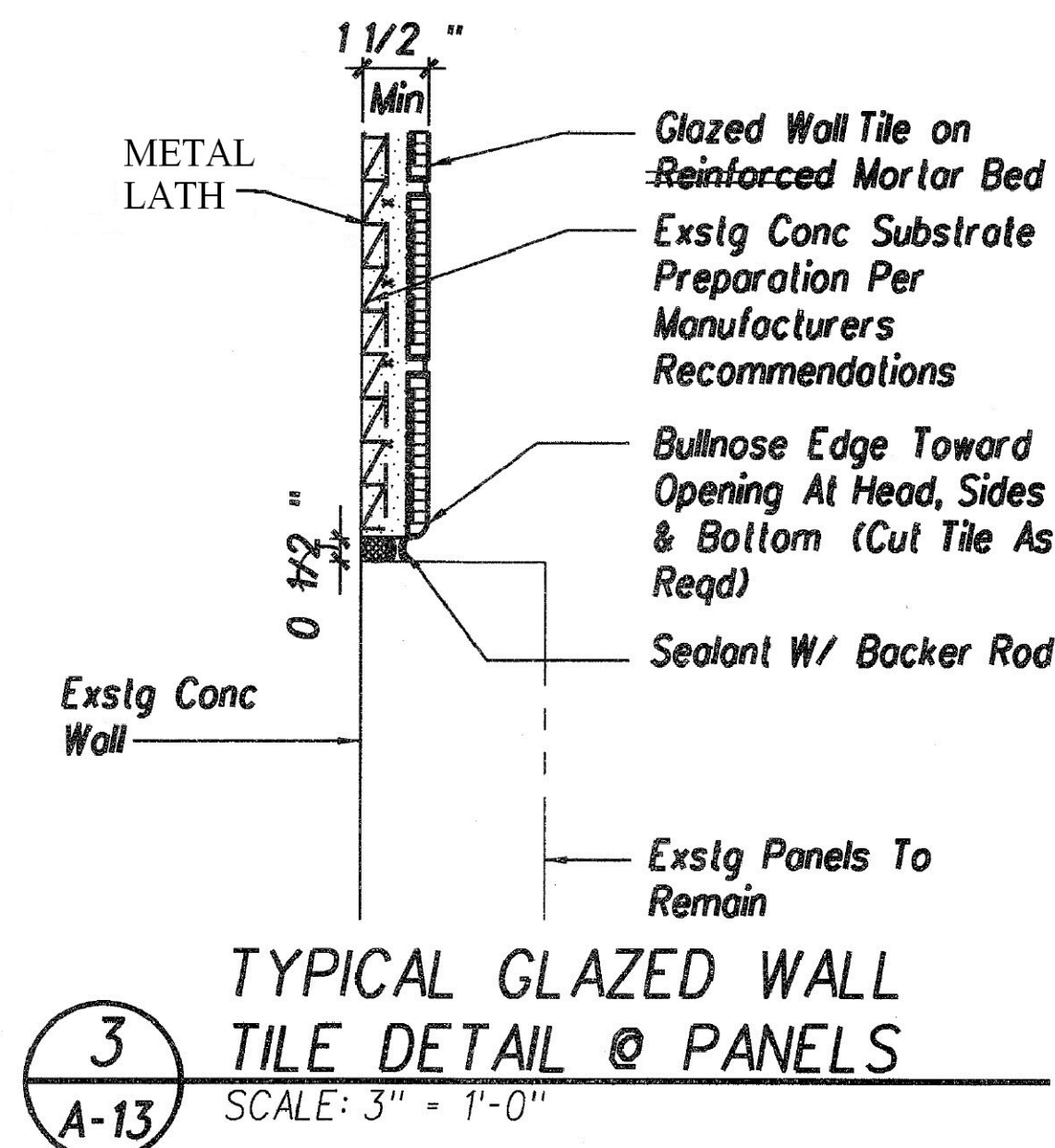
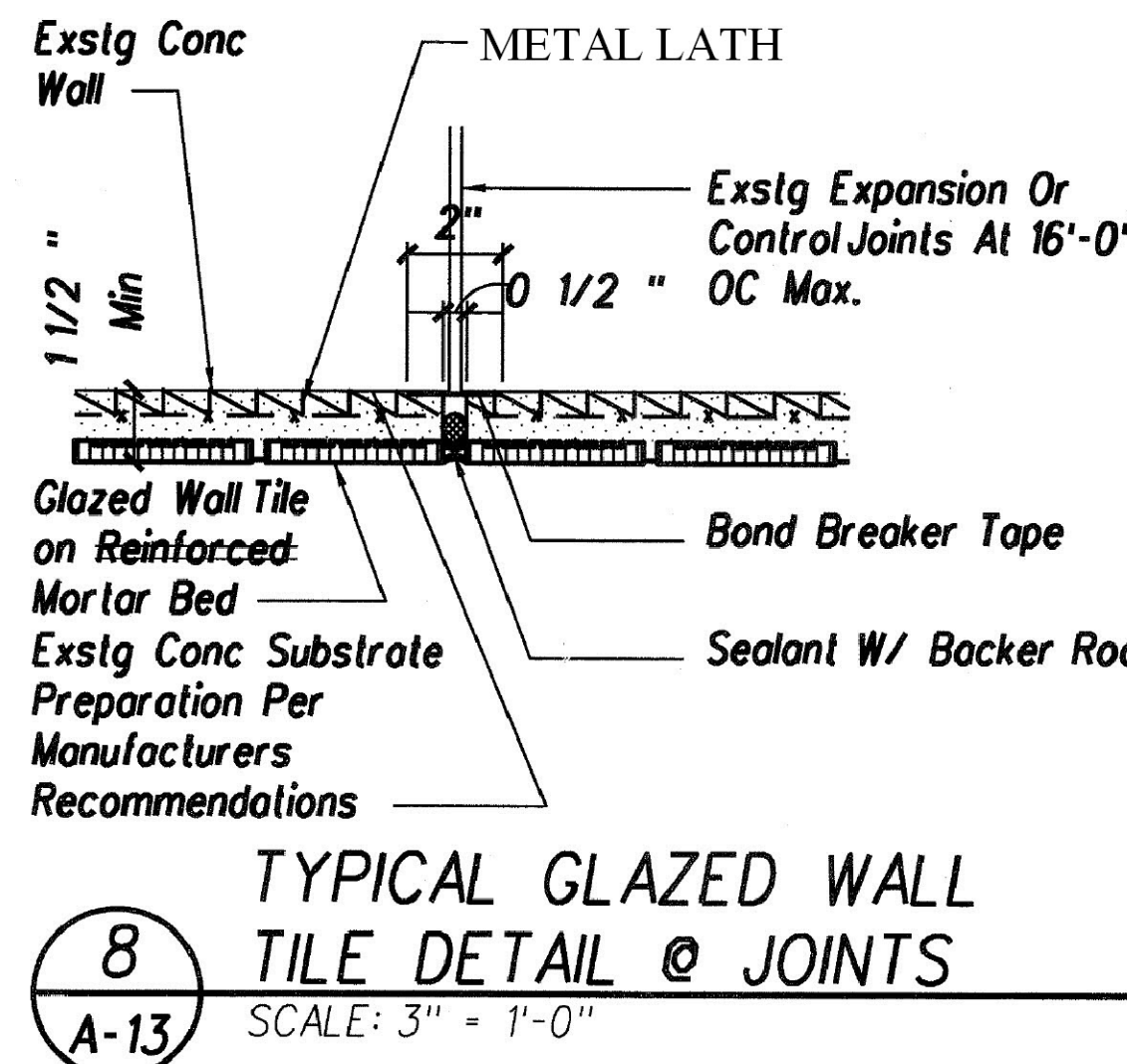
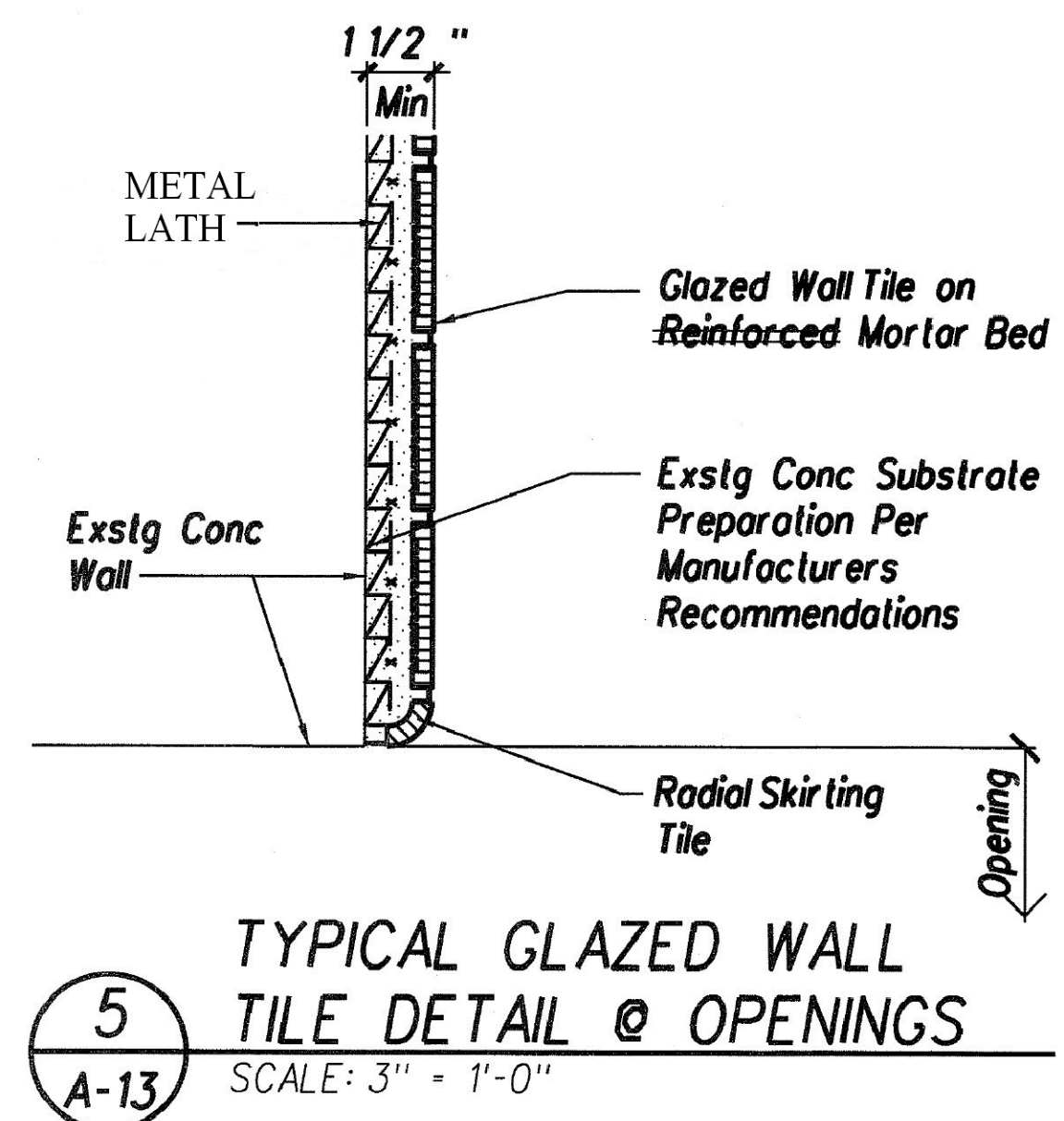
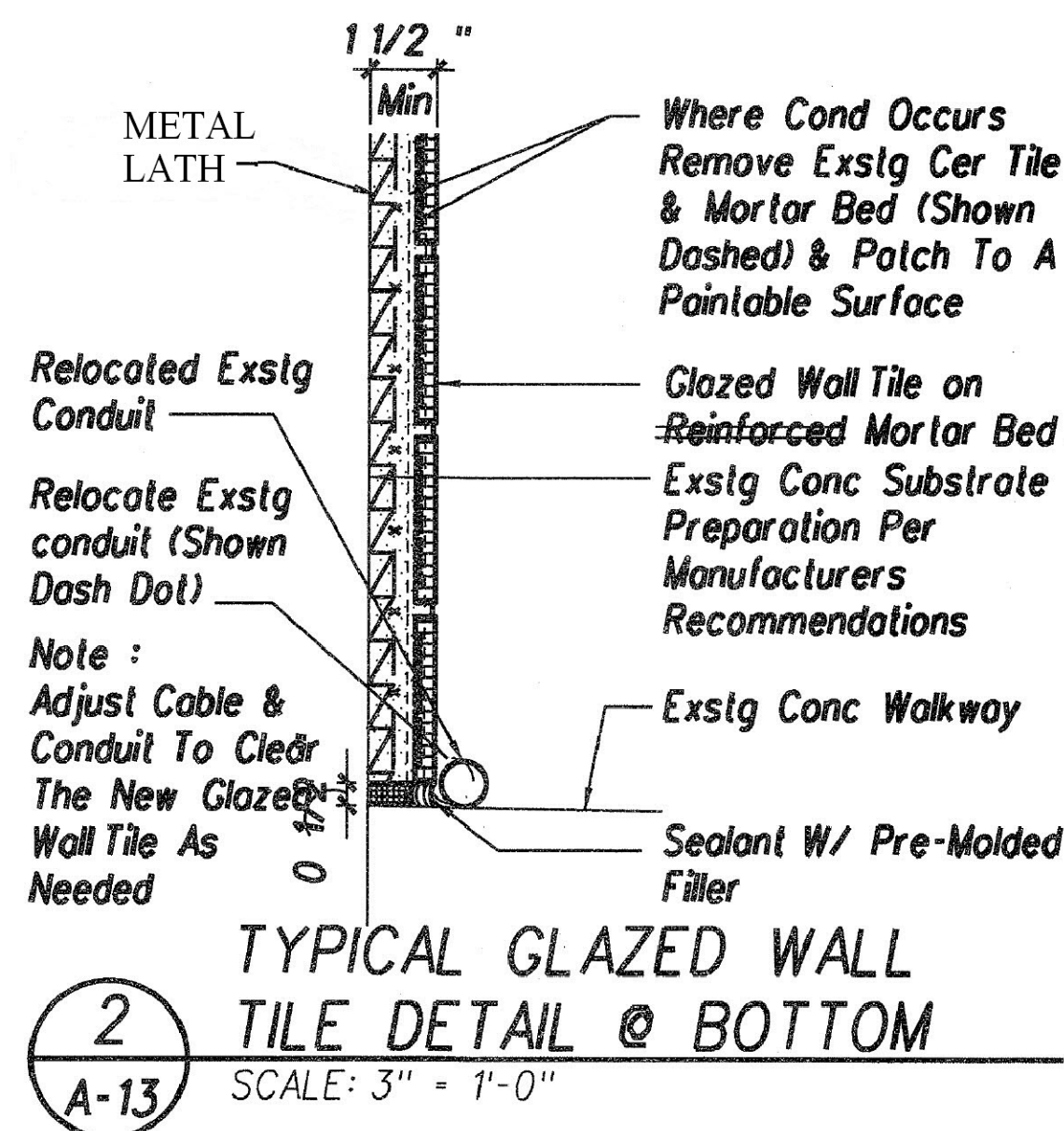
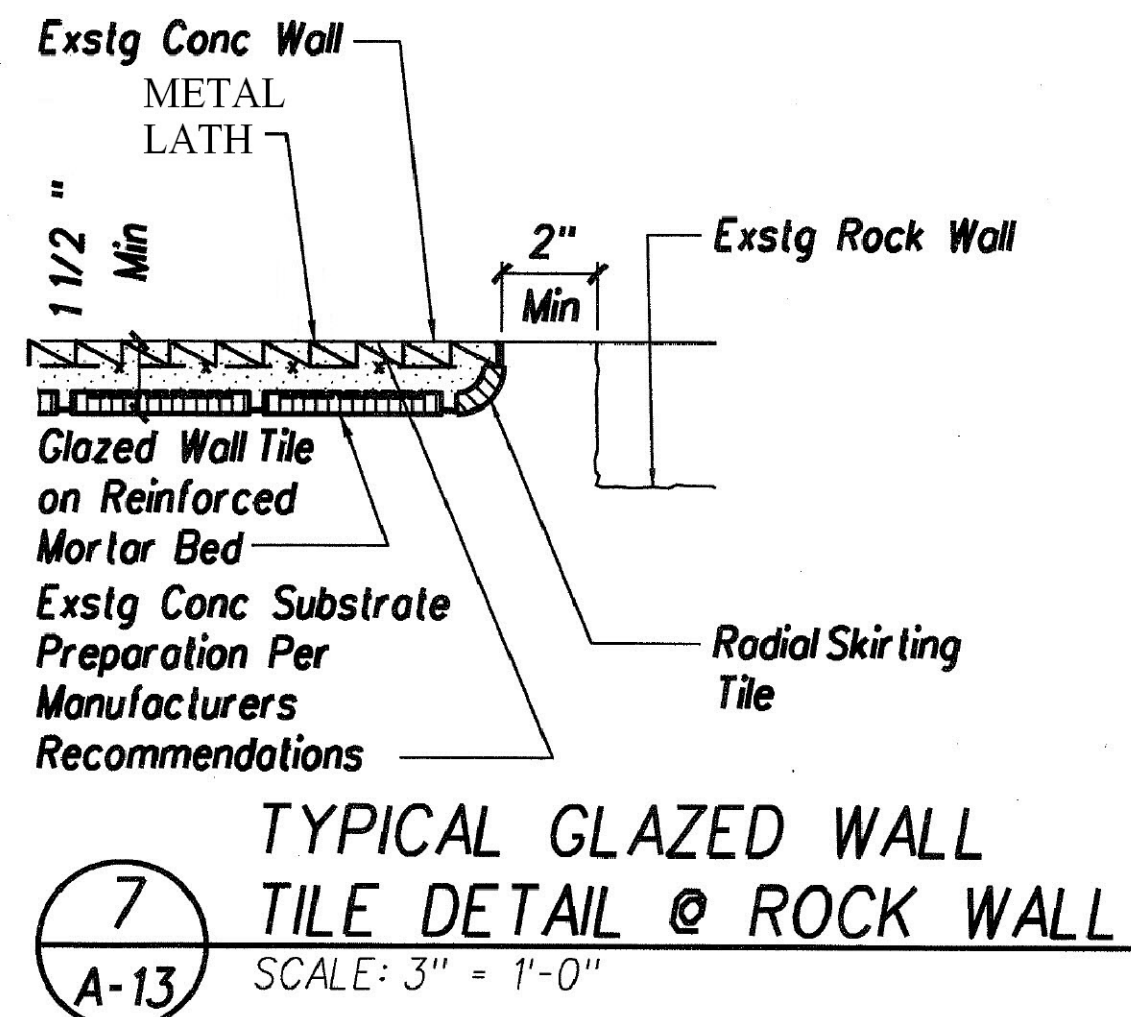
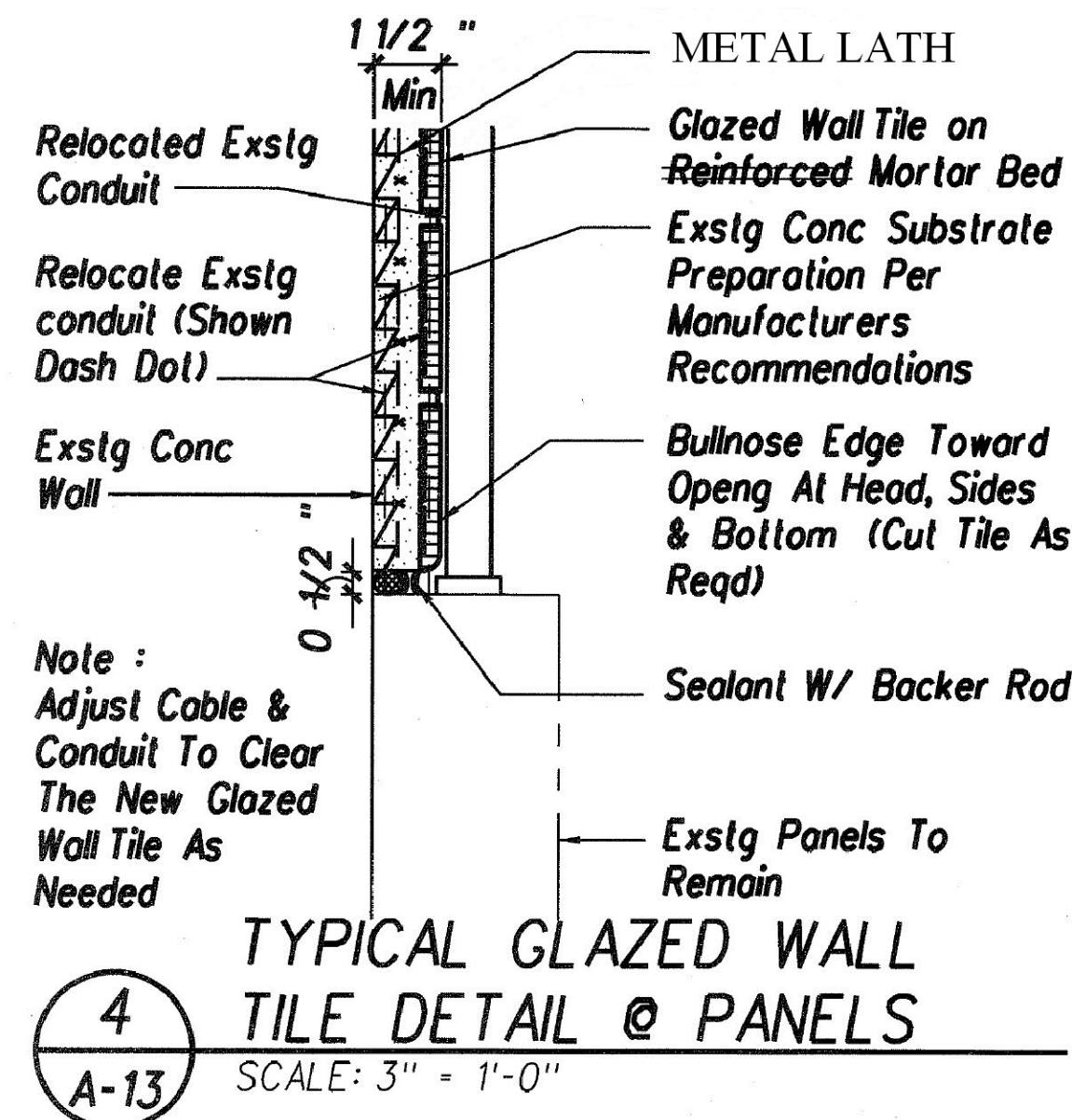
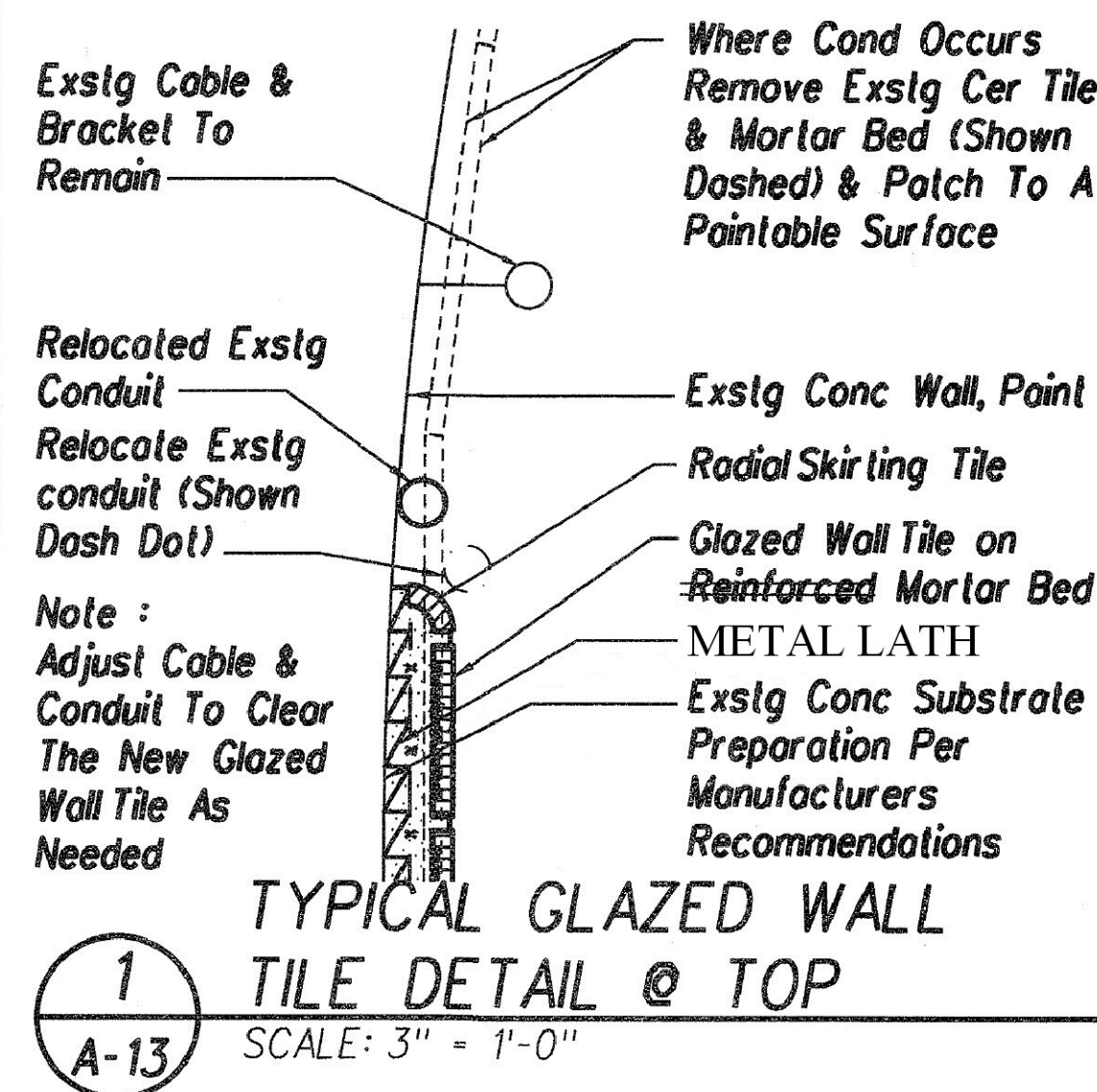

LEGEND

METAL LATH

LEGEND FOR AS-BUILT POSTINGS	
	Squiggly line for as-built deletion
	Double line for as-built deletion
Roadway	Text for as-built posting



THIS WORK WAS PREPARED BY ME OR UNDER MY SUPERVISION AND CONSTRUCTION OF THIS PROJECT WILL BE UNDER MY OBSERVATION.

SIGNATURE: *[Signature]*
 EXPIRATION DATE OF THE LICENSE: 4/24/14

GRAPHIC SCALES



STATE OF HAWAII
DEPARTMENT OF TRANSPORTATION
HIGHWAYS DIVISION

DETAILS

LIKELIKE HIGHWAY

Wilson Tunnel Improvements

Leak and Crack Remediation

F. A. Project No. STP-063-1(22)

Scale: AS NOTED Date: April 24, 2003

SHEET No. A-13 OF 13 SHEETS

"AS- BUILT"

43

SURVEY PLOTTED BY	DATE
DRAWN BY	
TRACED BY	
DESIGNED BY	
QUANTITIES BY	
CHECKED BY	
ORIGINAL PLAN	
NOTE BOOK	
No.	