

FED. ROAD DIST. NO.	STATE	PROJ. NO.	FISCAL YEAR	SHEET NO.	TOTAL SHEETS
HAWAII	HAW.	63A-01-97	1998	12	52

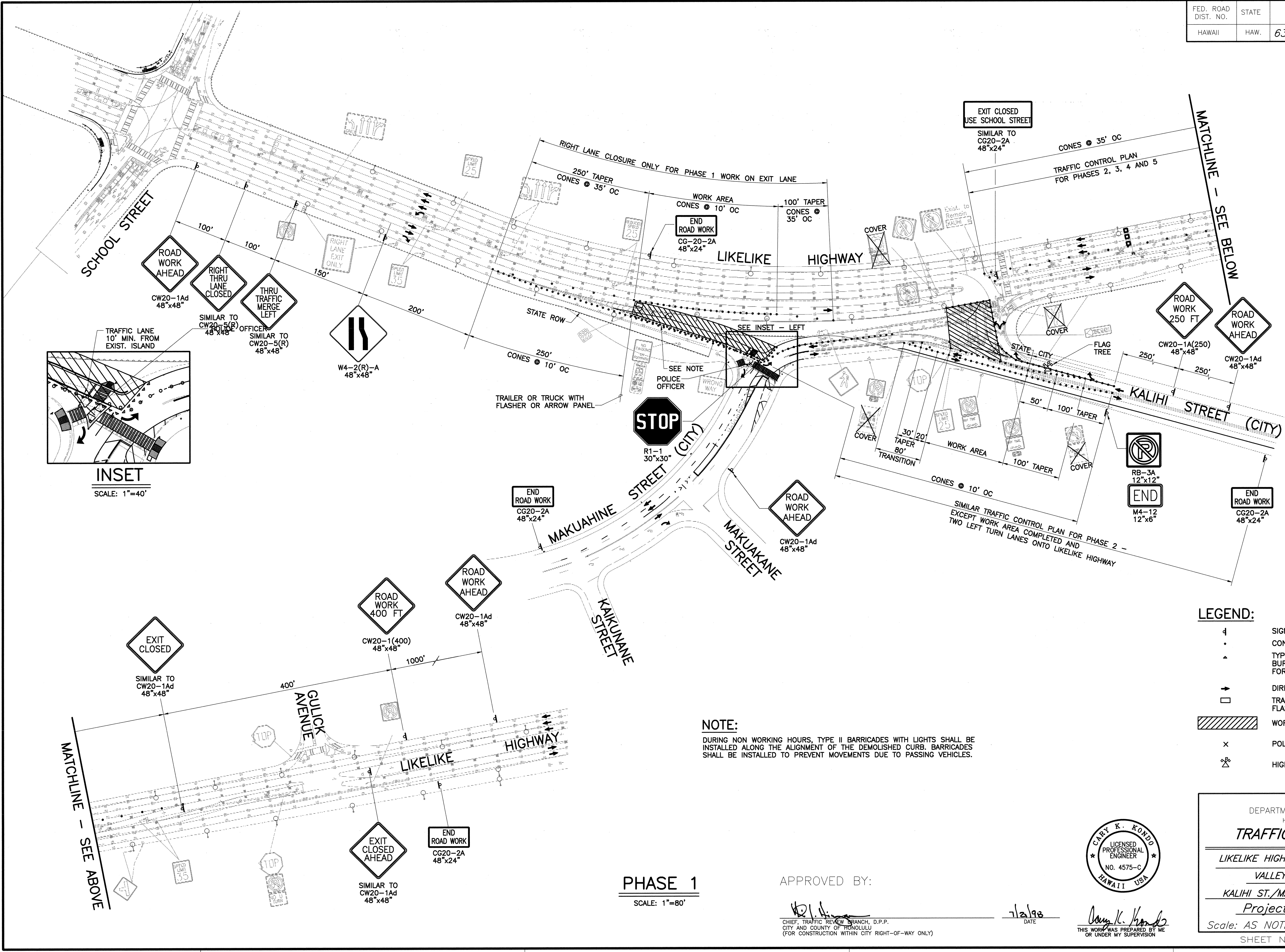

STATE OF HAWAII  
DEPARTMENT OF TRANSPORTATION  
HIGHWAYS DIVISION

**TRAFFIC CONTROL PLAN**

LIKELIKE HIGHWAY TRAFFIC IMPROVEMENTS  
VALLEY VIEW DRIVE TO H-1  
KALIHI ST./MAKUAHINE ST. INTERSECTION  
Project No. 63A-01-97

Scale: AS NOTED Date: MAY 1998

SHEET No. 2 OF 9 SHEETS

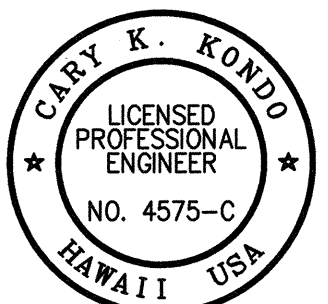

APPROVED BY:

7/2/98  
DATE  
THIS WORK WAS PREPARED BY ME OR UNDER MY SUPERVISION

SURVEY PLOTTED BY	DATE
DRAWN BY	
TRACED BY	
DESIGNED BY	
QUANTITIES BY	
CHECKED BY	
ORIGINAL PLAN	
NOTE BOOK	
No.	



FED. ROAD DIST. NO.	STATE	PROJ. NO.	FISCAL YEAR	SHEET NO.	TOTAL SHEETS
HAWAII	HAW.	63A-01-97	1998	13	52

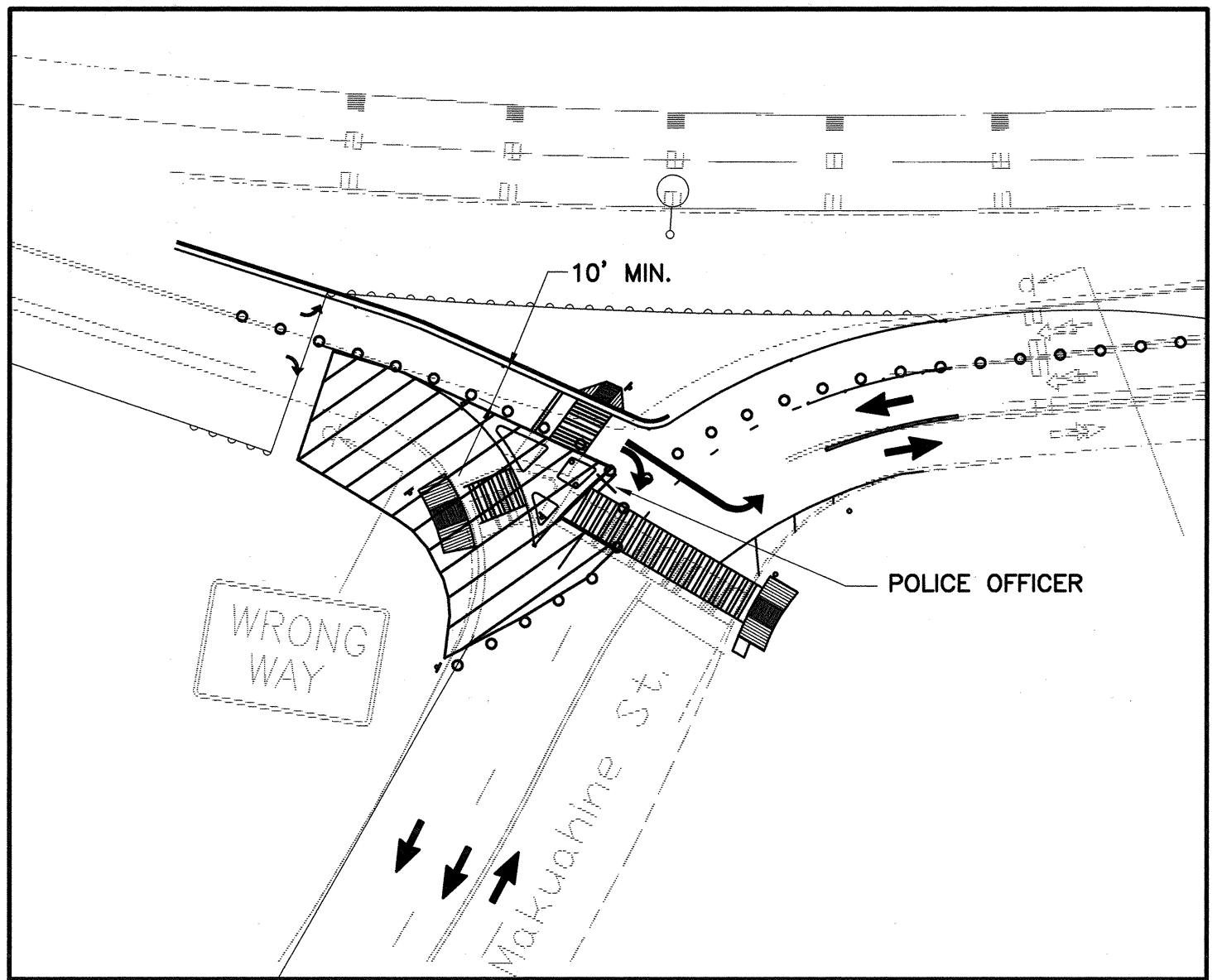
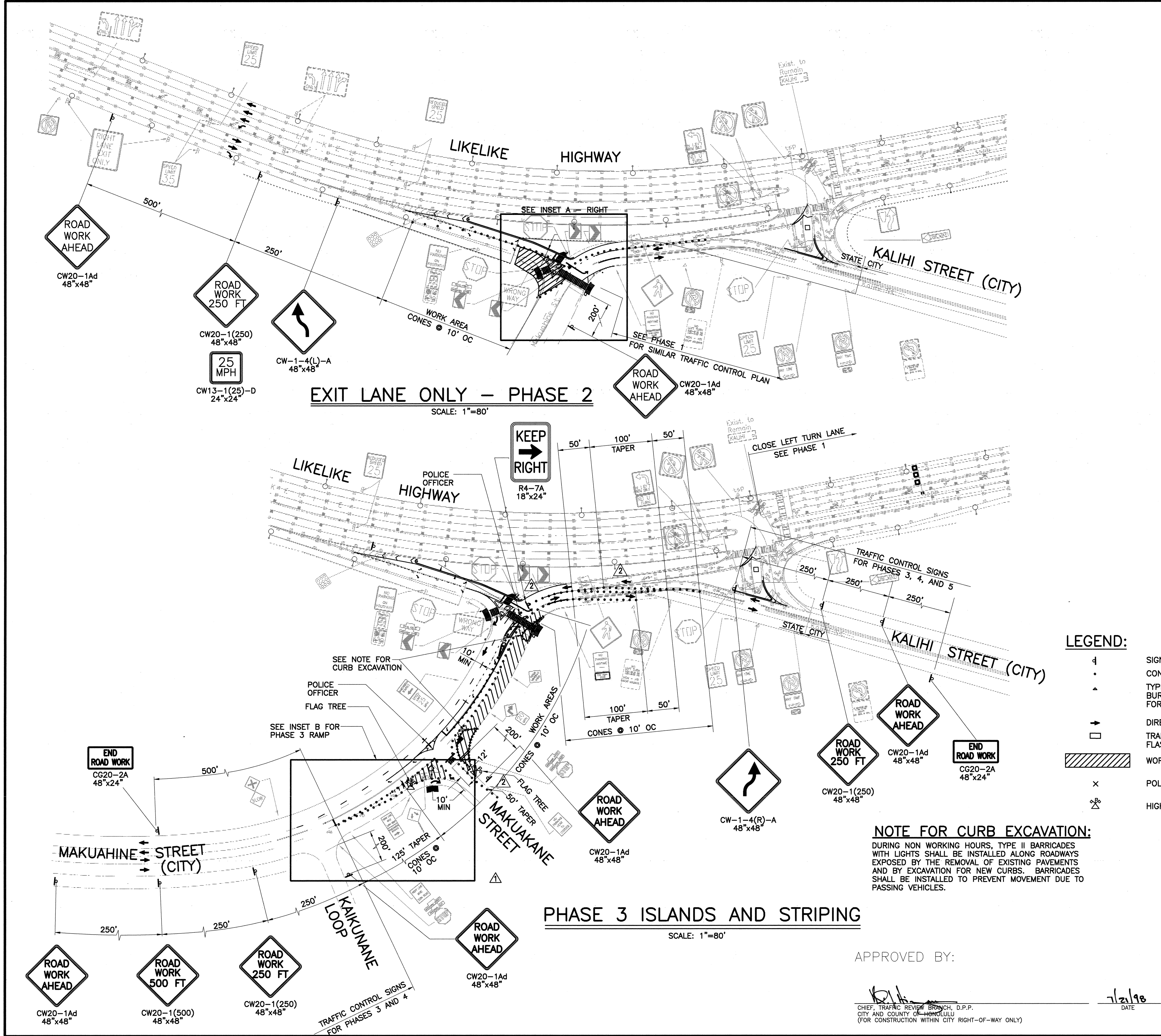

INSET A  
SCALE: 1"=40'

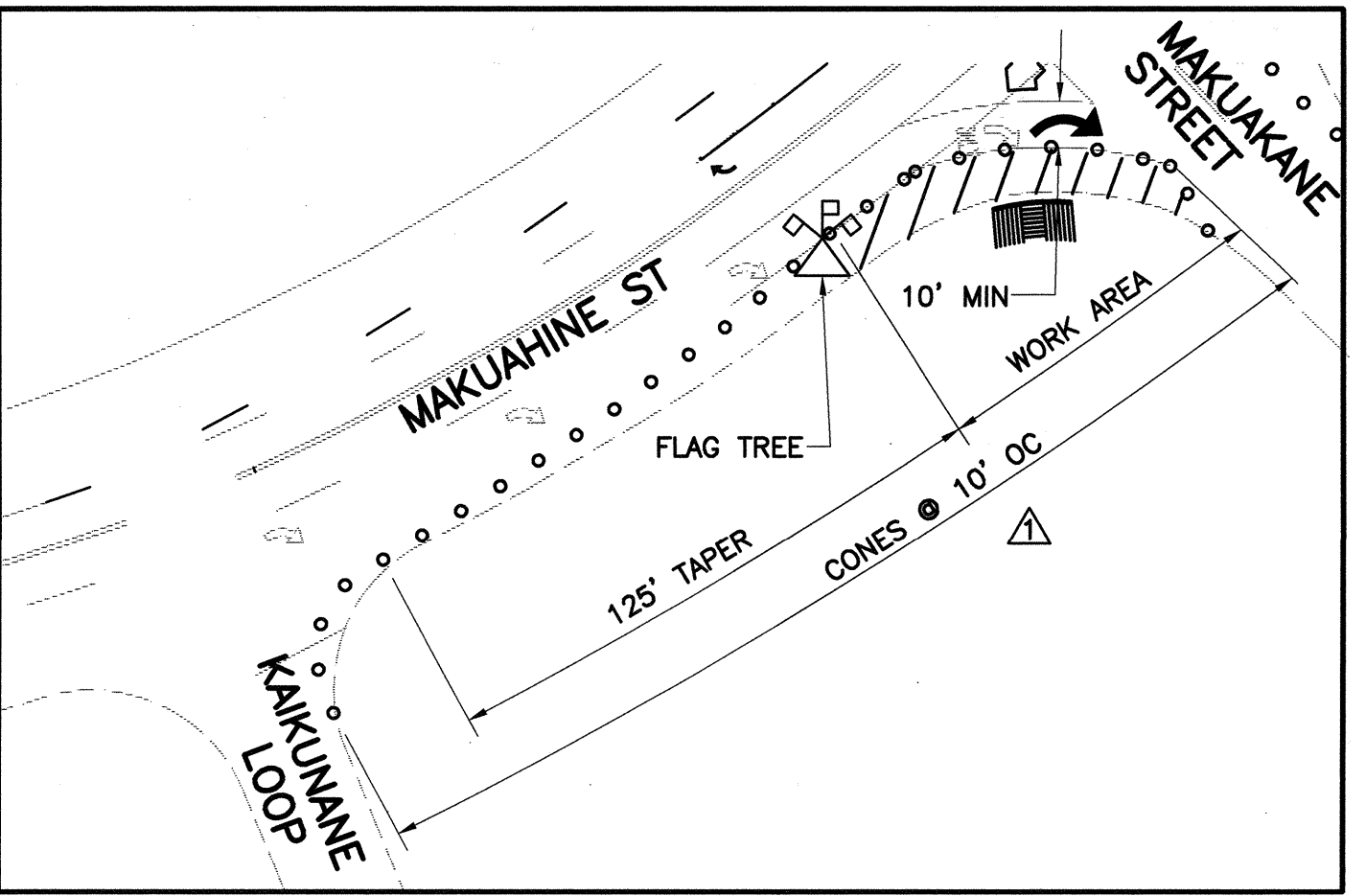

INSET B  
SCALE: 1"=40'

LEGEND:

- SIGN
- CONE
- TYPE III BARRICADE WITH STEADY BURN LIGHTS SPACED @ 6' O.C. MAXIMUM FOR NON WORKING HOURS
- DIRECTION OF TRAFFIC
- TRAILER OR TRUCK WITH FLASHER OR ARROW PANEL
- WORK AREA
- POLICE OFFICER
- HIGH LEVEL WARNING DEVICE (FLAG TREE)

NOTE FOR CURB EXCAVATION:  
DURING NON WORKING HOURS, TYPE II BARRICADES WITH LIGHTS SHALL BE INSTALLED ALONG ROADWAYS EXPOSED BY THE REMOVAL OF EXISTING PAVEMENTS AND BY EXCAVATION FOR NEW CURBS. BARRICADES SHALL BE INSTALLED TO PREVENT MOVEMENT DUE TO PASSING VEHICLES.

PHASE 3 ISLANDS AND STRIPING  
SCALE: 1"=80'

APPROVED BY:

CHIEF, TRAFFIC REVIEW BRANCH, D.P.P.  
CITY AND COUNTY OF HONOLULU  
(FOR CONSTRUCTION WITHIN CITY RIGHT-OF-WAY ONLY)

7/21/98  
DATE

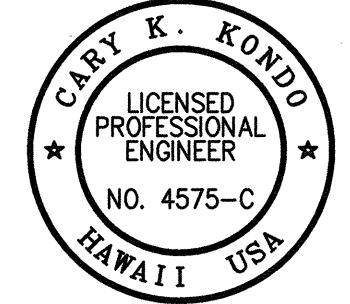

THIS WORK WAS PREPARED BY ME OR UNDER MY SUPERVISION

Rev	Date	Description	Eng	App
2	7/2/98	REVISED CONES, ADDED SIGNS, FLAG TREE AND POLICE OFFICER	EM	
1	6/8/98	REVISED TAPER	EM	

STATE OF HAWAII  
DEPARTMENT OF TRANSPORTATION  
HIGHWAYS DIVISION

**TRAFFIC CONTROL PLAN**

LIKELIKE HIGHWAY TRAFFIC IMPROVEMENTS  
VALLEY VIEW DRIVE TO H-1  
KALIHI ST./MAKUAHINE ST. INTERSECTION  
Project No. 63A-01-97

Scale: AS NOTED Date: MAY 1998  
SHEET No. 3 OF 9 SHEETS



FED. ROAD DIST. NO.	STATE	PROJ. NO.	FISCAL YEAR	SHEET NO.	TOTAL SHEETS
HAWAII	HAW.	63A-01-97	1998	14	52

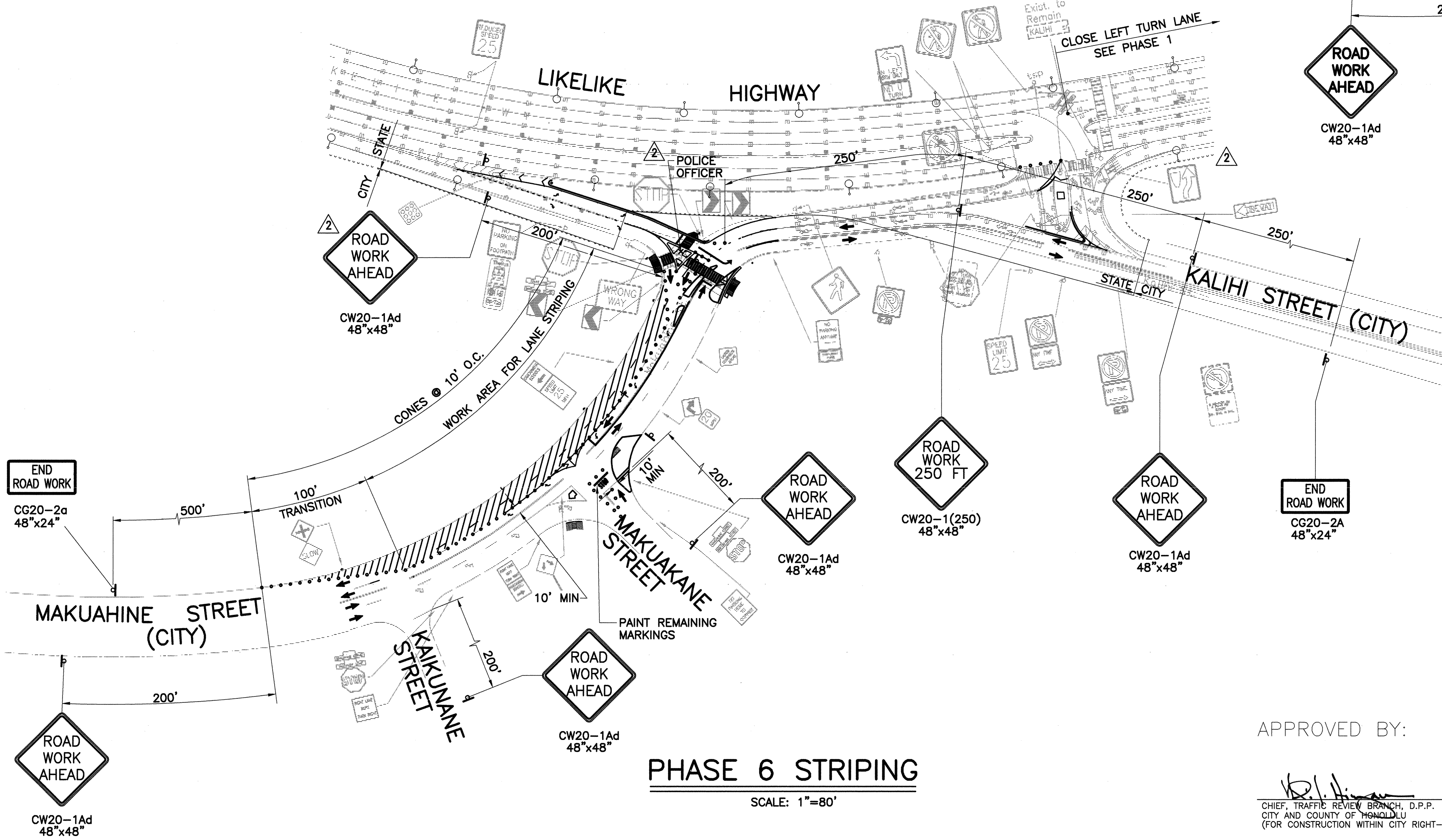
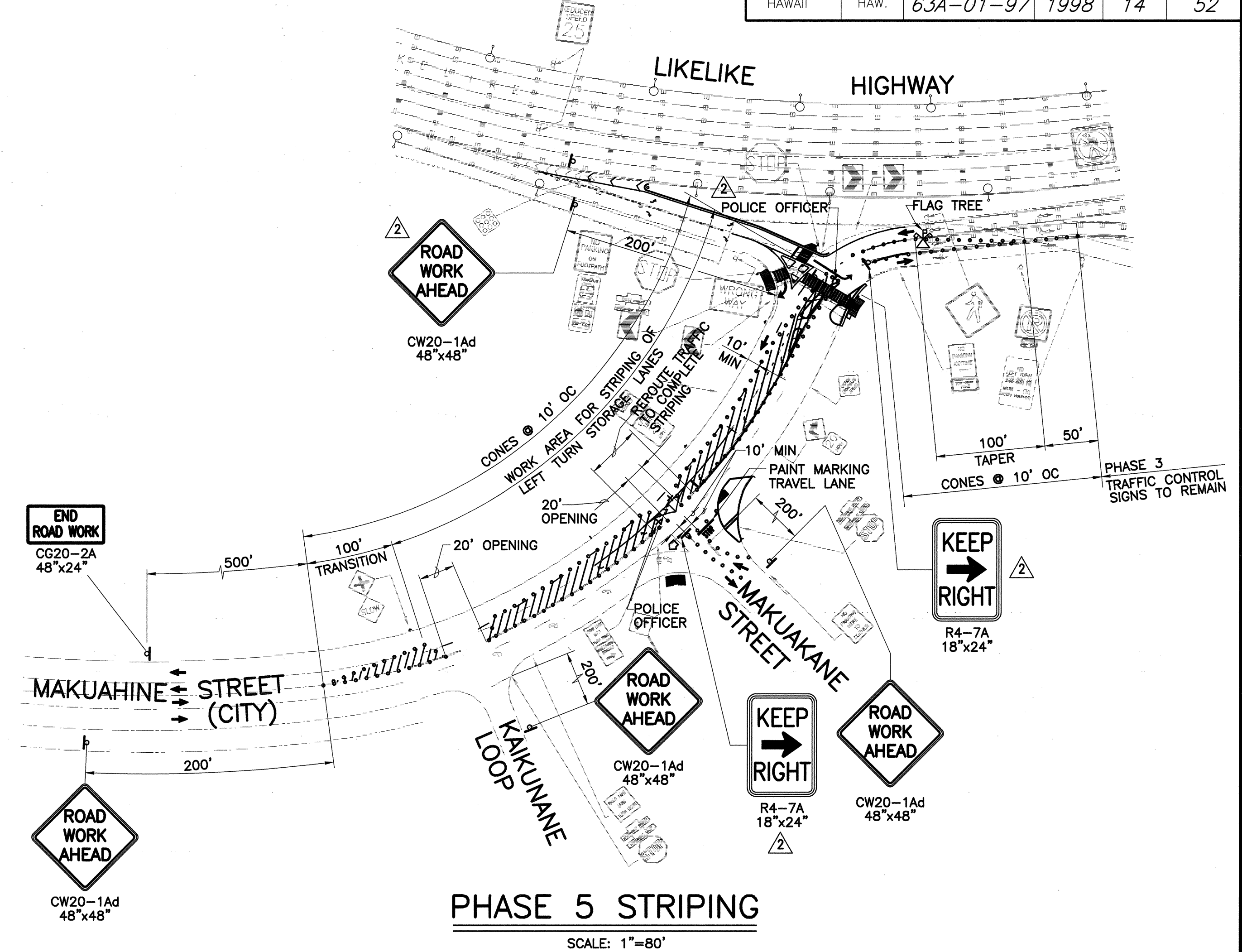
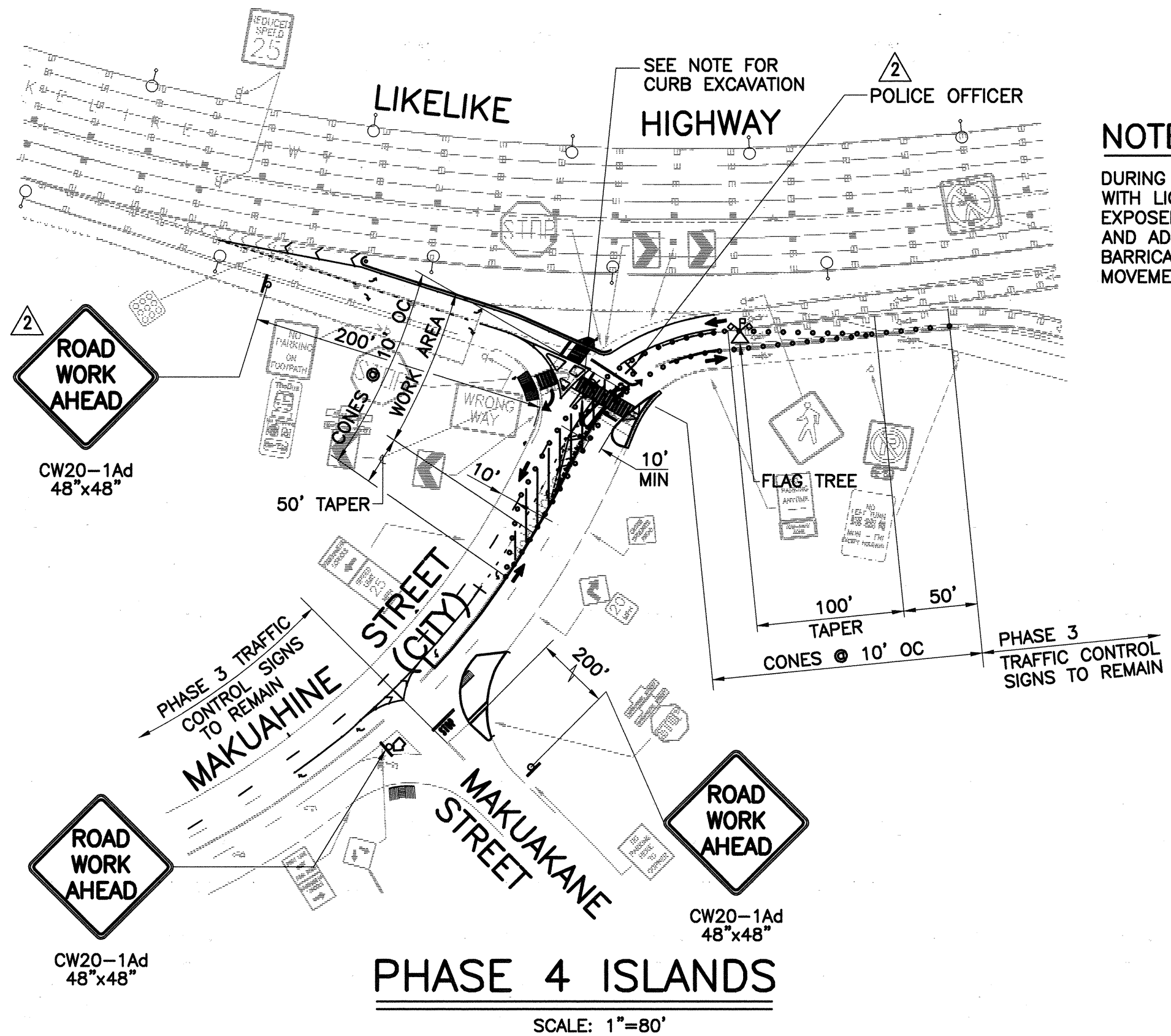

- LEGEND:**
- SIGN
  - CONE
  - TYPE III BARRICADE WITH STEADY BURN LIGHTS SPACED @ 6' O.C. MAXIMUM FOR NON WORKING HOURS
  - DIRECTION OF TRAFFIC
  - TRAILER OR TRUCK WITH FLASHER OR ARROW PANEL
  - WORK AREA
  - POLICE OFFICER
  - HIGH LEVEL WARNING DEVICE (FLAG TREE)

Rev	Date	Description	Eng	App
2	7/2/98	ADDED POLICE OFFICER AND SIGNS. REVISED SIGNS.	EM	

STATE OF HAWAII  
DEPARTMENT OF TRANSPORTATION  
HIGHWAYS DIVISION

**TRAFFIC CONTROL PLAN**

LIKELIKE HIGHWAY TRAFFIC IMPROVEMENTS  
VALLEY VIEW DRIVE TO H-1  
KALIHI ST./MAKUAHINE ST. INTERSECTION  
Project No. 63A-01-97

Scale: AS NOTED Date: MAY 1998

SHEET No. 4 OF 9 SHEETS

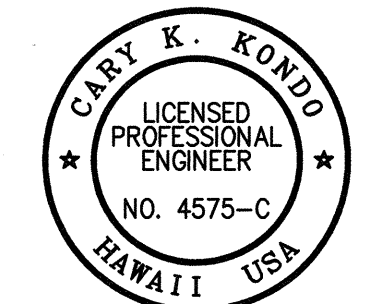

APPROVED BY:

CHIEF, TRAFFIC REVIEW BRANCH, D.P.P.  
CITY AND COUNTY OF HONOLULU  
(FOR CONSTRUCTION WITHIN CITY RIGHT-OF-WAY ONLY)

7/2/98  
DATE

Cary K. Kondo  
THIS WORK WAS PREPARED BY ME  
OR UNDER MY SUPERVISION

SURVEY PLOTTED BY: \_\_\_\_\_ DATE: \_\_\_\_\_  
DRAWN BY: \_\_\_\_\_  
CHECKED BY: \_\_\_\_\_  
NOTE BOOK: \_\_\_\_\_  
QUANTITIES BY: \_\_\_\_\_  
CHECKED BY: \_\_\_\_\_



FED. ROAD DIST. NO.	STATE	PROJ. NO.	FISCAL YEAR	SHEET NO.	TOTAL SHEETS
HAWAII	HAW.	63A-01-97	1998	15	52

**NOTE A:**  
DURING NON WORKING HOURS, TYPE II BARRICADES WITH LIGHTS SHALL BE INSTALLED ALONG EDGE OF EXISTING PAVEMENTS EXPOSED BY ADJACENT EXCAVATION FOR NEW PAVEMENTS. BARRICADES SHALL BE INSTALLED TO PREVENT MOVEMENT DUE TO PASSING VEHICLES.

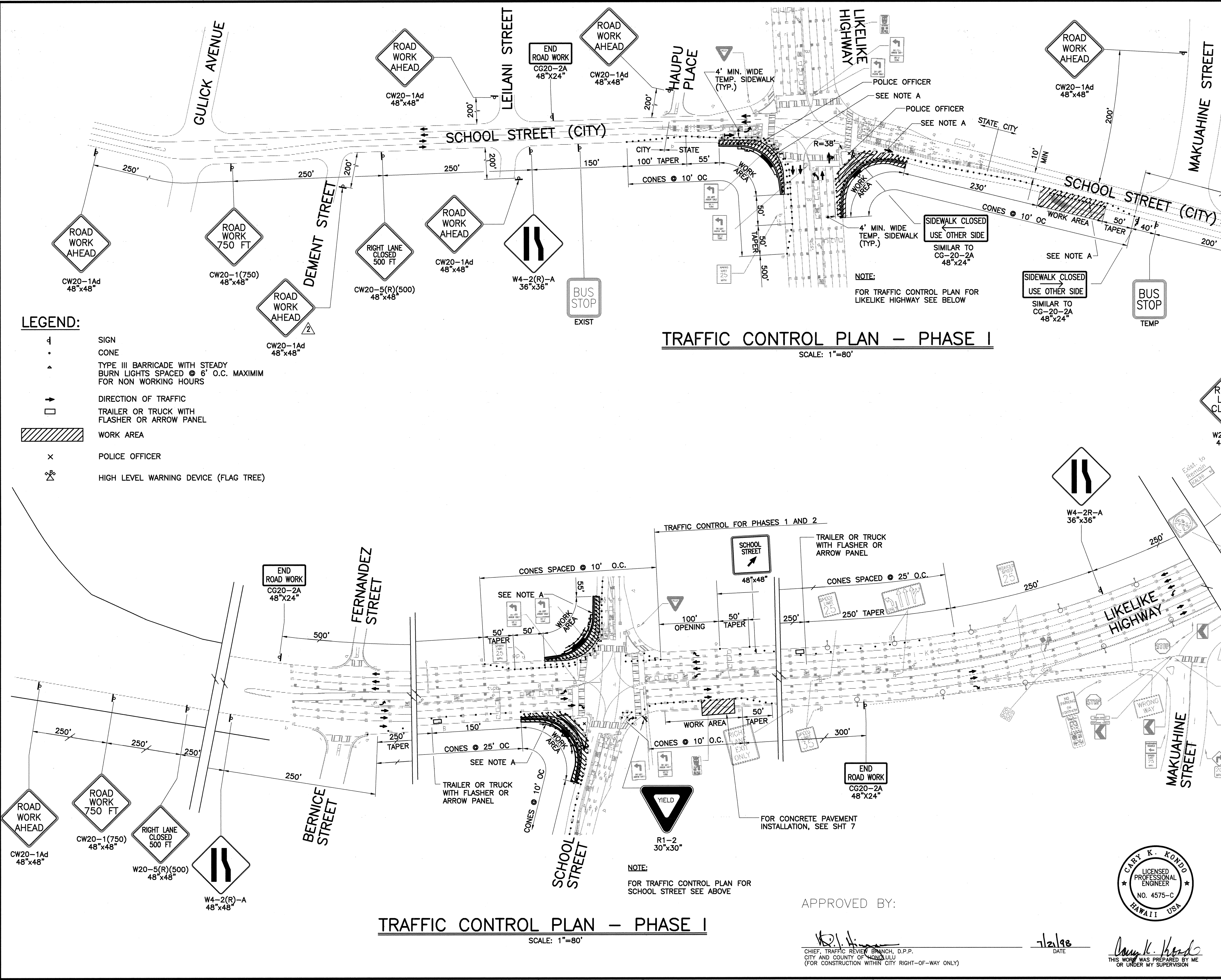

- LEGEND:**
- 4 SIGN
  - CONE
  - ▲ TYPE III BARRICADE WITH STEADY BURN LIGHTS SPACED @ 6' O.C. MAXIMUM FOR NON WORKING HOURS
  - DIRECTION OF TRAFFIC
  - TRAILER OR TRUCK WITH FLASHER OR ARROW PANEL
  - ▨ WORK AREA
  - × POLICE OFFICER
  - ⚠ HIGH LEVEL WARNING DEVICE (FLAG TREE)

**TRAFFIC CONTROL PLAN - PHASE I**  
SCALE: 1"=80'

**TRAFFIC CONTROL PLAN - PHASE I**  
SCALE: 1"=80'

Rev	Date	Description	EM	Eng	App
2	7/2/98	ADDED SIGN			

STATE OF HAWAII  
DEPARTMENT OF TRANSPORTATION  
HIGHWAYS DIVISION

**TRAFFIC CONTROL PLAN**

LIKELIKE HIGHWAY TRAFFIC IMPROVEMENTS  
VALLEY VIEW DRIVE TO H-1  
LIKELIKE HIGHWAY/SCHOOL ST. INTERSECTION  
Project No. 63A-01-97

Scale: AS NOTED Date: MAY 1998

SHEET No. 5 OF 9 SHEETS

SURVEY PLOTTED BY	DATE
DESIGNED BY	
NOTED BY	
CHECKED BY	
ORIGINAL PLAN	
NOTE BOOK	
QUANTITIES BY	
CHECKED BY	

APPROVED BY:

CHIEF, TRAFFIC REVIEW BRANCH, D.P.P.  
CITY AND COUNTY OF HONOLULU  
(FOR CONSTRUCTION WITHIN CITY RIGHT-OF-WAY ONLY)

7/2/98  
DATE

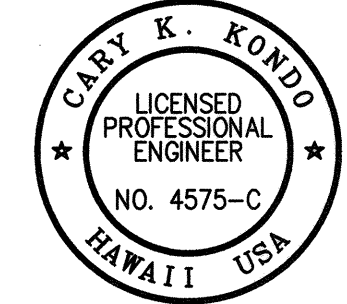

THIS WORK WAS PREPARED BY ME  
OR UNDER MY SUPERVISION



FED. ROAD DIST. NO.	STATE	PROJ. NO.	FISCAL YEAR	SHEET NO.	TOTAL SHEETS
HAWAII	HAW.	63A-01-97	1998	16	52

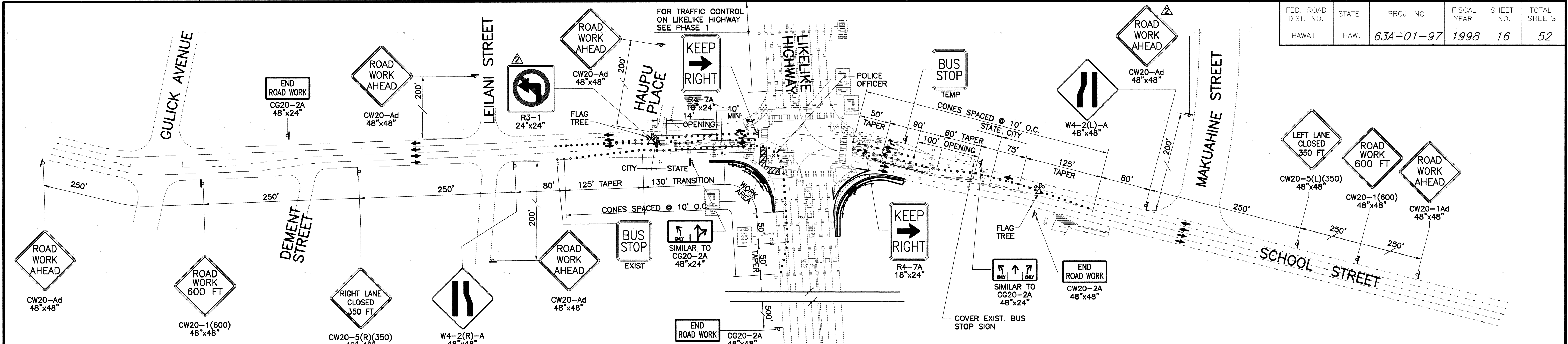

TRENCHING AND STRIPING - PHASE 2  
SCALE: 1"=80'

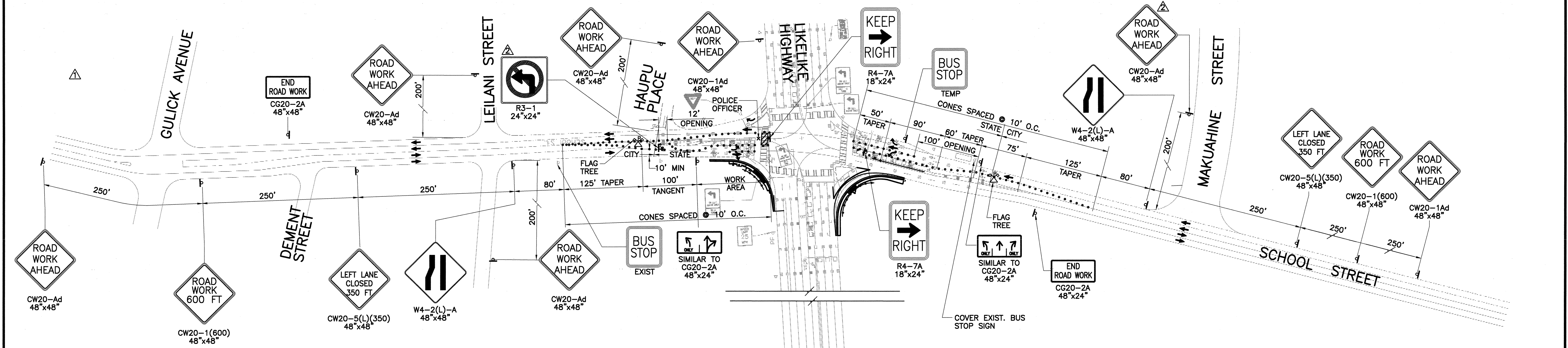

TRENCHING AND STRIPING - PHASE 3  
SCALE: 1"=80'

- LEGEND:**
- 4 SIGN
  - CONE
  - ▲ TYPE III BARRICADE WITH STEADY BURN LIGHTS SPACED @ 6' O.C. MAXIMUM FOR NON WORKING HOURS
  - DIRECTION OF TRAFFIC
  - TRAILER OR TRUCK WITH FLASHER OR ARROW PANEL
  - ▨ WORK AREA
  - x POLICE OFFICER
  - ⚠ HIGH LEVEL WARNING DEVICE (FLAG TREE)

SURVEY PLOTTED BY	DATE
DRAWN BY	
TRACED BY	
DESIGNED BY	
CHECKED BY	
ORIGINAL PLAN	
NOTE BOOK	
No.	

APPROVED BY:

*[Signature]*  
CHIEF, TRAFFIC REVIEW BRANCH, D.P.P.  
CITY AND COUNTY OF HONOLULU  
(FOR CONSTRUCTION WITHIN CITY RIGHT-OF-WAY ONLY)

7/2/98  
DATE



*[Signature]*  
THIS WORK WAS PREPARED BY ME  
OR UNDER MY SUPERVISION

Rev	Date	Description	Eng	App
2	7/2/98	ADDED SIGNS	EM	
1	6/8/98	MOVED ADVANCE SIGNS	EM	

STATE OF HAWAII  
DEPARTMENT OF TRANSPORTATION  
HIGHWAYS DIVISION

**TRAFFIC CONTROL PLAN**

LIKELIKE HIGHWAY TRAFFIC IMPROVEMENTS  
VALLEY VIEW DRIVE TO H-1  
LIKELIKE HIGHWAY/SCHOOL ST. INTERSECTION  
Project No. 63A-01-97  
Scale: AS NOTED Date: MAY 1998  
SHEET No. 6 OF 9 SHEETS



FED. ROAD DIST. NO.	STATE	PROJ. NO.	FISCAL YEAR	SHEET NO.	TOTAL SHEETS
HAWAII	HAW.	63A-01-97	1998	17	52

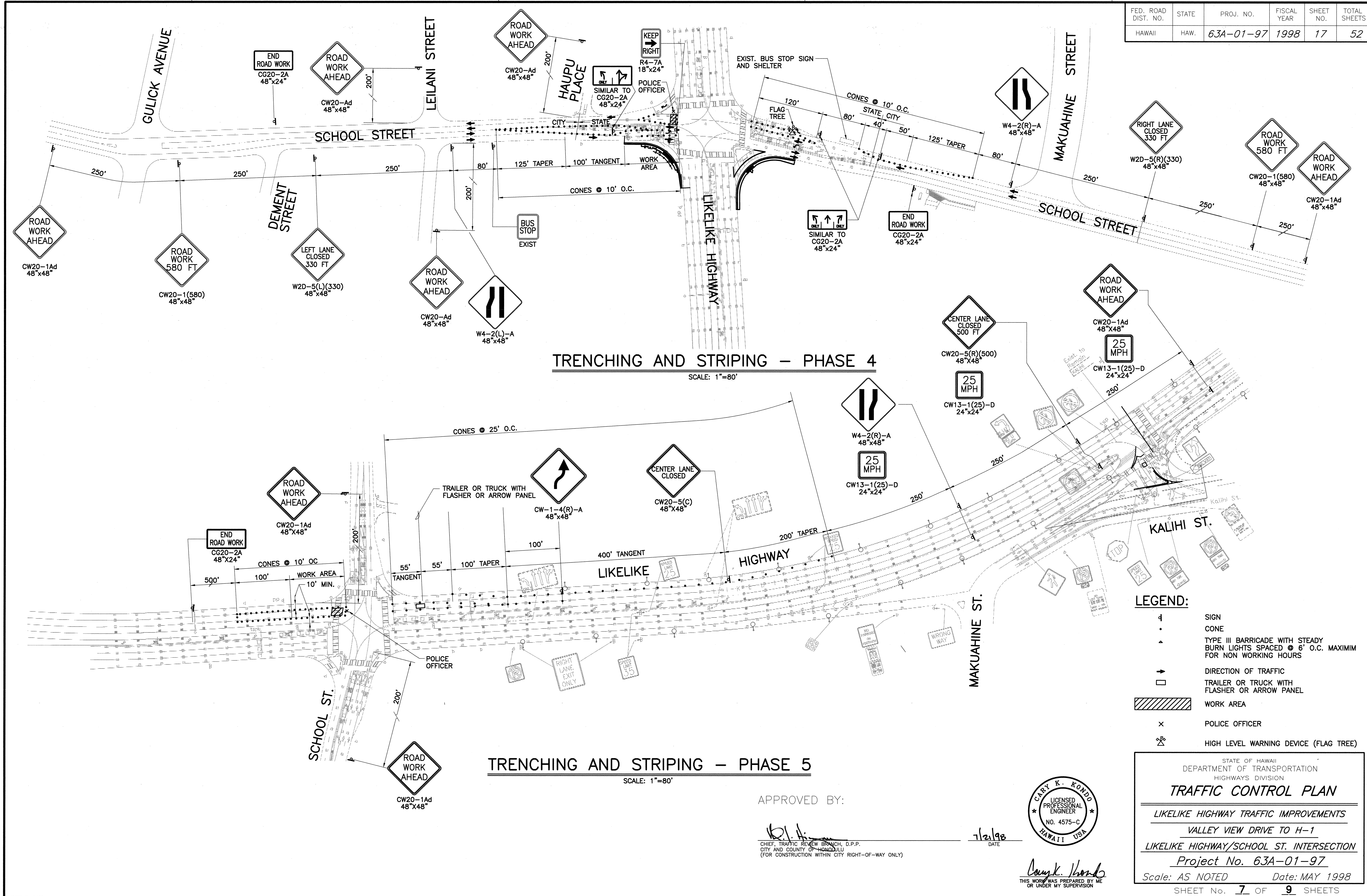

DATE	_____
SURVEY PLOTTED BY	_____
DRAWN BY	_____
TRACED BY	_____
QUANTITIES BY	_____
CHECKED BY	_____
ORIGINAL PLAN	_____
NOTE BOOK	_____
No.	_____





FED. ROAD DIST. NO.	STATE	PROJ. NO.	FISCAL YEAR	SHEET NO.	TOTAL SHEETS
HAWAII	HAW.	63A-01-97	1998	19	52

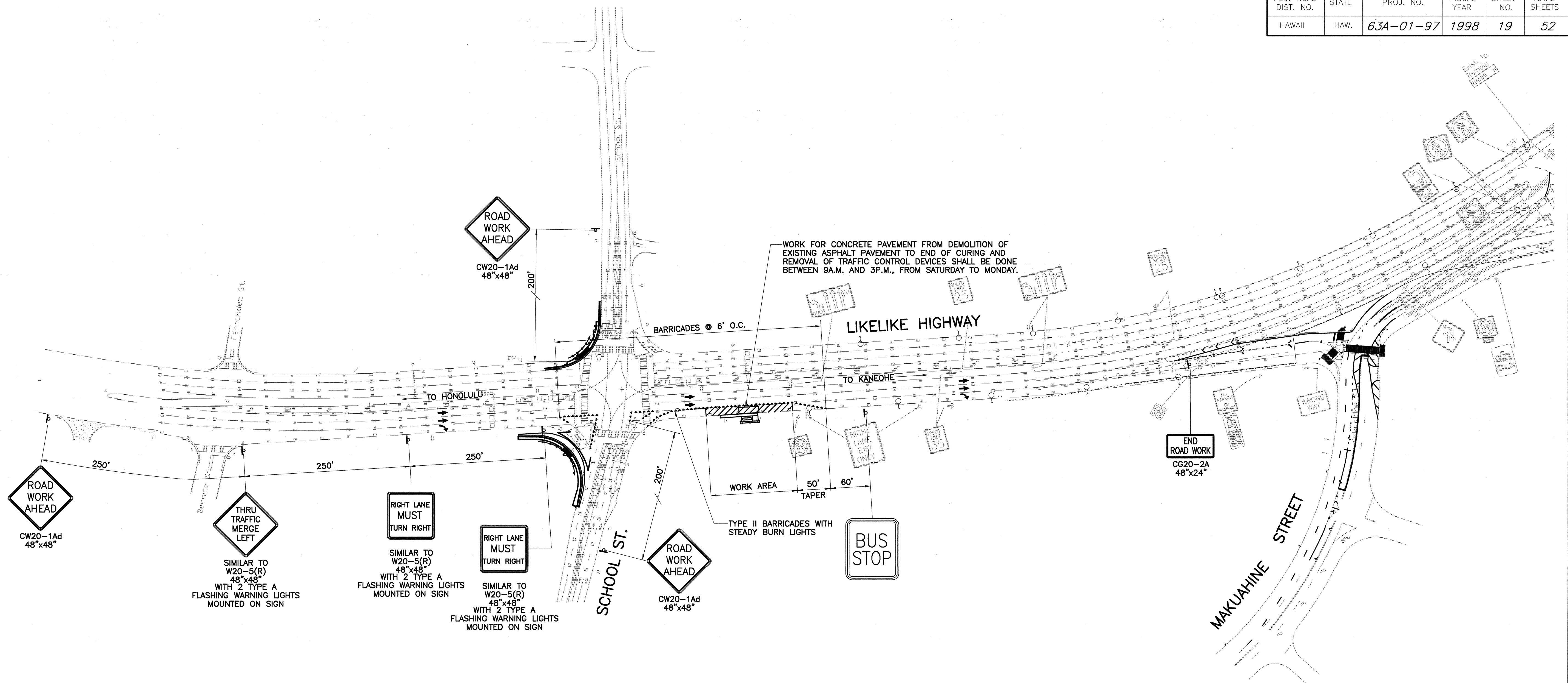

TRAFFIC CONTROL PLAN FOR CONCRETE PAVEMENT

SCALE: 1"=80'

- LEGEND:
- SIGN
  - CONE
  - TYPE III BARRICADE WITH STEADY BURN LIGHTS SPACED @ 6' O.C. MAXIMUM FOR NON WORKING HOURS
  - DIRECTION OF TRAFFIC
  - TRAILER OR TRUCK WITH FLASHER OR ARROW PANEL
  - WORK AREA
  - POLICE OFFICER
  - HIGH LEVEL WARNING DEVICE (FLAG TREE)

SURVEY PLOTTED BY	DATE
DRAWN BY	
DESIGNED BY	
QUANTITIES BY	
CHECKED BY	

ORIGINAL PLAN	No.
NOTE BOOK	
CHECKED BY	

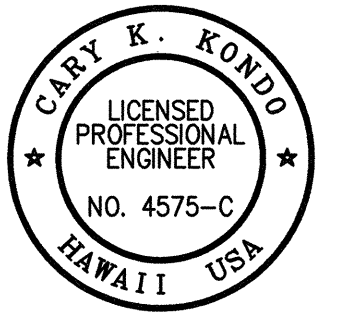

THIS WORK WAS PREPARED BY ME OR UNDER MY SUPERVISION

STATE OF HAWAII  
DEPARTMENT OF TRANSPORTATION  
HIGHWAYS DIVISION

**TRAFFIC CONTROL PLAN**

LIKELIKE HIGHWAY TRAFFIC IMPROVEMENTS  
VALLEY VIEW DRIVE TO H-1  
LIKELIKE HIGHWAY/SCHOOL ST. INTERSECTION  
Project No. 63A-01-97

Scale: AS NOTED Date: MAY 1998

SHEET No. 9 OF 9 SHEETS