

DEPARTMENT OF PUBLIC WORKS
CITY & COUNTY OF HONOLULU
DIVISION OF ENGINEERING
JOB NO. 12-63
IMPROVEMENT DISTRICT NO. 162
KAHALUU CUTOFF ROAD
Kaneohe, Heeia, Ahuimanu and Kahaluu, Koolau Poko, Oahu
FINAL REPORT: JUNE 27, 1963

COMMUNITY PLANNING INCORPORATED
CIVIL ENGINEERS-SURVEYORS-CONSULTANT PLANNERS
233 MERCHANT ST. HONOLULU, OAHU

DIVISION OF ENGINEERING
Room 202
City Hall
Honolulu, Hawaii

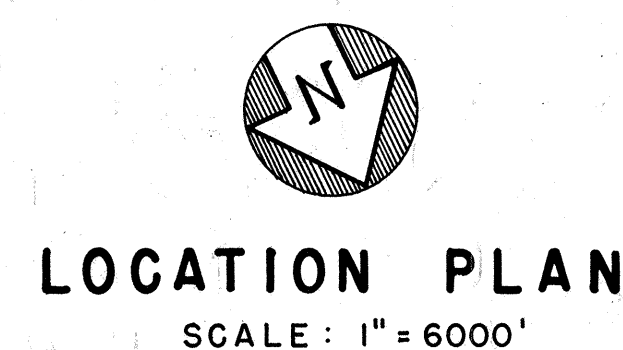
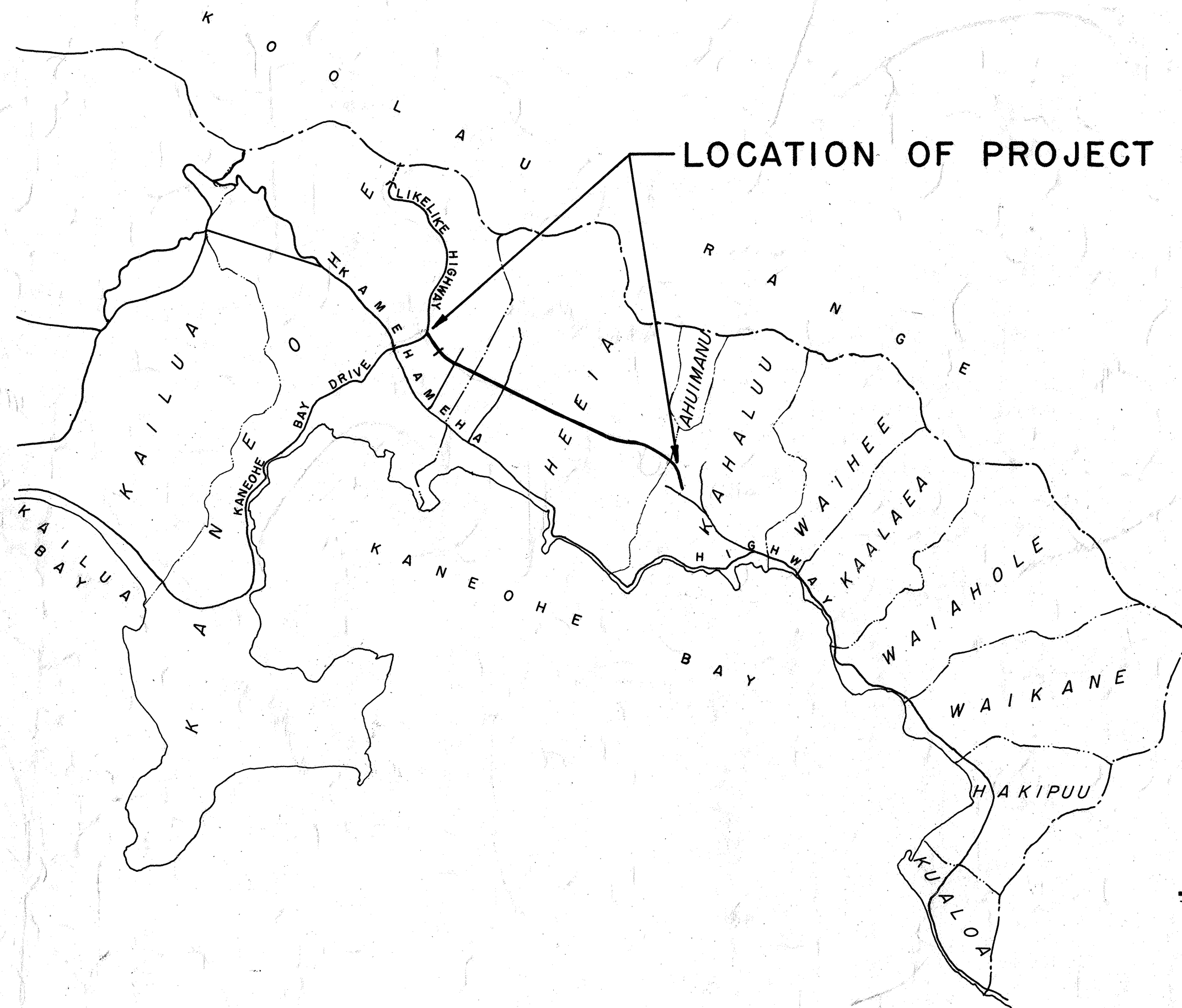

TAX MAP KEY:
4-5-23 & 26
4-6-00, 12 & 14
4-7-04 & 30

INDEX

DESCRIPTION	SHEET NO.
TITLE SHEET	1
GENERAL LAYOUT	2
GENERAL NOTES	3
TYPICAL ROADWAY CROSS SECTION	4
PLAN AND PROFILE	5 THRU 26
KAHALUU CUTOFF ROAD	5 THRU 22
LIKELIKE HIGHWAY	23
SERVICE ROAD (PASTURE)	24
SERVICE ROAD (HOME)	25
TEMPORARY ACCESS ROAD	26
ROAD CROSS SECTION	27 THRU 45
KAHALUU CUTOFF ROAD	27 THRU 41
LIKELIKE HIGHWAY	41 THRU 42
DRAINAGE CHANNEL	43 THRU 44
TEMPORARY ACCESS ROAD	45
DRAINAGE DET. (HDWS, DR. INLET, GRATE & FRAME) AND EMB. CONST. DET.	46 THRU 49
HEEIA STREAM DBLE 7.5' x 12' R.C. BOX CULVERT	50
AHUIMANU DBLE 6' x 12' R.C. BOX CULVERT	51
STORM DRAIN MANHOLES	52
DROP INTAKES, RET. WALLS, HDWS, CONST. JOINTS	53
CATCH BASINS AND MANHOLE CASTINGS	54
GUARDRAIL DETAILS	55
FENCES, GATES, GUARDRAILS	56
MONUMENTS, SIGNS & LOCATION OF SIGNS	57
STREET NAME SIGNS	58
STREET LIGHTING DETAILS	59
WATER DETAILS	60
KUAHULU PL. DBLE 5' x 5' R.C. BOX CULVERT	61
KENEKE ST. DBLE 5' x 5' R.C. BOX CULVERT	62

APPROVED:

ACTING PLANNING DIRECTOR, PLANNING DEPT.
CHIEF ENGINEER, DEPT. OF PUBLIC WORKS.
DIRECTOR, DEPT. OF TRANSPORTATION
STATE OF HAWAII
MGR. & CHIEF ENGINEER, BOARD OF
WATER SUPPLY.
TRAFFIC ENGINEER, DEPT. OF TRAFFIC

9-28-62
DATE
9-28-62
DATE
9/7/62
DATE
8/10/62
DATE
8/17/62
DATE