

FED. ROAD DIST. NO.	STATE	PROJ. NO.	FISCAL YEAR	SHEET NO.	TOTAL SHEETS
HAWAII	HAW.	61C-01-04M	2004	31	91

**NOTE:**

Tack Coat faces of Existing Asphalt Bound Materials prior to filling excavation with New Asphalt bound materials.

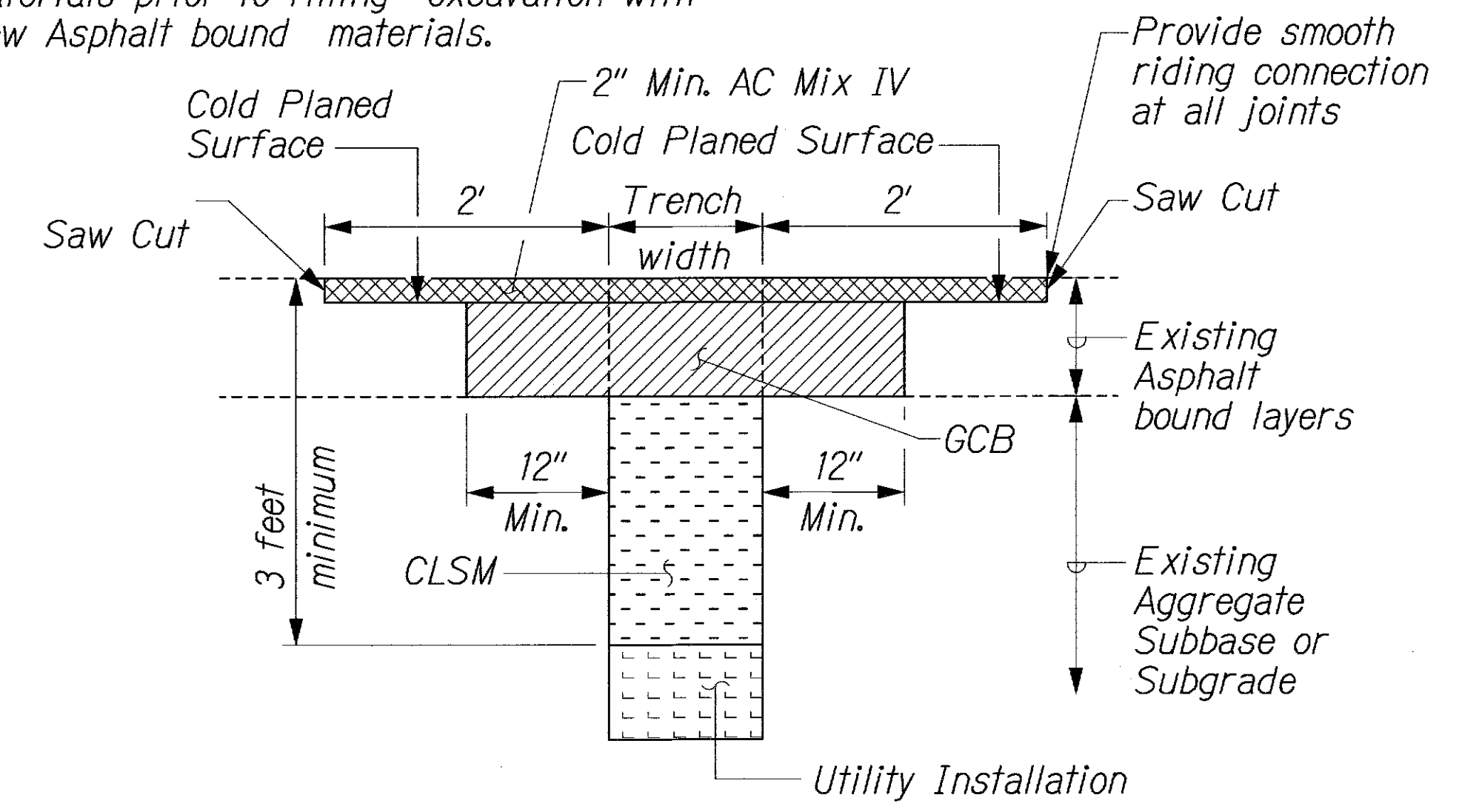

**ASPHALT PAVEMENT RESTORATION  
OVER TRENCH EXCAVATION**

Not to Scale

**WATER NOTES:**

1. This water service lateral connection is required for a temporary irrigation system for the project. Once the landscaping has been accepted by the State Department of Transportation, the existing 1 1/2" water meter shall be removed by BWS after service holder terminates service and requests removal of meter. Contractor to cut and plug lateral at main, and remove and dispose of existing meter box. (The \$360 cut & plug charge to be refunded, once BWS inspector confirms it has been completed)
2. The Contractor shall apply and pay for a temporary water meter from the BWS. The Contractor shall be responsible for the payment of the water service for the duration of the plant establishment period.
3. Unless otherwise specified, all materials and construction of water system facilities and appurtenances shall be in accordance with the STANDARD SPECIFICATIONS FOR ROAD, BRIDGE, PUBLIC WORKS CONSTRUCTION, dated 1994, as amended, of the Hawaii Highways Division, Department of Transportation, and the City and County of Honolulu, Board of Water Supply's "WATER SYSTEM STANDARDS", DATED 2002, THE "WATER SYSTEM EXTERNAL CORROSION CONTROL STANDARDS", VOLUME 3, DATED 1991, and all subsequent amendments and additions.
4. The Contractor shall notify the Board of Water Supply in writing one week prior to commencing work on the water system.
5. The Contractor shall be solely responsible for all assumptions, deductions, or conclusions he/she may make or derive from the subsurface information or data furnished on the plans. The Contractor must satisfy himself/herself through his/her own investigations as to what subsurface conditions are to be encountered.
6. See additional Board of Water Supply notes on Sheet N-5.

ORIGINAL PLAN	SURVEY PLOTTED BY	DATE
NOTE BOOK	DRAWN BY	
	TRACED BY	
	QUANTITIES BY	
	CHECKED BY	

U-CASTLE JUNCTION/MSO/UTL/Idgn

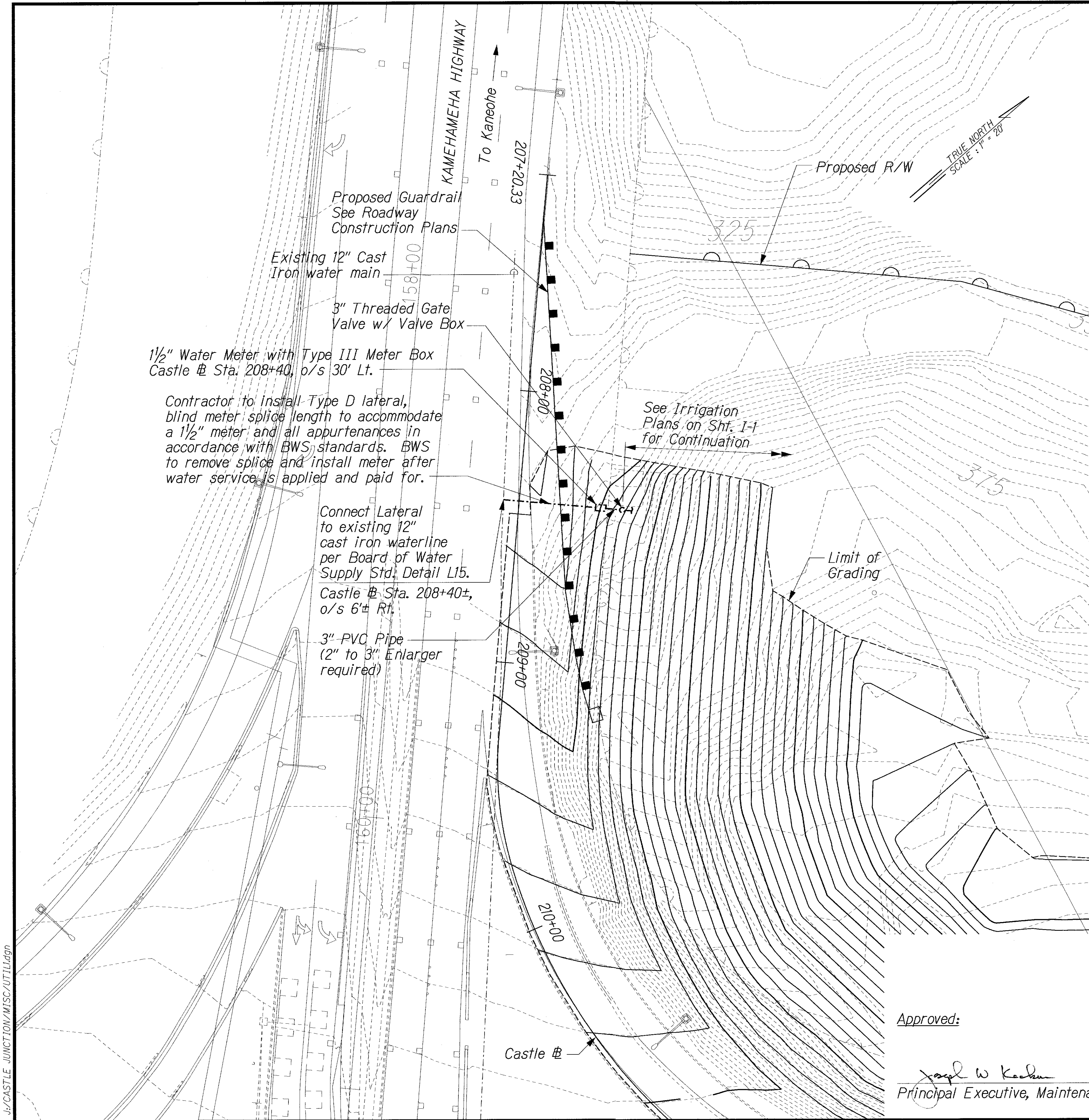

Approved:

*Joseph W. Kachun*  
Principal Executive, Maintenance Unit, BWS Date 10/2/03

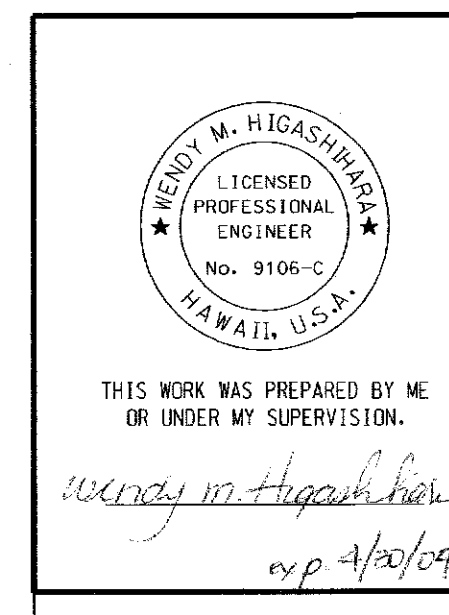

STATE OF HAWAII  
DEPARTMENT OF TRANSPORTATION  
HIGHWAYS DIVISION

**WATER PLAN**

KALANIANA'OLE HIGHWAY  
EMERGENCY LANDSLIDE REPAIRS AT CASTLE JUNCTION

PROJECT NO. 61C-01-04M  
Scale: 1"=20' Date: Sept. 26, 2003

SHEET No. U-1 OF 2 SHEETS

10/2/03  
Date