

FED. ROAD DIST. NO.	STATE	PROJ. NO.	FISCAL YEAR	SHEET NO.	TOTAL SHEETS
HAWAII	HAW.	61C-01-04M	2004	38	91

GENERAL NOTES FOR TRAFFIC CONTROL PLAN

1. Only Traffic Control Plans for major construction activities are shown. The Contractor shall develop his own Traffic Control Plans in accordance with Section 645 of the Special Provisions for activities to complete work not covered by the Traffic Control Plans. The Contractor shall submit the Traffic Control Plans to the Engineer for approval. Payment for development and implementation of the Traffic Control Plans shall be considered incidental to the various contract items.

2. All lane closures and traffic pattern changes (detours) not shown on the plan shall be submitted to the Engineer for approval in accordance with Specifications Section 645-Traffic Control. For restrictions on lane closures, detours, construction work during peak hours, and other requirements regarding maintaining vehicular and pedestrian traffic, see Section 107.13 - Public Convenience and Safety, Section 645-Traffic Control, and Section 104.04 - Maintenance of Traffic.

3. The Contractor shall make minor adjustments at intersections, driveways, bridges, structures, etc. to fit field conditions.

4. Cones or delineators shall be extended to a point where they are visible to approaching traffic.

5. Traffic control devices shall be installed such that the sign or device farthest from the work area shall be placed first. The others shall then be placed progressively toward the work area.

6. Flaggers and/or police officers shall be in sight of each other or in direct communications at all times.

7. When required by the Resident Engineer, the Contractor shall install a flashing arrow board.

8. Sign spacings (L), taper lengths (T), and spacings of cones or delineators shall be as shown in Table 1 of Section 645 in the Specifications, unless otherwise noted on the Traffic Control Plans.

9. All traffic lanes shall be minimum of 11 feet wide.

10. All construction warning signs shall be promptly removed or covered whenever the message is not applicable or not in use.

11. The backs of all signs for traffic control shall be appropriately covered to preclude the display of inapplicable sign messages (i.e., when signs have messages on both faces).

12. At the end of each day's work or as soon as the work is completed, the Contractor shall remove all traffic control devices no longer needed to permit free and safe passage of public traffic. Removal shall be in the reverse order of installation.

13. Replace permanent pavement markings and traffic signs upon completion of each phase of work.
14. Existing conflicting pavement markings shall be removed and temporary pavement markings shall be installed before traffic patterns are changed. After completion of the work, temporary pavement markings shall be removed. Payment for removal of existing pavement markings; and furnishing, installing, and removal of temporary pavement markings, whether or not shown on the Traffic Control Plans shall be considered incidental to the various contract items.

15. The locations of pavement markings, signs, and delineators used in the Traffic Control shall be as shown on the plans and/or as determined in the field by the Engineer.

16. Damage to signs, temporary pavement markers, and delineators caused by the public shall be repaired or replaced by the Contractor as directed by the Engineer and paid for under Section 645. Damage caused by the Contractor's negligence shall be repaired or replaced at the Contractor's expense.

17. During working and non-working hours, the Contractor shall furnish, install, and maintain Type I Barricades at 10' spacing in new and existing pavement areas closed to public vehicles.

18. The Contractor shall provide sand bags or other accepted weights for the Type I Barricades, when used. The Contractor shall provide steady burn amber lamps during hours of darkness. The lamps shall be attached on the Type I Barricade end closest to the traveled way. The lamp should be visible to the motorist. Payment for Type I Barricades with amber lamps shall be considered incidental to the various contract items.

19. Contractor shall maintain access to adjacent properties at all times.

20. Cones and signs for night work shall be retroreflective.

21. The Contractor shall provide a transition taper during non-construction hours for open trenches adjacent to the travelway. See Transition Taper Detail this sheet.

22. Steel plates for covering trenches shall have a skid resistant surface. Payment for steel plates shall be considered incidental to the various contract items.

23. The Contractor shall limit the extent of trench and excavation work for pavement reconstruction to an area that can be satisfactorily backfilled in one work day.

LEGEND:

- • •

Cones
- ↑

Portable Arrow Board
- Direction of Traffic
- New Sign
- ◻

Existing Sign
- ▨

Work Area

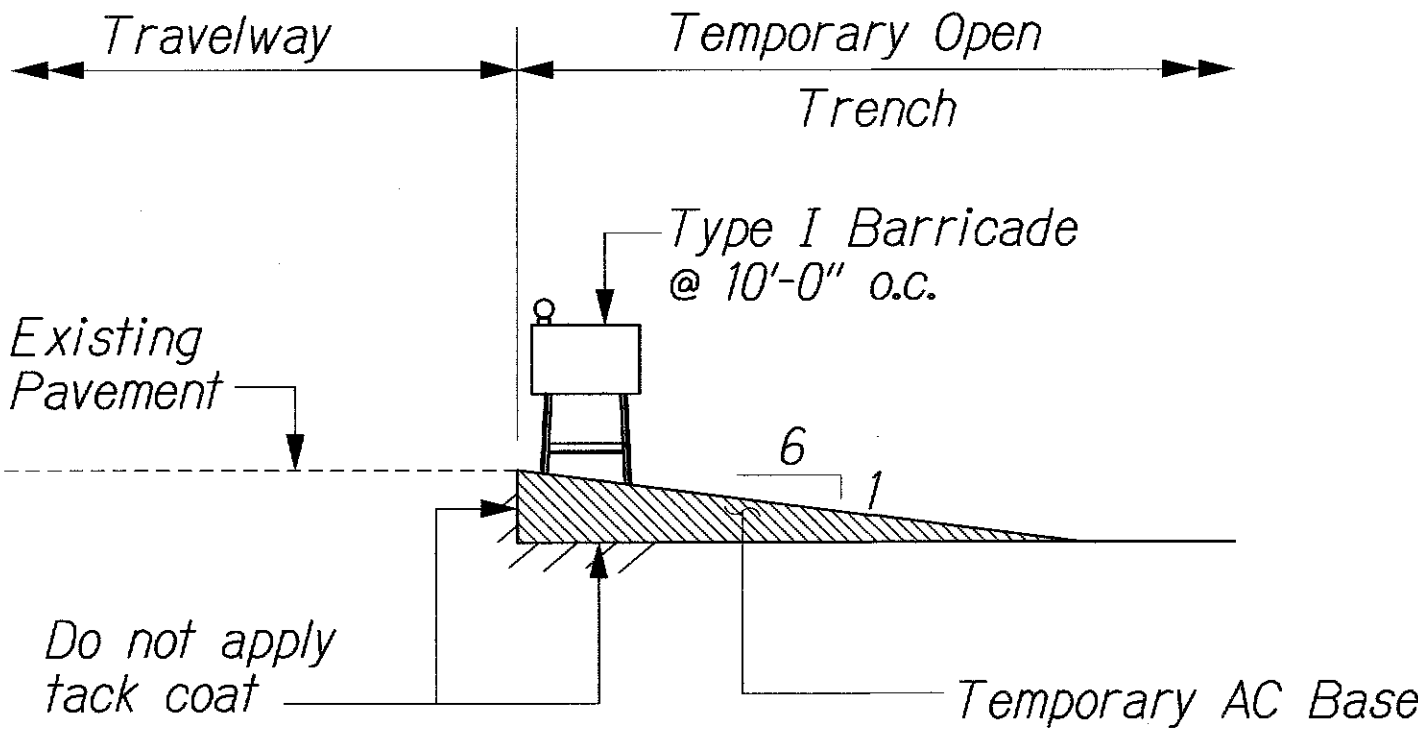

NOTE:

Contractor shall install & maintain appropriate construction warning signs. Payment for furnishing, installing and removing construction warning signs shall be considered incidental to the various contract items.

(Remove prior to pavement construction) Payment for construction and removal of Temporary AC Base shall be considered incidental to the various contract items.

TRANSITION TAPER

Not To Scale

SURVEY PLOTTED BY	DATE
DRAWN BY	
DESIGNED BY	
QUANTITIES BY	
CHECKED BY	
ORIGINAL PLAN	
NOTE BOOK	
No.	

RANDALL M. URASAKI

LICENSED PROFESSIONAL ENGINEER

No. 7269-C

HAWAII, U.S.A.

THIS WORK WAS PREPARED BY ME OR UNDER MY SUPERVISION.

*[Signature]*

4/26/04

STATE OF HAWAII

DEPARTMENT OF TRANSPORTATION

HIGHWAYS DIVISION

TRAFFIC CONTROL NOTES

AND LEGEND

KALANIANA'OLE HIGHWAY

EMERGENCY LANDSLIDE REPAIRS AT CASTLE JUNCTION

PROJECT NO. 61C-01-04M

Scale: None Date: Sept. 26, 2003

SHEET No. D-1 OF 4 SHEETS