

FED. ROAD DIST. NO.	STATE	FED. AID PROJ. NO.	FISCAL YEAR	SHEET NO.	TOTAL SHEETS
HAWAII	HAW.	NH-061-1(036)	2020	ADD. 84	238

TRUE NORTH
SCALE: 1" = 40'

BEGIN PROJECT
Federal-Aid
Project No. NH-061-1(036)
Sta. 10+38.91

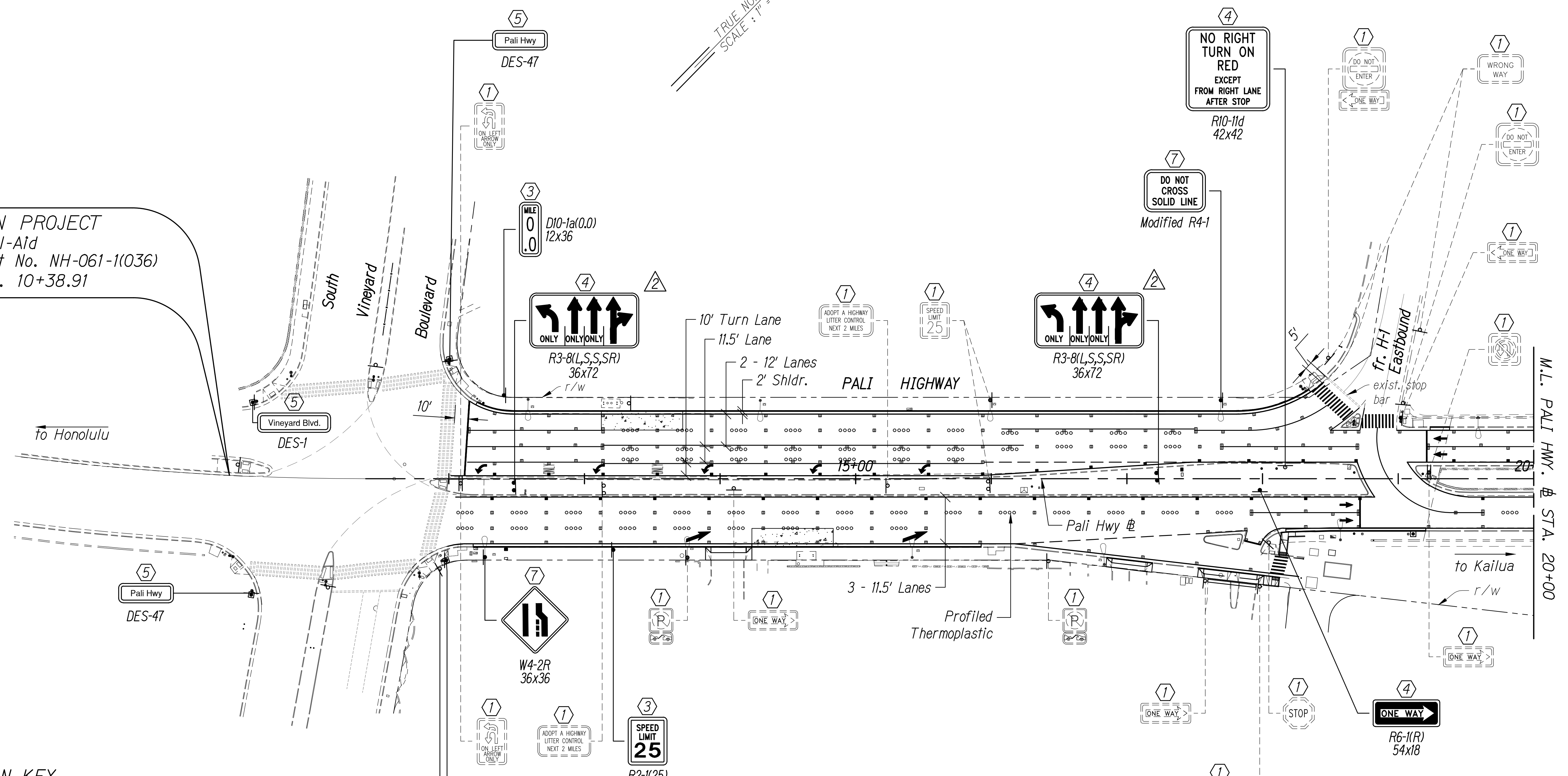

- SIGN KEY**
- ① Existing Sign and Post(s) to Remain
 - ② Remove Existing Sign and Post
 - ③ Install New Sign(s) w/Steel Post(s) and RM-3(s)
 - ④ Remove Existing Sign and Post(s) and Install New Sign(s) w/Post(s) and RM-3(s)
 - ⑤ Remove Existing Sign on Mast Arm and Install New Sign(s) on Traffic Signal Mast Arm
 - ⑥ Remove Existing Sign on Type I Pole and Install New Sign(s) on Traffic Signal Pole
 - ⑦ Remove Existing Sign(s) on Light Post and Install New Sign(s) on Light Post

SURVEY PLOTTED BY	DATE
DRAWN BY	
TRACED BY	
DESIGNED BY	
CHECKED BY	
NOTE BOOK	
N ^o .	

SIGNING AND STRIPING PLAN
Scale: 1"=40'

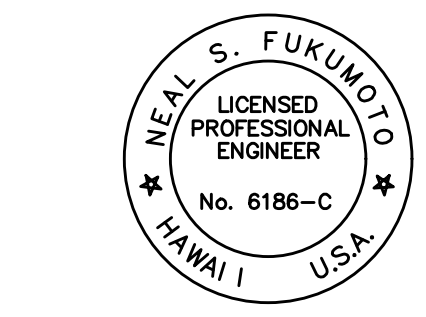

This work was prepared by me or under my supervision.
Exp. 04-30-22
Neal S. Fukumoto
Wesley R. Segawa & Associates, Inc.

9/3/20	② Revised Sign
DATE	DESCRIPTION
STATE OF HAWAII DEPARTMENT OF TRANSPORTATION HIGHWAYS DIVISION	
SIGNING AND STRIPING PLAN	
PALI HIGHWAY RESURFACING Vineyard Boulevard to Waokanaka Street Federal-Aid Project No. NH-061-1(036)	
Scale: 1"=40'	Date: April 2020
SHEET No. CL1 OF 14 SHEETS	

FED. ROAD DIST. NO.	STATE	FED. AID PROJ. NO.	FISCAL YEAR	SHEET NO.	TOTAL SHEETS
HAWAII	HAW.	NH-061-1(036)	2020	85	238

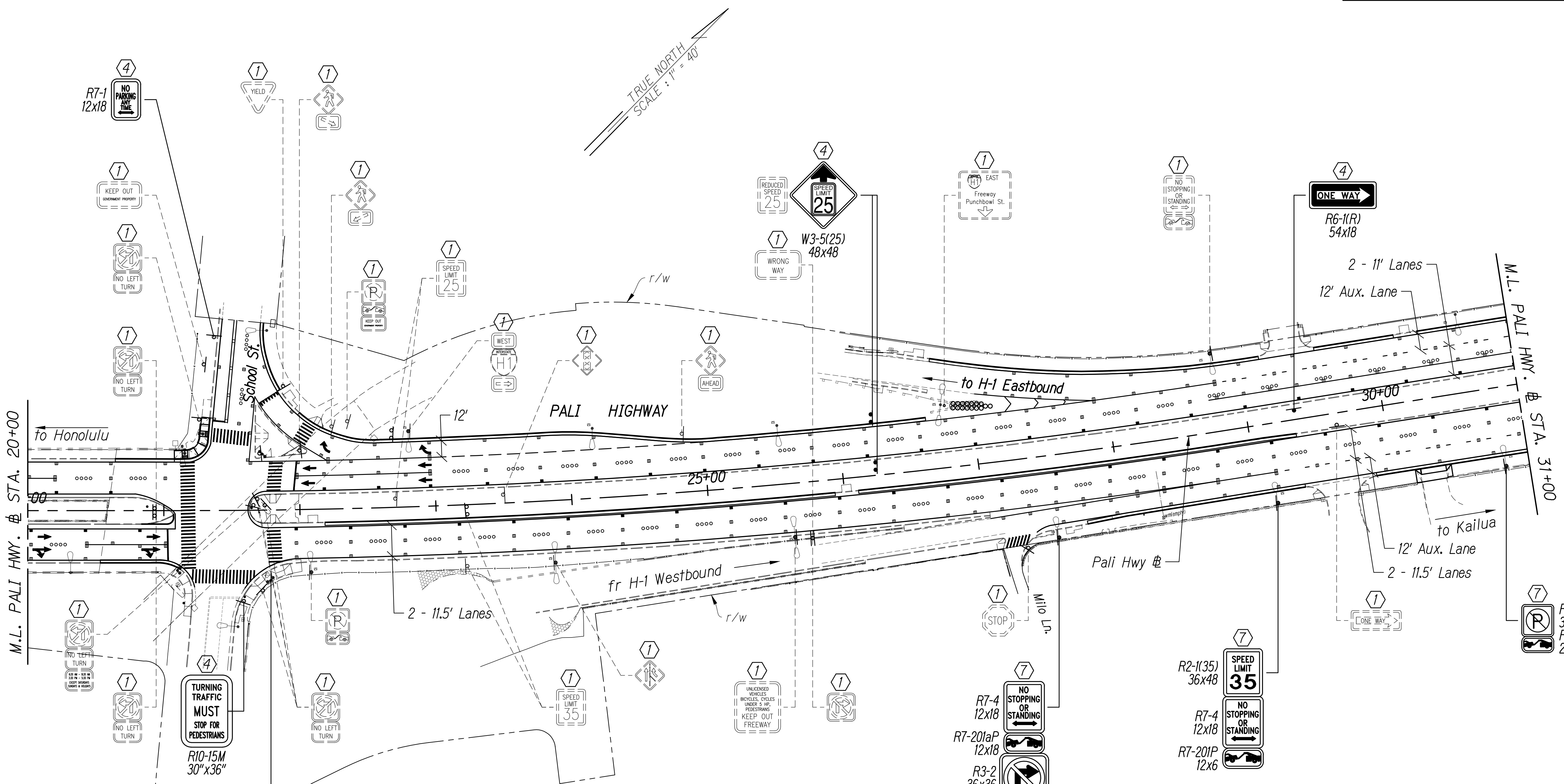

SIGN KEY

- ① Existing Sign and Post(s) to Remain
- ② Remove Existing Sign and Post
- ③ Install New Sign(s) w/Steel Post(s) and RM-3(s)
- ④ Remove Existing Sign and Post(s) and Install New Sign(s) w/Post(s) and RM-3(s)
- ⑤ Remove Existing Sign on Mast Arm and Install New Sign(s) on Traffic Signal Mast Arm
- ⑥ Remove Existing Sign on Type I Pole and Install New Sign(s) on Traffic Signal Pole
- ⑦ Remove Existing Sign(s) on Light Post and Install New Sign(s) on Light Post

④ Pali Hwy DES-2
 ⑥ School St DES-3

TURNING TRAFFIC MUST STOP FOR PEDESTRIANS
 R10-15M 30"x36"

SURVEY PLOTTED BY	DATE
DRAWN BY	
TRACED BY	
DESIGNED BY	
CHECKED BY	
ORIGINAL PLAN	
NOTE BOOK	

SIGNING AND STRIPING PLAN
 Scale: 1"=40'

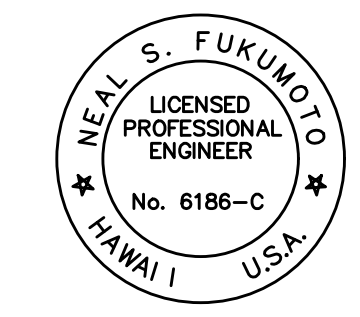

This work was prepared by me or under my supervision.
 Exp. 04-30-22
 Wesley R. Segawa & Associates, Inc.

STATE OF HAWAII
 DEPARTMENT OF TRANSPORTATION
 HIGHWAYS DIVISION

SIGNING AND STRIPING PLAN

PALI HIGHWAY RESURFACING
 Vineyard Boulevard to Waokanaka Street
 Federal-Aid Project No. NH-061-1(036)

Scale: 1"=40' Date: April 2020

SHEET No. CL2 OF 14 SHEETS

FED. ROAD DIST. NO.	STATE	FED. AID PROJ. NO.	FISCAL YEAR	SHEET NO.	TOTAL SHEETS
HAWAII	HAW.	NH-061-1(036)	2020	86	238

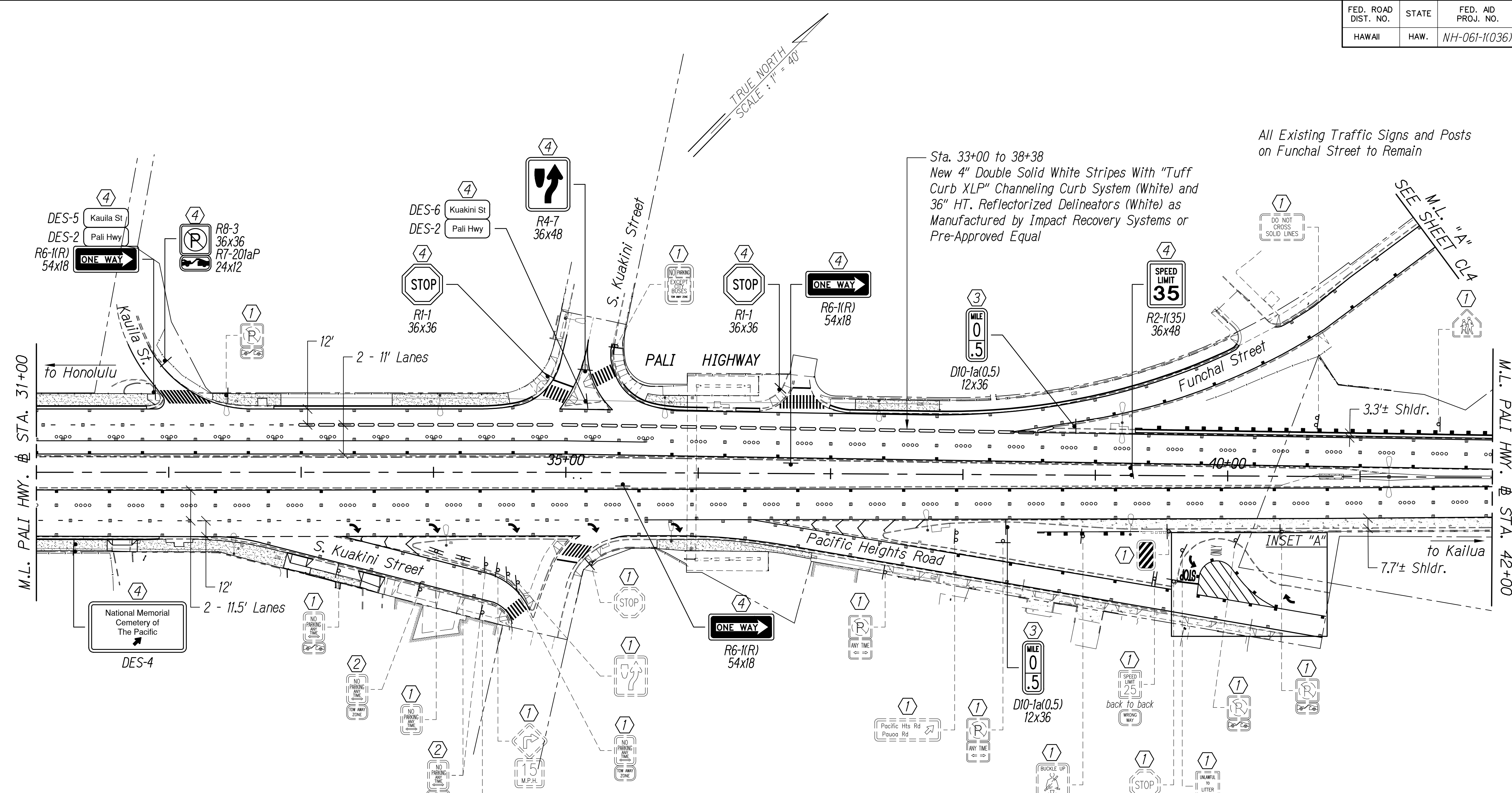

All Existing Traffic Signs and Posts on Funchal Street to Remain

Sta. 33+00 to 38+38
New 4" Double Solid White Stripes With "Tuff Curb XLP" Channeling Curb System (White) and 36" HT. ReflectORIZED Delineators (White) as Manufactured by Impact Recovery Systems or Pre-Approved Equal

SEE M.I. "A"

M.L. PALI HWY. # STA. 31+00

M.L. PALI HWY. # STA. 42+00

SIGN KEY

- ① Existing Sign and Post(s) to Remain
- ② Remove Existing Sign and Post
- ③ Install New Sign(s) w/Steel Post(s) and RM-3(s)
- ④ Remove Existing Sign and Post(s) and Install New Sign(s) w/Post(s) and RM-3(s)
- ⑤ Remove Existing Sign on Mast Arm and Install New Sign(s) on Traffic Signal Mast Arm
- ⑥ Remove Existing Sign on Type I Pole and Install New Sign(s) on Traffic Signal Pole
- ⑦ Remove Existing Sign(s) on Light Post and Install New Sign(s) on Light Post

SIGNING AND STRIPING PLAN

Scale: 1"=40'

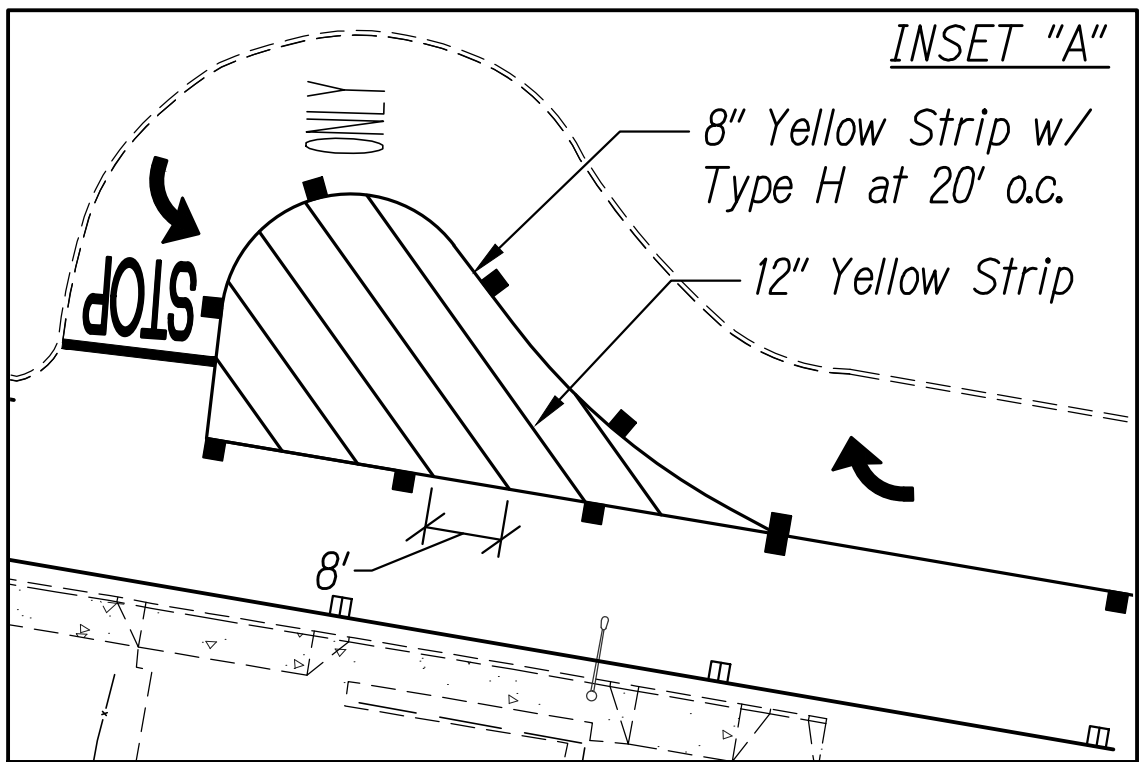

SURVEY PLOTTED BY	DATE
DRAWN BY	
TRACED BY	
DESIGNED BY	
CHECKED BY	
ORIGINAL PLAN	
NOTE BOOK	

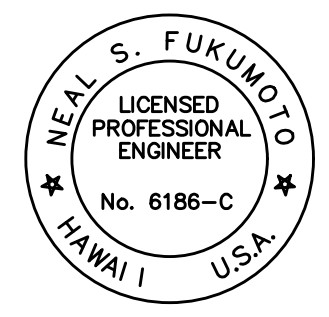

This work was prepared by me or under my supervision.
Exp. 04-30-22
Neal S. Fukumoto
Wesley R. Segawa & Associates, Inc.

STATE OF HAWAII
DEPARTMENT OF TRANSPORTATION
HIGHWAYS DIVISION

SIGNING AND STRIPING PLAN

PALI HIGHWAY RESURFACING
Vineyard Boulevard to Waokanaka Street
Federal-Aid Project No. NH-061-1(036)

Scale: 1"=40' Date: April 2020
SHEET No. CL3 OF 14 SHEETS

FED. ROAD DIST. NO.	STATE	FED. AID PROJ. NO.	FISCAL YEAR	SHEET NO.	TOTAL SHEETS
HAWAII	HAW.	NH-061-1(036)	2020	87	238

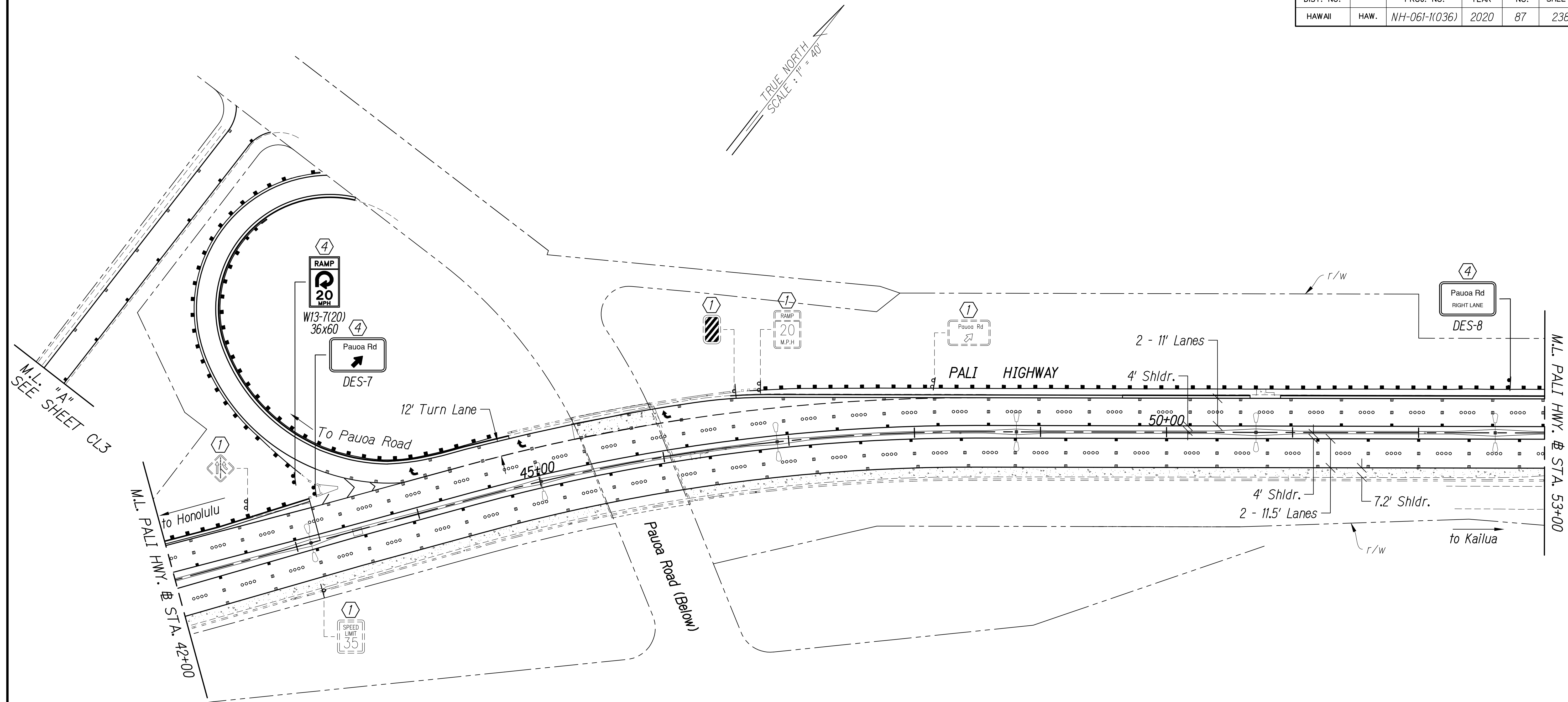

SURVEY PLOTTED BY	DATE
DRAWN BY	
DESIGNED BY	
CHECKED BY	
ORIGINAL PLAN	
NOTE BOOK	
No.	

SIGN KEY

- ① Existing Sign and Post(s) to Remain
- ② Remove Existing Sign and Post
- ③ Install New Sign(s) w/Steel Post(s) and RM-3(s)
- ④ Remove Existing Sign and Post(s) and Install New Sign(s) w/Post(s) and RM-3(s)
- ⑤ Remove Existing Sign on Mast Arm and Install New Sign(s) on Traffic Signal Mast Arm
- ⑥ Remove Existing Sign on Type I Pole and Install New Sign(s) on Traffic Signal Pole
- ⑦ Remove Existing Sign(s) on Light Post and Install New Sign(s) on Light Post

SIGNING AND STRIPING PLAN
Scale: 1"=40'

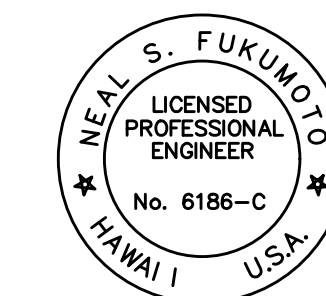

This work was prepared by me or under my supervision.
Exp. 04-30-22
Neal S. Fukumoto
Wesley R. Segawa & Associates, Inc.

STATE OF HAWAII
DEPARTMENT OF TRANSPORTATION
HIGHWAYS DIVISION

SIGNING AND STRIPING PLAN

PALI HIGHWAY RESURFACING
Vineyard Boulevard to Waokanaka Street
Federal-Aid Project No. NH-061-1(036)

Scale: 1"=40' Date: April 2020

SHEET No. CL04 OF 14 SHEETS

FED. ROAD DIST. NO.	STATE	FED. AID PROJ. NO.	FISCAL YEAR	SHEET NO.	TOTAL SHEETS
HAWAII	HAW.	NH-061-1(036)	2020	88	238

TRUE NORTH
SCALE: 1" = 40'

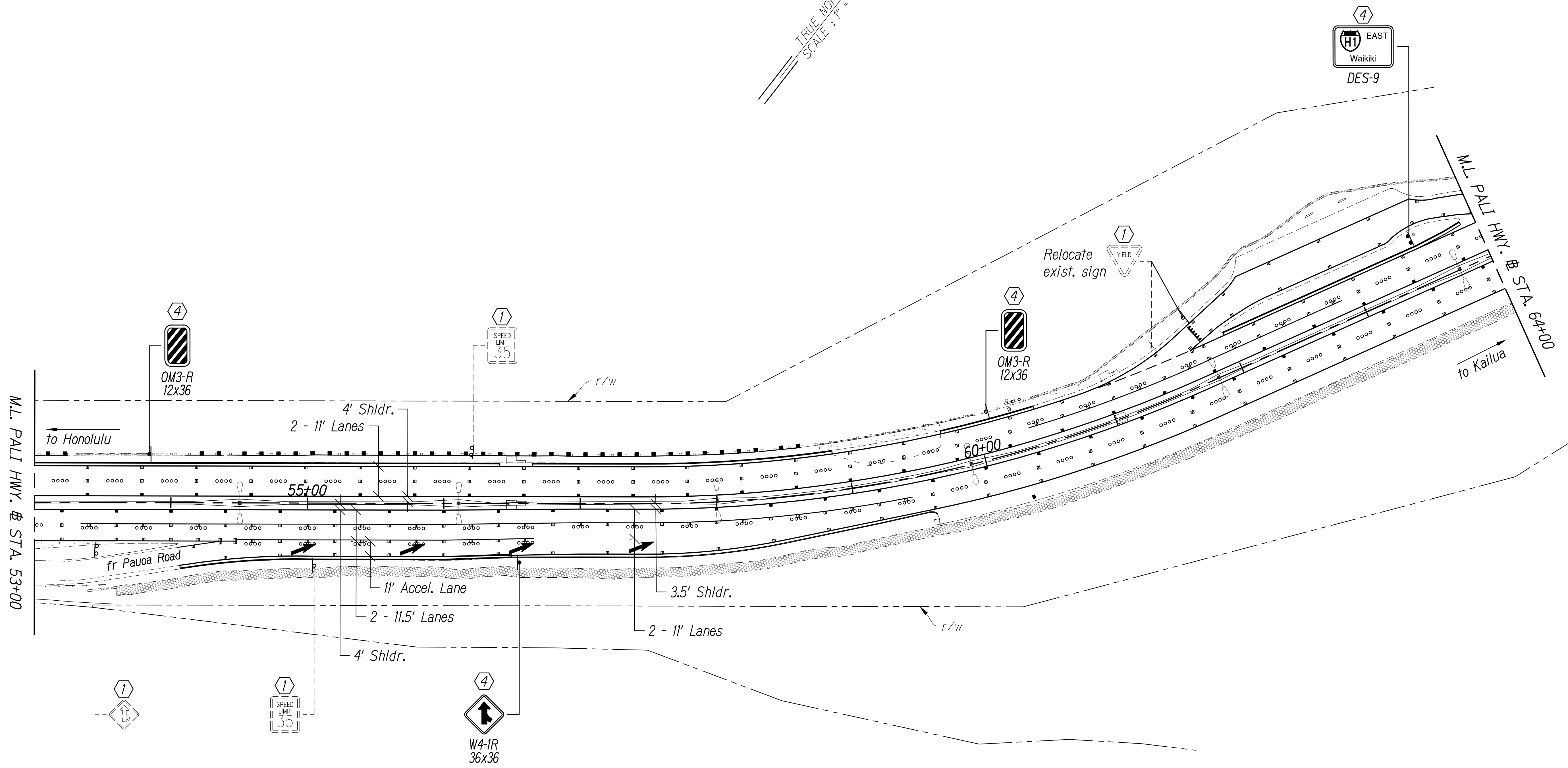

SIGN KEY

- ① Existing Sign and Post(s) to Remain
- ② Remove Existing Sign and Post
- ③ Install New Sign(s) w/Steel Post(s) and RM-3(s)
- ④ Remove Existing Sign and Post(s) and Install New Sign(s) w/Post(s) and RM-3(s)
- ⑤ Remove Existing Sign on Mast Arm and Install New Sign(s) on Traffic Signal Mast Arm
- ⑥ Remove Existing Sign on Type I Pole and Install New Sign(s) on Traffic Signal Pole
- ⑦ Remove Existing Sign(s) on Light Post and Install New Sign(s) on Light Post

SURVEY PLOTTED BY	DATE
DRAWN BY	
TRACED BY	
DESIGNED BY	
CHECKED BY	
NOTE BOOK	
NO.	

SIGNING AND STRIPING PLAN
Scale: 1"=40'

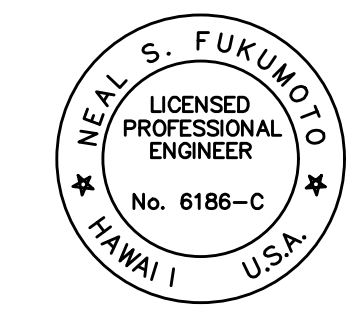

This work was prepared by me or under my supervision.
Exp. 04-30-22
Neal S. Fukumoto
Wesley R. Segawa & Associates, Inc.

STATE OF HAWAII
DEPARTMENT OF TRANSPORTATION
HIGHWAYS DIVISION

SIGNING AND STRIPING PLAN

PALI HIGHWAY RESURFACING
Vineyard Boulevard to Waokanaka Street
Federal-Aid Project No. NH-061-1(036)

Scale: 1"=40' Date: April 2020

SHEET No. CL5 OF 14 SHEETS

FED. ROAD DIST. NO.	STATE	FED. AID PROJ. NO.	FISCAL YEAR	SHEET NO.	TOTAL SHEETS
HAWAII	HAW.	NH-061-1(036)	2020	ADD. 89	238

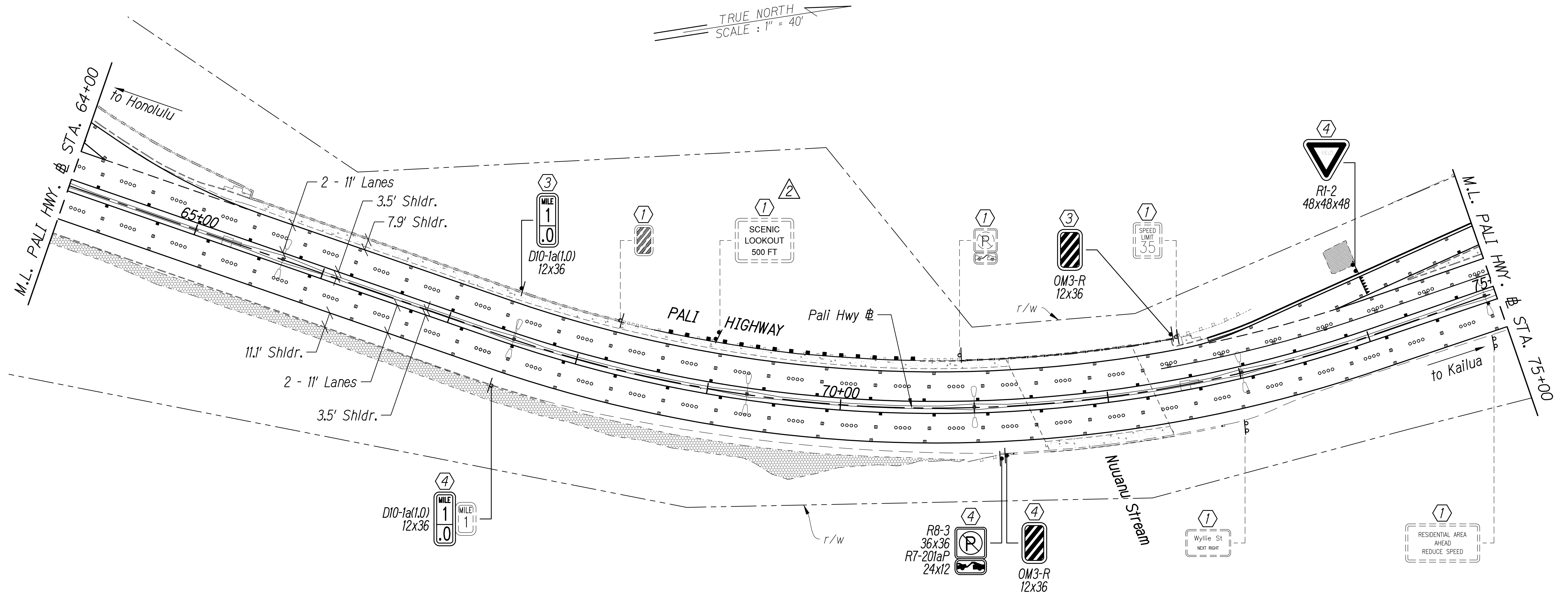

SURVEY PLOTTED BY	DATE
DRAWN BY	
TRACED BY	
DESIGNED BY	
CHECKED BY	
NOTE BOOK	
NO.	

SIGN KEY

- ① Existing Sign and Post(s) to Remain
- ② Remove Existing Sign and Post
- ③ Install New Sign(s) w/Steel Post(s) and RM-3(s)
- ④ Remove Existing Sign and Post(s) and Install New Sign(s) w/Post(s) and RM-3(s)
- ⑤ Remove Existing Sign on Mast Arm and Install New Sign(s) on Traffic Signal Mast Arm
- ⑥ Remove Existing Sign on Type I Pole and Install New Sign(s) on Traffic Signal Pole
- ⑦ Remove Existing Sign(s) on Light Post and Install New Sign(s) on Light Post

SIGNING AND STRIPING PLAN
Scale: 1"=40'

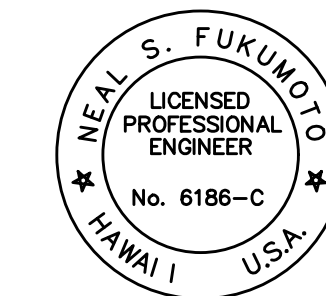

This work was prepared by me or under my supervision.
Exp. 04-30-22
Neal S. Fukumoto
Wesley R. Segawa & Associates, Inc.

9/3/20	② Revised Sign
DATE	DESCRIPTION
STATE OF HAWAII DEPARTMENT OF TRANSPORTATION HIGHWAYS DIVISION SIGNING AND STRIPING PLAN PALI HIGHWAY RESURFACING Vineyard Boulevard to Waokanaka Street Federal-Aid Project No. NH-061-1(036) Scale: 1"=40' Date: April 2020	
SHEET No. CL6 OF 14 SHEETS	

FED. ROAD DIST. NO.	STATE	FED. AID PROJ. NO.	FISCAL YEAR	SHEET NO.	TOTAL SHEETS
HAWAII	HAW.	NH-061-1(036)	2020	90	238

TRUE NORTH
SCALE: 1" = 40'

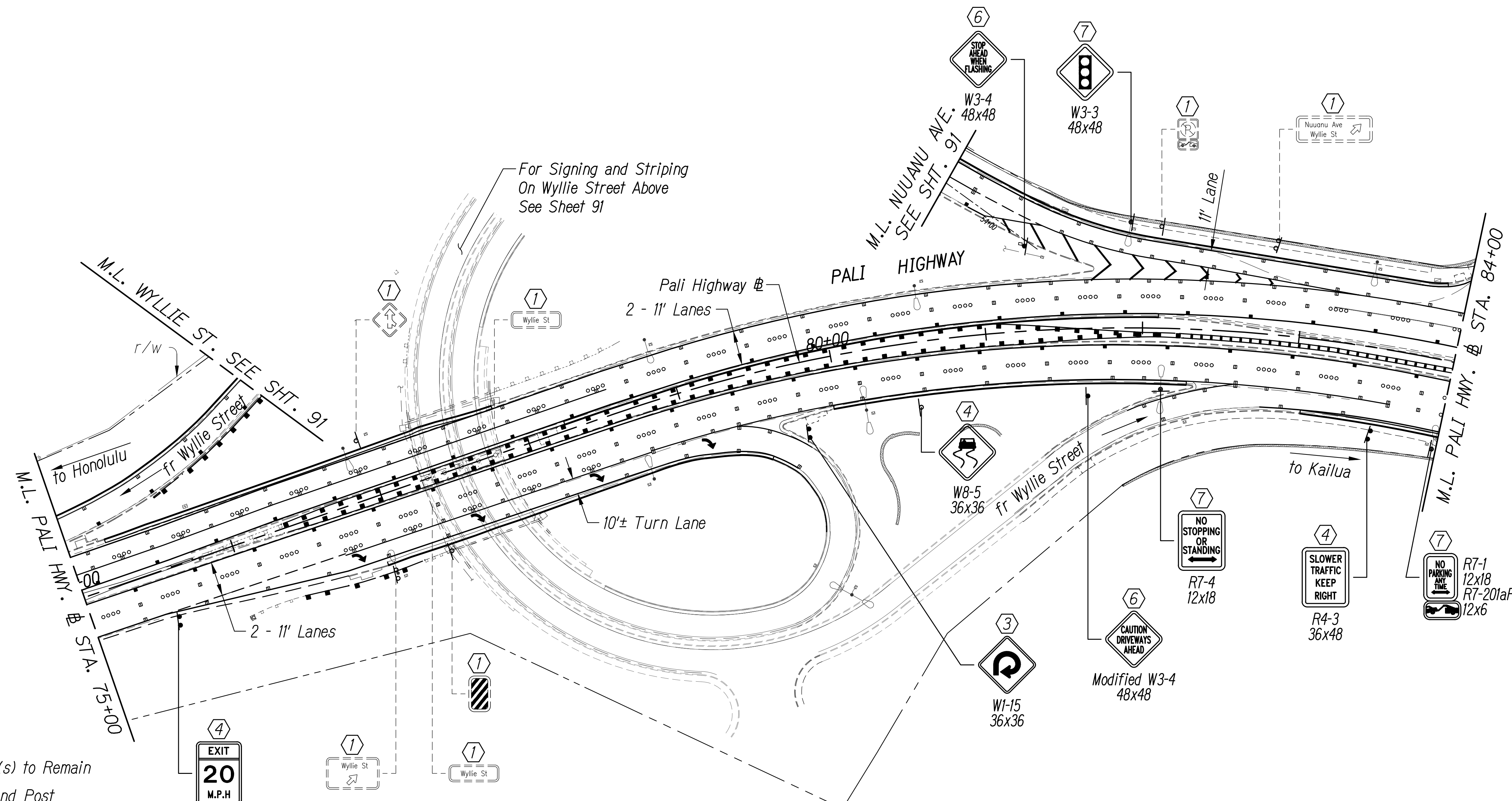

SIGN KEY

- ① Existing Sign and Post(s) to Remain
- ② Remove Existing Sign and Post
- ③ Install New Sign(s) w/Steel Post(s) and RM-3(s)
- ④ Remove Existing Sign and Post(s) and Install New Sign(s) w/Post(s) and RM-3(s)
- ⑤ Remove Existing Sign on Mast Arm and Install New Sign(s) on Traffic Signal Mast Arm
- ⑥ Remove Existing Sign on Type I Pole and Install New Sign(s) on Traffic Signal Pole
- ⑦ Remove Existing Sign(s) on Light Post and Install New Sign(s) on Light Post

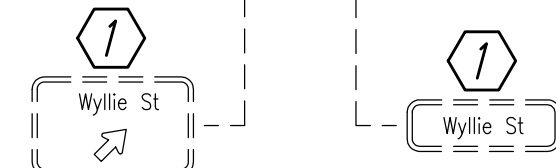
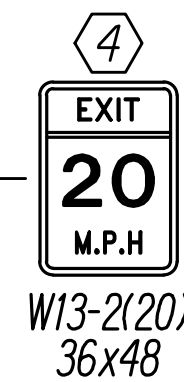

SIGNING AND STRIPING PLAN
Scale: 1"=40'

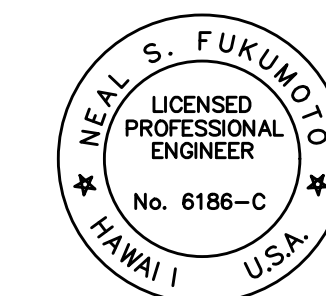

This work was prepared by me or under my supervision.
Exp. 04-30-22
Neal S. Fukumoto
Wesley R. Segdow & Associates, Inc.

STATE OF HAWAII
DEPARTMENT OF TRANSPORTATION
HIGHWAYS DIVISION

SIGNING AND STRIPING PLAN

PALI HIGHWAY RESURFACING
Vineyard Boulevard to Waokanaka Street
Federal-Aid Project No. NH-061-1(036)

Scale: 1"=40' Date: April 2020
SHEET No. CL7 OF 14 SHEETS

SURVEY PLOTTED BY: _____	DATE: _____
DRAWN BY: _____	
DESIGNED BY: _____	
CHECKED BY: _____	
ORIGINAL PLAN	
NOTE BOOK	
No. _____	

FED. ROAD DIST. NO.	STATE	FED. AID PROJ. NO.	FISCAL YEAR	SHEET NO.	TOTAL SHEETS
HAWAII	HAW.	NH-061-1(036)	2020	91	238

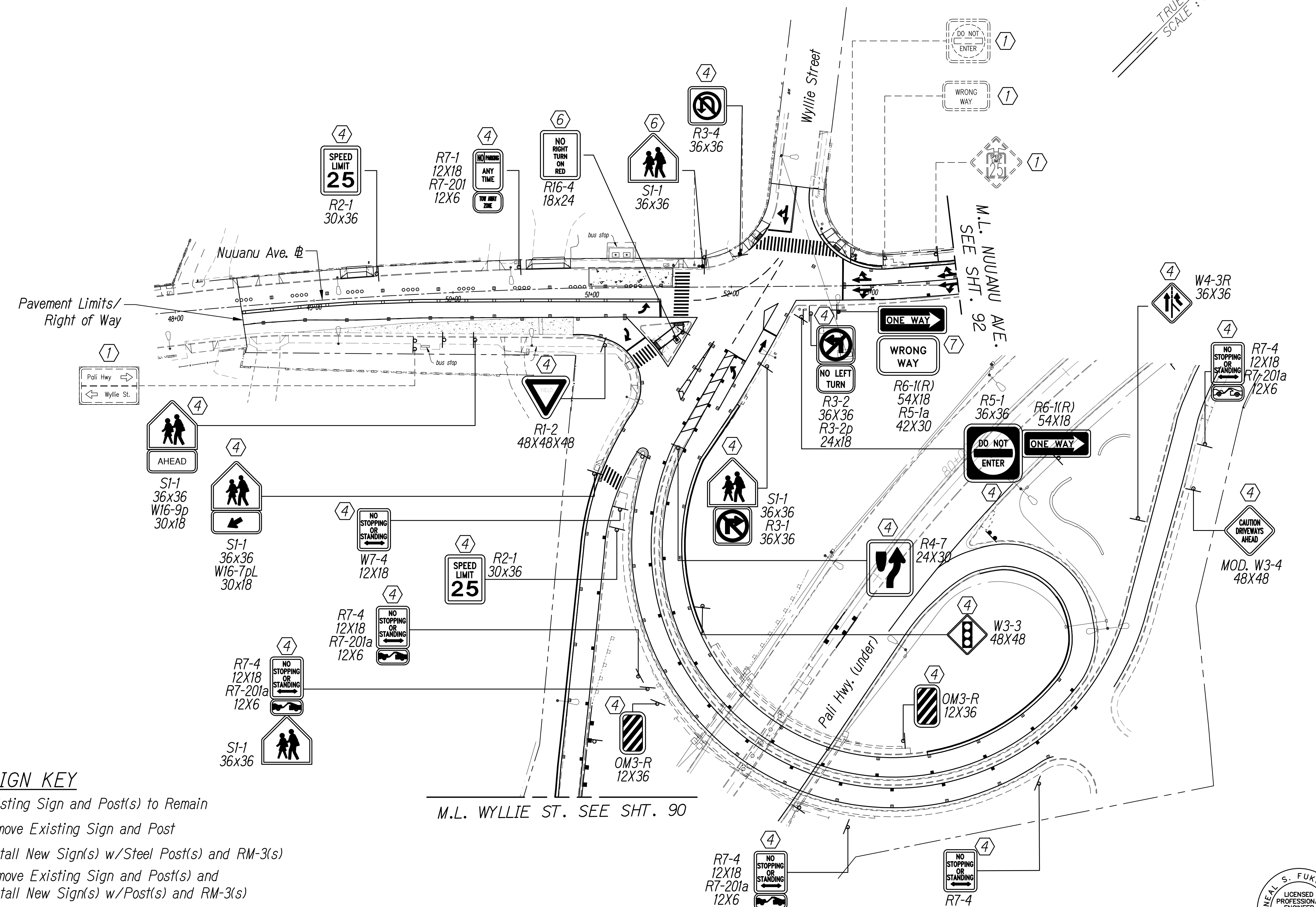
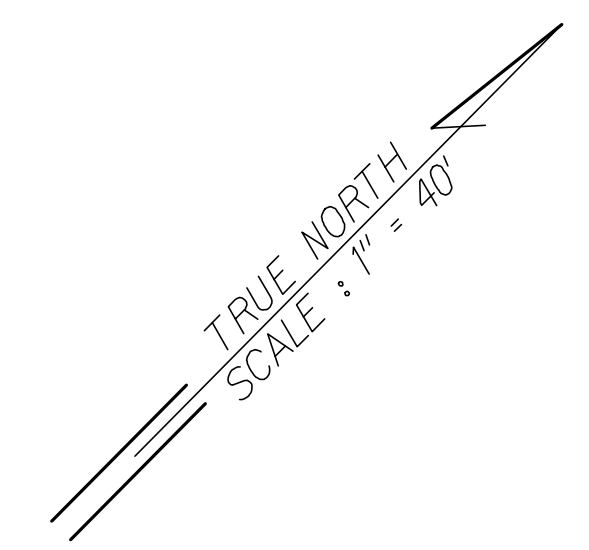

- SIGN KEY**
- ① Existing Sign and Post(s) to Remain
 - ② Remove Existing Sign and Post
 - ③ Install New Sign(s) w/Steel Post(s) and RM-3(s)
 - ④ Remove Existing Sign and Post(s) and Install New Sign(s) w/Post(s) and RM-3(s)
 - ⑤ Remove Existing Sign on Mast Arm and Install New Sign(s) on Traffic Signal Mast Arm
 - ⑥ Remove Existing Sign on Type I Pole and Install New Sign(s) on Traffic Signal Pole
 - ⑦ Remove Existing Sign(s) on Light Post and Install New Sign(s) on Light Post

SURVEY PLOTTED BY: _____	DATE: _____
DRAWN BY: _____	
TRACED BY: _____	
DESIGNED BY: _____	
CHECKED BY: _____	
ORIGINAL PLAN	
NOTE BOOK	
NO.	

SIGNING AND STRIPING PLAN
Scale: 1"=40'

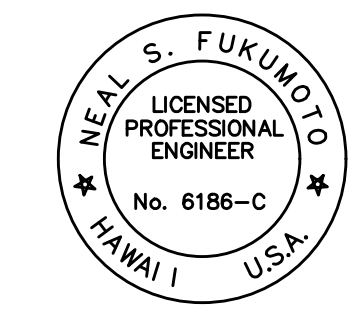

This work was prepared by me or under my supervision.
Exp. 04-30-22
Neal S. Fukumoto
Wesley R. Segdwa & Associates, Inc.

STATE OF HAWAII
DEPARTMENT OF TRANSPORTATION
HIGHWAYS DIVISION

SIGNING AND STRIPING PLAN

PALI HIGHWAY RESURFACING
Vineyard Boulevard to Waokanaka Street
Federal-Aid Project No. NH-061-1(036)

Scale: 1"=40' Date: April 2020
SHEET No. CL8 OF 14 SHEETS

FED. ROAD DIST. NO.	STATE	FED. AID PROJ. NO.	FISCAL YEAR	SHEET NO.	TOTAL SHEETS
HAWAII	HAW.	NH-061-1(036)	2020	92	238

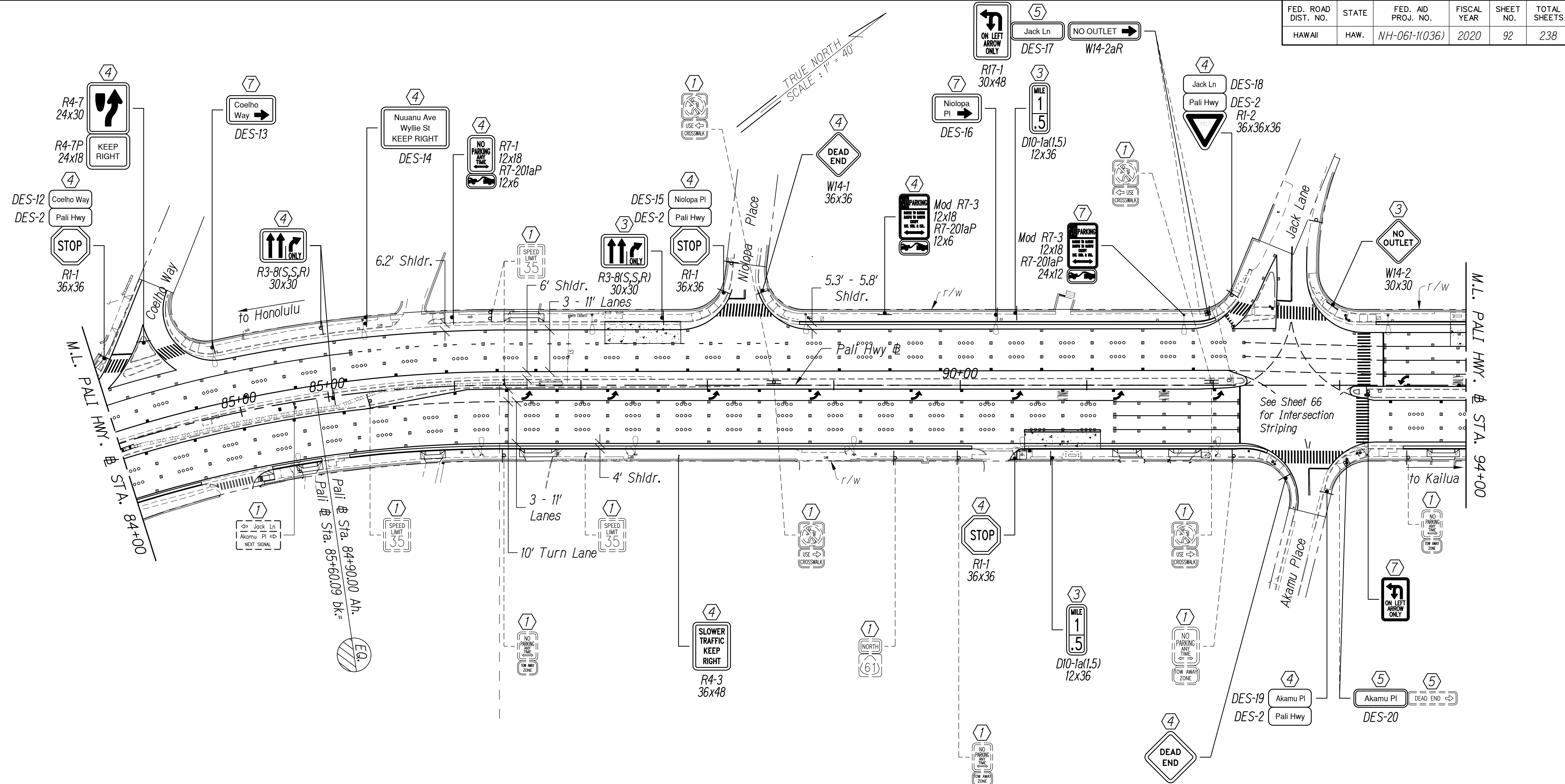

SIGN KEY

- ① Existing Sign and Post(s) to Remain
- ② Remove Existing Sign and Post
- ③ Install New Sign(s) w/Steel Post(s) and RM-3(s)
- ④ Remove Existing Sign and Post(s) and Install New Sign(s) w/Post(s) and RM-3(s)
- ⑤ Remove Existing Sign on Mast Arm and Install New Sign(s) on Traffic Signal Mast Arm
- ⑥ Remove Existing Sign on Type I Pole and Install New Sign(s) on Traffic Signal Pole
- ⑦ Remove Existing Sign(s) on Light Post and Install New Sign(s) on Light Post

SIGNING AND STRIPING PLAN
Scale: 1"=40'

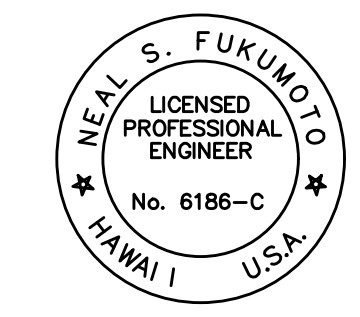

This work was prepared by me or under my supervision.
Exp. 04-30-22
Neal S. Fukumoto
Wesley R. Segawa & Associates, Inc.

STATE OF HAWAII
DEPARTMENT OF TRANSPORTATION
HIGHWAYS DIVISION

SIGNING AND STRIPING PLAN

PALI HIGHWAY RESURFACING
Vineyard Boulevard to Waokanaka Street
Federal-Aid Project No. NH-061-1(036)

Scale: 1"=40' Date: April 2020
SHEET No. CL9 OF 14 SHEETS

SURVEY PLOTTED BY	DATE
DRAWN BY	
TRACED BY	
DESIGNED BY	
CHECKED BY	
NOTE BOOK	
NO.	

FED. ROAD DIST. NO.	STATE	FED. AID PROJ. NO.	FISCAL YEAR	SHEET NO.	TOTAL SHEETS
HAWAII	HAW.	NH-061-1(036)	2020	93	238

TRUE NORTH
SCALE: 1" = 40'

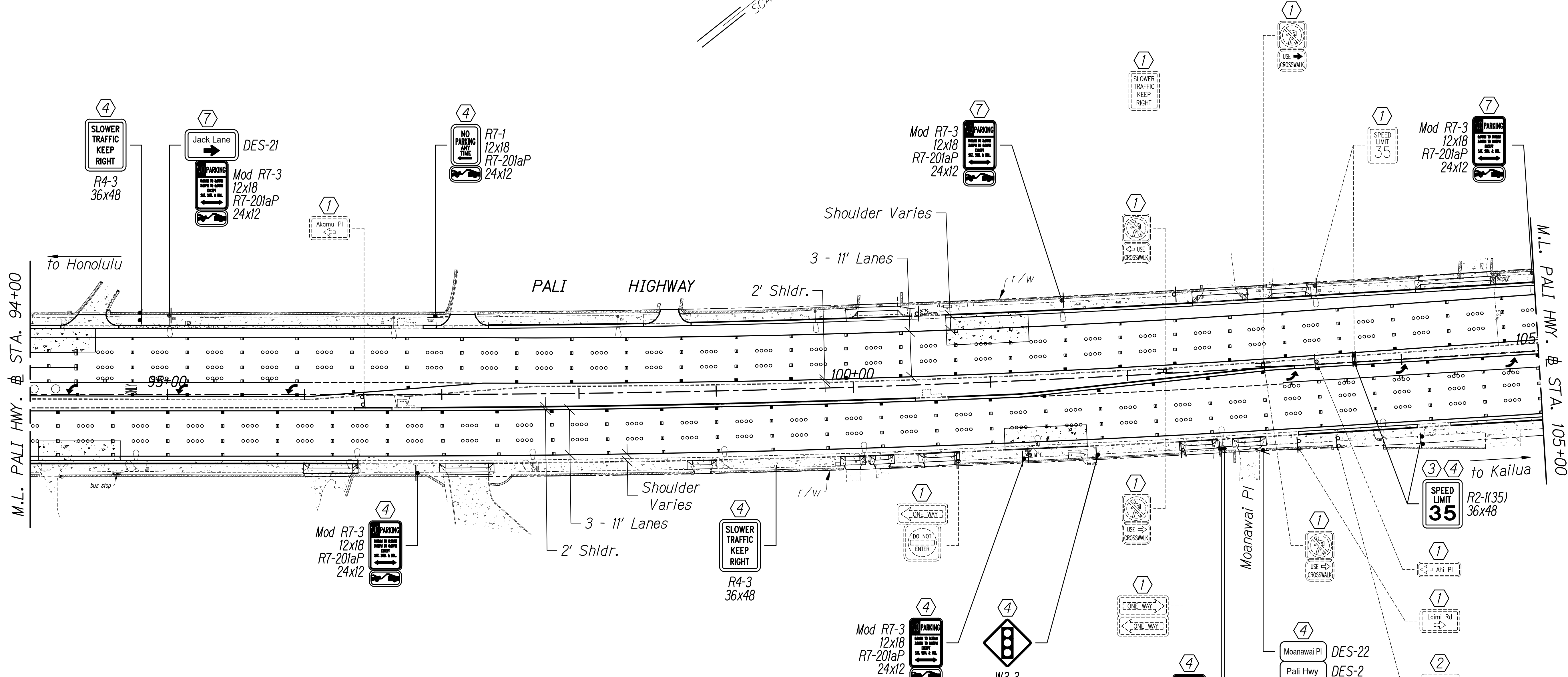

SIGN KEY

- ① Existing Sign and Post(s) to Remain
- ② Remove Existing Sign and Post
- ③ Install New Sign(s) w/Steel Post(s) and RM-3(s)
- ④ Remove Existing Sign and Post(s) and Install New Sign(s) w/Post(s) and RM-3(s)
- ⑤ Remove Existing Sign on Mast Arm and Install New Sign(s) on Traffic Signal Mast Arm
- ⑥ Remove Existing Sign on Type I Pole and Install New Sign(s) on Traffic Signal Pole
- ⑦ Remove Existing Sign(s) on Light Post and Install New Sign(s) on Light Post

SIGNING AND STRIPING PLAN
Scale: 1"=40'

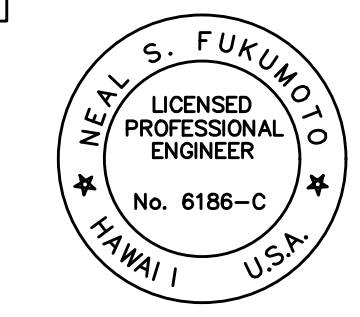

This work was prepared by me or under my supervision.
Exp. 04-30-22
Neal S. Fukumoto
Wesley R. Segawa & Associates, Inc.

STATE OF HAWAII
DEPARTMENT OF TRANSPORTATION
HIGHWAYS DIVISION

SIGNING AND STRIPING PLAN

PALI HIGHWAY RESURFACING
Vinyard Boulevard to Waokanaka Street
Federal-Aid Project No. NH-061-1(036)

Scale: 1"=40' Date: April 2020
SHEET No. CL10 OF 14 SHEETS

SURVEY PLOTTED BY: _____	DATE: _____
DRAWN BY: _____	TRACED BY: _____
DESIGNED BY: _____	CHECKED BY: _____
NOTE BOOK No. _____	

FED. ROAD DIST. NO.	STATE	FED. AID PROJ. NO.	FISCAL YEAR	SHEET NO.	TOTAL SHEETS
HAWAII	HAW.	NH-061-1(036)	2020	95	238

***Gateway System Legend:**

- ☐ 36" Height MP Flex Post as Manufactured by Impact Recovery Systems or Pre-Approved Equal
 - ▣ R1-6a Sign on Fixed Base as Manufactured by Impact Recovery Systems or Pre-Approved Equal
- See Sheet 94 for Typical Section

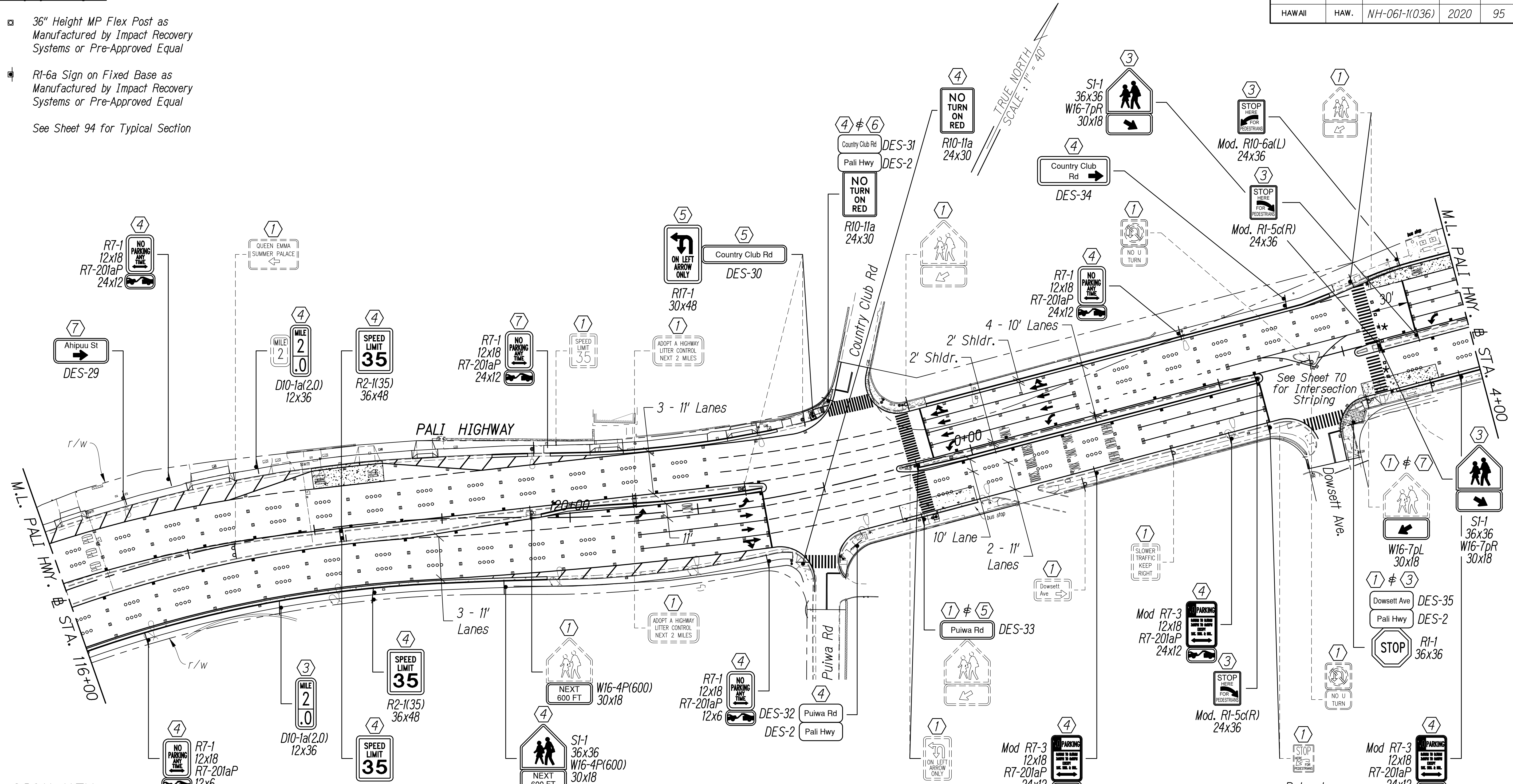

SIGN KEY

- ① Existing Sign and Post(s) to Remain
- ② Remove Existing Sign and Post
- ③ Install New Sign(s) w/Steel Post(s) and RM-3(s)
- ④ Remove Existing Sign and Post(s) and Install New Sign(s) w/Post(s) and RM-3(s)
- ⑤ Remove Existing Sign on Mast Arm and Install New Sign(s) on Traffic Signal Mast Arm
- ⑥ Remove Existing Sign on Type I Pole and Install New Sign(s) on Traffic Signal Pole
- ⑦ Remove Existing Sign(s) on Light Post and Install New Sign(s) on Light Post

SIGNING AND STRIPING PLAN
Scale: 1"=40'

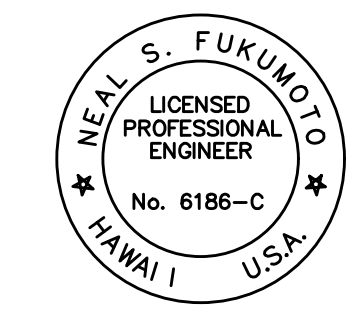

This work was prepared by me or under my supervision.
Exp. 04-30-22
Neal S. Fukumoto
Wesley R. Segawa & Associates, Inc.

STATE OF HAWAII
DEPARTMENT OF TRANSPORTATION
HIGHWAYS DIVISION

SIGNING AND STRIPING PLAN

PALI HIGHWAY RESURFACING
Vineyard Boulevard to Waokanaka Street
Federal-Aid Project No. NH-061-1(036)

Scale: 1"=40' Date: April 2020

SHEET No. 012 OF 14 SHEETS

SURVEY PLOTTED BY: _____	DATE: _____
DRAWN BY: _____	TRACED BY: _____
DESIGNED BY: _____	CHECKED BY: _____
NOTE BOOK: _____	NO. _____

FED. ROAD DIST. NO.	STATE	FED. AID PROJ. NO.	FISCAL YEAR	SHEET NO.	TOTAL SHEETS
HAWAII	HAW.	NH-061-1(036)	2020	96	238

- * Gateway System Legend:**
- ▣ 36" Height MP Flex Post as Manufactured by Impact Recovery Systems or Pre-Approved Equal
 - ▣ RI-6a Sign on Fixed Base as Manufactured by Impact Recovery Systems or Pre-Approved Equal
- See Sheet 94 for Typical Section

TRUE NORTH
SCALE: 1"=40'

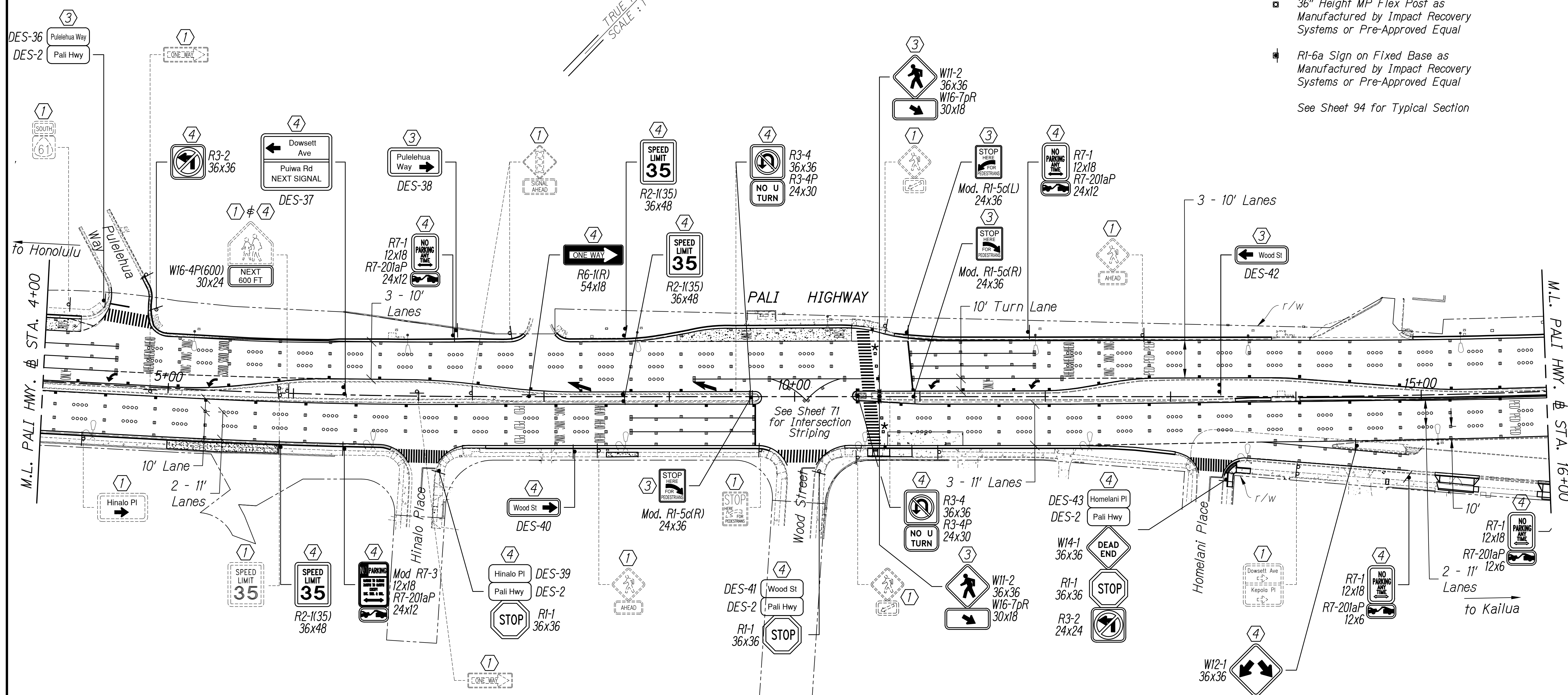

- SIGN KEY**
- ① Existing Sign and Post(s) to Remain
 - ② Remove Existing Sign and Post
 - ③ Install New Sign(s) w/Steel Post(s) and RM-3(s)
 - ④ Remove Existing Sign and Post(s) and Install New Sign(s) w/Post(s) and RM-3(s)
 - ⑤ Remove Existing Sign on Mast Arm and Install New Sign(s) on Traffic Signal Mast Arm
 - ⑥ Remove Existing Sign on Type I Pole and Install New Sign(s) on Traffic Signal Pole
 - ⑦ Remove Existing Sign(s) on Light Post and Install New Sign(s) on Light Post

SIGNING AND STRIPING PLAN
Scale: 1"=40'

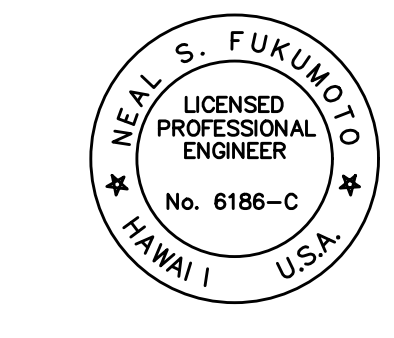

This work was prepared by me or under my supervision.
Exp. 04-30-22
Neal S. Fukumoto
Wesley R. Segawa & Associates, Inc.

STATE OF HAWAII
DEPARTMENT OF TRANSPORTATION
HIGHWAYS DIVISION

SIGNING AND STRIPING PLAN

PALI HIGHWAY RESURFACING
Vineyard Boulevard to Waokanaka Street
Federal-Aid Project No. NH-061-1(036)

Scale: 1"=40' Date: April 2020
SHEET No. CL13 OF 14 SHEETS

SURVEY PLOTTED BY	DATE
DRAWN BY	
TRACED BY	
DESIGNED BY	
CHECKED BY	
NOTE BOOK	
NO.	

FED. ROAD DIST. NO.	STATE	FED. AID PROJ. NO.	FISCAL YEAR	SHEET NO.	TOTAL SHEETS
HAWAII	HAW.	NH-061-1(036)	2020	97	238

★ Gateway System Legend:

- 36" Height MP Flex Post as Manufactured by Impact Recovery Systems or Pre-Approved Equal
 - R1-6a Sign on Fixed Base as Manufactured by Impact Recovery Systems or Pre-Approved Equal
- See Sheet 94 for Typical Section

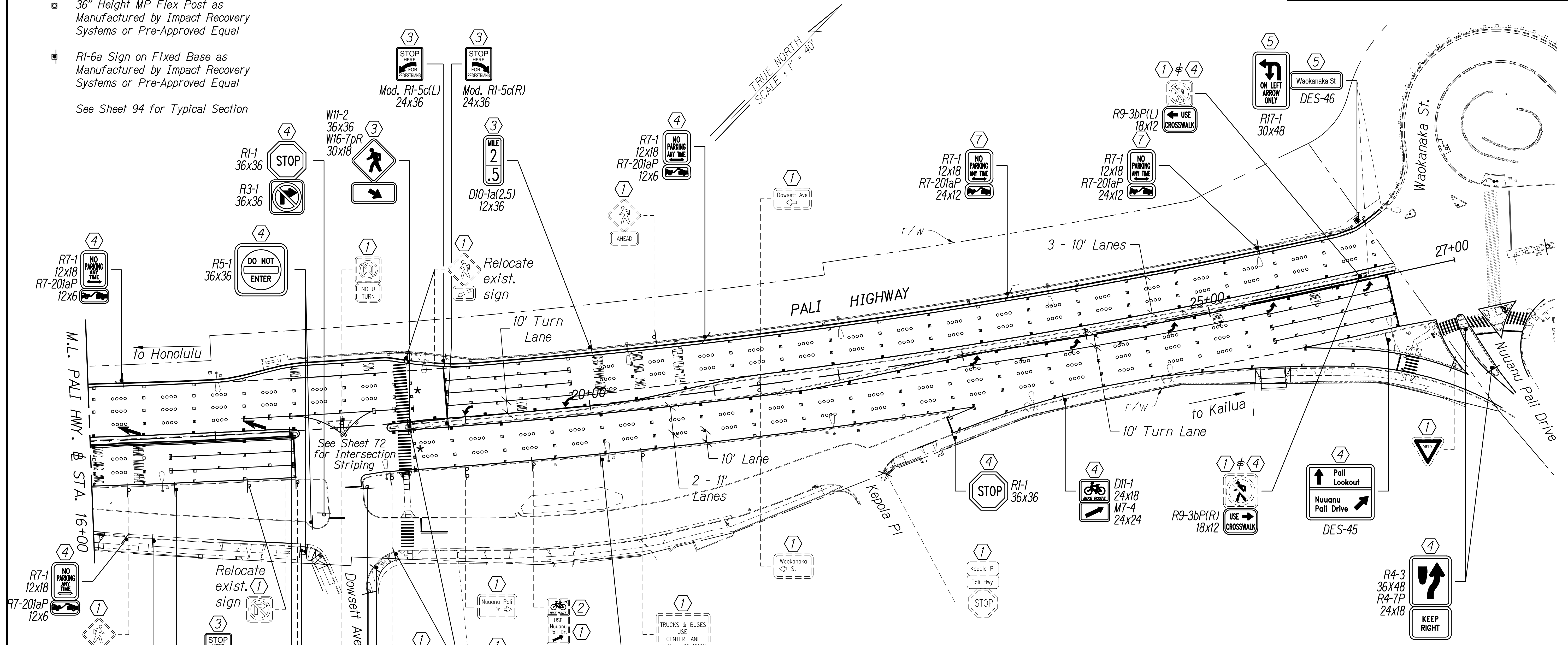

SIGN KEY

- ① Existing Sign and Post(s) to Remain
- ② Remove Existing Sign and Post
- ③ Install New Sign(s) w/Steel Post(s) and RM-3(s)
- ④ Remove Existing Sign and Post(s) and Install New Sign(s) w/Post(s) and RM-3(s)
- ⑤ Remove Existing Sign on Mast Arm and Install New Sign(s) on Traffic Signal Mast Arm
- ⑥ Remove Existing Sign on Type I Pole and Install New Sign(s) on Traffic Signal Pole
- ⑦ Remove Existing Sign(s) on Light Post and Install New Sign(s) on Light Post

SURVEY PLOTTED BY: _____	DATE: _____
DRAWN BY: _____	
TRACED BY: _____	
DESIGNED BY: _____	
CHECKED BY: _____	
NOTE BOOK: _____	

SIGNING AND STRIPING PLAN
Scale: 1"=40'

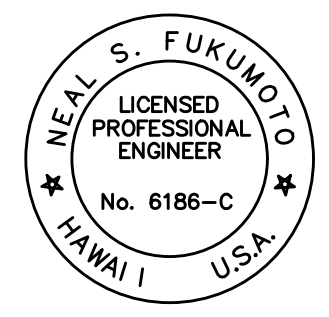

This work was prepared by me or under my supervision.
Exp. 04-30-22
Neal S. Fukumoto
Wesley R. Segawa & Associates, Inc.

STATE OF HAWAII
DEPARTMENT OF TRANSPORTATION
HIGHWAYS DIVISION

SIGNING AND STRIPING PLAN

PALI HIGHWAY RESURFACING
Vineyard Boulevard to Waakanaka Street
Federal-Aid Project No. NH-061-1(036)

Scale: 1"=40' Date: April 2020

SHEET No. CL14 OF 14 SHEETS