

GENERAL NOTES

FED. ROAD DIST. NO.	STATE	PROJ. NO.	FISCAL YEAR	SHEET NO.	TOTAL SHEETS
HAWAII	HAW.	61A-01-10M	2010	ADD.3	9

1. The scope of work for this project includes cold planing, re-constructing existing pavement by removing portland cement concrete and replacing with asphalt concrete, and installing pavement markings.
2. The Contractor is reminded of the requirements of Subsection 108.01 - Subletting of Contract, which requires him to perform work amounting to not less than 30 percent of the total contract cost less deductible items. Non-compliance with this Subsection may be grounds for rejection of bid.
3. The Contractor's attention is directed to the following Sections of the Special Provision: Subsection 107.13 - Public Convenience and Safety; Subsection 107.21 - Contractor's Responsibility for Utility property and services; and Section 645 - Work Zone Traffic Control.
4. At the end of each day's work, the Contractor shall remove all equipment and other obstructions to permit free and safe passage of public traffic.
5. The existence and location of underground utilities, manholes, monuments and structures as shown on the plans are from the latest available data, but the accuracy is not guaranteed. The encountering of other obstacles during the course of work is possible. The Contractor shall be held liable for any damages incurred to the existing facilities and/or improvements as a result of his operations.
6. The Contractor shall notify in writing, the Oahu Transit Services, Inc. Roads Supervision Office, 811 Middle St. Hon, HI 96819 (phone# 848-4571) , two (2) weeks prior to construction, informing them of location, scope of work, and closure of Name of Highway and/or traffic lanes and dates of closure. The contractor shall provide and maintain for normal bus operation.
7. The Contractor shall notify the Engineer in writing, two (2) weeks prior to starting construction operations.
8. The Contractor shall obtain a Community Noise permit from the State Department of Health, Noise and Radiation Branch, 591 Ala Moana Blvd., Room 136, Honolulu, HI 96813-2498; Telephone No. 586-4700. This shall be considered incidental to the various contract items and will not be paid for separately.
9. The Contractor shall indemnify and be solely responsible for the protection of adjacent properties, utilities and existing structures from damages due to construction. Repairing any damage shall be at the Contractor's own expense, to the satisfaction of the Engineer.
10. Existing drainage system will be functional at all times during construction. The Contractor shall furnish materials, equipment, labor, tools and incidentals necessary to maintain flow. This work shall be considered incidental to various contract items and will not be paid for separately.
11. Tack Coat shall be incidental to various contract items and will not be paid for separately.
12. Smooth riding connections shall be constructed at all limits of project, including the beginning and end of project, connecting approaches, side streets, walkways and driveways as shown on the plans and/or as directed by the Engineer.
13. The Contractor shall clean and remove any accumulation of aggregates along the roadside within 10 feet of the edge of pavement. This work shall be considered incidental to various contract items and will not be paid for separately.
14. The Contractor shall sawcut and remove existing portland cement concrete. Removal method shall be with no impact and minimal vibration as approved by Engineer.
15. All saw cutting work shall be considered incidental to Excavation of Weakened Pavement Areas.
16. The Contractor shall provide and maintain for access to and from all existing driveways , sidewalks and ADA access routes, and side streets and cross streets at all times.
17. The Contractor shall provide and maintain a passable pedestrian-safe and easily accessible route. Accessible routes to comply with ADAAG 4.3.1. the Engineer shall consider the cost for furnishing equipment, tools, labor, materials, and incidentals necessary to complete the work as included in the contract price of various contract items.
18. All work specified in the contract but not listed separately in the proposal schedule shall be considered incidental to various contract items and shall not be paid for separately.
- △ 19. The Contractor shall remove and dispose of all existing raised pavement markers, thermoplastic line markings, traffic tapes, and epoxy adhesives. This work shall be considered incidental to H.M.A. Pavement, Mix No. IV and will not be paid for separately.
20. No material and/or equipment shall be stockpiled or otherwise stored within the highway right-of-way except at locations designed in writing and approved by the Engineer. If use of location is approved by the engineer, the Contractor shall obtain a permit to use the property within the highway right-of-way from the Oahu District Office at telephone no. 831-6712.
- △ 21. The Contractor shall submit Traffic Control Plans to be approved by the Engineer at least two weeks prior to construction. The Contractor shall maintain two lanes of traffic at all times.
22. The Contractor shall restore roadway to existing pavement elevations and restore pavement marking and striping to existing condition. Removal and disposal of all existing raised pavement markers shall be considered incidental to various contract items and will not be paid for separately.

ORIGINAL PLAN	SURVEY PLOTTED BY	DATE
NOTE BOOK	DRAWN BY	
	DESIGNED BY	
	QUANTITIES BY	
	CHECKED BY	

6/23/10	△ Revised General Note No. 19 and 21
DATE	REVISION
STATE OF HAWAII DEPARTMENT OF TRANSPORTATION HIGHWAYS DIVISION	
GENERAL NOTES AND LEGEND	
PALI HIGHWAY PAVEMENT REPAIRS	
Vicinity of Laimi Road towards Puiwa Road	
Project No. 61A-01-10M	
Scale: None	Date: April, 2010
SHEET No. 1 OF 2 SHEETS	

FED. ROAD DIST. NO.	STATE	PROJ. NO.	FISCAL YEAR	SHEET NO.	TOTAL SHEETS
HAWAII	HAW.	61A-01-10M	2010	ADD.7	9

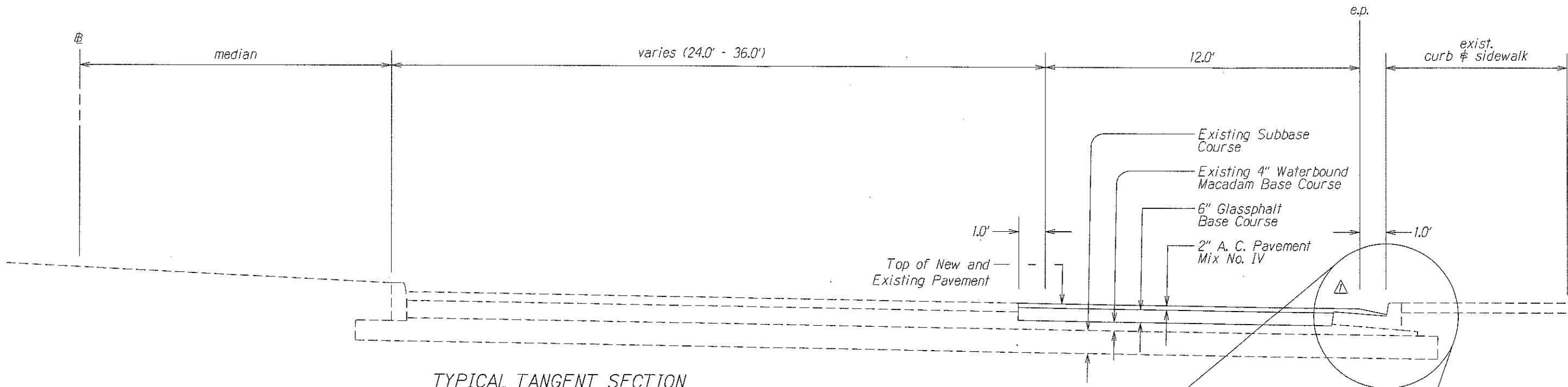

TYPICAL TANGENT SECTION
 Scale: 1/2" = 1'

Notes: If aggregate in the existing waterbound macadam base course are loose and cannot be locked together through extensive rolling, remove the 4" WBM Base Course layer to the top of the existing subbase course and replace with Glassphalt Base Course. Removal and replacement of WBM course layer to be paid under Item No. 202.1000 Removal of Existing Water bound Macadam Base Course.

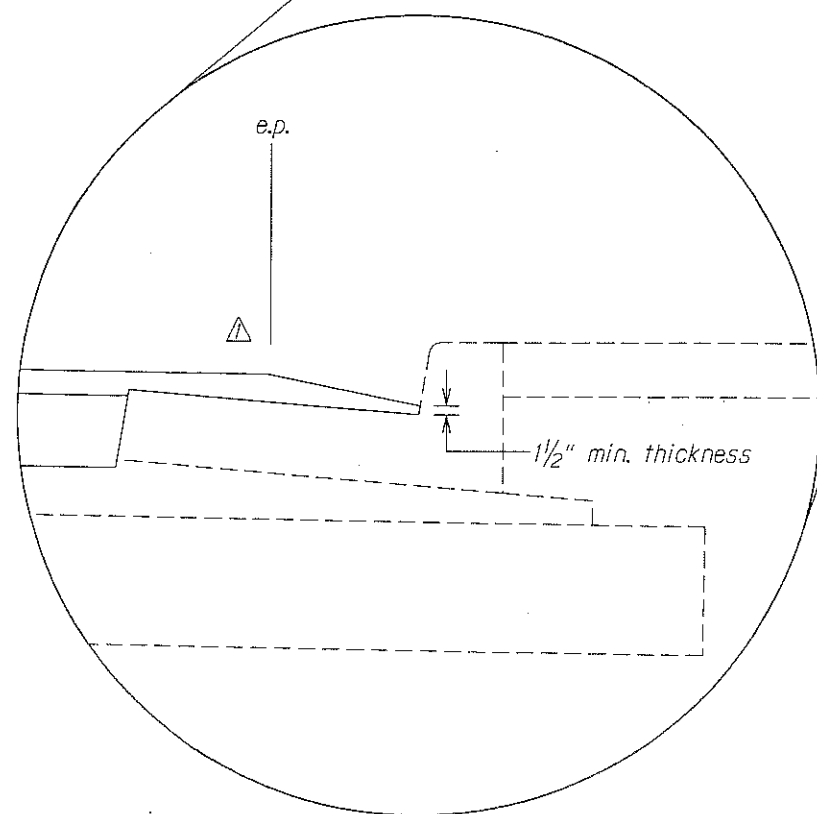

6/23/10	Revised Typical Tangent Section Detail
DATE	REVISION
STATE OF HAWAII DEPARTMENT OF TRANSPORTATION HIGHWAYS DIVISION	
TYPICAL SECTION	
PALI HIGHWAY PAVEMENT REPAIRS Vicinity of Laimi Road towards Puiwa Road Project No. 61A-01-10M	
Scale: As Shown	Date: April, 2010
SHEET No. 1 OF 1 SHEETS	

ORIGINAL PLAN	SURVEY PLOTTED BY	DATE
NOTE BOOK	DRAWN BY	
603 m/s	DESIGNED BY	
1/2" = 1'	CHECKED BY	

FED. ROAD DIST. NO.	STATE	PROJ. NO.	FISCAL YEAR	SHEET NO.	TOTAL SHEETS
HAWAII	HAW.	61A-01-10M	2010	ADD.9 S-1	9

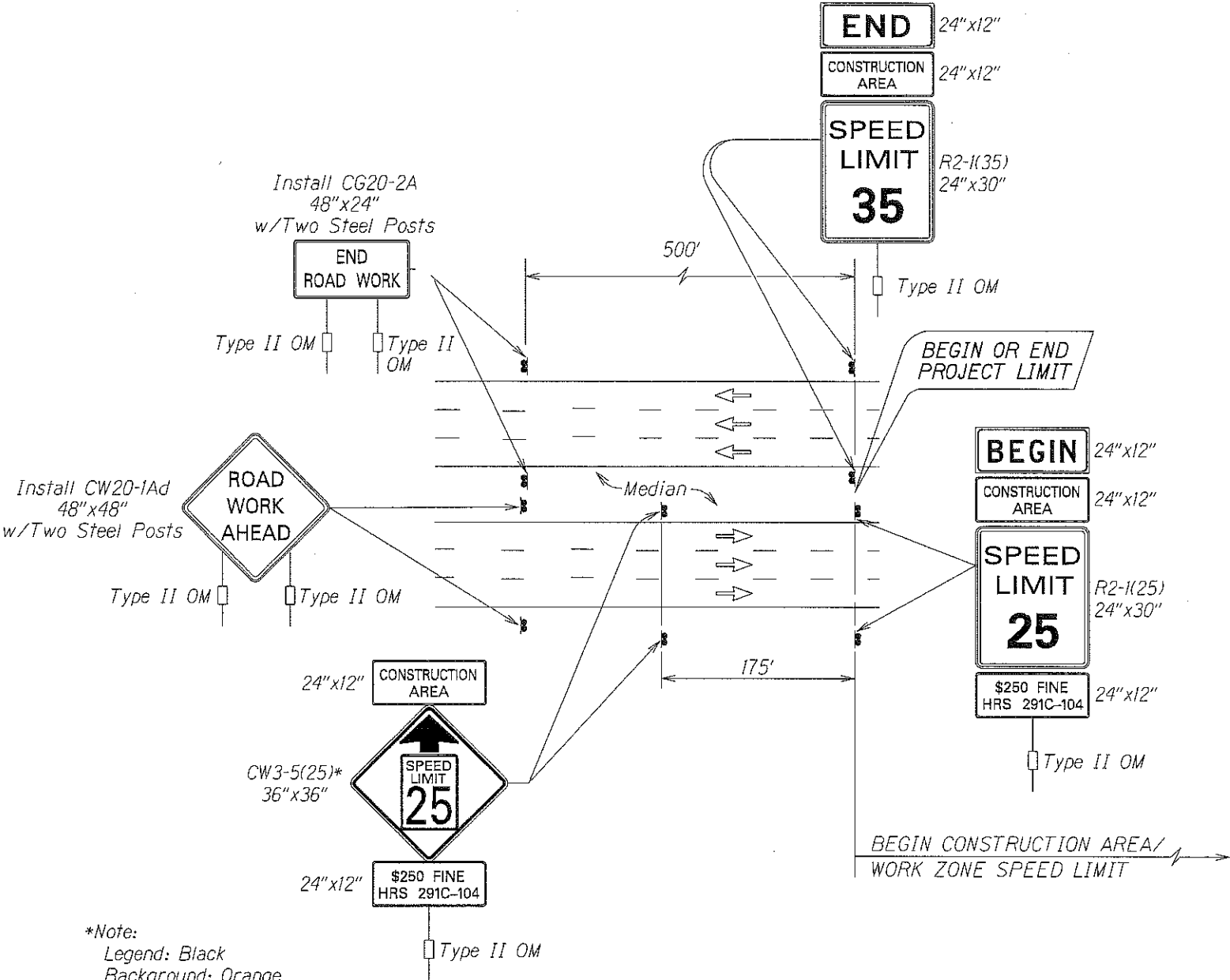

- Work Zone Notes:**
1. This Work Zone Sign Plan is intended for use on long-term stationary work zones/construction phases (3 days or more). All work zones or construction phases less than 3 days duration will use Traffic Control Plans shown in Section 645 of the Special Provisions.
 2. All existing regulatory speed limit signs with posts within the work zone/project limits shall be removed and replaced with work zone speed limit sign assemblies (R2-1(25) and CW3-5(25) with "CONSTRUCTION AREA" and "\$250 FINE HRS 291C-104" Supplemental Signs).
 3. Construction sign assemblies shall be installed on both the approaching and trailing ends of each work zone as shown on this plan.
 4. Each construction warning sign shall have a minimum of two (2) Type II OM. Each work zone speed limit assembly shall have a minimum of one (1) Type II OM. Installation of each Type II OM shall be considered incidental to Item No. 645.0100 - Traffic Control.
 5. Upon the completion of all physical work or as directed by the Engineer, all construction signs and work zone speed limit assemblies shall be removed. All speed limit signs and posts that were existing at the start of the project within the work zone/project limits shall be restored back to their original locations and configurations.
 6. Placement of construction signs shall not obstruct the path of pedestrians and bicyclists.
 7. The removal and restoration of existing regulatory speed limit signs with new posts along with the installation, maintenance and removal of work zone speed limit sign assemblies shall be considered incidental to Item No. 645.0100 - Traffic Control. Sign covers shall be commercially manufactured and HDOT approved. Sign covers shall not allow any portion of the sign being covered to be visible. If the sign has more than one side, cover shall completely cover each side. "Homemade" or "field made" covers shall not be used or accepted.

**TYPICAL DETAIL FOR CONSTRUCTION SIGNS
ON MULTILANE DIVIDED LOW SPEED HIGHWAY**

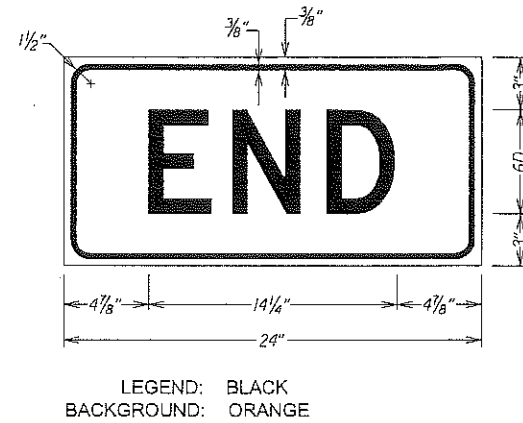
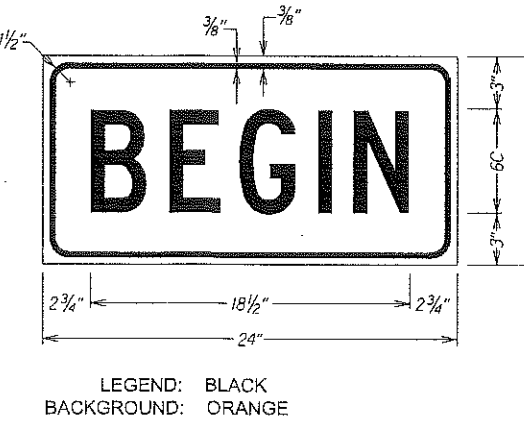
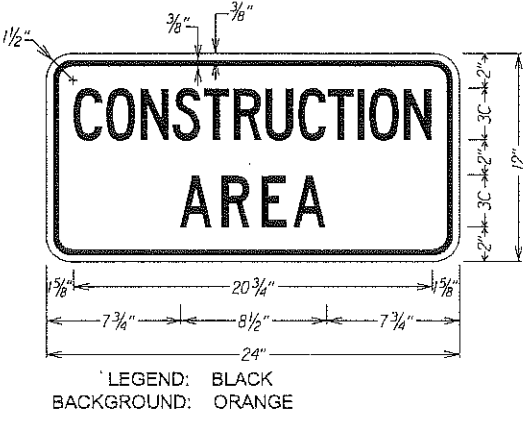

6/23/10	Added Sheet
DATE	REVISION
STATE OF HAWAII DEPARTMENT OF TRANSPORTATION HIGHWAYS DIVISION	
LOW SPEED DIVIDED HIGHWAY	
WORK ZONE SIGNING PLAN, NOTES&DETAILS	
PALI HIGHWAY PAVEMENT REPAIRS Vicinity of Laimi Rd. towards Puhi Rd.	
Project No. 61A-01-10M	
Not To Scale	Date: June, 2010
SHEET No. 1 OF 1 SHEETS	