

FED. ROAD DIST. NO.	STATE	PROJ. NO.	FISCAL YEAR	SHEET NO.	TOTAL SHEETS
OAHU	HAWAII	61D-02-06	2006	53	57

GENERAL NOTES FOR TRAFFIC CONTROL PLAN

- Only Traffic Control Plans for major construction activities are shown. The Contractor shall develop his own Traffic Control Plans in accordance with Section 645 of the Special Provisions for activities to complete work not covered by the Traffic Control Plans. The Contractor shall submit the Traffic Control Plans to the Engineer for approval. Payment for development and implementation of the Traffic Control Plans shall be paid for on a lump sum basis.
- All lane closures and traffic pattern changes (diversion) not shown on the plan shall be submitted to the Engineer for approval in accordance with Specifications Section 645 Work Zone Traffic Control. For restrictions on lane closures, detours, construction work during peak hours, and other requirements regarding maintaining vehicular and pedestrian traffic, see Section 107.13 Contractor Duty Regarding Public Convenience and Section 645 Work Zone Traffic Control.
- The Contractor shall make minor adjustments at intersections, driveways, bridges, structures, etc. to fit field conditions.
- Cones or delineators shall be extended to a point where they are visible to approaching traffic.
- Traffic control devices shall be installed such that the sign or device farthest from the work area shall be placed first. The others shall then be placed progressively toward the work area.
- Flaggers and/or police officers shall be in sight of each other or in direct communications at all times.
- Sign spacings (L), taper lengths (T), and spacings of cones or delineators shall be as shown in Table 1 of Section 645 in the Specifications, unless otherwise noted on the Traffic Control Plans.
- All traffic lanes shall be minimum of 11 feet wide.
- All construction warning signs shall be promptly removed or covered whenever the message is not applicable or not in use.
- The backs of all signs for traffic control shall be appropriately covered to preclude the display of inapplicable sign messages (i.e., when signs have messages on both faces).
- At the end of each day's work or as soon as the work is completed, the Contractor shall remove all traffic control devices no longer needed to permit free and safe passage of public traffic. Removal shall be in the reverse order of installation.
- The locations of signs and delineators used in the Traffic Control shall be as shown on the plans and/or as determined in the field by the Engineer.
- Damage to signs, temporary pavement markers, and delineators caused by the public shall be repaired or replaced by the Contractor as directed by the Engineer and paid for under Section 645. Damage caused by the Contractor's negligence shall be repaired or replaced at the Contractor's expense.

- During working and non-working hours, the Contractor shall furnish, install, and maintain Type II Barricades with steady burn amber lamps at 10' spacing in new and existing pavement areas closed to public vehicles.
- The Contractor shall provide sand bags or other accepted weights for the Type II Barricades, when used. The Contractor shall provide steady burn amber lamps during hours of darkness. The lamps shall be attached on the Type II Barricade end closest to the traveled way. The lamp should be visible to the motorist. Payment for Type II Barricades with amber lamps shall be considered incidental to the various contract items.
- Contractor shall maintain access to adjacent properties at all times.
- Cones and signs for night work shall be retroreflective.

LEGEND:

- • • Cones
- ↕, ↗, ↘ Portable Arrow Board
- Direction of Traffic
- New Sign
- ◻ Existing Sign
- ▨ Work Area

SURVEY PLOTTED BY	DATE
DESIGNED BY	
TRACED BY	
NOTE BOOK	
DESIGNED BY	
QUANTITIES BY	
CHECKED BY	
No.	

EarthTech
A tyco International Ltd. Company

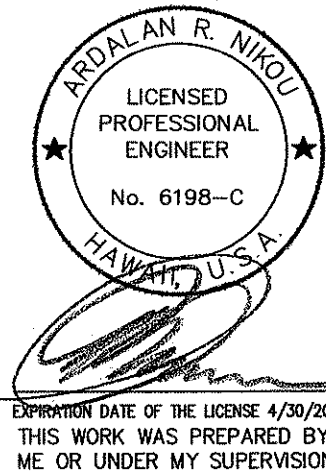

STATE OF HAWAII
DEPARTMENT OF TRANSPORTATION
HIGHWAYS DIVISION

**TRAFFIC CONTROL NOTES
AND LEGEND**

KAILUA ROAD PERMANENT
ROCKFALL AND LANDSLIDE MITIGATION
PROJECT NO. 61D-02-06

Scale: As Noted Date: Aug 2006

SHEET No. 1 OF 5 SHEETS

FED. ROAD DIST. NO.	STATE	PROJ. NO.	FISCAL YEAR	SHEET NO.	TOTAL SHEETS
OAHU	HAWAII	61D-02-06	2006	54	57

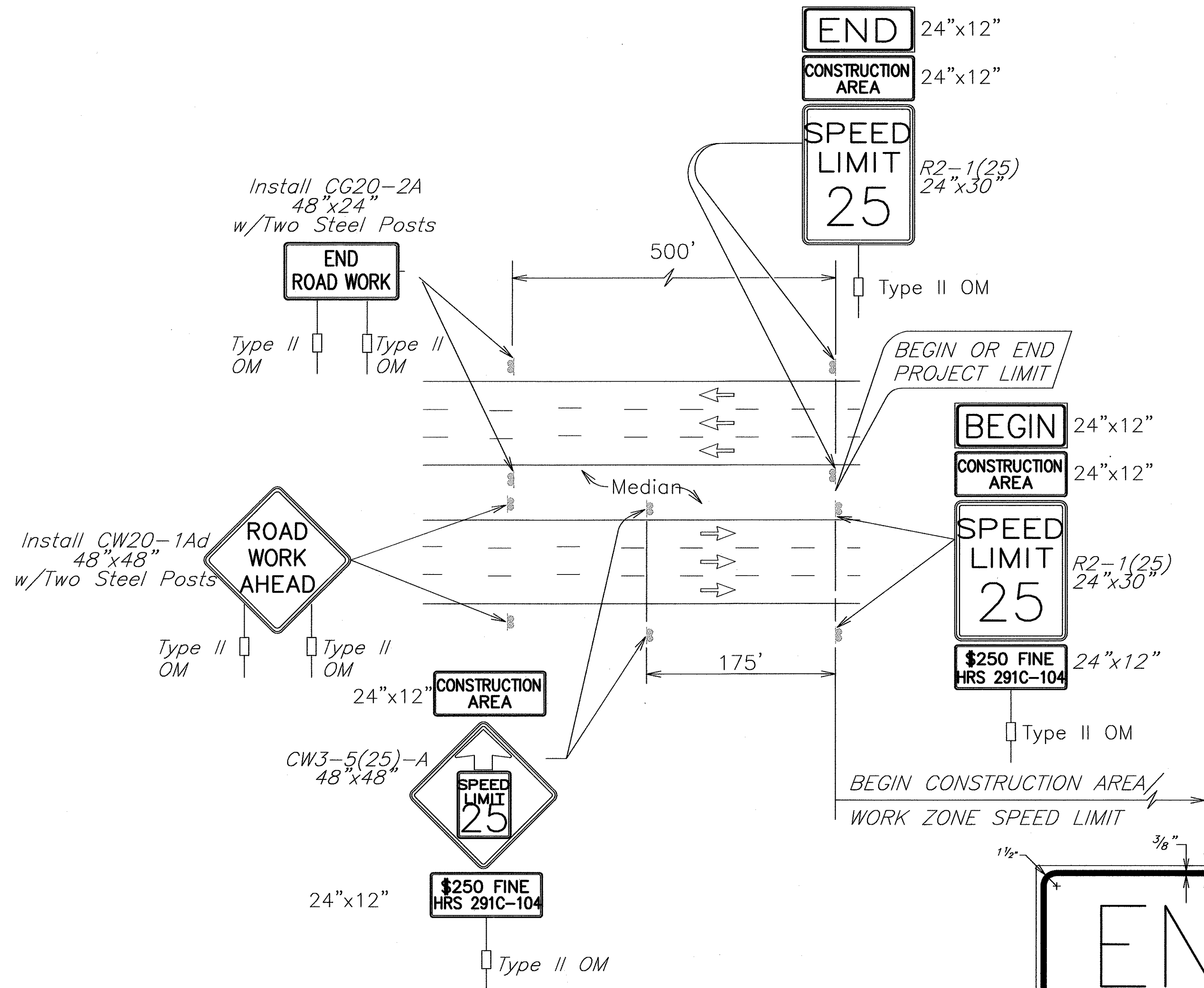

TYPICAL DETAIL FOR CONSTRUCTION SIGNS
ON MULTILANE DIVIDED LOW SPEED HIGHWAY

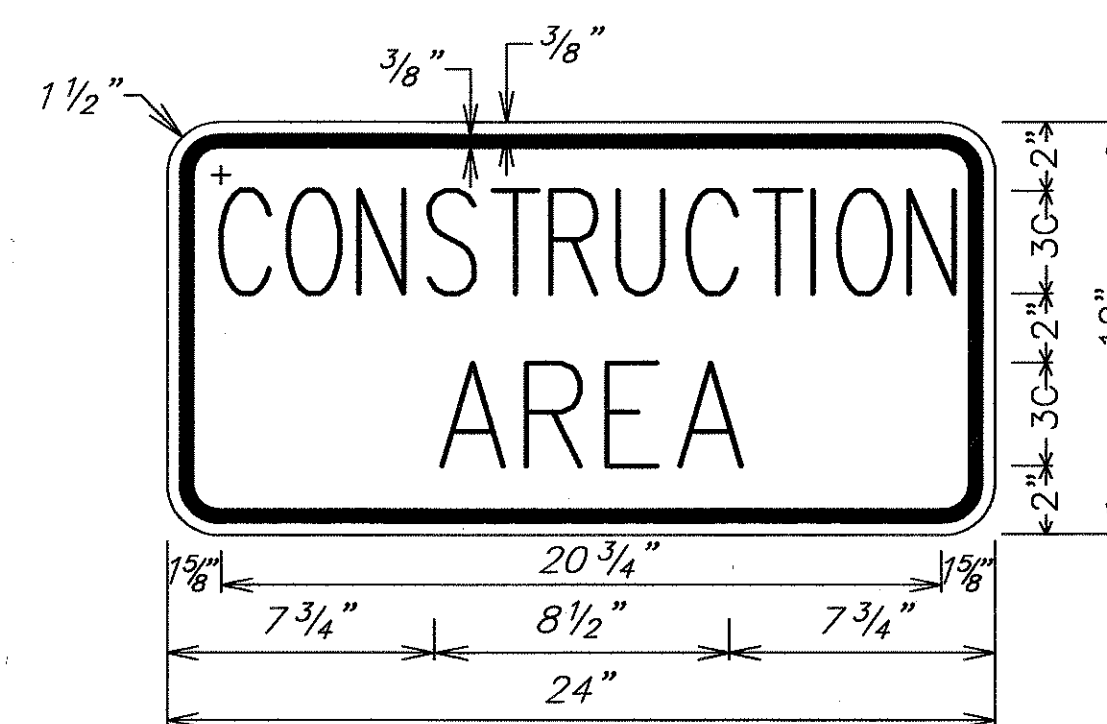

LEGEND: BLACK
BACKGROUND: ORANGE

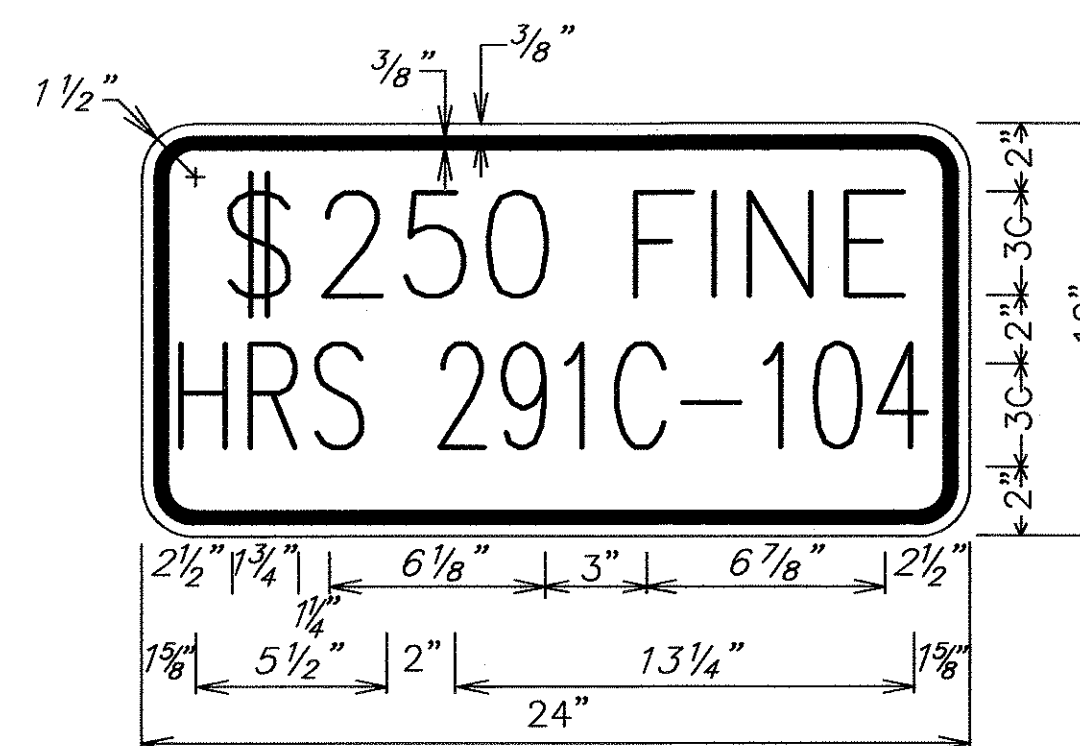

LEGEND: BLACK
BACKGROUND: WHITE

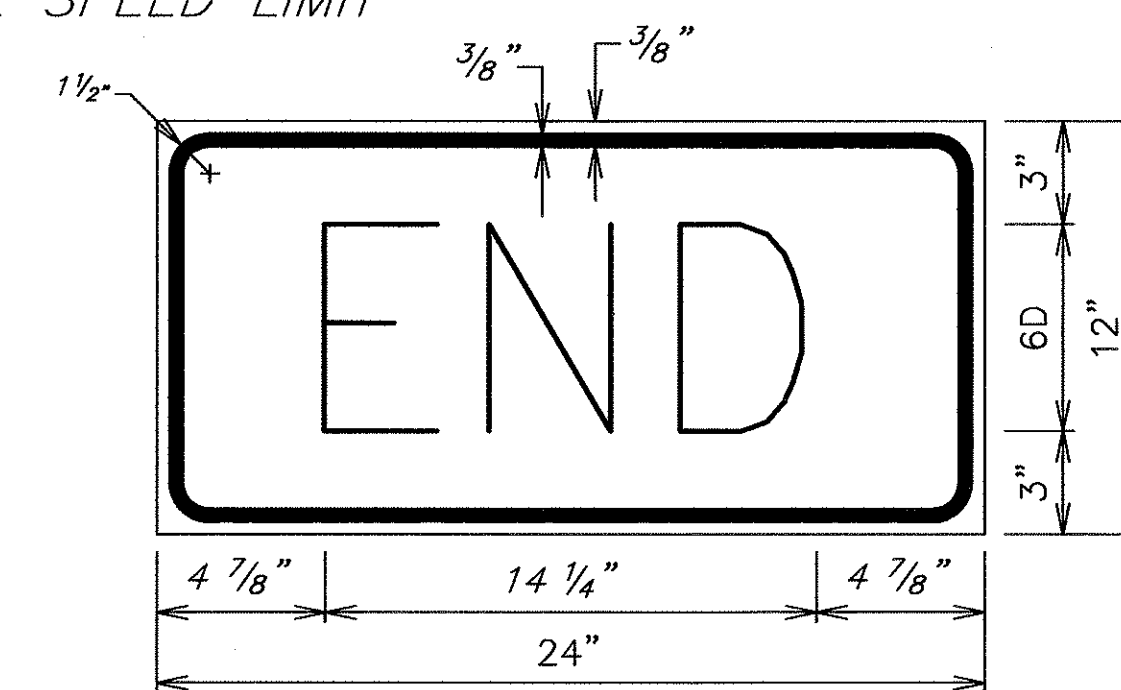

LEGEND: BLACK
BACKGROUND: ORANGE

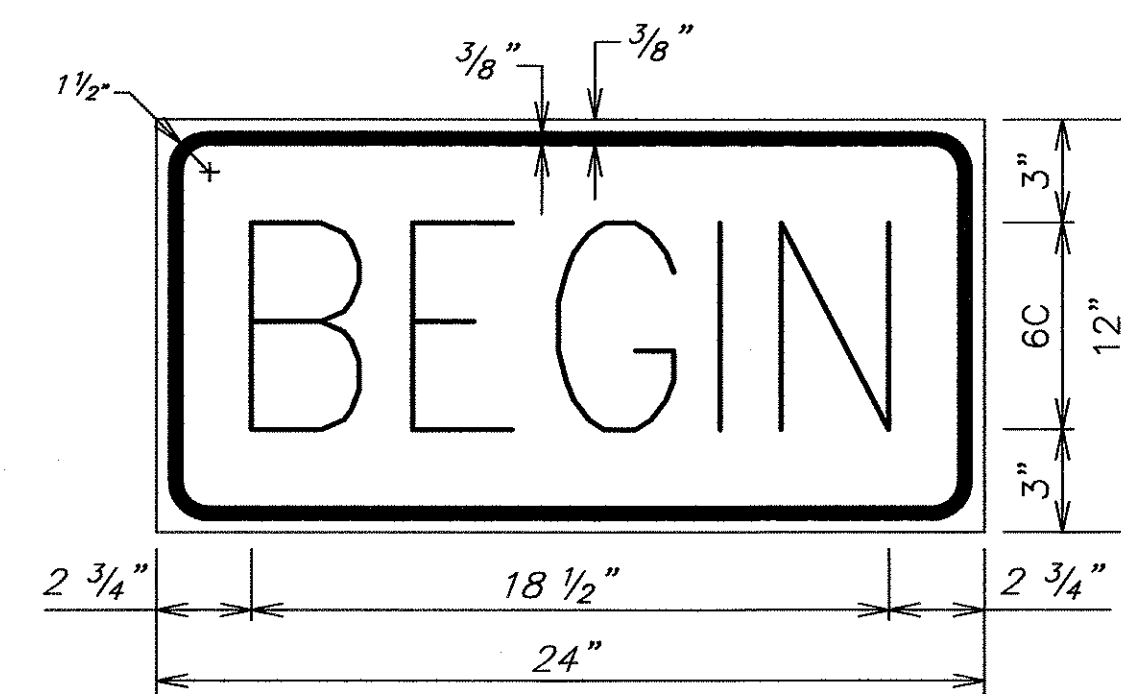

LEGEND: BLACK
BACKGROUND: ORANGE

Work Zone Note:

1. This Work Zone Sign Plan is intended for use on long-term stationary work zones/construction phases (3 days or more). All work zones or construction phases less than 3 days duration will use Traffic Control Plans shown in Section 645 of the Special Provisions.
2. All existing regulatory speed limit signs with posts within the work zone/project limits shall be removed and replaced with work zone speed limit sign assemblies (R2-1(25) and R2-5b(25) with "CONSTRUCTION AREA" and "\$250 FINE HRS 291C-104" Supplemental Signs).
3. Construction sign assemblies shall be installed on both the approaching and trailing ends of each work zone as shown on this plan.
4. Each construction warning sign shall have a minimum of two (2) Type II OM. Each work zone speed limit assembly shall have a minimum of one (1) Type II OM. Installation of each Type II OM shall be considered incidental to Item No. 645.0500, Traffic Control.
5. Upon the completion of all physical work or as directed by the Engineer, all construction signs and work zone speed limit assemblies shall be removed. All speed limit signs and posts that were existing at the start of the project within the work zone/project limits shall be restored back to their original locations and configurations.
6. Placement of construction signs shall not obstruct the path of pedestrians and bicyclists.
7. The removal and restoration of existing regulatory speed limit signs with new posts along with the installation, maintenance and removal of work zone speed limit sign assemblies shall be considered incidental to Item No. 645.0500, Traffic Control.

EarthTech
A tyco International Ltd. Company

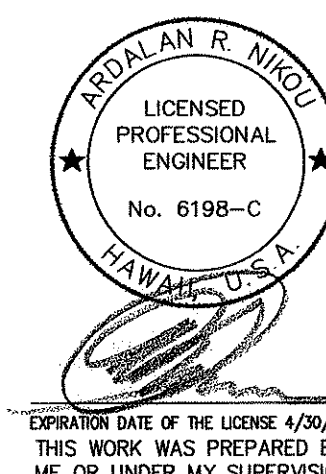

STATE OF HAWAII
DEPARTMENT OF TRANSPORTATION
HIGHWAYS DIVISION

**LOW SPEED DIVIDED HIGHWAY
WORK ZONE SIGNING PLAN, NOTES & DETAILS**

KAILUA ROAD PERMANENT
ROCKFALL AND LANDSLIDE MITIGATION
PROJECT NO. 61D-02-06

Scale: As Noted Date: Aug 2006

SHEET No. 2 OF 5 SHEETS

FED. ROAD DIST. NO.	STATE	PROJ. NO.	FISCAL YEAR	SHEET NO.	TOTAL SHEETS
OAHU	HAWAII	61D-02-06	2006	55	57

TRUE NORTH
SCALE : 1" = 40'

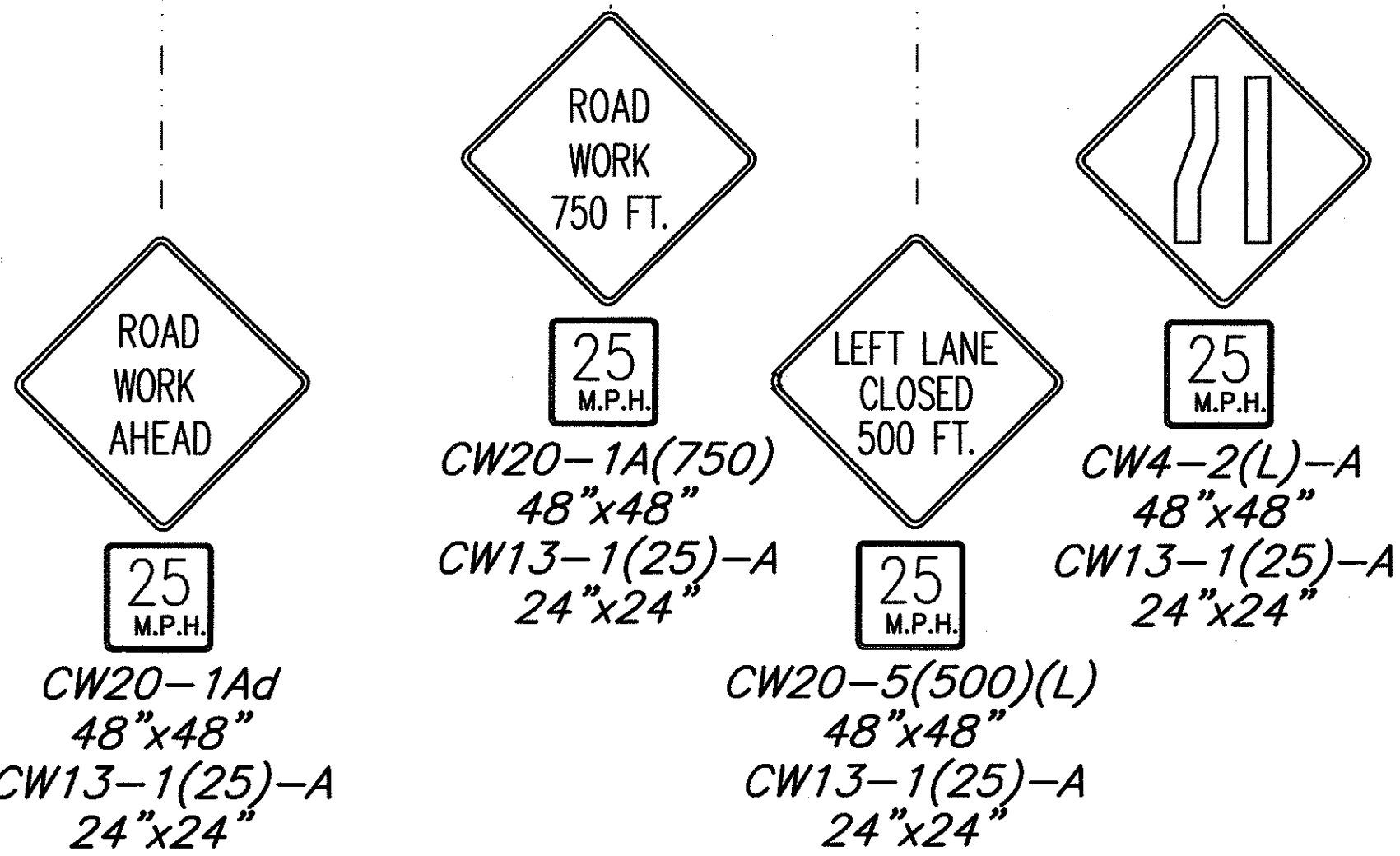
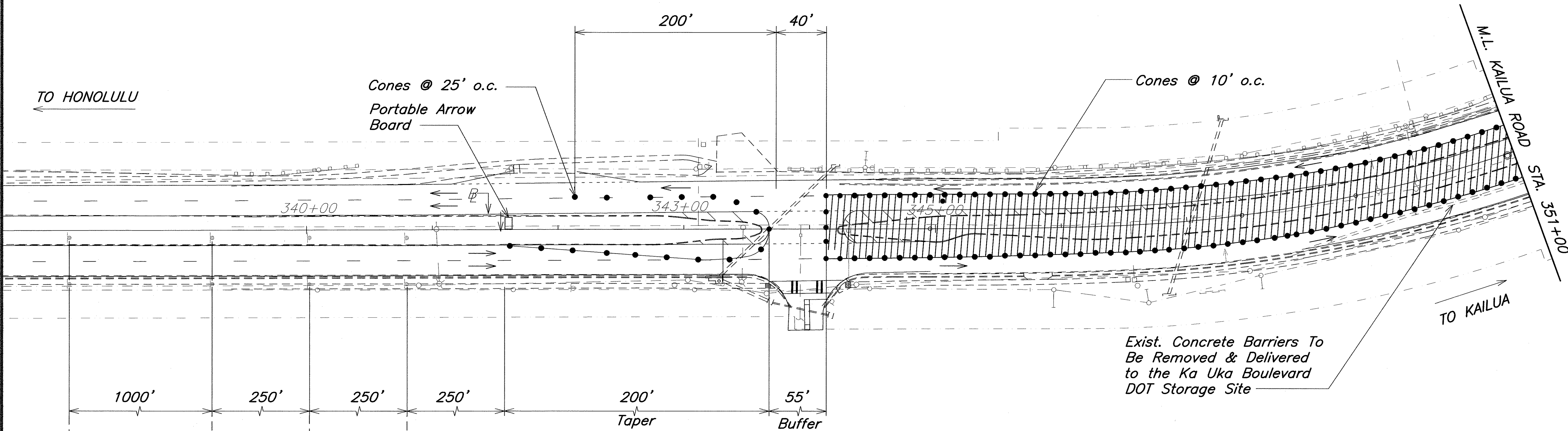

LEGEND:

 Work Area

EarthTech
A **tyco** International Ltd. Company

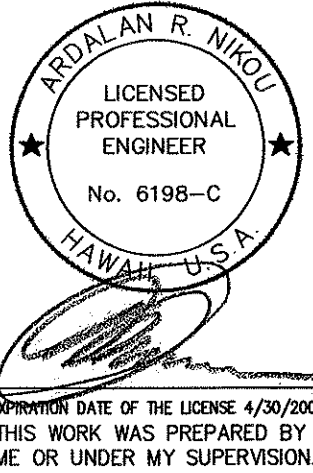

STATE OF HAWAII
DEPARTMENT OF TRANSPORTATION
HIGHWAYS DIVISION

TRAFFIC CONTROL PLAN

KAILUA ROAD PERMANENT
ROCKFALL AND LANDSLIDE MITIGATION
PROJECT NO. 61D-02-06

Scale: As Noted Date: Aug 2006

SHEET No. 3 OF 5 SHEETS

FED. ROAD DIST. NO.	STATE	PROJ. NO.	FISCAL YEAR	SHEET NO.	TOTAL SHEETS
OAHU	HAWAII	61D-02-06	2006	56	57

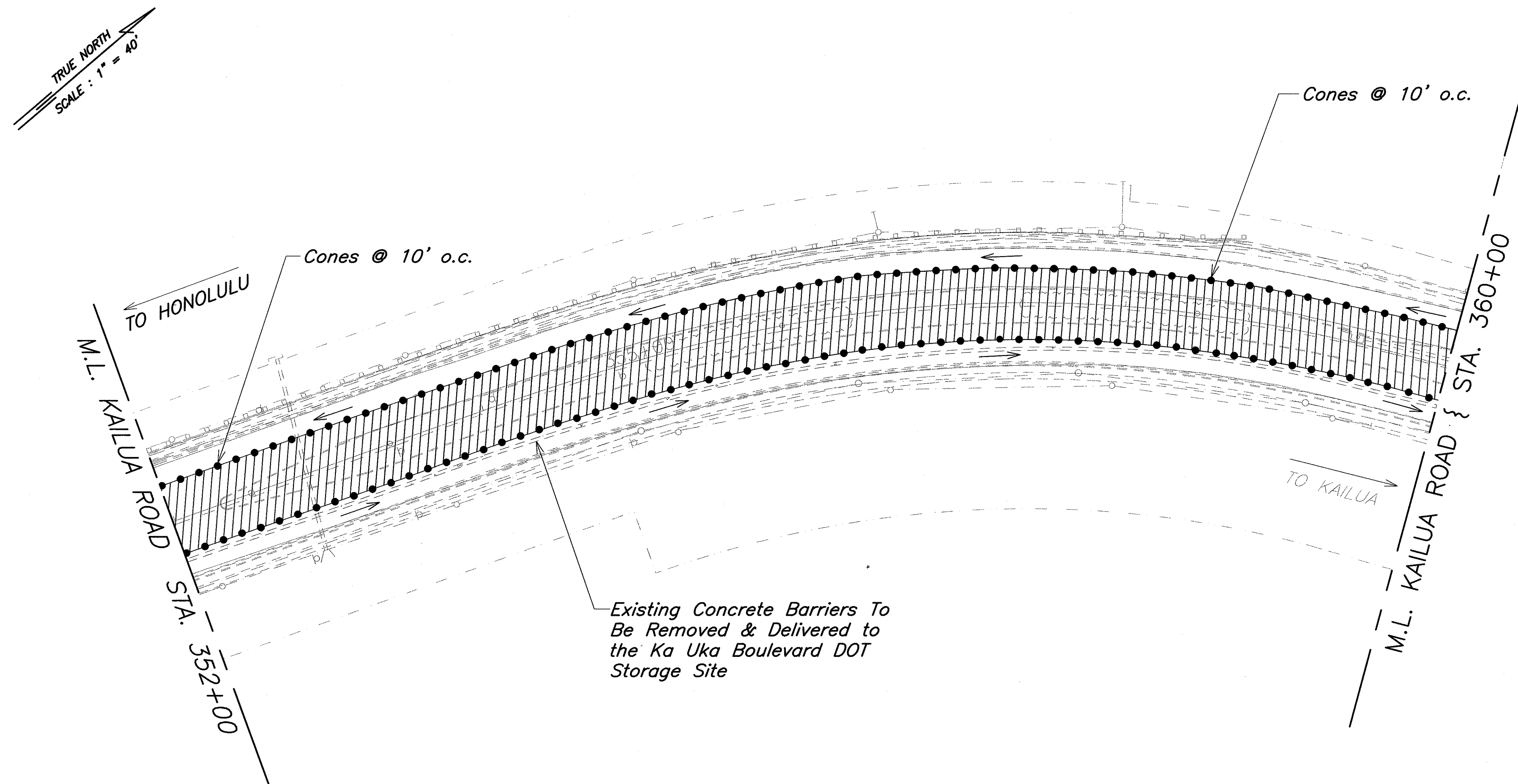

ORIGINAL PLAN	SURVEY PLOTTED BY	DATE
NOTE BOOK	DRAWN BY	
	TRACED BY	
	QUANTITIES BY	
	CHECKED BY	
No.		

LEGEND:

Work Area

EarthTech
 a **tyco** International Ltd. Company

ARULAN R. NIKOL
 LICENSED PROFESSIONAL ENGINEER
 No. 6198-C
 HAWAII, U.S.A.

EXPIRATION DATE OF THE LICENSE 4/30/2008
 THIS WORK WAS PREPARED BY ME OR UNDER MY SUPERVISION.

STATE OF HAWAII
 DEPARTMENT OF TRANSPORTATION
 HIGHWAYS DIVISION

TRAFFIC CONTROL PLAN

*KAILUA ROAD PERMANENT
 ROCKFALL AND LANDSLIDE MITIGATION
 PROJECT NO. 61D-02-06*

Scale: As Noted Date: Aug 2006

SHEET No. 4 OF 5 SHEETS

FED. ROAD DIST. NO.	STATE	PROJ. NO.	FISCAL YEAR	SHEET NO.	TOTAL SHEETS
OAHU	HAWAII	61D-02-06	2006	57	57

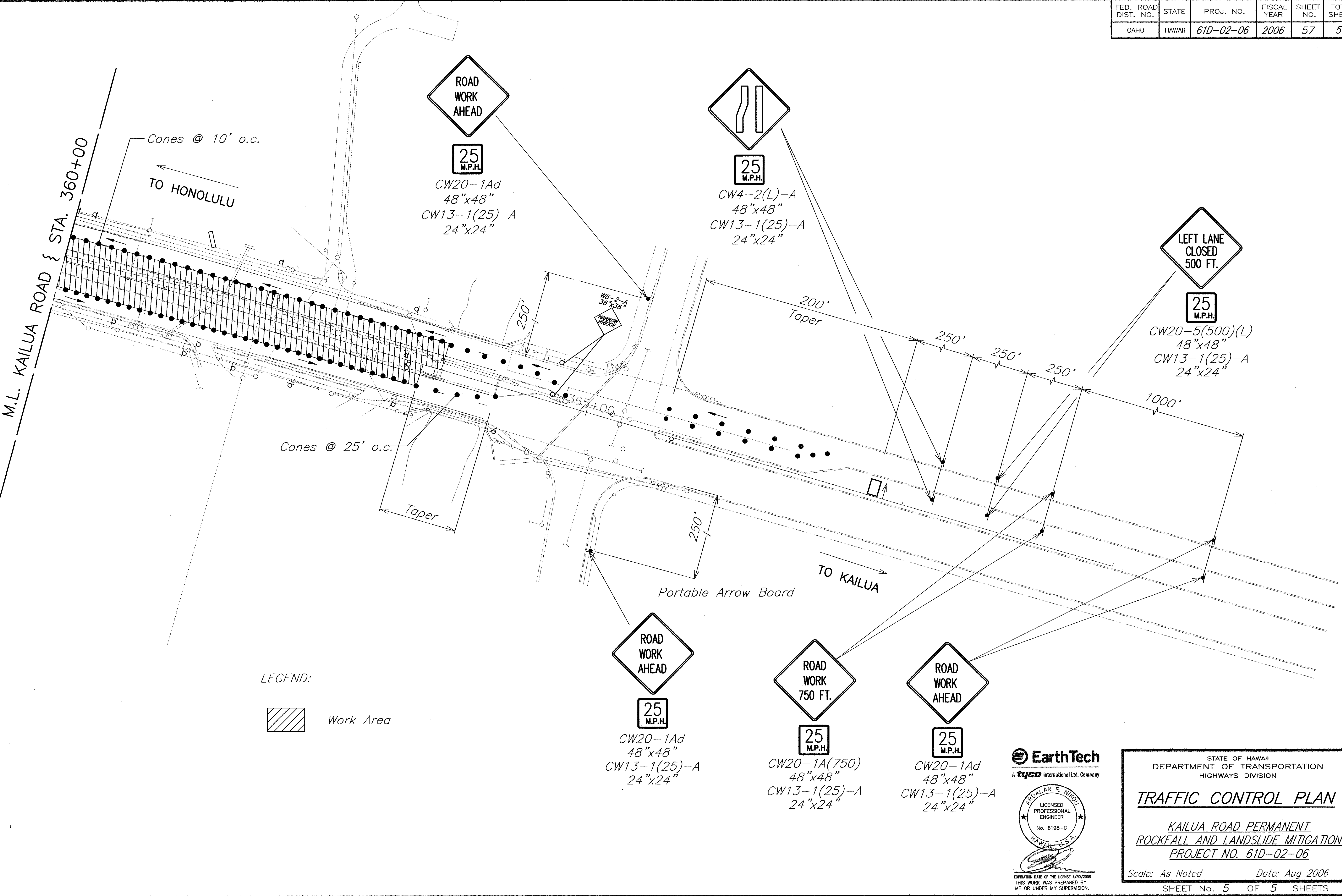

SURVEY PLOTTED BY	DATE
DESIGNED BY	
NOTED BY	
CHECKED BY	
APPROVED BY	
DATE	

EarthTech
A tyco International Ltd. Company

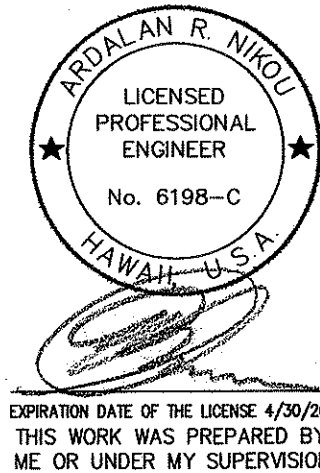

STATE OF HAWAII
DEPARTMENT OF TRANSPORTATION
HIGHWAYS DIVISION

TRAFFIC CONTROL PLAN

KAILUA ROAD PERMANENT
ROCKFALL AND LANDSLIDE MITIGATION
PROJECT NO. 61D-02-06

Scale: As Noted Date: Aug 2006

SHEET No. 5 OF 5 SHEETS

LEGEND

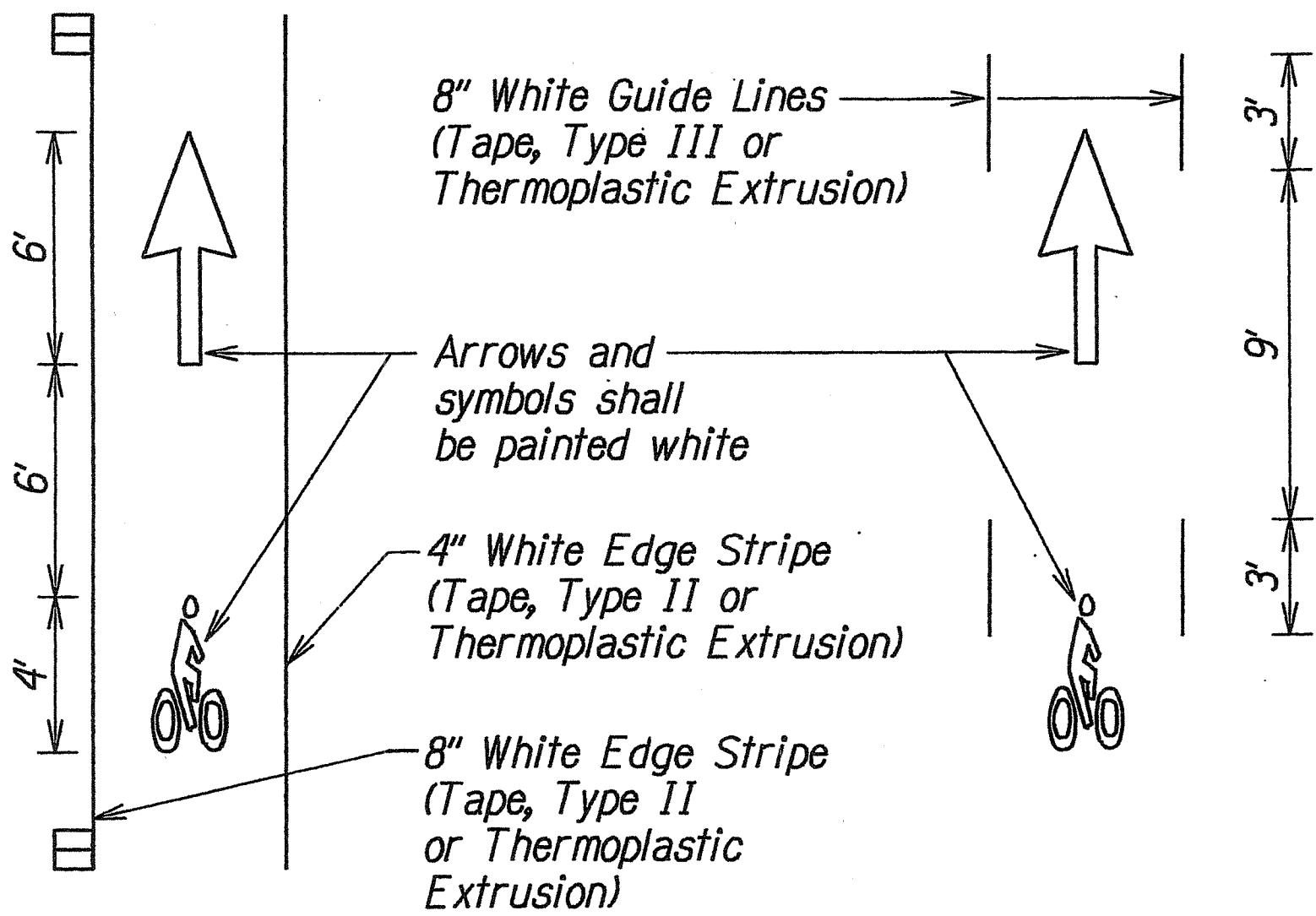
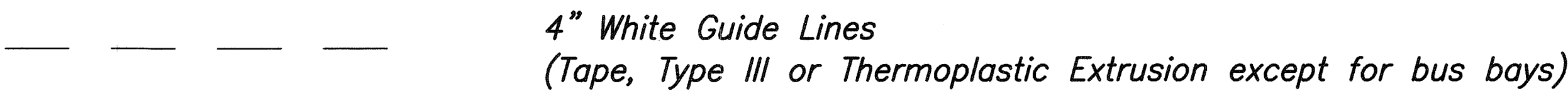
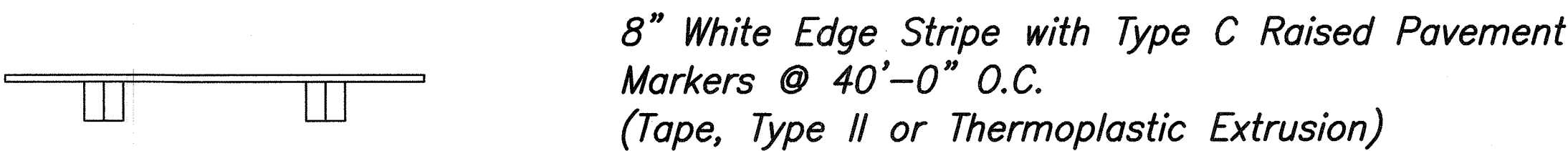
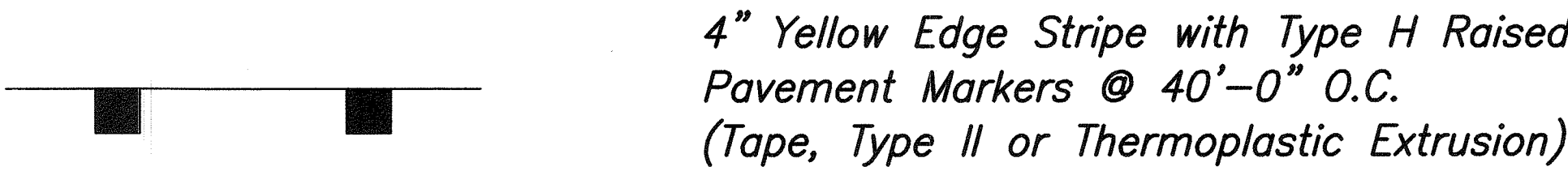
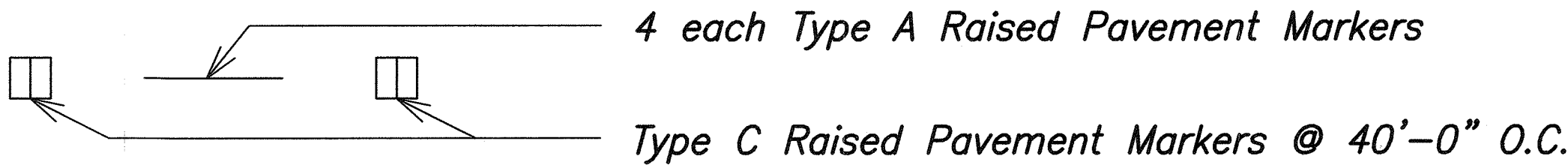

NOTE: Bike Lane Markings - Pavement Arrows and Symbol shall be paid for as one complete set.

Notes

1. Layout of pavement markings and striping shall be done by the Contractor and approved by the Engineer prior to any installation work.
2. Existing pavement markings not incorporated in the final traffic pattern shall be removed as directed by the Engineer. Costs shall be incidental to the various pavement marking items.
3. Raised pavement markings shall not be installed within crosswalks.
4. Final locations of all signs shall be approved by the Engineer prior to any installation work.
5. Inform the Engineer of any existing sign not shown on these plans.
6. All pavement striping shall be as noted on the legend or plans.
7. All preformed pavement marking tapes over existing pavement shall be applied with an approved primer as recommended by the tape manufacturer and as approved by the Engineer. The primer shall be allowed to dry to the tacky stage prior to tape application.
8. Clean all existing signs shown in the plans. Work shall be considered incidental and inclusive of various contract items.
9. Adjust and straighten all existing signs shown in the plans to be square and plumb. Work shall be considered incidental and inclusive of various contract items.
10. Remove and dispose branches, leaves, and vegetation obstructing reasonable motorist view to the signs. Work shall be considered incidental of various contract items.
11. Install State Type II Object Marker on all utility poles within project vicinity. See Standard Plan TE-17. Replace existing with new if existing marker on the pole exist.
12. All signs shall use high-intensity grade reflective sheeting in accordance with Specifications.
13. Install blue hydrant raised pavement markers at all hydrant locations in accordance with the latest BWS standards.

SURVEY PLOTTED BY	DATE
DRAWN BY	
DESIGNED BY	
QUANTITIES BY	
CHECKED BY	
ORIGINAL PLAN	
NOTE BOOK	
No.	

EarthTech
A tyco International Ltd. Company

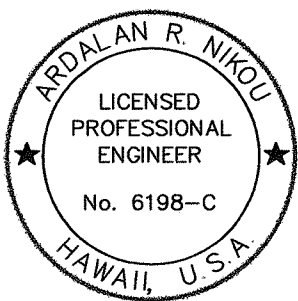

EXPIRATION DATE OF THE LICENSE 4/30/2008
THIS WORK WAS PREPARED BY
ME OR UNDER MY SUPERVISION.

STATE OF HAWAII
DEPARTMENT OF TRANSPORTATION
HIGHWAYS DIVISION

PAVEMENT MARKING
LEGEND

KAILUA ROAD PERMANENT
ROCKFALL AND LANDSLIDE MITIGATION
PROJECT NO. 61D-02-06

Scale: As Noted Date: Aug 2006

SHEET No. 1 OF 3 SHEETS

C.O. 57S-1

FED. ROAD DIST. NO.	STATE	PROJ. NO.	FISCAL YEAR	SHEET NO.	TOTAL SHEETS
OAHU	HAWAII	61D-02-06	2006	C.O. 57S-2	57

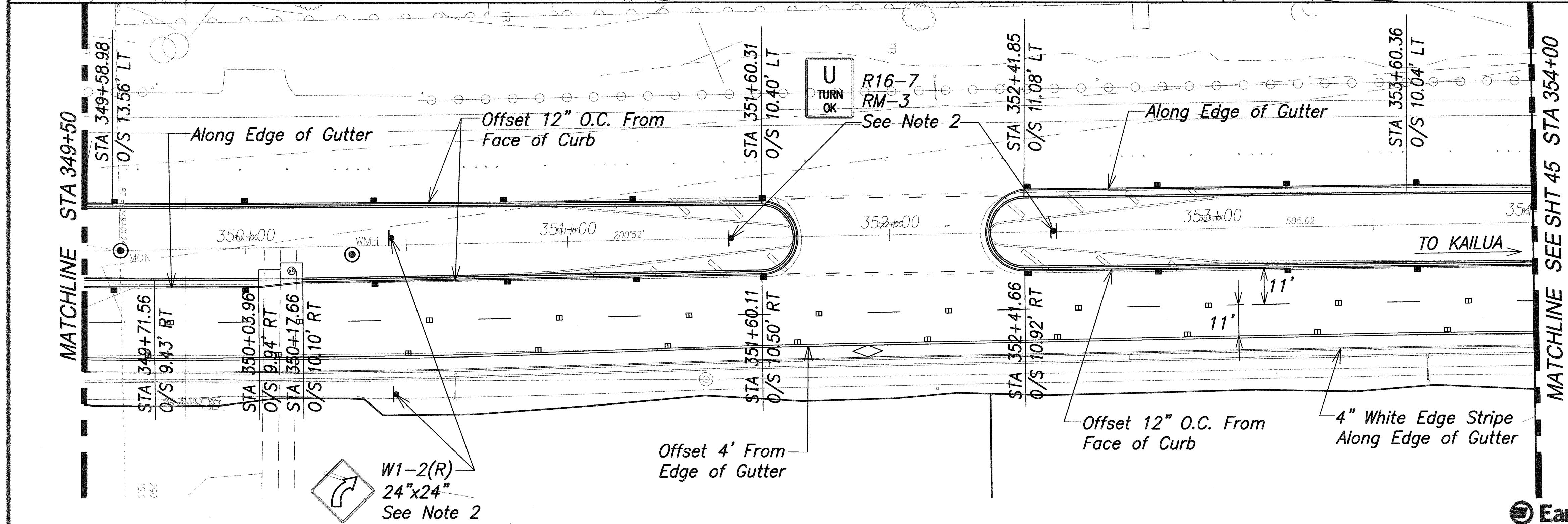
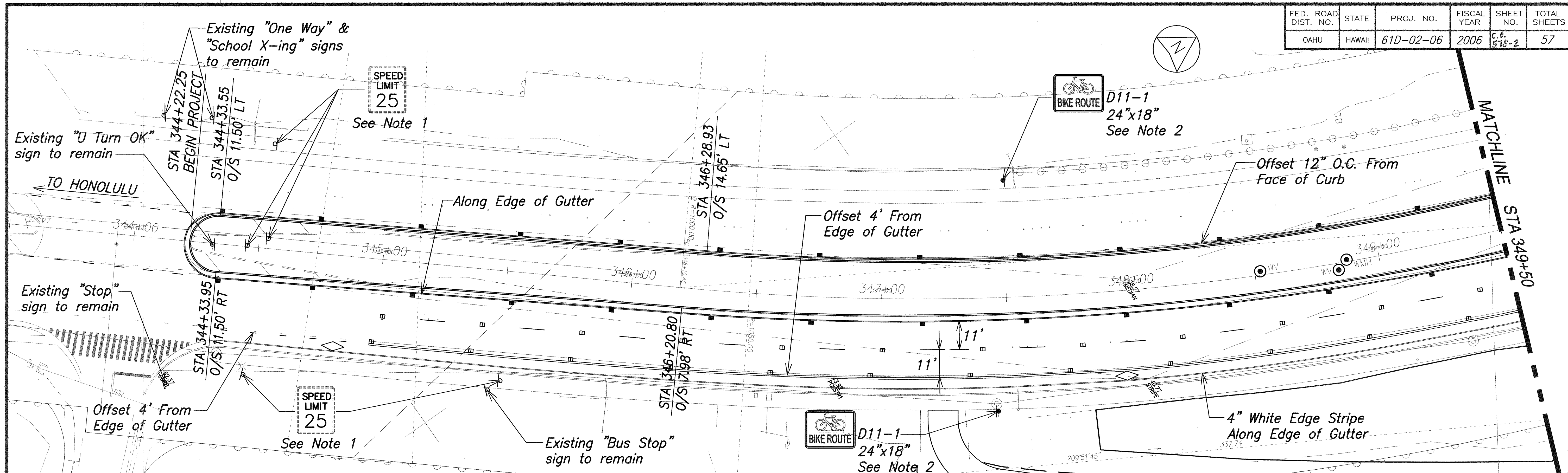

Notes:

1. Remove existing sign(s) and post(s).
2. Install new sign(s) and post(s).
3. Remove existing temporary construction signs whether or not shown on the plan.

ORIGINAL PLAN	SURVEY PLOTTED BY	DATE
NOTE BOOK	DRAWN BY	
	DESIGNED BY	
	QUANTITIES BY	
	CHECKED BY	

GRAPHIC SCALE

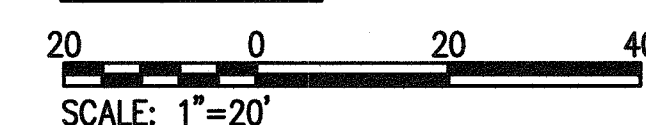

EarthTech
A tyco International Ltd. Company

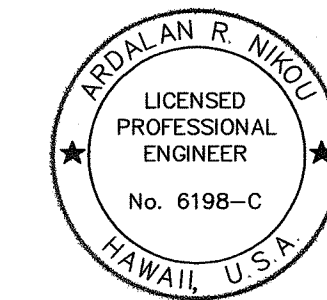

EXPIRATION DATE OF THE LICENSE: 4/30/2008
THIS WORK WAS PREPARED BY ME OR UNDER MY SUPERVISION.

STATE OF HAWAII
DEPARTMENT OF TRANSPORTATION
HIGHWAYS DIVISION
**PAVEMENT MARKING
AND SIGNAGE PLAN 1**
KAILUA ROAD PERMANENT
ROCKFALL AND LANDSLIDE MITIGATION
PROJECT NO. 61D-02-06

Scale: As Noted Date: Aug 2006
SHEET No. 2 OF 3 SHEETS

C.O. 57S-2

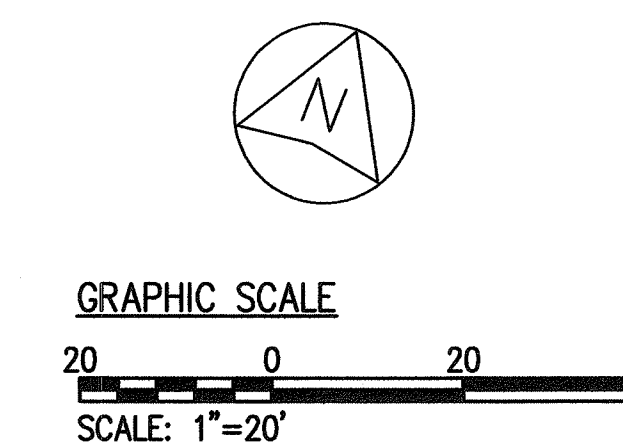
[illegible]

C.O. 57S-3

ORIGINAL PLAN	SURVEY PLOTTED BY _____ DATE _____
NOTE BOOK	DRAWN BY _____
	TRACED BY _____
	DESIGNED BY _____
	QUANTITIES BY _____
10.	CHECKED BY _____