

FED. ROAD DIST. NO.	STATE	PROJ. NO.	FISCAL YEAR	SHEET NO.	TOTAL SHEETS
OAHU	HAWAII	61D-02-06	2006	ADD.29	57

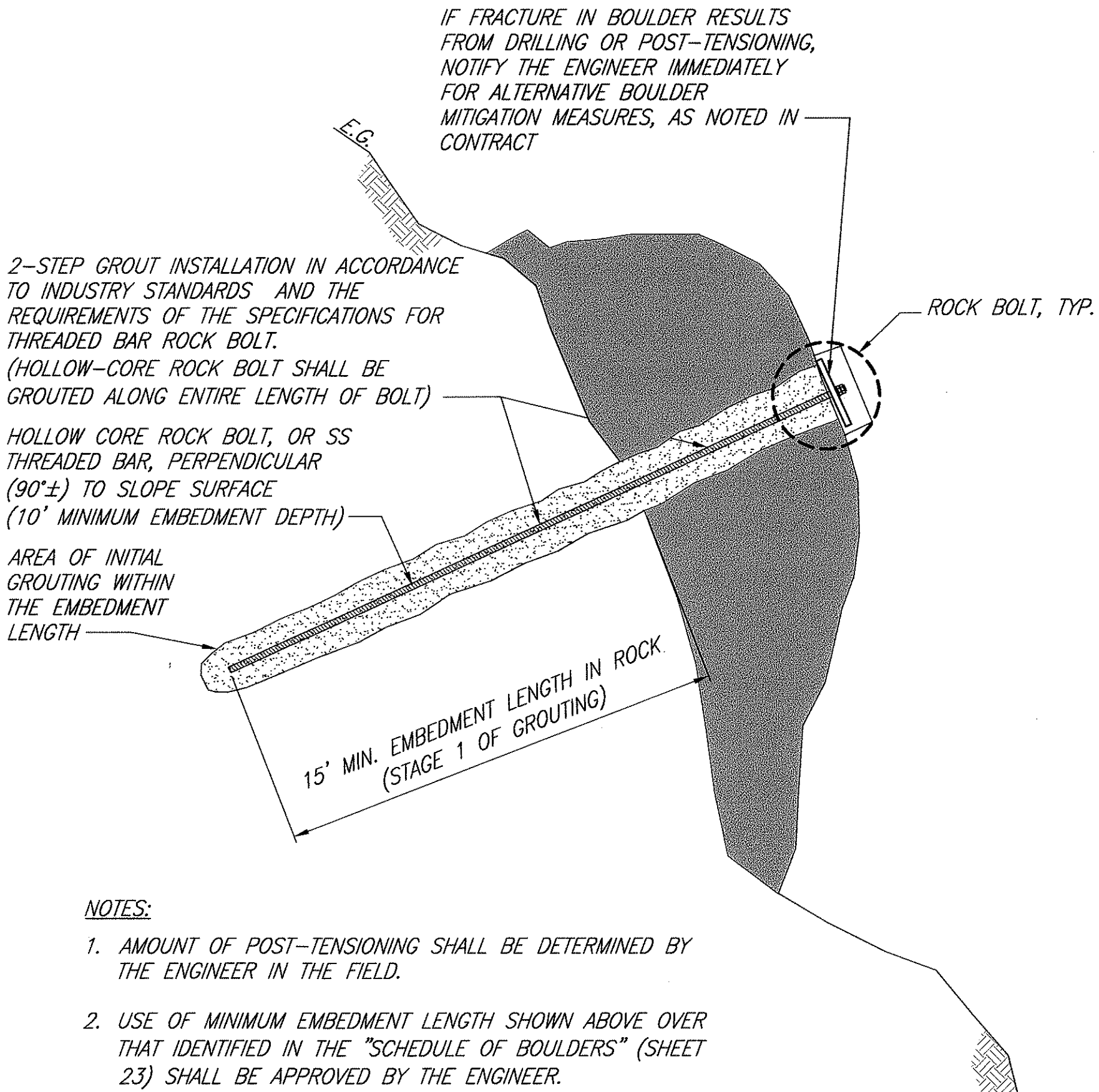

ROCK BOLT ANCHOR (POST-TENSIONED), TYP.
NOT TO SCALE

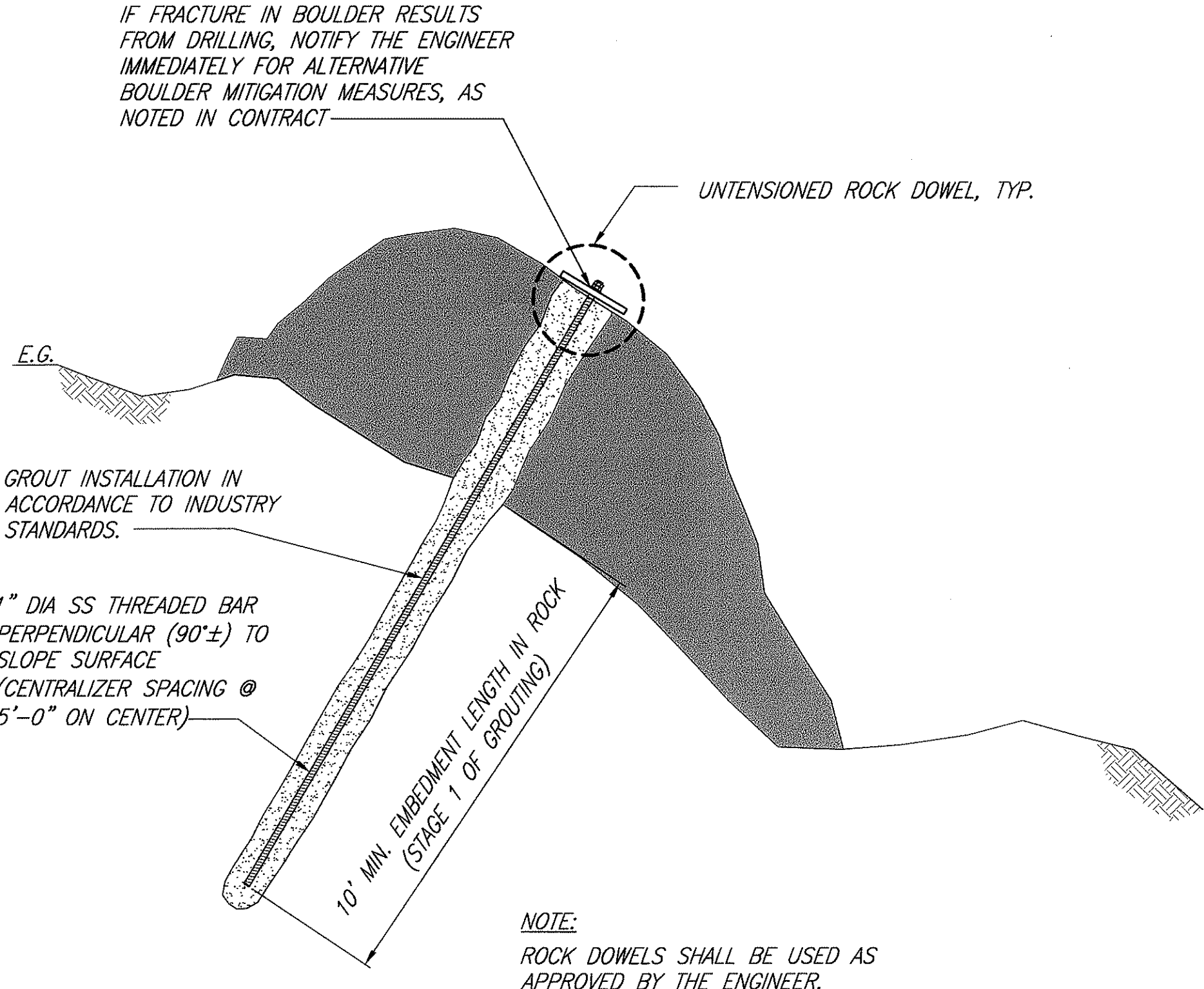

ROCK DOWEL ANCHOR, TYP.
NOT TO SCALE

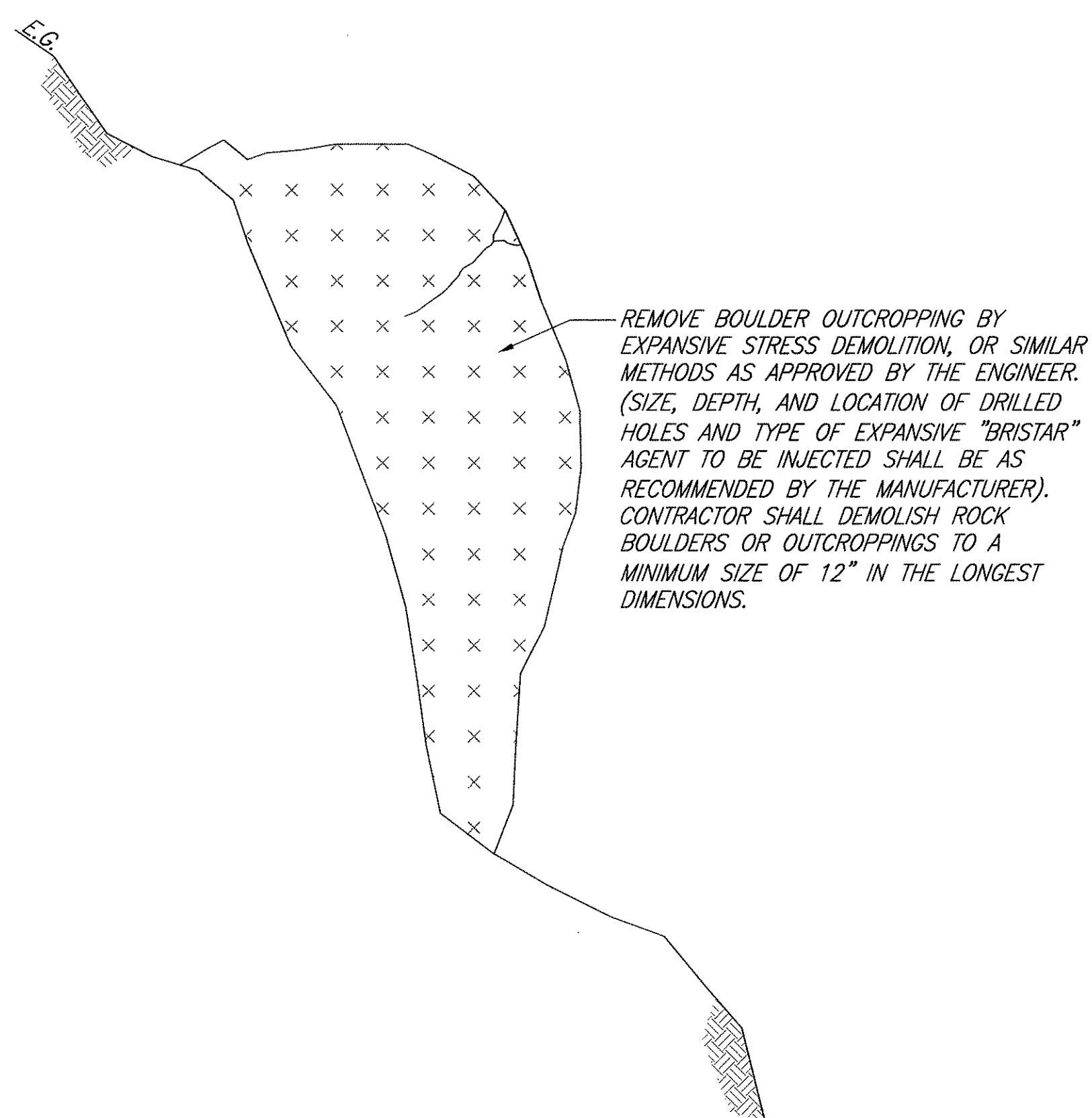

BOULDER DEMOLITION, TYPICAL
NOT TO SCALE

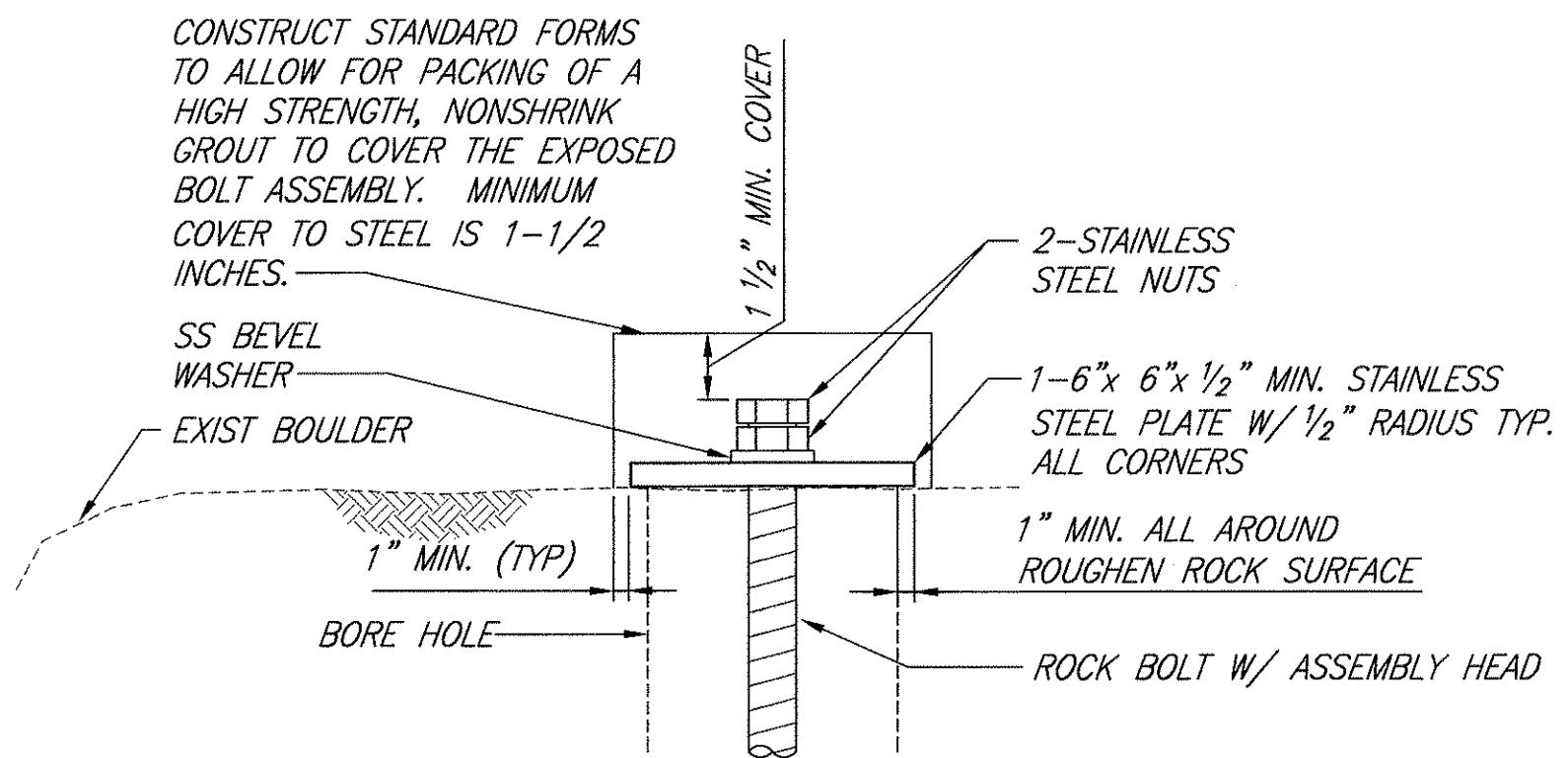

NOTE: ALL EXPOSED METAL SHALL EITHER BE POWDER COATED OR PAINTED WITH PAINT COLOR JUST FLAT BLACK AS APPROVED BY THE ENGINEER.

SECTION

1 ROCK BOLT DETAIL
29 NOT TO SCALE

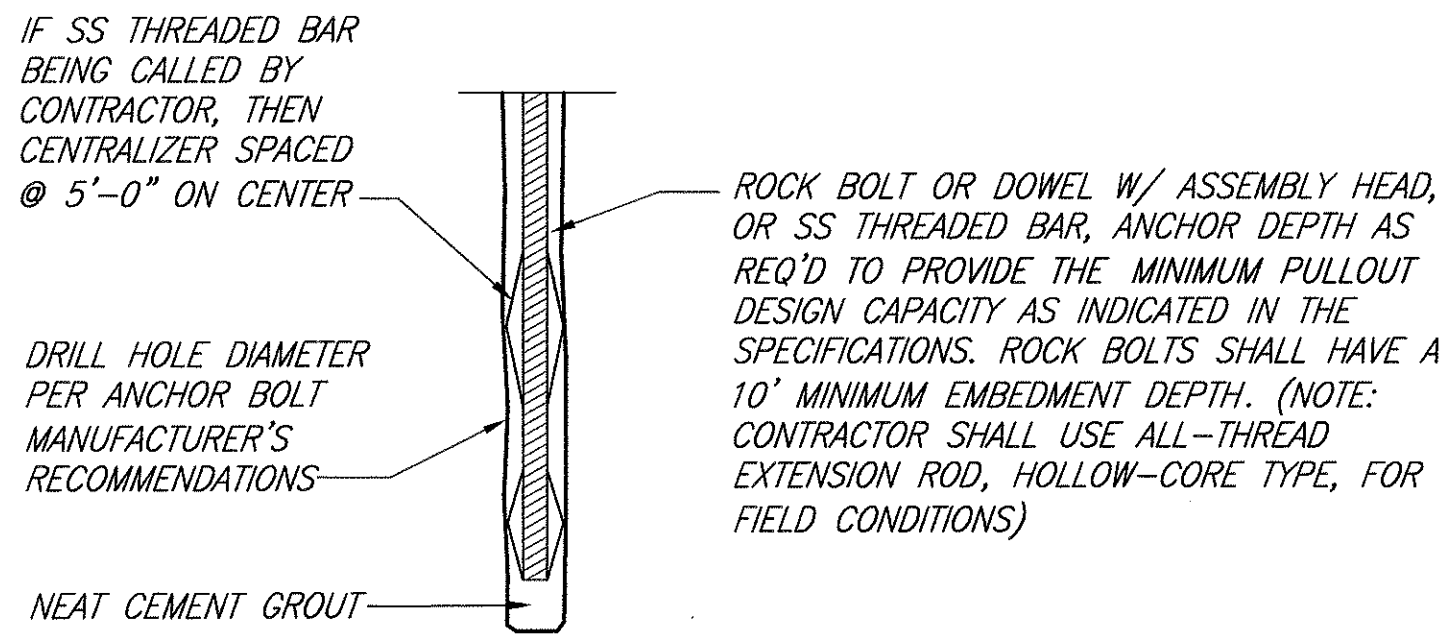

2 ROCK BOLT/ DOWEL DETAIL
29 NOT TO SCALE

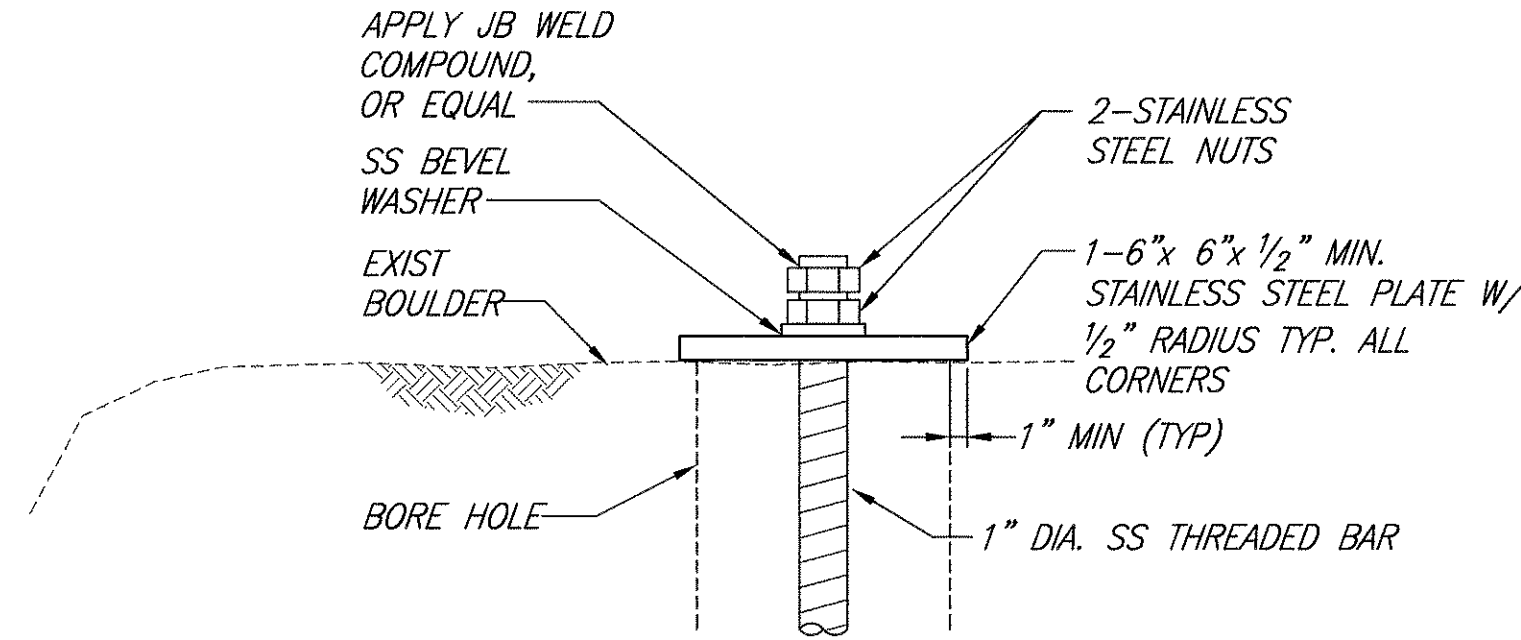

SECTION

3 ROCK DOWEL DETAIL
29 NOT TO SCALE

EarthTech
A tyco International Ltd. Company

ASADAN R. NIQUO
LICENSED PROFESSIONAL ENGINEER
No. 6198-C
HAWAII
EXPIRATION DATE OF THE LICENSE: 4/30/2008
THIS WORK WAS PREPARED BY ME OR UNDER MY SUPERVISION.

9/04/06	Added notes; Revised details
Date	Revision

STATE OF HAWAII
DEPARTMENT OF TRANSPORTATION
HIGHWAYS DIVISION

ROCK BOLT ANCHOR

KAILUA ROAD PERMANENT
ROCKFALL AND LANDSLIDE MITIGATION
PROJECT NO. 61D-02-06

Scale: As Noted Date: Aug 2006

SHEET No. 1 OF 1 SHEETS