

FED. ROAD DIST. NO.	STATE	PROJ. NO.	FISCAL YEAR	SHEET NO.	TOTAL SHEETS
HAWAII	HAW.	61D-01-06M	2006	16	18

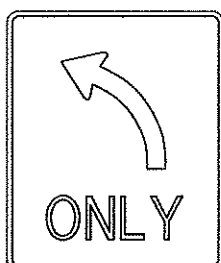

R3-5L
30"x36" on
Removable
Post

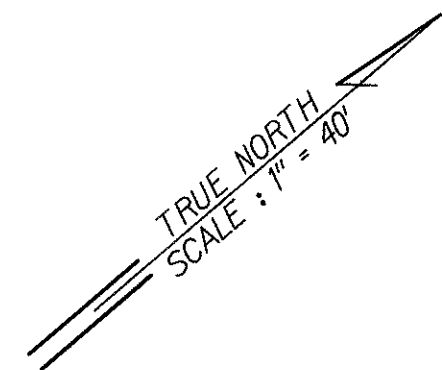
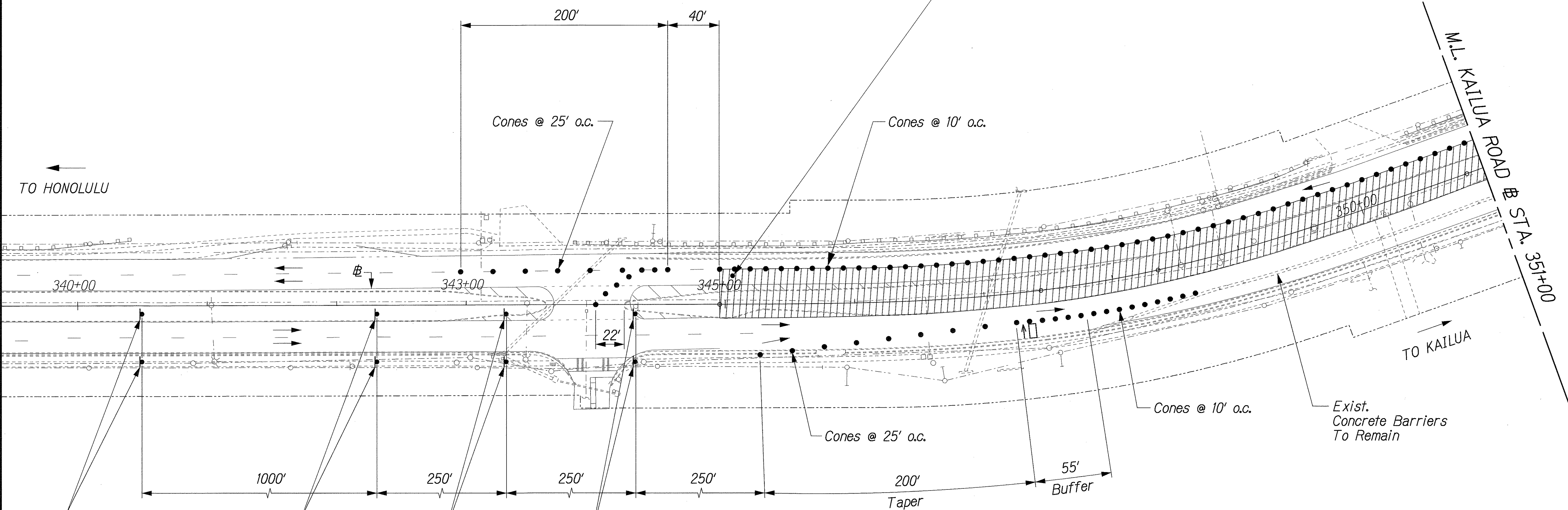

CW20-1Ad
48"x48"
CW13-1(25)-A
24"x24"



CW20-1A(750)
48"x48"
CW13-1(25)-A
24"x24"



CW20-5(500)(R)
48"x48"
CW13-1(25)-A
24"x24"

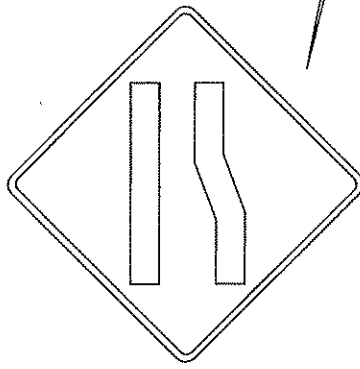

CW4-2(R)-A
48"x48"
CW13-1(25)-A
24"x24"

LEGEND:

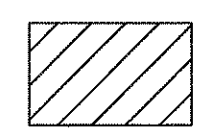

Work Area

STATE OF HAWAII
DEPARTMENT OF TRANSPORTATION
HIGHWAYS DIVISION

TRAFFIC CONTROL PLAN

KAILUA ROAD
TEMPORARY LANE FOR ROCKFALL & LANDSLIDE
PROJECT NO.: 61D-01-06M
Scale: 1" = 40' Date: May 2006
SHEET No. TC-3 OF 5 SHEETS

FED. ROAD DIST. NO.	STATE	PROJ. NO.	FISCAL YEAR	SHEET NO.	TOTAL SHEETS
HAWAII	HAW.	61D-01-06M	2006	17	18

TRUE NORTH
SCALE: 1" = 40'

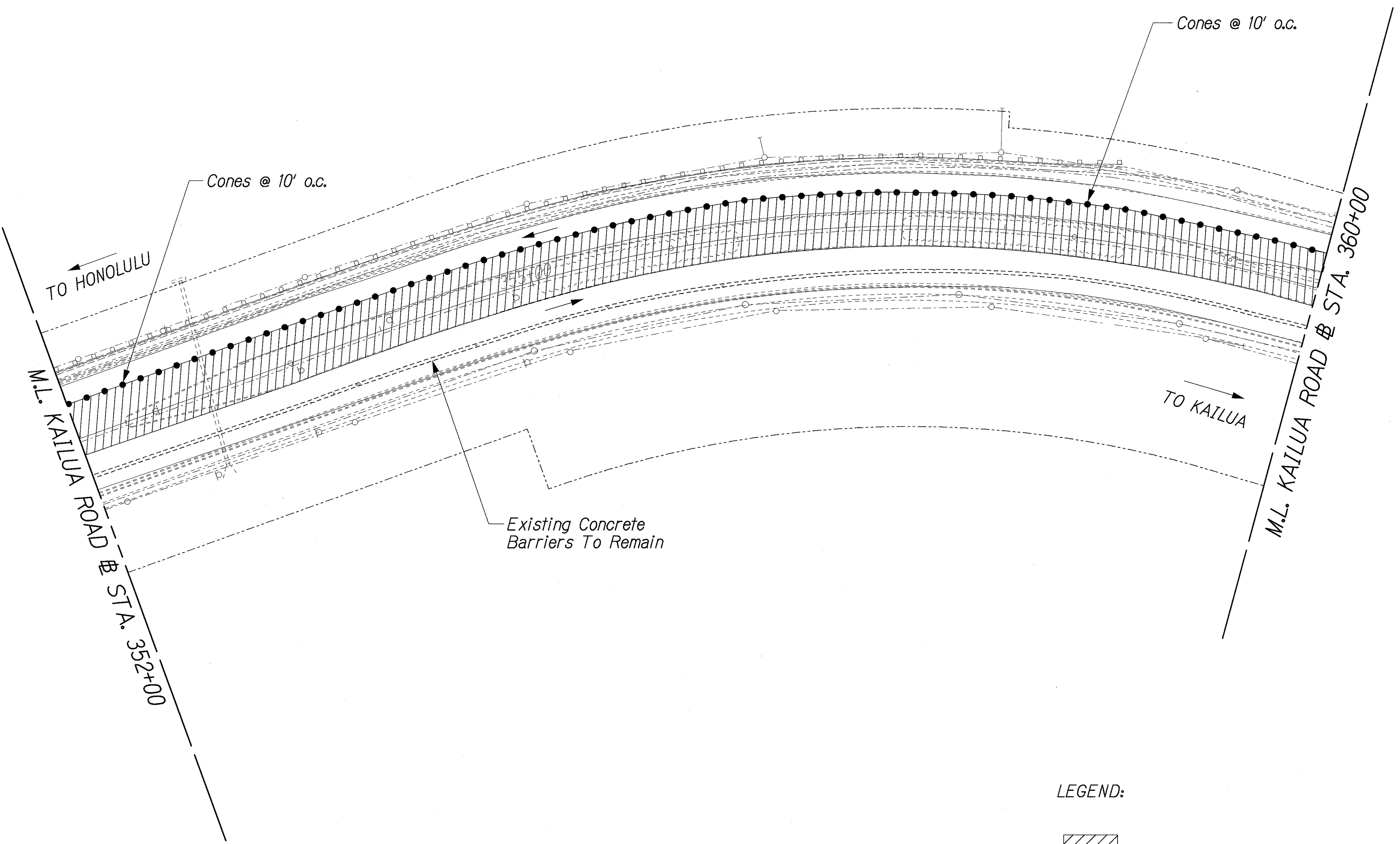

LEGEND:

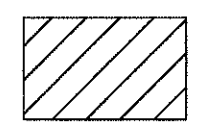

Work Area

DESIGNED BY	DATE
DRAWN BY	
CHECKED BY	
NOTED BY	
QUANTITIES BY	
NO.	

16/KAILUA ROAD/ROAD/TCP24gn

STATE OF HAWAII
DEPARTMENT OF TRANSPORTATION
HIGHWAYS DIVISION

TRAFFIC CONTROL PLAN

KAILUA ROAD
TEMPORARY LANE FOR ROCKFALL & LANDSLIDE
PROJECT NO.: 61D-01-06M
Scale: 1" = 40' Date: May 2006

SHEET No. TC-4 OF 5 SHEETS

FED. ROAD DIST. NO.	STATE	PROJ. NO.	FISCAL YEAR	SHEET NO.	TOTAL SHEETS
HAWAII	HAW.	61D-01-06M	2006	18	18

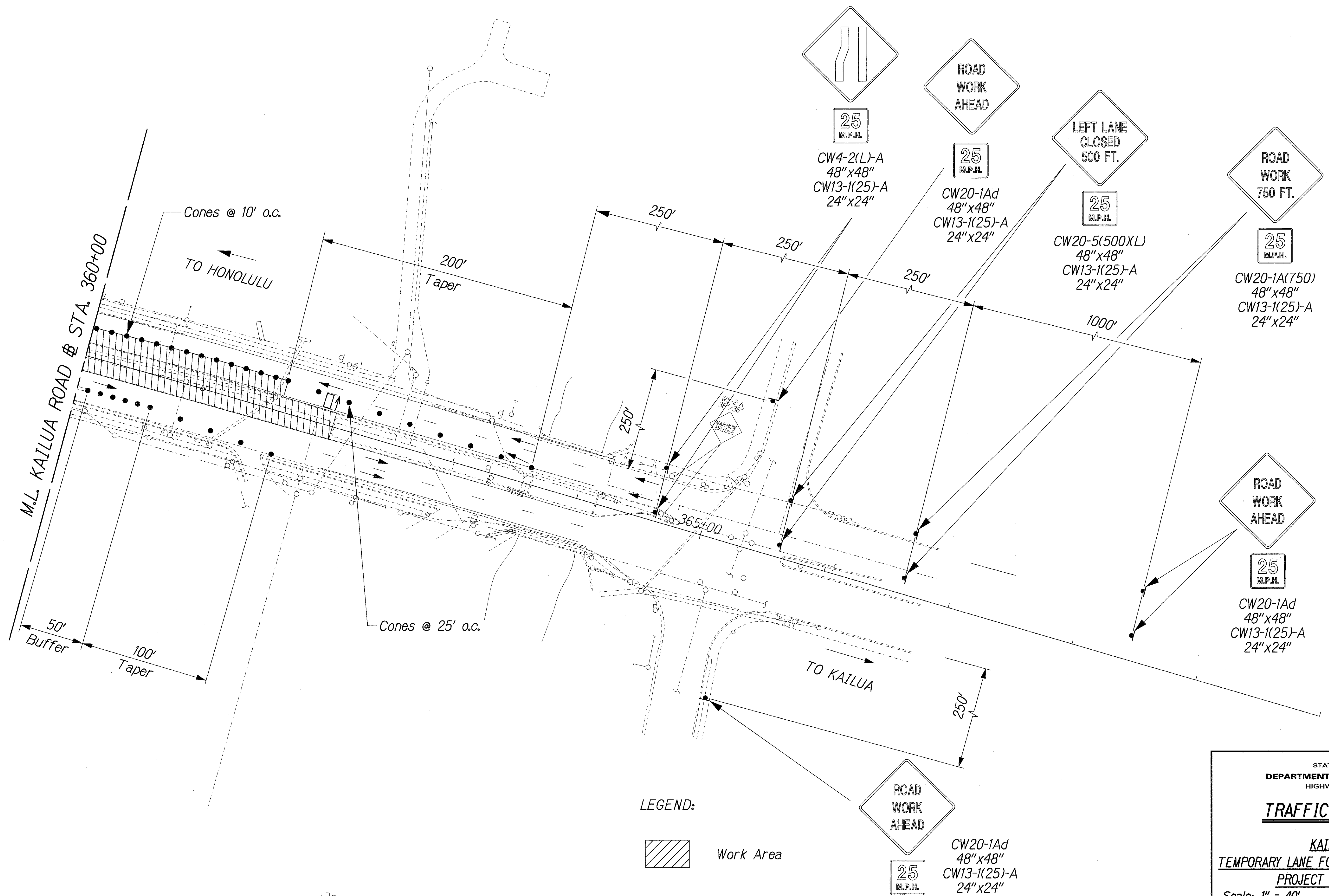

DESIGNED BY	DATE
DRAWN BY	
CHECKED BY	
NOTED BY	
QUANTITIES BY	
CHECKED BY	

1/6 KAILUA ROAD/ROAD/TCF3.dgn

LEGEND:

Work Area

STATE OF HAWAII
DEPARTMENT OF TRANSPORTATION
HIGHWAYS DIVISION

TRAFFIC CONTROL PLAN

KAILUA ROAD
TEMPORARY LANE FOR ROCKFALL & LANDSLIDE
PROJECT NO.: 61D-01-06M
Scale: 1" = 40' Date: May 2006

SHEET No. TC-5 OF 5 SHEETS