

FED. ROAD DIST. NO.	STATE	PROJ. NO.	FISCAL YEAR	SHEET NO.	TOTAL SHEETS
HAWAII	HAW.	61C-01-04M	2004	51	91

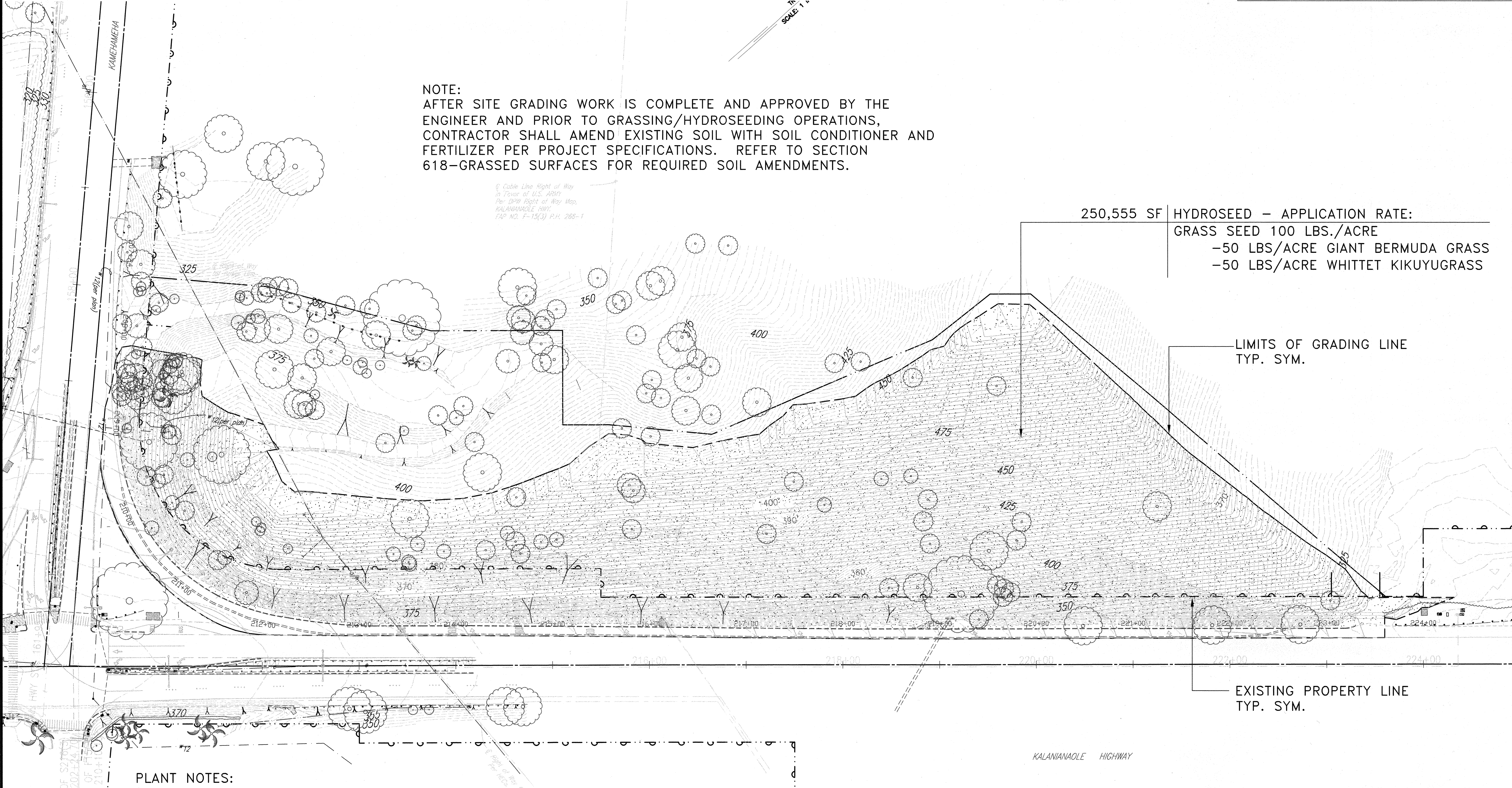

SURVEY PLOTTED BY	DATE
DRAWN BY	
DESIGNED BY	
QUANTITIES BY	
CHECKED BY	
ORIGINAL PLAN	
NOTE BOOK	
No.	

PLANT NOTES:

1. LANDSCAPE CONTRACTOR SHALL FIELD VERIFY ALL QUANTITIES AND DIMENSIONS PRIOR TO INSTALLATION. QUANTITIES SHOWN IN PLANT LIST ARE FOR CONVENIENCE ONLY. PLANS SHALL GOVERN.
2. LANDSCAPE CONTRACTOR SHALL BE RESPONSIBLE FOR LOCATING AND PROTECTING ALL EXISTING UTILITIES.
3. NOTIFY AND MEET WITH THE ENGINEER PRIOR TO PLANT INSTALLATION FOR VERIFICATION/INTERPRETATION OF PLANS.
4. NOTIFY ENGINEER OF ANY DISCREPANCIES IN PLANT LOCATIONS OR INSUFFICIENT PLANT QUANTITIES DUE TO DIFFERENCES IN PLAN AND ACTUAL FIELD CONDITIONS.
5. NOTIFY ENGINEER 30 DAYS PRIOR TO PLANTING OPERATIONS FOR APPROVAL OF ALL PLANT MATERIAL. ALL PLANT MATERIAL NOT APPROVED BY THE ENGINEER WILL BE SUBJECT TO REJECTION.

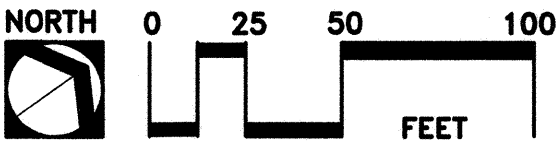

R. Stan Duncan
4/26/04

STATE OF HAWAII
DEPARTMENT OF TRANSPORTATION
HIGHWAYS DIVISION

PLANTING PLAN
KALANIANA'OLE HIGHWAY
EMERGENCY LANDSLIDE REPAIRS AT CASTLE JUNCTION

PROJECT NO. 61C-01-04M
Scale: 1"= 50'-0" Date: Sept. 26, 2003