

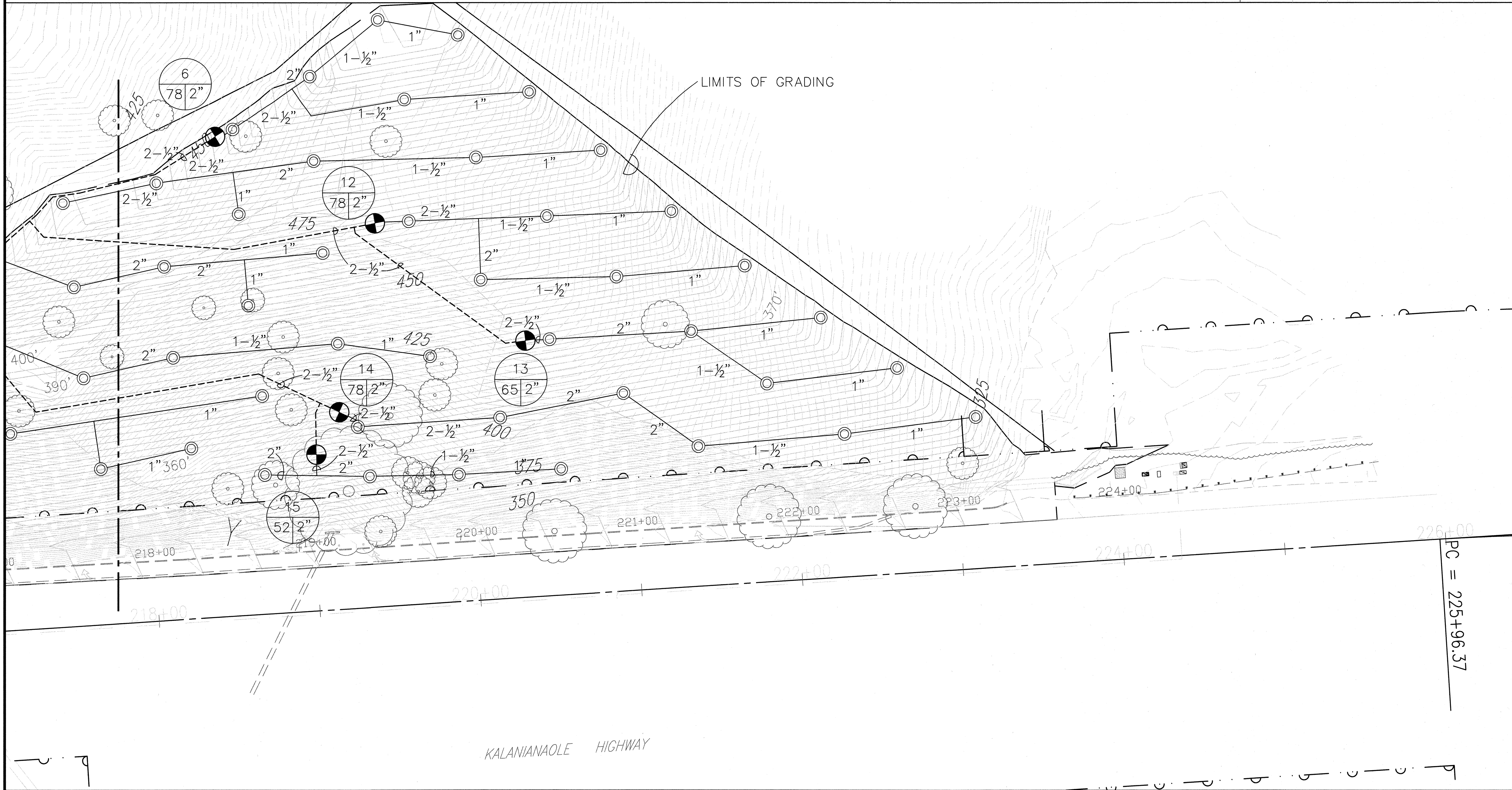



FED. ROAD DIST. NO.	STATE	PROJ. NO.	FISCAL YEAR	SHEET NO.	TOTAL SHEETS
HAWAII	HAW.	61C-01-04M	2004	47	91



ORIGINAL PLAN	SURVEY PLOTTED BY	DATE
NOTE BOOK	DRAWN BY	
	DESIGNED BY	
	QUANTITIES BY	
	CHECKED BY	

THIS PLAN IS DIAGRAMMATIC. IRRIGATION SYSTEM IS SUBJECT TO FIELD ADJUSTMENTS DUE TO UNANTICIPATED SITE CONDITIONS. THE IRRIGATION SYSTEM IS INTENDED TO BE TEMPORARY AND SHALL BE INSTALLED ABOVE GRADE. NO TRENCHING OR BURYING OF LINES SHALL OCCUR. LOCATE ALL MAINLINES, LATERALS, VALVES AND SPRINKLER HEADS WITHIN PLANTING AREAS, UNLESS OTHERWISE NOTED. AVOID ANY CONFLICT BETWEEN UTILITIES, STRUCTURES AND PLANTINGS. THE CONTRACTOR SHALL BE RESPONSIBLE FOR LOCATING AND PROTECTING ALL EXISTING UTILITIES.

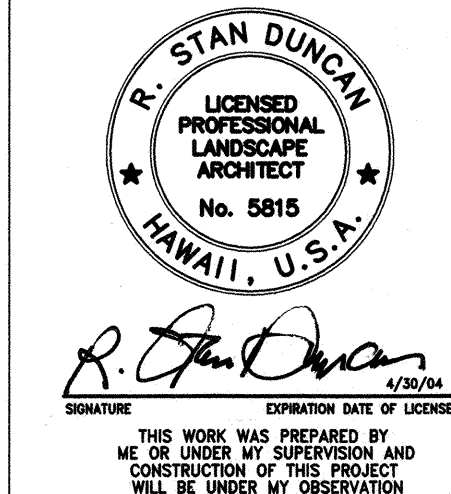
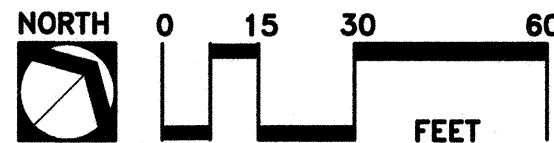

STATE OF HAWAII  
DEPARTMENT OF TRANSPORTATION  
HIGHWAYS DIVISION

**IRRIGATION PLAN**  
**KALANIANAʻOLE HIGHWAY**  
**EMERGENCY LANDSLIDE REPAIRS AT CASTLE JUNCTION**

**PROJECT NO. 61C-01-04M**  
Scale: 1" = 30'-0" Date: Sept. 26, 2003

SHEET No. 1-2 OF 5 SHEETS