

FED. ROAD DIST. NO.	STATE	PROJ. NO.	FISCAL YEAR	SHEET NO.	TOTAL SHEETS
HAWAII	HAW.	61B-01-98	1999	10	18

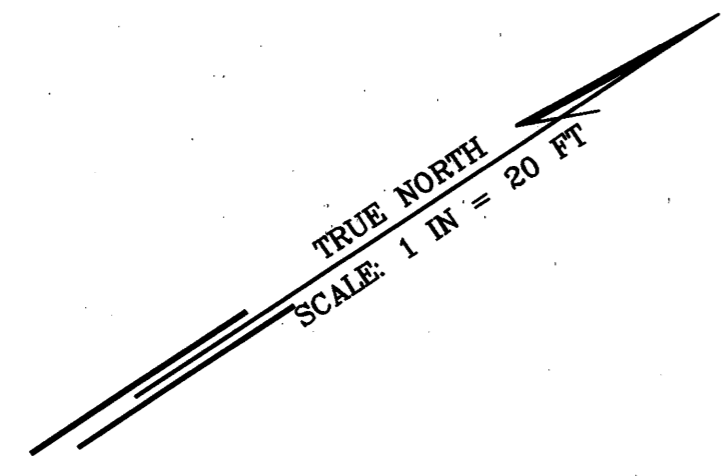

WAOKANAKA St.
 ←

Relocate Existing 5'x2' Sign on New Posts

DOWSETT AVE.
 ←

Relocate Existing 5'x2' Sign on New Posts (2)

CONDUIT	CABLE
1-2"	1-2C#14

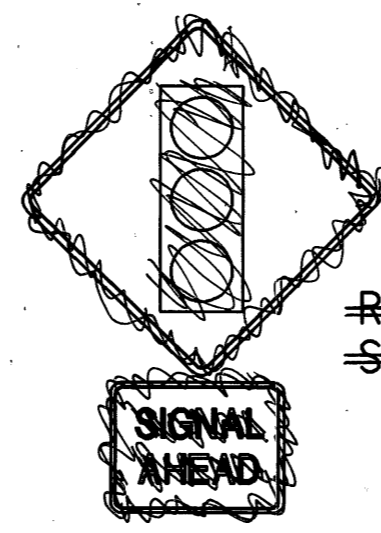
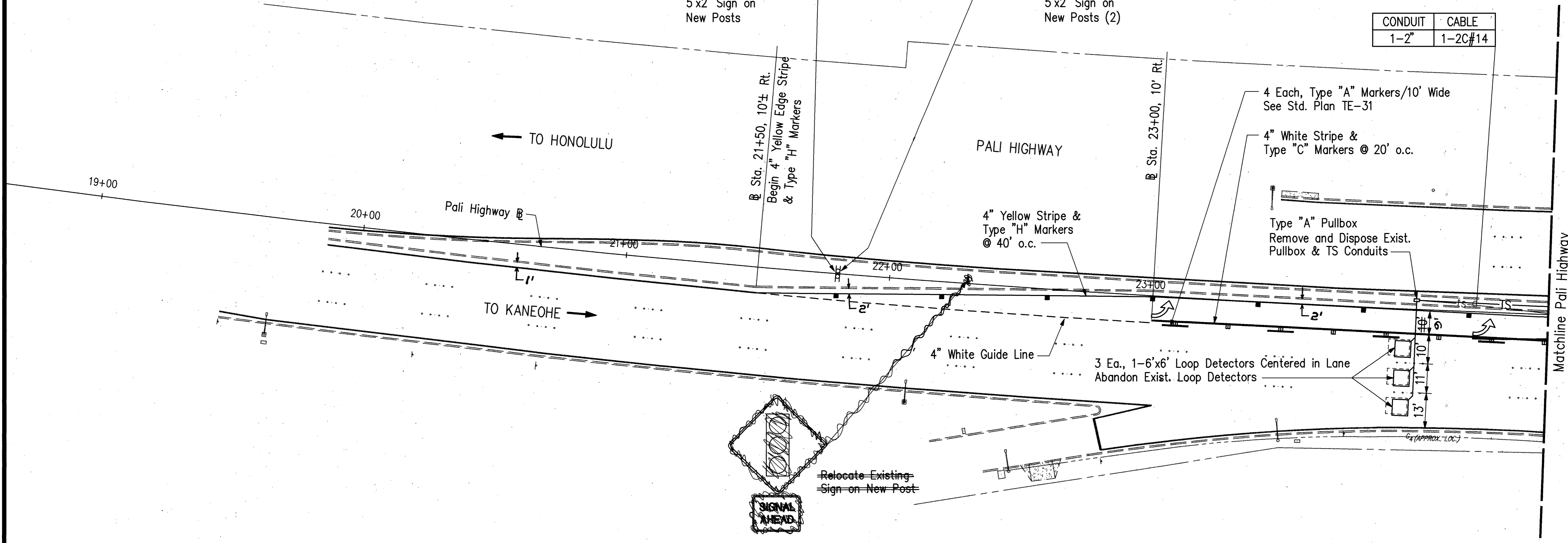

Relocate Existing Sign on New Post

Matchline Pali Highway Sta. 24+50 See Sheet No. SS3

SURVEY PLOTTED BY	DATE
DRAWN BY	
DESIGNED BY	
QUANTITIES BY	
CHECKED BY	
No.	

CAD by J. Minura, 95-52

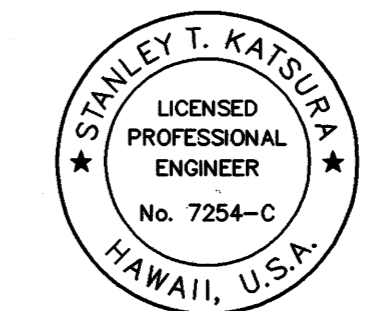

THIS WORK WAS PREPARED BY ME OR UNDER MY SUPERVISION.

Stanley Katsura

STATE OF HAWAII
 DEPARTMENT OF TRANSPORTATION
 HIGHWAYS DIVISION

SIGNING & STRIPING

PALI HIGHWAY
 EXTEND LEFT-TURN STORAGE LANE
 AT WAOKANAKA STREET
 PROJECT NO. 61B-01-98

SCALE: 1" = 20' DATE: JANUARY 1999

SHEET NO. SS2 OF 3 SHEETS

FED. ROAD DIST. NO.	STATE	PROJ. NO.	FISCAL YEAR	SHEET NO.	TOTAL SHEETS
HAWAII	HAW.	61B-01-98	1999	11	18

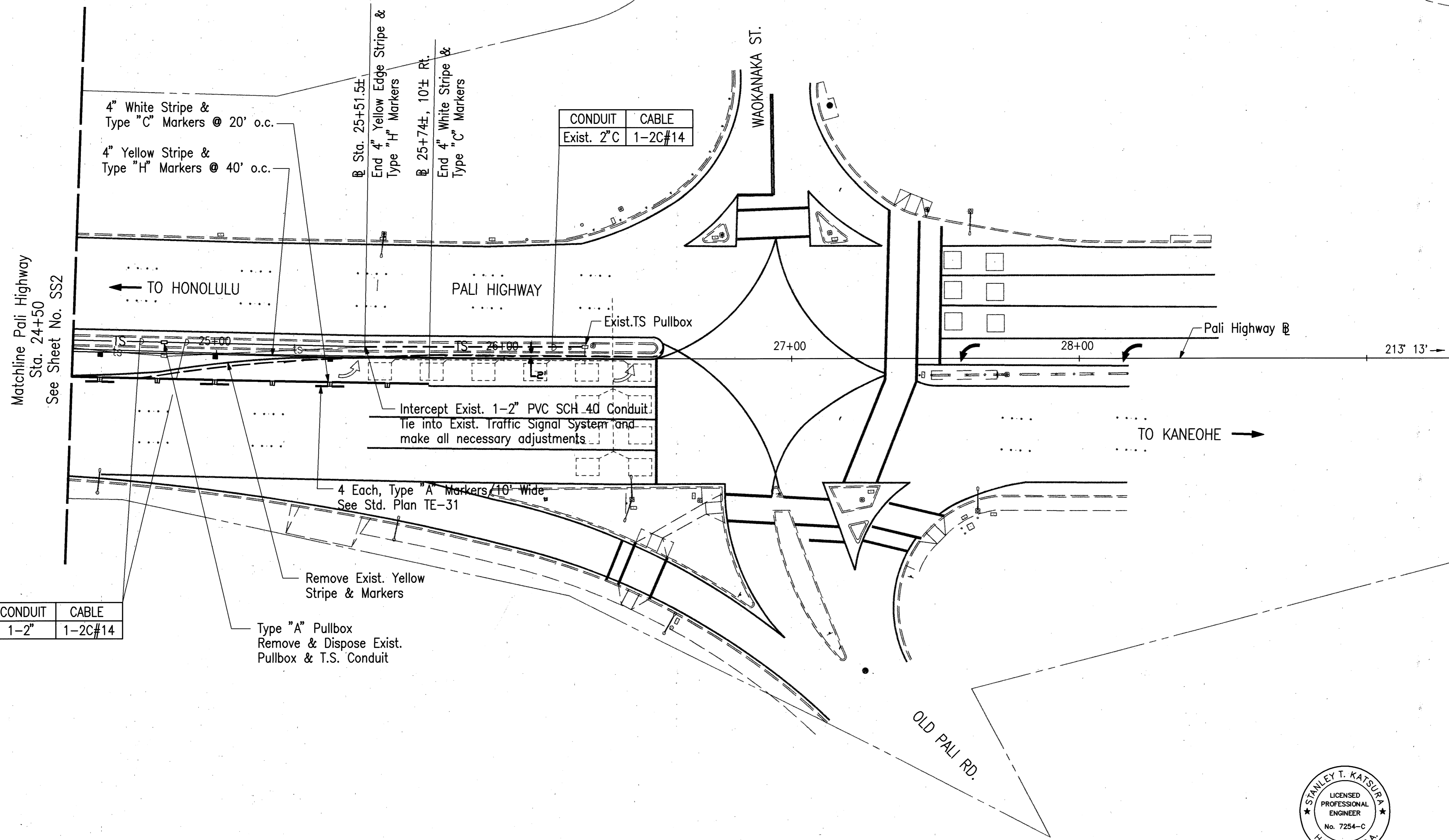
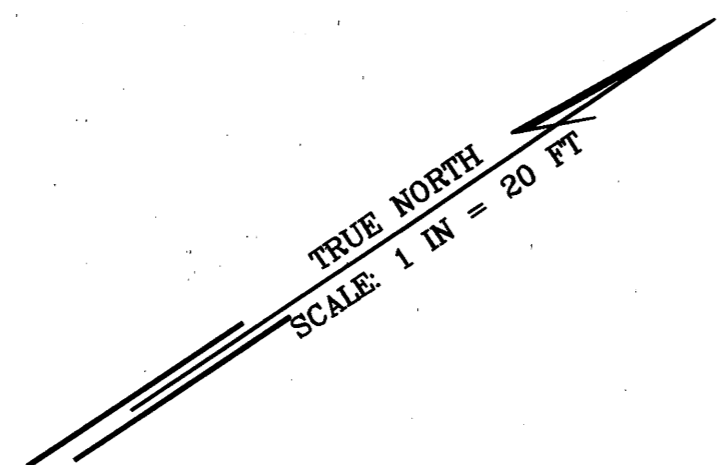

ORIGINAL PLAN	DATE
DRAWN BY	
TRACED BY	
QUANTITIES BY	
CHECKED BY	
No.	

CAD by J. Mimura, 55-52

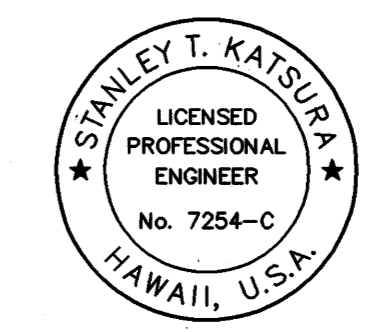

THIS WORK WAS PREPARED BY ME OR UNDER MY SUPERVISION.

Stanley T. Katsura

STATE OF HAWAII
DEPARTMENT OF TRANSPORTATION
HIGHWAYS DIVISION

SIGNING & STRIPING

PALI HIGHWAY
EXTEND LEFT-TURN STORAGE LANE
AT WAOKANAKA STREET
PROJECT NO. 61B-01-98

SCALE: 1" = 20' DATE: JANUARY 1999

SHEET NO. SS3 OF 3 SHEETS