

FED. ROAD DIST. NO.	STATE	FED. AID PROJ. NO.	FISCAL YEAR	SHEET NO.	TOTAL SHEETS
HAWAII	HAW.	STP-061-1 (34)	2000	22	38

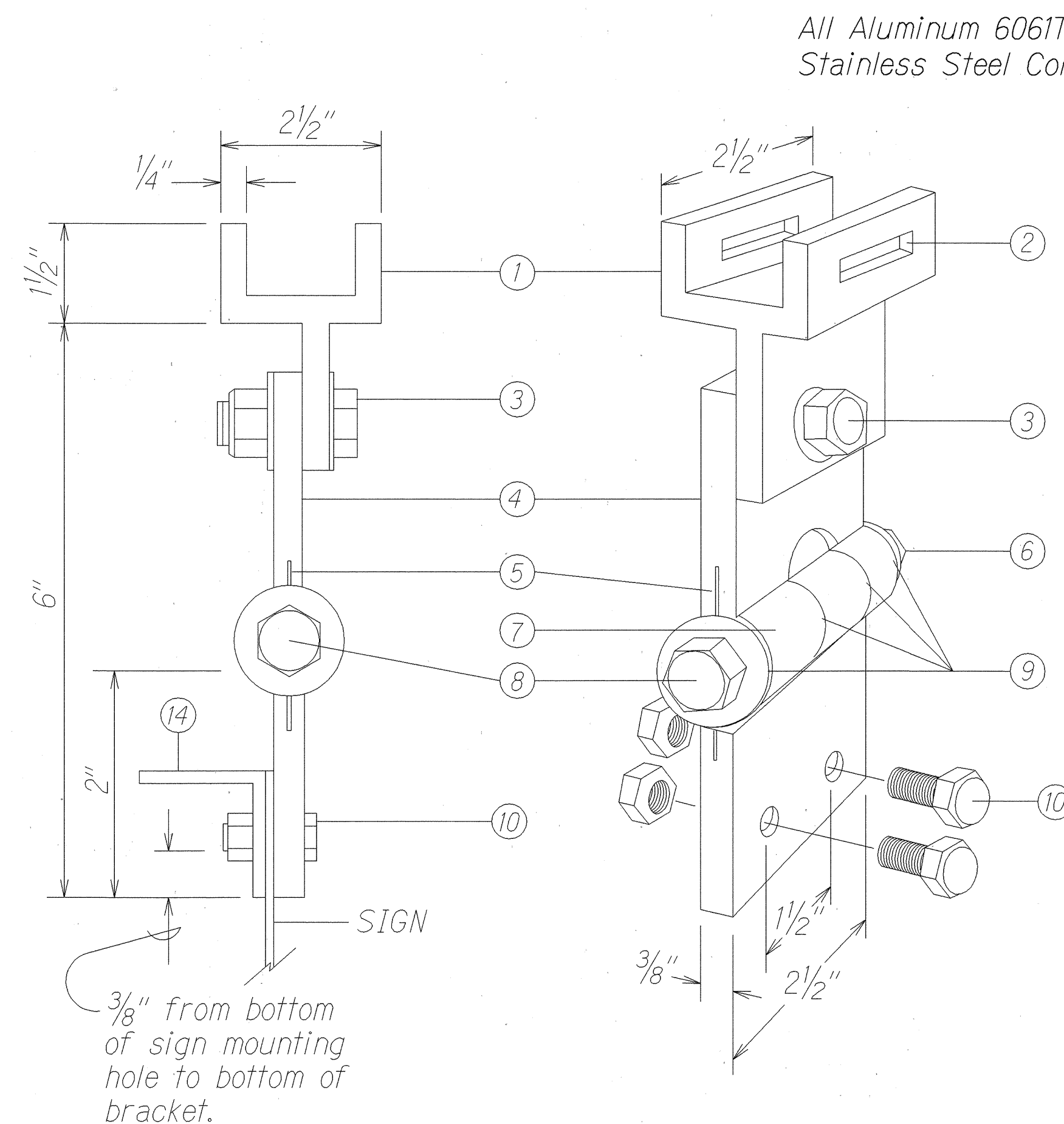

**FIXED LENGTH NON-ADJUSTABLE  
SWING SIGN BRACKET**

- ① Pivotal Upper Bracket
- ② 1 5/8" x 1/4" Slot for double strapping to electrolier mast arm. (M2G-34S(HD) .030" x 3/4" Heavy Duty Stainless Steel Strap with M2G-34B(HD) Buckle recommended.)
- ③ 1/2" - 13 x 1 1/2" Stainless Steel Hex Head Bolt with Stainless Steel Hex Lock Nut and 1/16" Stainless Steel Washer (both sides). Allows upper bracket to pivot and align with electrolier mast arm.
- ④ 6" Overall drop with Fixed Length Sign Bracket
- ⑤ Stainless Steel Dampener Spring (Removable)
- ⑥ Stainless Steel Hex Lock Nut with 1/16" Stainless Steel Washer
- ⑦ 1" O.D. Axle Housing
- ⑧ 1/2" - 13 x 4" Stainless Steel Hex Head Bolt with 1/16" Stainless Steel Washer
- ⑨ Oillite Bushing
- ⑩ Sign Mounting Sets, consisting of two each 5/16" - 18 x 1" Stainless Steel Hex Head Bolt with Stainless Steel Hex Lock Nut. Two holes on 1 1/2" centers provide positive lock sign mounting to bracket.

All Aluminum 6061T6 Alloy and  
Stainless Steel Components.

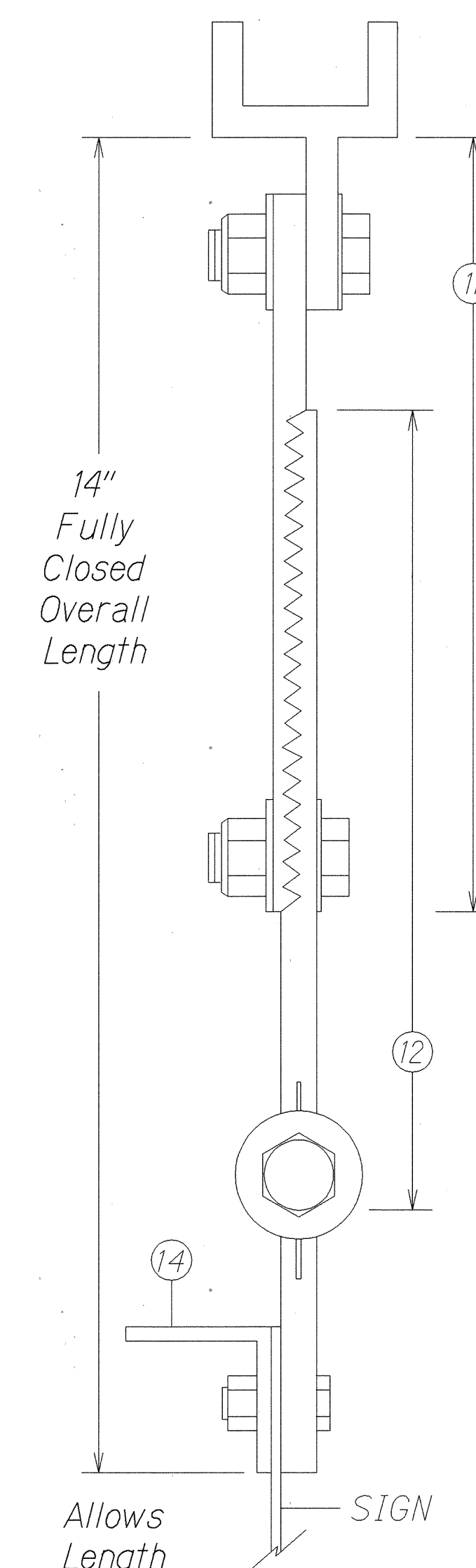
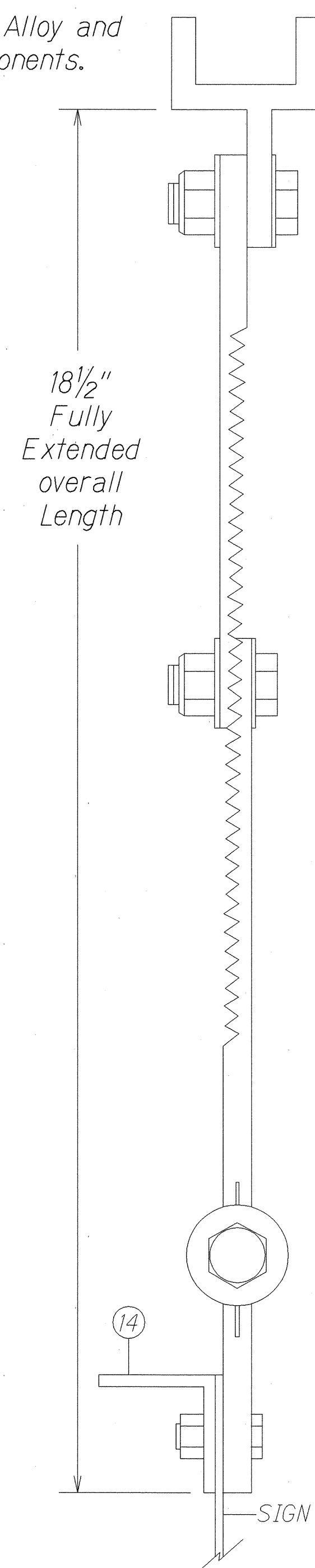

**ADJUSTABLE LENGTH  
SWING SIGN BRACKET**

- ⑪ 8 1/4" overall length Upper Adjustable Sign Bracket section
- ⑫ 9" overall length Lower Adjustable Sign Bracket section, including Axle Housing (8" overall length to top of Axle Housing)
- ⑬ 1/2" - 13 x 1 1/2" Stainless Steel Hex Bolt with Stainless Steel Hex Lock Nut and 1/16" Stainless Steel Washers (both sides). Loosen lock nut, adjust bracket teeth to level sign.
- ⑭ 1 1/4" x 1 1/4" x 1/8" Aluminum Angle

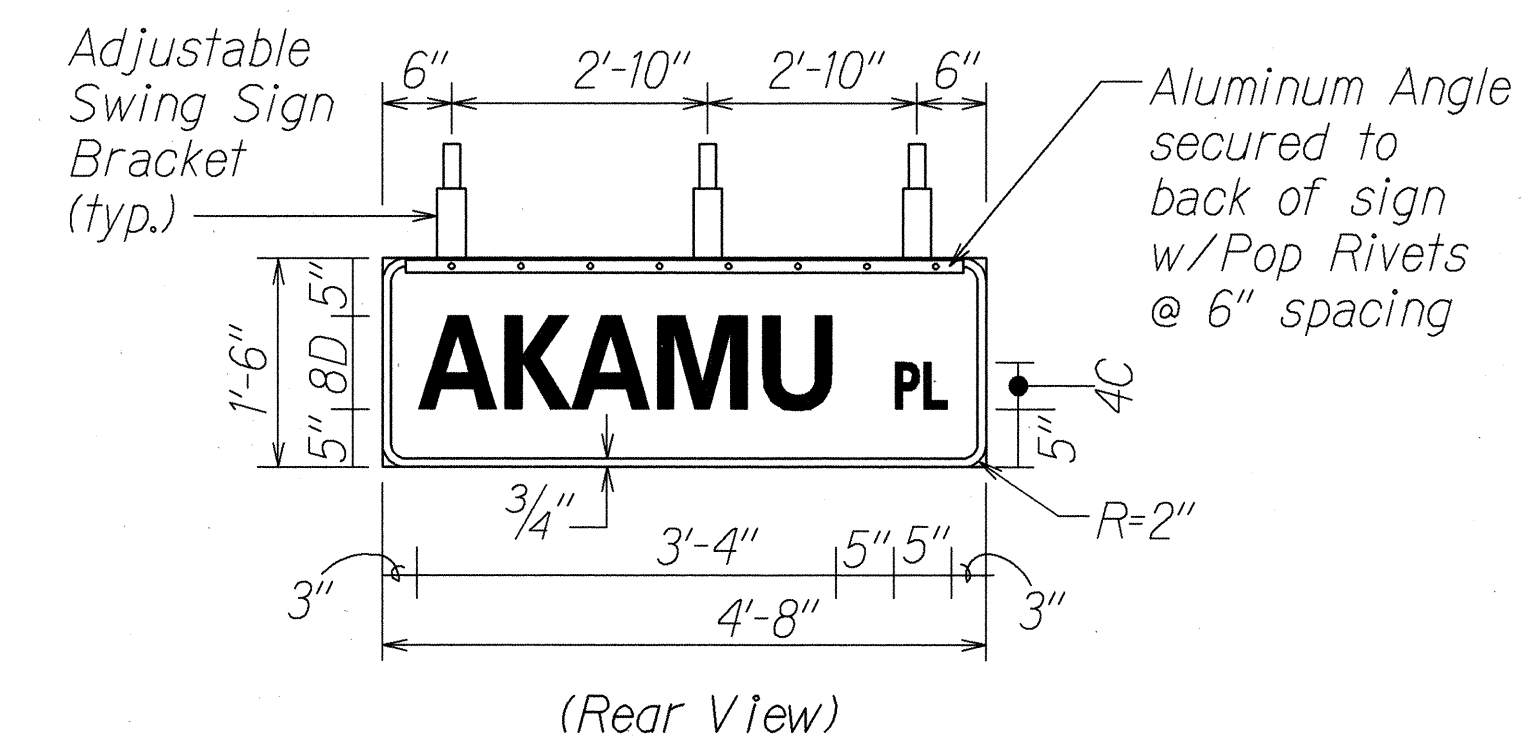

**(Rear View)**

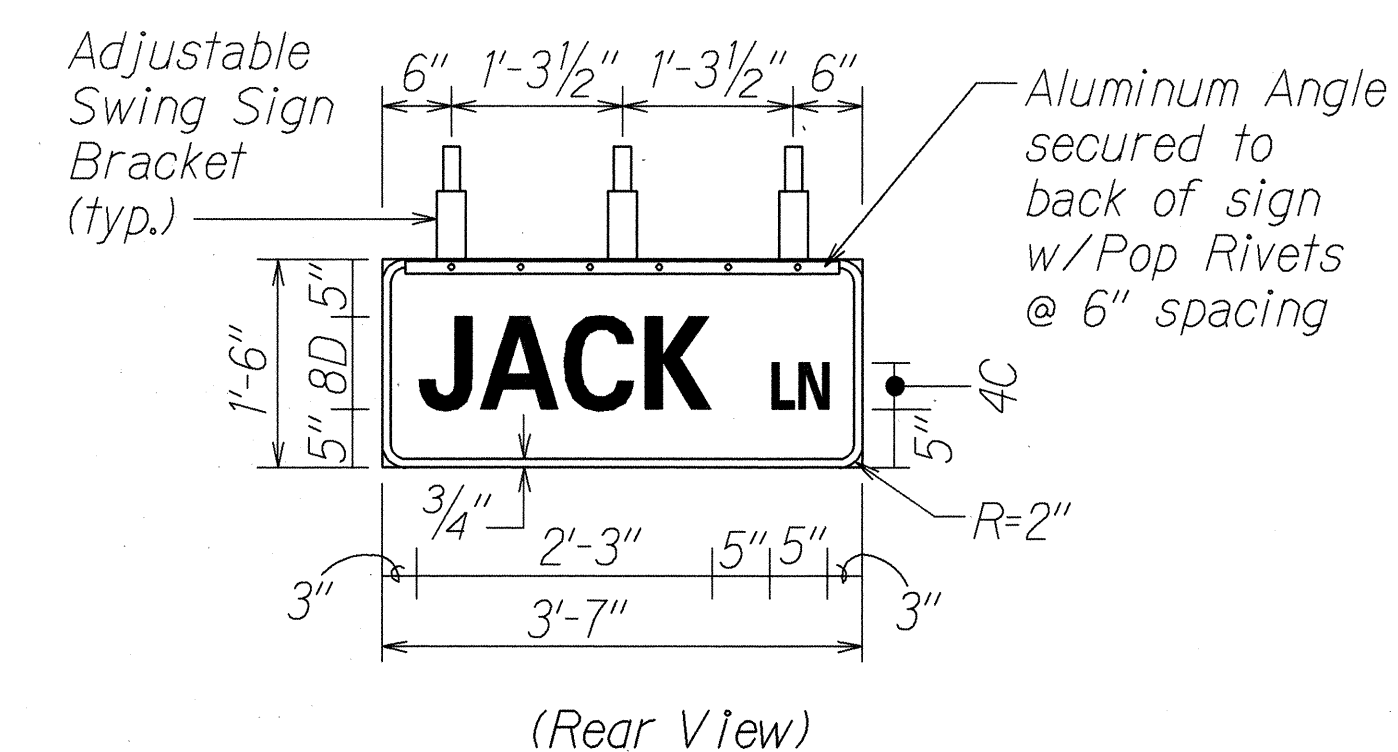

**(Rear View)**

NOTE:  
TEXT SHALL BE APPLIED TO BOTH SIDES OF PANEL.

**PANEL & SWING BRACKET LAYOUT  
FOR STREET NAME SIGN**

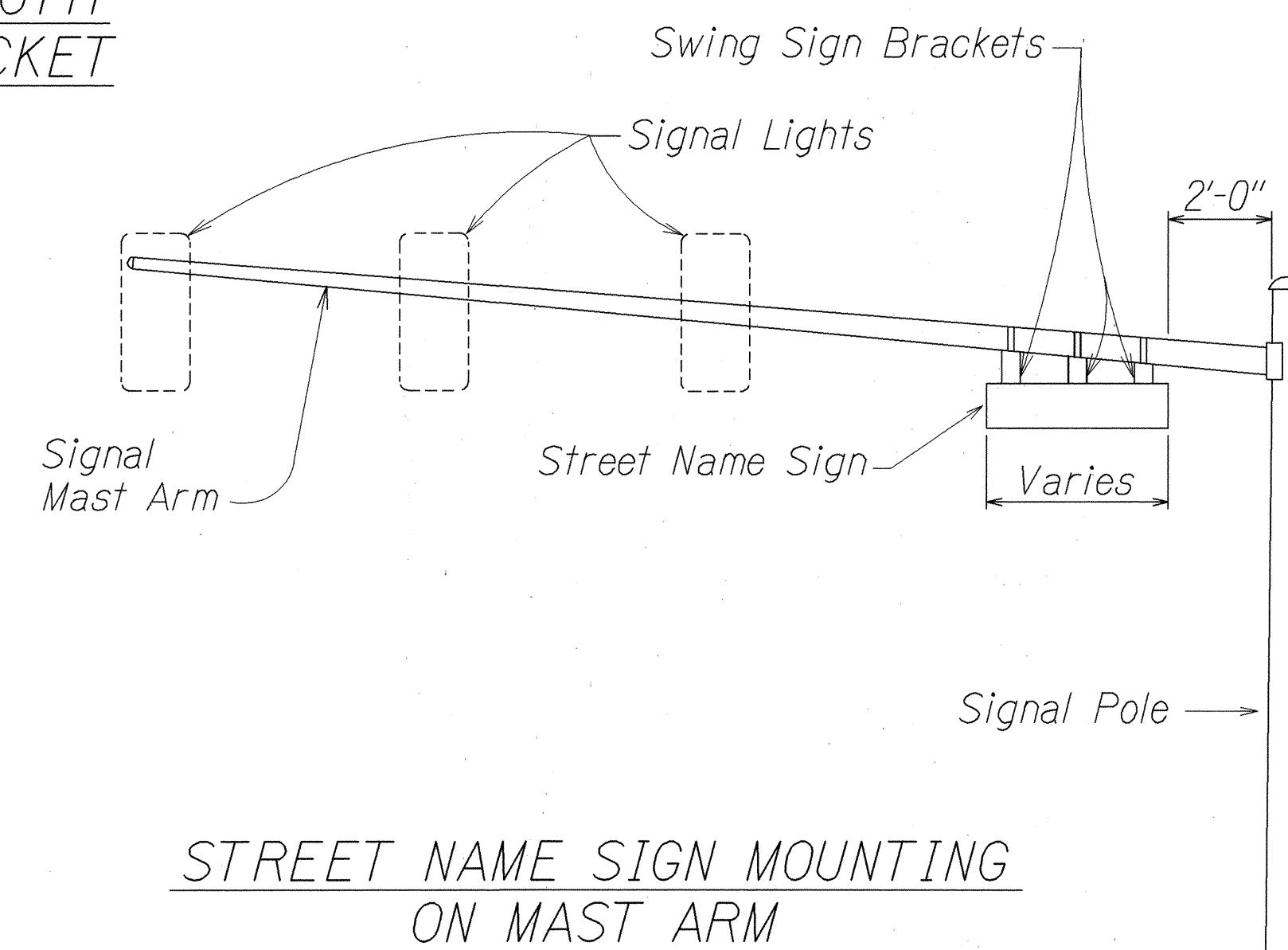

**STREET NAME SIGN MOUNTING  
ON MAST ARM**



THIS WORK WAS PREPARED BY  
ME OR UNDER MY SUPERVISION

STATE OF HAWAII DEPARTMENT OF TRANSPORTATION HIGHWAYS DIVISION	
<b>SIGN MOUNTING DETAIL</b>	
PALI HIGHWAY	
INTERSECTION IMPROVEMENTS AT JACK LANE	
F.A. PROJECT NO. STP-061-1 (34)	
Not to Scale	Date: Feb 29, 2000
SHEET No. 1 OF 1 SHEETS	

Note: Dimensions may vary slightly.