

--	--

$$\text{P.T. STA. } 86+35.50 \\ \text{Baseline R} = 1000.00$$

Legend

- | | | | | | |
|-------|-----------------------|-----------|-------------------------------|-----------|-----------------------------|
| A/C | Asphalt Concrete | H= | Approximate Height | -D 30" | 30 inch Drain Line |
| BC | Bottom Curb | HECO | Hawaiian Electric Company Box | -S 3" | 8 inch Sewer Line |
| TW | Top Curb | HTB | Hawaiian Telephone Box | -W 2 1/2" | 2 1/2 inch Water Line |
| BW | Bottom Wall | HTPB | Hawaiian Telephone Pullbox | | |
| TW | Top Wall | HTMH | Hawaiian Telephone Manhole | -EDH | Overhead Electrical Line |
| CBX | Concrete Box | INV | Invert= | -EU | Underground Electrical Line |
| CBMH | Catch Basin Manhole | INV=(FWR) | Filled with Rubbish | • • • • | Buttons |
| CONC. | Concrete | INV=(FWD) | Filled with Dirt | -C 4" | 4 inch Gas Line |
| CRM | Concrete Rock Masonry | LP | Light Post | | |
| D= | Approximate Diameter | MB | Metal Box | | |
| DI | Drain Inlet | MHI | Manhole Impression | | |
| DMH | Drain Manhole | S= | Approximate Size | | |
| EB | Electric Box | SDMH | Storm Drain Manhole | | |
| ELEC. | Electric | SCO | Sewer Cleanout | | |
| EMH | Electric Manhole | SMH | Sewer Manhole | | |
| EP | Electric Pole | SPK | Sprinkler | | |
| EXP | Exposed Pipe | SLB | Street Light Box | | |
| GV | Gas Valve | SLP | Slampipe | | |
| PH | Fire Hydrant | STKR | Slower Traffic Keep Right | | |
| GW | Guy Wire | SP | Summer Palace | | |
| | | TMH | Telephone Manhole | | |
| | | TS= | Top Stem= | | |
| | | TP | Top Pipe= | | |
| | | WB | Water Bib | | |
| | | WP | Wood Post for Walkway Roof | | |
| | | WMH | Water Manhole | | |
| | | WV | Water Valve | | |
| | | W/GA | With Guy Anchor | | |
| | | WS | White Stripe | | |
| | | YS | Yellow Stripe | | |

TOPOGRAPHIC SURVEY
PORTION OF PALI HIGHWAY
FOR PROPOSED TRAFFIC SIGNAL SYSTEMS "JACK LANE"
at Honolulu, Oahu, Hawaii
Tax Map Key: 2-2-31 & 32, 2-2-22, 1-8-07 & 08

Note:

Utility Lines plotted based on located manholes and "As Built" drawings. "Not Guaranteed". Need to be reviewed by each discipline for proper connections.

Based on "As-Built" Drawing Titled Pali Highway Resurfacing Vineyard Boulevard to Country Club Road
F.A. Project No. STP-061-1(30)

Note:

- *Origin of Azimuths and Coordinates: "WYLLIE"*
- *Origin of Bench Mark - Street Monument at the intersection of Pali Highway and Wyllie Street. (Elev = 230.53 ft.)*
- *Elevations and distances are based on English units (Feet)*



THIS WORK WAS PREPARED BY ME
OR UNDER MY SUPERVISION

STATE OF HAWAII
DEPARTMENT OF TRANSPORTATION
HIGHWAYS DIVISION

EXISTING CONDITIONS PLAN

PALI HIGHWAY
INTERSECTION IMPROVEMENTS AT JACK LANE
F.A. PROJECT NO. STP-061-1 (34)

Scale: As Noted ***Date: Feb 29, 2000***

SHEET No. 1 OF 2 SHEETS

FED. ROAD DIST. NO.	STATE	FED. AID PROJ. NO.	FISCAL YEAR	SHEET NO.	TOTAL SHEETS
HAWAII	HAW.	STP-061-1 (34)	2000	38	38

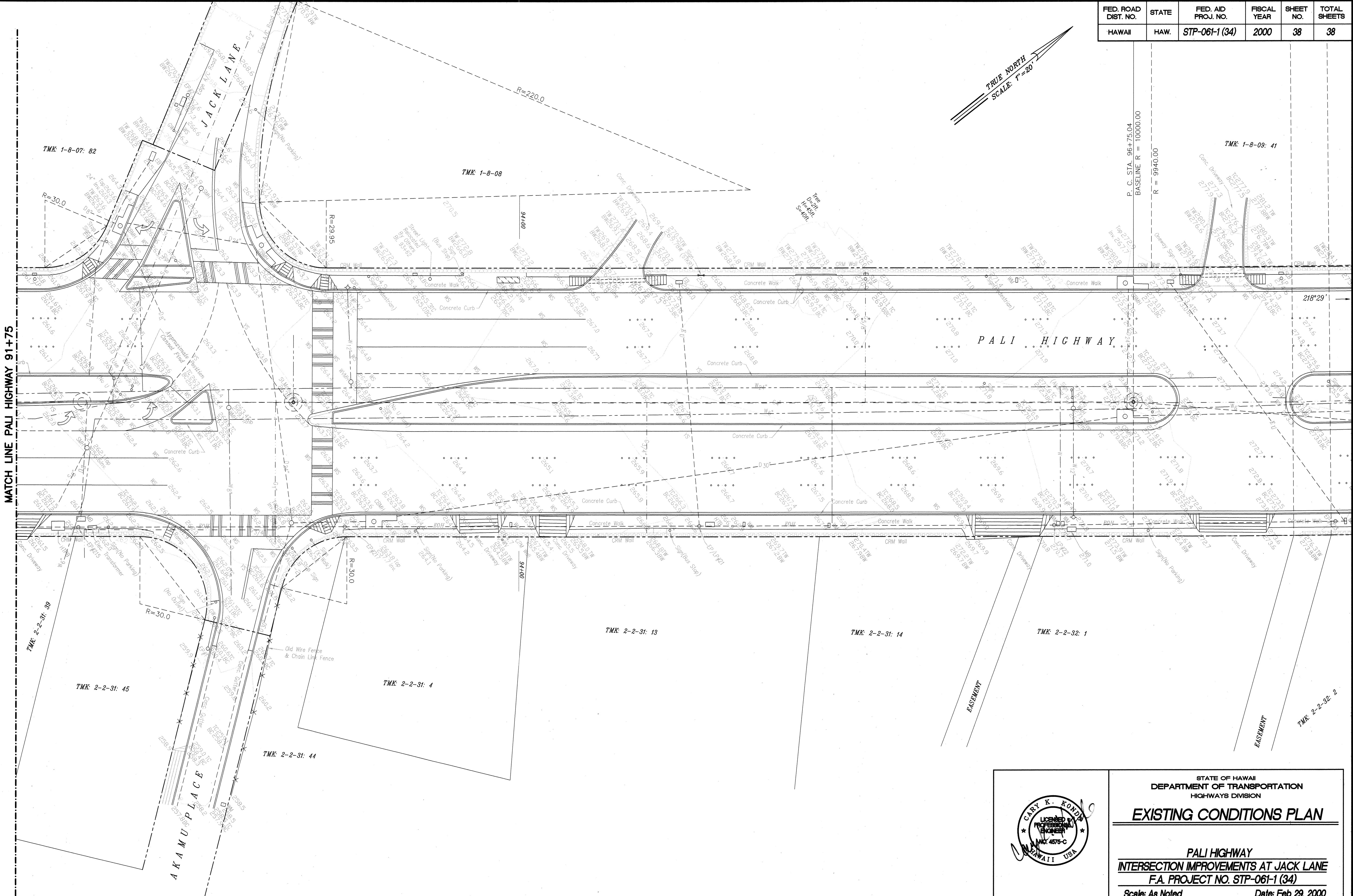
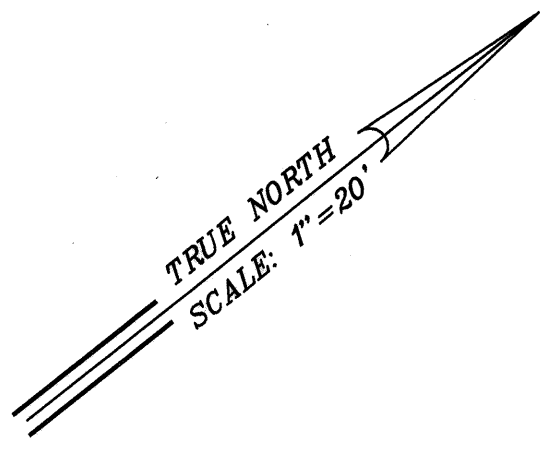

SURVEY PLOTTED BY	DATE
DRAWN BY	
DESIGNED BY	
QUANTITIES BY	
CHECKED BY	

THIS WORK WAS PREPARED BY ME OR UNDER MY SUPERVISION

STATE OF HAWAII
DEPARTMENT OF TRANSPORTATION
HIGHWAYS DIVISION

EXISTING CONDITIONS PLAN

PALI HIGHWAY
INTERSECTION IMPROVEMENTS AT JACK LANE
F.A. PROJECT NO. STP-061-1 (34)

Scale: As Noted Date: Feb 29, 2000

SHEET No. 2 OF 2 SHEETS