

INDEX TO DRAWINGS	
SHEET NO.	DESCRIPTION
1	TITLE SHEET
2	TYPICAL SECTIONS
3-6	PLAN & PROFILE
7-8	DRAINAGE DETAILS

STATE OF HAWAII

DEPARTMENT OF TRANSPORTATION

DIVISION OF HIGHWAYS

HONOLULU, HAWAII

"AS BUILT"

PLANS FOR

INSTALLATION OF PERFORATED UNDERDRAINS

AND

RECONSTRUCTION AND RESURFACING

OF A PORTION OF

PALI HIGHWAY

(NEAR CARTER'S CORNER)

PROJECT NO. B-61-01-61

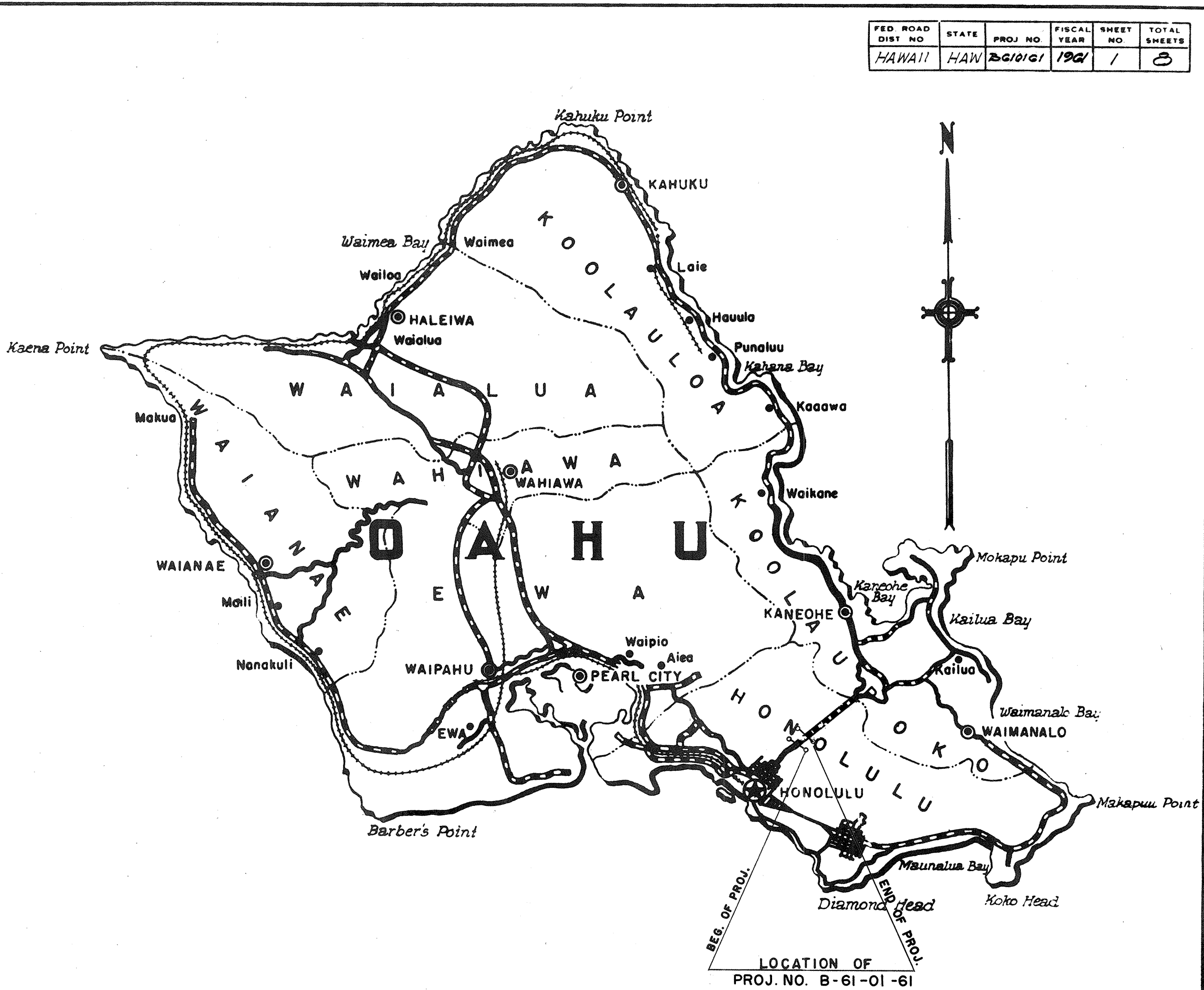

NOTE:

ALL CHANGES MADE DURING CONSTRUCTION

HAVE BEEN NOTED IN RED ON THESE TRACINGS

AND CHECKED BY:

T. Harano

CONSTRUCTION ENGINEER, OAHU

1/11/62

DATE

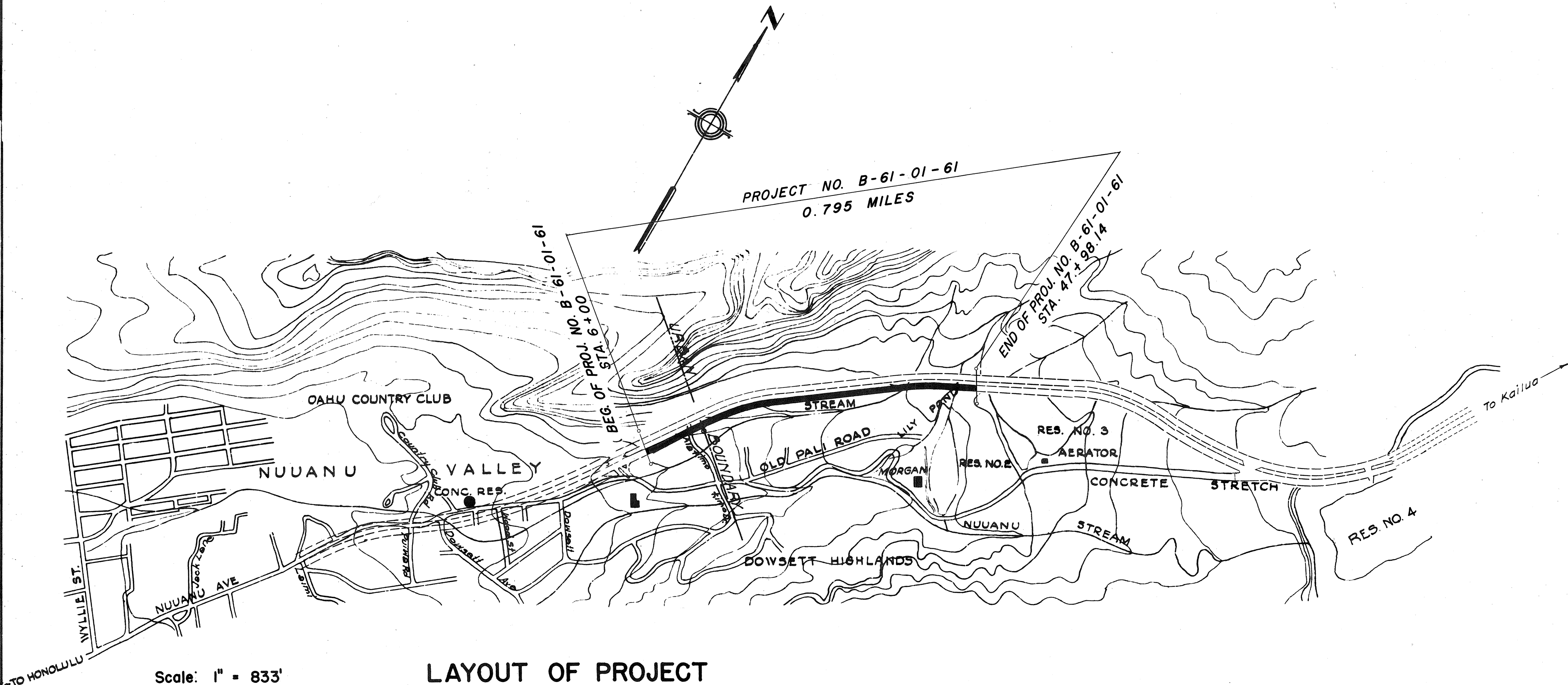

LAYOUT OF PROJECT

APPROVED :

DATE : 5/31/61

Sam O. Hirota

for DIRECTOR OF TRANSPORTATION