

REVISED SEPT. 1959

GENERAL NOTES

1. EXACT LOCATION OF TRAFFIC SIGNAL STANDARDS ARE TO BE DETERMINED IN THE FIELD BY THE ENGINEER.
2. PAVEMENT MARKING BY OTHERS.
3. METER LOOP TO BE INSTALLED BY H.E.CO.
4. FOR DETAIL OF CONDUIT ENCASED IN CONCRETE JACKET, SEE SHEET NO. 131

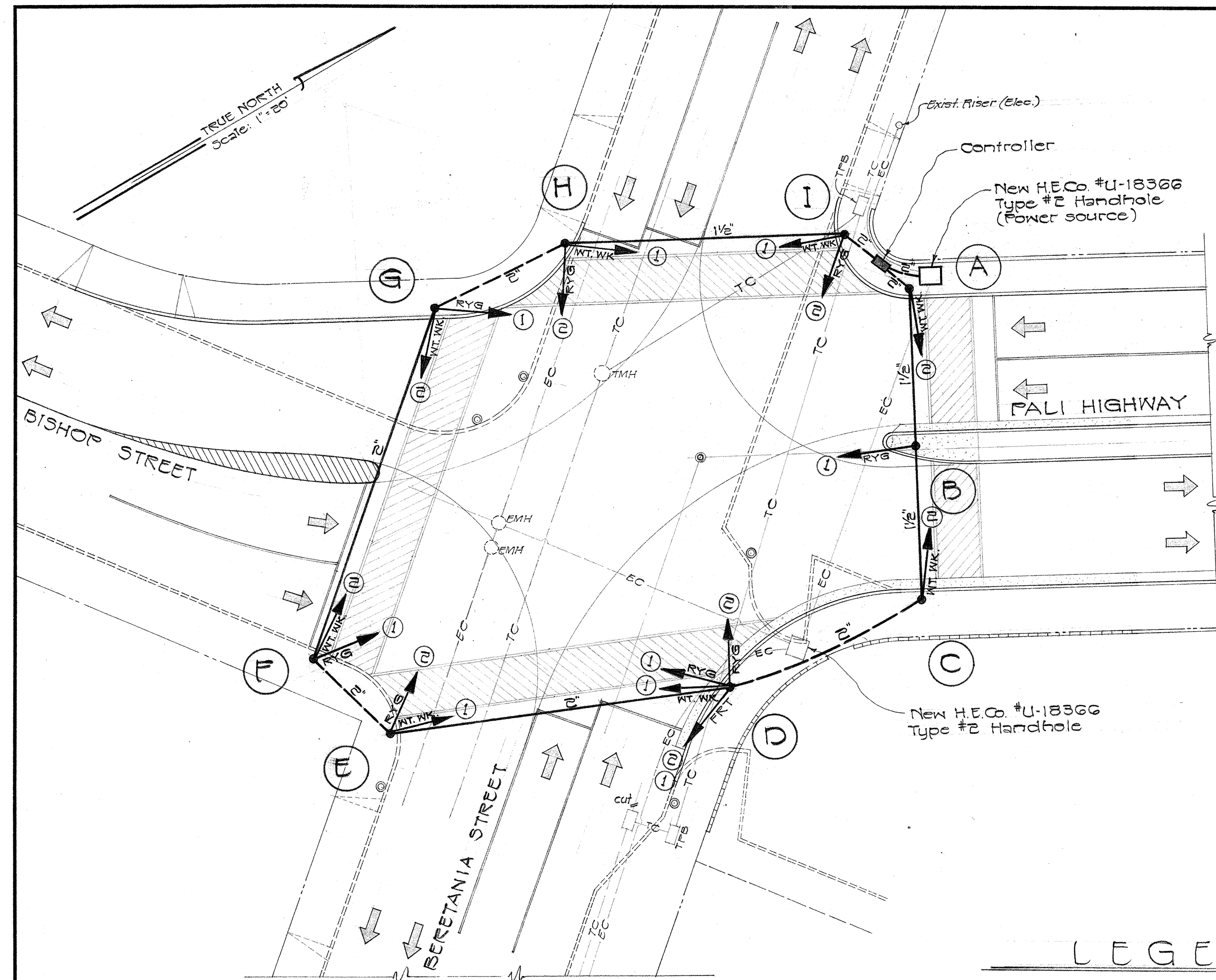

PLAN LAYOUT
Scale: 1" = 20'

LEGEND

- EXIST. C & C TRAFFIC SIGNAL STANDARD
- TRAFFIC SIGNAL STANDARD
- CONTROLLER BOX
- 1/2" STEEL CONDUIT (SIZE INDICATED)
- 2" TRANSITE CONDUIT (SIZE INDICATED)
- PEDESTRIANS CROSSING
- R/Y/G— TRAFFIC SIGNAL HEAD
- FRT— FREE RIGHT TURN
- TBS— NEW H.T.CO. PULL BOX
- TC— NEW H.T.CO. DUCT LINE
- TC--- EXISTING H.T.CO. DUCT LINE
- EC--- NEW H.E.CO. DUCT LINE
- EC--- EXISTING H.E.CO. DUCT LINE

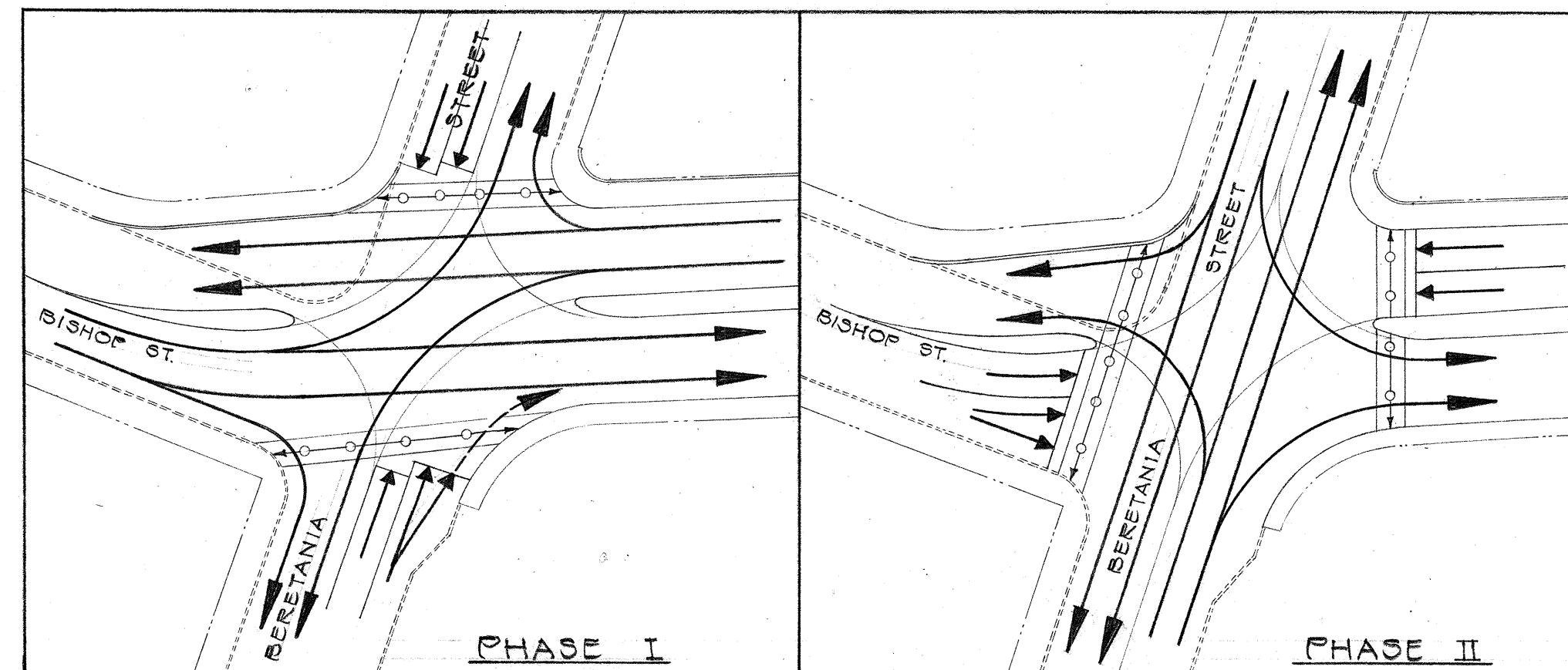

PHASE DIAGRAMS
Scale: 1" = 30'

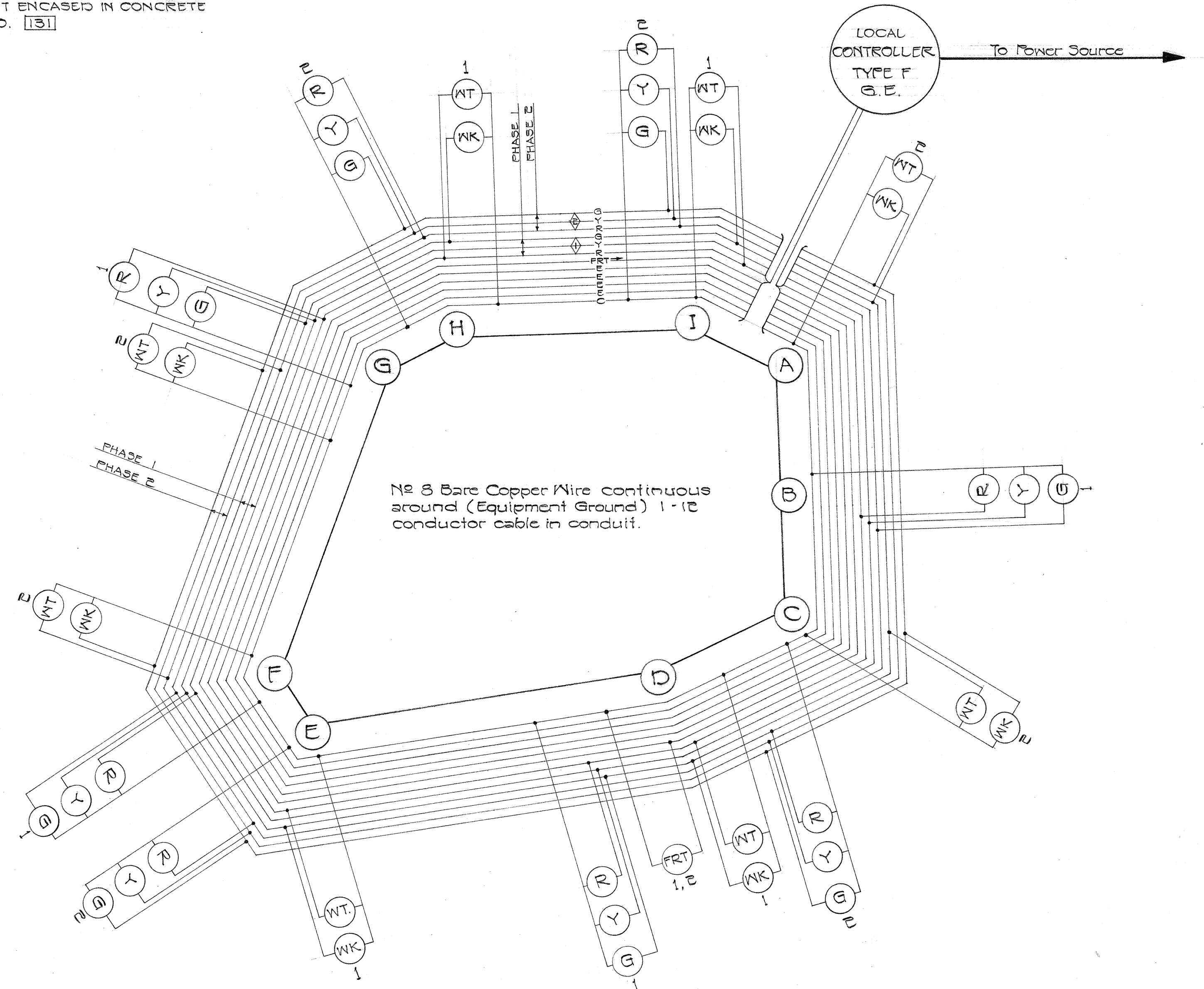

GEOGRAPHICAL CIRCUIT WIRING
DIAGRAM FOR SIGNAL CABLE CIRCUIT
Not to Scale

NOTE

1. EXISTING CITY AND COUNTY TRAFFIC SIGNAL SYSTEM AT THIS INTERSECTION SHALL BE ABANDONED.
2. EXISTING TRAFFIC SIGNAL STANDARDS WITH SIGNAL HEADS AND CONTROLLER WILL BE DISMANTLED AND HAULED TO C & C TRAFFIC SAFETY DIVISION YARD BY THE DIVISION CREW.
3. THE CONTRACTOR SHALL NOTIFY C & C DIVISION OF TRAFFIC SAFETY AS TO THE TIME OF REMOVAL OF THESE EXISTING TRAFFIC EQUIPMENT.
4. EXISTING UNDERGROUND CONDUITS AND CABLES SHALL BE ABANDONED OR REMOVED AS DIRECTED BY THE ENGINEER (INCIDENTAL TO ITEM OF 'ROADWAY EXCAVATION'.)

**NOTE: THIS SHEET SUPERSEDES
SHT. NO. .8146(2).71 138**

**TERRITORIAL HIGHWAY DEPARTMENT
TERRITORY OF HAWAII
NUUANU HIGHWAY
PROJECT NO. BU-061-1(6), UNIT 4
BERETANIA & BISHOP STREETS
INSTALLATION OF TRAFFIC SIGNAL EQUIPMENT
SCALE: AS NOTED SEPTEMBER, 1959**

SHEET NO. OF SHEETS

.8146 (2).71A 138-A

GENERAL NOTES

1. EXACT LOCATION OF TRAFFIC SIGNAL STANDARDS TO BE DETERMINED IN THE FIELD BY THE ENGINEER.
2. PAVEMENT MARKING BY OTHERS.
3. EXISTING TRAFFIC SIGNAL STANDARDS TO BE RELOCATED AND ADJUSTED TO NEW GRADE.

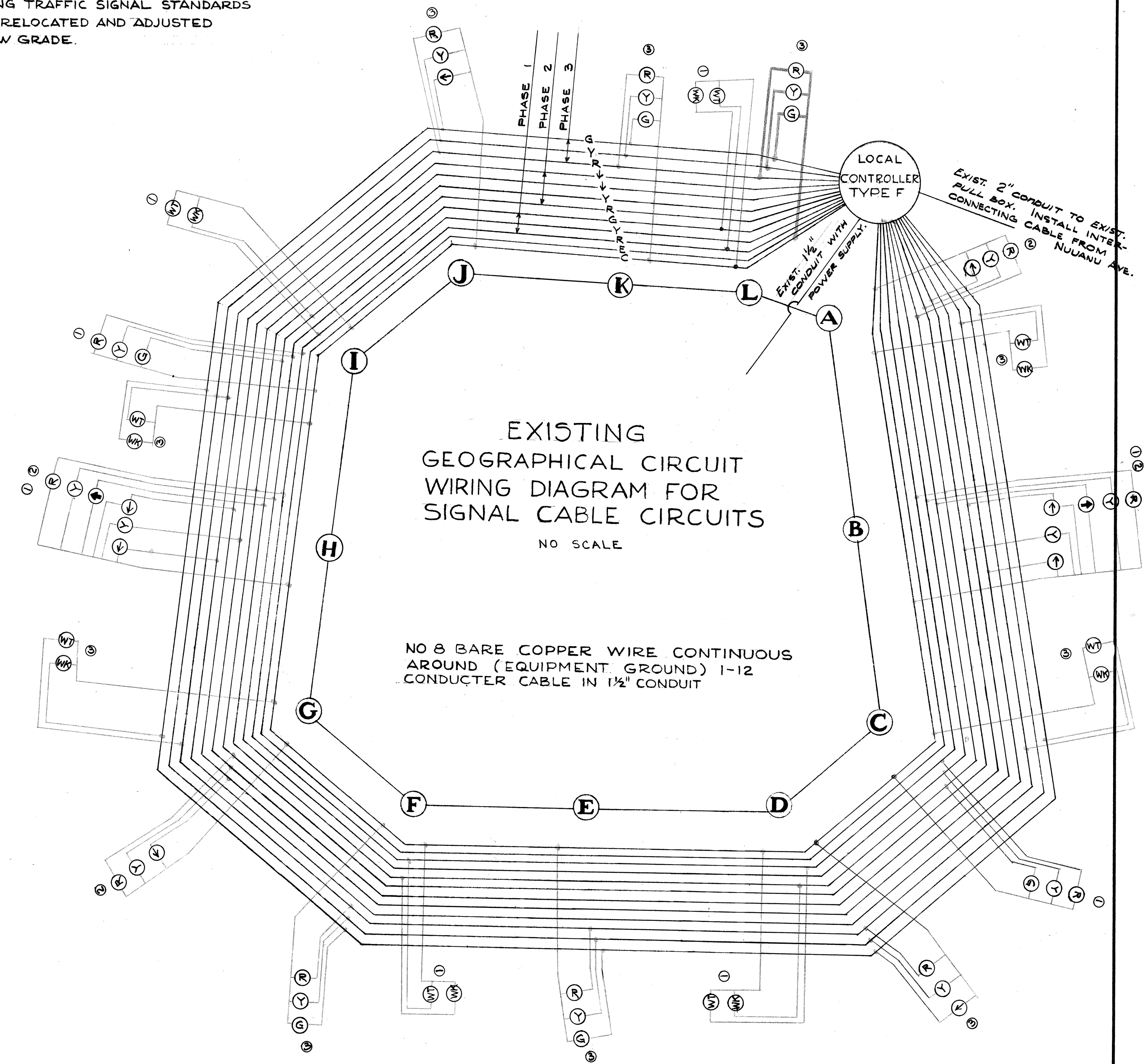
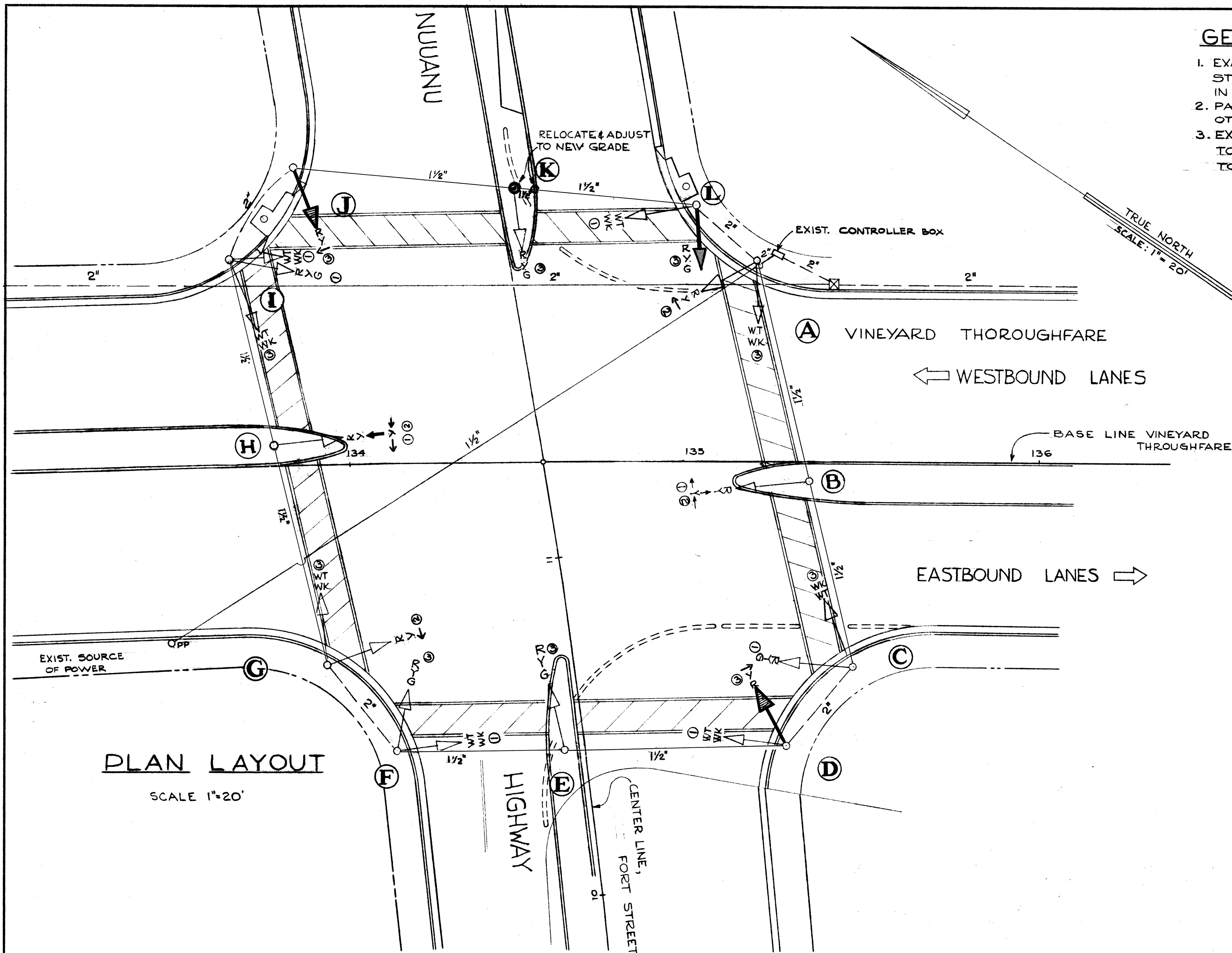

EXISTING
GEOGRAPHICAL CIRCUIT
WIRING DIAGRAM FOR
SIGNAL CABLE CIRCUITS
NO SCALE

NO 8 BARE COPPER WIRE CONTINUOUS
AROUND (EQUIPMENT GROUND) 1-12
CONDUCTOR CABLE IN 1 1/2" CONDUIT

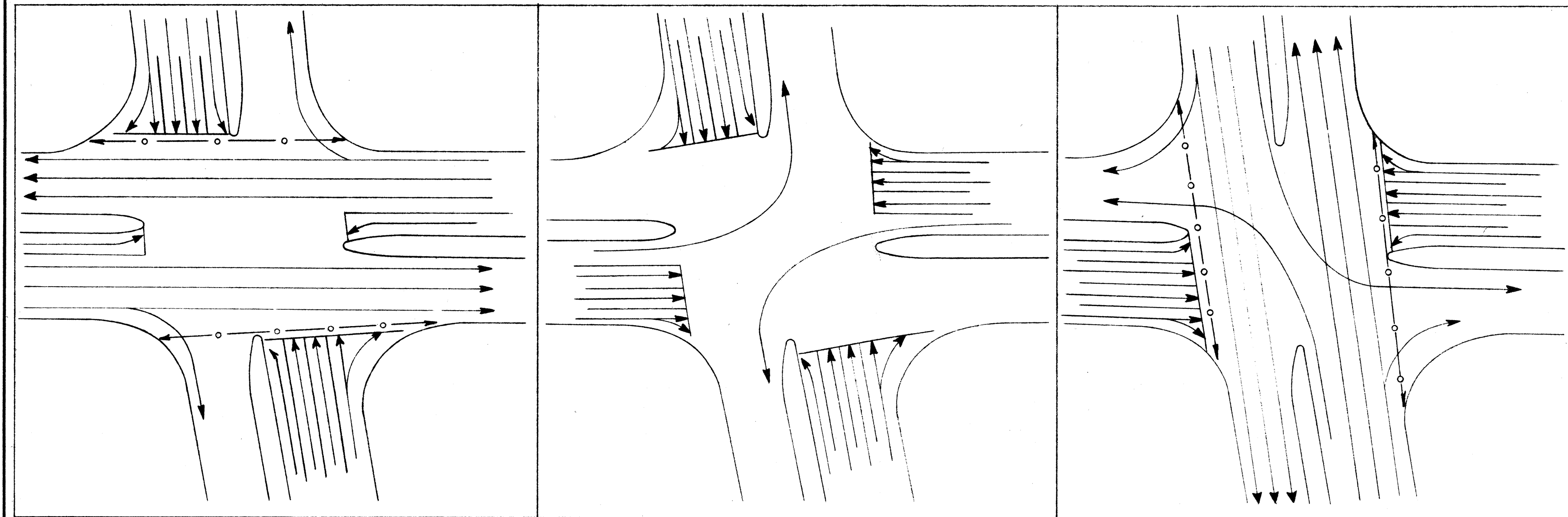

PHASE I

PHASE II

PHASE III
(SEE NOTE)

LEGEND

- RELOCATED TRAFFIC SIGNAL STANDARD
- EXISTING TRAFFIC SIGNAL STANDARD
- EXISTING CONTROLLER BOX
- EXISTING TYPE "A" PULL BOX
- 1 1/2" EXISTING STEEL CONDUIT (SIZE INDICATED)
- 2" EXISTING TRANSITE CONDUIT (SIZE INDICATED)
- 1 1/2" PEDESTRIANS CROSSING
- NEW STEEL CONDUIT (SIZE INDICATED)
- EXISTING TRAFFIC SIGNAL HEADS
- EXISTING TRAFFIC SIGNAL HEADS TO BE MODIFIED
- OPP POWER POLE (SOURCE OF POWER)
- NEW TRAFFIC SIGNAL HEAD

TERRITORIAL HIGHWAY DEPARTMENT
TERRITORY OF HAWAII
NUUANU HIGHWAY
PROJECT NO. BU-061-1(6), UNIT 4
VINEYARD THOROUGHFARE INTERSECTION
INSTALLATION OF TRAFFIC SIGNAL EQUIPMENT
SCALE: AS NOTED
SEPTEMBER 1957

SHEET NO. 2 OF 3 SHEETS

8146 (2) 72 139

DESIGNED BY	DATE
DRAWN BY	
CHECKED BY	
QUANTITIES CHECKED BY	
NOTE BOOK NO.	