

- ### GENERAL NOTES
- A. DESIGN DATA**
- LOADING: (AASHTO CODE 1957)  
UNIFORM SUPERIMPOSED LIVE LOAD = 25 PSF
  - ALLOWABLE STRESSES  
CONCRETE:  
PRESTRESSED MEMBERS  $f_c = 6000$  P.S.I.  
HARDROCK  $f_c = 6000$  P.S.I.  
LIGHTWEIGHT  $f_c = 4200$  P.S.I.  
@ TRANSFER  $f_c = 4200$  P.S.I.  
@ POST TENSIONING  $f_c = 5200$  P.S.I.  
TRANSFER  $f_c = 5200$  P.S.I.  
POST TENSIONING 3,045 P.S.I.  
DESIGN 2,400 P.S.I.
  - NON-PRESTRESS  
HARDROCK & LIGHTWEIGHT  $f_c = 3000$  P.S.I.  
 $f_c = 1,200$  P.S.I.
  - REINFORCING:  
PRESTRESSING STEEL  
1/2"  $\phi$  STRANDS  
INITIAL = 25.7 K/STRAND  
DESIGN = 20.7 K/STRAND  
POST TENSIONING STEEL  
7/16"  $\phi$  STRAND  
INITIAL = 18.9 K/STRAND  
DESIGN = 15.09 K/STRAND  
MILD STEEL  $f_y = 20.0$  K/STRAND
- B. CONSTRUCTION METHOD**
- ALL BACKFILL BEHIND ABUTMENTS SHALL BE COMPLETE IN PLACE BEFORE PLACING PRESTRESSED MEMBERS.
  - REINFORCING: SPLICES SHALL BE STAGGERED WHERE POSSIBLE UNLESS SHOWN OTHERWISE. MINIMUM LAP = 30 DIA.  
SLABS: TOP BARS @ MIDSPAN  
BOTT BARS @ SUPPORT  
FTG: TOP BARS @ MIDSPAN  
BOTT BARS @ PILES
  - CLEARANCES: ABUTMENT 3" CL  
DECK SLAB 3/4" CL  
ALL OTHERS 1 1/2" CL
  - PILES: LENGTHS SHALL BE THE CAST LENGTHS  
DESIGN LOAD = 32 TONS PER PILE.
- C. MATERIALS**
- CONCRETE
    - ABUTMENT & CAST IN PLACE SECTION OF PILE MEMBER CITY & COUNTY CLASS 'A' CONCRETE, TYPE I CEMENT
    - PRESTRESSED MEMBER  
HARDROCK  $f_c = 6000$  P.S.I. & 28 DAYS LIGHTWEIGHT  $f_c = 6000$  P.S.I. & 28 DAYS LIGHTWEIGHT AGGREGATE CONFORMING TO ASTM C230.
    - DECK TOPPING & CURB  
LIGHTWEIGHT  $f_c = 3000$  P.S.I. & 28 DAYS MAX WT. 120 P.C.F.
    - ALL OTHERS CITY & COUNTY CLASS 'A' CONCRETE TYPE I CEMENT
    - GROUT FOR POST TENSION SHEATHS (4" & 4.000 P.S.I.) SHALL BE CONT. NUCHEX THRU OUT SHEATHS. USE MINKAPLAST ADVANTURE IN ACCORDANCE TO MANUFACTURERS SPECIFICATION.
  - REINFORCING STEEL
    - MILD STEEL SHALL BE NEW BILLET STEEL CONFORMING TO ASTM A 15, A 205.
    - PRESTRESSING STRANDS SHALL CONFORM TO ASTM A 416.

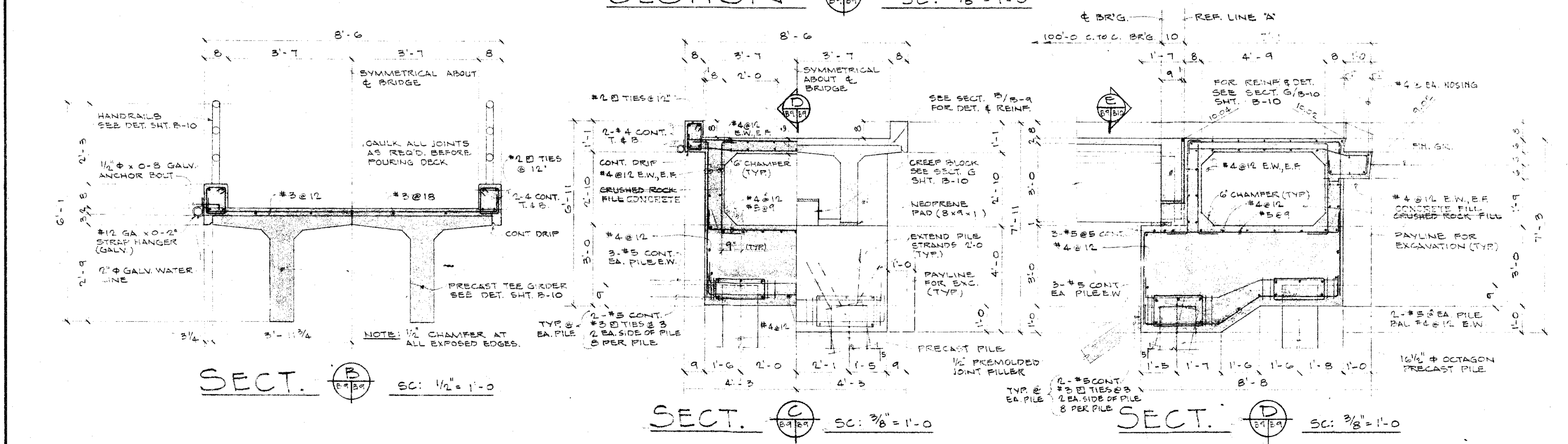
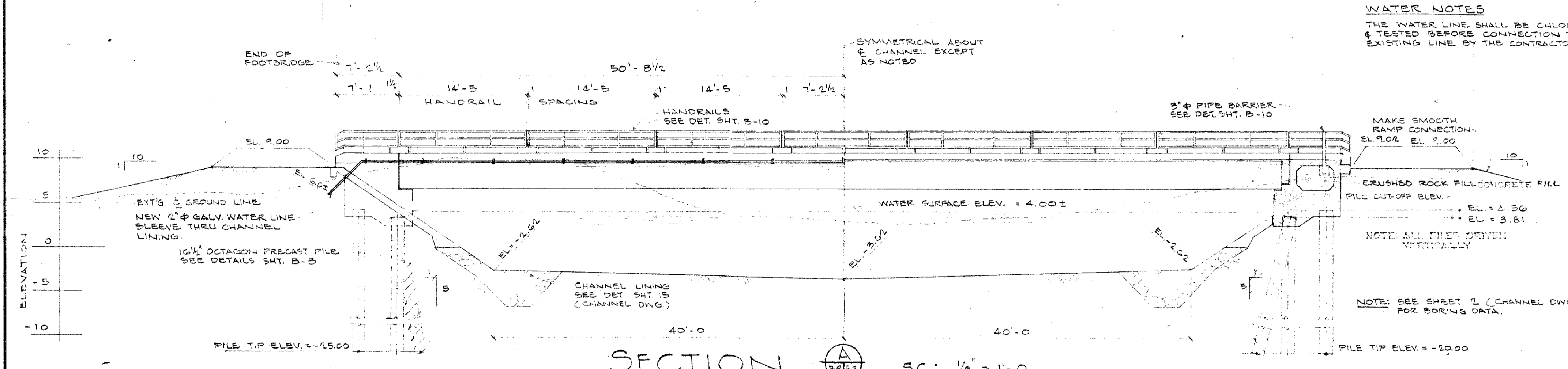

PLAN & SECTIONS	
FOOTBRIDGE DETAILS	
KAUPUNI CHANNEL K-1 WAIANAE KI WATERSHED WAIANAE, CAHU, HAWAII	
DEPARTMENT OF PUBLIC WORKS CITY AND COUNTY OF HONOLULU DIVISION OF ENGINEERING AND	
U. S. DEPARTMENT OF AGRICULTURE SOIL CONSERVATION SERVICE	
Designed W.T. A.M.	Date 11/21/58
Drawn A.M.	Approved [Signature] DIV. OF ENGR.
Traced A.M.	Title CHIEF ENGINEER, D.P.W.
Checked D.T.	Sheet 7-5-3046
FILE 9	POCKET 7
FOUNDER 1	NO. 22
Form SCS-313 (November 1955)	