

E1 Install grated drop inlet protection. For detail, see sheet 19.

E2 Install catch basin protection. For detail, see sheet 19.

E3 Install compost filter sock. For detail, see sheet 19.

driveway driveway

 Demolish and dispose of concrete ramp, sidewalk, curb, gutter, asphalt concrete curb, and asphalt concrete sidewalk.

---8--- Existing Contour Minor

FED ROAD DIST. NO.	STATE	FED AID PROJ. NO.	FISCAL YEAR	SHEET NO.	TOTAL SHEETS
HAWAII	HAW.	STP-0300(163)	2020	14	284

True North
Scale: 1"=20'
TMK: 8-7-044

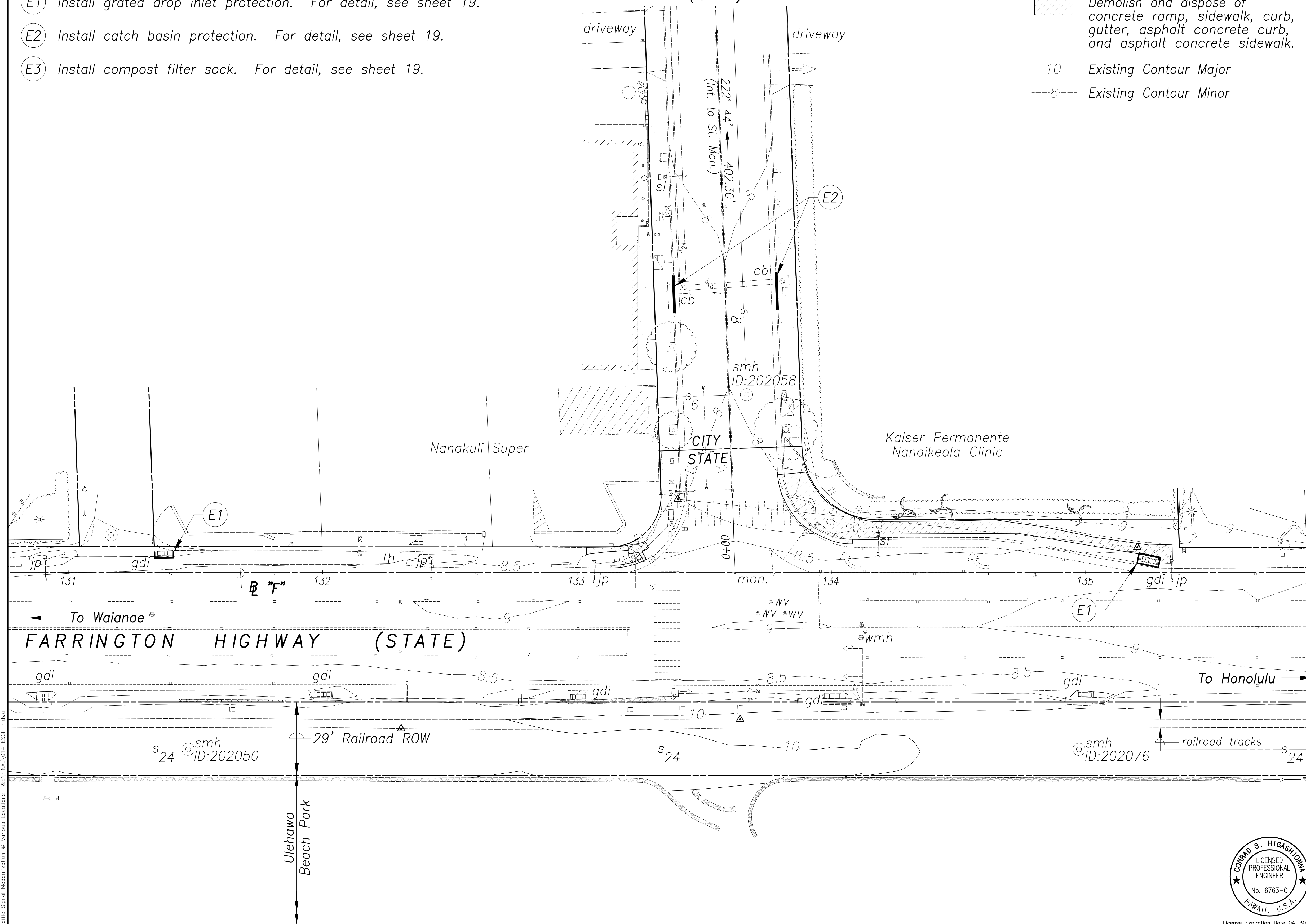

Chief, Civil Engineering Branch, DPP
(For construction in City ROW only)

Date _____

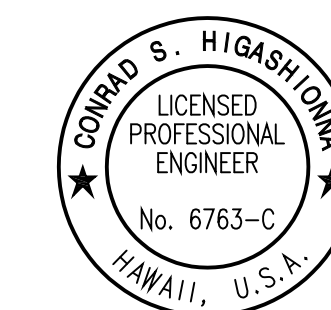

License Expiration Date 04-30-22

THIS WORK WAS PREPARED BY ME OR UNDER MY SUPERVISION AND CONSTRUCTION OF THIS PROJECT WILL BE UNDER MY OBSERVATION AS DEFINED IN HAR TITLE 16, CHAPTER 115, RULES OF THE BOARD OF PROFESSIONAL ENGINEERS, ARCHITECTS AND SURVEYORS, STATE OF HAWAII.

CONRAD HIGASHIYAMA

STATE OF HAWAII
DEPARTMENT OF TRANSPORTATION
HIGHWAYS DIVISION

EROSION & SEDIMENT CONTROL PLAN

Farrington Hwy & Nanaikeola St

Traffic Signal Modernization,
Oahu, Phase 1

Scale: As Shown Date: July 2020

SHEET No. *D-1* OF *17* SHEETS

FED. ROAD DIST. NO.	STATE	FED. AID PROJ. NO.	FISCAL YEAR	SHEET NO.	TOTAL SHEETS
HAWAII	HAW.	STP-0300(163)	2020	15	284

True North
Scale: 1"=40'
TMK: 9-9-055, 057, 072 & 074

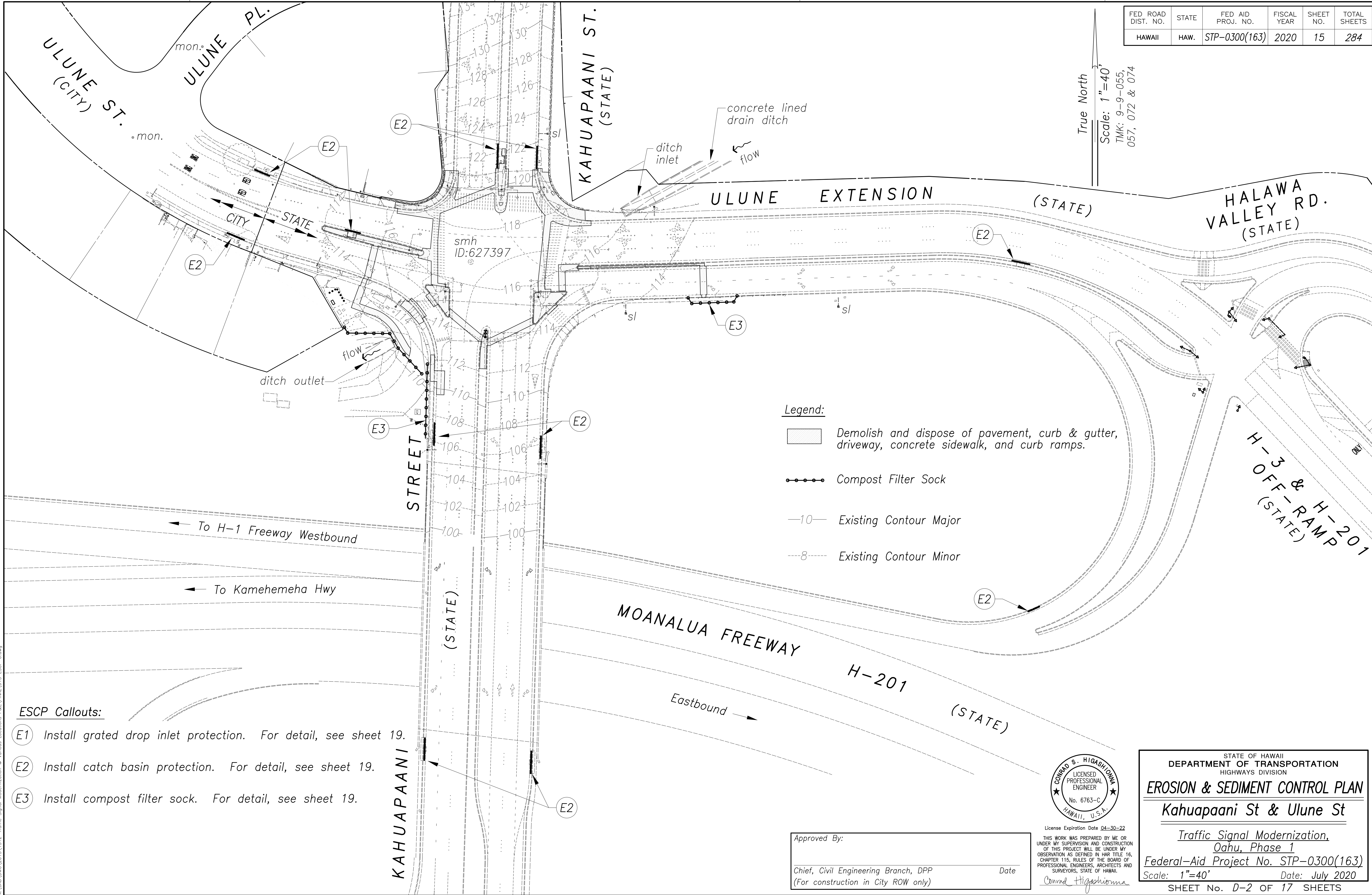

Legend:

- Demolish and dispose of pavement, curb & gutter, driveway, concrete sidewalk, and curb ramps.
- Compost Filter Sock
- Existing Contour Major
- Existing Contour Minor

ESCP Callouts:

- E1** Install grated drop inlet protection. For detail, see sheet 19.
- E2** Install catch basin protection. For detail, see sheet 19.
- E3** Install compost filter sock. For detail, see sheet 19.

SURVEY PLOTTED BY	DATE
DRAWN BY	
DESIGNED BY	
QUANTITIES BY	
CHECKED BY	
ORIGINAL PLAN	
NOTE BOOK	
No.	

Aug 28, 2020-8:58pm
N:\CAO\DWG\2015\1512-Traffic Signal Modernization @ Various Locations P&E\FINAL\015 ESCP U.dwg

Approved By: _____ Date _____
Chief, Civil Engineering Branch, DPP
(For construction in City ROW only)

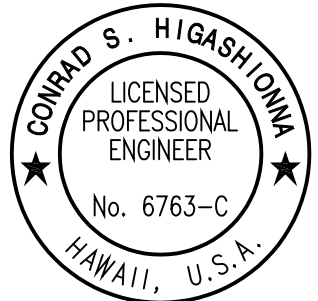

License Expiration Date 04-30-22
THIS WORK WAS PREPARED BY ME OR UNDER MY SUPERVISION AND CONSTRUCTION OF THIS PROJECT WILL BE UNDER MY OBSERVATION AS DEFINED IN HAWAII TITLE 16, CHAPTER 115, RULES OF THE BOARD OF PROFESSIONAL ENGINEERS, ARCHITECTS AND SURVEYORS, STATE OF HAWAII.
Conrad Higashimura

STATE OF HAWAII
DEPARTMENT OF TRANSPORTATION
HIGHWAYS DIVISION
EROSION & SEDIMENT CONTROL PLAN
Kahuapaani St & Ulune St
*Traffic Signal Modernization,
Oahu, Phase 1*
Federal-Aid Project No. STP-0300(163)
Scale: 1"=40' Date: July 2020
SHEET No. D-2 OF 17 SHEETS

- E1 Install grated drop inlet protection. For detail, see sheet 19.
- E2 Install catch basin protection. For detail, see sheet 19.
- E3 Install compost filter sock. For detail, see sheet 19.

 Demolish and dispose of concrete ramp, sidewalk, curb, gutter, asphalt concrete curb, and asphalt concrete sidewalk.

—10— Existing Contour Major

—8— Existing Contour Minor

FED ROAD DIST. NO.	STATE	FED AID PROJ. NO.	FISCAL YEAR	SHEET NO.	TOTAL SHEETS
HAWAII	HAW.	STP-0300(163)	2020	16	284

True North
Scale: 1"=20'
TMK: 2-1-005,
009, 018, & 019

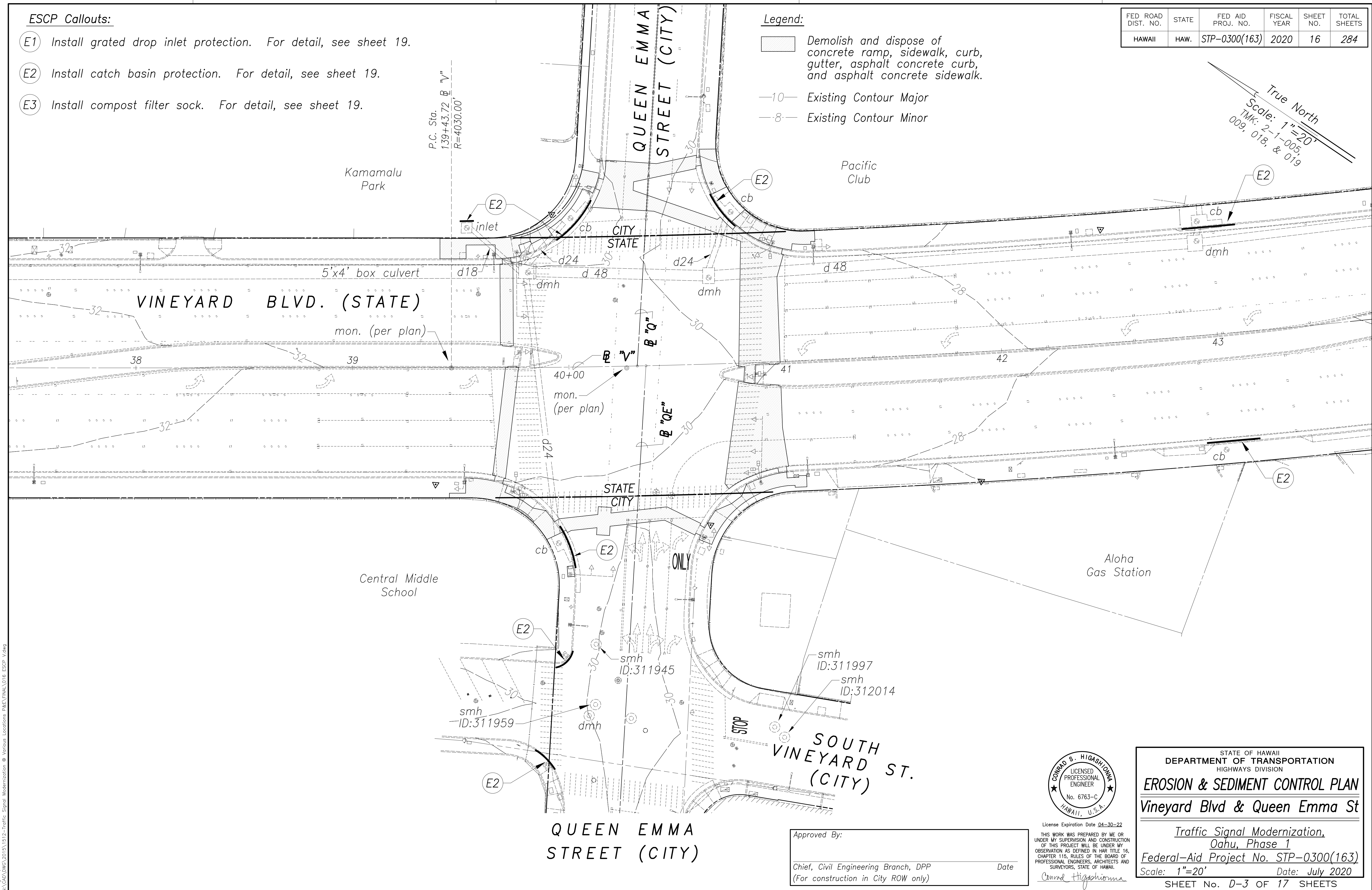

License Expiration Date 04-30-22

THIS WORK WAS PREPARED BY ME OR
UNDER MY SUPERVISION AND CONSTRUCTION
OF THIS PROJECT WILL BE UNDER MY
OBSERVATION AS DEFINED IN HAR TITLE 16,
CHAPTER 115, RULES OF THE BOARD OF
PROFESSIONAL ENGINEERS, ARCHITECTS AND
SURVEYORS, STATE OF HAWAII.

Conrad Higashionna

STATE OF HAWAII
DEPARTMENT OF TRANSPORTATION
HIGHWAYS DIVISION

EROSION & SEDIMENT CONTROL PLAN

Vineyard Blvd & Queen Emma St

Traffic Signal Modernization.

Oahu, Phase 1
Federal Aid Project No. STB 0300(163)



Scale: 1"=20' Date: July 2020

SHEET No. *D-3* OF 17 SHEETS

ESCP Callouts:

- (E1) Install grated drop inlet protection. For detail, see sheet 19.
- (E2) Install catch basin protection. For detail, see sheet 19.
- (E3) Install compost filter sock. For detail, see sheet 19.

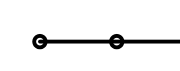
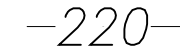
Legend:

-  Remove and dispose of existing A.C. pavement, curb & gutter, driveway, concrete sidewalk, and curb ramp.
-  Compost Filter Sock
-  -220- Existing Contour Major
-  -218- Existing Contour Minor
-  Approximate limits of grading and disturbed area

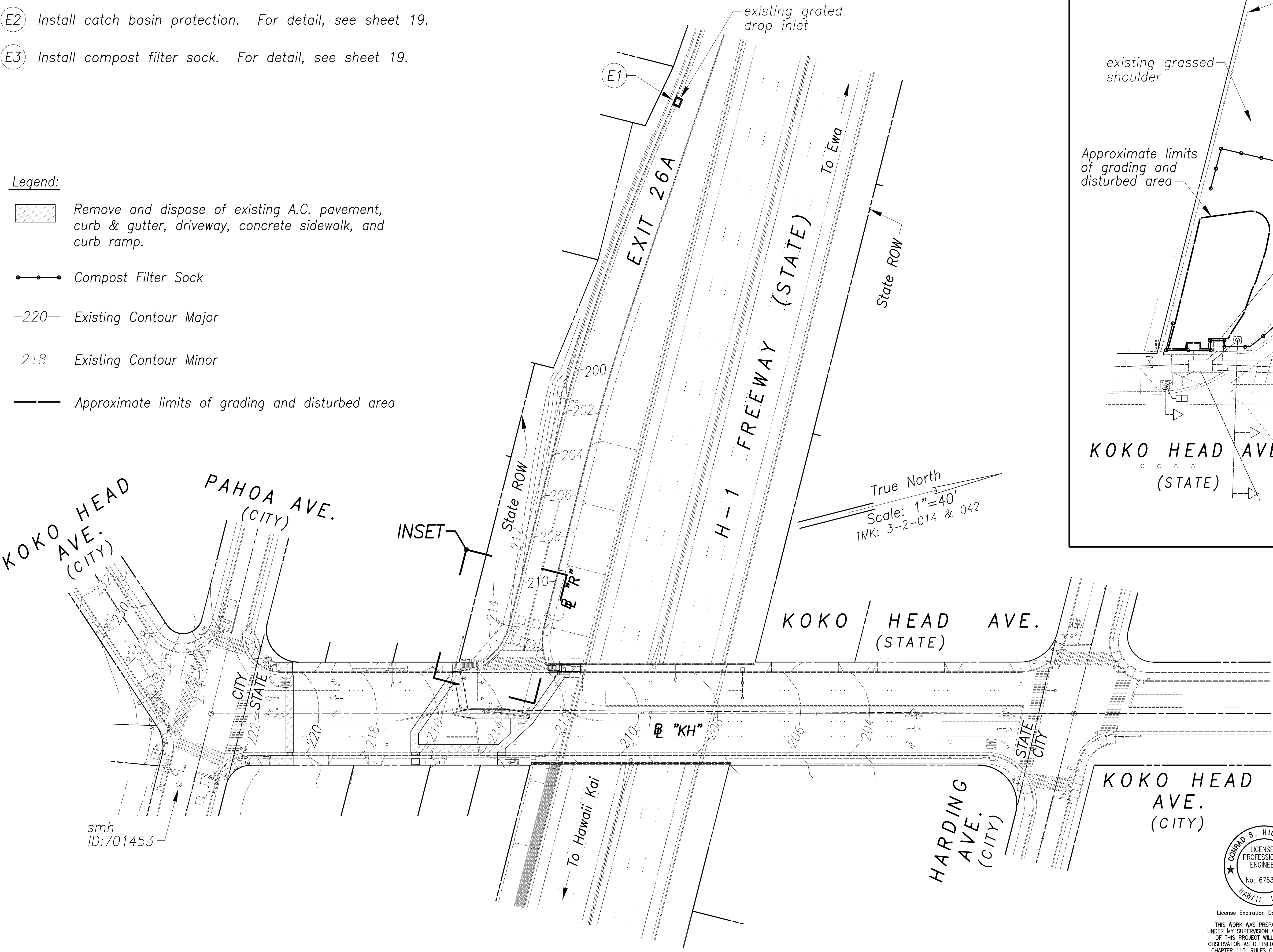

FED. ROAD DIST. NO.	STATE	FED. AID PROJ. NO.	FISCAL YEAR	SHEET NO.	TOTAL SHEETS
HAWAII	HAW.	STP-0300(163)	2020	17	284

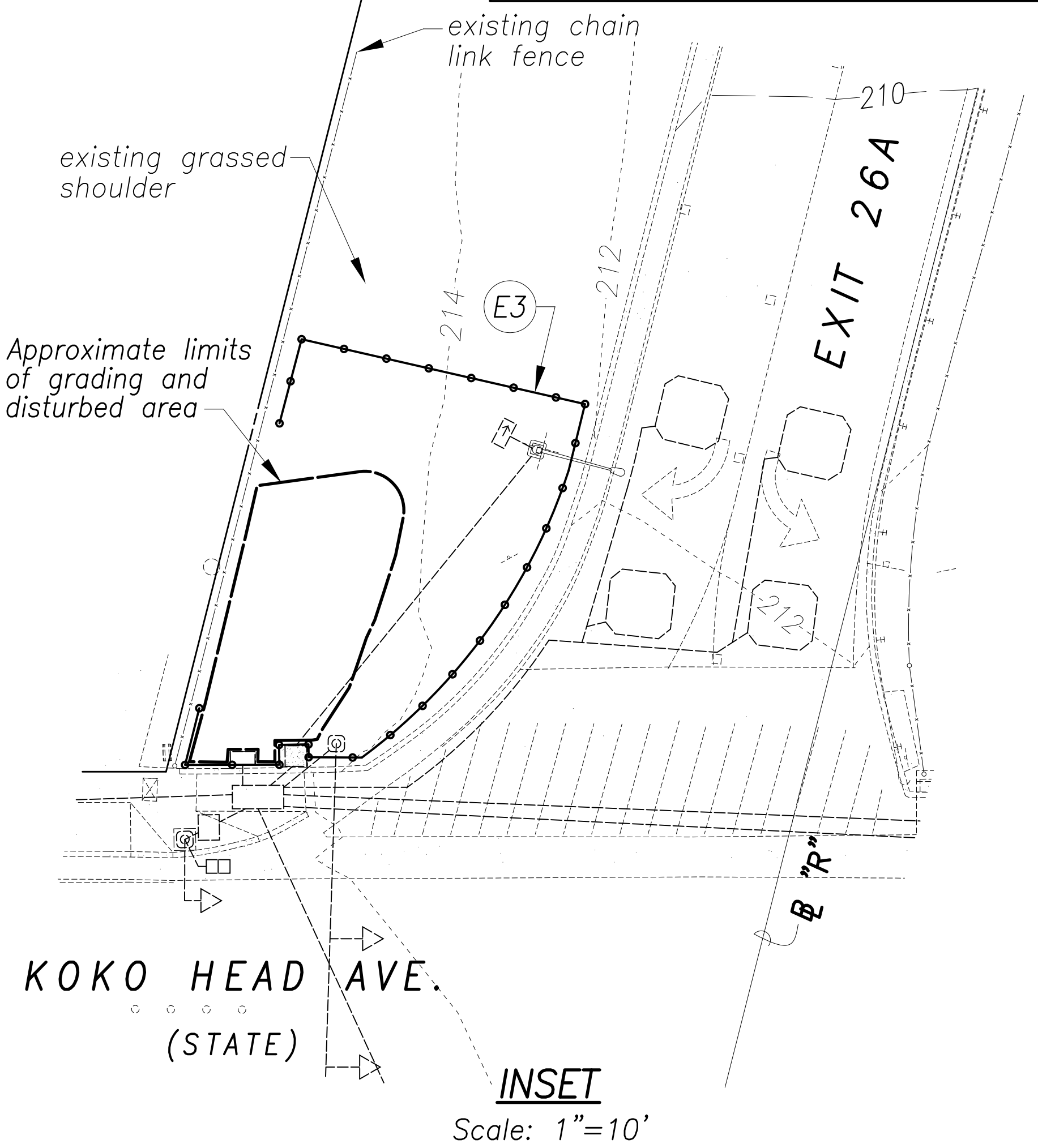

SURVEY PLOTTED BY	DATE
DRAWN BY	
DESIGNED BY	
QUANTITIES BY	
CHECKED BY	

ORIGINAL PLAN	No.
NOTE BOOK	
CHECKED BY	

Aug. 28, 2020-5:50pm
N:\CADD\DWG\2015\1512-Traffic Signal Modernization @ Various Locations P&E\FINAL\017 ESCP II.dwg

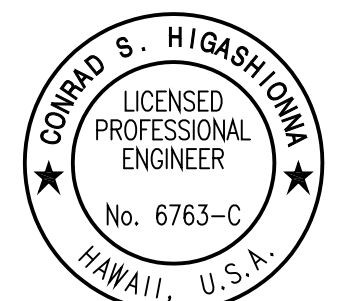

License Expiration Date 04-30-22
THIS WORK WAS PREPARED BY ME OR UNDER MY SUPERVISION AND CONSTRUCTION OF THIS PROJECT WILL BE UNDER MY OBSERVATION AS DEFINED IN HAWAII TITLE 16, CHAPTER 115, RULES OF THE BOARD OF PROFESSIONAL ENGINEERS, ARCHITECTS AND SURVEYORS, STATE OF HAWAII.
Conrad Higashimura

STATE OF HAWAII
DEPARTMENT OF TRANSPORTATION
HIGHWAYS DIVISION

EROSION & SEDIMENT CONTROL PLAN

H-1 Exit 26A & Koko Head Ave

*Traffic Signal Modernization,
Oahu, Phase 1*

Federal-Aid Project No. STP-0300(163)

Scale: 1"=40' Date: July 2020

SHEET No. D-4 OF 17 SHEETS

ESCP Callouts:

- (E1) Install grated drop inlet protection. For detail, see sheet 19.
- (E2) Install catch basin protection. For detail, see sheet 19.
- (E3) Install compost filter sock. For detail, see sheet 19.

FED. ROAD DIST. NO.	STATE	FED. AID PROJ. NO.	FISCAL YEAR	SHEET NO.	TOTAL SHEETS
HAWAII	HAW.	STP-0300(163)	2020	18	284

