

ALL ALUMINUM 6061T6 ALLOY AND
STAINLESS STEEL COMPONENTS.

NOTE: DIMENSIONS MAY VARY SLIGHTLY.

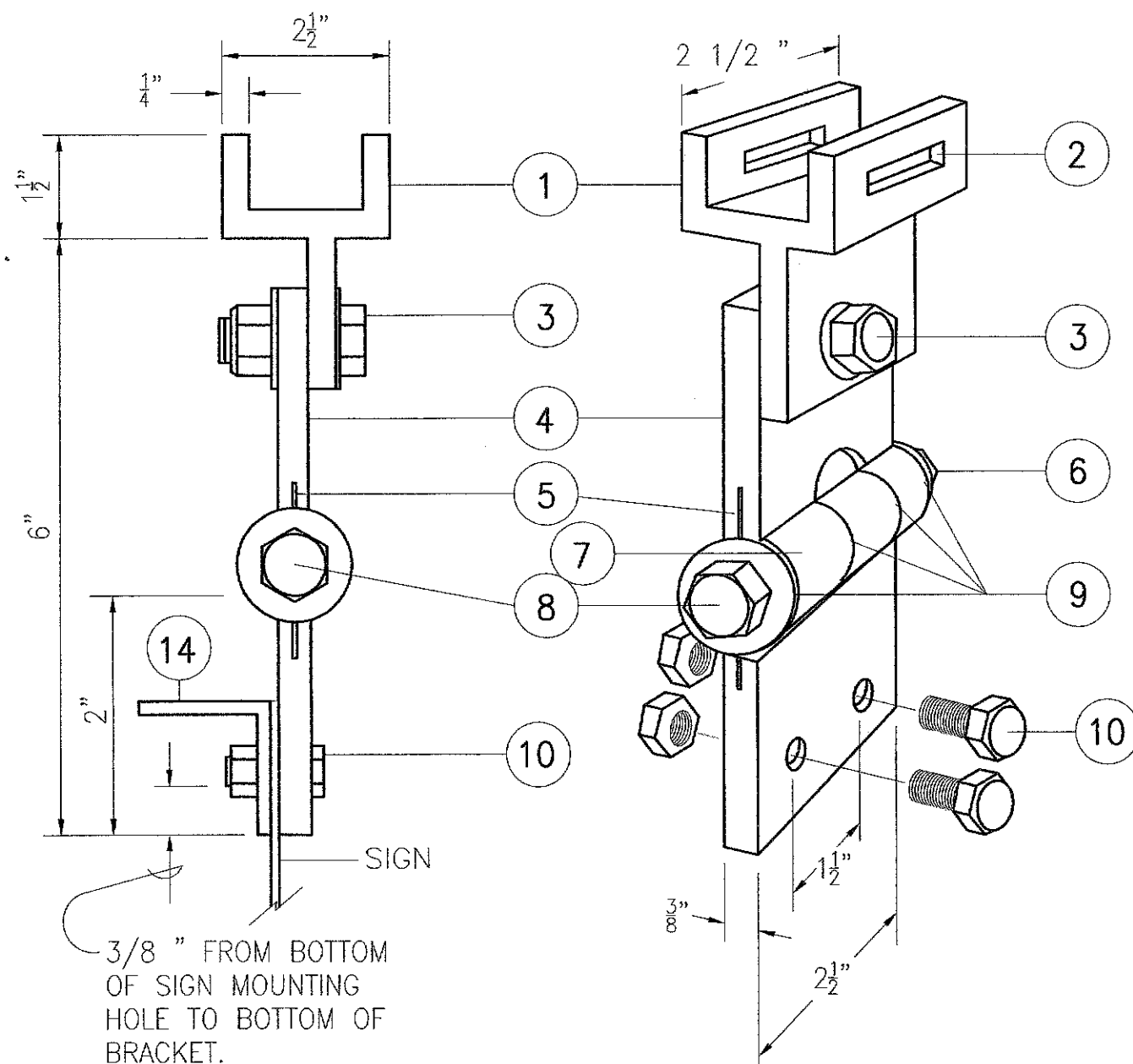

**FIXED LENGTH NON-ADJUSTABLE
SWING SIGN BRACKET**
NOT TO SCALE

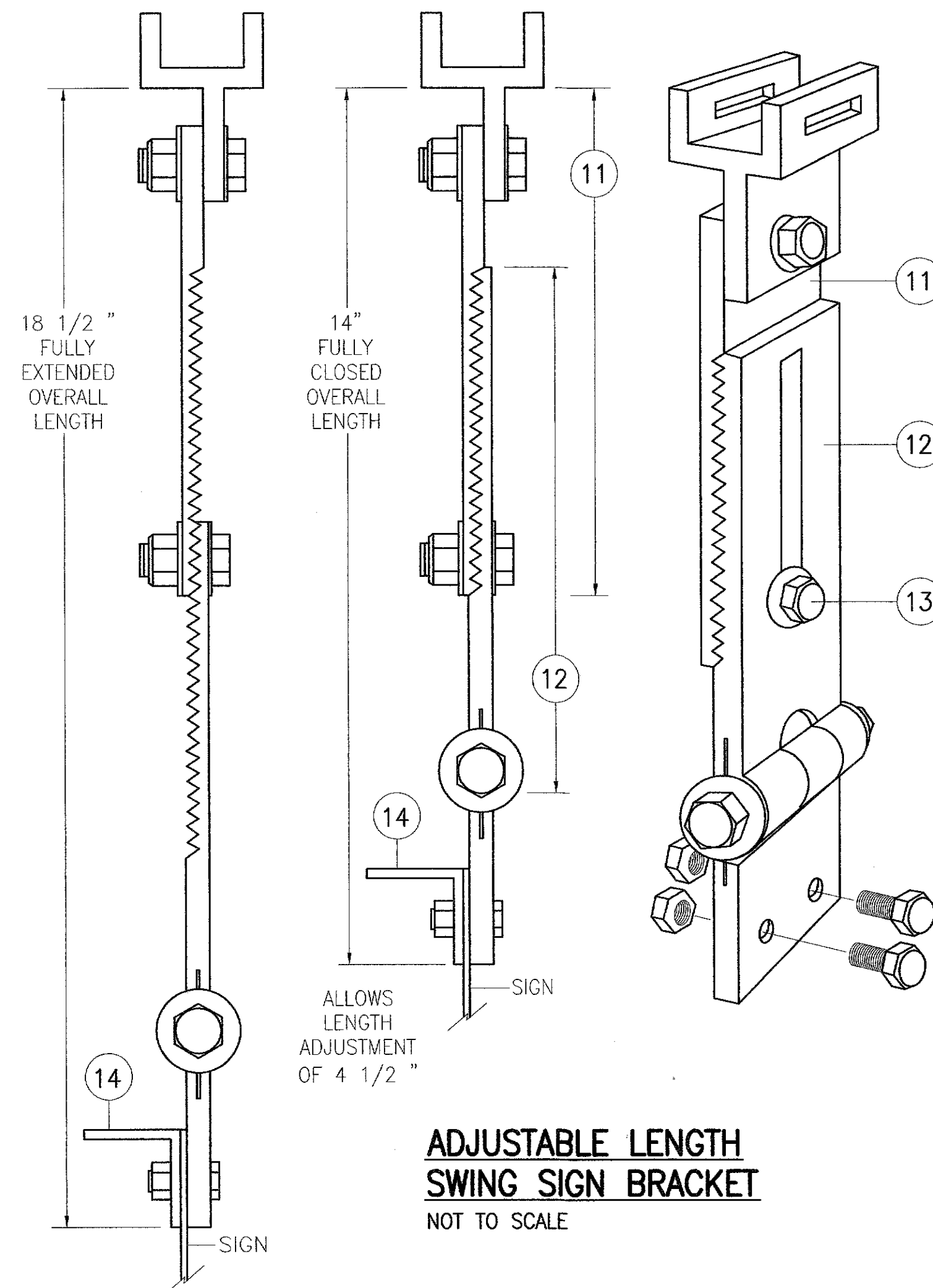

**ADJUSTABLE LENGTH
SWING SIGN BRACKET**
NOT TO SCALE

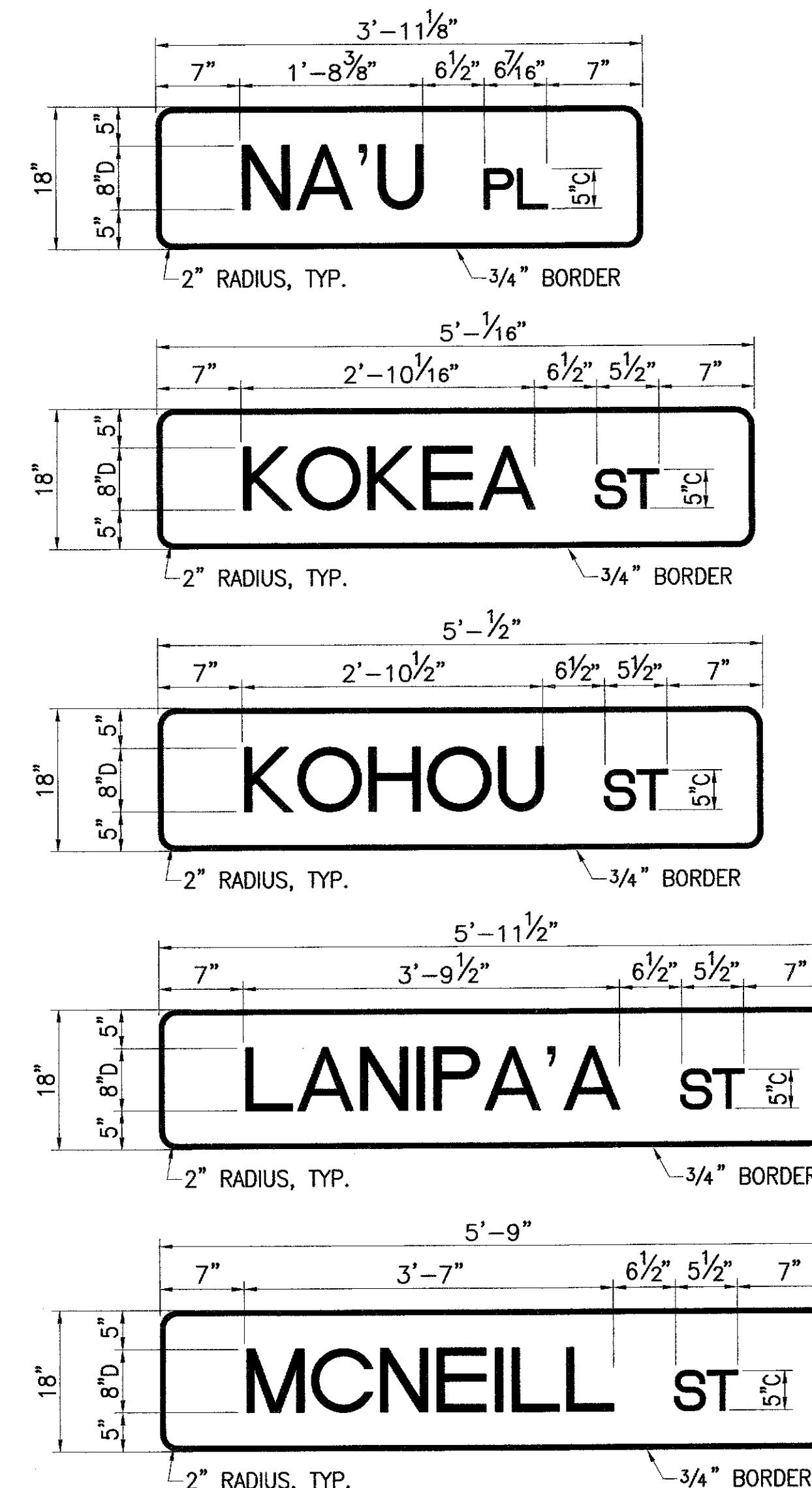

STREET NAME SIGN DETAILS
NOT TO SCALE

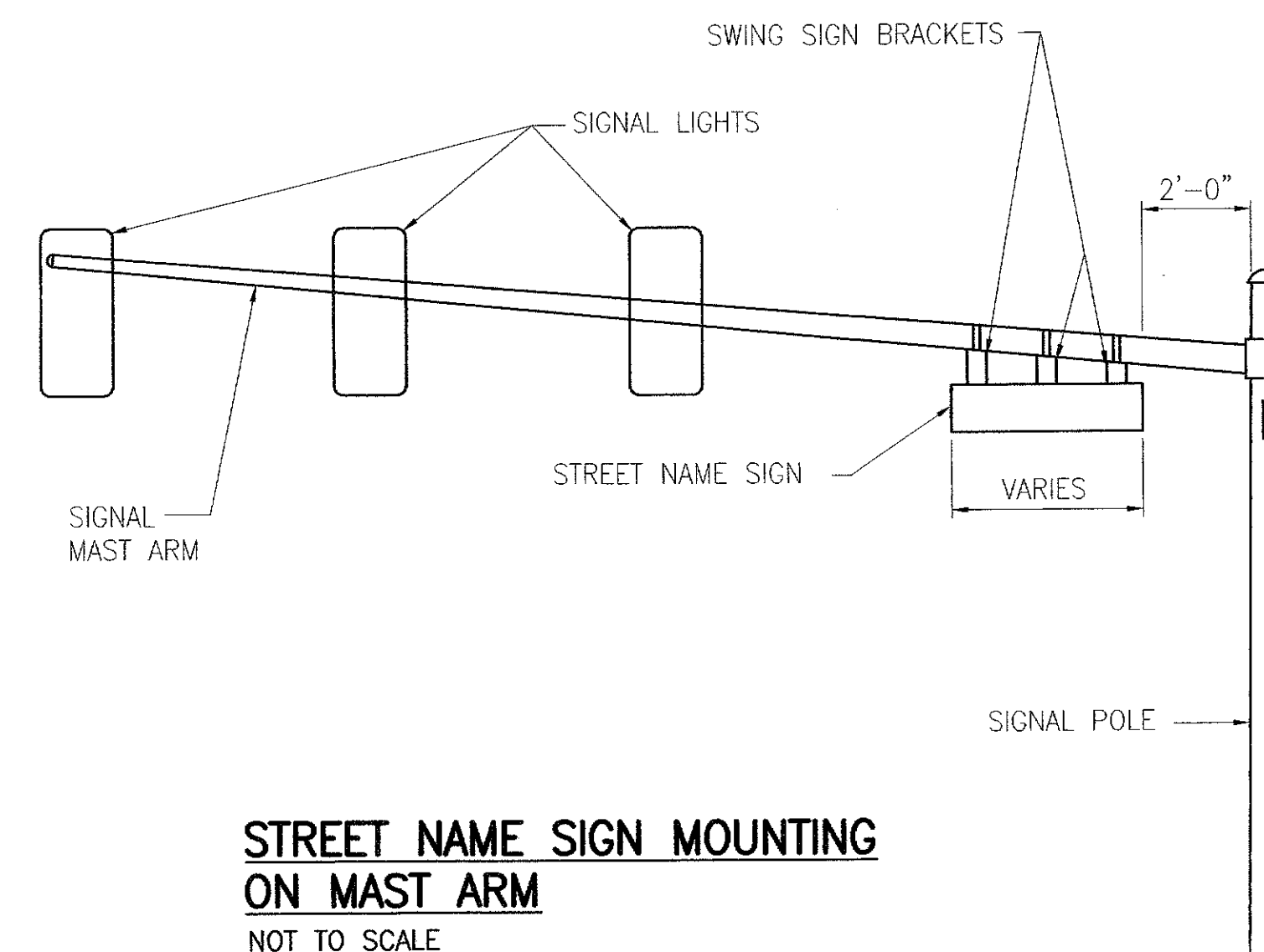

**STREET NAME SIGN MOUNTING
ON MAST ARM**
NOT TO SCALE

FED. ROAD DIST. NO.	STATE	FED. AID PROJ. NO.	FISCAL YEAR	SHEET NO.	TOTAL SHEETS
HAWAII	HAW.	STP-0001(36)	2008	42	42

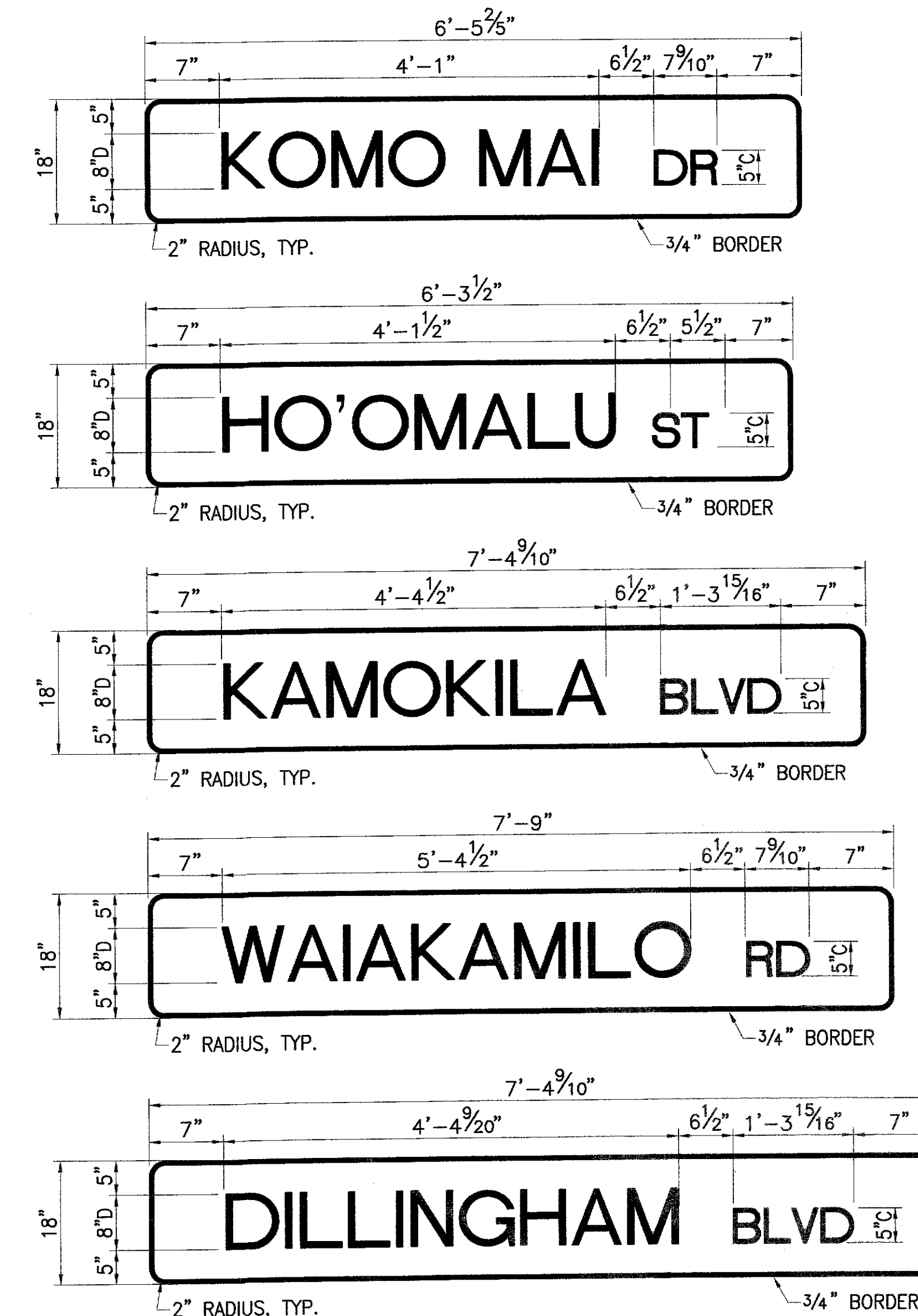

- 1 PIVOTAL UPPER BRACKET
- 2 1 5/8 " x 1/4 " SLOT FOR DOUBLE STRAPPING TO ELECTROLIER
MAST ARM. (M2G-34S(HD) .030" x 3/4 " HEAVY DUTY STAINLESS
STEEL STRAP WITH M2G-34B(HD) BUCKLE RECOMMENDED.)
- 3 1/2 " - 13 x 1 1/2 " STAINLESS STEEL HEX HEAD BOLT WITH
STAINLESS STEEL HEX LOCK NUT AND 1/16 " STAINLESS STEEL
WASHER (BOTH SIDES). ALLOWS UPPER BRACKET TO PIVOT AND
ALIGN WITH ELECTROLIER MAST ARM.
- 4 6" OVERALL DROP WITH FIXED LENGTH SIGN BRACKET
- 5 STAINLESS STEEL DAMPENER SPRING (REMOVABLE)
- 6 STAINLESS STEEL HEX LOCK NUT WITH 1/16 " STAINLESS STEEL
WASHER
- 7 1" O.D. AXLE HOUSING
- 8 1/2 " - 13 x 4" STAINLESS STEEL HEX HEAD BOLT WITH 1/16 " STAINLESS STEEL WASHER
- 9 OILITE BUSHING
- 10 SIGN MOUNTING SETS, CONSISTING OF TWO EACH 5/16 " - 18 X
1" STAINLESS STEEL HEX HEAD BOLT WITH STAINLESS STEEL HEX
LOCK NUT. TWO HOLES ON 1 1/2 " CENTERS PROVIDE POSITIVE
LOCK SIGN MOUNTING TO BRACKET.
- 11 8 1/4 " OVERALL LENGTH UPPER ADJUSTABLE SIGN BRACKET
SECTION
- 12 9" OVERALL LENGTH LOWER ADJUSTABLE SIGN BRACKET SECTION,
INCLUDING AXLE HOUSING (8" OVERALL LENGTH TO TOP OF AXLE
HOUSING)
- 13 1/2 " - 13 x 1 1/2 " STAINLESS STEEL HEX BOLT WITH
STAINLESS STEEL HEX LOCK NUT AND 1/16 " STAINLESS STEEL
WASHERS (BOTH SIDES). LOOSEN LOCK NUT, ADJUST BRACKET
TEETH TO LEVEL SIGN.
- 14 1 1/4 " x 1 1/4 " x 1/8 " ALUMINUM ANGLE

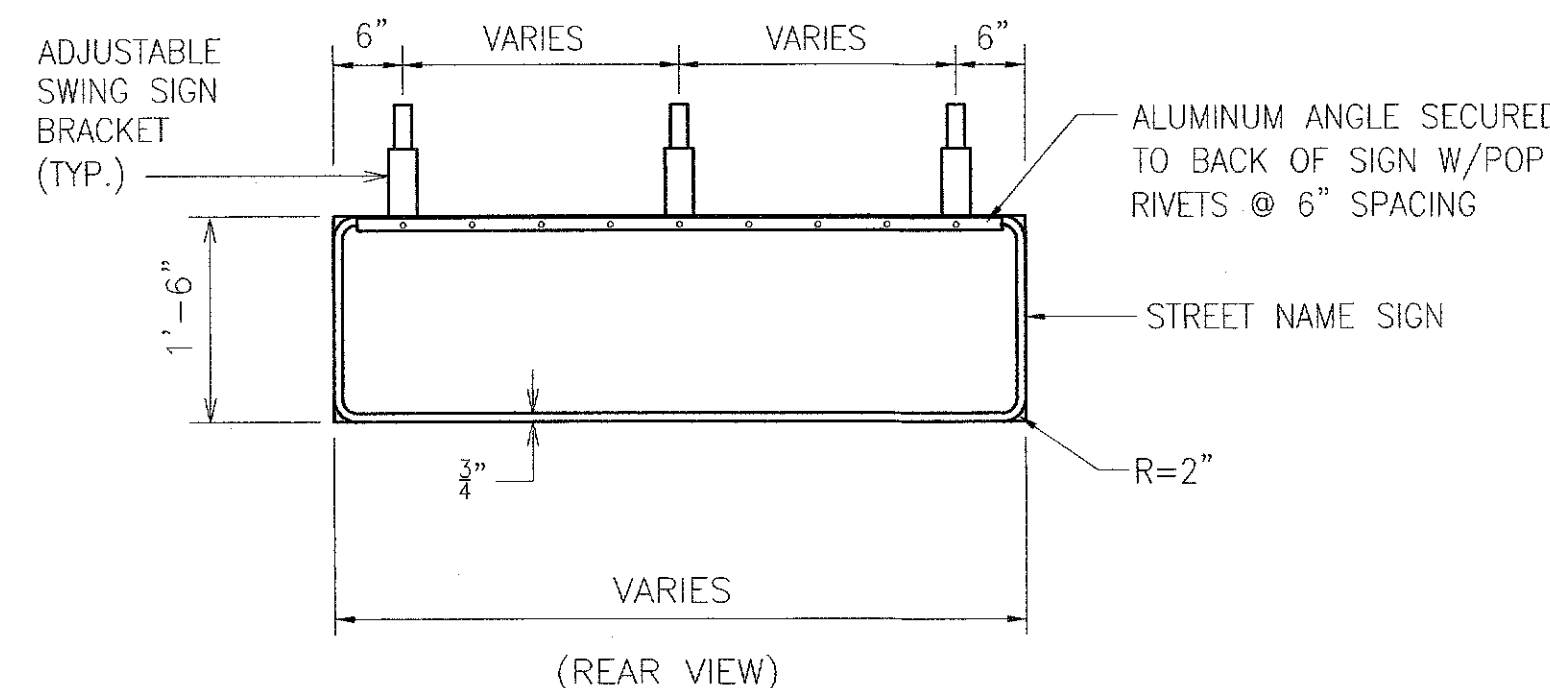

**PANEL & SWING BRACKET LAYOUT FOR
STREET NAME SIGN**
NOT TO SCALE

NOTES:

1. STREET NAME SIGNS SHALL HAVE WHITE MESSAGE AND BORDER
ON GREEN BACKGROUND.
2. ALL SIGN FACES SHALL BE COMPLETELY REFLECTORIZED WITH
TYPE "B" REFLECTIVE SHEETING.
3. THE SIGN SHALL BE IN CONFORMANCE WITH THE REQUIREMENTS
OF SECTION 712.20 OF THE STANDARD SPECIFICATION.

REVISION	DATE	DESCRIPTION	ENGINEER	APPROVED
DEPARTMENT OF TRANSPORTATION SERVICES CITY & COUNTY OF HONOLULU				
TRAFFIC CONTROL SIGNALIZATION AT VARIOUS LOCATIONS ON OAHU, PHASE X FEDERAL-AID NO. STP-0001(36)				
STREET NAME SIGN DETAIL				
DESIGN	LHY			
DRAWN	LHY			
CHECKED	KKN			
DATE	08/04/08			
PROJECT NO.		FILE	DRAW	FOLDER

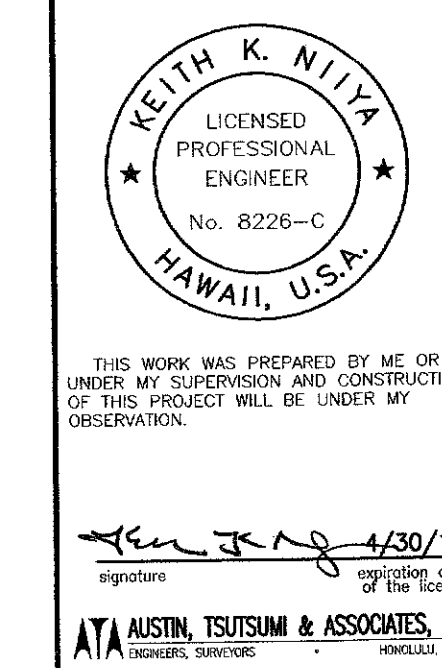

C-42
SHEET 42
OF 42 SHEETS