

FED. ROAD DIST. NO.	STATE	FED. AID PROJ. NO.	FISCAL YEAR	SHEET NO.	TOTAL SHEETS
HAWAII	HAW.	STP-0001(36)	2008	7	42

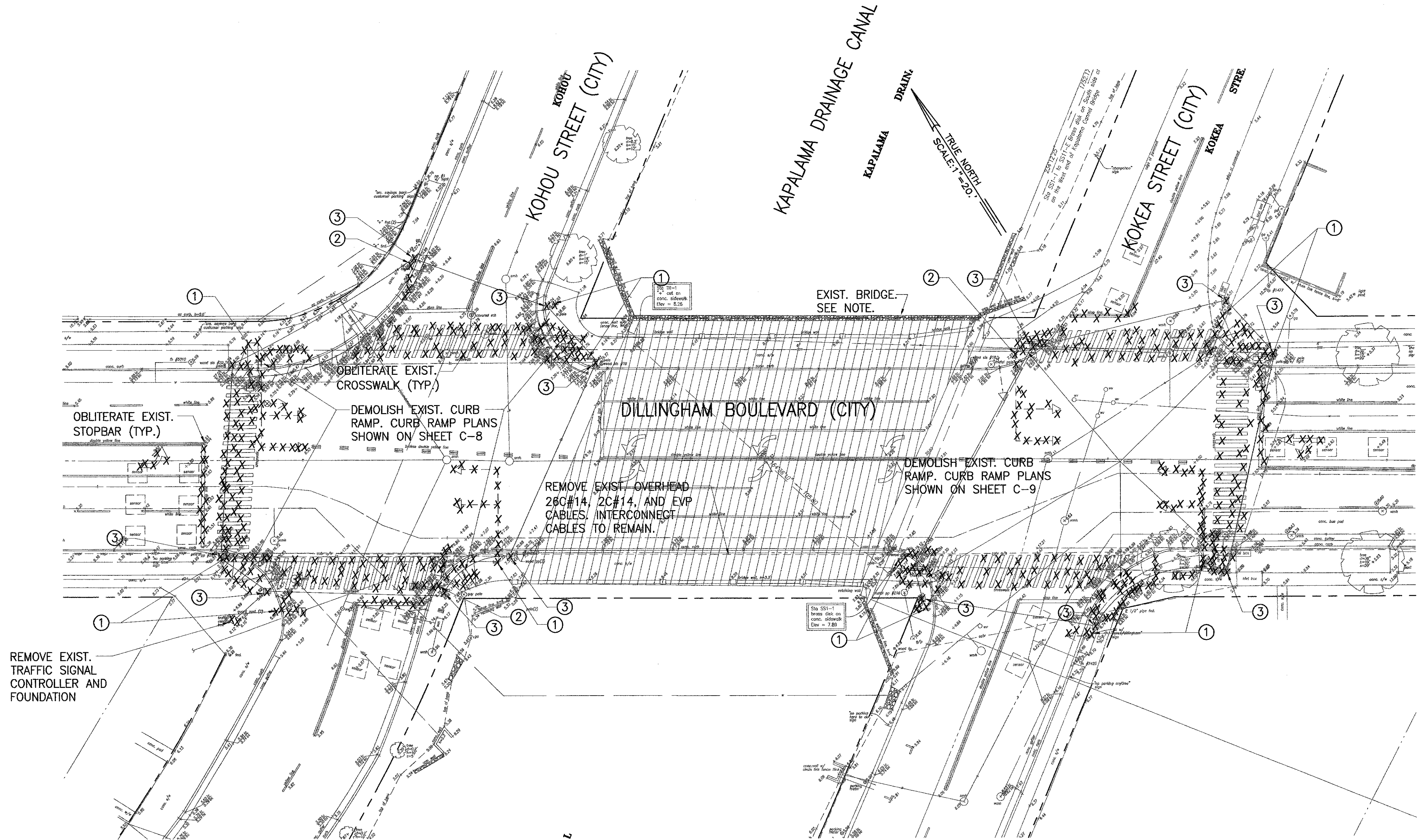

DEMOLITION PLAN  
SCALE: 1"=20'

NOTES

- CONTRACTOR SHALL TAKE ALL PRECAUTIONS NECESSARY AS NOT TO DAMAGE BRIDGE STRUCTURES. SHOULD THE ENGINEER DETERMINE THAT DAMAGE TO THE BRIDGE STRUCTURE HAS OCCURRED, THE CONTRACTOR SHALL REPAIR THE DAMAGE IN FULL. THE COSTS FOR ALL SUCH REPAIRS SHALL BE PAID FOR SOLELY BY THE CONTRACTOR.
- IN ORDER TO ADDRESS THE POSSIBILITY THAT HISTORIC SITES MAY BE ENCOUNTERED DURING CONSTRUCTION, THE CONTRACTOR SHALL RETAIN AN ARCHAEOLOGICAL MONITOR FROM THE SHPD APPROVED LIST, WHO SHALL BE PRESENT DURING ALL GROUND-DISTURBING ACTIVITIES AT THIS INTERSECTION. SEE SPECIFICATIONS, SECTION 212 FOR DETAILS.

SYMBOL	NOTES
①	DEMOLISH EXIST. TRAFFIC SIGNAL STANDARDS AND ALL ATTACHED TRAFFIC SIGNAL ASSEMBLIES, EVP'S, AND HEADS.
②	DEMOLISH EXIST. TRAFFIC SIGNAL STANDARDS AND ALL ATTACHED TRAFFIC SIGNAL ASSEMBLIES, EVP'S, AND HEADS. RELOCATE EXIST. SIGNS, SEE SHEET C-27 FOR RELOCATION.
③	REMOVE EXIST. TRAFFIC SIGNAL PULLBOX COVER AND FILL EXIST. PULLBOX WITH CONCRETE AND PROVIDE SMOOTH RIDING CONNECTION WITH EXIST. SIDEWALK

APPROVED

CHIEF, TRAFFIC SIGNALS AND TECHNOLOGY DIVISION,  
DEPARTMENT OF TRANSPORTATION SERVICES  
CITY & COUNTY OF HONOLULU

DATE

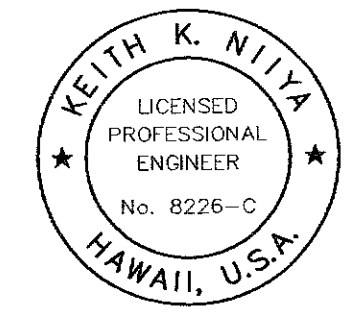

THIS WORK WAS PREPARED BY ME OR UNDER MY SUPERVISION AND CONSTRUCTION OF THIS PROJECT WILL BE UNDER MY OBSERVATION.

signature  
ATA AUSTIN, TSUTSUMI & ASSOCIATES, INC.  
ENGINEERS, ARCHITECTS, PLANNERS

REVISION	DATE	DESCRIPTION	ENGINEER	APPROVED
----------	------	-------------	----------	----------

DEPARTMENT OF TRANSPORTATION SERVICES  
CITY & COUNTY OF HONOLULU

TRAFFIC CONTROL SIGNALIZATION  
AT VARIOUS LOCATIONS ON OAHU, PHASE X  
FEDERAL-AID NO. STP-0001(36)

DEMOLITION PLAN  
DILLINGHAM BOULEVARD/KOKEA STREET/KOHOU STREET

DESIGN LHY

DRAWN LHY

CHECKED KKN

DATE 08/04/08

PROJECT NO.

FILE DRAW FOLDER

FILE POCKET FOLDER NO.

C-7

SHEET 7

OF 42 SHEETS