

| FED. ROAD DIST. NO. | STATE | FEDERAL AID PROJ. NO. | FISCAL YEAR | SHEET NO. | TOTAL SHEETS |
|---------------------|-------|-----------------------|-------------|-----------|--------------|
| HAWAII | HAW. | NH-0300(205) | 2024 | 190 | 197 |

GENERAL NOTES:

1. All Work Shall be Constructed in Accordance With the Following Construction Standards and specifications:
Construction Standards of Department of Transportation, State of Hawaii, 2005.
- Current Standards Specifications for Road and Bridge Construction, State of Hawaii.
- 2 It is Not the Intent of These Plans and Specifications to Indicate That All Existing Utilities are Shown on the Plans. The Information on the Existing Utilities are Based on Available Plans. The Locations are Approximate only and the Contractor Shall Verify the Location and Depth of the Facilities and Exercise Proper Care in Excavating in This Area. All Existing Utilities Whether or Not Shown on the Plans Shall be Protected at All Times by the Contractor. The Contractor Shall be Responsible for Any Damages to the Facilities Whether Shown or Not Shown on Plans. Any Repair Work Shall be Provided at No Additional Cost to This Project.
3. Exercise Proper Care When Excavating in Areas With Existing Underground Facilities. Damages to the Existing Facilities Shall be Immediately Reported to the Respective Utility Companies, City or State Agency. The Repair Work Shall be Provided at No Additional Cost to the Project.
4. All Saw Cutting Work Shall be Considered Incidental to the Various Contract Items.
5. For Typical Construction Details Not Shown on Plans, Refer to Applicable Standard Details of Construction and Maintenance Services, Department of Transportation, State of Hawaii.
6. Extra Care Shall be Taken While Excavating for the Pullboxes and Ductlines. Contractor Shall Tone for Location of Utility Lines Prior to Excavation.
7. Furnish and Install a Minimum Two Each TORX T-27 Tamper-Proof Screws per Pullbox Cover Section In Accordance With State DOT Highways Requirements.

ELECTRICAL SYMBOLS LIST

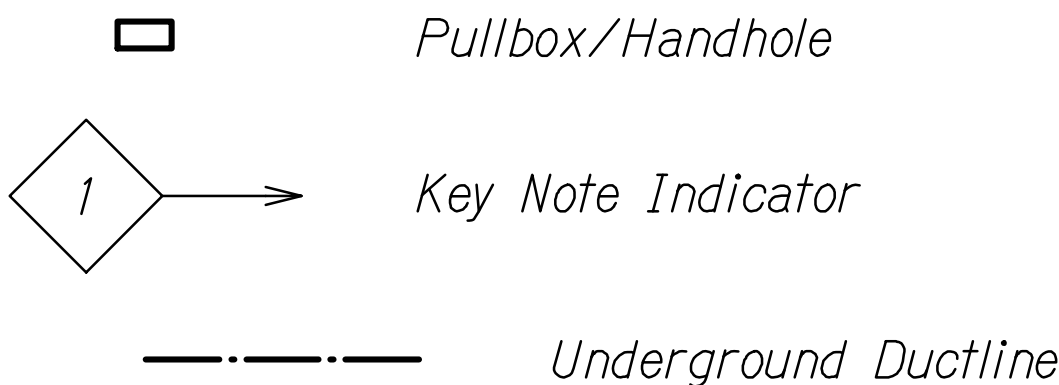

DUCT DESIGNATION

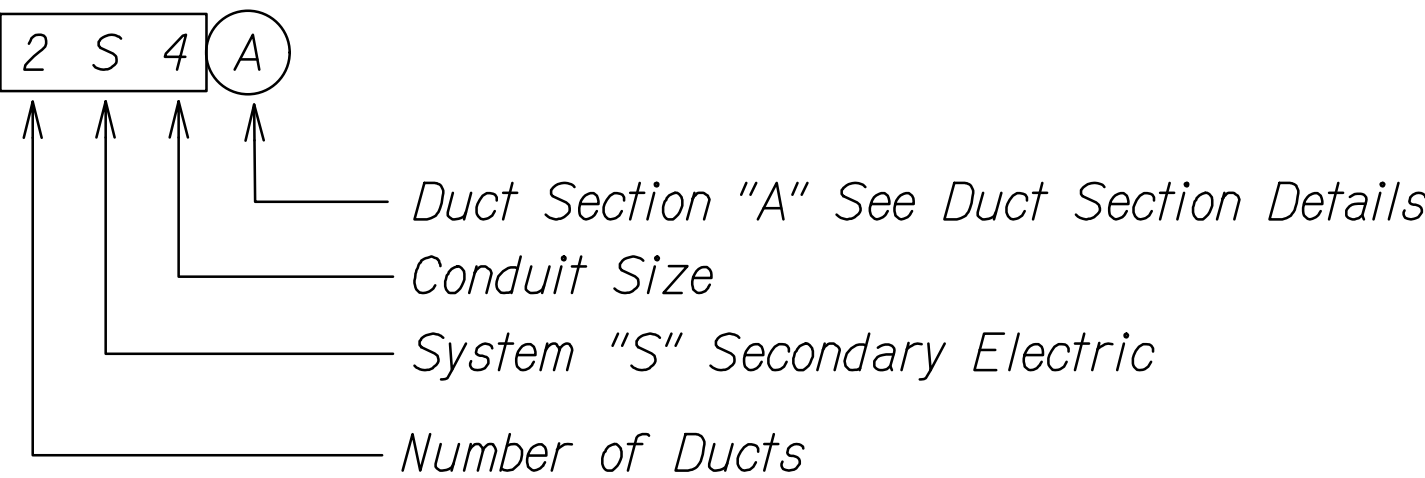

PULLBOX, HANDHOLE SCHEDULE

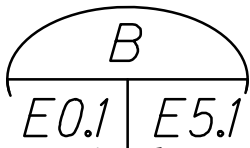
- 105 State Highways Electrical Pullbox, Type C, See State DOT Standard Plan TE-37 and General Note 7. Provide Re-inforced Concrete Collar Ring Around the Perimeter of Pullbox, See 

| ORIGINAL PLAN | SURVEY PLOTTED BY | DATE |
|---------------|-------------------|------|
| NOTE BOOK | DRAWN BY | |
| No. | DESIGNED BY | |
| | CHECKED BY | |

DRAWING NAME: WA-01-PROJECTS\2023\23028_H1H2DESTSIGNUPGRD\01-DWG\23028_E0.1_SYM.DWG PLOT TIME: 10-31-23, 10:06 AM

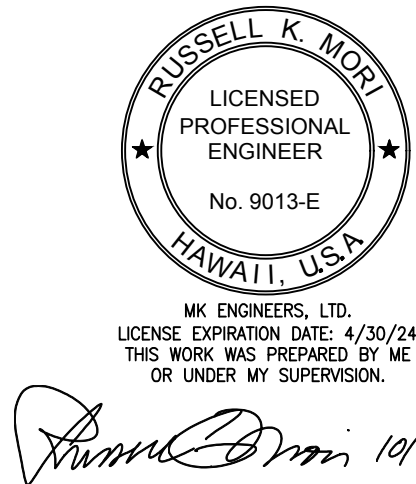

STATE OF HAWAII
DEPARTMENT OF TRANSPORTATION
HIGHWAYS DIVISION

ELECTRICAL SYMBOLS & NOTES

INTERSTATE ROUTE H-1 AND H-201
DESTINATION SIGN UPGRADE/REPLACEMENT, PHASE 3B
FAP NO. NH-0300(205)

Scale: As Noted Date: Oct. 2023

SHEET No. E0.1 OF 8 SHEETS

| FED. ROAD DIST. NO. | STATE | FEDERAL AID PROJ. NO. | FISCAL YEAR | SHEET NO. | TOTAL SHEETS |
|---------------------|-------|-----------------------|-------------|-----------|--------------|
| HAWAII | HAW. | NH-0300(205) | 2024 | 191 | 197 |

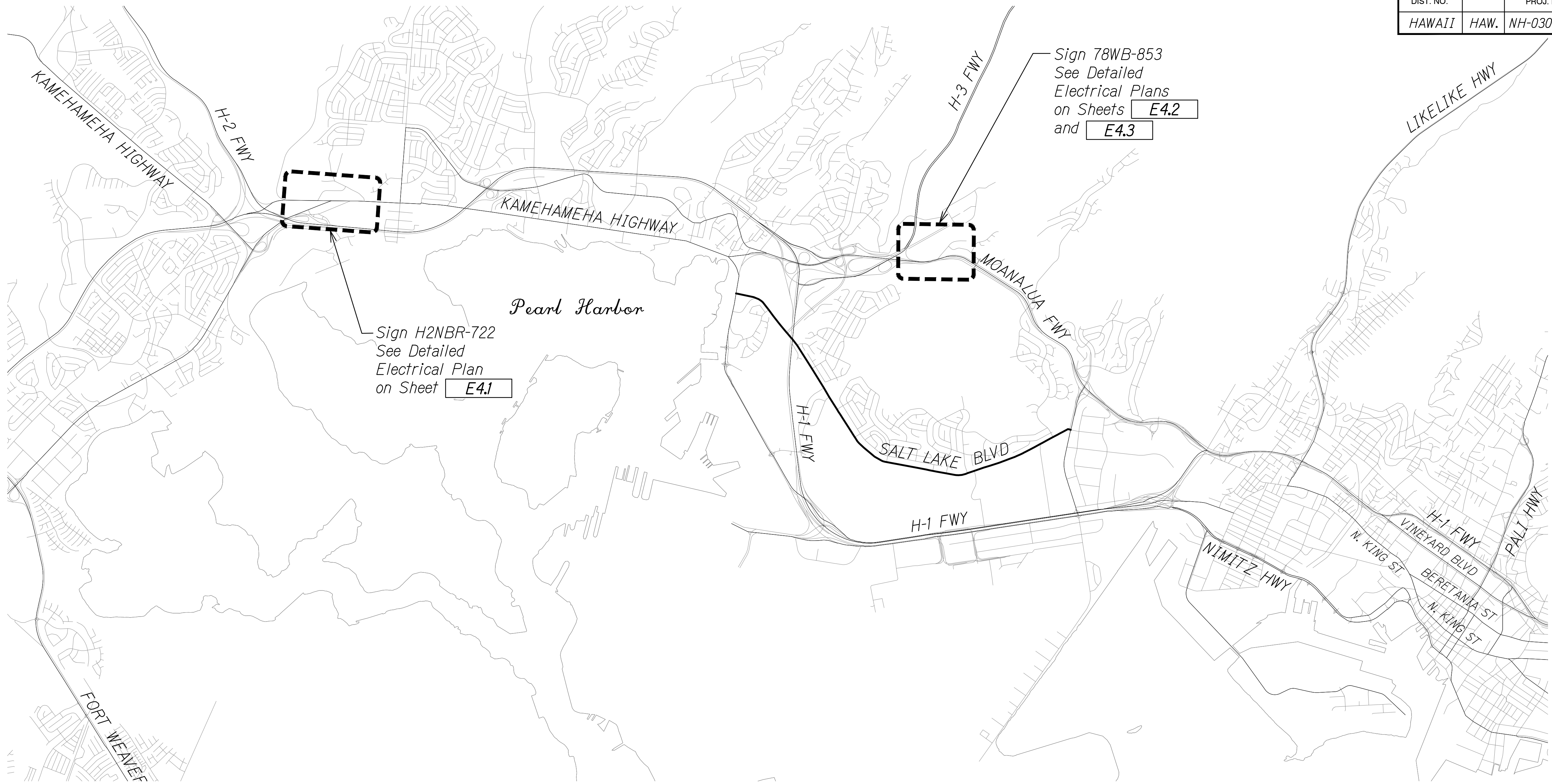

PARTIAL SITE ELECTRICAL PLAN
SCALE: 1" = 2500'-0"

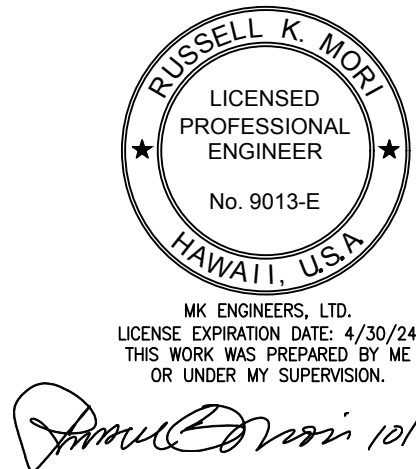
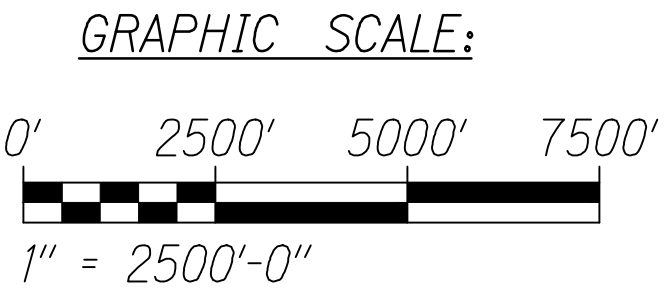
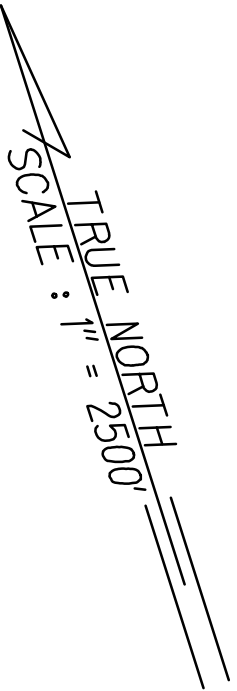

STATE OF HAWAII
DEPARTMENT OF TRANSPORTATION
HIGHWAYS DIVISION

PARTIAL SITE ELECTRICAL PLAN

INTERSTATE ROUTE H-1 AND H-201
DESTINATION SIGN UPGRADE/REPLACEMENT, PHASE 3B
FAP NO. NH-0300(205)

Scale: As Noted Date: Oct. 2023

SHEET No. E11 OF 8 SHEETS

| | | |
|---------------|-------------------|------|
| ORIGINAL PLAN | SURVEY PLOTTED BY | DATE |
| NOTE BOOK | DRAWN BY | |
| No. | DESIGNED BY | |
| | CHECKED BY | |

DRAWING NAME: WA_01_PROJECTS\2023\23028_H1H2DESTSIGNUPGRD\01_DWG\23028_E1_1_SITEELEC.DWG PLOT TIME: 10-31-23, 10:07 AM

| FED. ROAD DIST. NO. | STATE | FEDERAL AID PROJ. NO. | FISCAL YEAR | SHEET NO. | TOTAL SHEETS |
|---------------------|-------|-----------------------|-------------|-----------|--------------|
| HAWAII | HAW. | NH-0300(205) | 2024 | 192 | 197 |

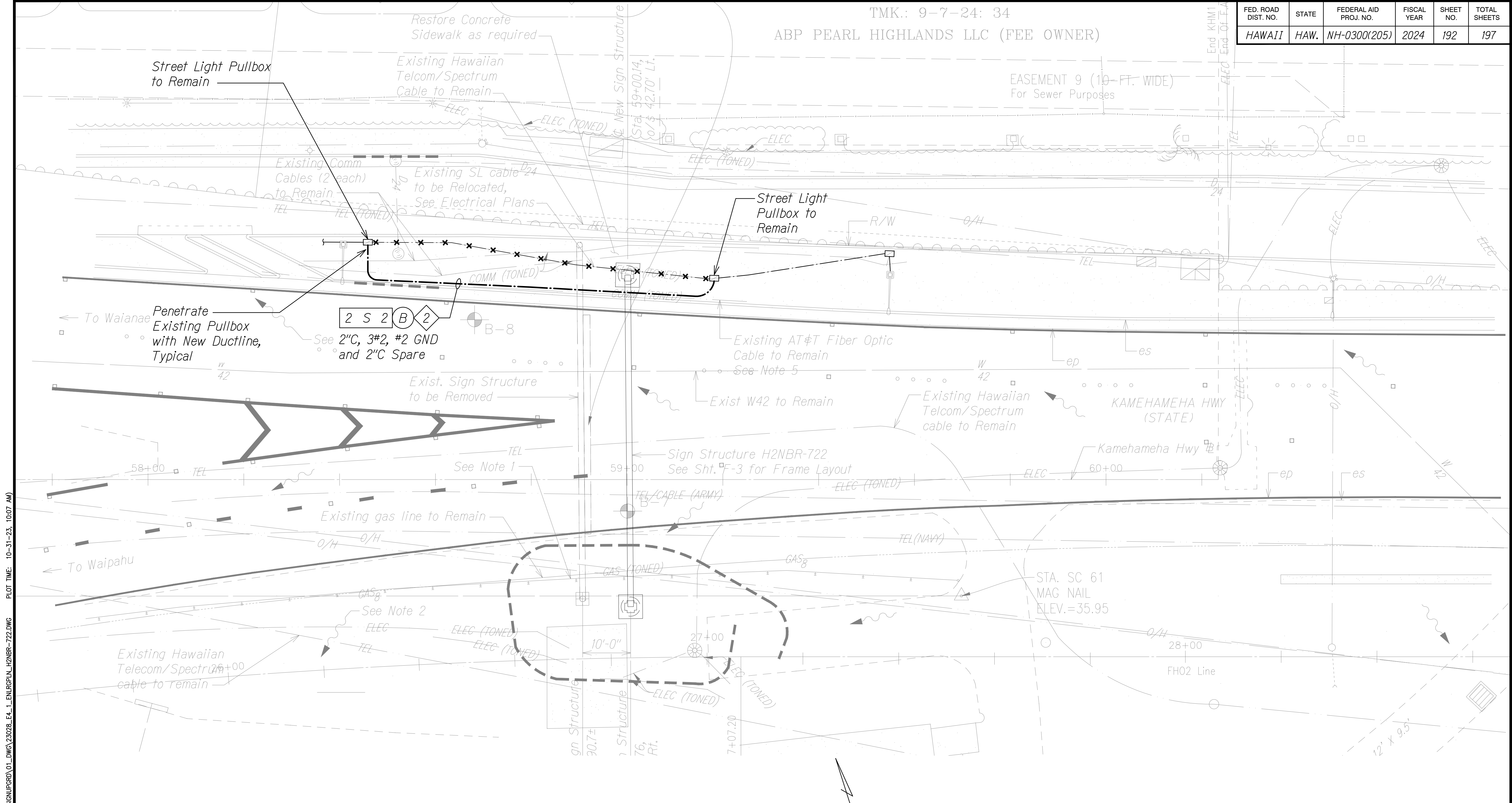

SIGN STRUCTURE H2NBR-722 ENLARGED ELECTRICAL PLAN

SCALE: 1" = 10'-0"

Notes:

- Light Lines Denote Existing Condition
- Bold Lines Denote New Work
- "X" Denotes Removal Work

- Sawcut and Patch Existing Concrete Pavement to Install New Ductline. Repair Concrete Pavement to Match Original Condition.
- Coordinate Power Outage of the Existing Lighting Feeder Circuit With State DOT Highways Via the Contracting Officer. Request for Feeder Power Outage Must be Submitted in Writing a Minimum of 25 Days in Advance of the Desired Outage Date for Approval.

GRAPHIC SCALE:

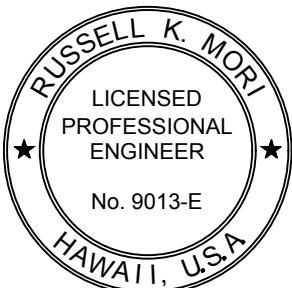
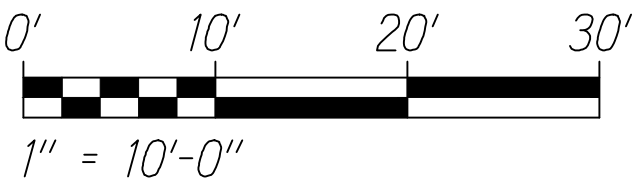

10/31/23

STATE OF HAWAII
DEPARTMENT OF TRANSPORTATION
HIGHWAYS DIVISION

**SIGN STRUCTURE H2NBR-722
ENLARGED ELECTRICAL PLAN**

INTERSTATE ROUTE H-1 AND H-201
DESTINATION SIGN UPGRADE/REPLACEMENT, PHASE 3B
FAP NO. NH-0300(205)

Scale: As Noted Date: Oct. 2023

SHEET No. E41 OF 8 SHEETS

| FED. ROAD DIST. NO. | STATE | FEDERAL AID PROJ. NO. | FISCAL YEAR | SHEET NO. | TOTAL SHEETS |
|---------------------|-------|-----------------------|-------------|-----------|--------------|
| HAWAII | HAW. | NH-0300(205) | 2024 | 193 | 197 |

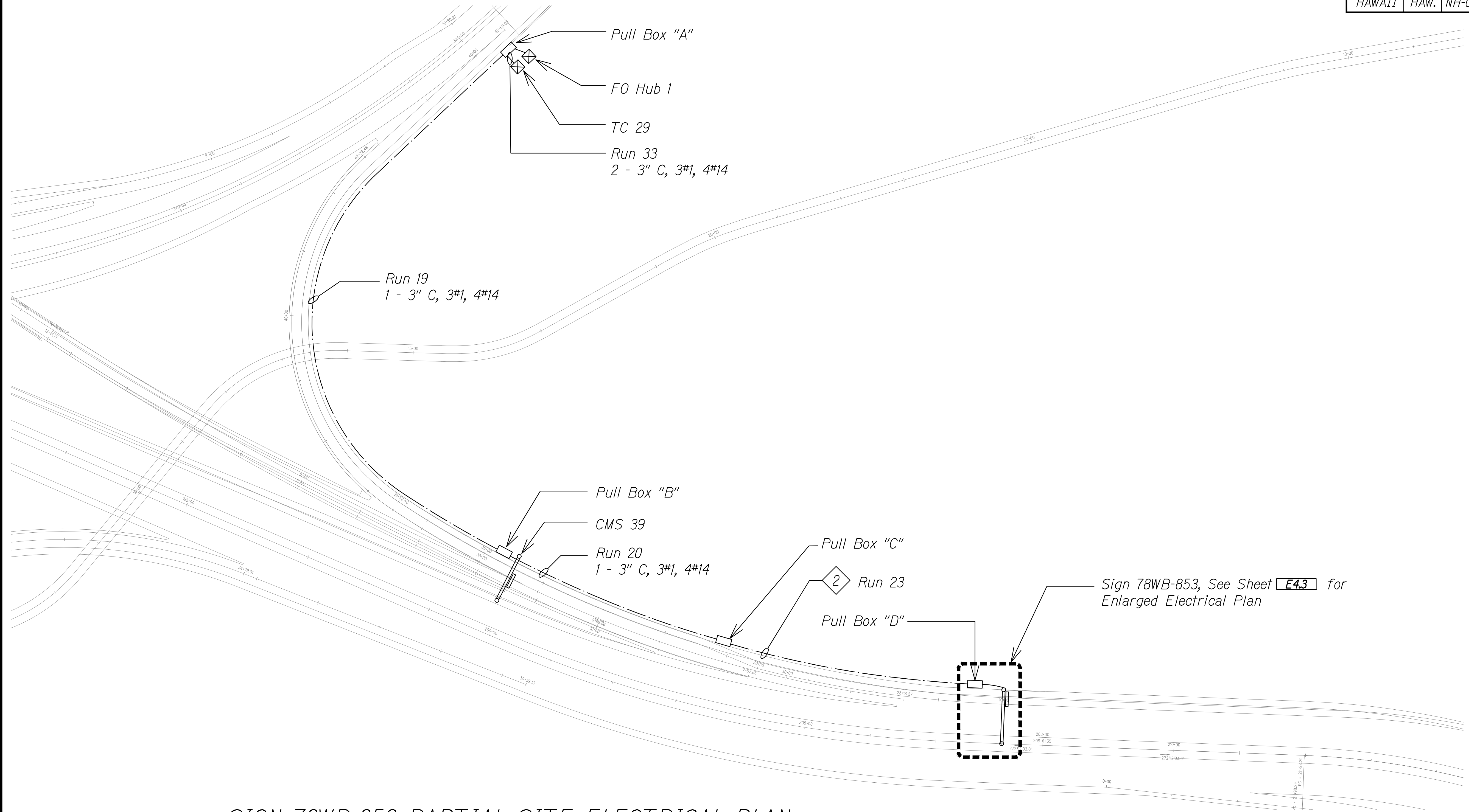

SIGN 78WB-853 PARTIAL SITE ELECTRICAL PLAN

SCALE: 1" = 80'-0"

Notes:

1. All Electrical Items Shown Are Existing
2. Cut and Insulate Conductors In Pullbox "C" to Facilitate New Work at Sign 78WB-853. Upon Completion of New Electrical Infrastructure Work at Sign 78WB-853 Provide New 3#1 and 4#14 in Existing 3"C, Splice to Existing Conductors in Pullbox C, and Extend to Relocated Sign 78WB-853.

TRUE NORTH
SCALE: 1" = 10'

GRAPHIC SCALE:

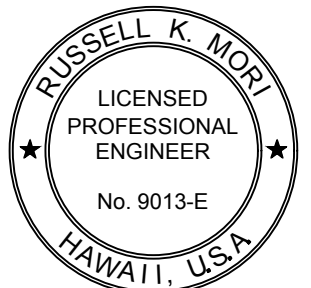
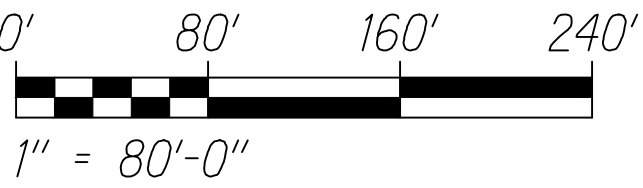

MR. ENGINEERS, LTD.
LICENSE EXPIRATION DATE: 4/30/24
THIS WORK WAS PREPARED BY ME
OR UNDER MY SUPERVISION.

Russell K. Mori 10/31/23

STATE OF HAWAII
DEPARTMENT OF TRANSPORTATION
HIGHWAYS DIVISION

**SIGN 78WB-853 PARTIAL SITE
ELECTRICAL PLAN**

INTERSTATE ROUTE H-1 AND H-201
DESTINATION SIGN UPGRADE/REPLACEMENT, PHASE 3B
FAP NO. NH-0300(205)

Scale: As Noted Date: Oct. 2023

SHEET No. E4.2 OF 8 SHEETS

| | | |
|---------------|-------------------|------|
| ORIGINAL PLAN | SURVEY PLOTTED BY | DATE |
| NOTE BOOK | DRAWN BY | |
| No. | DESIGNED BY | |
| | CHECKED BY | |

DRAWING NAME: WA_01_PROJECTS\2023\23028_H1H20ESTSIGNUPGRD_01_DWG\23028_E4_2_ENRGINDWG PLOT TIME: 10-31-23, 10:08 AM

| FED. ROAD DIST. NO. | STATE | FEDERAL AID PROJ. NO. | FISCAL YEAR | SHEET NO. | TOTAL SHEETS |
|---------------------|-------|-----------------------|-------------|-----------|--------------|
| HAWAII | HAW. | NH-0300(205) | 2024 | 194 | 197 |

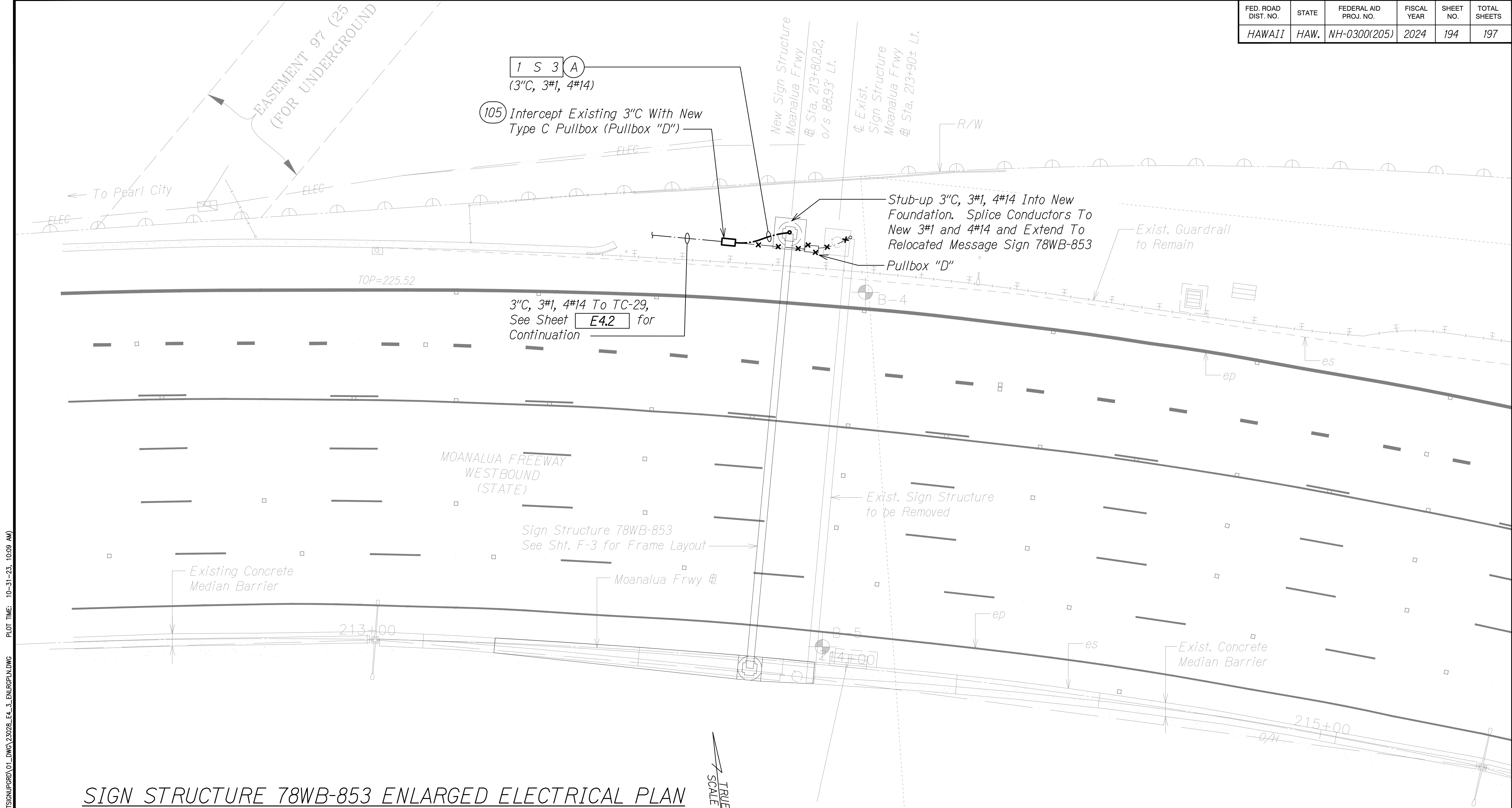

SIGN STRUCTURE 78WB-853 ENLARGED ELECTRICAL PLAN

Scale: 1" = 10'-0"

Notes:

- 1. Light Lines Denote Existing Condition
- Bold Lines Denote New Work
- "X" Denotes Removal Work

TRUE NORTH
SCALE: 1" = 10'

GRAPHIC SCALE:

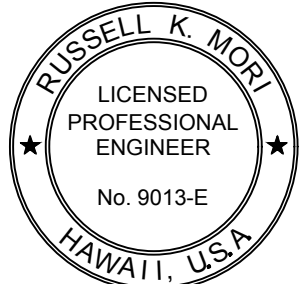
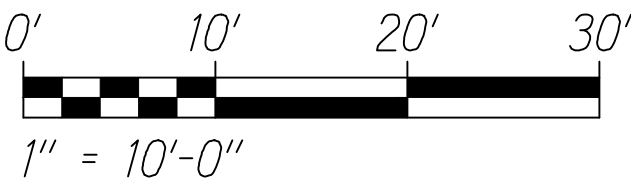

MR. ENGINEERS, LTD.
LICENSE EXPIRATION DATE: 4/30/24
THIS WORK WAS PREPARED BY ME
OR UNDER MY SUPERVISION.

Russell K. Mori 10/21/23

STATE OF HAWAII
DEPARTMENT OF TRANSPORTATION
HIGHWAYS DIVISION

SIGN STRUCTURE 78WB-853
ENLARGED ELECTRICAL PLAN

INTERSTATE ROUTE H-1 AND H-201
DESTINATION SIGN UPGRADE/REPLACEMENT, PHASE 3B
FAP NO. NH-0300(205)

Scale: As Noted Date: Oct. 2023

SHEET No. E4.3 OF 8 SHEETS

| FED. ROAD DIST. NO. | STATE | FEDERAL AID PROJ. NO. | FISCAL YEAR | SHEET NO. | TOTAL SHEETS |
|---------------------|-------|-----------------------|-------------|-----------|--------------|
| HAWAII | HAW. | NH-0300(205) | 2024 | 195 | 197 |

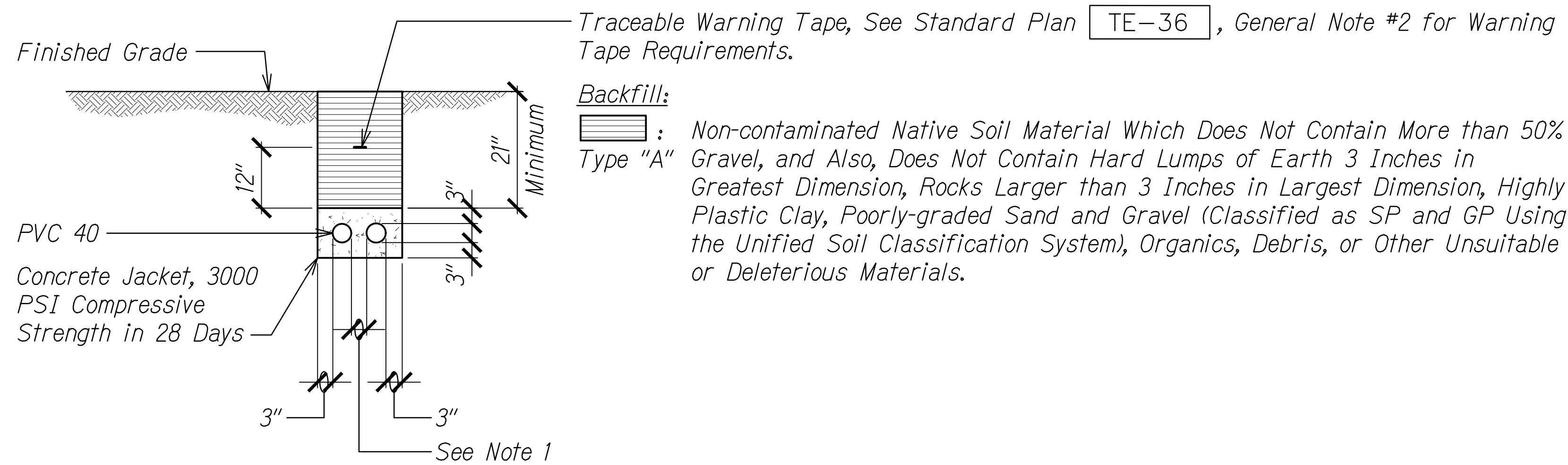

A TYPICAL DUCT SECTION (CONCRETE ENCASED) FOR UNPAVED AREAS
E5.1 | E5.1 Not To Scale

- Notes:**
1. Provide 2" Separation between Ducts of Same System and 3" between Ducts of Different Systems.
 2. Where Trench Encounters Grass or Landscaping, Provide 4" Top Soil After Trench is Backfilled, and Restore Landscaping to Match Existing Adjacent Area.
 3. See Duct Section Details for Conduit Arrangement.

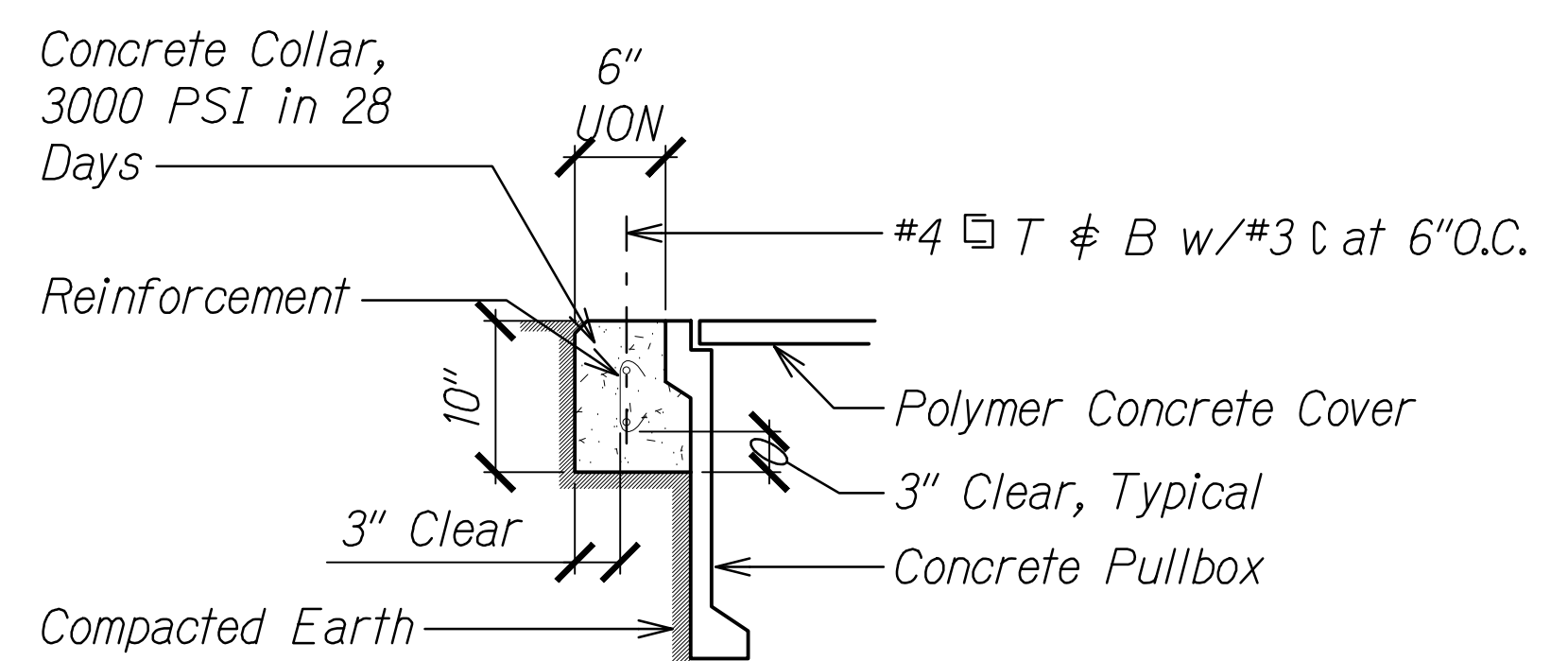

B CONCRETE COLLAR RING
E0.1 | E5.1 Not To Scale



DUCT SECTION DETAILS
Not To Scale

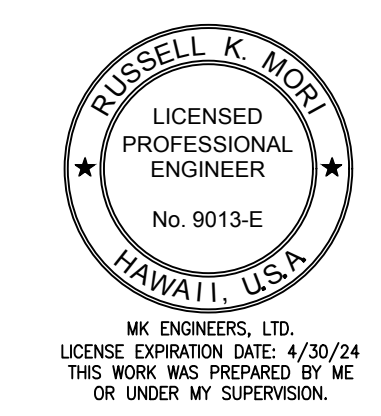

Russell K. Mori 10/31/23

STATE OF HAWAII
DEPARTMENT OF TRANSPORTATION
HIGHWAYS DIVISION

DUCT SECTION DETAILS

INTERSTATE ROUTE H-1 AND H-201
DESTINATION SIGN UPGRADE/REPLACEMENT, PHASE 3B
FAP NO. NH-0300(205)

Scale: As Noted Date: Oct. 2023

SHEET No. E5.1 OF 8 SHEETS

| | | |
|---------------|-------------------|------|
| ORIGINAL PLAN | SURVEY PLOTTED BY | DATE |
| NOTE BOOK | DRAWN BY | |
| No. | DESIGNED BY | |
| | QUANTITIES BY | |
| | CHECKED BY | |

DRAWING NAME: WA_01_PROJECTS\2023\23028_H1H20DESTSIGNUPGRD\01_DWG\23028_E5.1_DUCT.DWG PLOT TIME: 10-31-23, 10:09 AM)

| FED. ROAD DIST. NO. | STATE | FEDERAL AID PROJ. NO. | FISCAL YEAR | SHEET NO. | TOTAL SHEETS |
|---------------------|-------|-----------------------|-------------|-----------|--------------|
| HAWAII | HAW. | NH-0300(205) | 2024 | 196 | 197 |

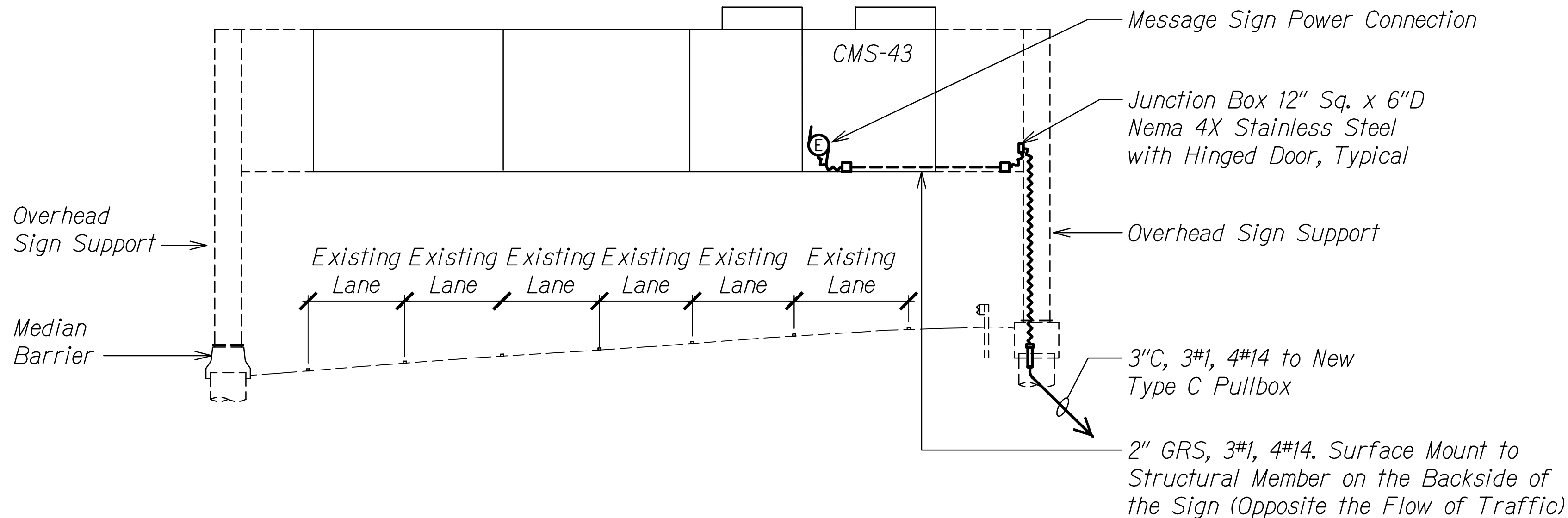

A SIGN STRUCTURE 78WB-853 (FACING DIRECTION OF TRAFFIC)
E5.2 | E5.2 Scale: 1" = 10'-0"

- Notes:
- See Sht. D-6 for Sign Panel Details.
 - See Sht. S7.1 for Structural Plans.

| | | |
|---------------|-------------------|------|
| ORIGINAL PLAN | SURVEY PLOTTED BY | DATE |
| NOTE BOOK | DRAWN BY | |
| No. | DESIGNED BY | |
| | CHECKED BY | |

DRAWING NAME: WA\01_PROJECTS\2023\23028_H1H20DESTSIGNUPGRD\01_DWG\23028_E5.2_DET_78WB-853.DWG PLOT TIME: 10-31-23, 10:13 AM

GRAPHIC SCALE:

0' 10' 20' 30'

1" = 10'-0"

Amul Bora 10/31/23

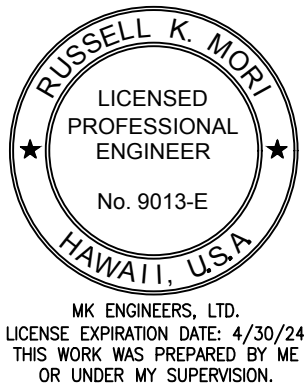

STATE OF HAWAII
DEPARTMENT OF TRANSPORTATION
HIGHWAYS DIVISION

SIGN STRUCTURE 78WB-853
ELECTRICAL DETAILS

INTERSTATE ROUTE H-1 AND H-201
DESTINATION SIGN UPGRADE/REPLACEMENT, PHASE 3B
FAP NO. NH-0300(205)

Scale: As Noted Date: Oct. 2023

SHEET No. E5.2 OF 8 SHEETS

| FED. ROAD DIST. NO. | STATE | FEDERAL AID PROJ. NO. | FISCAL YEAR | SHEET NO. | TOTAL SHEETS |
|---------------------|-------|-----------------------|-------------|-----------|--------------|
| HAWAII | HAW. | NH-0300(205) | 2024 | 197 | 197 |

HALAWA APPROACH

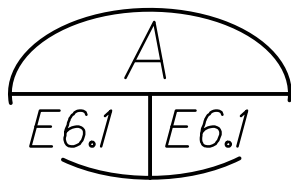
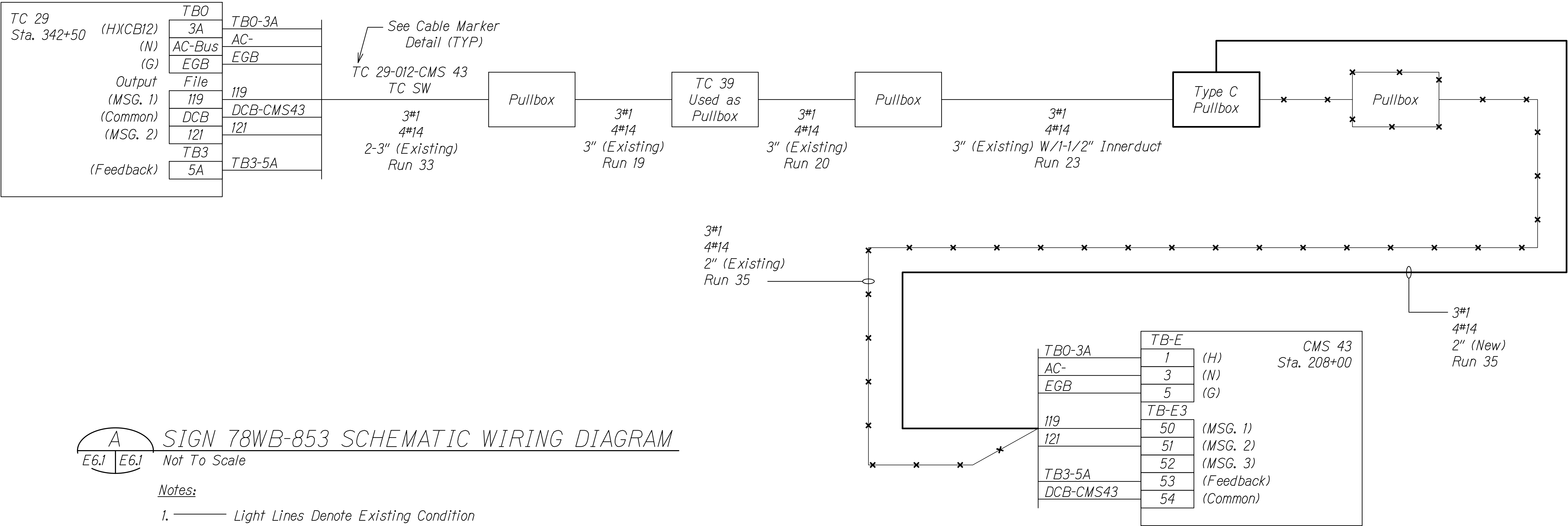

SIGN 78WB-853 SCHEMATIC WIRING DIAGRAM

Not To Scale

Notes:

- Light Lines Denote Existing Condition
Bold Lines Denote New Work
"X" Denotes Removal Work
- This Schematic Diagram is Based on Available Reference Drawings. Field Verify All Existing Conditions and Prepare an As-Built Drawing Prior to Start of Removal Work to Ensure the System is Put Back in its Operating Condition Prior to Start of Construction. Note Any Deficiencies on the As-Built Drawings.

| | | |
|---------------|-------------------|------|
| ORIGINAL PLAN | SURVEY PLOTTED BY | DATE |
| NOTE BOOK | DRAWN BY | |
| No. | DESIGNED BY | |
| | CHECKED BY | |

DRAWING NAME: WA\01_PROJECTS\2023\23028_H1H2DESIGNUPGRD\01_DWG\23028_E6.1_0LD.DWG PLOT TIME: 10-31-23, 10:10 AM

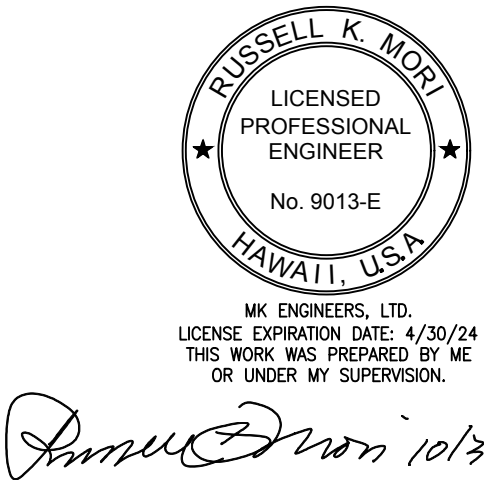

Date: 10/31/23

STATE OF HAWAII
DEPARTMENT OF TRANSPORTATION
HIGHWAYS DIVISION

SIGN STRUCTURE 78WB-853
ELECTRICAL DETAILS

INTERSTATE ROUTE H-1 AND H-201
DESTINATION SIGN UPGRADE/REPLACEMENT, PHASE 3B
FAP NO. NH-0300(205)

Scale: As Noted Date: Oct. 2023

SHEET No. E6.1 OF 8 SHEETS