

FED. ROAD DIST. NO.	STATE	PROJ. NO.	FISCAL YEAR	SHEET NO.	TOTAL SHEETS
HAWAII	HAW.	HWY-O-02-18M	2018	ADD. 31S-1	31

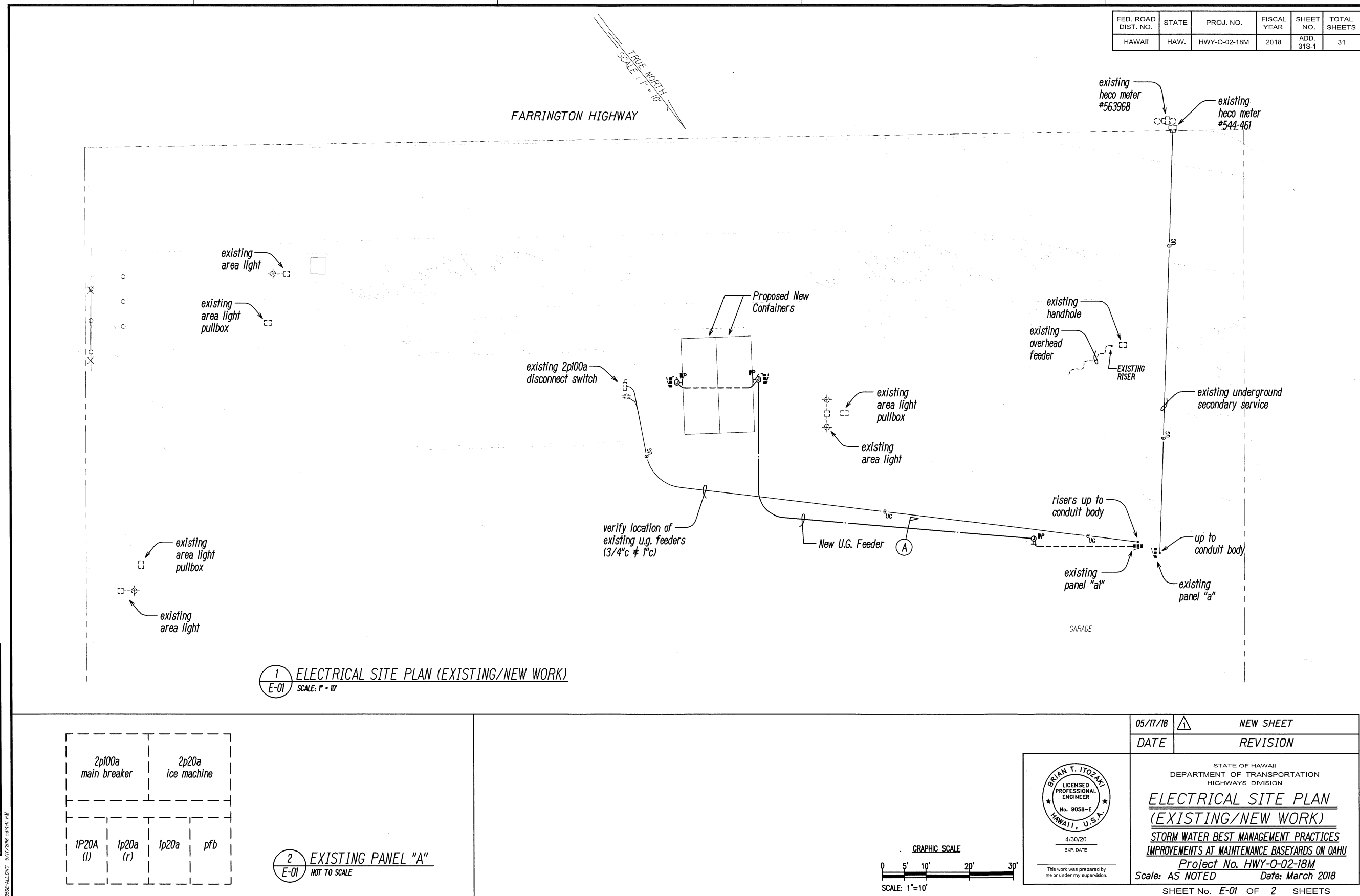

ORIGINAL PLAN	DATE
DRAWN BY	
DESIGNED BY	
QUANTITIES BY	
CHECKED BY	
No.	

356E-ALLING 5/17/2018 5:44:11 PM

ADD. 31S-1

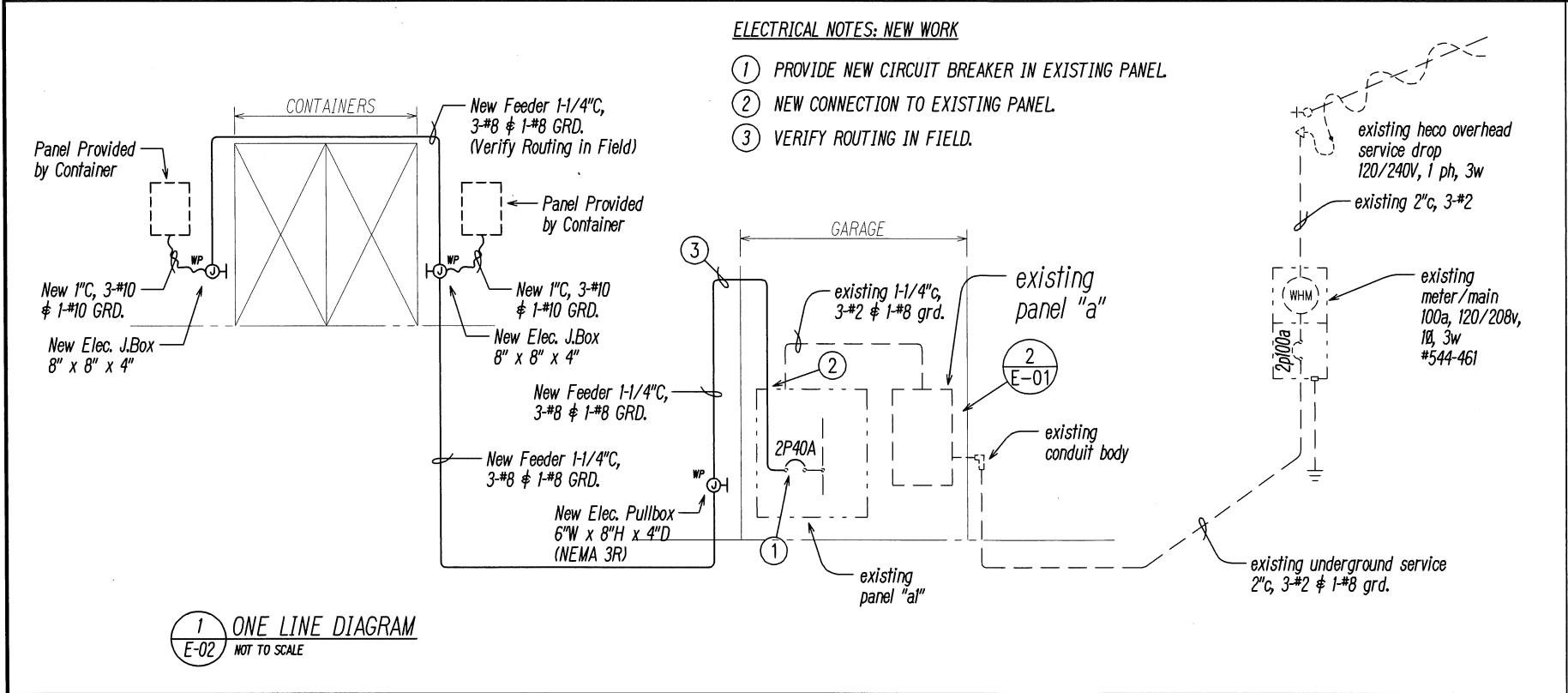

FED. ROAD DIST. NO.	STATE	PROJ. NO.	FISCAL YEAR	SHEET NO.	TOTAL SHEETS
HAWAII	HAW.	HWY-0-02-18M	2018	ADD. 31S-2	31

ELECTRICAL SYMBOL LIST		
EXISTING	NEW	DESCRIPTION
		AREA LIGHT, POLE MOUNTED WITH BRACKET ARM.
		JUNCTION BOX, WALL MOUNTED.
		RECEPTACLE, DUPLEX, WALL MOUNTED, 20A, 125V, NEMA 5-20.
		EQUIPMENT DISCONNECT SWITCH, HORSEPOWER RATED.
		ELECTRIC PANEL.
		RACEWAY, UNDERGROUND.
		EXPOSED RACEWAY.
		ELECTRICAL NOTE INDICATOR.
		DUCT SECTION INDICATOR.
		DETAIL INDICATOR UPPER HALF: DETAIL NUMBER. LOWER HALF: SHEET NUMBER, DETAIL LOCATION.
	WP	INDICATES WEATHERPROOF.

Notes:

1. All ducts shall be PVC Schedule 40.
2. Provide detectable duct warning tape 12" below finish grade or pavement directly above ducts.

General Electrical Notes:

1. Electrical contractor shall visit site and verify existing electrical installation and new design prior to bid.
2. Electrical contractor shall, at no additional cost to the state, disconnect and reconnect all existing electrical installations in conflict with new construction.
3. All existing electrical installations adjacent to the project area shall be maintained. disconnect and re-connect as required. Provide temporary connections as required.
4. Electrical contractor shall coordinate all his work with other trades.
5. Electrical contractor shall verify and confirm location of all wiring devices and lighting fixtures w/Civil prior to rough-in.
6. Circuit numbers indicated are for the purpose of circuit grouping and may not reflect actual panel circuit number assignment. Electrical contractor shall balance panel load and assign circuits accordingly. Provide new typewritten panel directory using room names and numbers.
7. Wire count in raceways not indicated. Electrical contractor shall provide number of wires as required in new raceways and additional wires as required in existing raceways.
8. Paint all exposed raceways and outlet boxes to match surrounding finish.
9. All multiwire branch circuits shall be in accordance with NEC Article 210.4. All circuits shall have individual neutrals.
10. Existing condition shown on drawings are taken from past design drawings and visual field investigation. Prior to start of construction, contractor shall field verify all existing conditions shown. Deviations shall be shown on As-Built drawings.
11. All new raceways in ceiling space shall be properly supported.
12. All new recessed light fixtures shall be supported from concrete slab with two 12 gage wires attached at opposing corners of the light fixture per IBC Section 1621.
13. all penetrations through fire rated walls and slabs shall be sealed to maintain the integrity of the fire rating using a U.L. Listed fire stopping system.
14. Refinish and patch to match all existing wall and ceiling surfaces damaged or scratched by electrical removal and installation work. New touch-up paint work shall blend into and match existing finish.
15. All new wires shall be # 12 awg, unless otherwise noted.
16. All feeder wiring shall include an insulated green grounding conductor sized per Table 250.122 of the National Electrical Code. This conductor shall be carried in all raceways and shall be attached to the panel ground bus.
17. The contractor shall provide and install all junction and pull boxes required for the installation of electrical devices and equipment, whether or not specifically indicated on the plans. Sizing of these boxes shall be per the National Electrical Code.
18. The term "wiring" shall include raceway, conductors, equipment, and wiring.
19. The term "provide" shall mean "Furnish and install".
20. All exterior raceways shall be galvanized rigid steel.

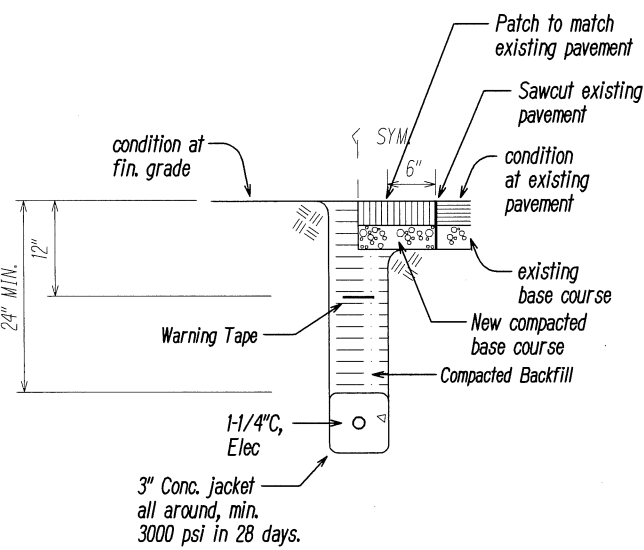

DUCT SECTION A

DATE	_____
SURVEY PLOTTED BY	_____
DRAWN BY	_____
CHECKED BY	_____
NOTE BOOK	_____
QUANTITIES BY	_____
CHECKED BY	_____
NO.	_____

05/17/18	NEW SHEET
DATE	REVISION

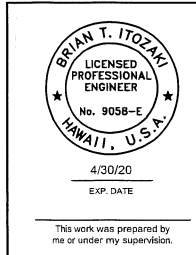

STATE OF HAWAII
DEPARTMENT OF TRANSPORTATION
HIGHWAYS DIVISION

**MISCELLANEOUS
ELECTRICAL DETAILS**

STORM WATER BEST MANAGEMENT PRACTICES
IMPROVEMENTS AT MAINTENANCE BASEYARDS ON OAHU

Project No. HWY-0-02-18M
Scale: AS NOTED Date: March 2018