

FED. ROAD DIST. NO.	STATE	PROJ. NO.	FISCAL YEAR	SHEET NO.	TOTAL SHEETS
HAWAII	HAW.	HWY-0-02-11R	2014	40	43

TRUE NORTH
Scale: 1" = 40'

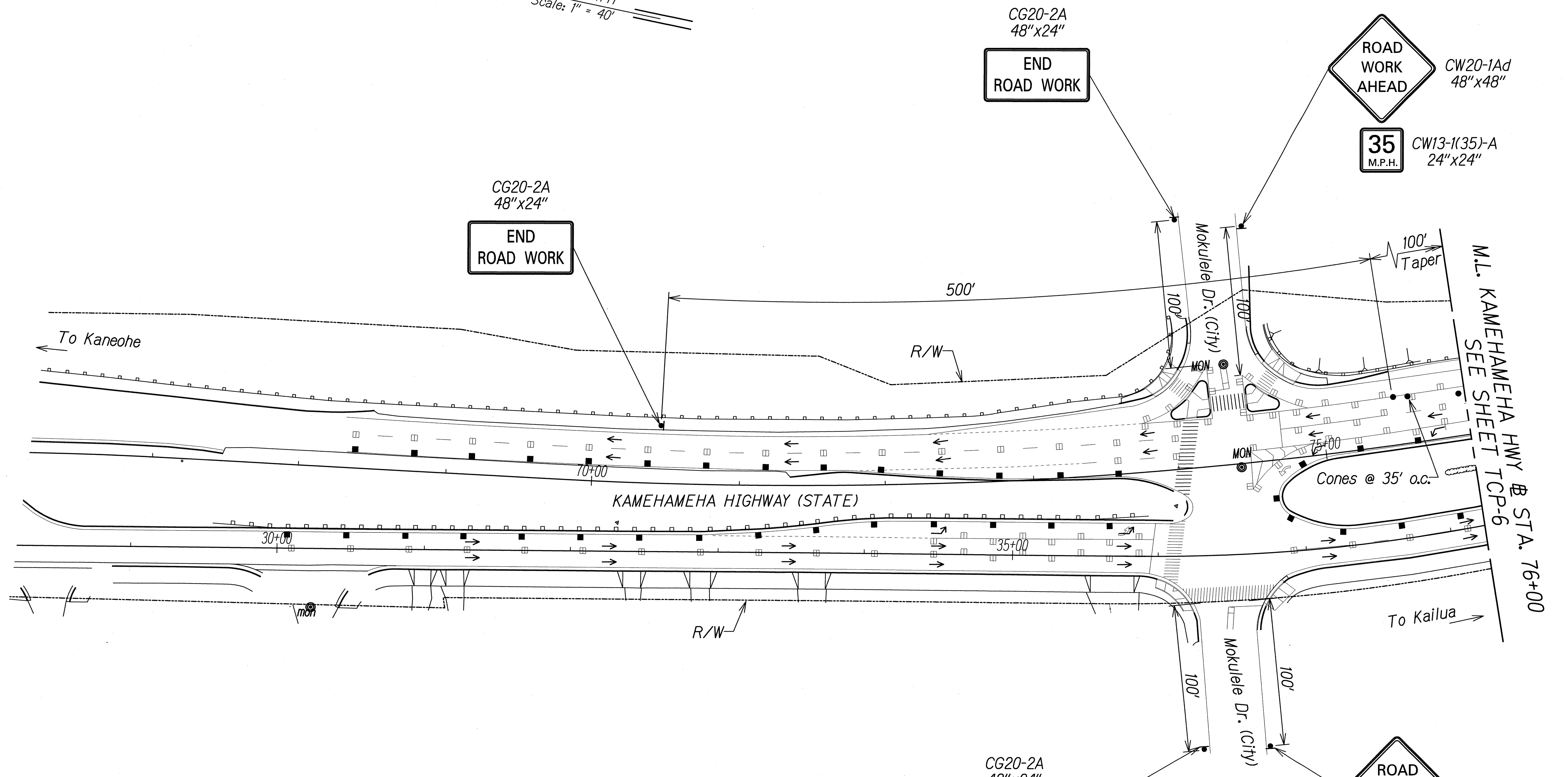

Note:
Contractor shall coordinate
with private property owner
prior to placement of Traffic
Controls within Private Property.

DATE	
SURVEY PLOTTED BY	
DRAWN BY	
TRACED BY	
QUANTITIES BY	
CHECKED BY	
ORIGINAL PLAN	
NOTE BOOK	
N ^o .	

T:\16523A-Permanent-BMP-Cadd\Sheets\Traffic Control\TCP-01-Kam Hwy.dgn

THIS WORK WAS PREPARED BY ME
OR UNDER MY SUPERVISION.

Gerald D. Andrade 04/30/14
SIGNATURE EXPIRATION DATE OF THE LICENSE

STATE OF HAWAII
DEPARTMENT OF TRANSPORTATION
HIGHWAYS DIVISION

TRAFFIC CONTROL PLAN
KAMEHAMEHA HIGHWAY
MISCELLANEOUS PERMANENT BEST
MANAGEMENT PRACTICES ON OAHU
PROJECT NO. HWY-0-02-11R
Scale: 1"=40' Date: April, 2014

FED. ROAD DIST. NO.	STATE	PROJ. NO.	FISCAL YEAR	SHEET NO.	TOTAL SHEETS
HAWAII	HAW.	HWY-0-02-11R	2014	41	43

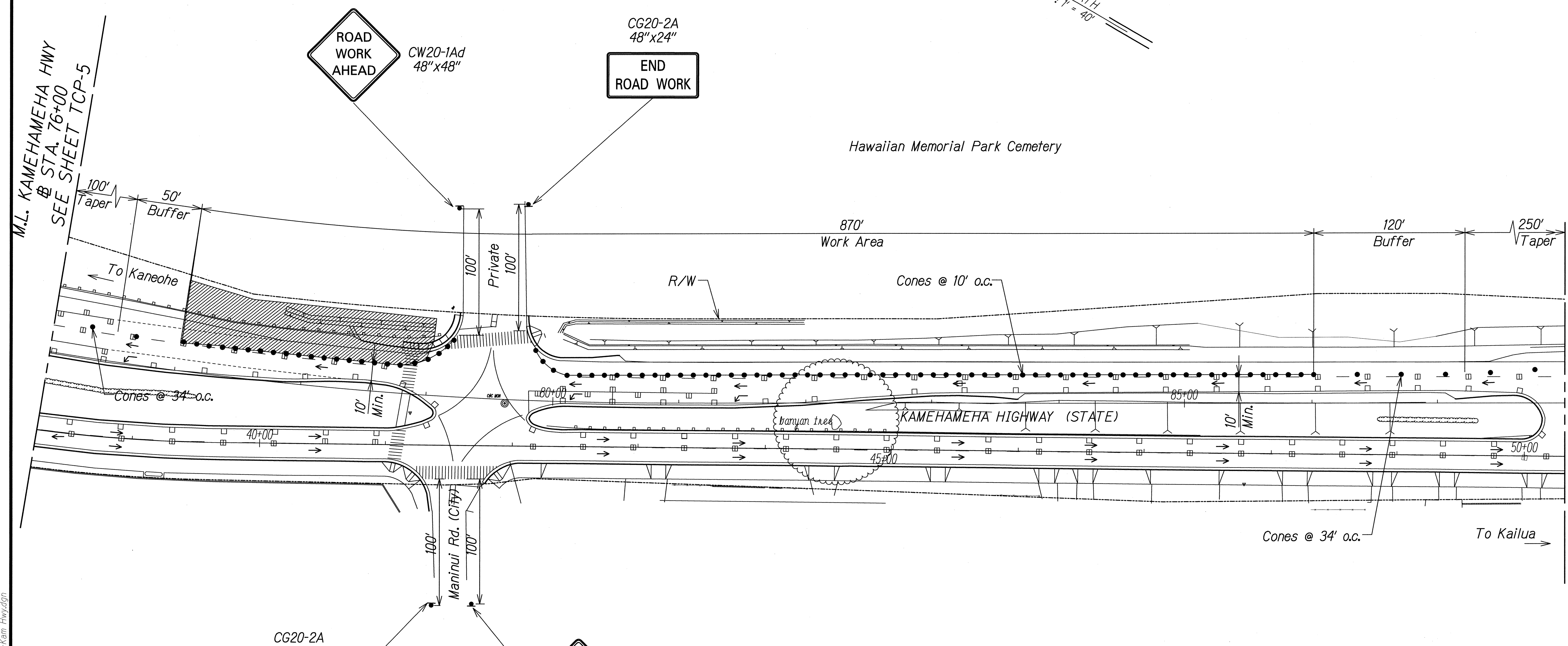
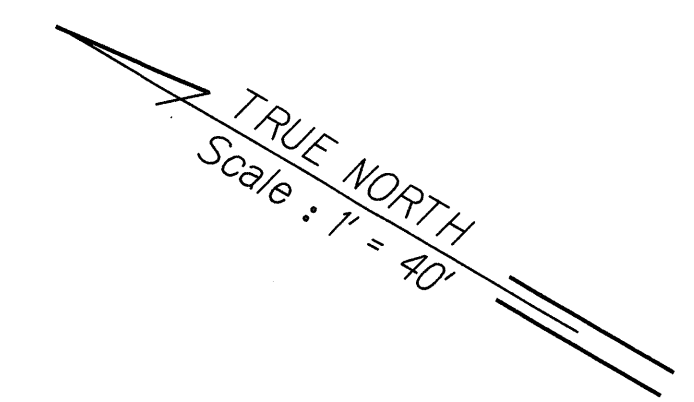

Note:
Contractor shall coordinate with private property owner prior to placement of Traffic Controls within Private Property.

DATE	_____
SURVEY PLOTTED BY	_____
DRAWN BY	_____
TRACED BY	_____
QUANTITIES BY	_____
CHECKED BY	_____
ORIGINAL PLAN	_____
NOTE BOOK	_____
N.	_____

T:\16523A-Permanent_BMP\Cadd\Sheets\Traffic Control\TCP-02-Kam Hwy.dgn

THIS WORK WAS PREPARED BY ME OR UNDER MY SUPERVISION.

Gerald D. Andrade
SIGNATURE

04/30/14
EXPIRATION DATE OF THE LICENSE

STATE OF HAWAII
DEPARTMENT OF TRANSPORTATION
HIGHWAYS DIVISION

TRAFFIC CONTROL PLAN
KAMEHAMEHA HIGHWAY
MISCELLANEOUS PERMANENT BEST
MANAGEMENT PRACTICES ON OAHU
PROJECT NO. HWY-0-02-11R
Scale: 1"=40' Date: April, 2014

SHEET No. TCP-6 OF 8 SHEETS

FED. ROAD DIST. NO.	STATE	PROJ. NO.	FISCAL YEAR	SHEET NO.	TOTAL SHEETS
HAWAII	HAW.	HWY-0-02-11R	2014	42	43

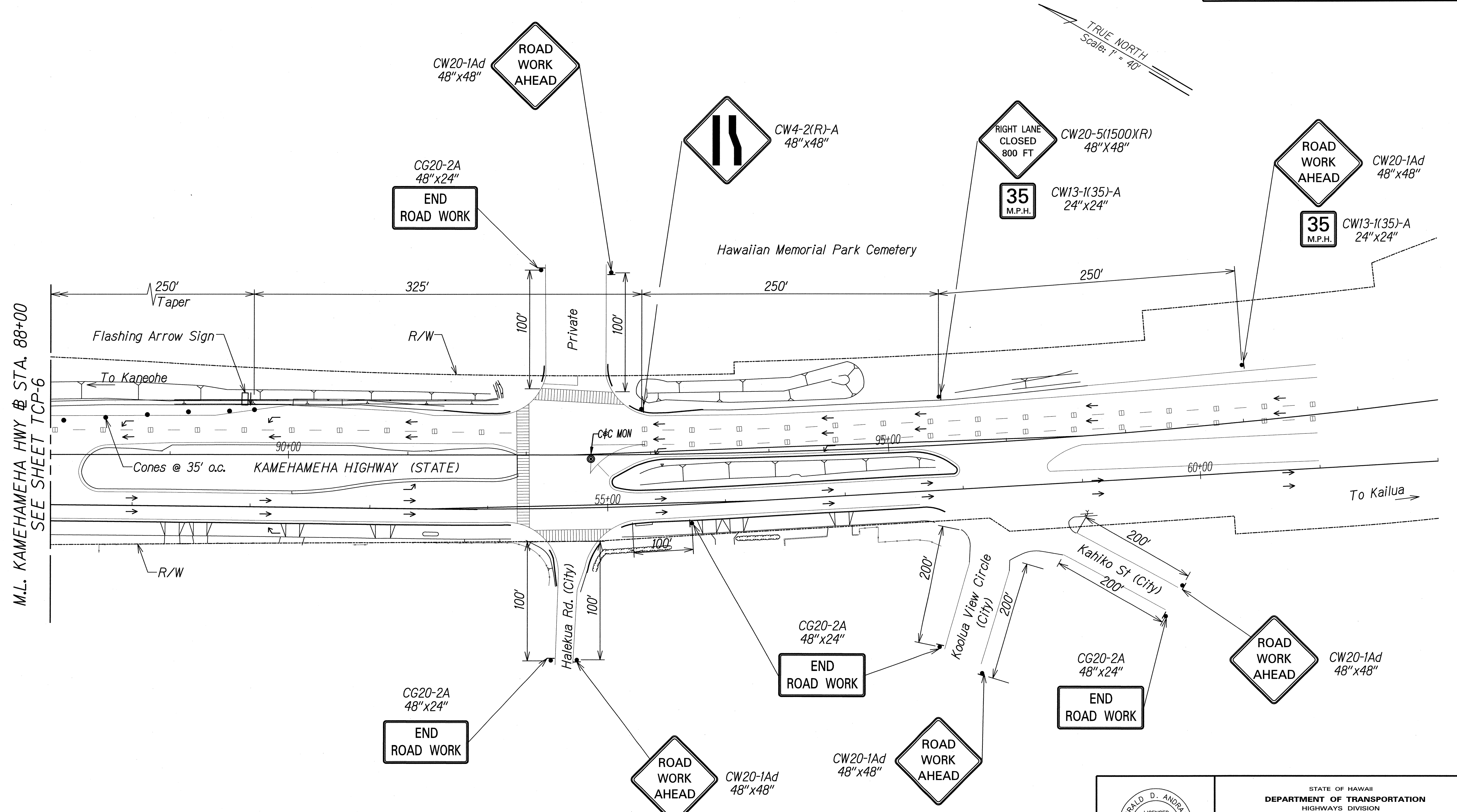

Note:
Contractor shall coordinate with private property owner prior to placement of Traffic Controls within Private Property.

ORIGINAL PLAN	DATE
NO. _____	_____
BY _____	_____
DATE _____	_____
BY _____	_____
DATE _____	_____

T:\16523A-Permanent_BWP\Cadd\Sheets\Traffic Control\TCP-03-Kam Hwy.dgn

GERALD D. ANDRADE
LICENSED PROFESSIONAL ENGINEER
No. 10377-C
HAWAII, U.S.A.

THIS WORK WAS PREPARED BY ME OR UNDER MY SUPERVISION.

Signature: *Gerald D. Andrade*
Date: 04/30/14
Expiration Date of License

STATE OF HAWAII
DEPARTMENT OF TRANSPORTATION
HIGHWAYS DIVISION

TRAFFIC CONTROL PLAN
KAMEHAMEHA HIGHWAY

MISCELLANEOUS PERMANENT BEST MANAGEMENT PRACTICES ON OAHU

PROJECT NO. HWY-0-02-11R
Scale: 1"=40' Date: April, 2014