

FED. ROAD DIST. NO.	STATE	PROJ. NO.	FISCAL YEAR	SHEET NO.	TOTAL SHEETS
HAWAII	HAW.	HWY-0-03-05M	2007	4	36

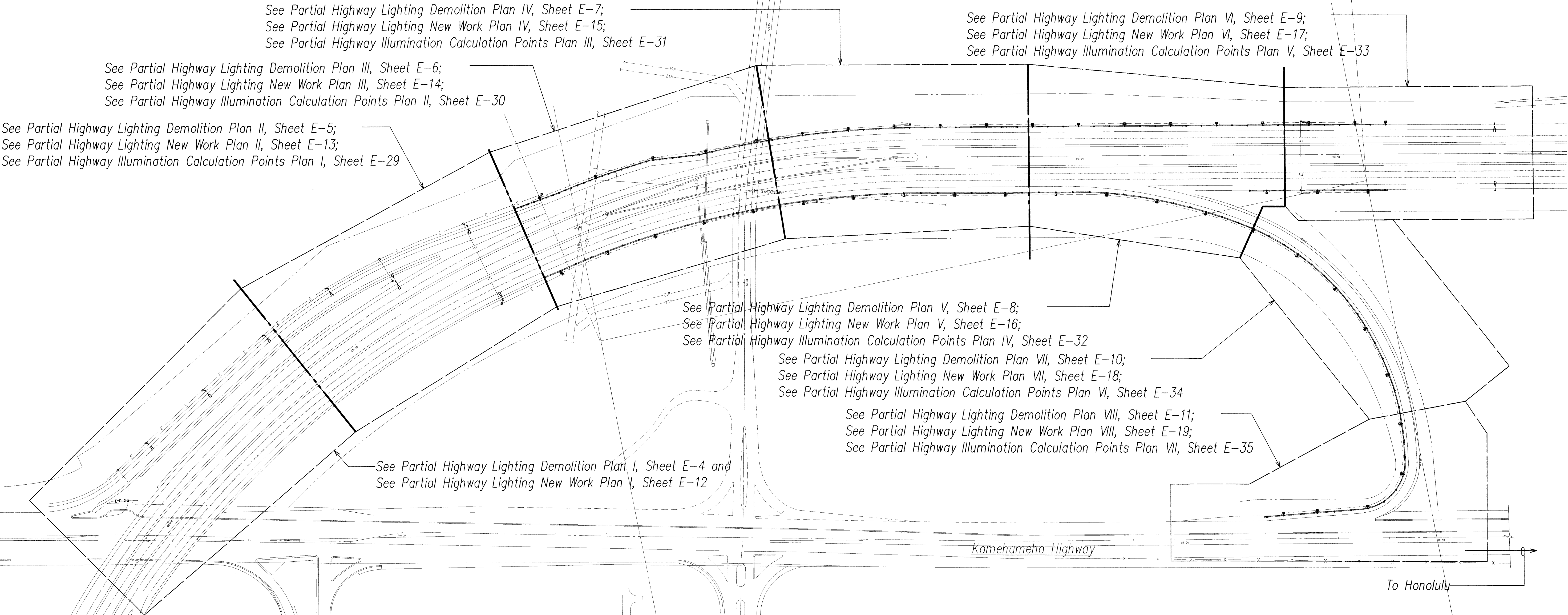

SURVEY PLOTTED BY	DATE
DRAWN BY	
DESIGNED BY	
CHECKED BY	
NOTE BOOK	
No.	

LAST SAVE: 06/01/07 @ 05:42:31 BY: AM PLOT 02 1=100  
Z:\ACAD PROJECTS\24056A\24056A.dwg; 24056A-overall.thm plan 0REFS: X12-REV \_24056A-WAHIAWINTERCHANGE \_24056A-ALL-ELEC

# **OVERALL ELECTRICAL SITE PLAN** SCALE: 1"=100'

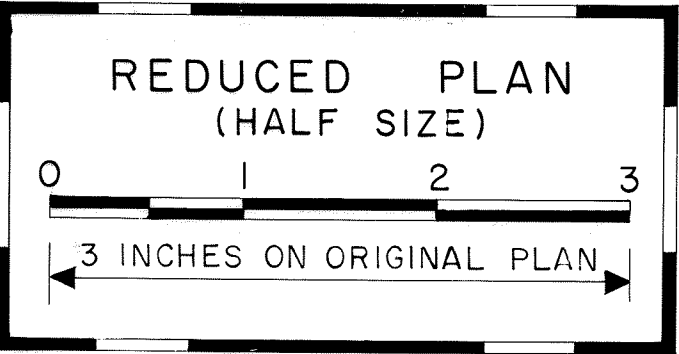
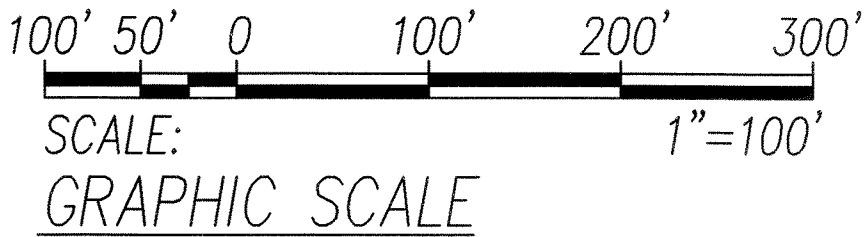
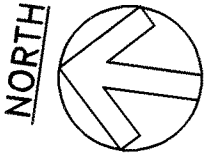

RONALD N. S. HO & ASSOCIATES, INC.  
Electrical Engineers

06.07.07  
*Andrew I. Miyasato*  
THIS WORK WAS PREPARED BY  
ME OR UNDER MY SUPERVISION  
04.30.2008  
EXPIRATION DATE OF THE LICENSE

STATE OF HAWAII  
DEPARTMENT OF TRANSPORTATION  
HIGHWAYS DIVISION  
**OVERALL ELECTRICAL SITE PLAN**  
  
H-2 RAIL LIGHT REPLACEMENT,  
VICINITY OF WAHIAWA OFF RAMP  
  
Project No. HWY-0-03-05M  
Scale: AS NOTED Date: JUNE 2007  
**SHEET No. E-3 OF 35 SHEETS**

4