

| FED. ROAD DIST. NO. | STATE | PROJ. NO. | FISCAL YEAR | SHEET NO. | TOTAL SHEETS |
|---------------------|-------|--------------|-------------|-----------|--------------|
| HAWAII | HAW. | HWY-0-03-05M | 2007 | 5 | 36 |

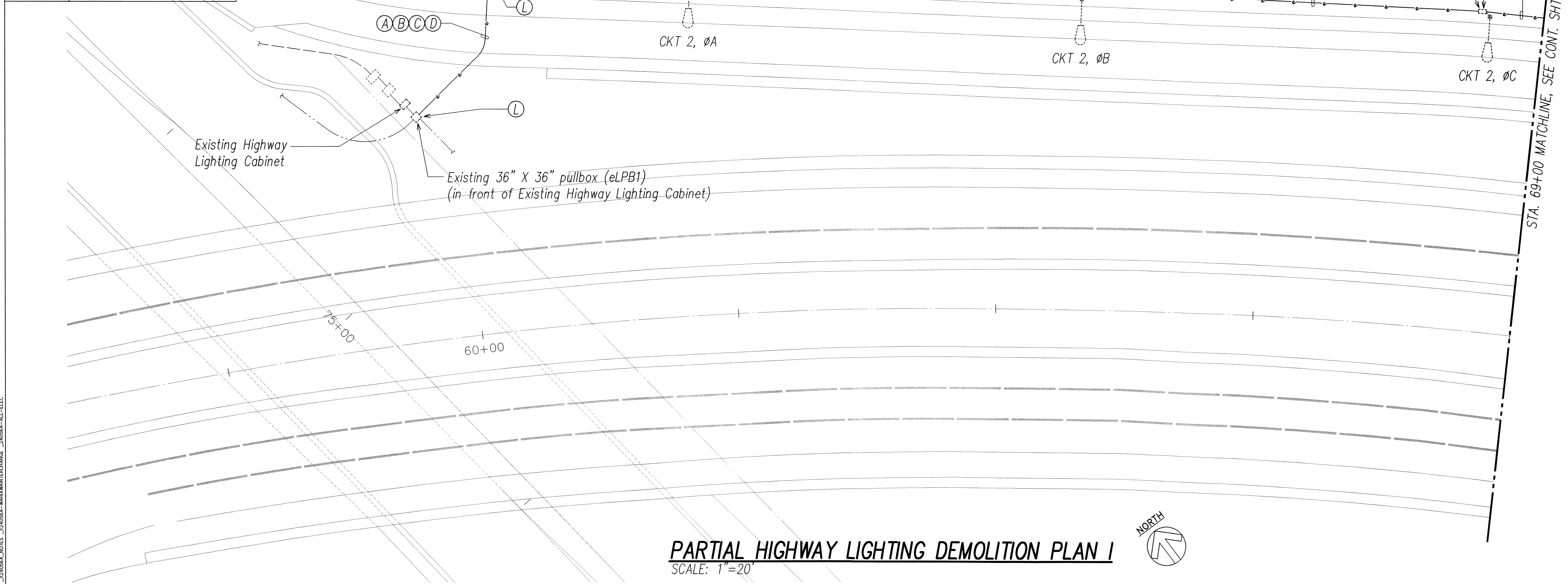
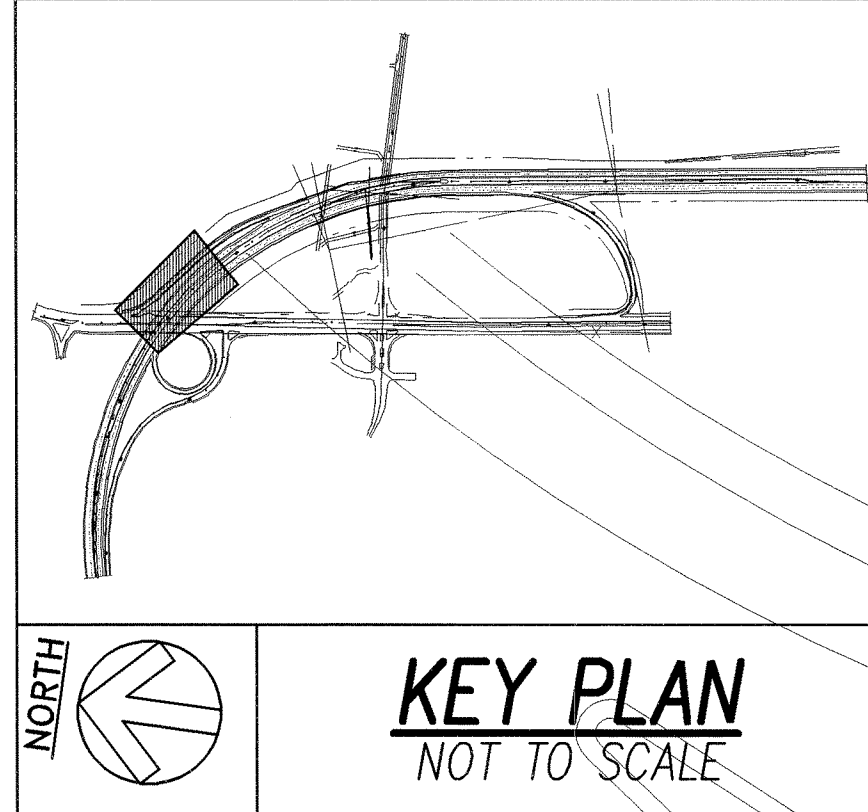

PARTIAL HIGHWAY LIGHTING DEMOLITION PLAN I
SCALE: 1"=20'

DEMOLITION PLAN NOTES

- (A) Existing Circuit No. 1: 2" Conduit with 4#4, 1#8 Ground; Remove Conductors and Reuse Conduit.
- (B) Existing Circuit No. 2: 2" Conduit, 4#4, 1#8 Ground; Remove Conductors and Reuse Conduit.
- (C) Existing Circuit No. 4: 2" Conduit, 3#8, 1#8 Ground.
- (D) Existing Spare 2" Conduit.
- (E) Existing Circuit No. 3: 2" Conduit, 4#8, 1#8 Ground.
- (F) Existing Circuit No. 1: 2" Conduit, 4#4, 1#8 Ground; Remove Conductors and Abandon Conduit in Place.
- (G) Existing Circuit No. 2: 2" Conduit, 4#4, 1#8 Ground; Remove Conductors and Abandon Conduit in Place.
- (H) Existing Junction Box, Flush Mounted in Existing Concrete Barrier; Remove Conductors and Abandon Junction Box in Place.
- (I) Remove Existing Barrier Top Mounted Continuous Row Fluorescent Light Fixtures and All Associated Mounting Hardware; Patch Existing Concrete Barrier with Epoxy Grout, Flush with Existing Finish.
- (J) Existing Circuit to Existing Highway Sign Light to Remain and be Disconnected from Existing Circuit Conductors to Maintain Existing Circuit Continuity.
- (K) Existing Highway Lighting Concrete Pullbox to be Abandoned in Place.
- (L) Existing Highway Lighting Concrete Pullbox to Remain and be Reused.

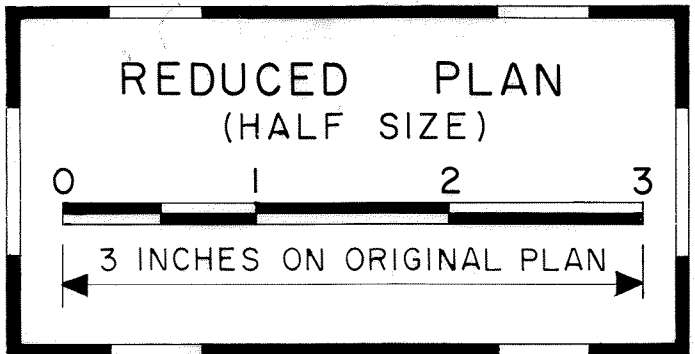

RONALD N. S. HO & ASSOCIATES, INC.
Electrical Engineers
ANDREW L. HARRIS
LICENSED PROFESSIONAL ENGINEER
No. 4340-E
HAWAII, U.S.A.
06.09.07
THIS WORK WAS PREPARED BY ME OR UNDER MY SUPERVISION
04.30.2008
EXPIRATION DATE OF THE LICENSE

STATE OF HAWAII
DEPARTMENT OF TRANSPORTATION
HIGHWAYS DIVISION
PARTIAL HIGHWAY LIGHTING DEMOLITION PLAN I
H-2 RAIL LIGHT REPLACEMENT
VICINITY OF WAHIAWA OFF RAMP
Project No. HWY-0-03-05M
Scale: AS NOTED Date: JUNE 2007
SHEET No. E-4 OF 35 SHEETS

| | |
|-------------------|------|
| SURVEY PLOTTED BY | DATE |
| DRAWN BY | " |
| DESIGNED BY | " |
| CHECKED BY | " |
| NOTE BOOK | " |
| No. | " |

LAST SAVE: 06/02/07 @ 08:52:44 BY: AM PLOT 02:14:00
Z:\ACAD\PROJECTS\24056A\24056A.dwg I:\REFS: 24056A-KEYPLAN 24056A-NOTES 24056A-WAHIAWAINTERCHANGE 24056A-ALL-ELEC

| FED. ROAD DIST. NO. | STATE | PROJ. NO. | FISCAL YEAR | SHEET NO. | TOTAL SHEETS |
|------------------------|-------|--------------|----------------|--------------|-----------------|
| HAWAII | HAW. | HWY-0-03-05M | 2007 | 6 | 36 |

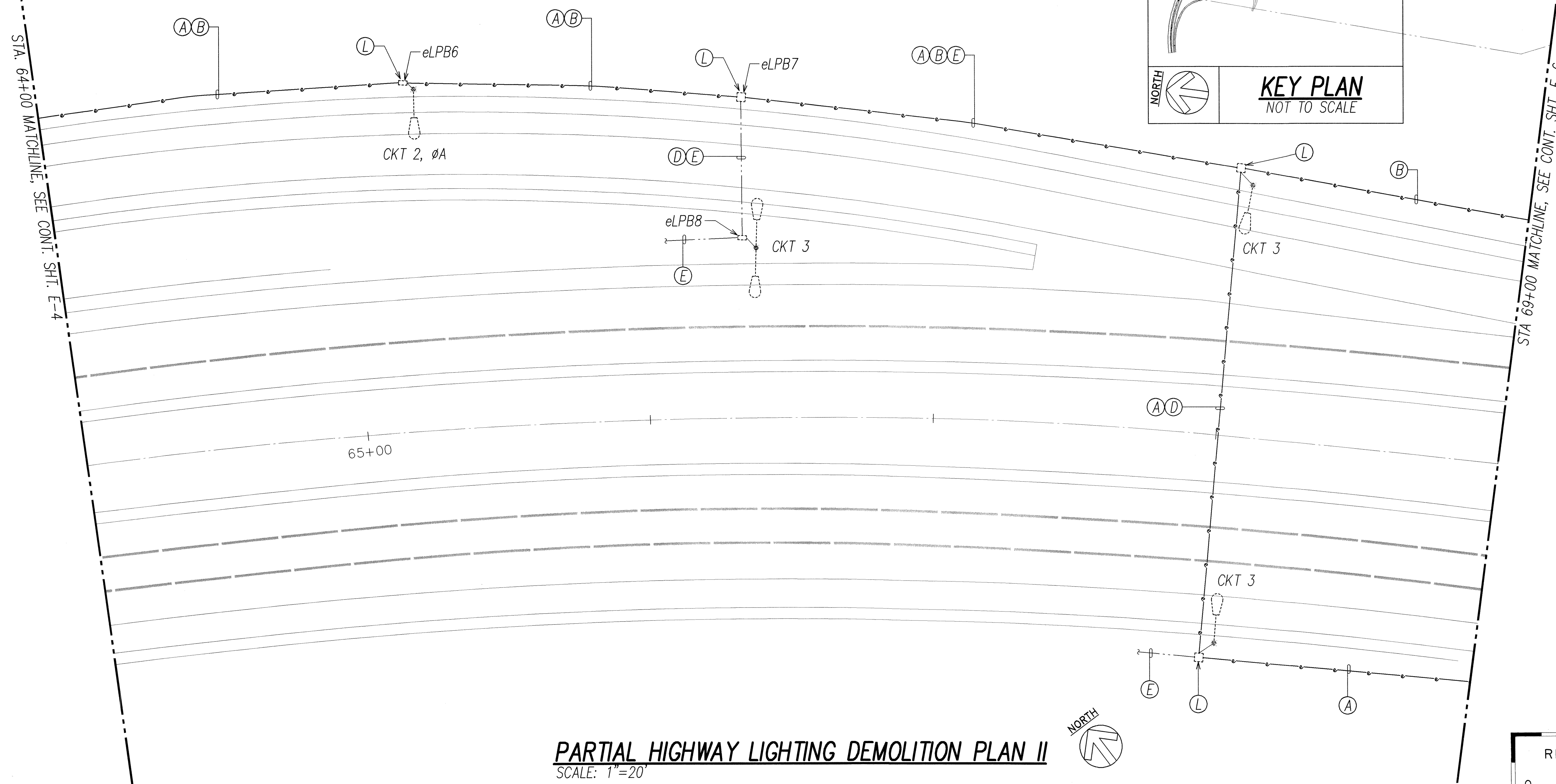
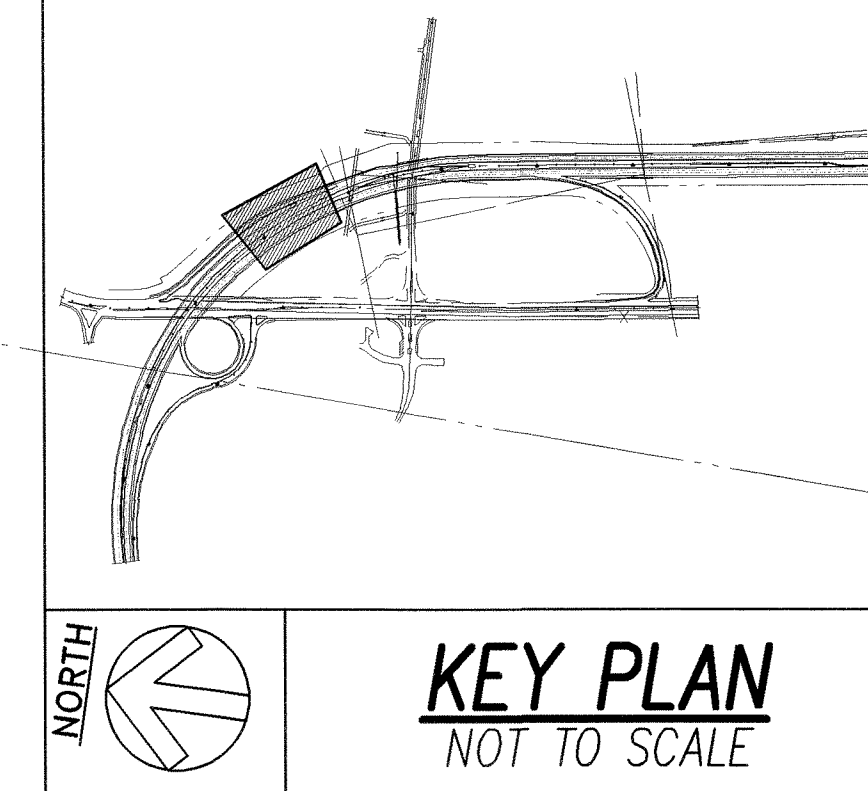

REDUCED PLAN
(HALF SIZE)

0 1 2 3

3 INCHES ON ORIGINAL PLAN

RONALD N. S. HO & ASSOCIATES, INC.
Electrical Engineers

ANDREW L. MIYASATO
★ LICENSED PROFESSIONAL ENGINEER ★
No. 4340-E
HAWAII, U.S.A.

06.09.01
Andrew L. Miyasato

THIS WORK WAS PREPARED BY
ME OR UNDER MY SUPERVISION

04.30.2008

EXPIRATION DATE OF THE LICENSE

STATE OF HAWAII
DEPARTMENT OF TRANSPORTATION
HIGHWAYS DIVISION

PARTIAL HIGHWAY LIGHTING
DEMOLITION PLAN II
H-2 RAIL LIGHT REPLACEMENT,
VICINITY OF WAHIAWA OFF RAMP

| | | | | |
|----------------------------|--|--|-----------------|--|
| Project No. HWY-0-03-05M | | | | |
| Scale: AS NOTED | | | Date: JUNE 2007 | |
| SHEET No. E-5 OF 35 SHEETS | | | | |

| FED. ROAD DIST. NO. | STATE | PROJ. NO. | FISCAL YEAR | SHEET NO. | TOTAL SHEETS |
|---------------------|-------|--------------|-------------|-----------|--------------|
| HAWAII | HAW. | HWY-0-03-05M | 2007 | 7 | 36 |

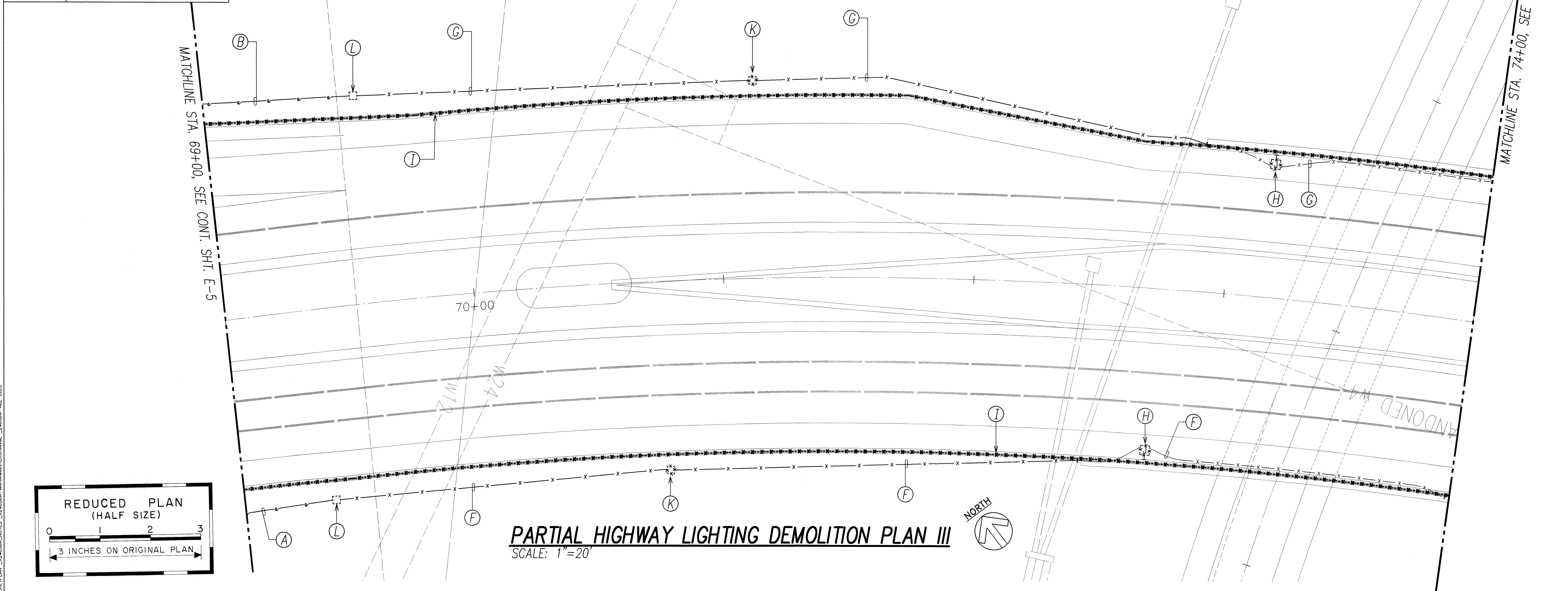
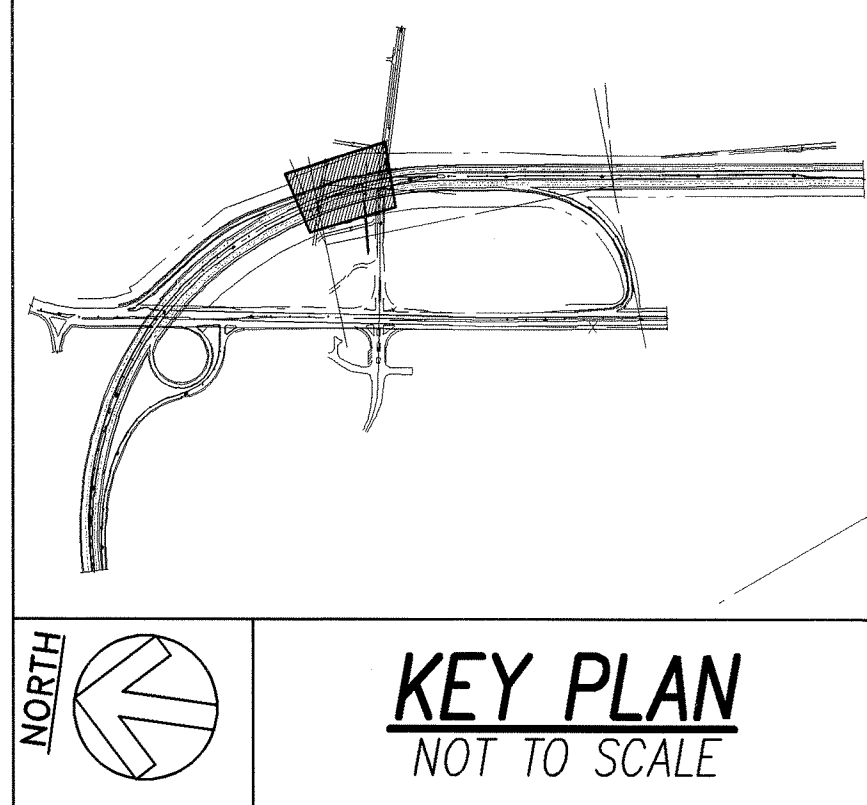

PARTIAL HIGHWAY LIGHTING DEMOLITION PLAN III
SCALE: 1"=20'

DEMOLITION PLAN NOTES

- (A) Existing Circuit No. 1: 2" Conduit with 4#4, 1#8 Ground; Remove Conductors and Reuse Conduit.
- (B) Existing Circuit No. 2: 2" Conduit, 4#4, 1#8 Ground; Remove Conductors and Reuse Conduit.
- (C) Existing Circuit No. 4: 2" Conduit, 3#8, 1#8 Ground.
- (D) Existing Spare 2" Conduit.
- (E) Existing Circuit No. 3: 2" Conduit, 4#8, 1#8 Ground.
- (F) Existing Circuit No. 1: 2" Conduit, 4#4, 1#8 Ground; Remove Conductors and Abandon Conduit in Place.
- (G) Existing Circuit No. 2: 2" Conduit, 4#4, 1#8 Ground; Remove Conductors and Abandon Conduit in Place.
- (H) Existing Junction Box, Flush Mounted in Existing Concrete Barrier; Remove Conductors and Abandon Junction Box in Place.
- (I) Remove Existing Barrier Top Mounted Continuous Row Fluorescent Light Fixtures and All Associated Mounting Hardware; Patch Existing Concrete Barrier with Epoxy Grout, Flush with Existing Finish.
- (J) Existing Circuit to Existing Highway Sign Light to Remain and be Disconnected from Existing Circuit Conductors to Maintain Existing Circuit Continuity.
- (K) Existing Highway Lighting Concrete Pullbox to be Abandoned in Place.
- (L) Existing Highway Lighting Concrete Pullbox to Remain and be Reused.

| | |
|-------------------|------|
| SURVEY PLOTTED BY | DATE |
| DRAWN BY | |
| CHECKED BY | |
| DESIGNED BY | |
| QUANTITIES BY | |
| CHECKED BY | |
| No. | |

LAST SAVE: 06/09/07 @ 06:53:10 PM PLOT 05 1-20
Z:\ACAD\PROJECTS\24056A\008_24056A.dwg
XREFS: X102-REV_X24056A_KEYPLAN_X24056A_NOTES_X24056A-WAHIAWAINTERCHANGE_24056A-ALL-ELEC

RONALD N. S. HO & ASSOCIATES, INC.
Electrical Engineers

ANDREW I. MIYASATO
LICENSED PROFESSIONAL ENGINEER
No. 4340-E
HAWAII, U.S.A.

06-09-07
Andrew I. Miyasato

THIS WORK WAS PREPARED BY ME OR UNDER MY SUPERVISION
04.30.2008
EXPIRATION DATE OF THE LICENSE

STATE OF HAWAII
DEPARTMENT OF TRANSPORTATION
HIGHWAYS DIVISION

**PARTIAL HIGHWAY LIGHTING
DEMOLITION PLAN III**

H-2 RAIL LIGHT REPLACEMENT
VICINITY OF WAHIAWA OFF RAMP

Project No. HWY-0-03-05M
Scale: AS NOTED Date: JUNE 2007

SHEET No. E-6 OF 35 SHEETS

| FED. ROAD DIST. NO. | STATE | PROJ. NO. | FISCAL YEAR | SHEET NO. | TOTAL SHEETS |
|---------------------|-------|--------------|-------------|-----------|--------------|
| HAWAII | HAW. | HWY-0-03-05M | 2007 | 9 | 36 |

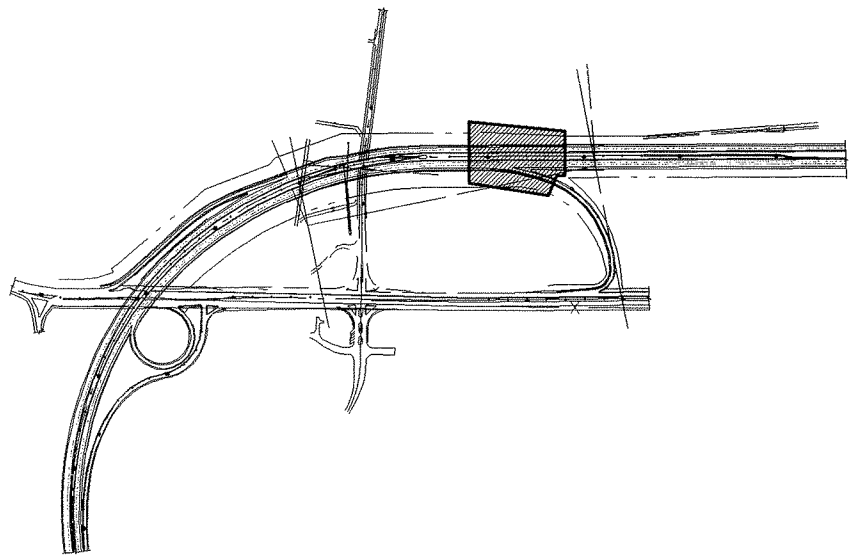

KEY PLAN
NOT TO SCALE

MATCHLINE STA. 79+00, SEE CONT. SHT. E-7

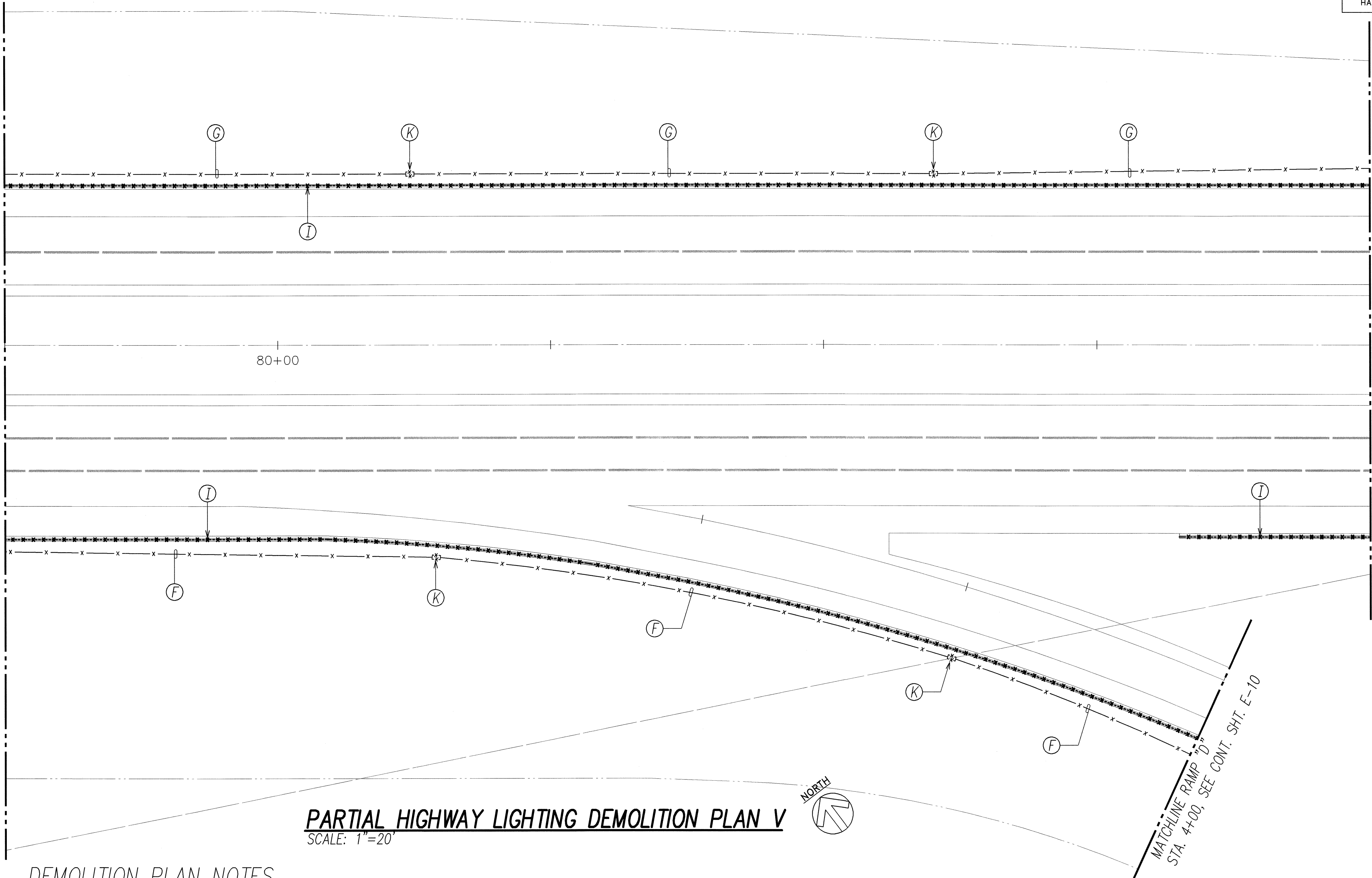

PARTIAL HIGHWAY LIGHTING DEMOLITION PLAN V

SCALE: 1"=20'

DEMOLITION PLAN NOTES

- (A) Existing Circuit No. 1: 2" Conduit with 4#4, 1#8 Ground; Remove Conductors and Reuse Conduit.
- (B) Existing Circuit No. 2: 2" Conduit, 4#4, 1#8 Ground; Remove Conductors and Reuse Conduit.
- (C) Existing Circuit No. 4: 2" Conduit, 3#8, 1#8 Ground.
- (D) Existing Spare 2" Conduit.
- (E) Existing Circuit No. 3: 2" Conduit, 4#8, 1#8 Ground.
- (F) Existing Circuit No. 1: 2" Conduit, 4#4, 1#8 Ground; Remove Conductors and Abandon Conduit in Place.
- (G) Existing Circuit No. 2: 2" Conduit, 4#4, 1#8 Ground; Remove Conductors and Abandon Conduit in Place.
- (H) Existing Junction Box, Flush Mounted in Existing Concrete Barrier; Remove Conductors and Abandon Junction Box in Place.
- (I) Remove Existing Barrier Top Mounted Continuous Row Fluorescent Light Fixtures and All Associated Mounting Hardware; Patch Existing Concrete Barrier with Epoxy Grout, Flush with Existing Finish.
- (J) Existing Circuit to Existing Highway Sign Light to Remain and be Disconnected from Existing Circuit Conductors to Maintain Existing Circuit Continuity.
- (K) Existing Highway Lighting Concrete Pullbox to be Abandoned in Place.
- (L) Existing Highway Lighting Concrete Pullbox to Remain and be Reused.

| ORIGINAL PLAN | DATE |
|-------------------|------|
| SURVEY PLOTTED BY | |
| DRAWN BY | |
| CHECKED BY | |
| DESIGNED BY | |
| QUANTITIES BY | |
| CHECKED BY | |
| No. | |

LAST SAVE: 06/03/07 @ 06:53:45 PM. PLOT TO: 1-20
Z:\ACAD\PROJECTS\24056A\24056A.dwg V:\REFS: X12-REV _X24056A_KEYPLAN _X24056A_NOTES _X24056A-WAHIAWATERCHANGE _24056A-ALL-ELEC

RONALD N. S. HO & ASSOCIATES, INC.
Electrical Engineers
ANDREW I. MIYASATO
LICENSED PROFESSIONAL ENGINEER
No. 4340-E
HAWAII, U.S.A.
06.03.07
THIS WORK WAS PREPARED BY ME OR UNDER MY SUPERVISION
04.30.2008
EXPIRATION DATE OF THE LICENSE

STATE OF HAWAII
DEPARTMENT OF TRANSPORTATION
HIGHWAYS DIVISION
PARTIAL HIGHWAY LIGHTING DEMOLITION PLAN V
H-2 RAIL LIGHT REPLACEMENT
VICINITY OF WAHIAWA OFF RAMP
Project No. HWY-0-03-05M
Scale: AS NOTED Date: JUNE 2007
SHEET No. E-8 OF 35 SHEETS

| FED. ROAD DIST. NO. | STATE | PROJ. NO. | FISCAL YEAR | SHEET NO. | TOTAL SHEETS |
|---------------------|-------|--------------|-------------|-----------|--------------|
| HAWAII | HAW. | HWY-0-03-05M | 2007 | 10 | 36 |

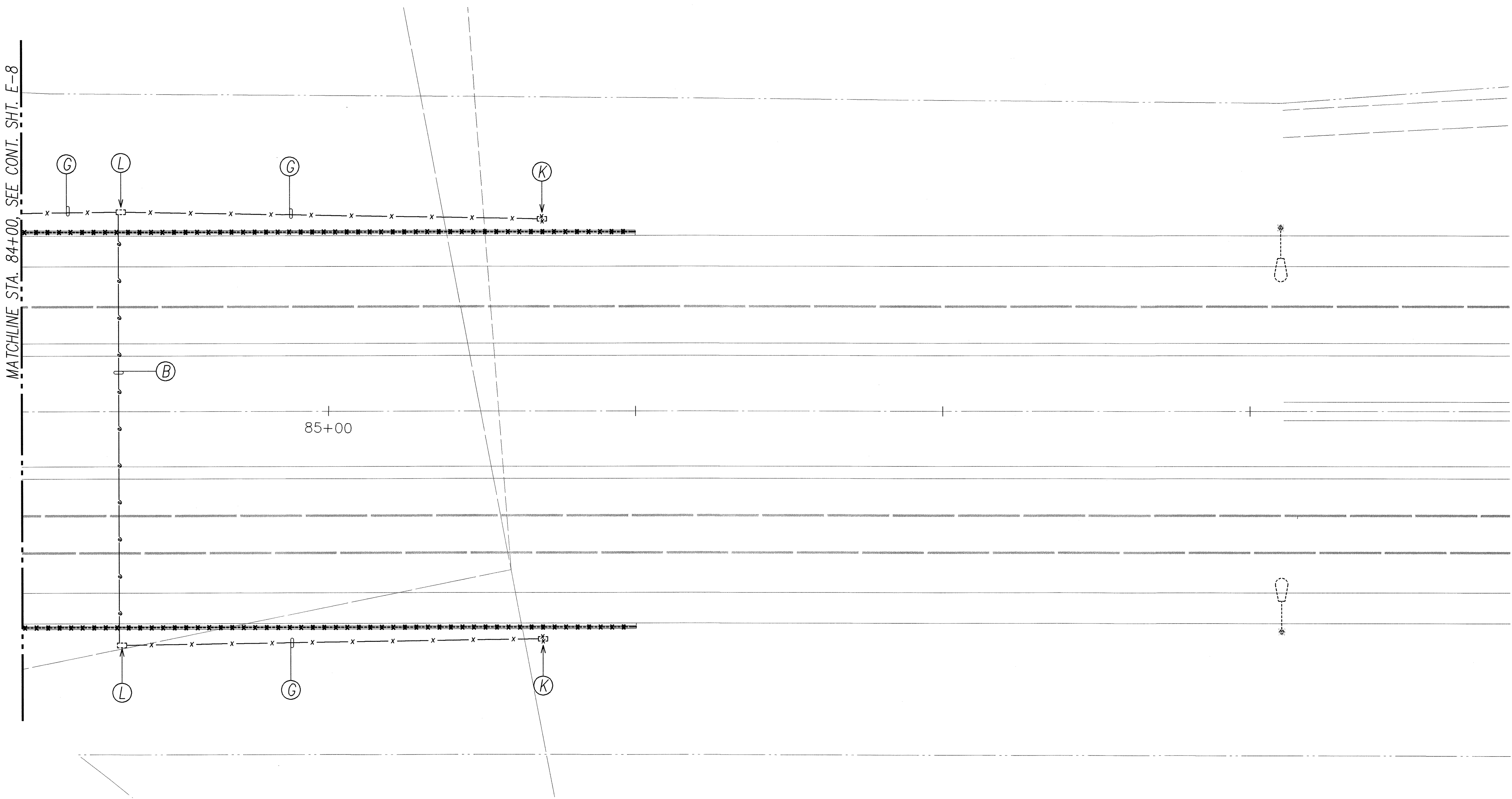
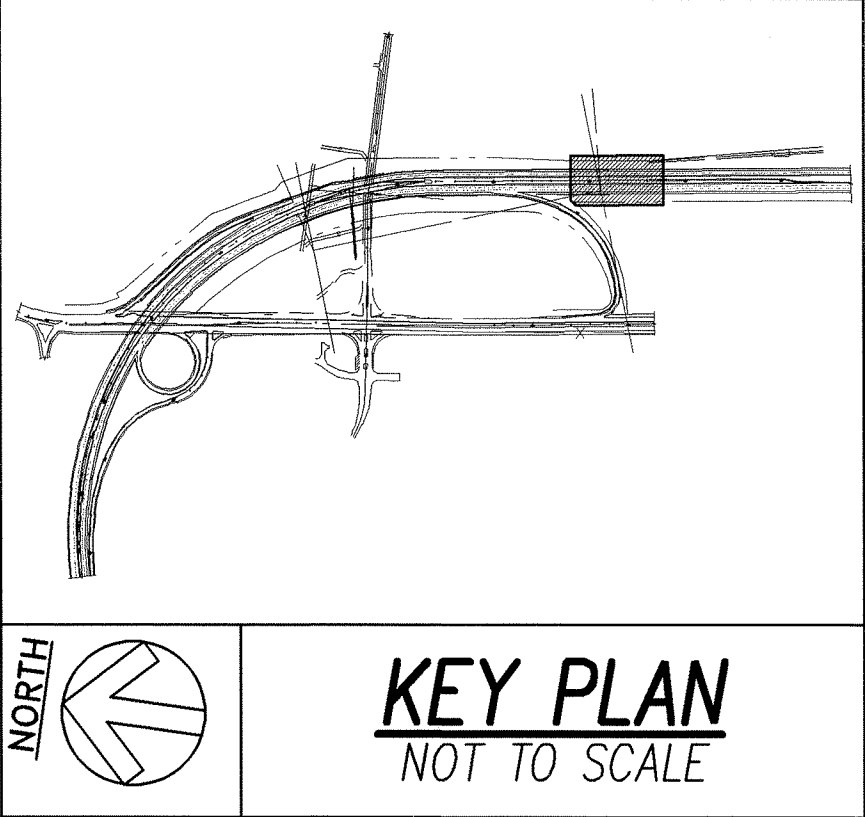

PARTIAL HIGHWAY LIGHTING DEMOLITION PLAN VI
SCALE: 1"=20'

DEMOLITION PLAN NOTES

- (A) Existing Circuit No. 1: 2" Conduit with 4#4, 1#8 Ground; Remove Conductors and Reuse Conduit.
- (B) Existing Circuit No. 2: 2" Conduit, 4#4, 1#8 Ground; Remove Conductors and Reuse Conduit.
- (C) Existing Circuit No. 4: 2" Conduit, 3#8, 1#8 Ground.
- (D) Existing Spare 2" Conduit.
- (E) Existing Circuit No. 3: 2" Conduit, 4#8, 1#8 Ground.
- (F) Existing Circuit No. 1: 2" Conduit, 4#4, 1#8 Ground; Remove Conductors and Abandon Conduit in Place.
- (G) Existing Circuit No. 2: 2" Conduit, 4#4, 1#8 Ground; Remove Conductors and Abandon Conduit in Place.
- (G) Existing Circuit No. 2: 2" Conduit, 4#4, 1#8 Ground; Remove Conductors and Abandon Conduit in Place.
- (H) Existing Junction Box, Flush Mounted in Existing Concrete Barrier; Remove Conductors and Abandon Junction Box in Place.
- (I) Remove Existing Barrier Top Mounted Continuous Row Fluorescent Light Fixtures and All Associated Mounting Hardware; Patch Existing Concrete Barrier with Epoxy Grout, Flush with Existing Finish.
- (J) Existing Circuit to Existing Highway Sign Light to Remain and be Disconnected from Existing Circuit Conductors to Maintain Existing Circuit Continuity.
- (K) Existing Highway Lighting Concrete Pullbox to be Abandoned in Place.
- (L) Existing Highway Lighting Concrete Pullbox to Remain and be Reused.

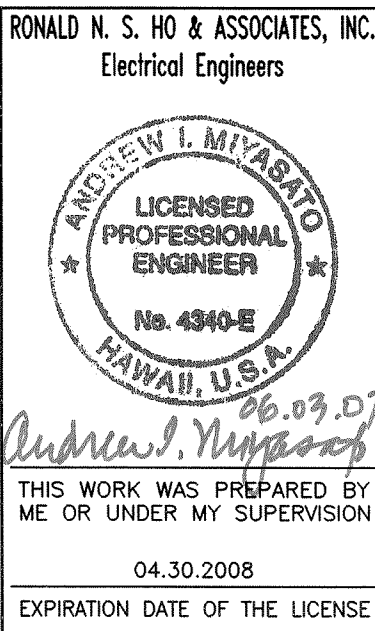
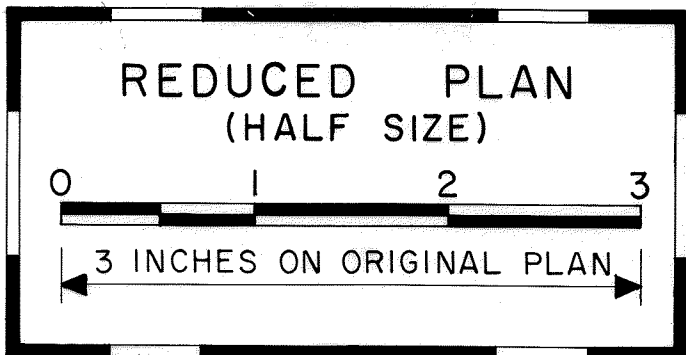
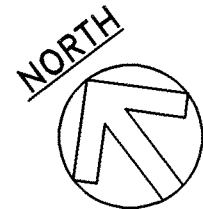

STATE OF HAWAII
DEPARTMENT OF TRANSPORTATION
HIGHWAYS DIVISION
**PARTIAL HIGHWAY LIGHTING
DEMOLITION PLAN VI**
H-2 RAIL LIGHT REPLACEMENT,
VICINITY OF WAHIAWA OFF RAMP

Project No. HWY-0-03-05M
Scale: AS NOTED Date: JUNE 2007
SHEET No. E-9 OF 35 SHEETS

| FED. ROAD DIST. NO. | STATE | PROJ. NO. | FISCAL YEAR | SHEET NO. | TOTAL SHEETS |
|---------------------|-------|--------------|-------------|-----------|--------------|
| HAWAII | HAW. | HWY-0-03-05M | 2007 | 11 | 36 |

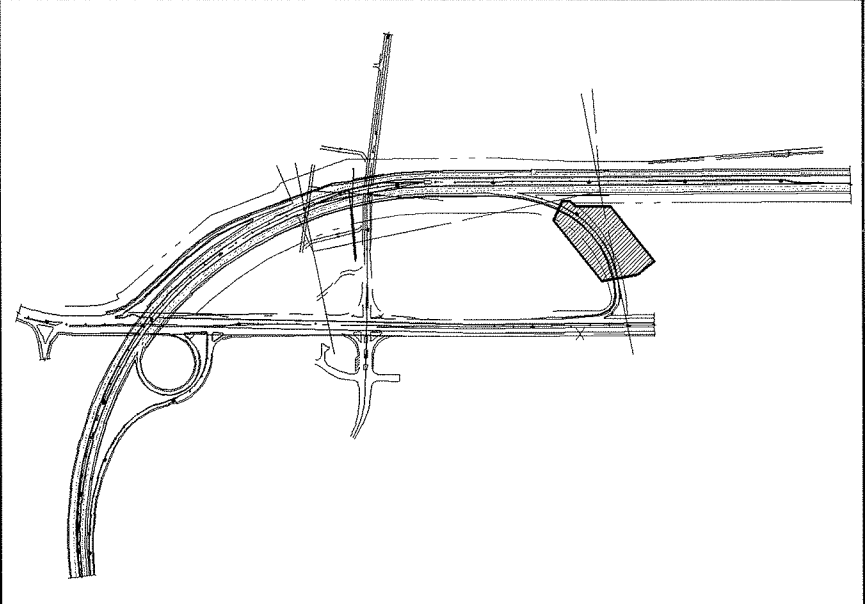

NORTH

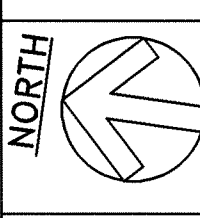

KEY PLAN

NOT TO SCALE

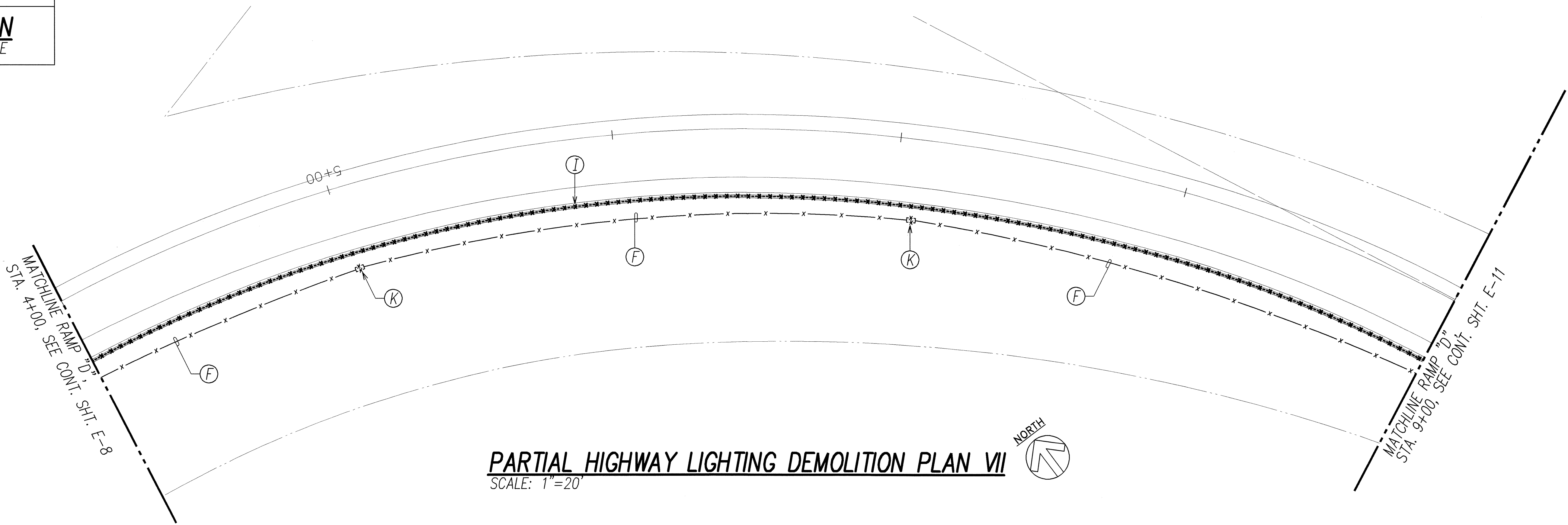

PARTIAL HIGHWAY LIGHTING DEMOLITION PLAN VII

SCALE: 1"=20'

DEMOLITION PLAN NOTES

- (A)

Existing Circuit No. 1: 2" Conduit with 4#4, 1#8 Ground; Remove Conductors and Reuse Conduit.

(B)

Existing Circuit No. 2: 2" Conduit, 4#4, 1#8 Ground; Remove Conductors and Reuse Conduit.

(C)

Existing Circuit No. 4: 2" Conduit, 3#8, 1#8 Ground.

(D)

Existing Spare 2" Conduit.

(E)

Existing Circuit No. 3: 2" Conduit, 4#8, 1#8 Ground.

(F)

Existing Circuit No. 1: 2" Conduit, 4#4, 1#8 Ground; Remove Conductors and Abandon Conduit in Place.

(G)

Existing Circuit No. 2: 2" Conduit, 4#4, 1#8 Ground; Remove Conductors and Abandon Conduit in Place.

(H)

Existing Junction Box, Flush Mounted in Existing Concrete Barrier; Remove Conductors and Abandon Junction Box in Place.

(I)

Remove Existing Barrier Top Mounted Continuous Row Fluorescent Light Fixtures and All Associated Mounting Hardware; Patch Existing Concrete Barrier with Epoxy Grout, Flush with Existing Finish.

(J)

Existing Circuit to Existing Highway Sign Light to Remain and be Disconnected from Existing Circuit Conductors to Maintain Existing Circuit Continuity.

(K)

Existing Highway Lighting Concrete Pullbox to be Abandoned in Place.

(L)

Existing Highway Lighting Concrete Pullbox to Remain and be Reused.

| | |
|-------------------|------|
| SURVEY PLOTTED BY | DATE |
| DRAWN BY | |
| DESIGNED BY | |
| CHECKED BY | |
| NOTE BOOK | |
| No. | |

LAST SAVE: 06/03/07 @ 08:54:49 PM PLT: E-11 1:000000-10.000000

Z:\VAD\PROJECTS\24056A\010\24056A.dwg hwy plan VII SHEET: 3412-REV _24056A-NEWPLAN _24056A-NOTES _24056A-WAHIAWAINTERCHANGE _24056A-ALL-ELEC

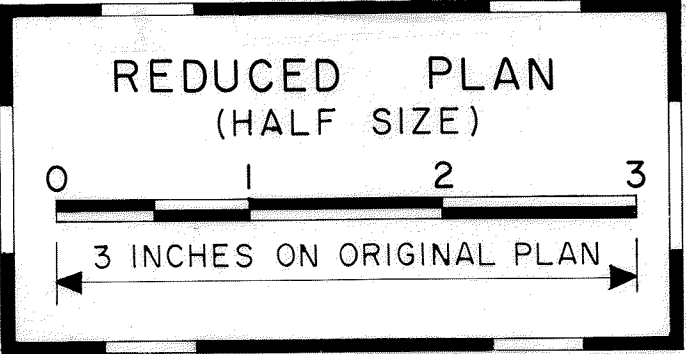

RONALD N. S. HO & ASSOCIATES, INC.

Electrical Engineers

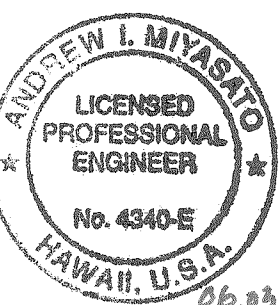

THIS WORK WAS PREPARED BY ME OR UNDER MY SUPERVISION

04.30.2008

EXPIRATION DATE OF THE LICENSE

STATE OF HAWAII

DEPARTMENT OF TRANSPORTATION

HIGHWAYS DIVISION

PARTIAL HIGHWAY LIGHTING

DEMOLITION PLAN VII

H-2 RAIL LIGHT REPLACEMENT,

VICINITY OF WAHIAWA OFF RAMP

Project No. HWY-0-03-05M

Scale: AS NOTED Date: JUNE 2007

SHEET No. E-10 OF 35 SHEETS

| FED. ROAD DIST. NO. | STATE | PROJ. NO. | FISCAL YEAR | SHEET NO. | TOTAL SHEETS |
|---------------------|-------|--------------|-------------|-----------|--------------|
| HAWAII | HAW. | HWY-0-03-05M | 2007 | 12 | 36 |

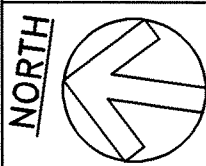
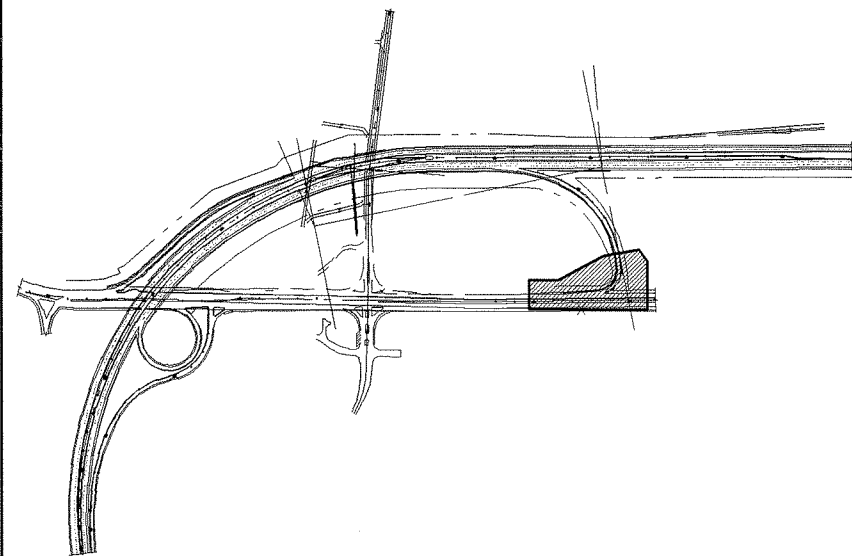

KEY PLAN
NOT TO SCALE

DEMOLITION PLAN NOTES

- (A) Existing Circuit No. 1: 2" Conduit with 4#4, 1#8 Ground; Remove Conductors and Reuse Conduit.
- (B) Existing Circuit No. 2: 2" Conduit, 4#4, 1#8 Ground; Remove Conductors and Reuse Conduit.
- (C) Existing Circuit No. 4: 2" Conduit, 3#8, 1#8 Ground.
- (D) Existing Spare 2" Conduit.
- (E) Existing Circuit No. 3: 2" Conduit, 4#8, 1#8 Ground.
- (F) Existing Circuit No. 1: 2" Conduit, 4#4, 1#8 Ground; Remove Conductors and Abandon Conduit in Place.
- (G) Existing Circuit No. 2: 2" Conduit, 4#4, 1#8 Ground; Remove Conductors and Abandon Conduit in Place.
- (H) Existing Junction Box, Flush Mounted in Existing Concrete Barrier; Remove Conductors and Abandon Junction Box in Place.
- (I) Remove Existing Barrier Top Mounted Continuous Row Fluorescent Light Fixtures and All Associated Mounting Hardware; Patch Existing Concrete Barrier with Epoxy Grout, Flush with Existing Finish.
- (J) Existing Circuit to Existing Highway Sign Light to Remain and be Disconnected from Existing Circuit Conductors to Maintain Existing Circuit Continuity.
- (K) Existing Highway Lighting Concrete Pullbox to be Abandoned in Place.
- (L) Existing Highway Lighting Concrete Pullbox to Remain and be Reused.

MATCHLINE RAMP "D", STA. 9+00, SEE CONT. SHT. E-10

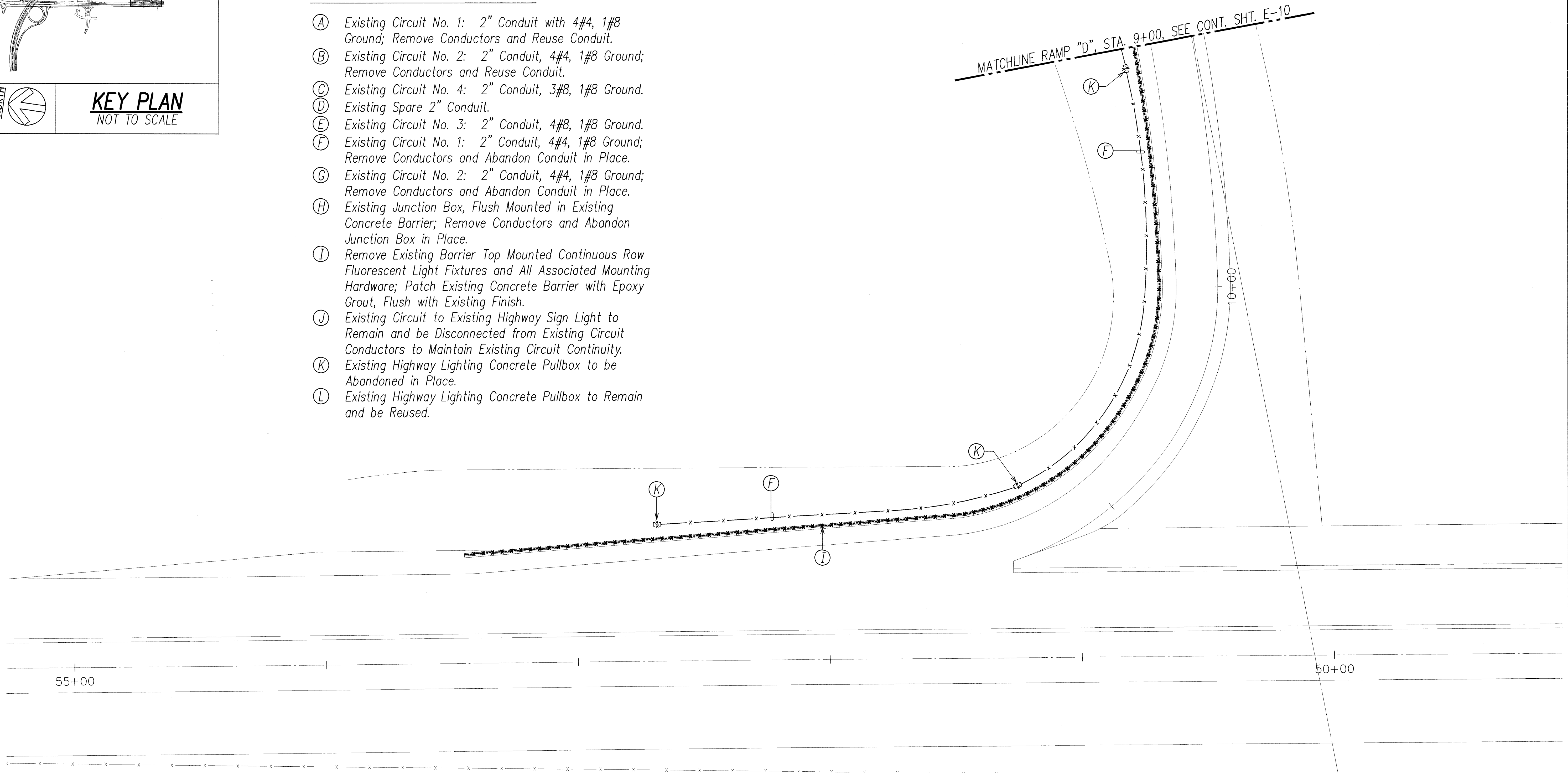

| | |
|-------------------|------|
| SURVEY PLOTTED BY | DATE |
| DRAWN BY | |
| CHECKED BY | |
| DESIGNED BY | |
| QUANTITIES BY | |
| CHECKED BY | |
| No. | |

LAST SAVE: 06/07/07 @ 05:56:10 BY: JAM PLOT SS: 1-20
Z:\ACAD PROJECTS\24056A\01_24056A.dwg XREFS: X12-REV_01_24056A.dwg XREFS: X12-REV_01_24056A.dwg XREFS: X12-REV_01_24056A.dwg

PARTIAL HIGHWAY LIGHTING DEMOLITION PLAN VIII

SCALE: 1"=20'

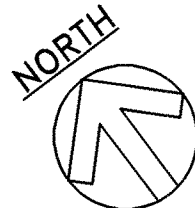

RONALD N. S. HO & ASSOCIATES, INC.
Electrical Engineers

06.07.07
THIS WORK WAS PREPARED BY
ME OR UNDER MY SUPERVISION
04.30.2008
EXPIRATION DATE OF THE LICENSE

STATE OF HAWAII
DEPARTMENT OF TRANSPORTATION
HIGHWAYS DIVISION
**PARTIAL HIGHWAY LIGHTING
DEMOLITION PLAN VIII**
H-2 RAIL LIGHT REPLACEMENT,
VICINITY OF WAHIAWA OFF RAMP

Project No. HWY-0-03-05M
Scale: AS NOTED Date: JUNE 2007
SHEET No. E-11 OF 35 SHEETS