

FED. ROAD DIST. NO.	STATE	PROJ. NO.	FISCAL YEAR	SHEET NO.	TOTAL SHEETS
HAWAII	HAW.	HWY-0-10-06M	2006	25	57

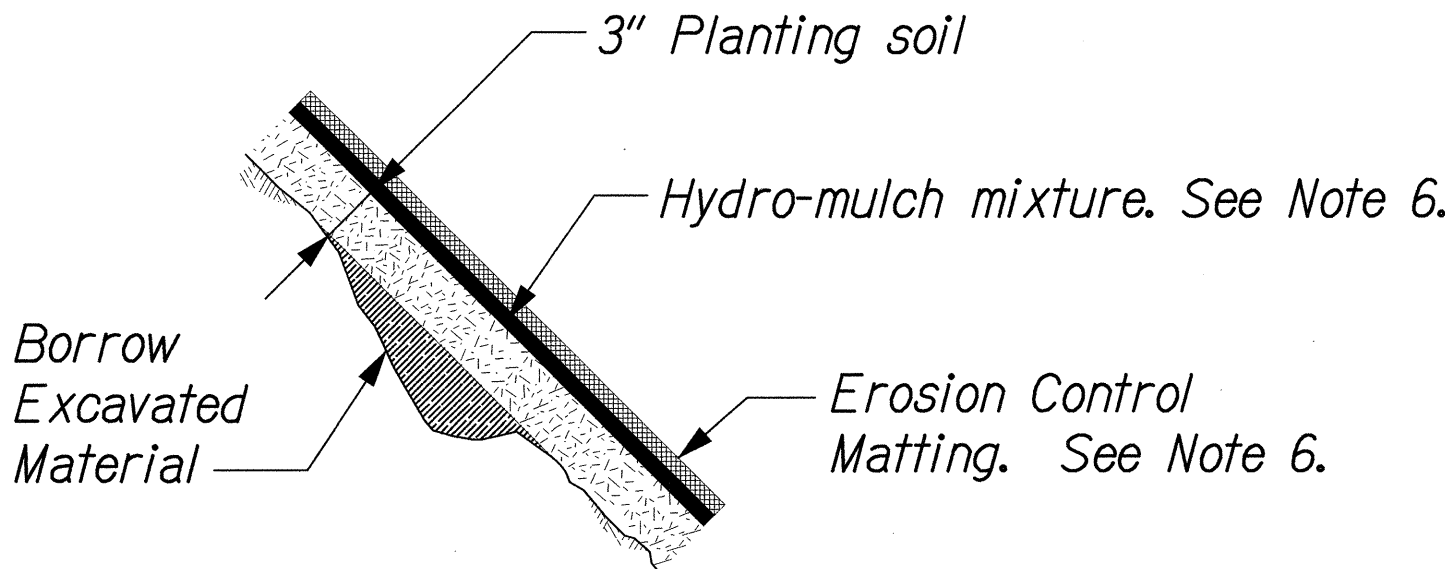

FILLING OF RUT
Scale: Not to Scale

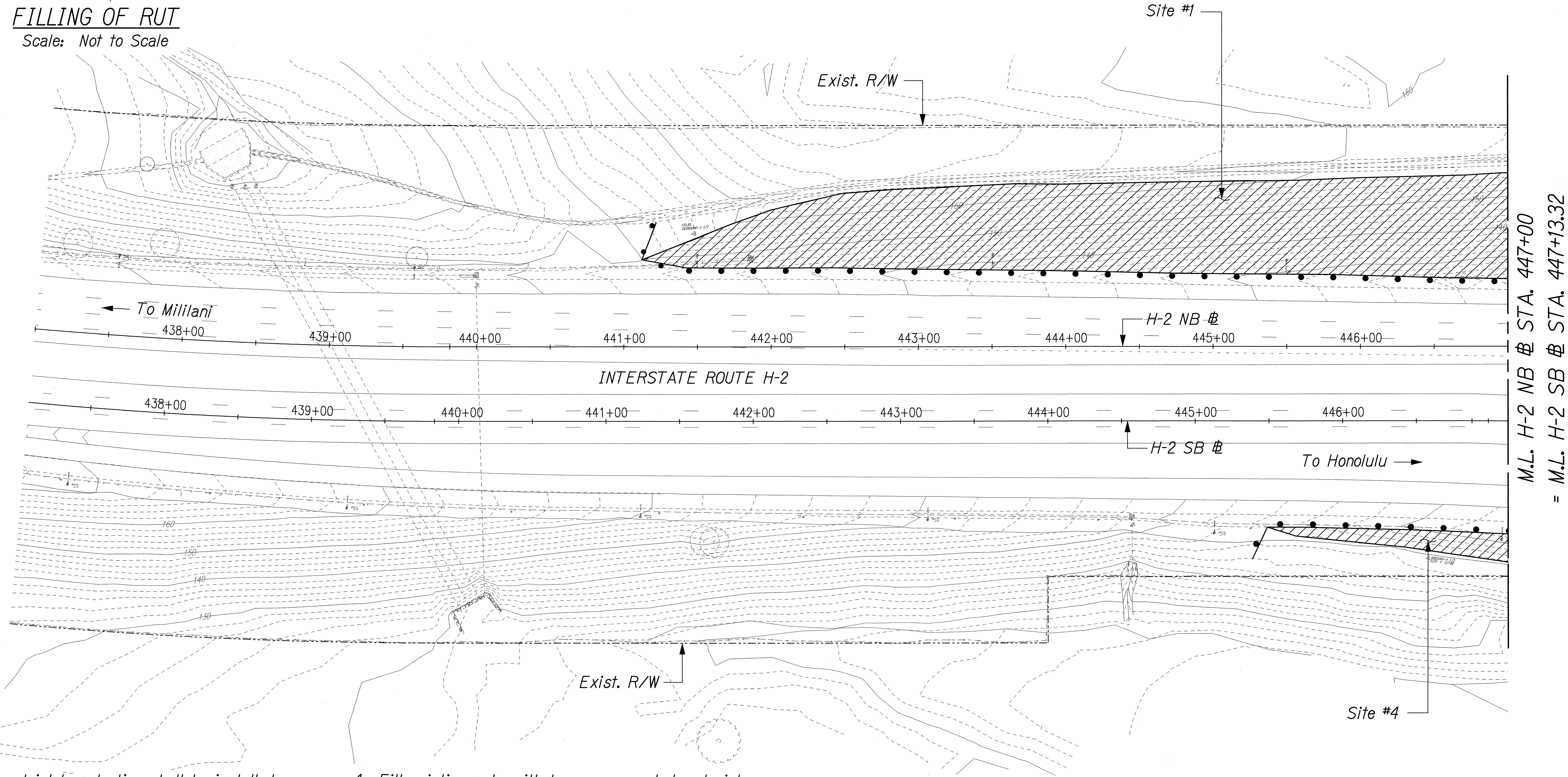

NOTES:

- Silt fence and inlet protection shall be installed prior to any construction activity in the area.
- Silt fence and inlet protection shall be removed once the State accepts completed slope with erosion control matting.
- Removal of erosion control items shall be the responsibility of the Contractor and considered included in the lump sum cost of Item No. 209.1000 Installation, Maintenance, Monitoring, and Removal of BMP. Contractor shall restore disturbed area due to Silt Fence removal to equal or better condition at no cost to the State.
- Fill existing ruts with borrow excavated material to form a slope that is approximately 2H:1V. See Special Provisions Section 203.03 (CX3) for compaction requirements.
- Spread planting soil to form a 3-inch thick top layer.
- Place hydro-mulch mixture and erosion control matting in the sequence recommended per erosion control matting manufacturer's installation guidelines.

LEGEND:

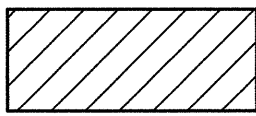

Erosion Control Matting



Silt Fence

THIS WORK WAS PREPARED BY ME OR UNDER MY SUPERVISION.

Wendy M. Higashimura
exp. 4/30/08

STATE OF HAWAII
DEPARTMENT OF TRANSPORTATION
HIGHWAYS DIVISION

EROSION CONTROL
INTERSTATE ROUTE H-2 - SITES 1-4

SLOPE MAINTENANCE FOR EROSION CONTROL
AT VARIOUS SITES ON OAHU
Project No. HWY-0-10-06M

Scale: 1"=40' Date: April 2006

FED. ROAD DIST. NO.	STATE	PROJ. NO.	FISCAL YEAR	SHEET NO.	TOTAL SHEETS
HAWAII	HAW.	HWY-0-10-06M	2006	26	57

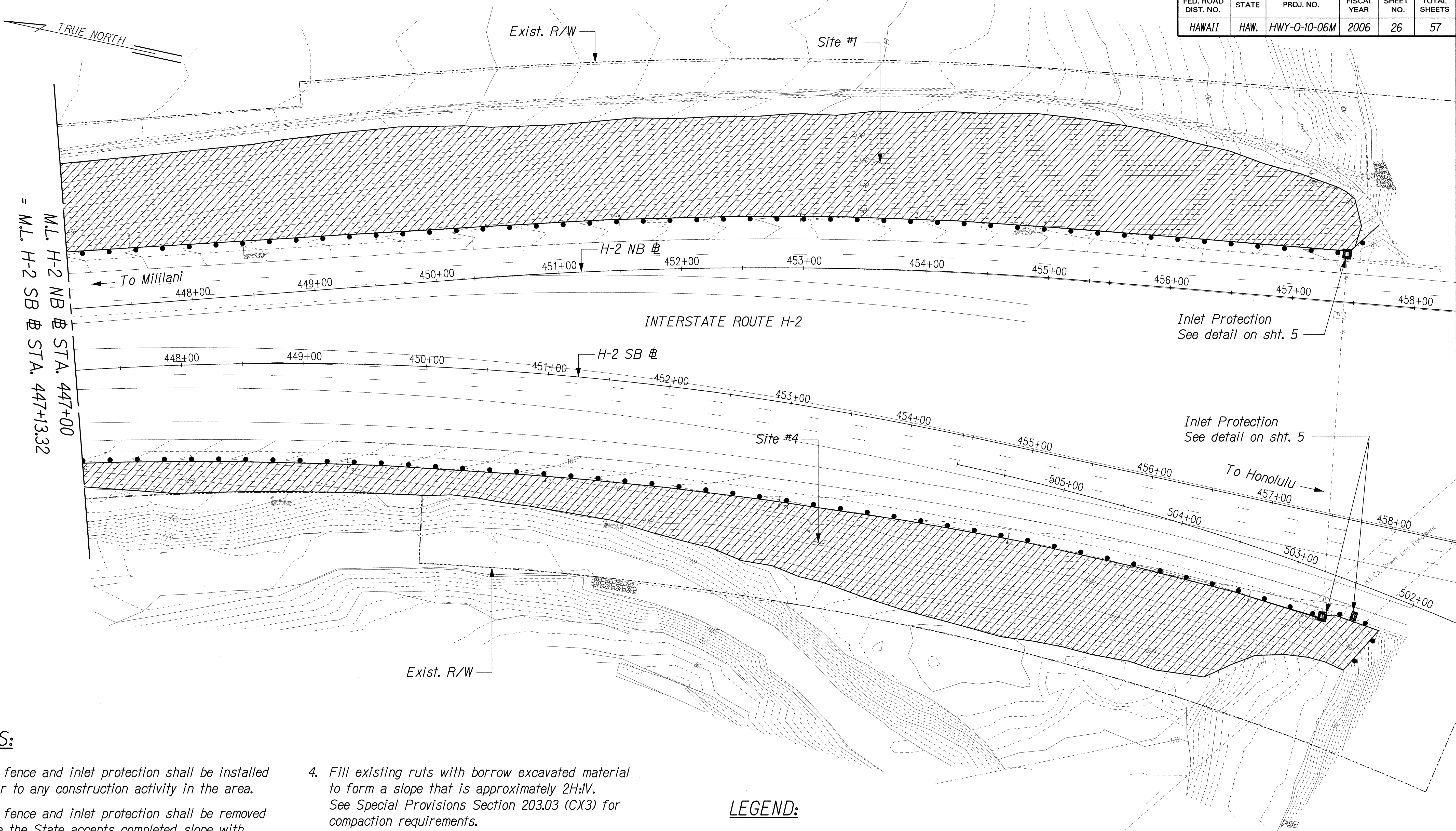

NOTES:

1. Silt fence and inlet protection shall be installed prior to any construction activity in the area.
2. Silt fence and inlet protection shall be removed once the State accepts completed slope with erosion control matting.
3. Removal of erosion control items shall be the responsibility of the Contractor and considered included in the lump sum cost of Item No. 209.1000 Installation, Maintenance, Monitoring, and Removal of BMP. Contractor shall restore disturbed area due to Silt Fence removal to equal or better condition at no cost to the State.
4. Fill existing ruts with borrow excavated material to form a slope that is approximately 2H:1V. See Special Provisions Section 203.03 (CX3) for compaction requirements.
5. Spread planting soil to form a 3-inch thick top layer.
6. Place hydro-mulch mixture and erosion control matting in the sequence recommended per erosion control matting manufacturer's installation guidelines.

LEGEND:

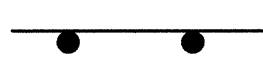
-  Erosion Control Matting
-  Silt Fence

ORIGINAL PLAN	SURVEY PLOTTED BY	DATE
NOTE BOOK	DRAWN BY	
	DESIGNED BY	
	CHECKED BY	

J:\SSWMP - 10 PRIORITY SITES\EC\EC-H2-21-4B-POST.dgn

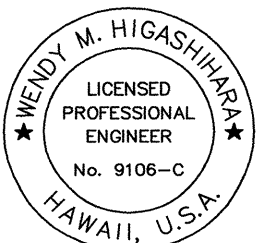

THIS WORK WAS PREPARED BY ME OR UNDER MY SUPERVISION.

Wendy M. Higashimura
exp. 4/30/08

STATE OF HAWAII
DEPARTMENT OF TRANSPORTATION
HIGHWAYS DIVISION



EROSION CONTROL
INTERSTATE ROUTE H-2 - SITES 1&4

SLOPE MAINTENANCE FOR EROSION CONTROL
AT VARIOUS SITES ON OAHU
Project No. HWY-0-10-06M

Scale: 1"=40' Date: April 2006

FED. ROAD DIST. NO.	STATE	PROJ. NO.	FISCAL YEAR	SHEET NO.	TOTAL SHEETS
HAWAII	HAW.	HWY-0-10-06M	2006	27	57

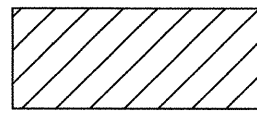
LEGEND:

-  Erosion Control Matting
-  Silt Fence

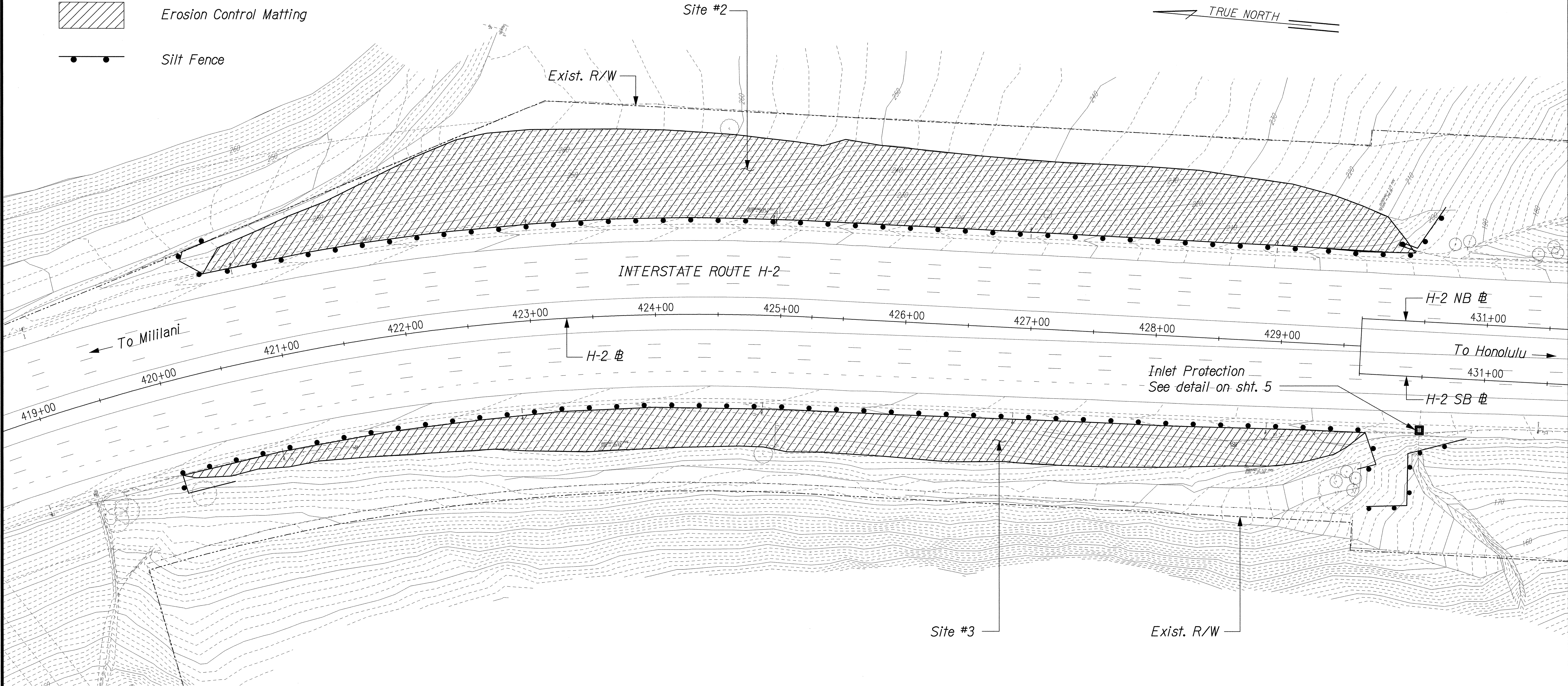

NOTES:

- Silt fence and inlet protection shall be installed prior to any construction activity in the area. Contractor shall locate (if not shown on plan) and install inlet protection at the first inlets beyond the work area on the down slope side of the work area. Inlets shall be on the same side of the road as the construction activity.
- Silt fence and inlet protection shall be removed once the State accepts completed slope with erosion control matting.
- Removal of erosion control items shall be the responsibility of the Contractor and considered included in the lump sum cost of Item No. 209.1000 Installation, Maintenance, Monitoring, and Removal of BMP. Contractor shall restore disturbed area due to Silt Fence removal to equal or better condition at no cost to the State.
- Fill existing ruts with borrow excavated material to form a slope that is approximately 2H:1V. See Special Provisions Section 203.03 (CX3) for compaction requirements.
- Spread planting soil to form a 3-inch thick top layer.
- Place hydro-mulch mixture and erosion control matting in the sequence recommended per erosion control matting manufacturer's installation guidelines.

ORIGINAL PLAN	SURVEY PLOTTED BY	DATE
NOTE BOOK	DRAWN BY	
	DESIGNED BY	
	CHECKED BY	

J:\SSMWP - 10 PRIORITY SITES\EC\EC-H2-23-POST.dgn

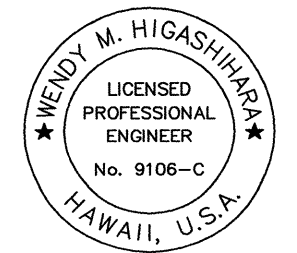

THIS WORK WAS PREPARED BY ME OR UNDER MY SUPERVISION.

Wendy M. Higashimura
exp. 4/30/08

STATE OF HAWAII
DEPARTMENT OF TRANSPORTATION
HIGHWAYS DIVISION

EROSION CONTROL
INTERSTATE ROUTE H-2 - SITES 2&3

SLOPE MAINTENANCE FOR EROSION CONTROL
AT VARIOUS SITES ON OAHU
Project No. HWY-0-10-06M

Scale: 1"=40' Date: April 2006

FED. ROAD DIST. NO.	STATE	PROJ. NO.	FISCAL YEAR	SHEET NO.	TOTAL SHEETS
HAWAII	HAW.	HWY-0-10-06M	2006	28	57

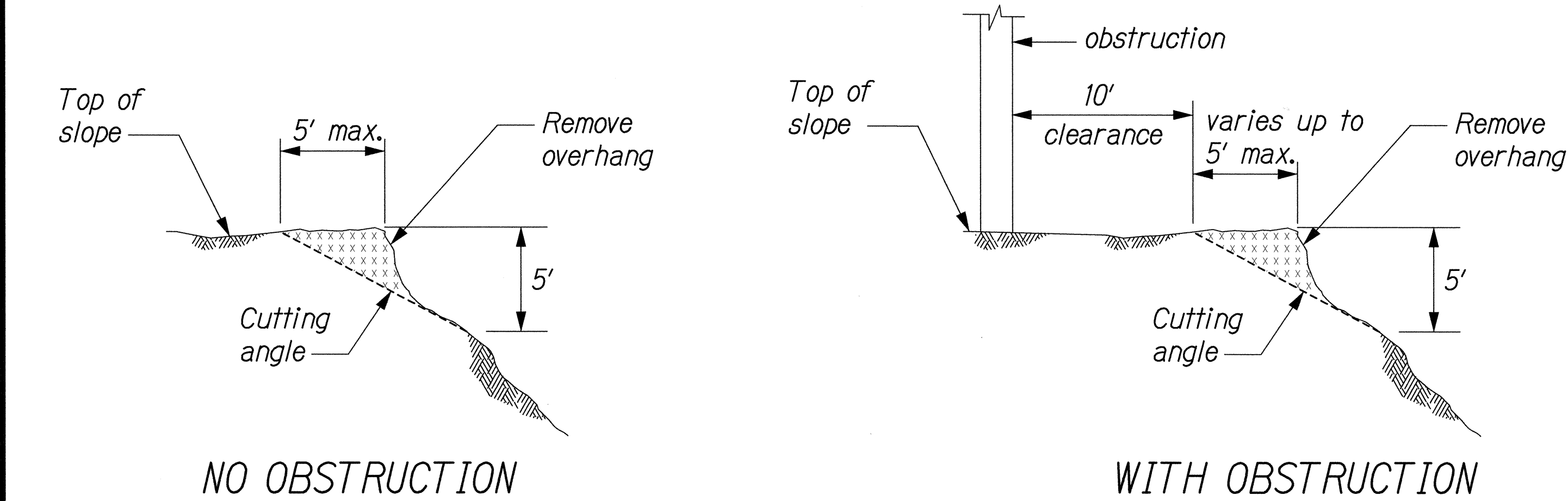

CUTTING OVERHANG
Scale: Not to Scale

- NOTES:**
1. When removing overhang, maintain 10' clearance from obstructions (i.e. utility poles, fencing, trees, etc.). Contractor shall remove overhang to the maximum horizontal distance of 5' from top of slope where possible. Where the 5' maximum conflicts with the 10' clearance, remove the overhang up to 10' clearance.
 2. Contractor shall notify Engineer prior to overhang removal if disturbance is anticipated to jeopardize the stability of the existing trees to remain.

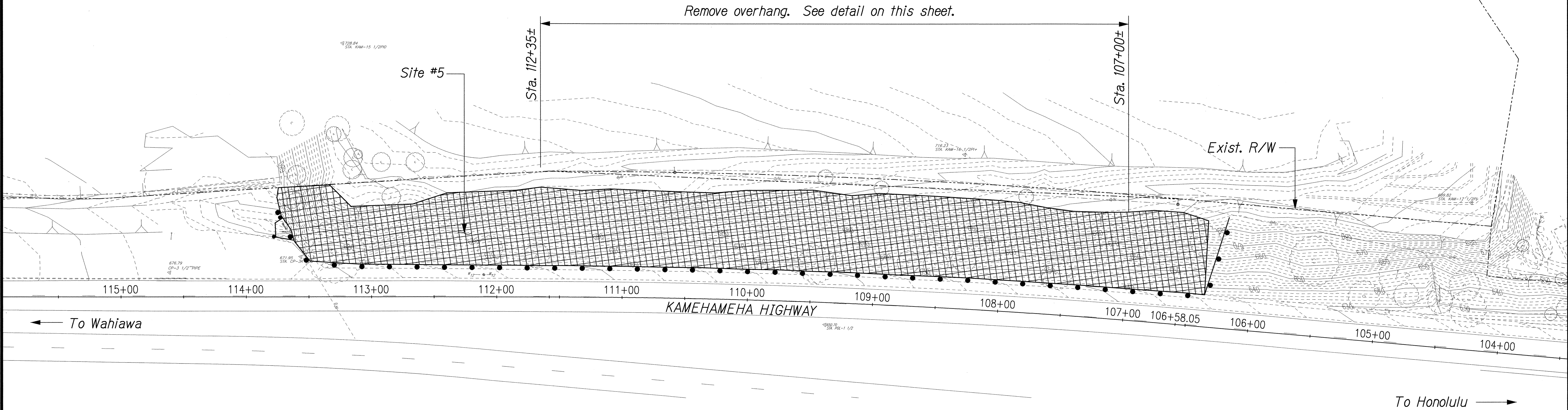

- NOTES:**
1. Silt fence shall be installed prior to any construction activity in the area.
 2. Silt fence shall be removed one year after the State accepts the completed slope with hydro-mulch.
 3. Removal of erosion control items shall be the responsibility of the Contractor and considered included in the lump sum cost of Item No. 209.1000 Installation, Maintenance, Monitoring, and Removal of BMP. Contractor shall restore disturbed area due to Silt Fence removal to equal or better condition at no cost to the State.
 4. Maximum limits of erosion control work area shown. Existing vegetation coverage may vary at time of construction. Contractor shall install erosion control measures on areas with no vegetation or as directed by the Engineer. Existing trees and vegetation shall remain unless otherwise indicated on plan or by the Engineer for removal.
 5. Remove any loose soil on the exposed slope face prior to hydro-mulch mixture application. Removal shall be paid for under Item No. 203.0300 Excess Soil Removal.
 6. Remove overhang. See detail on this sheet. Removal shall be paid under Item No. 203.0300 Excess Soil Removal.

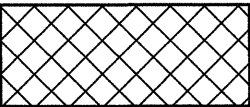
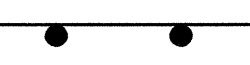
- LEGEND:**
-  Hydro-Mulch Mixture
 -  Silt Fence

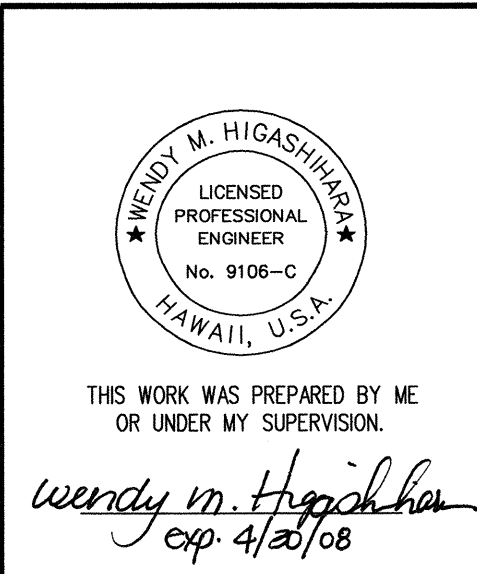

STATE OF HAWAII
DEPARTMENT OF TRANSPORTATION
HIGHWAYS DIVISION

EROSION CONTROL
KAMEHAMEHA HIGHWAY - SITE 5
SLOPE MAINTENANCE FOR EROSION CONTROL
AT VARIOUS SITES ON OAHU
Project No. HWY-0-10-06M

Scale: 1"=40' Date: April 2006

SHEET No. EC-4 OF 8 SHEETS

ORIGINAL PLAN	DATE
DRAWN BY	
TRACED BY	
DESIGNED BY	
QUANTITIES BY	
CHECKED BY	

J:\SSWMP - 10 PRIORITY SITES\EC\EC-KAM HWY-5-POST.dgn

FED. ROAD DIST. NO.	STATE	PROJ. NO.	FISCAL YEAR	SHEET NO.	TOTAL SHEETS
HAWAII	HAW.	HWY-0-10-06M	2006	29	57

LEGEND:

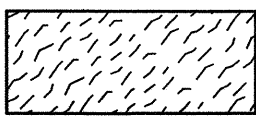

Hydraulic Blanket Mixture

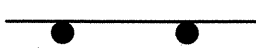

Silt Fence

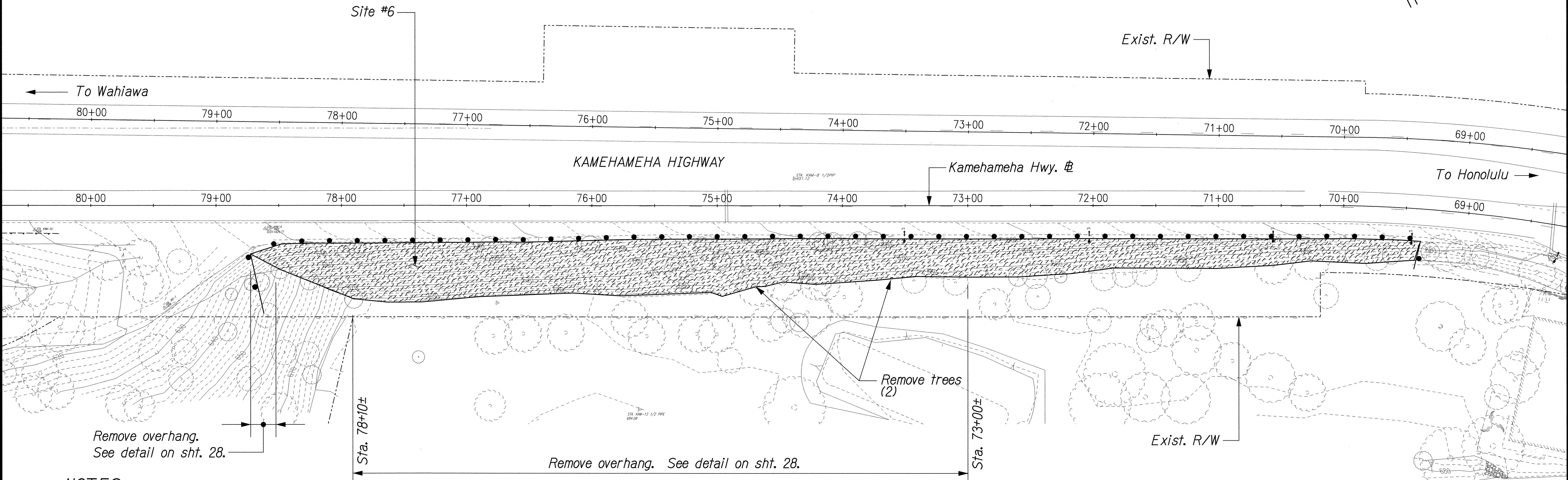
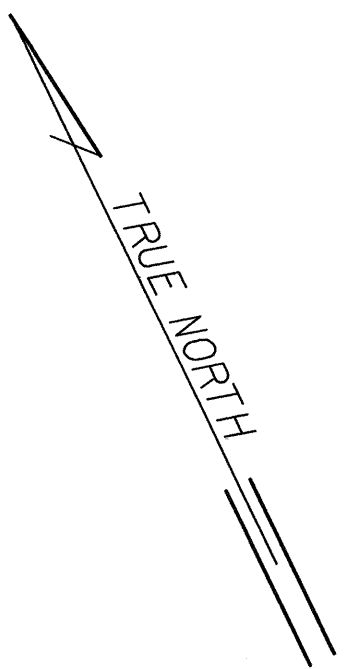

NOTES:

1. Silt fence shall be installed prior to any construction activity in the area.
2. Silt fence shall be removed one year after the State accepts completed slope with hydraulically applied blanket.
3. Removal of erosion control items shall be the responsibility of the Contractor and considered included in the lump sum cost of Item No. 209.1000 Installation, Maintenance, Monitoring, and Removal of BMP. Contractor shall restore disturbed area due to Silt Fence removal to equal or better condition at no cost to the State.
4. Maximum limits of erosion control work area shown. Existing vegetation coverage may vary at time of construction. Contractor shall install erosion control measures on areas with no vegetation or as directed by the Engineer. Existing trees and vegetation shall remain unless otherwise indicated on plan or by the Engineer for removal.
5. Remove any loose soil on the exposed slope face prior to hydraulic blanket mixture application. Removal shall be paid for under Item No. 203.0300 Excess Soil Removal.
6. Remove overhang. See detail on Sht. 28. Removal shall be paid for under Item No. 203.0300 Excess Soil Removal.
7. Contractor shall notify Engineer and Christopher Dacus, HWY-DL, (692-7600) 7 days prior to any work commencing on site. HWY-DL will verify the number and location of trees to be removed.

ORIGINAL PLAN	SURVEY PLOTTED BY	DATE
NOTE BOOK	DRAWN BY	
	DESIGNED BY	
	CHECKED BY	

J:\SSWMP - 10 PRIORITY SITES\EC\EC-KAM HWY-6-POST.dgn

THIS WORK WAS PREPARED BY ME OR UNDER MY SUPERVISION.

Wendy M. Higashihara
exp. 4/30/08

STATE OF HAWAII
DEPARTMENT OF TRANSPORTATION
HIGHWAYS DIVISION

EROSION CONTROL
KAMEHAMEHA HIGHWAY - SITE 6

SLOPE MAINTENANCE FOR EROSION CONTROL
AT VARIOUS SITES ON OAHU
Project No. HWY-0-10-06M

Scale: 1"=40' Date: April 2006

SHEET No. EC-5 OF 8 SHEETS

FED. ROAD DIST. NO.	STATE	PROJ. NO.	FISCAL YEAR	SHEET NO.	TOTAL SHEETS
HAWAII	HAW.	HWY-0-10-06M	2006	30	57

LEGEND:

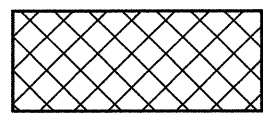

Hydro-Mulch Mixture

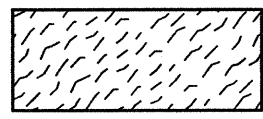

Hydraulic Blanket Mixture



Silt Fence

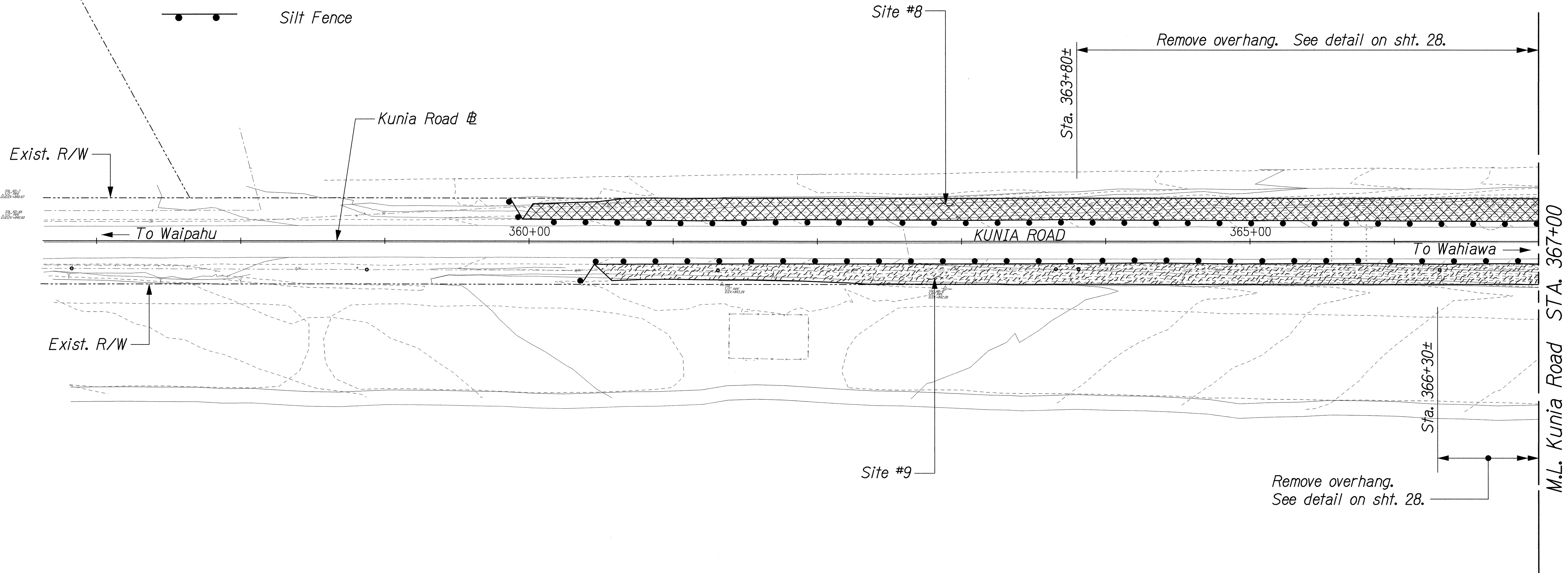

NOTES:

- For Sites 7 - 10, Contractor shall notify the Navy Information Operation Command (NIOC) Facility of the schedule, location and nature of work at least seven (7) days prior to the start of construction.
Facilities Department (N4)
Navy Information Operations Command, Hawaii
Schofield Barracks, HI 96857
Voice: (808) 655-3564/655-3266/655-3888
Fax: (808) 655-3553
- Silt fence shall be installed prior to construction activity in the area.
- Silt fence shall be removed one year after the State accepts completed slope with hydro-mulch or hydraulically applied erosion control blanket.
- Removal of erosion control items shall be the responsibility of the Contractor and considered included in the lump sum cost of Item No. 209.1000 Installation, Maintenance, Monitoring, and Removal of BMP. Contractor shall restore disturbed area due to Silt Fence removal to equal or better condition at no cost to the State.
- Maximum limits of erosion control work area shown. Existing vegetation coverage may vary at time of construction. Contractor shall install erosion control measures on areas with no vegetation or as directed by the Engineer. Existing trees and vegetation shall remain unless otherwise indicated on plan or by the Engineer for removal.
- Remove any loose soil on the exposed slope face prior to hydro-mulch or hydraulic blanket mixture application. Removal shall be paid for under Item No. 203.0300 Excess Soil Removal.
- Remove overhang. See Detail on Sht. 28. Removal shall be paid for under Item No. 203.0300 Excess Soil Removal.

ORIGINAL PLAN	SURVEY PLOTTED BY	DATE
NOTE BOOK	DRAWN BY	
	DESIGNED BY	
	CHECKED BY	

J:\SSWMP - 10 PRIORITY SITES\EC\EC-KUNIA-8-9A-POST.dgn

THIS WORK WAS PREPARED BY ME OR UNDER MY SUPERVISION.
Wendy M. Higashimura
exp 4/30/08

STATE OF HAWAII
DEPARTMENT OF TRANSPORTATION
HIGHWAYS DIVISION

EROSION CONTROL
KUNIA ROAD - SITES 8 & 9
SLOPE MAINTENANCE FOR EROSION CONTROL
AT VARIOUS SITES ON OAHU
Project No. HWY-0-10-06M

Scale: 1"=40' Date: April 2006

SHEET No. EC-6 OF 8 SHEETS

FED. ROAD DIST. NO.	STATE	PROJ. NO.	FISCAL YEAR	SHEET NO.	TOTAL SHEETS
HAWAII	HAW.	HWY-O-10-06M	2006	31	57

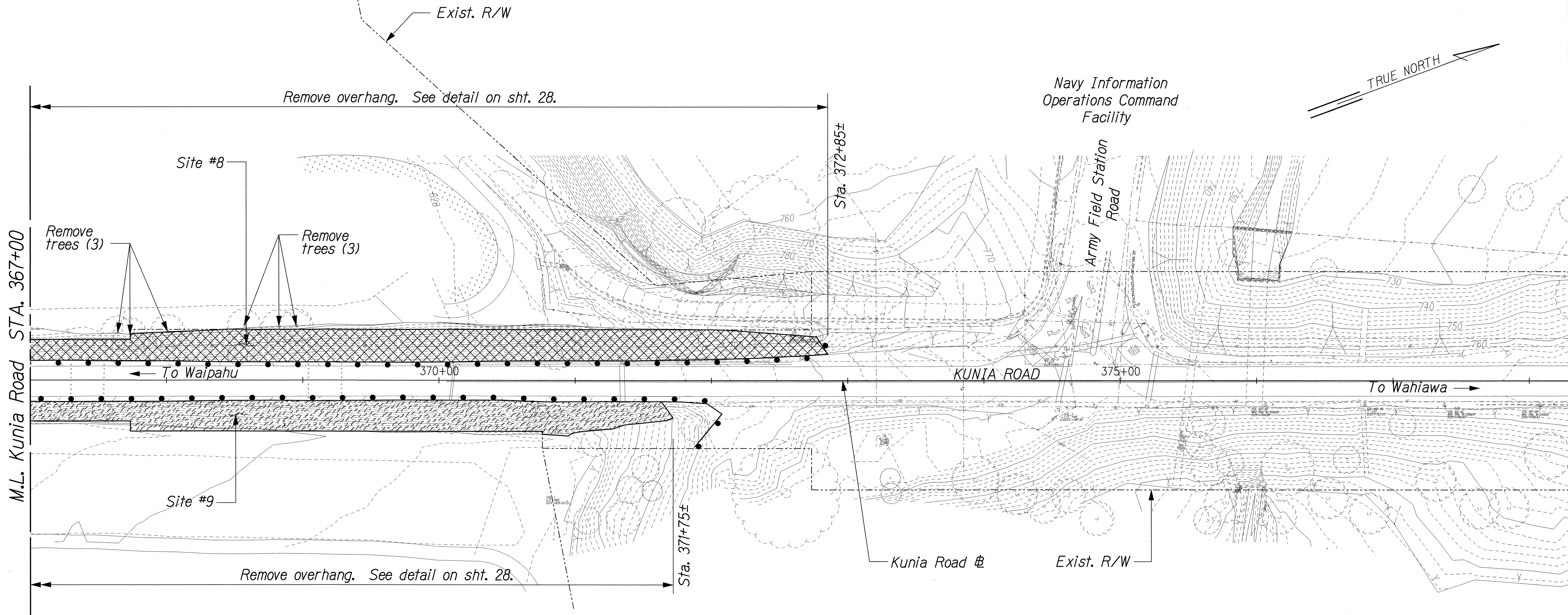

NOTES:

- For Sites 7 - 10, Contractor shall notify the Navy Information Operation Command (NIOC) Facility of the schedule, location and nature of work at least seven (7) days prior to the start of construction.
Facilities Department (N4)
Navy Information Operations Command, Hawaii
Schofield Barracks, HI 96857
Voice: (808) 655-3564/655-3266/655-3888
Fax: (808) 655-3553
- Silt fence shall be installed prior to construction activity in the area.
- Silt fence shall be removed one year after the State accepts completed slope with hydromulch or hydraulically applied erosion control blanket.
- Removal of erosion control items shall be the responsibility of the Contractor and considered included in the lump sum cost of Item No. 209.1000 Installation, Maintenance, Monitoring, and Removal of BMP. Contractor shall restore disturbed area due to Silt Fence removal to equal or better condition at no cost to the State.
- Maximum limits of erosion control work area shown. Existing vegetation coverage may vary at time of construction. Contractor shall install erosion control measures on areas with no vegetation or as directed by the Engineer. Existing trees and vegetation shall remain unless otherwise indicated on plan or by the Engineer for removal.
- Remove any loose soil on the exposed slope face prior to hydromulch or hydraulic blanket mixture application. Removal shall be paid for under Item No. 203.0300 Excess Soil Removal.
- Remove overhang. See detail on Sht. 28. Removal shall be paid for under Item No. 203.0300 Excess Soil Removal.
- Contractor shall notify Engineer and Christopher Dacus, HWY-DL, (692-7600) 7 days prior to any work commencing on site. HWY-DL will verify the number and location of trees to be removed.

LEGEND:

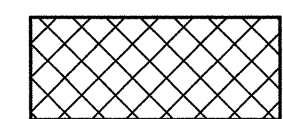

Hydro-Mulch Mixture

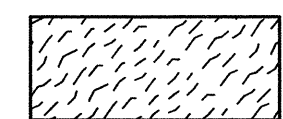

Hydraulic Blanket Mixture

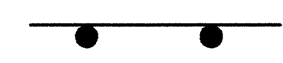

Silt Fence

 THIS WORK WAS PREPARED BY ME OR UNDER MY SUPERVISION. <i>Wendy M. Higashimura</i> exp. 4/30/08	STATE OF HAWAII DEPARTMENT OF TRANSPORTATION HIGHWAYS DIVISION EROSION CONTROL KUNIA ROAD - SITES 8 & 9 SLOPE MAINTENANCE FOR EROSION CONTROL AT VARIOUS SITES ON OAHU Project No. HWY-O-10-06M Scale: 1"=40' Date: April 2006
	SHEET No. EC-7 OF 8 SHEETS
	31

ORIGINAL PLAN	SURVEY PLOTTED BY	DATE
NOTE BOOK	DRAWN BY	
	DESIGNED BY	
	CHECKED BY	

J:\SSWMP - 10 PRIORITY SITES\EC\EC-KUNIA-8-9B-POST.dgn

FED. ROAD DIST. NO.	STATE	PROJ. NO.	FISCAL YEAR	SHEET NO.	TOTAL SHEETS
HAWAII	HAW.	HWY-0-10-06M	2006	32	57

LEGEND:



Hydro-Mulch Mixture

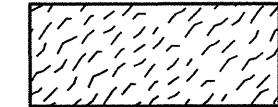

Hydraulic Blanket Mixture



Silt Fence

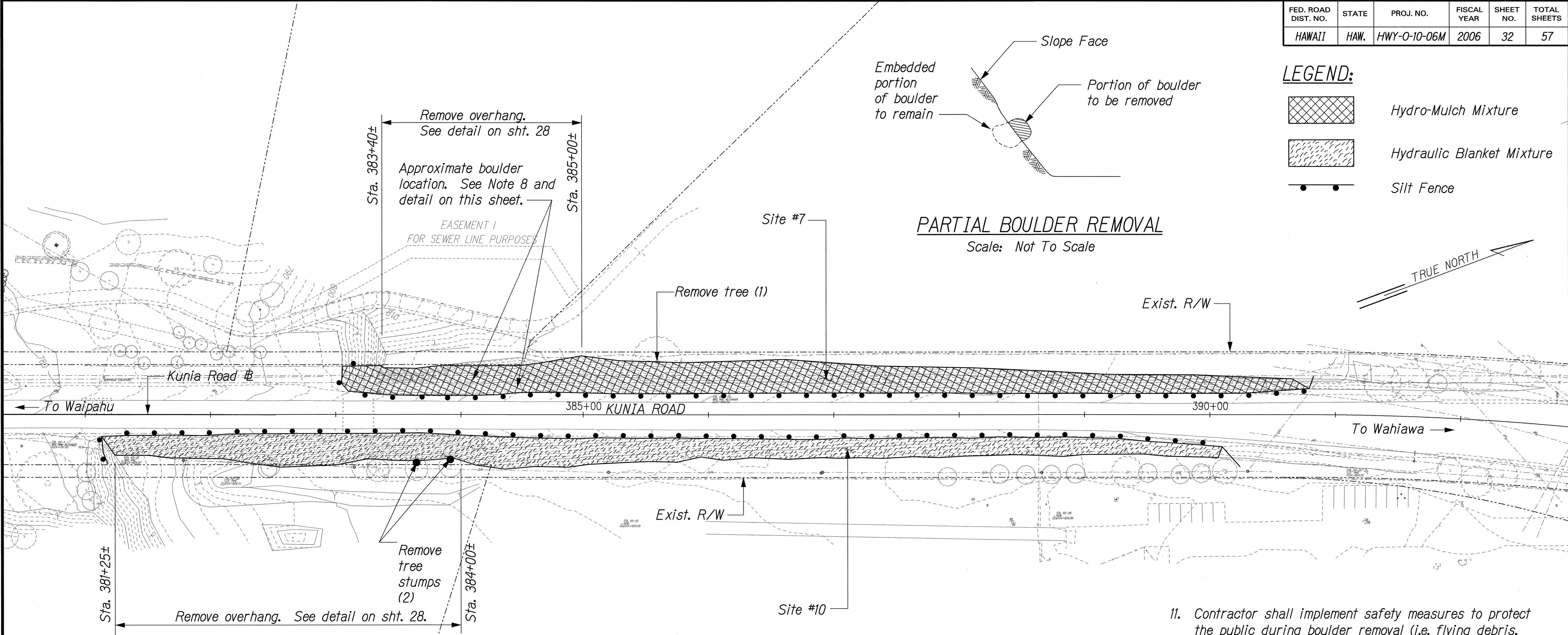

NOTES:

1. For Sites 7 - 10, Contractor shall notify the Navy Information Operation Command (NIOC) Facility of the schedule, location and nature of work at least seven (7) days prior to the start of construction.

Facilities Department (N4)
Navy Information Operations Command, Hawaii
Schofield Barracks, HI 96857
Voice: (808) 655-3564/655-3266/655-3888
Fax: (808) 655-3553

2. For Sites 7 and 10, Contractor shall notify Master Sergeant Nambert (489-5330) of Wheeler Army Airfield of the construction work at least seven (7) days prior to the start of construction.

3. Silt fence shall be installed prior to construction activity in the area.
4. Silt fence shall be removed one year after the State accepts completed slope with hydro-mulch or hydraulically applied erosion control blanket.

5. Removal of erosion control items shall be the responsibility of the Contractor and considered included in the lump sum cost of Item No. 209.1000 Installation, Maintenance, Monitoring, and Removal of BMP. Contractor shall restore disturbed area due to Silt Fence removal to equal or better condition at no cost to the State.

6. Maximum limits of erosion control work area shown. Existing vegetation coverage may vary at time of construction. Contractor shall install erosion control measures on areas with no vegetation or as directed by the Engineer. Existing trees and vegetation shall remain unless otherwise indicated on plan or by the Engineer for removal.

7. Remove any loose soil on the exposed slope face prior to hydromulch or hydraulic blanket mixture application. Removal shall be paid for under Item No. 203.0300 Excess Soil Removal.

8. Remove overhang. See detail on Sht. 28. Removal shall be paid for under Item No. 203.0300 Excess Soil Removal.

9. Contractor shall remove portion of boulder protruding beyond the slope face. Portion of boulder embedded in the slope to remain. Contractor is responsible to fill voids 6-inches and deeper that are due to the boulder removal at no extra cost to the State. Depth of void shall be measured from the surface immediately surrounding the boulder.

10. Construction shall take precautions to prevent damage to surrounding property during boulder removal. Damage to State facilities and surrounding property as a result of the boulder removal activity shall be restored to previous condition or better by the Contractor at no cost to the State.

11. Contractor shall implement safety measures to protect the public during boulder removal (i.e. flying debris, falling boulder fragments, etc).

12. Contractor shall notify Engineer and Christopher Dacus, HWL-DL, (692-7600) 7 days prior to any work commencing on site. HWY-DL will verify the number and location of trees to be removed.

13. Contractor shall notify Engineer prior to tree removal if disturbance is anticipated to jeopardize utility pole stability.

14. Removal of tree stumps shall be paid for under Item No. 202.0411 Removal of Trees.

ORIGINAL PLAN	SURVEY PLOTTED BY	DATE
NOTE BOOK	DRAWN BY	
	TRACED BY	
	DESIGNED BY	
	CHECKED BY	
	IN CHARGE	

J6/SSWMP - 10 PRIORITY SITES/EC/EC-KUNIA-7-10-POST.dgn

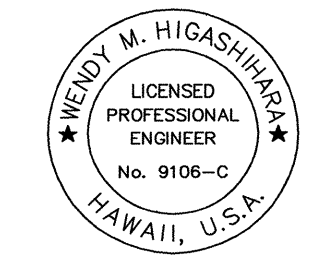

THIS WORK WAS PREPARED BY ME OR UNDER MY SUPERVISION.

Wendy M. Higashimura
exp. 4/30/08

STATE OF HAWAII
DEPARTMENT OF TRANSPORTATION
HIGHWAYS DIVISION

EROSION CONTROL

KUNIA ROAD - SITES 7 & 10

SLOPE MAINTENANCE FOR EROSION CONTROL AT VARIOUS SITES ON OAHU

Project No. HWY-0-10-06M

Scale: 1"=40'

Date: April 2006