

FED. ROAD DIST. NO.	STATE	PROJ. NO.	FISCAL YEAR	SHEET NO.	TOTAL SHEETS
HAWAII	HAW.	HWY-0-04-04	2006	7	45

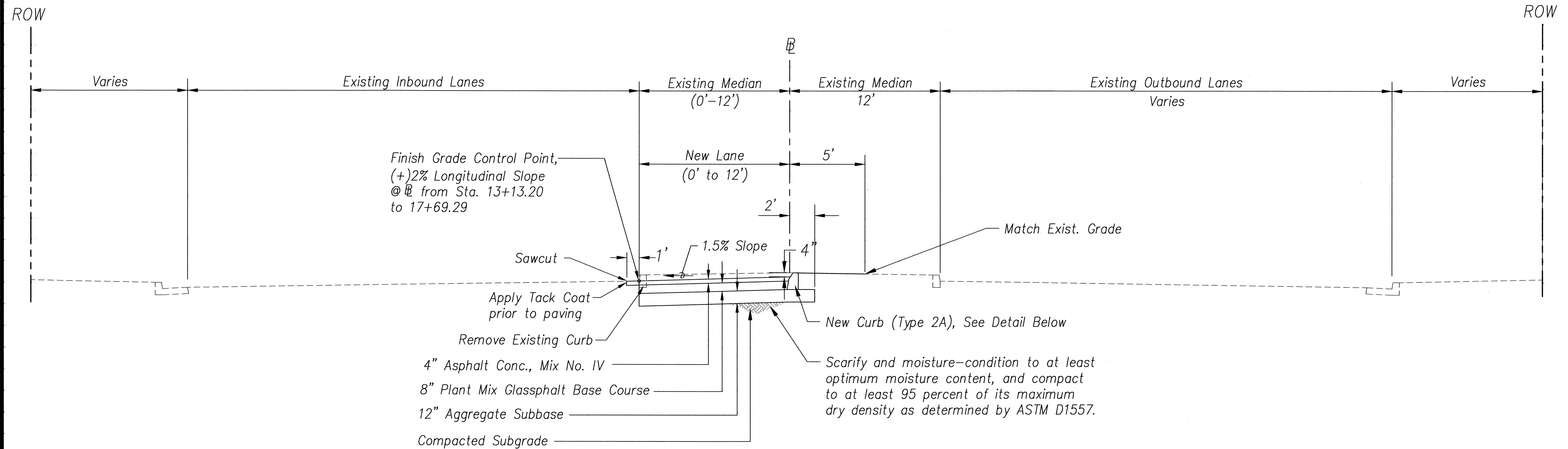

TYPICAL SECTION – PALI HIGHWAY
STA. 13+13.20 TO 17+69.29

SCALE: 1" = 4'

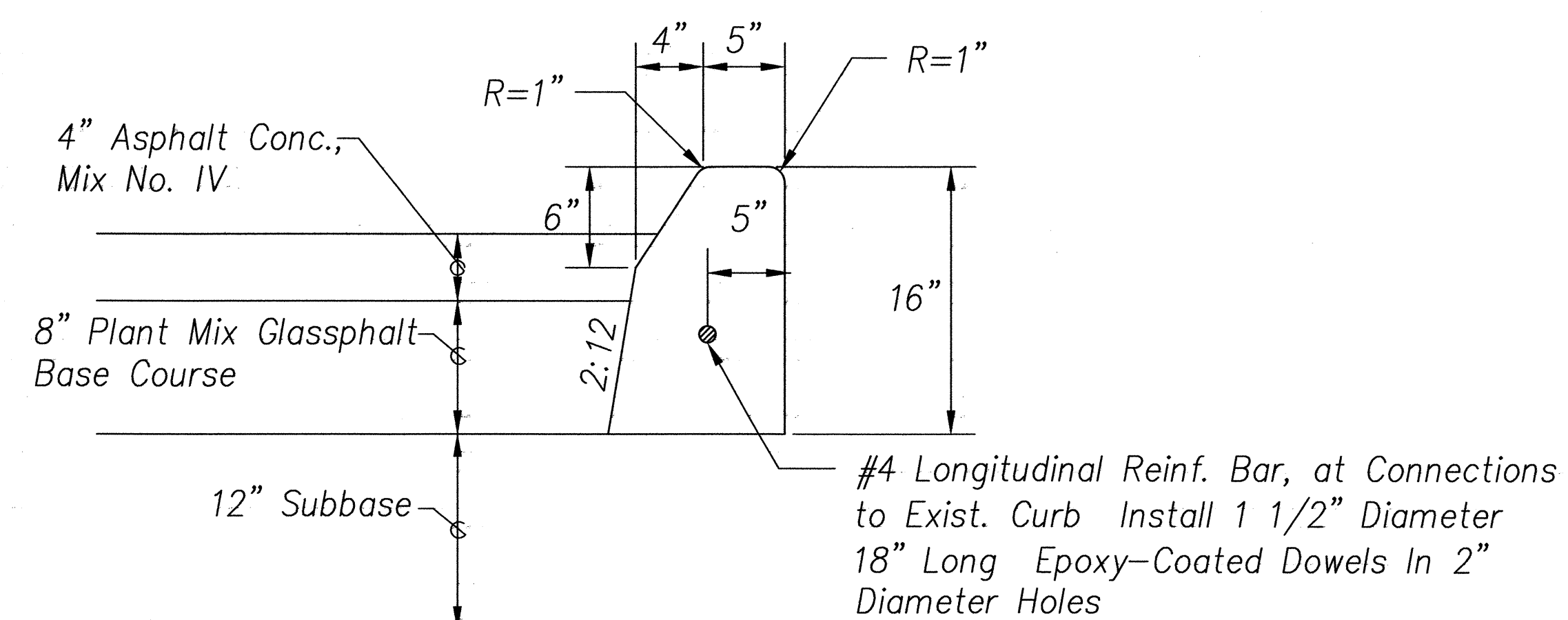

CAST-IN-PLACE CONCRETE CURB (TYPE 2A)

SCALE: Not to Scale

SURVEY PLOTTED BY	DATE
DRAWN BY	
TRACED BY	
CHECKED BY	
NOTE BOOK	
NO.	

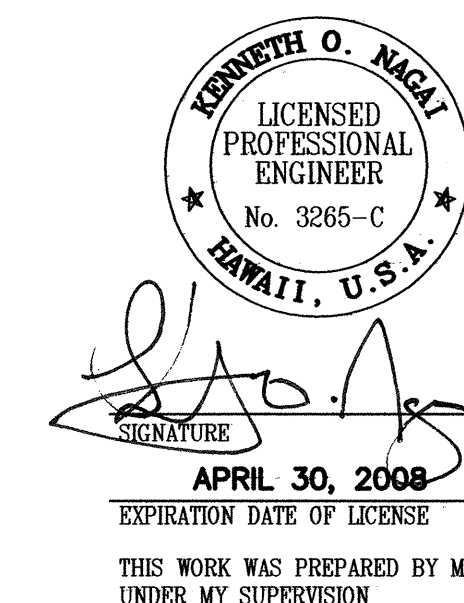

STATE OF HAWAII
DEPARTMENT OF TRANSPORTATION
HIGHWAYS DIVISION

TYPICAL SECTION & DETAIL
PALI HIGHWAY
TRAFFIC OPERATIONAL IMPROVEMENTS
AT VARIOUS INTERSECTIONS & ROADWAYS
PROJECT NO. HWY-0-04-04
PALI HWY./VINEYARD BLVD. INTERSECTION IMPROVEMENTS
SCALE: 1" = 4' DATE: March 2006

SHEET No. C-5 OF 14 SHEETS