

FED. ROAD DIST. NO.	STATE	PROJ. NO.	FISCAL YEAR	SHEET NO.	TOTAL SHEETS
HAWAII	HAW.	HWY-0-04-04	2006	12	45

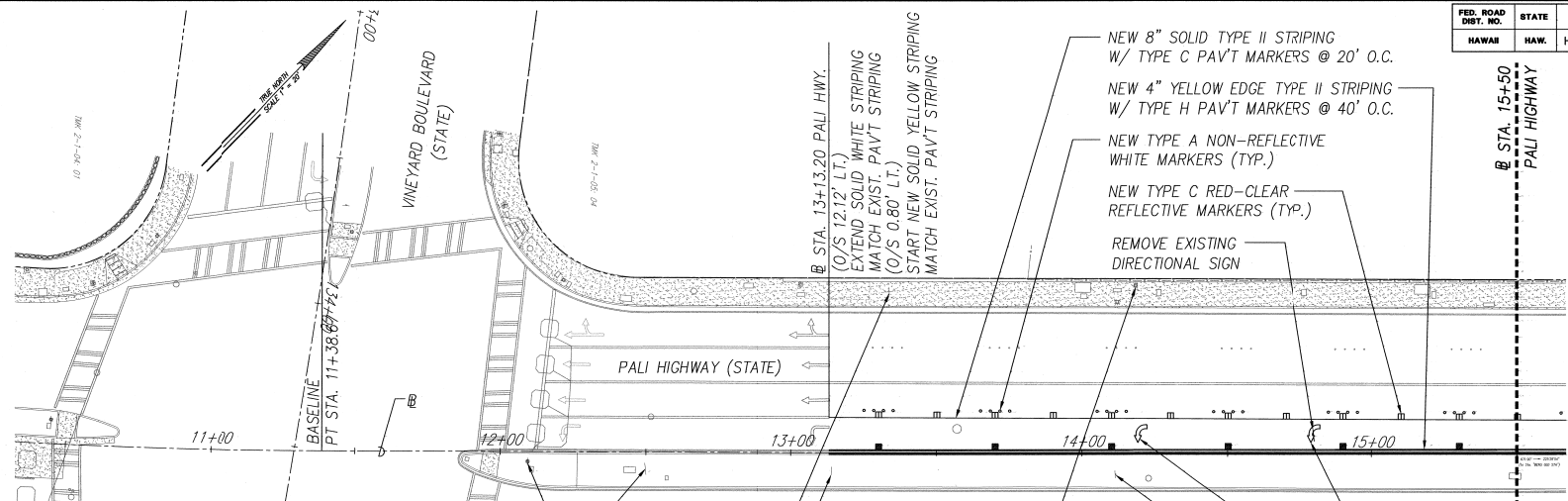

EXIST. 'ON LEFT ARROW ONLY' SIGN TO REMAIN  
 EXIST. DIRECTIONAL ARROW SIGN TO REMAIN  
 EXIST. BUS STOP SIGN TO REMAIN  
 EXIST. 'ADOPT A HIGHWAY' SIGN TO REMAIN  
 EXIST. 'DO NOT CROSS SOLID LINE' SIGN TO REMAIN

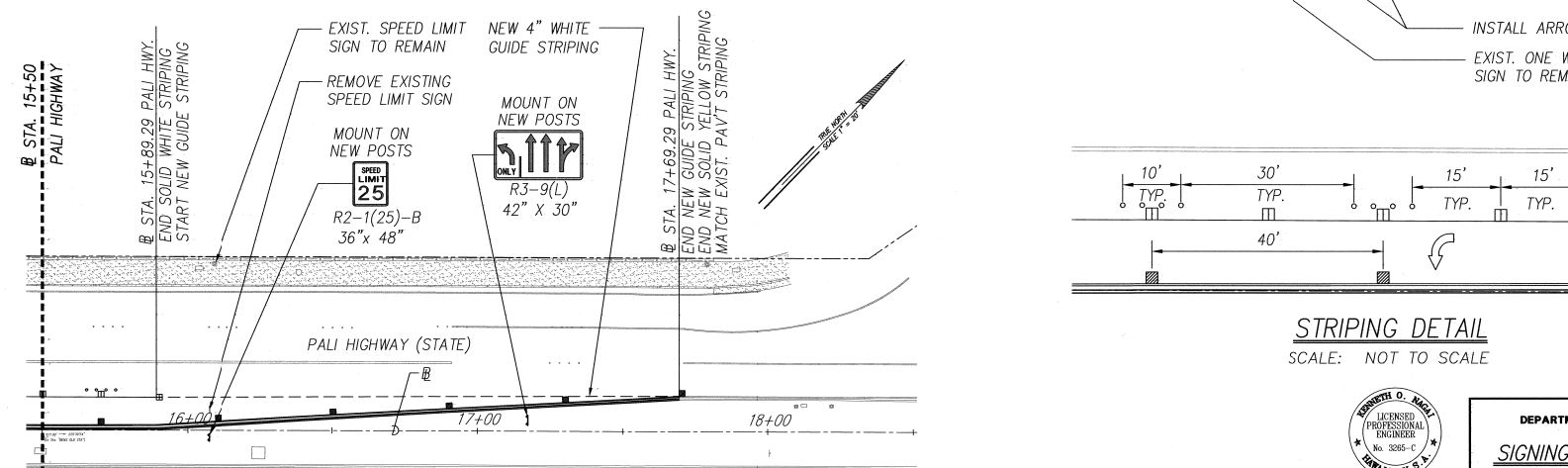

EXIST. SPEED LIMIT SIGN TO REMAIN  
 REMOVE EXISTING SPEED LIMIT SIGN  
 MOUNT ON NEW POSTS  
 R2-1(25)-B  
 36" x 48"  
 NEW 4" WHITE GUIDE STRIPING  
 MOUNT ON NEW POSTS  
 R3-9(L)  
 42" X 30"  
 EXIST. 'ADOPT A HIGHWAY' SIGN TO REMAIN  
 EXIST. 'DO NOT CROSS SOLID LINE' SIGN TO REMAIN

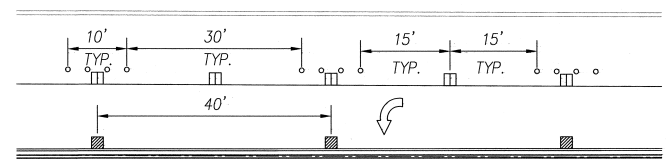

**STRIPING DETAIL**  
 SCALE: NOT TO SCALE

**SIGNING AND STRIPING PLAN - PALI HWY**



DESIGNED BY	DATE
DRAWN BY	
CHECKED BY	
IN CHARGE BY	
APPROVED BY	

**ROBERT O. MAGEE**  
 LICENSED PROFESSIONAL ENGINEER  
 No. 3885-C  
 HAWAII, U.S.A.  
 APRIL 30, 2008  
 EXPIRATION DATE OF LICENSE  
 THIS WORK WAS PREPARED BY ME OR UNDER MY SUPERVISION

STATE OF HAWAII  
 DEPARTMENT OF TRANSPORTATION  
 HIGHWAYS DIVISION  
**SIGNING & STRIPING PLAN**  
**PALI HIGHWAY**  
 TRAFFIC OPERATIONAL IMPROVEMENTS  
 AT VARIOUS INTERSECTIONS & ROADWAYS  
 PROJECT NO. HWY-0-04-04  
 PALI HWY/VINEYARD BLVD. INTERSECTION IMPROVEMENTS  
 SCALE: 1"=20'  
 DATE: March 2006

SHEET No. C-10 OF 14 SHEETS

TRAFFIC OPERATIONAL IMPROVEMENTS AT VARIOUS INTERSECTIONS AND ROADWAYS  
 PROJECT NO. HWY-0-04-04  
 MARCH 14, 2006