

FED. ROAD DIST. NO.	STATE	FED. AID PROJ. NO.	FISCAL YEAR	SHEET NO.	TOTAL SHEETS
OAHU	HAW.	CMAQ-0300(111)	2008	144	203

NOTES:
 1. All Aluminum 6061T6 Alloy and Stainless Steel Components.
 2. Dimensions may vary slightly.

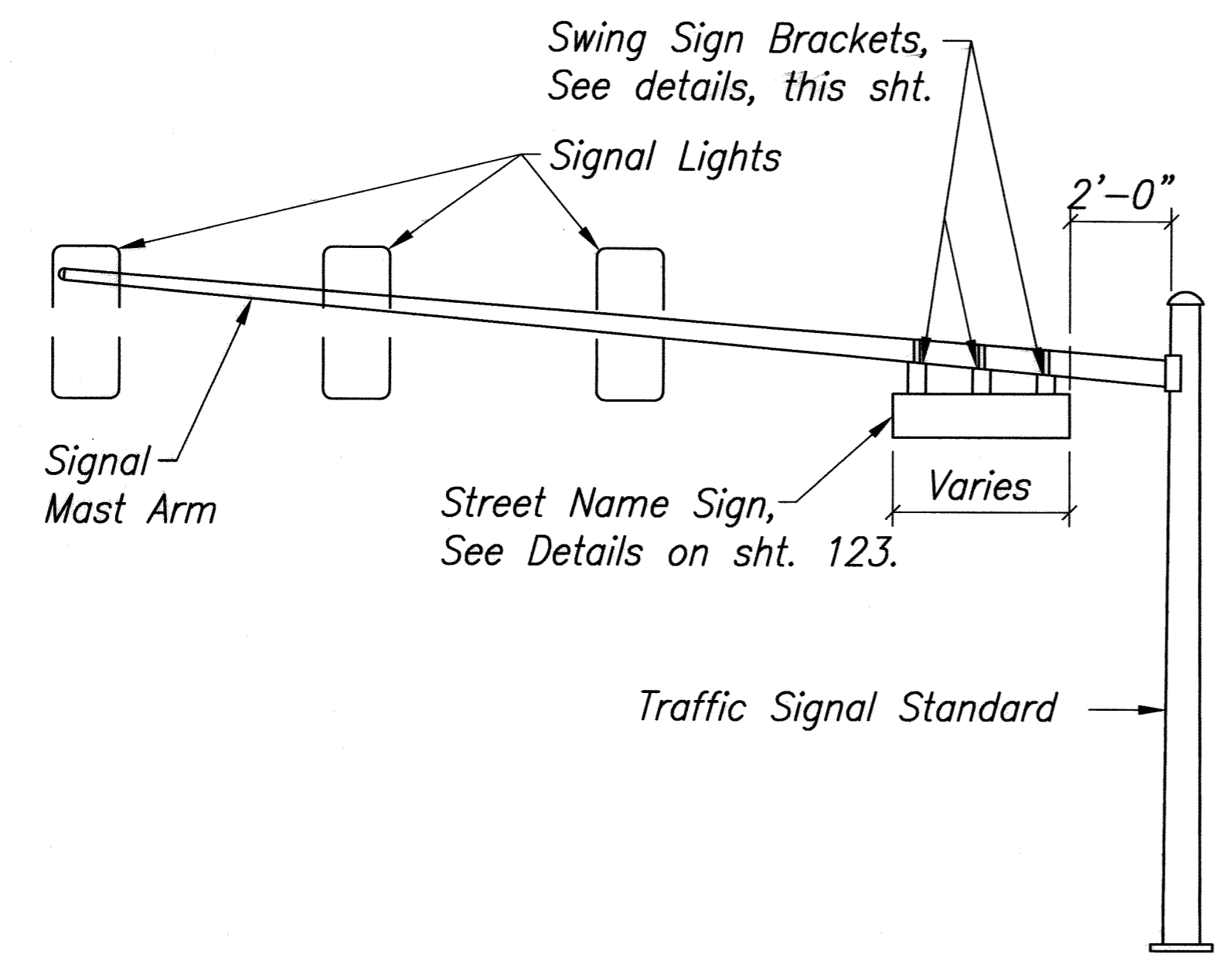

STREET NAME SIGN MOUNTING ON MAST ARM 1
 144
 Not to Scale

MATERIAL CALLOUT

- ① Pivotal Upper Bracket
- ② 1 5/8" x 1/4" Slot for double strapping to electrolier mast arm. (M2G-34S(HD) .030" x 3/4" Heavy Duty Stainless Steel Strap with M2g-34B(HD) Buckle recommended)
- ③ 1/2" - 13 x 1 1/2" Stainless Steel Hex Head Bolt with Stainless Steel Hex Lock Nut and 1/16" Stainless Steel Washer (both sides). Allows upper bracket to pivot and align with electrolier mast arm.
- ④ 6" Overall drop with Fixed Length Sign Bracket
- ⑤ Stainless Steel Dampener Spring (Removable)
- ⑥ Stainless Steel Hex Lock Nut with 1/16" Stainless Steel Washer.
- ⑦ 1" O.D. Axle Housing
- ⑧ 1/2" - 13 x 4" Stainless Steel Hex Head Bolt with 1/16" Stainless Steel Washer.
- ⑨ Oilite Bushing
- ⑩ Sign Mounting Sets, consisting of two each 5/16" - 18 x 1" Stainless Steel Hex Head Bolt with Stainless Steel Hex Lock Nut. Two holes on 1 1/2" centers provide positive lock sign mounting to bracket.
- ⑪ 8 1/4" overall length Upper Adjustable Sign Bracket section.
- ⑫ 9" overall length Lower Adjustable Sign Bracket section, including Axle Housing (8" overall length to top of Axle Housing).
- ⑬ 1/2" - 13 x 1 1/2" Stainless Steel Hex Bolt with Stainless Steel Hex Lock Nut and 1/16" Stainless Steel Washers (both sides). Loosen lock nut, adjust bracket teeth to level sign.
- ⑭ 1 1/4" x 1 1/4" x 1/8" Aluminum Angle

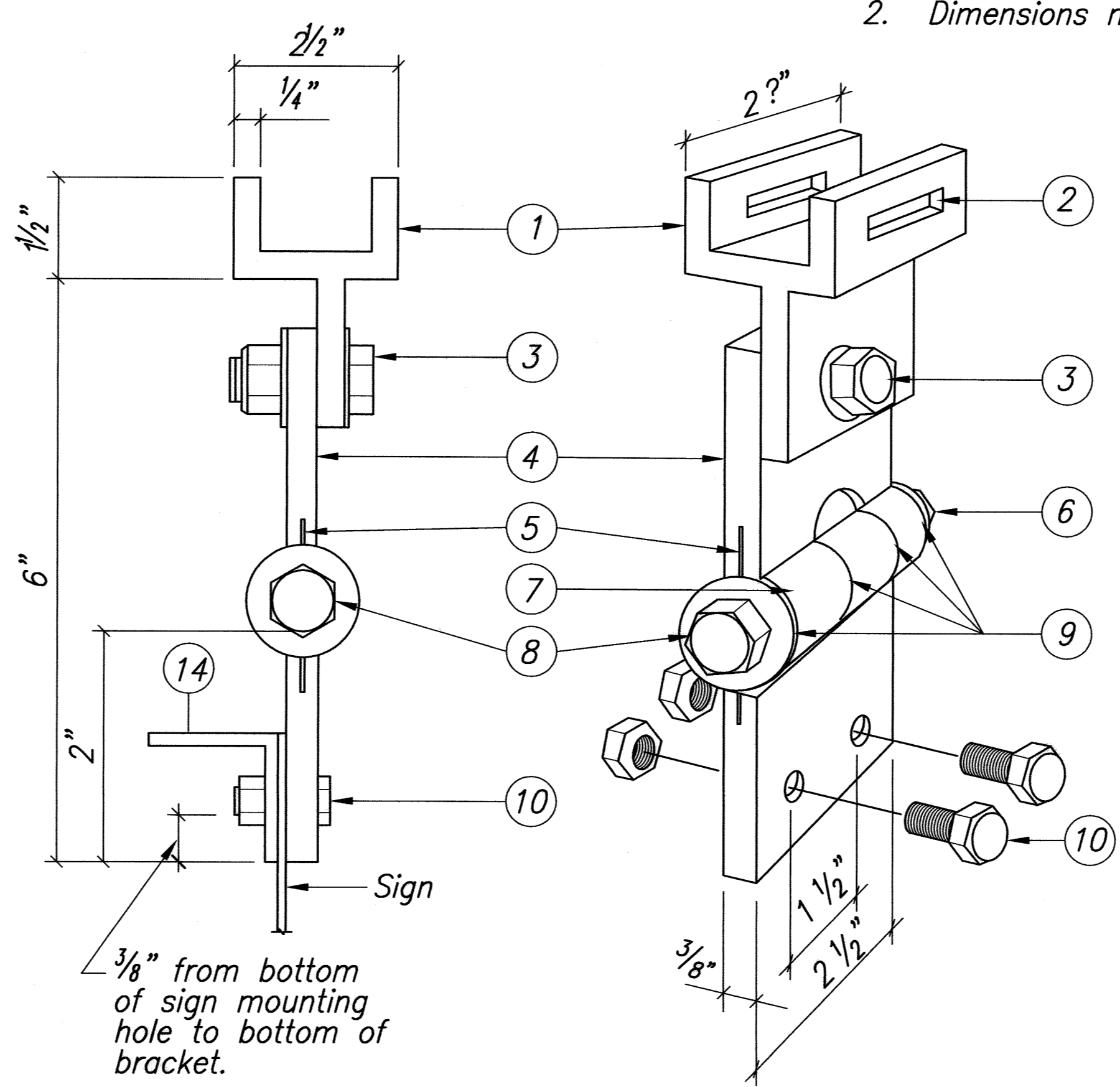

FIXED LENGTH NON-ADJUSTABLE SWING SIGN BRACKET 2
 144
 Not to Scale

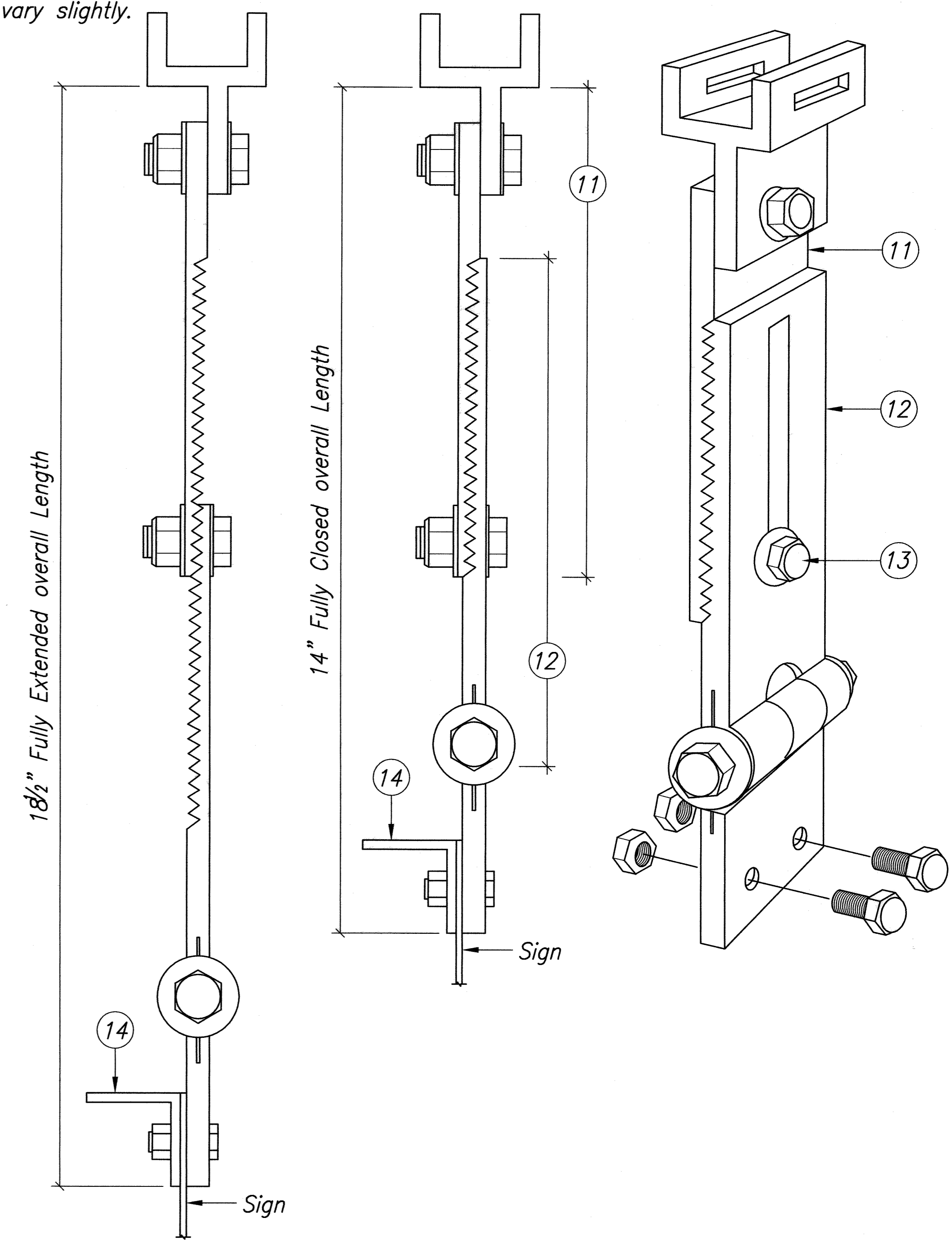

ADJUSTABLE LENGTH SWING SIGN BRACKET 3
 144
 Not to Scale

DATE	_____
DESIGNED BY	_____
TRACED BY	_____
DESIGNED BY	_____
QUANTITIES BY	_____
CHECKED BY	_____
NO.	_____

Plot Date: Aug 25 2008 Plot Time: 2:19 pm
 File: S:\BID\DOT\Oahu\Various\TSM\Urm\Imp-mes01.dwg

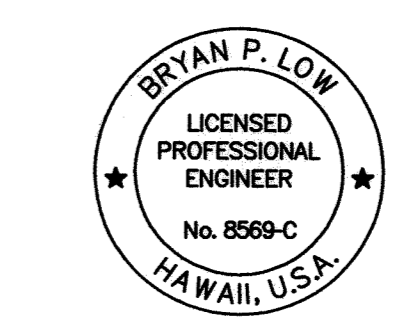

LICENSE EXPIRATION DATE 04/30/10
 THIS WORK WAS PREPARED BY ME
 OR UNDER MY SUPERVISION
 SHIMABUKURO, ENDO & YOSHIZAKI, INC.
 1126 12TH AVENUE
 HONOLULU, HAWAII 96816

STATE OF HAWAII
 DEPARTMENT OF TRANSPORTATION
 HIGHWAYS DIVISION

Mast Arm Sign Mounting Details

Traffic Signal Modernization
 Various Locations - Oahu
 Federal-Aid Project No. CMAQ-0300(111)

Date: July, 2008