

FED. ROAD DIST. NO.	STATE	PROJ. NO.	FISCAL YEAR	SHEET NO.	TOTAL SHEETS
OAHU	HAW.	HWY-0-01-13	2016	47	47

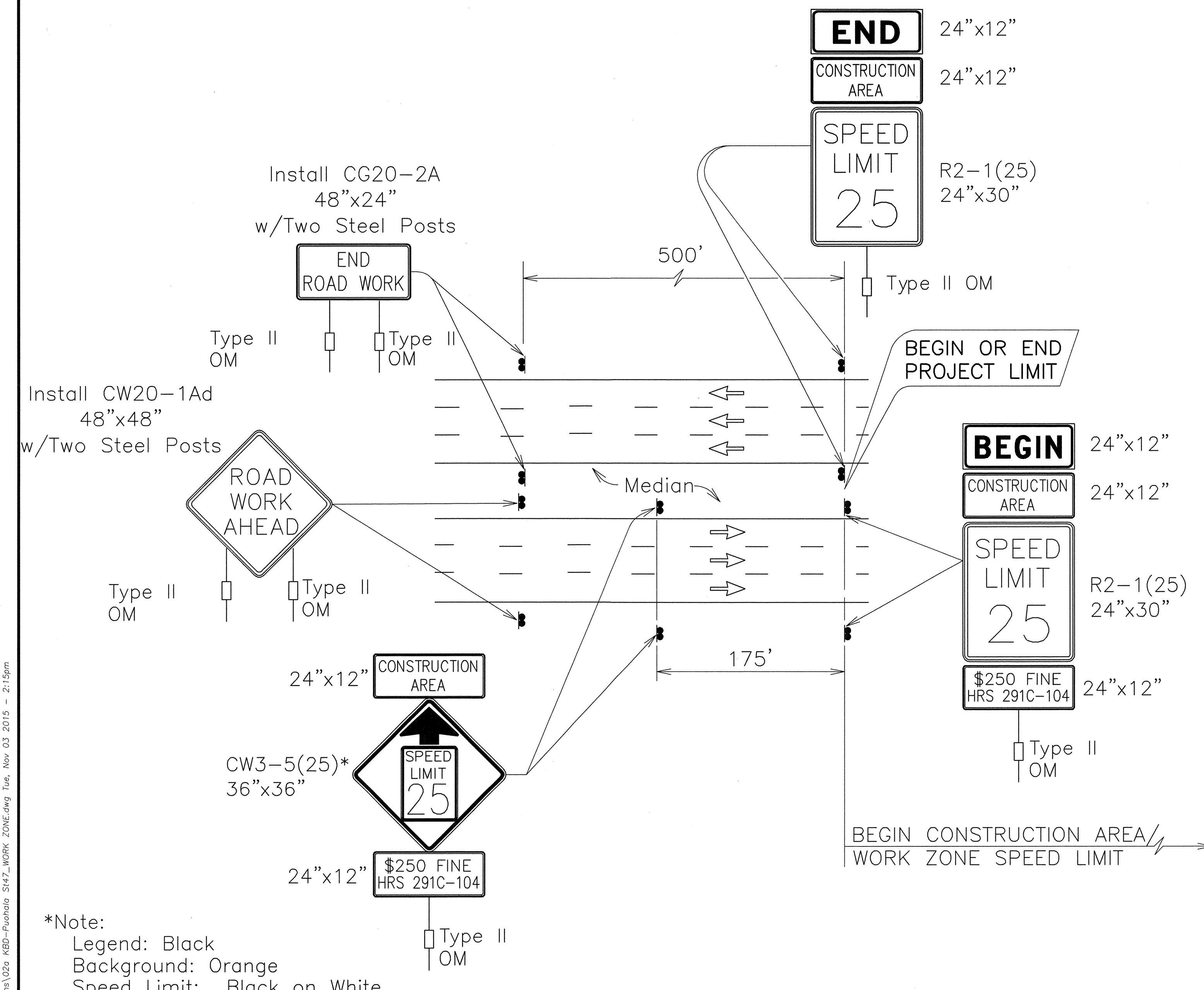

**Work Zone Notes:**

1. This Work Zone Sign Plan is intended for use on long-term stationary work zones/construction phases (3 days or more). All work zones or construction phases less than 3 days duration will use Traffic Control Plans shown in Section 645 of the Special Provisions.
2. All existing regulatory speed limit signs with posts within the work zone/project limits shall be removed and replaced with work zone speed limit sign assemblies (R2-1(25) and CW3-5(25) with "CONSTRUCTION AREA" and "\$250 FINE HRS 291C-104" Supplemental Signs).
3. Construction sign assemblies shall be installed on both the approaching and trailing ends of each work zone as shown on this plan.
4. Each construction warning sign shall have a minimum of two (2) Type II OM. Each work zone speed limit assembly shall have a minimum of one (1) Type II OM. Installation of each Type II OM shall be considered incidental to Item No. 621.7100, Construction Sign with Posts.
5. Upon the completion of all physical work or as directed by the Engineer, all construction signs and work zone speed limit assemblies shall be removed. All speed limit signs and posts that were existing at the start of the project within the work zone/project limits shall be restored back to their original locations and configurations.
6. Placement of construction signs shall not obstruct the path of pedestrians and bicyclists.
7. The removal and restoration of existing regulatory speed limit signs with new posts along with the installation, maintenance and removal of work zone speed limit sign assemblies shall be considered incidental to Item No. 621.7100, Construction Sign with Posts. Sign covers shall be commercially manufactured and HDOT approved. Sign covers shall not allow any portion of the sign being covered to be visible. If the sign has more than one side, cover shall completely cover each side. "Homemade" or "field made" covers shall not be used or accepted.

**TYPICAL DETAIL FOR CONSTRUCTION SIGNS ON MULTILANE DIVIDED LOW SPEED HIGHWAY**

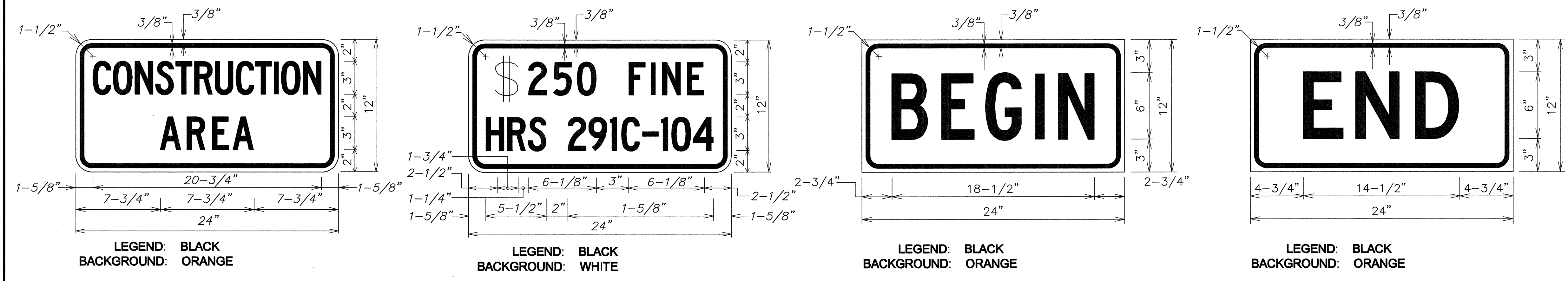

STATE OF HAWAII  
DEPARTMENT OF TRANSPORTATION  
HIGHWAYS DIVISION  
**LOW SPEED DIVIDED HIGHWAY WORK ZONE SIGNING PLAN, NOTES & DETAILS**  
Traffic Operational Improvements at Various Locations  
Vicinity of Kaneohe Bay Drive and Puuhala Street  
Project No. HWY-0-01-13  
Scale: As Noted Date: Oct 2015  
SHEET No. 1 OF 1 SHEETS

ORIGINAL PLAN	DATE
NO. _____	_____
DESIGNED BY _____	_____
CHECKED BY _____	_____
DATE _____	_____

C:\Users\PLM\Documents\Projects\2009-028 Traffic Operational Improvements\Plans\AutoCAD Files\Construction Plans\02a KBD-Puuhala St47\_WORK\_ZONE.dwg Tue, Nov 03 2015 - 2:15pm