

Z:\ACAD\PROJECTS\221023_EWA_3RD_LEVEL\E-E-301_221023_EWA_DEMO_3RD_AREA 01 9/8/2022 2:24PM MPetner

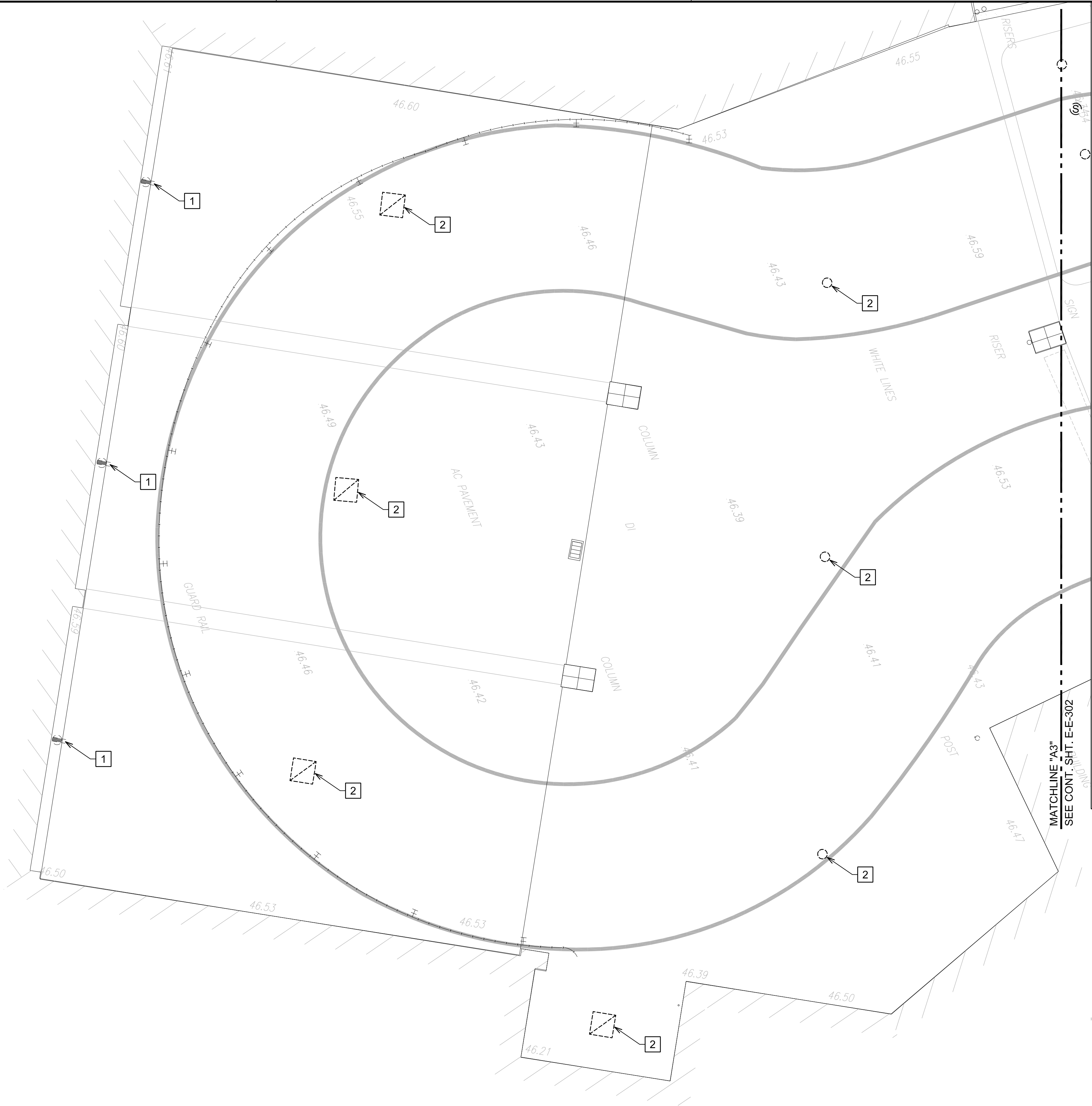

1
E-E-301

DEMOLITION PLAN EWA 3RD FLOOR AREA 1
SCALE: 3/16" = 1'-0"

NOTE(S):

- 1 EXISTING RECEPTACLE TO REMAIN.
2 EXISTING LIGHT FIXTURE TO REMAIN.

MATCHLINE "B3"
SEE CONT. SHT. E-E-302

MATCHLINE "C3"
SEE CONT. SHT. E-E-303

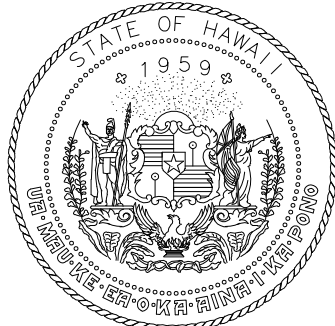
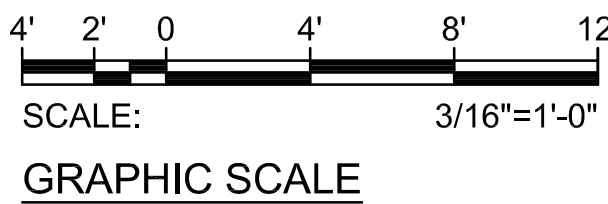

Airports Division
DEPARTMENT OF TRANSPORTATION
STATE OF HAWAII

RONALD N. S. HO & ASSOC., INC.
Electrical Engineers

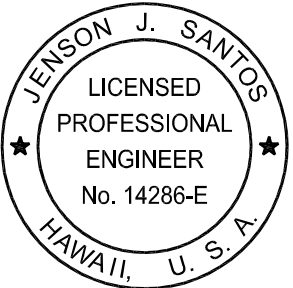

Jenson J. Santos 2022.09.09
THIS WORK WAS PREPARED BY
ME OR UNDER MY SUPERVISION
EXPIRATION DATE OF THE LICENSE:
2024.04.30

DSGN.	DRWN.	CHKD.	APPD.
MP	CAD	JS	JS

KEY PLAN / NOTES:

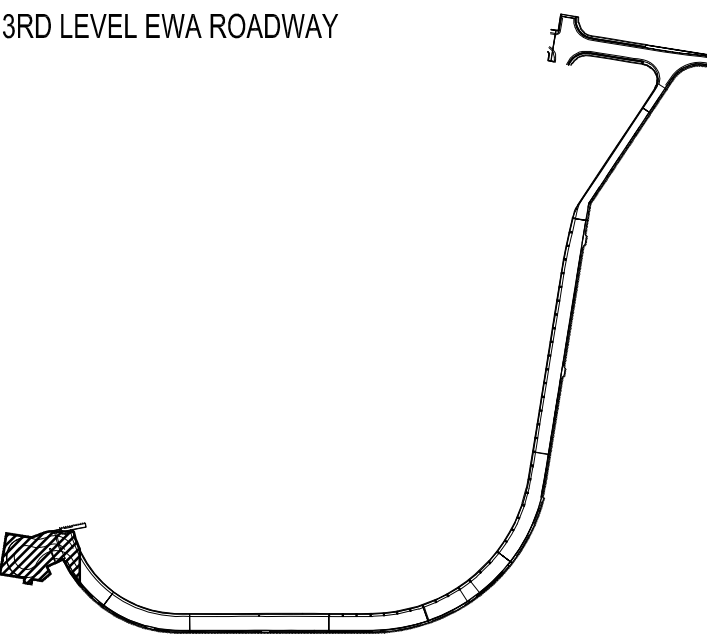

NO.	DATE	REVISIONS
-----	------	-----------

CONSTRUCTION DOCUMENTS

SEPTEMBER, 2022
DATE

PROJECT TITLE :

EWA AND DH CONCOURSE
ROADWAY IMPROVEMENTS
PHASE 1

AT
DANIEL K. INOUE INTERNATIONAL AIRPORT
HONOLULU, OAHU, HAWAII

PROJECT NO.:

AO1043-32

SHEET TITLE:

DEMOLITION PLAN
EWA 3RD FLOOR
AREA 1

DATE :
SEPTEMBER, 2022
SHEET :

DWG. NO.

E-E-301

201 OF 247 SHEETS

Z:\ACAD\PROJECTS\221023_EWA_3RD_LEVEL\E-E-302_221023_EWA_DEMO_3RD_AREA_02_9/8/2022 2:25PM MPetner

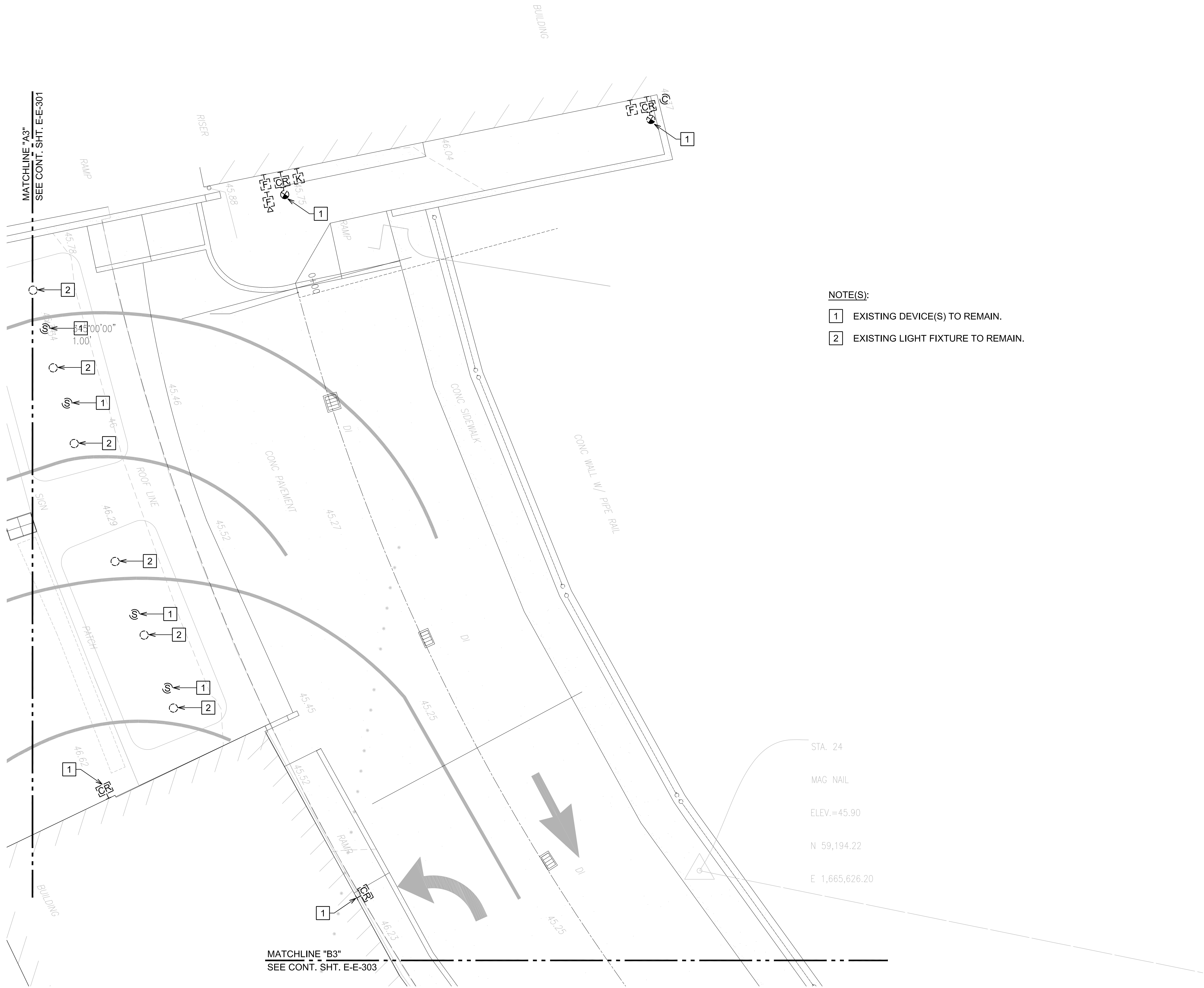

- NOTE(S):
- 1 EXISTING DEVICE(S) TO REMAIN.
 - 2 EXISTING LIGHT FIXTURE TO REMAIN.

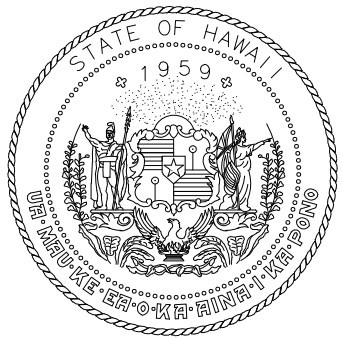

Airports Division
DEPARTMENT OF TRANSPORTATION
STATE OF HAWAII

RONALD N. S. HO & ASSOC., INC.
Electrical Engineers

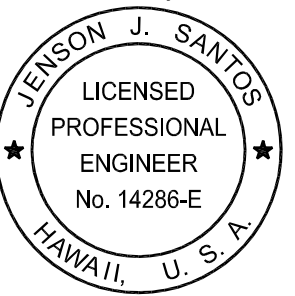

Jenson J. Santos 2022.09.09
THIS WORK WAS PREPARED BY
ME OR UNDER MY SUPERVISION
EXPIRATION DATE OF THE LICENSE:
2024.04.30

DSGN.	DRWN.	CHKD.	APPD.
MP	CAD	JS	JS

KEY PLAN / NOTES:

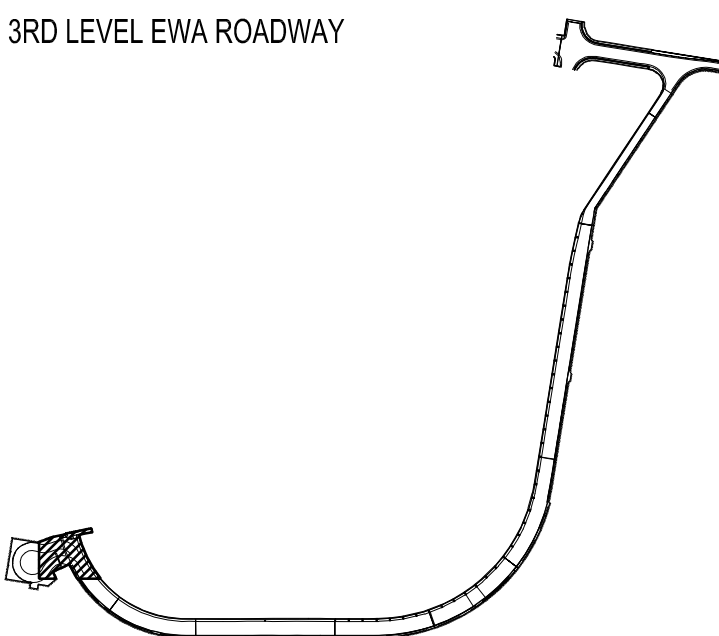

NO.	DATE	REVISIONS

CONSTRUCTION DOCUMENTS

SEPTEMBER, 2022
DATE

PROJECT TITLE :

EWA AND DH CONCOURSE
ROADWAY IMPROVEMENTS
PHASE 1

AT
DANIEL K. INOUE INTERNATIONAL AIRPORT
HONOLULU, OAHU, HAWAII

PROJECT NO.:

AO1043-32

SHEET TITLE:

DEMOLITION PLAN
EWA 3RD FLOOR
AREA 2

DATE :
SEPTEMBER, 2022
SHEET :
202 OF 247 SHEETS

DWG. NO.

E-E-302



1
E-E-302

DEMOLITION PLAN EWA 3RD FLOOR AREA 2
SCALE: 3/16" = 1'-0"

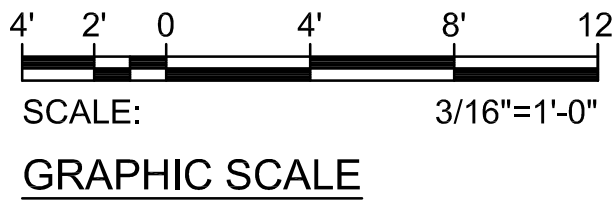

Z:\ACAD\PROJECTS\221023_EWA_3RD_LEVEL\E-E-303_221023_EWA_DEMO_3RD_AREA_03_9/8/2022_2:25PM_MPetner

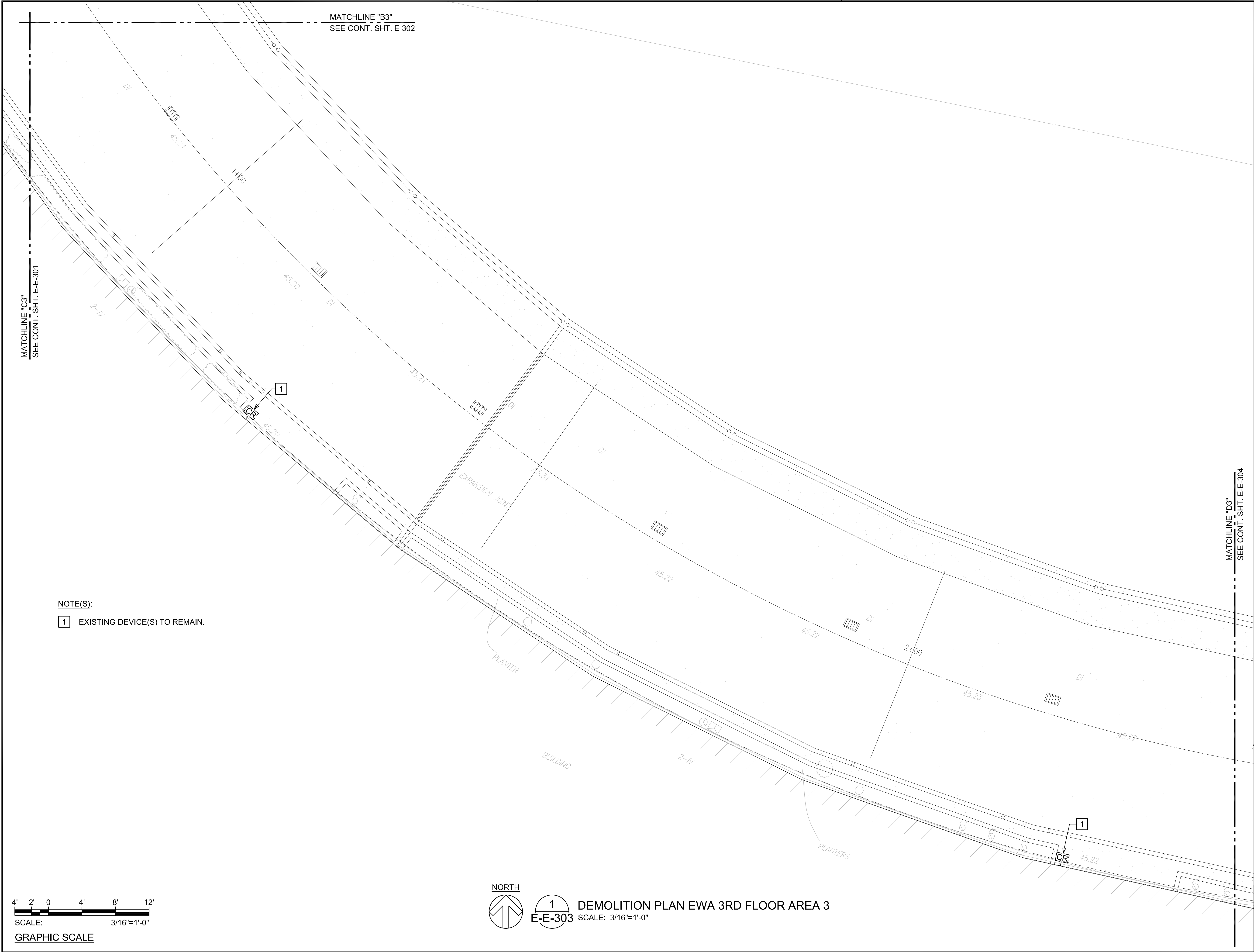

NOTE(S):

- 1 EXISTING DEVICE(S) TO REMAIN.

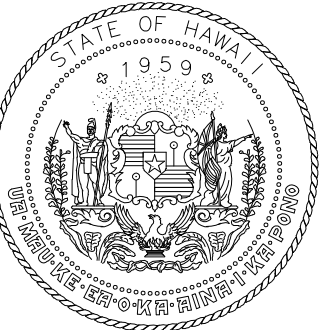

Airports Division
DEPARTMENT OF TRANSPORTATION
STATE OF HAWAII

RONALD N. S. HO & ASSOC., INC.
Electrical Engineers

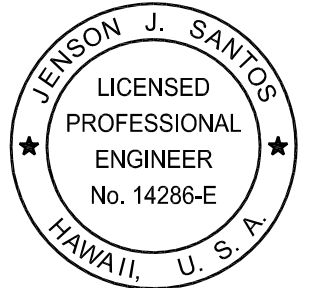

Jenson J. Santos 2022.09.09
THIS WORK WAS PREPARED BY
ME OR UNDER MY SUPERVISION
EXPIRATION DATE OF THE LICENSE:
2024.04.30

DSGN.	DRWN.	CHKD.	APPD.
MP	CAD	JS	JS

KEY PLAN / NOTES:

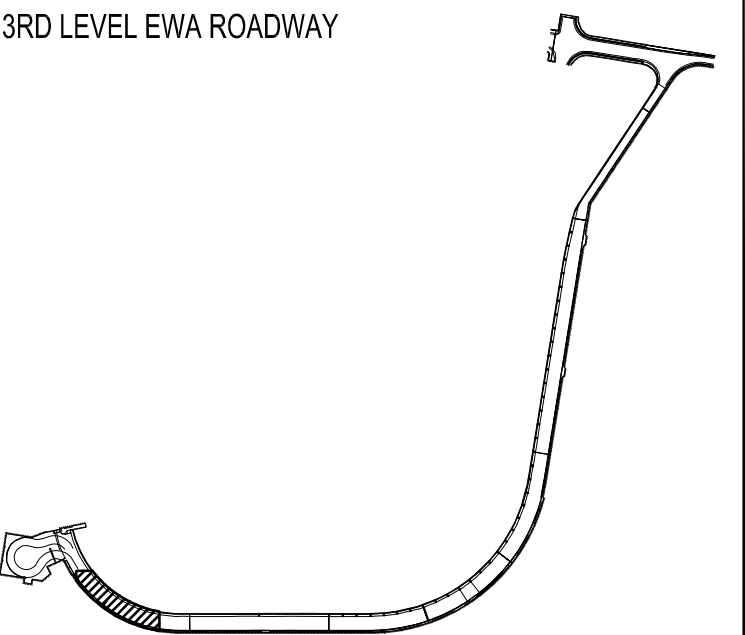

NO.	DATE	REVISIONS
-----	------	-----------

CONSTRUCTION
DOCUMENTS

SEPTEMBER, 2022
DATE

PROJECT TITLE :

EWA AND DH CONCOURSE
ROADWAY IMPROVEMENTS
PHASE 1

AT
DANIEL K. INOUE INTERNATIONAL AIRPORT
HONOLULU, OAHU, HAWAII

PROJECT NO.:

AO1043-32

SHEET TITLE:

DEMOLITION PLAN
EWA 3RD FLOOR
AREA 3

DATE :

SEPTEMBER, 2022

SHEET :

203 OF 247 SHEETS

DWG. NO.

E-E-303

Z:\ACAD\PROJECTS\221023_EWA_3RD_LEVEL\E-E-304_221023_EWA_DEMO_3RD_AREA 04 9/8/2022 2:26PM MPetner

MATCHLINE "D3"
SEE CONT. SHT. E-E-303

NOTE(S):

1. NO EXISTING DEVICE(S) OR LIGHT FIXTURES.



1
E-E-304

DEMOLITION PLAN EWA 3RD FLOOR AREA 4
SCALE: 3/16"=1'-0"

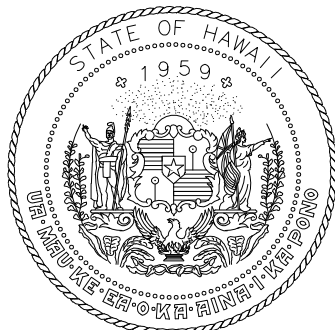
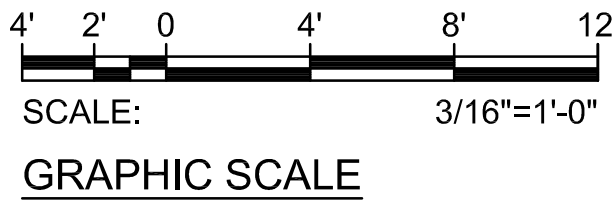

Airports Division
DEPARTMENT OF TRANSPORTATION
STATE OF HAWAII

RONALD N. S. HO & ASSOC., INC.
Electrical Engineers

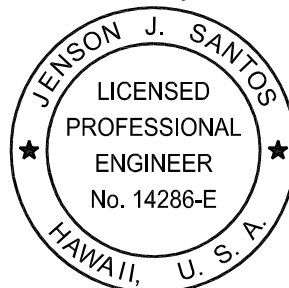

Jenson J. Santos 2022.09.09
THIS WORK WAS PREPARED BY
ME OR UNDER MY SUPERVISION
EXPIRATION DATE OF THE LICENSE:
2024.04.30

DSGN.	DRWN.	CHKD.	APPD.
MP	CAD	JS	JS

KEY PLAN / NOTES:

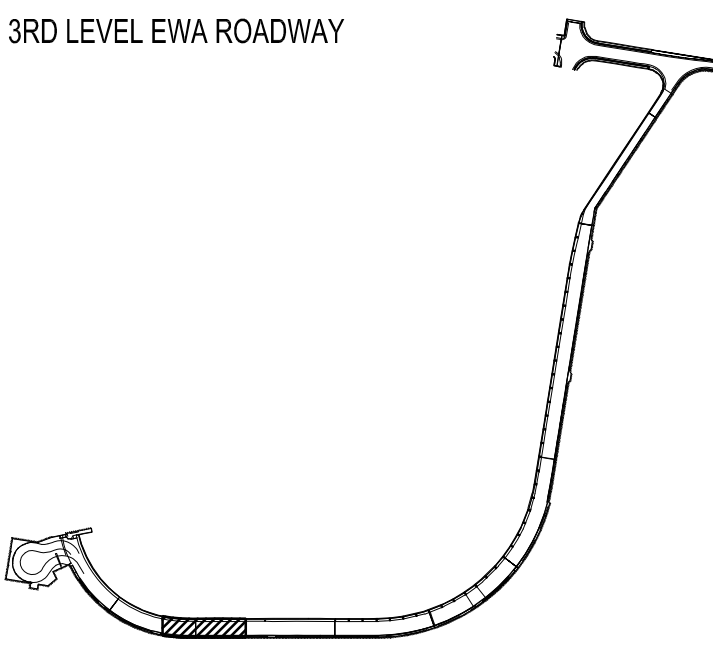

NO.	DATE	REVISIONS

CONSTRUCTION DOCUMENTS

SEPTEMBER, 2022
DATE

PROJECT TITLE :

EWA AND DH CONCOURSE
ROADWAY IMPROVEMENTS
PHASE 1

AT
DANIEL K. INOUE INTERNATIONAL AIRPORT
HONOLULU, OAHU, HAWAII

PROJECT NO.:

AO1043-32

SHEET TITLE:

DEMOLITION PLAN
EWA 3RD FLOOR
AREA 4

DATE :	DWG. NO.
SEPTEMBER, 2022	E-E-304
SHEET :	
204 OF 247 SHEETS	

Z:\ACAD\PROJECTS\221023_EWA_3RD_LEVEL\E-E-305_221023_EWA_DEMO_3RD_AREA_05_9/8/2022_2:26PM_MPetner
MATCHLINE "E3"
SEE CONT. SHT. E-E-304

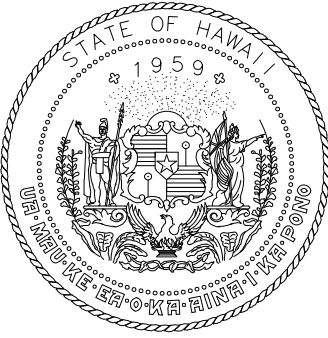
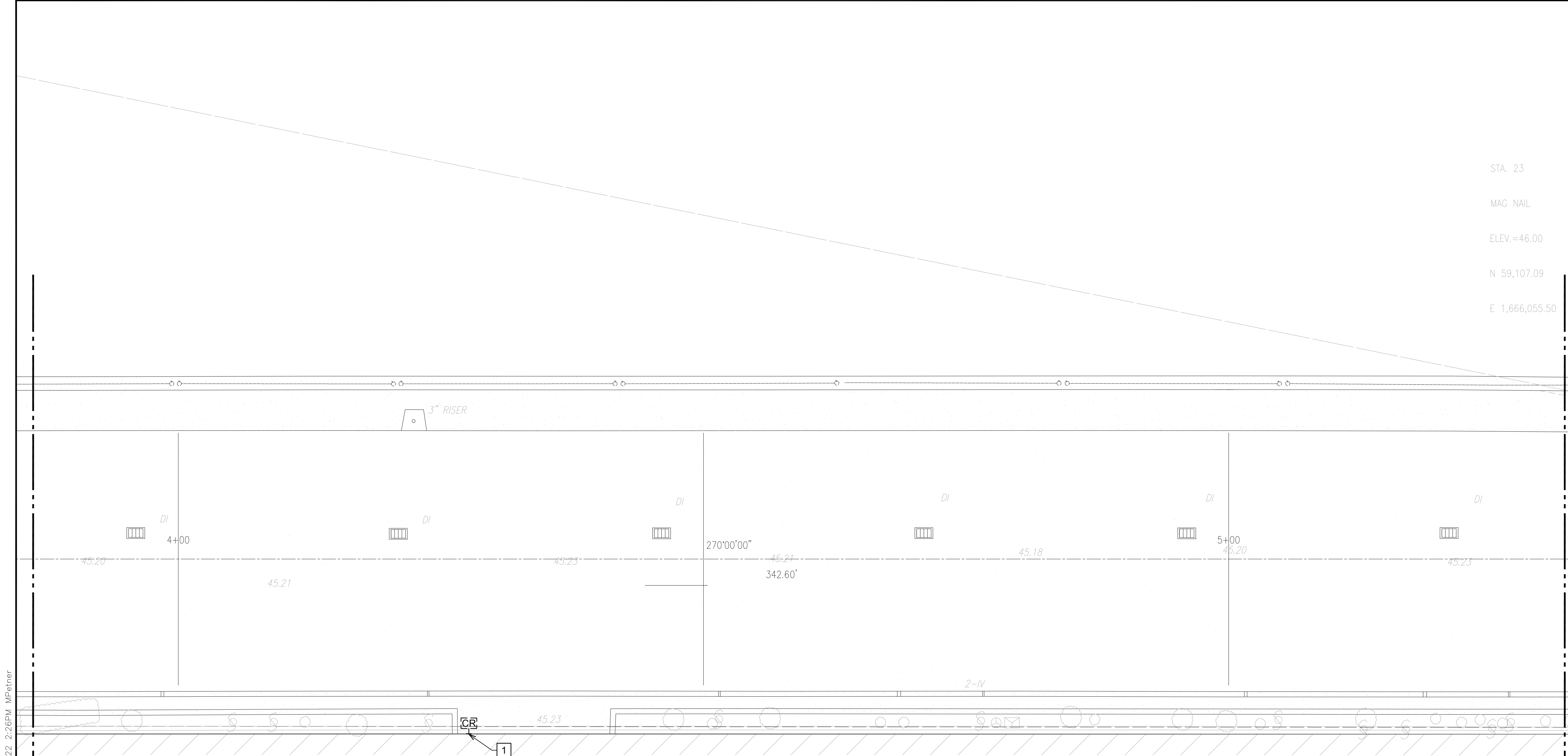

Airports Division
DEPARTMENT OF TRANSPORTATION
STATE OF HAWAII

RONALD N. S. HO & ASSOC., INC.
Electrical Engineers

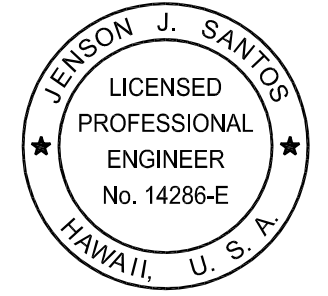

Jenson J. Santos 2022.09.09
THIS WORK WAS PREPARED BY
ME OR UNDER MY SUPERVISION
EXPIRATION DATE OF THE LICENSE:
2024.04.30

DSGN.	DRWN.	CHKD.	APPD.
MP	CAD	JS	JS

KEY PLAN / NOTES:

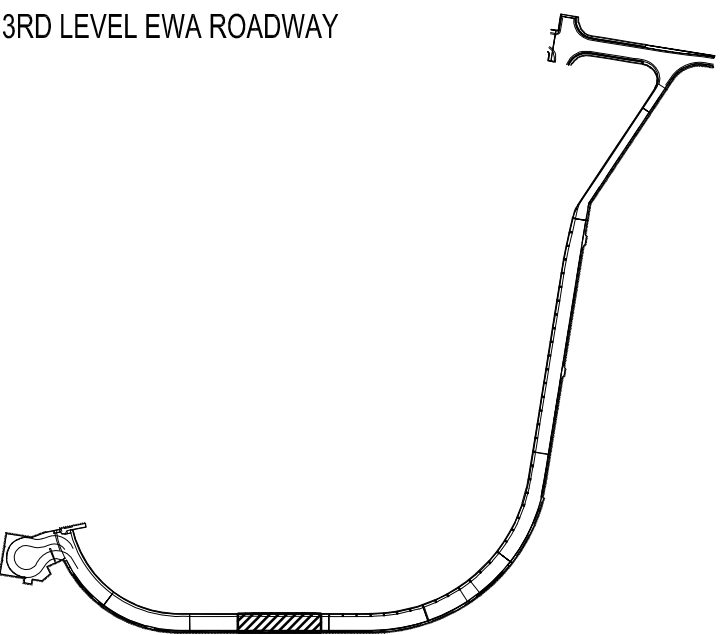

NO.	DATE	REVISIONS

CONSTRUCTION DOCUMENTS

SEPTEMBER, 2022
DATE

PROJECT TITLE :

EWA AND DH CONCOURSE
ROADWAY IMPROVEMENTS
PHASE 1

AT
DANIEL K. INOUE INTERNATIONAL AIRPORT
HONOLULU, OAHU, HAWAII

PROJECT NO.:

AO1043-32

SHEET TITLE:

DEMOLITION PLAN
EWA 3RD FLOOR
AREA 5

DATE :	DWG. NO.
SEPTEMBER, 2022	E-E-305
SHEET :	
205 OF 247 SHEETS	

NOTE(S):

- 1 EXISTING DEVICE(S) TO REMAIN.



1
E-E-305

DEMOLITION PLAN EWA 3RD FLOOR AREA 5
SCALE: 3/16"=1'-0"

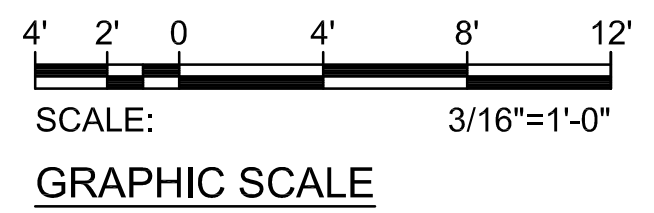

Z:\ACAD\PROJECTS\221023_EWA_3RD_LEVEL\E-E-306_221023_EWA_DEMO_3RD_AREA_06_9/9/2022_5:16PM_MPetner

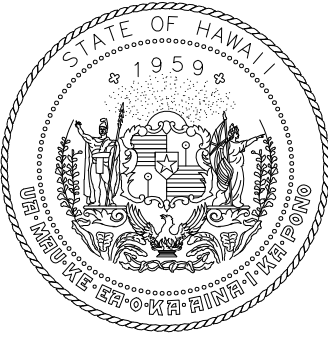
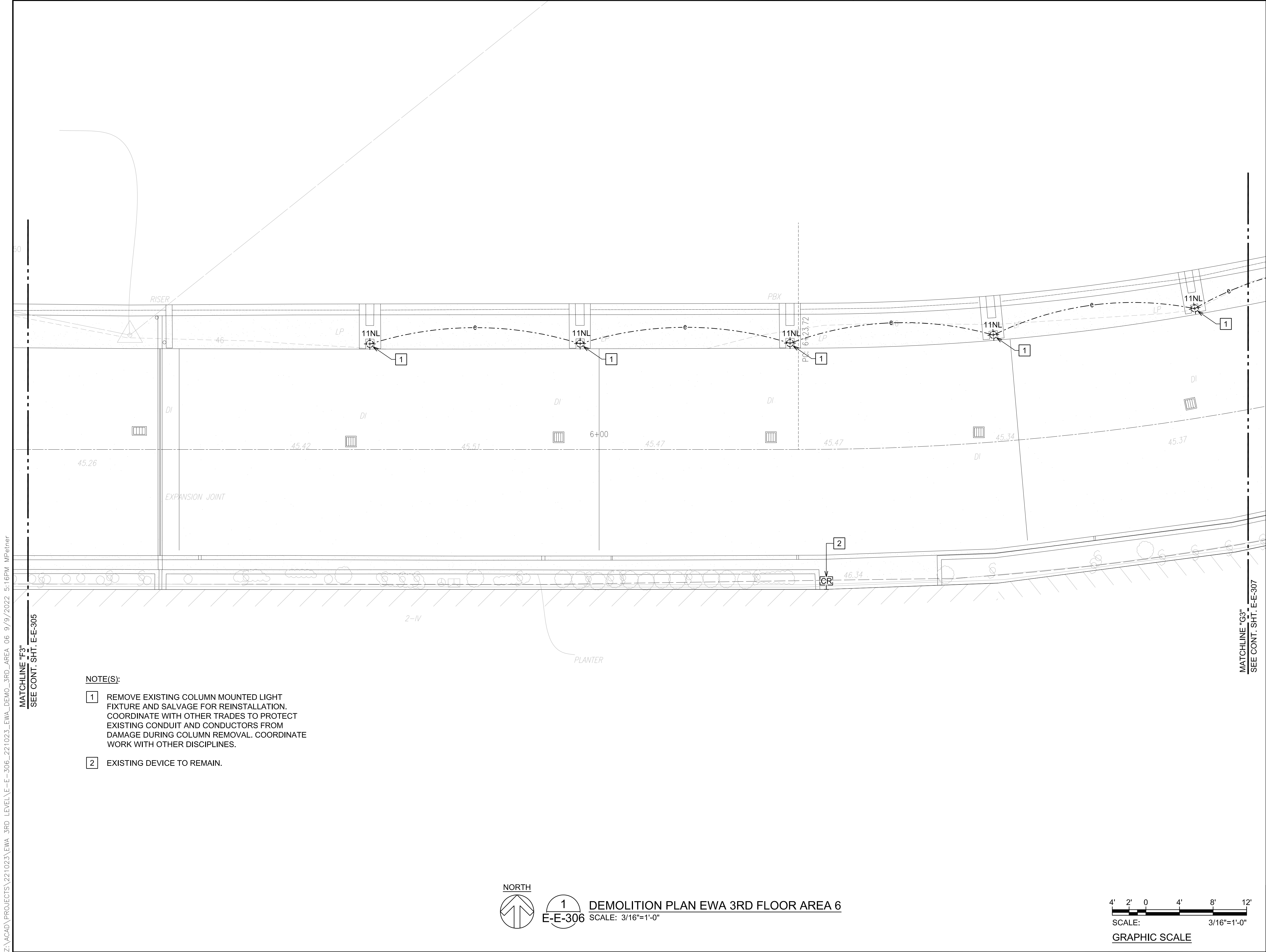

Airports Division
DEPARTMENT OF TRANSPORTATION
STATE OF HAWAII

RONALD N. S. HO & ASSOC., INC.
Electrical Engineers

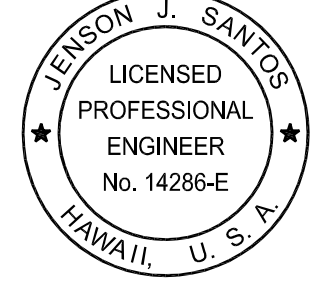

Jenson J. Santos 2022.09.09
THIS WORK WAS PREPARED BY
ME OR UNDER MY SUPERVISION
EXPIRATION DATE OF THE LICENSE:
2024.04.30

DSGN.	DRWN.	CHKD.	APPD.
MP	CAD	JS	JS

KEY PLAN / NOTES:

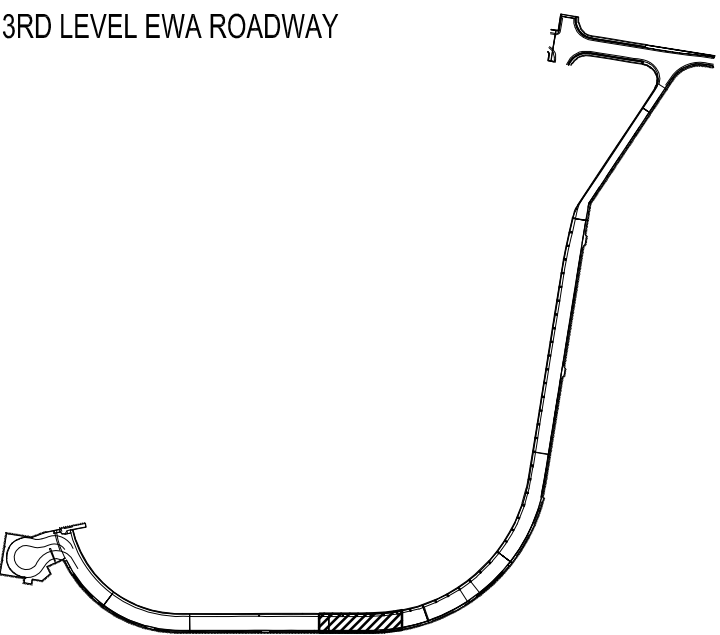

NO.	DATE	REVISIONS

CONSTRUCTION DOCUMENTS
SEPTEMBER, 2022
DATE

PROJECT TITLE :
EWA AND DH CONCOURSE
ROADWAY IMPROVEMENTS
PHASE 1
AT
DANIEL K. INOUE INTERNATIONAL AIRPORT
HONOLULU, OAHU, HAWAII

PROJECT NO.:

AO1043-32

SHEET TITLE:

DEMOLITION PLAN
EWA 3RD FLOOR
AREA 6

DATE :	DWG. NO.
SEPTEMBER, 2022	E-E-306
SHEET :	
206 OF 247 SHEETS	

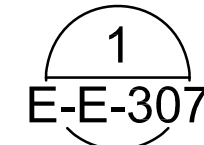

Z:\ACAD\PROJECTS\221023_EWA_3RD_LEVEL\E-E-308_221023_EWA_DEMO_3RD_AREA 08 9/8/2022 2:29PM MPetner

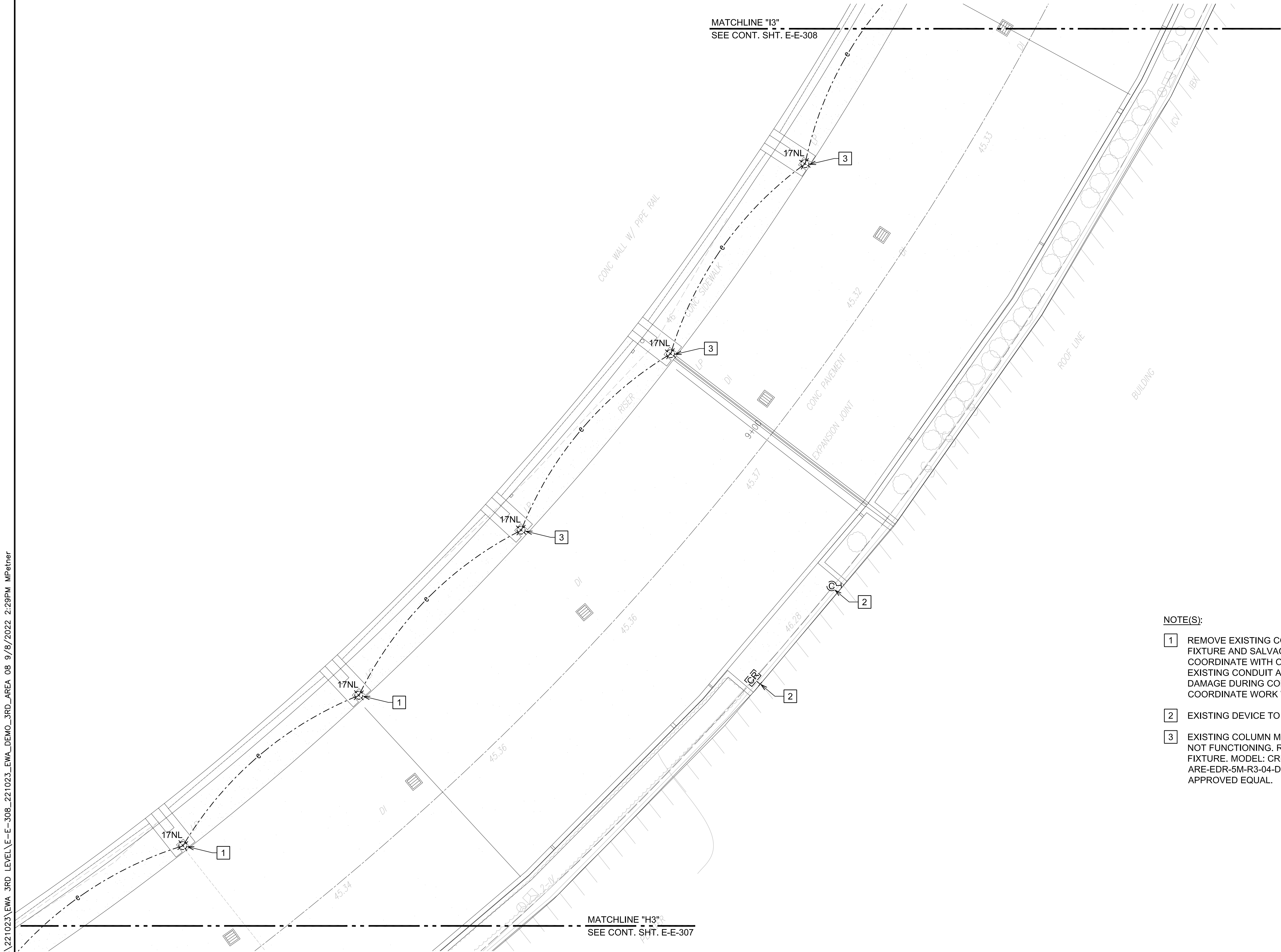

- NOTE(S):
- 1 REMOVE EXISTING COLUMN MOUNTED LIGHT FIXTURE AND SALVAGE FOR REINSTALLATION. COORDINATE WITH OTHER TRADES TO PROTECT EXISTING CONDUIT AND CONDUCTORS FROM DAMAGE DURING COLUMN REMOVAL. COORDINATE WORK WITH OTHER DISCIPLINES.
 - 2 EXISTING DEVICE TO REMAIN.
 - 3 EXISTING COLUMN MOUNTED LIGHT FIXTURE NOT FUNCTIONING. REPLACE WITH NEW LIGHT FIXTURE. MODEL: CREE ARE-EDR-5M-R3-04-D-UL-BK-525-40K-TL OR APPROVED EQUAL.



1
E-E-308

DEMOLITION PLAN EWA 3RD FLOOR AREA 8
SCALE: 3/16"=1'-0"

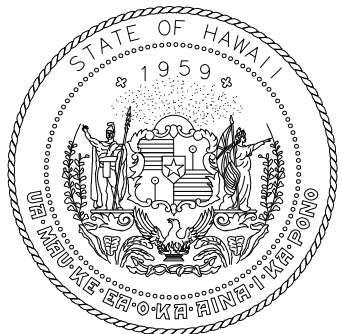
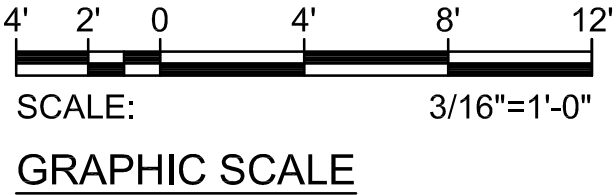

Airports Division
DEPARTMENT OF TRANSPORTATION
STATE OF HAWAII

RONALD N. S. HO & ASSOC., INC.
Electrical Engineers

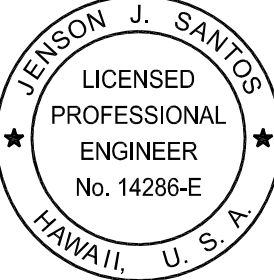

Jenson J. Santos 2022.09.09
THIS WORK WAS PREPARED BY
ME OR UNDER MY SUPERVISION
EXPIRATION DATE OF THE LICENSE:
2024.04.30

DSGN.	DRWN.	CHKD.	APPD.
MP	CAD	JS	JS

KEY PLAN / NOTES:

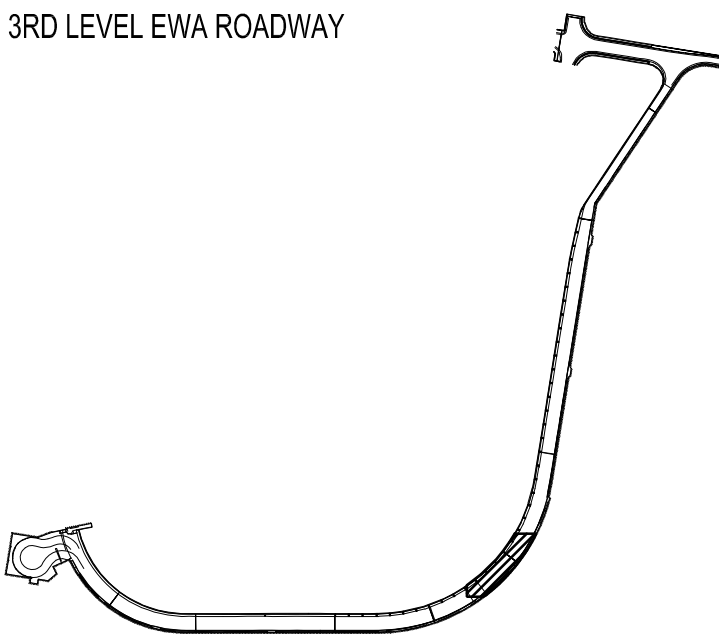

NO.	DATE	REVISIONS

CONSTRUCTION DOCUMENTS

SEPTEMBER, 2022
DATE

PROJECT TITLE :

EWA AND DH CONCOURSE
ROADWAY IMPROVEMENTS
PHASE 1

AT
DANIEL K. INOUE INTERNATIONAL AIRPORT
HONOLULU, OAHU, HAWAII

PROJECT NO.:

AO1043-32

SHEET TITLE:

DEMOLITION PLAN
EWA 3RD FLOOR
AREA 8

DATE :
SEPTEMBER, 2022
SHEET :

DWG. NO.

E-E-308

208 OF 247 SHEETS

Z:\ACAD\PROJECTS\221023\EWA 3RD LEVEL\E-E-309_221023_EWA_DEMO_3RD_AREA 09 9/8/2022 2:30PM MPetner

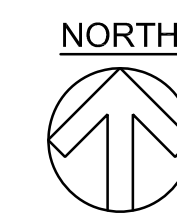

DEMOLITION PLAN EWA 3RD FLOOR AREA 9
SCALE: 3/16"=1'-0"

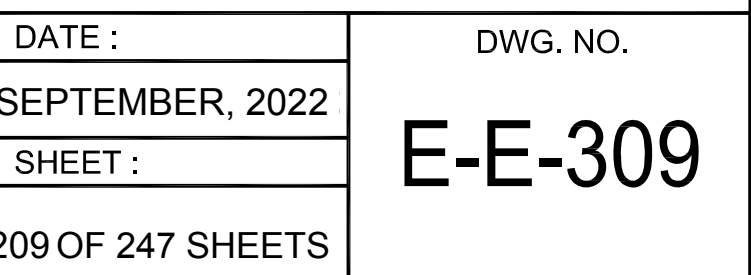
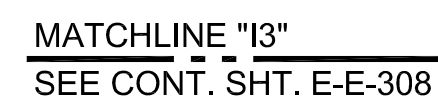

Z:\ACAD\PROJECTS\221023_EWA_3RD_LEVEL\E-E-310_221023_EWA_DEMO_3RD_AREA 10 9/9/2022 5:14PM MPetner

MATCHLINE "K3"
SEE CONT. SHT. E-E-311

STA. 22
MAG NAIL
ELEV.=46.06
N 59,405.63
E 1,666,428.79

MATCHLINE "J3"
SEE CONT. SHT. E-E-309

19NL

1

19NL

1

17NL

1

17NL

1

NOTE(S):

1 REMOVE EXISTING COLUMN MOUNTED LIGHT
FIXTURE AND SALVAGE FOR REINSTALLATION.
COORDINATE WITH OTHER TRADES TO PROTECT
EXISTING CONDUIT AND CONDUCTORS FROM
DAMAGE DURING COLUMN REMOVAL.



1
E-E-310

DEMOLITION PLAN EWA 3RD FLOOR AREA 10
SCALE: 3/16"=1'-0"

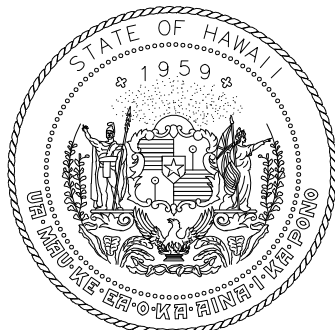
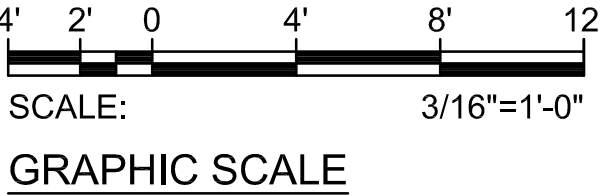

Airports Division
DEPARTMENT OF TRANSPORTATION
STATE OF HAWAII

RONALD N. S. HO & ASSOC., INC.
Electrical Engineers

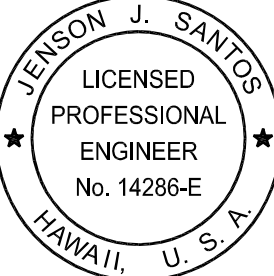

Jenson J. Santos 2022.09.09
THIS WORK WAS PREPARED BY
ME OR UNDER MY SUPERVISION
EXPIRATION DATE OF THE LICENSE:
2024.04.30

DSGN.	DRWN.	CHKD.	APPD.
MP	CAD	JS	JS

KEY PLAN / NOTES:

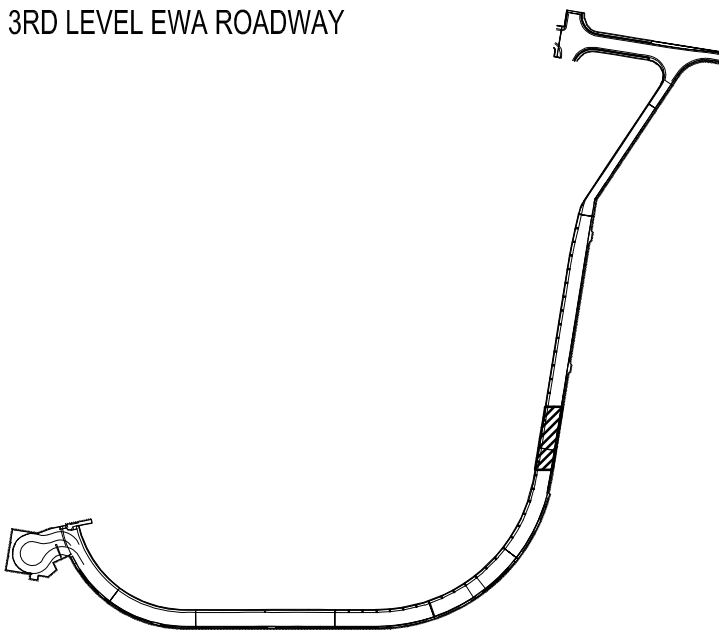

NO.	DATE	REVISIONS

CONSTRUCTION
DOCUMENTS

SEPTEMBER, 2022
DATE

PROJECT TITLE :

EWA AND DH CONCOURSE
ROADWAY IMPROVEMENTS
PHASE 1

AT
DANIEL K. INOUE INTERNATIONAL AIRPORT
HONOLULU, OAHU, HAWAII

PROJECT NO.:

AO1043-32

SHEET TITLE:

DEMOLITION PLAN
EWA 3RD FLOOR
AREA 10

DATE :
SEPTEMBER, 2022
SHEET :

DWG. NO.

E-E-310

210 OF 247 SHEETS

Z:\ACAD\PROJECTS\221023_EWA_3RD_LEVEL\E-E-311_221023_EWA_DEMO_3RD_AREA 11 9/8/2022 2:30PM MPetner

MATCHLINE "L3"
SEE CONT. SHT. E-E-312

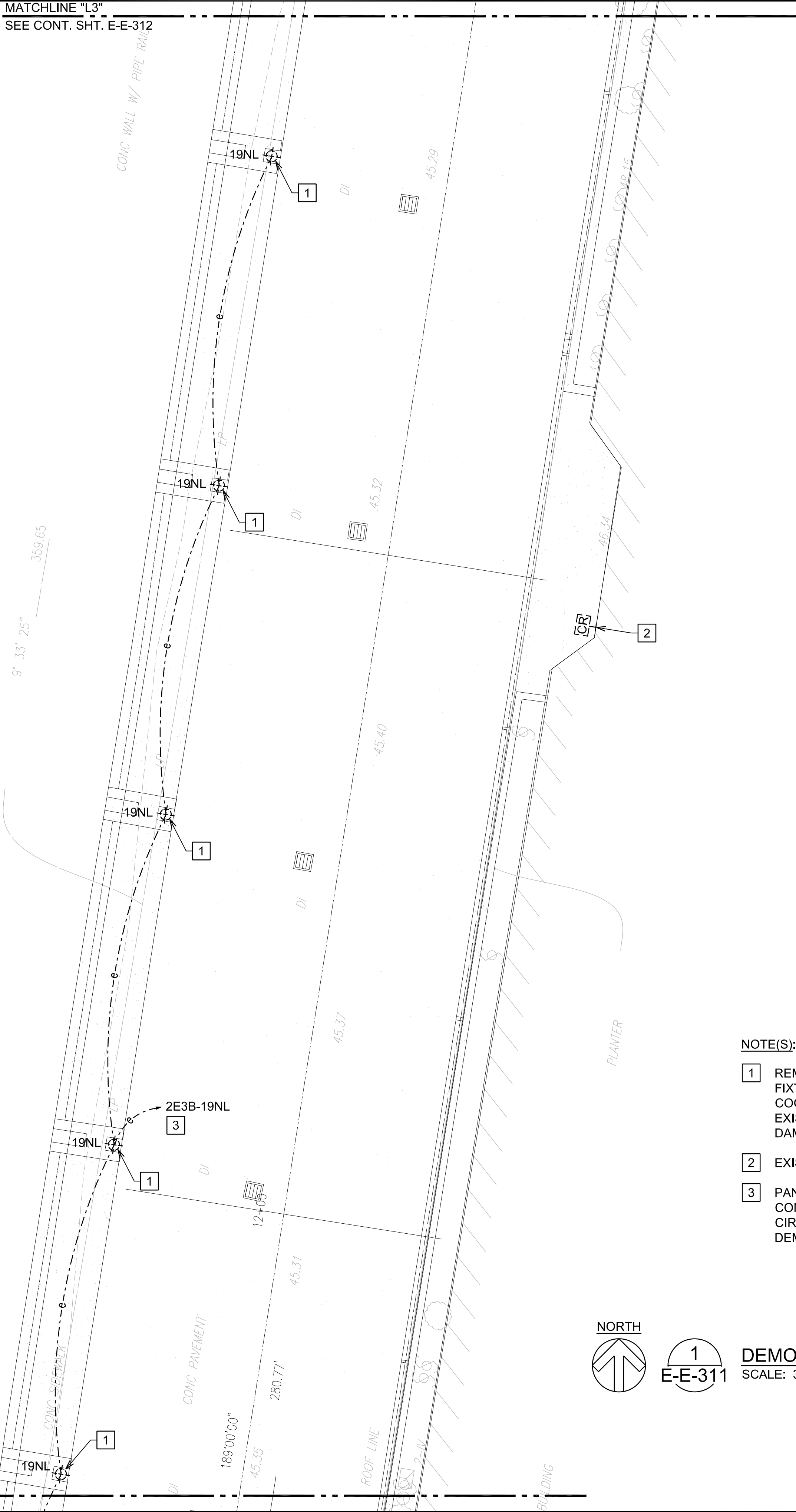

NOTE(S):

- 1 REMOVE EXISTING COLUMN MOUNTED LIGHT FIXTURE AND SALVAGE FOR REINSTALLATION. COORDINATE WITH OTHER TRADES TO PROTECT EXISTING CONDUIT AND CONDUCTORS FROM DAMAGE DURING COLUMN REMOVAL.
- 2 EXISTING DEVICE TO REMAIN.
- 3 PANEL "2E3B" LOCATED IN ELECTRICAL ROOM "E3F". CONTRACTOR TO VERIFY CIRCUIT NUMBER AND CIRCUIT ROUTE PRIOR TO THE START OF DEMOLITION. MARK-UP AS-BUILTS ACCORDINGLY.



1
E-E-311

DEMOLITION PLAN EWA 3RD FLOOR AREA 11
SCALE: 3/16"=1'-0"

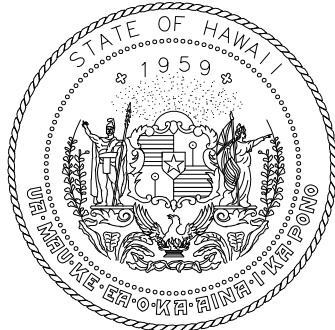
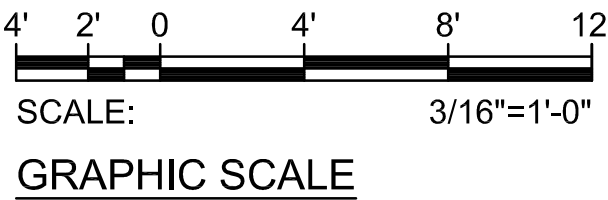

Airports Division
DEPARTMENT OF TRANSPORTATION
STATE OF HAWAII

RONALD N. S. HO & ASSOC., INC.
Electrical Engineers

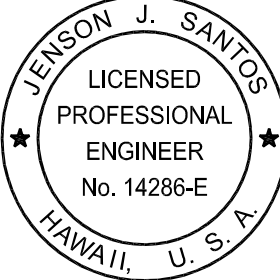

Jenson J. Santos 2022.09.09
THIS WORK WAS PREPARED BY
ME OR UNDER MY SUPERVISION
EXPIRATION DATE OF THE LICENSE:
2024.04.30

DSGN.	DRWN.	CHKD.	APPD.
MP	CAD	JS	JS

KEY PLAN / NOTES:

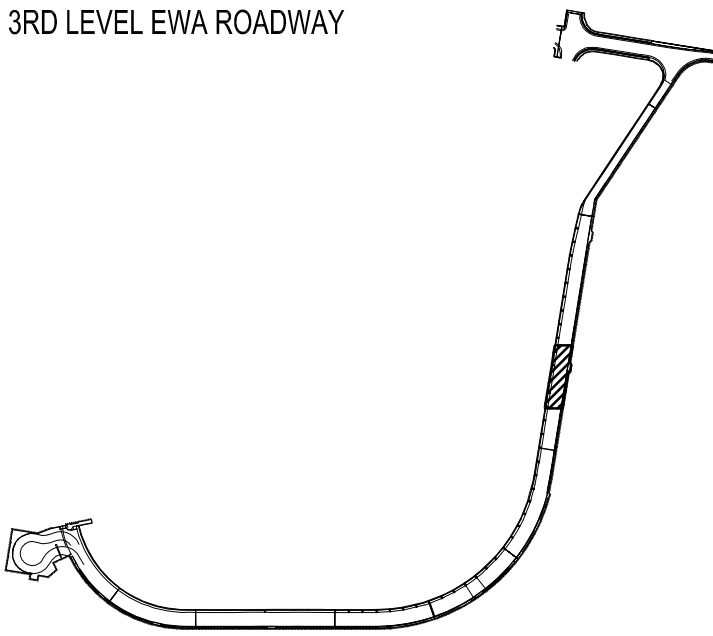

NO.	DATE	REVISIONS

CONSTRUCTION DOCUMENTS

SEPTEMBER, 2022
DATE

PROJECT TITLE :

EWA AND DH CONCOURSE
ROADWAY IMPROVEMENTS
PHASE 1

AT
DANIEL K. INOUE INTERNATIONAL AIRPORT
HONOLULU, OAHU, HAWAII

PROJECT NO.:

AO1043-32

SHEET TITLE:

DEMOLITION PLAN
EWA 3RD FLOOR
AREA 11

DATE :
SEPTEMBER, 2022
SHEET :

DWG. NO.

E-E-311

211 OF 247 SHEETS

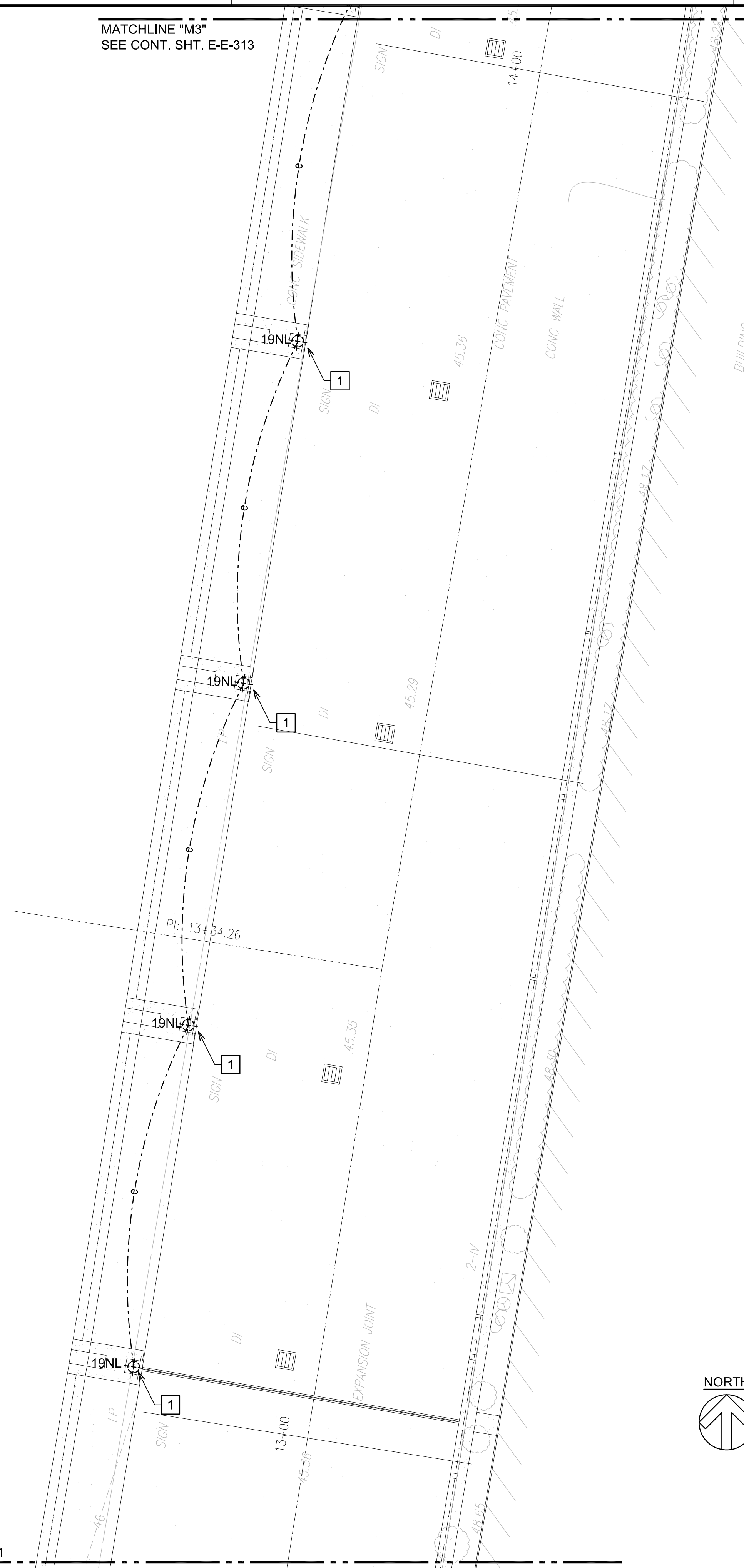

NOTE(S):

- 1 REMOVE EXISTING COLUMN MOUNTED LIGHT
FIXTURE AND SALVAGE FOR REINSTALLATION.
COORDINATE WITH OTHER TRADES TO PROTECT
EXISTING CONDUIT AND CONDUCTORS FROM
DAMAGE DURING COLUMN REMOVAL.



1
E-E-312

DEMOLITION PLAN EWA 3RD FLOOR AREA 12
SCALE: 3/16"=1'-0"

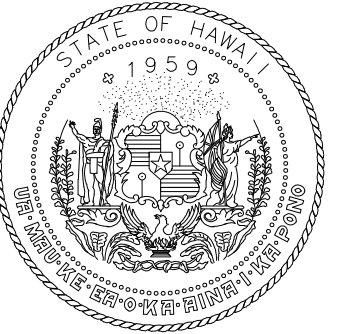
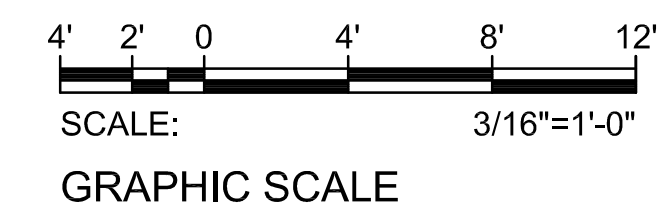

Airports Division
DEPARTMENT OF TRANSPORTATION
STATE OF HAWAII

RONALD N. S. HO & ASSOC., INC.
Electrical Engineers

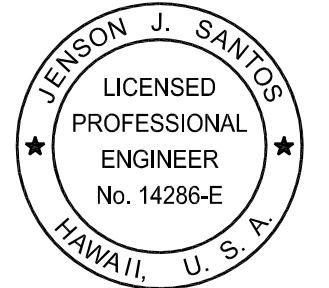

Junon Kator 2022.09.09

THIS WORK WAS PREPARED BY
ME OR UNDER MY SUPERVISION

EXPIRATION DATE OF THE LICENSE:
2024.04.30

DSGN.	DRWN.	CHKD.	APPD.
MP	CAD	JS	JS

KEY PLAN / NOTES:

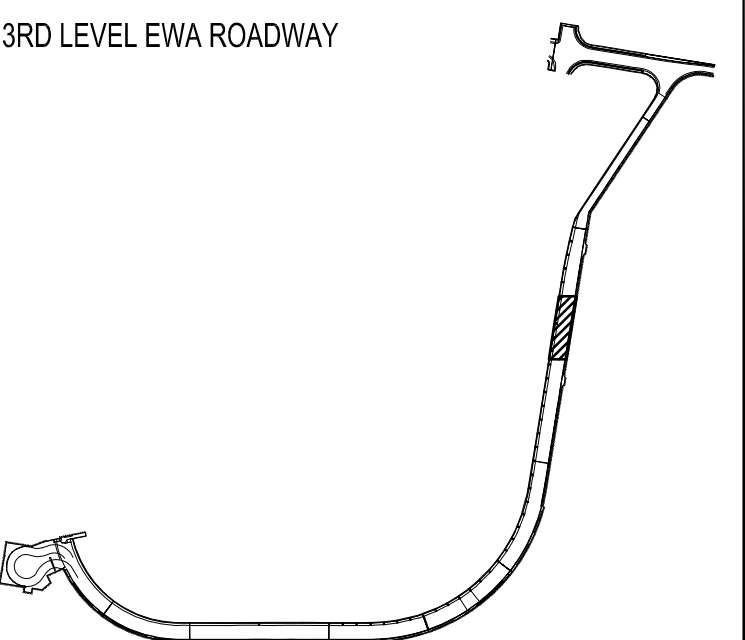

NO.	DATE	REVISIONS

CONSTRUCTION DOCUMENTS

SEPTMBER, 2022
DATE

PROJECT TITLE :

EWA AND DH CONCOURSE ROADWAY IMPROVEMENTS PHASE 1

AT
DANIEL K. INOUE INTERNATIONAL AIRPORT
HONOLULU, OAHU, HAWAII

PROJECT NO.:

AO1043-32

SHEET TITLE:

DEMOLITION PLAN EWA 3RD FLOOR AREA 12

DATE :	DWG. NO. E-E-312
SEPTEMBER, 2022	
SHEET :	
212 OF 247 SHEETS	

Z:\ACAD\PROJECTS\221023_EWA_3RD_LEVEL\E-E-313_221023_EWA_DEMO_3RD_AREA 13 9/8/2022 2:32PM MPetner

MATCHLINE "M3"
SEE CONT. SHT. E-E-312

STA. 21
MAG NAIL
ELEV.=46.00
N 59,760.28
E 1,666,488.50

BOUNDARY FOR LIMIT OF WORK

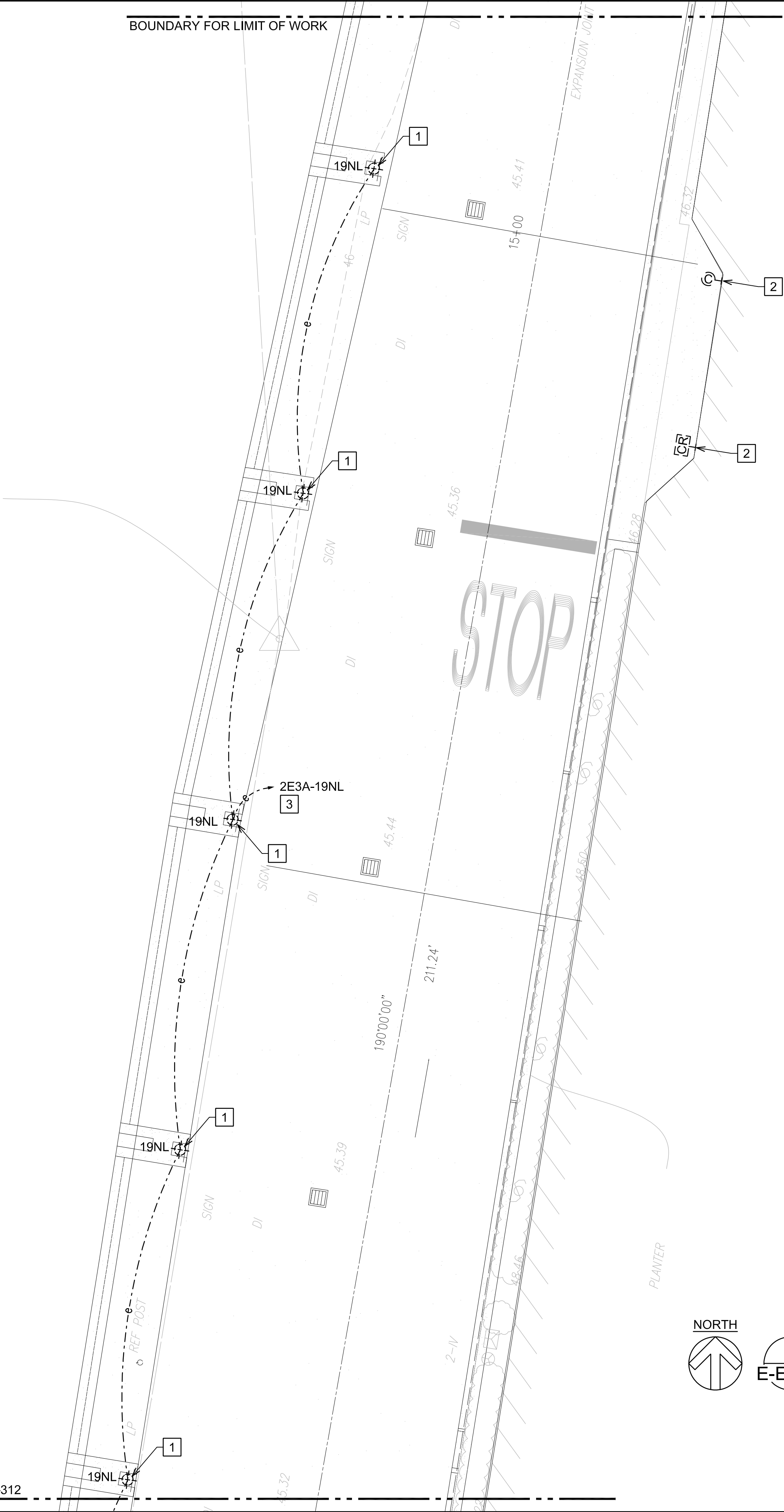

NOTE(S):

- 1 REMOVE EXISTING COLUMN MOUNTED LIGHT FIXTURE AND SALVAGE FOR REINSTALLATION. COORDINATE WITH OTHER TRADES TO PROTECT EXISTING CONDUIT AND CONDUCTORS FROM DAMAGE DURING COLUMN REMOVAL.
- 2 EXISTING DEVICE TO REMAIN.
- 3 PANEL "2E3A" LOCATED IN ELECTRICAL ROOM "E3A". CONTRACTOR TO VERIFY CIRCUIT NUMBER AND CIRCUIT ROUTE PRIOR TO THE START OF DEMOLITION. MARK-UP AS-BUILTS ACCORDINGLY.

NORTH



1
E-E-313

DEMOLITION PLAN EWA 3RD FLOOR AREA 13
SCALE: 3/16"=1'-0"

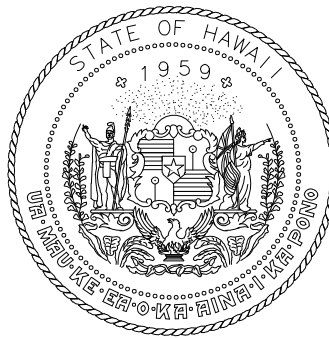
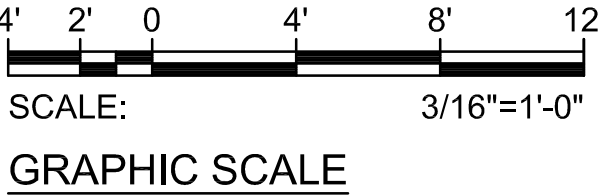

Airports Division
DEPARTMENT OF TRANSPORTATION
STATE OF HAWAII

RONALD N. S. HO & ASSOC., INC.
Electrical Engineers

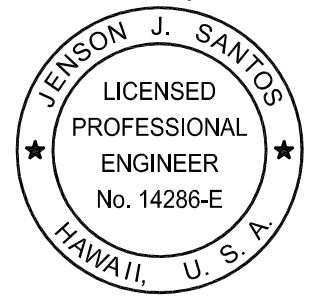

Jenson J. Santos 2022.09.09
THIS WORK WAS PREPARED BY
ME OR UNDER MY SUPERVISION
EXPIRATION DATE OF THE LICENSE:
2024.04.30

DSGN.	DRWN.	CHKD.	APPD.
MP	CAD	JS	JS

KEY PLAN / NOTES:

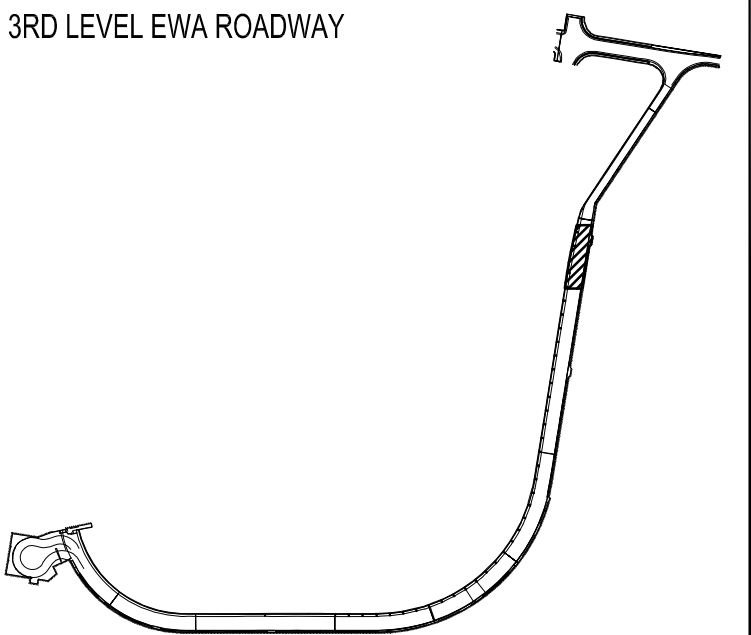

NO.	DATE	REVISIONS
-----	------	-----------

CONSTRUCTION
DOCUMENTS

SEPTEMBER, 2022
DATE

PROJECT TITLE :

EWA AND DH CONCOURSE
ROADWAY IMPROVEMENTS
PHASE 1

AT
DANIEL K. INOUE INTERNATIONAL AIRPORT
HONOLULU, OAHU, HAWAII

PROJECT NO.:

AO1043-32

SHEET TITLE:

DEMOLITION PLAN
EWA 3RD FLOOR
AREA 13

DATE :
SEPTEMBER, 2022
SHEET :

DWG. NO.

E-E-313

213 OF 247 SHEETS