

FED. ROAD DIST. NO.	STATE	PROJ. NO.	FISCAL YEAR	SHEET NO.	TOTAL SHEETS
HAWAII	HAW.	HWY-0-01-75	1978	1	2

"AS - BUILT" PLANS FOR

OAHU DISTRICT BASEYARD

IMPROVEMENT TO MOTOR POOL BUILDING

PROJECT NO. HWY. 0-01- 75

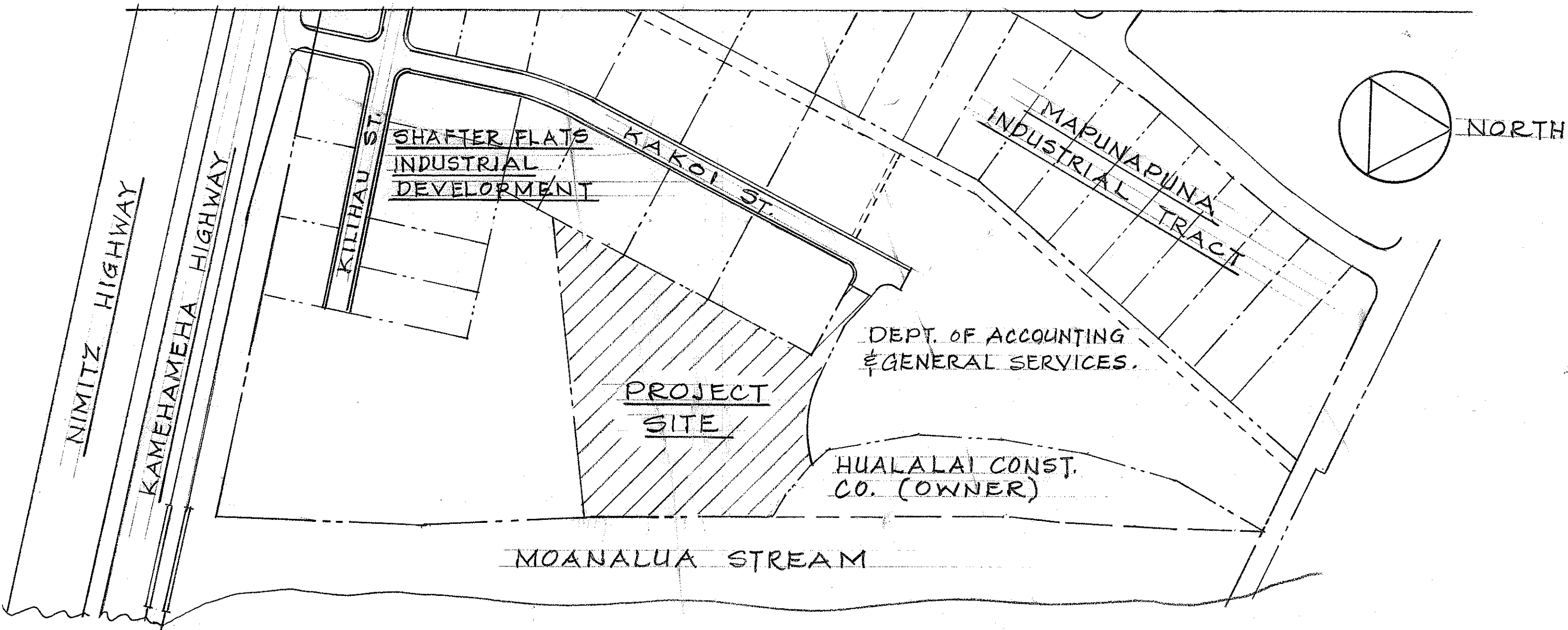

NO CHANGES WERE MADE DURING CONSTRUCTION ON THESE PLANS EXCEPT CHANGES IN THE ORIGINAL THEORETICAL QUANTITIES. FOR ACTUAL QUANTITIES, REFER TO PROJECT LEDGER AND/OR COMPUTATION BOOK.

*Howard Hanna*

RESIDENT ENGINEER

10/12/83

DATE

LOCATION MAP

TAX MAP KEY: 1-1-64-2

SCALE: 1" = 200'

DEPARTMENT OF TRANSPORTATION

STATE OF HAWAII

APPROVED:

*R. Higashimura*

9/16/77

DIR. OF TRANSPORTATION

DATE

STATE OF HAWAII

DEPARTMENT OF TRANSPORTATION

HIGHWAYS DIVISION

TITLE SHEET

AND

LOCATION MAP

DATE: Nov. '76

SHEET No. 1 OF 2 SHEETS

ORIGINAL PLAN	SURVEY PLOTTED BY	DATE
DRAWN BY	"	"
DESIGNED BY	"	"
NOTE BOOK	QUANTITIES BY	"
No.	CHECKED BY	"