

CONSTRUCTION PHASING AND TRAFFIC CONTROL NOTES:

1. Contractor shall not proceed to the next Construction Phase without approval by the Engineer. Any requests for adjustments in sequence of Construction Phasing shall be submitted in writing and approved by the Engineer. The Contractors attention is directed to Subsection 108.08 – Failure to Complete on Time and Liquidated Damages of the Special Provisions.
2. Relocation and/or removal of temporary signs, posts and portable concrete barriers used for Construction Phasing shall be considered incidental to their respective contract items.
3. All temporary signs and delineators for the purposes of Construction Phasing shall become the property of the Contractor at the completion of the project.
4. The Contractor shall delete the use of the ground anchorage steel pin for Portable Concrete Barrier (Intermediate Panel).
5. Portable concrete barrier panels in use during construction work shall not be stockpiled or otherwise stored within the Highway Right-Of-Way except at locations approved by the Engineer.
6. The Contractor shall periodically wash down signs, delineators and portable concrete barriers called for in the Construction Phasing Plans as deemed necessary by the Engineer. This work shall be considered incidental to the various contract items and no payment will be made therefore.
7. The location of pavement markings and signs, delineators and portable concrete guardrail panels used in the Construction Phasing shall be as shown on the plans and/or as determined in the field by the Engineer.
8. Damage to signs, temporary pavement markers, delineators and portable concrete barriers caused by the public shall be repaired or replaced by the Contractor as directed by the Engineer. This work shall be paid for under Item No. 645.0200 – Additional Police Officers and/or Additional Traffic Control Devices. Damage caused by the Contractors negligence shall be repaired or replaced at the Contractors expense.
9. Work required in the States Construction Phase Plans will be paid under applicable contract items or as otherwise specified herein.
10. Install Steady Burn Amber Lamps on portable concrete barrier @ 20.0' o.c. Installing, maintaining and changing batteries of the Portable Mounted Steady Burn Amber Lamps shall be considered incidental to Item No. 606.03 – Portable Concrete Barrier
11. Contractors construction shall proceed as follows unless otherwise approved by the Engineer.
1. Phase IA
2. Phase IB
3. Phase IC
4. Phase ID
5. Phase IIA
6. Phase IIB
7. Phase IIC
12. All other traffic control work shall be in accordance with Section 645 – Traffic Control. Work required for lane closures during the working day will not be paid for but shall be considered incidental to various contract items. Advance Construction Warning Signs as required under Section 645 of the Special Provisions shall be installed on all approaches to construction areas. This work shall be considered incidental to the various contract items.

23. This Work Zone Sign Plan is intended for use on long-term stationary work zones/construction phase (3 days or more). All work zones or construction phases less than 3 days duration will use Traffic Control Plans shown in Section 645 of the Special Provisions.
24. All existing regulatory speed limit signs with posts within the work zone/project limits shall be removed and replaced with work zone speed limit sign assemblies (R2-1(20) and CW3-5(20) with "CONSTRUCTION AREA" and "\$250 FINE HRS 29IC-104" Supplemental Signs).
25. Construction sign assemblies shall be installed on both the approaching and trailing ends of each work zone as shown on this plan.
26. Each construction warning sign shall have a minimum of (2) Type II OM. Each work zone speed limit assembly shall have a minimum of one (1) Type II OM. Installation of each Type II OM shall be considered incidental to Item No. 631.01, Regulatory Signs (10 sq. ft. or less) and Item No. 631.02 Regulatory Signs (Greater than 10 sq. ft.).
27. Upon the completion of all physical work or as directed by the Engineer, all construction signs and work zone speed limit assemblies shall be removed. All speed limit signs and posts that were existing at the start of the project within the work zone/project limits shall be restored back to their original locations and configurations.
28. Placement of construction signs shall not obstruct the path of pedestrians and bicyclists.
29. The removal and restoration of existing regulatory speed limit signs with new posts along with the installation, maintenance and removal of work zone speed limit sign assemblies shall be considered incidental to Item No. 631.01, Regulatory Signs (10 sq. ft. or less) and Item No. 631.02 Regulatory Signs (Greater than 10 sq. ft.).

30. Cost For Inertial Barrier System Shall be Incidental and Included in The Unit Cost of Portable Concrete Barriers. (Item No. 606.03 Portable Concrete Barrier).

LEGEND

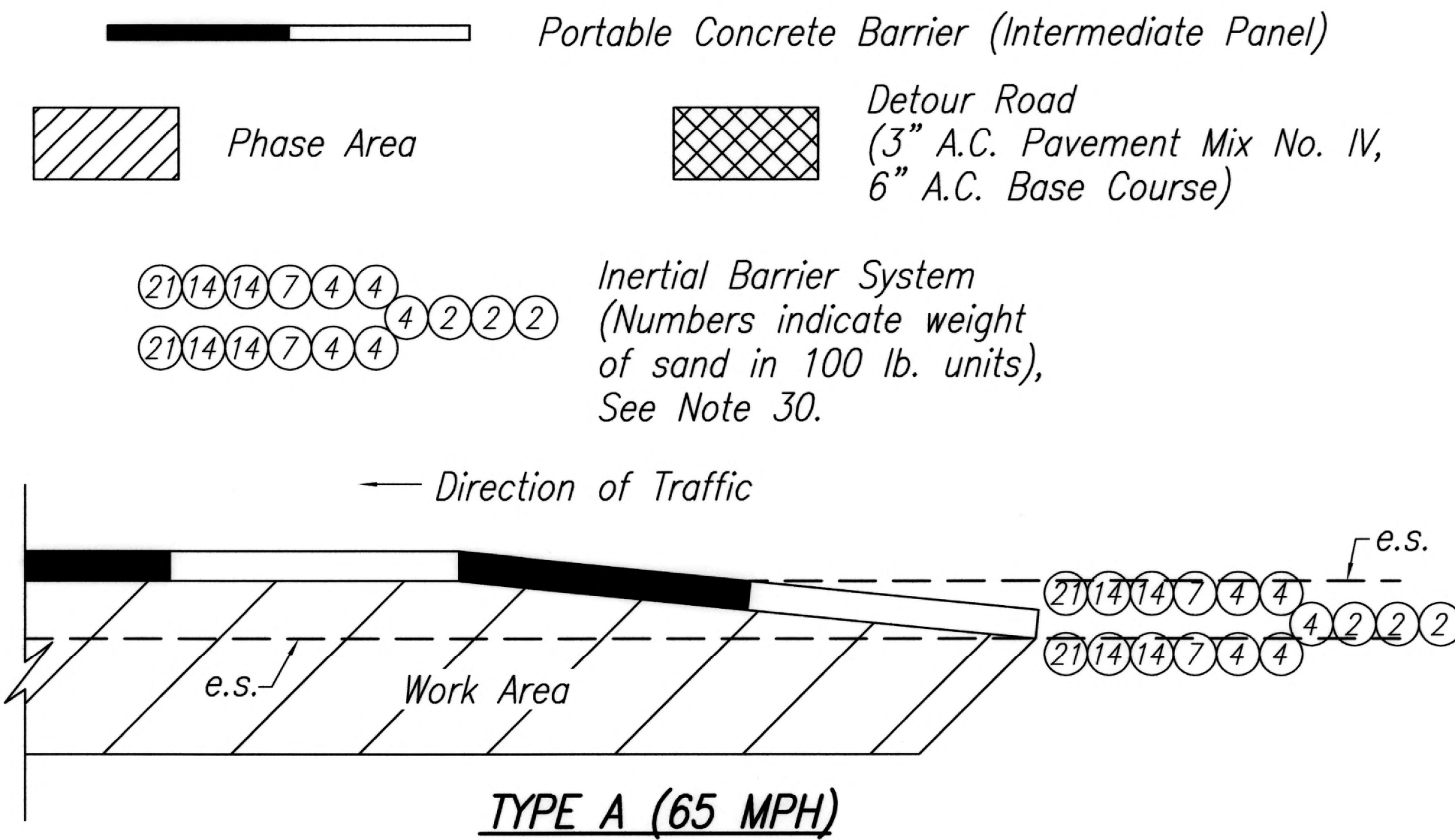

- Notes:
1. Contractor to install system per manufacturers recommendations
2. Numbers indicate pounds of sand in hundreds.

INERTIAL BARRIER SYSTEM LAYOUT
NOT TO SCALE



THIS WORK WAS PREPARED BY ME
OR UNDER MY SUPERVISION.
APRIL 30, 2014
FUKUNAGA & ASSOCIATES, INC. LIC. EXP. DATE

STATE OF HAWAII
DEPARTMENT OF TRANSPORTATION
HIGHWAYS DIVISION

**CONSTRUCTION PHASING
NOTES, LEGEND & DETAIL**

KAHULUI AIRPORT
ACCESS ROAD, PHASE I
Federal Aid Project No. NH-0380(10)
Scale: As Shown Date: February 2013

SHEET No. C-76 OF 93 SHEETS