

FED. ROAD DIST. NO.	STATE	FED. AID PROJ. NO.	FISCAL YEAR	SHEET NO.	TOTAL SHEETS
HAWAII	HAW.	HES-STP-3500(3)	1994	7	7

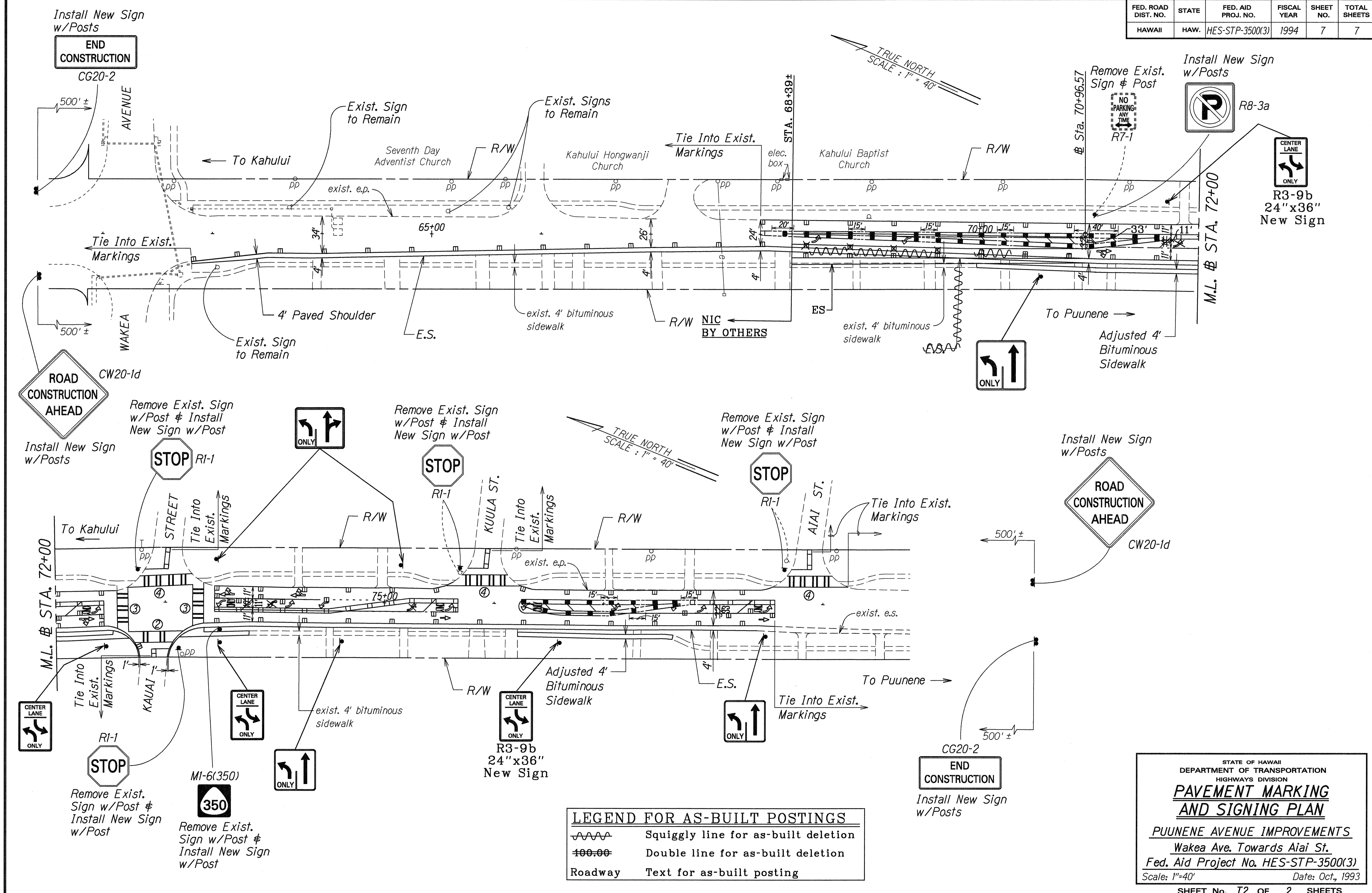

SURVEY PLOTTED BY DATE 8-24-93
 DRAWN BY R. Aji
 DESIGNED BY K. LUNENBERG
 CHECKED BY N. Yamamoto

LEGEND FOR AS-BUILT POSTINGS	
	Squiggly line for as-built deletion
	Double line for as-built deletion
Roadway	Text for as-built posting

STATE OF HAWAII
 DEPARTMENT OF TRANSPORTATION
 HIGHWAYS DIVISION
PAVEMENT MARKING AND SIGNING PLAN
 PUUNENE AVENUE IMPROVEMENTS
 Wakea Ave. Towards Aiai St.
 Fed. Aid Project No. HES-STP-3500(3)
 Scale: 1"=40' Date: Oct., 1993
 SHEET No. T2 OF 2 SHEETS