

FED. ROAD DIST. NO.	STATE	FED. AID PROJ. NO.	FISCAL YEAR	SHEET NO.	TOTAL SHEETS
HAWAII	HAW.	MG-3500(2)	1989	5	16

NOTES:

1. Contractor shall be responsible for the restoration to original condition of any property damage caused by his operations.
2. Contractor shall notify the Owner and/or Tenant 10 working days prior to entering property for driveway relocation.
3. Striping for the relocated parking stalls shall be 4" white paint and shall be paid for under Item 629.1011 - 4-Inch Pavement Striping (Paint).
4. All other existing pavement markings that are not needed shall be removed as directed by the Engineer. Removal shall be incidental to striping items.
5. Final locations of relocated "Exit Only" sign, pavement (Exit Only) words and standard arrows shall be determined in the field by the Engineer. Payment will be under their respective items.

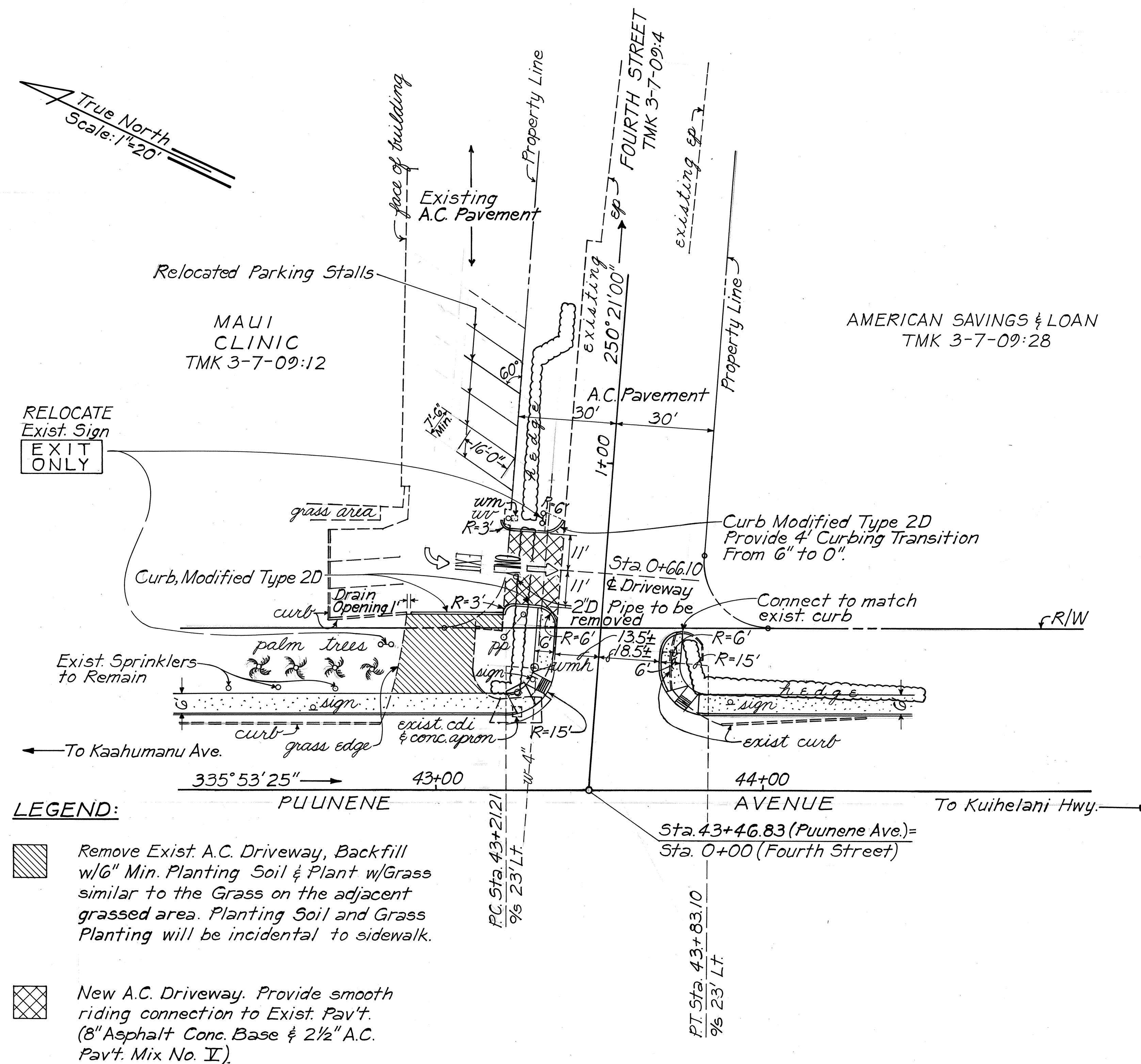

MAUI CLINIC RELOCATED DRIVEWAY PLAN
Scale: 1" = 20'

STATE OF HAWAII
DEPARTMENT OF TRANSPORTATION
HIGHWAYS DIVISION

DRIVEWAY RELOCATION DETAILS

*PUUNENE AVENUE SIDEWALK
Kaahumanu Ave. Towards Kuihelani Hwy.
F.A. Proj. No. MG-3500(2)*

Scale: As Shown Date: Sept. 1988

SHEET No. 1 OF 1 SHEETS