

DIST. NO.	STATE	PROJ. NO.	FISCAL YEAR	SHEET NO.	TOTAL SHEETS
MAUI	HAW.	3400A-01-20	2024	21	35

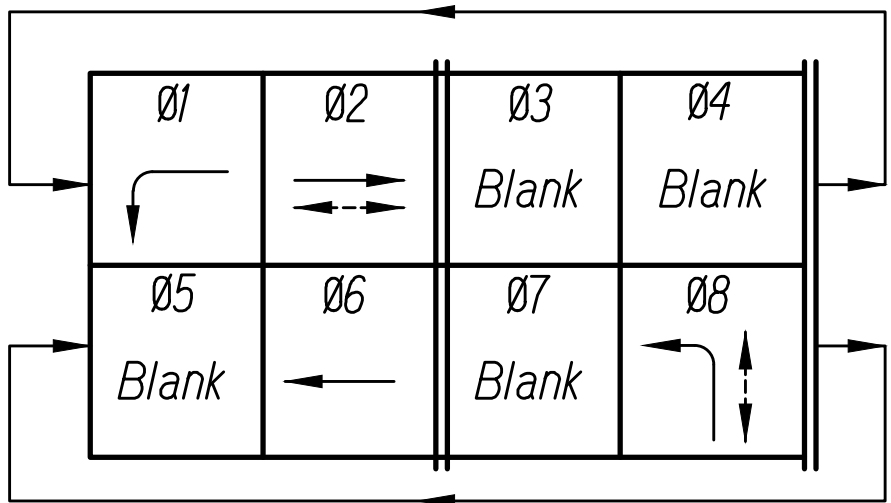

PHASE DIAGRAM

New Model Flex Controller
New 332L Cabinet

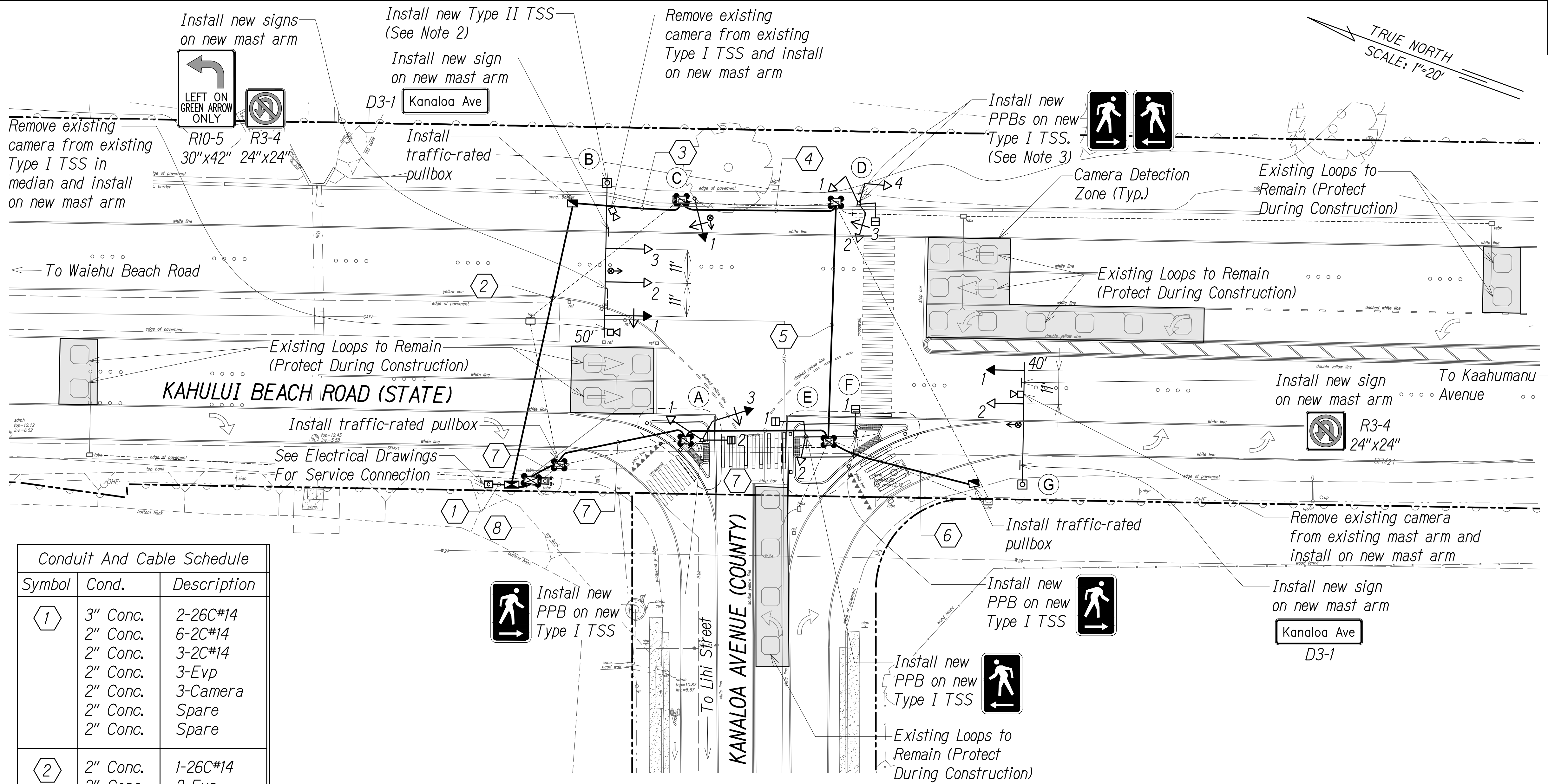
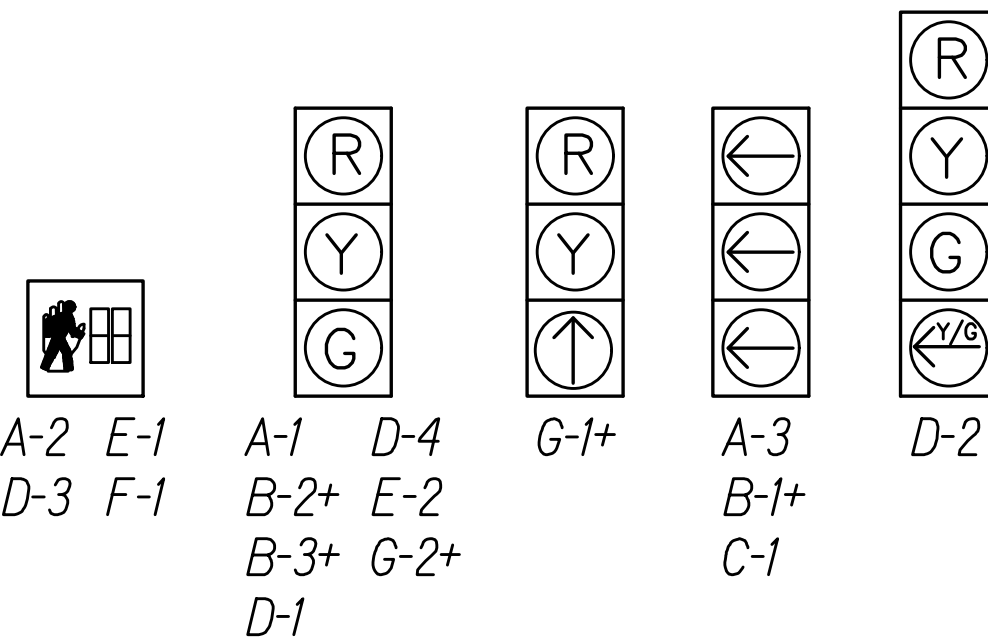

SIGNAL INDICATIONS

+ Indicates Back Plate W/
Retro Reflective Border

Conduit And Cable Schedule		
Symbol	Cond.	Description
1	3" Conc. 2" Conc. 2" Conc. 2" Conc. 2" Conc. 2" Conc.	2-26C#14 6-2C#14 3-2C#14 3-Evp 3-Camera Spare Spare
2	2" Conc. 2" Conc. 2" Conc. 2" Conc.	1-26C#14 2-Evp 2-Camera Spare
3	2" Conc. 2" Conc. 2" Conc. 2" Conc.	1-26C#14 1-Evp Spare Spare
4	2" Conc. 2" Conc. 2" Conc. 2" Conc.	1-26C#14 Spare Spare Spare
5	2" Conc. 2" Conc. 2" Conc. 2" Conc.	1-26C#14 5-2C#14 Spare Spare
6	2" Conc. 2" Conc. 2" Conc. 2" Conc. 2" Conc.	1-26C#14 1-26C#14 1-Evp 1-Camera Spare

Symbol	Cond.	Description
7	2" Conc. 2" Conc. 2" Conc. 2" Conc. 2" Conc.	1-26C#14 6-2C#14 1-2C#14 1-Evp 1-Camera Spare
8	2" Conc. 2" Conc. 2" Conc. 2" Conc. 2" Conc.	1-26C#14 6-2C#14 3-2C#14 1-Evp 1-Camera Spare

TRAFFIC SIGNAL PLAN

Scale: 1"=20'

NOTES:

- Traffic Signal Plan (including but not limited to intersection geometry, elevations, lane widths, striping, signs, traffic signal items, etc.) are based on a concept provided by the Hawaii Department of Transportation which may differ from actual field conditions. Contractor to verify field conditions prior to construction.
- Contractor shall verify the dimensions of Pole B prior to procurement to ensure minimum clearances and maximum height thresholds comply with MUTCD requirements due to the raised foundation at this location. Costs (including the procurement of additional Type II TSS to meet these thresholds) shall be considered incidental to the various contract items.
- Costs associated with existing loop detectors including, but not limited to splicing, additional cables, etc., shall be considered incidental to the various contract items. Contractor shall ensure that loop detectors are operational before, during, and after construction is complete.
- Costs associated with PPB extensions (if needed) shall be considered incidental to the various contract items.

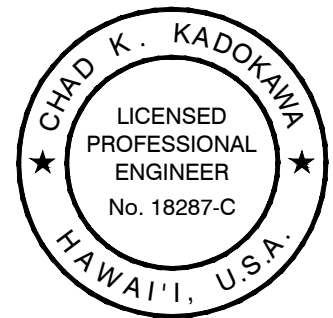

EXP. 4/30/26
THIS WORK WAS PREPARED BY ME OR UNDER MY SUPERVISION AND CONSTRUCTION OF THIS PROJECT WILL BE UNDER MY OBSERVATION AS DEFINED IN SECTION 16-115-2, HAWAII ADMINISTRATIVE RULES, DEPARTMENT OF COMMERCE AND CONSUMER AFFAIRS, STATE OF HAWAII, PROFESSIONAL ENGINEERS, ARCHITECTS, SURVEYORS AND LANDSCAPE ARCHITECTS.
CHAD K. KADOKAWA
LICENSE EXPIRES: APRIL 30, 2026
ATA AUSTIN, TSUTSUMI & ASSOCIATES, INC.
1
LINE IS 2 INCHES AT FULL SIZE
(If NOT 2-inches : Scale Accordingly)

STATE OF HAWAII
DEPARTMENT OF TRANSPORTATION
HIGHWAYS DIVISION

TRAFFIC SIGNAL PLAN

Kahului Beach Road Intersection
Improvements at Kanaloa Avenue
Project No. 3400A-01-20

Scale: As Shown Date: July 2024

SHEET No. TS-3 OF 6 SHEETS