

INDEX TO DRAWINGS	
SHEET NO.	DESCRIPTION
1	TITLE SHEET
2	STANDARD PLANS SUMMARY
3	GENERAL NOTES AND LEGEND
4 - 5	WATER POLLUTION & EROSION CONTROL NOTES
6 - 8	TYPICAL SECTIONS & DETAILS
9 - 12	GUARDRAIL DETAILS
13 - 17	ROADWAY PLANS
18	PAVEMENT MARKINGS LEGEND, DETAILS AND NOTES
19 - 20	CURB RAMP DETAILS
21	WORK ZONE SIGNING PLAN, NOTES & DETAILS
22	SIGN PANEL LAYOUTS AND MISCELLANEOUS DETAILS
23 - 27	SIGNING AND PAVEMENT MARKING PLANS
28	TRAFFIC SIGNAL PLAN

STATE OF HAWAII
DEPARTMENT OF TRANSPORTATION
HIGHWAYS DIVISION
HONOLULU, HAWAII

PLANS FOR
WAIEHU BEACH ROAD RESURFACING
KAHEKILI HIGHWAY TO KAHULUI BEACH ROAD
PROJECT NO. 3400B-01-10M

DISTRICT OF WAILUKU
ISLAND OF MAUI

FED. ROAD DIST. NO.	STATE	PROJ. NO.	FISCAL YEAR	SHEET NO.	TOTAL SHEETS
HAWAII	HAW.	3400B-01-10M	2010	1	28

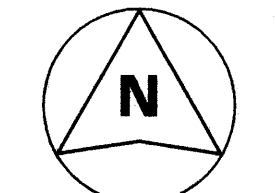
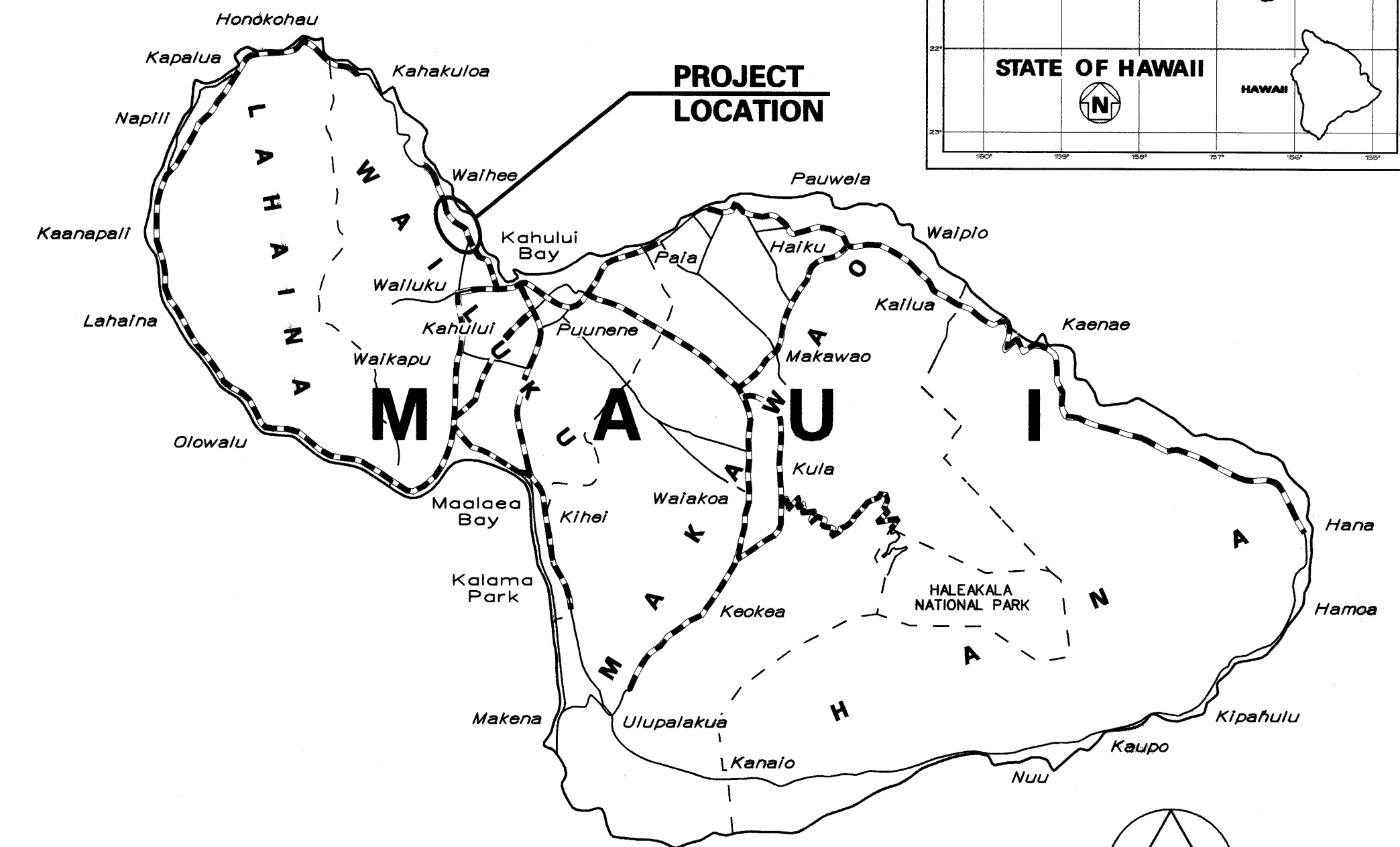
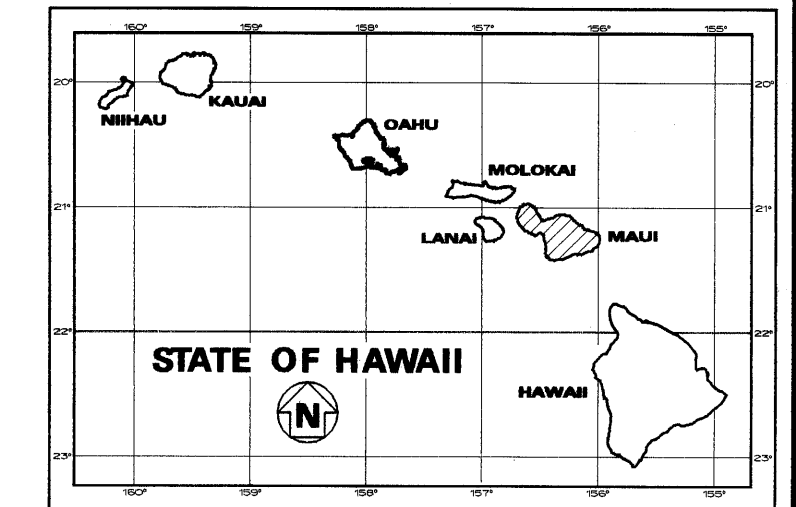

SCALE IN MILES

----- FEDERAL AID PROJECTS PREVIOUSLY CONSTRUCTED OR UNDER CONSTRUCTION

MILE POST 1.13 TO MILE POST 2.62

HWY-M
DESIGNED BY

HWY-ME
MANAGED BY

873-3535
PHONE

MAY, 2010
DATE

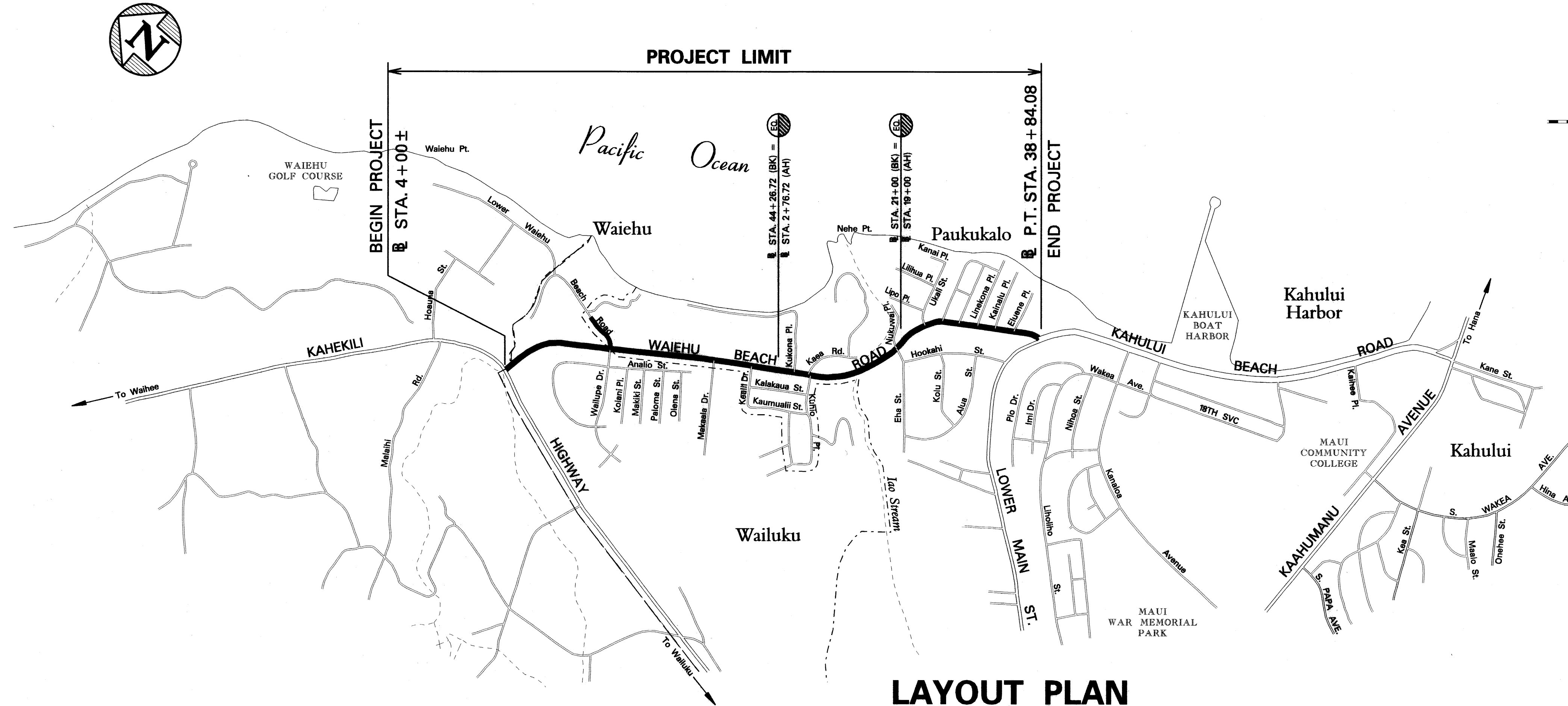

SCALE IN THOUSAND FEET

LAYOUT PLAN
GROSS LENGTH OF PROJECT.....1.49 MILES
NET LENGTH OF PROJECT.....1.49 MILES

DEPARTMENT OF TRANSPORTATION
STATE OF HAWAII

APPROVED:
[Signature]
DIR. OF TRANSPORTATION

[Signature]
DATE