

FED. ROAD DIST. NO.	STATE	FED. AID PROJ. NO.	FISCAL YEAR	SHEET NO.	TOTAL SHEETS
HAWAII	HAW.	BR-STP-3400(5)	2012	107	108

GENERAL CONSTRUCTION NOTES:

1. APPLICABLE CONSTRUCTION WORK SHALL BE DONE IN ACCORDANCE WITH THE STANDARD DETAILS FOR PUBLIC WORKS CONSTRUCTION, SEPTEMBER, 1986, OF THE DEPARTMENT OF PUBLIC WORKS, CITY AND COUNTY OF HONOLULU.

2. IT IS NOT THE INTENT OF THESE PLANS AND SPECIFICATIONS TO IMPLY THAT ALL EXISTING UTILITIES ARE SHOWN ON THE PLANS. ONLY THOSE OVERHEAD & UNDERGROUND PIPES, CABLES, DUCTLINES, ETC. KNOWN TO EXIST BY THE ENGINEER FROM HIS SEARCH OF RECORDS AT THE TIME OF DESIGN ARE INDICATED ON THE PLANS. THE CONTRACTOR SHALL ARRANGE WITH THE RESPECTIVE UTILITY COMPANIES TO TONE AND MARK THE LOCATION AND DEPTH OF THE EXISTING FACILITIES.

3. THE CONTRACTOR SHALL EXERCISE PROPER CARE WHEN EXCAVATING IN AREAS WITH EXISTING UNDERGROUND FACILITIES. THE CONTRACTOR SHALL BE RESPONSIBLE TO REPAIR AND/OR PAY ANY DAMAGES TO THE EXISTING FACILITIES. DAMAGES TO EXISTING FACILITIES SHALL BE REPORTED IMMEDIATELY TO THE UTILITY COMPANY CONCERNED.

4. NO CONTRACTOR SHALL PERFORM ANY TRENCHING OPERATION SO AS TO CAUSE FALLING ROCKS, SOIL OR DEBRIS IN ANY FORM TO FALL, SLIDE OR FLOW ONTO ADJOINING PROPERTIES, STREETS OR NATURAL WATERCOURSES. SHOULD SUCH VIOLATIONS OCCUR, THE COSTS INCURRED FOR ANY REMEDIAL ACTION BY THE CHIEF ENGINEER SHALL BE PAYABLE BY THE CONTRACTOR.

5. THE CONTRACTOR SHALL KEEP ALL BIKEWAYS, WALKWAYS, DRIVEWAYS, PARKING LOTS AND ROADWAYS OPEN FOR PEDESTRIAN AND/OR VEHICULAR TRAFFIC. SAFETY BARRIERS AND APPROPRIATE WARNING SIGNS AND DEVICES SHALL BE PROVIDED AT ALL TIMES FOR THE SAFETY OF PEDESTRIANS AND/OR VEHICLES.

6. THE CONTRACTOR SHALL AT HIS OWN EXPENSE KEEP THE PROJECT AREA AND ALSO THE SURROUNDING AREA FREE FROM DUST NUISANCES. THE WORK SHALL BE IN CONFORMANCE WITH THE AIR POLLUTION CONTROL STANDARDS AND REGULATIONS OF THE DEPARTMENT OF HEALTH, STATE OF HAWAII.

7. THE CONTRACTOR SHALL BE RESPONSIBLE FOR CONFORMITY WITH THE APPLICABLE PROVISIONS OF CHAPTER 54, WATER QUALITY STANDARDS AND CHAPTER 55, WATER POLLUTION CONTROL, OF TITLE 11, ADMINISTRATIVE RULES OF THE STATE DEPARTMENT OF HEALTH.

8. EXCAVATED MATERIAL SHALL BE HAULED AND DISPOSED BY THE CONTRACTOR.

9. OPEN TRENCHES SHALL BE PROHIBITED DURING NON-WORKING HOURS.

10. THE CONTRACTOR SHALL BE RESPONSIBLE TO INVESTIGATE, PROBE, TONE, EXPOSE, LOCATE AND PROTECT THE EXISTING UNDERGROUND UTILITIES IN THE AREA AFFECTED BY THIS PROJECT. CONTRACTOR SHALL BE REQUIRED TO ADJUST THE NEW INSTALLATION TO CLEAR EXISTING UNDERGROUND SYSTEMS AT NO ADDITIONAL COST TO THE CITY. CONTRACTOR SHALL BE REQUIRED TO REPAIR ALL DAMAGES TO THE EXISTING SYSTEMS CAUSED BY HIS NEGLIGENCE AT NO ADDITIONAL COST TO THE CITY. ALL REPAIR WORK SHALL BE DONE IN ACCORDANCE WITH THE STANDARDS OF THE DEPARTMENT OF DESIGN AND CONSTRUCTION AND THE VARIOUS UTILITY COMPANIES.
11. THE CONTRACTOR SHALL BE REQUIRED TO RESTORE THE EXISTING GRASS AREAS DAMAGED TO CONSTRUCTION. TOPSOILING AND GRASSING SHALL BE IN ACCORDANCE WITH DPR STANDARD SPECIFICATIONS FOR LANDSCAPING.

12. THE CONTRACTOR SHALL VISIT SITE, VERIFY ALL EXISTING DIMENSIONS, AS BUILT CONDITIONS, STRUCTURES, SITE IMPROVEMENTS, ETC. PRIOR TO BIDDING.







13. THE CONTRACTOR SHALL COORDINATE HIS OPERATIONS WITH THOSE OF OTHER CONTRACTORS WHO MAY BE EMPLOYED ON ADJACENT OR RELATED PROJECTS OF THE CITY AND AVOID UNNECESSARY DELAY OR HINDRANCE IN THE PERFORMANCE OF THEIR RESPECTIVE CONTRACTS.

14. THE CONTRACTOR TO PROTECT EXISTING LANDSCAPE STRUCTURES. ALL DAMAGES SHALL BE REPAIRED/REPLACED TO THE SATISFACTION OF THE OFFICER-IN-CHARGE AT NO ADDITIONAL COST TO THE CITY.

15. THE CONTRACTOR SHALL PROVIDE FOR PROVISION FOR THE OFFICER-IN-CHARGE TO REVISE LOCATION OF LIGHT POLES, FIXTURES & DUCTLINES 10'. THE CONTRACTOR SHALL RE-LAYOUT AND ADJUST AT NO ADDITIONAL COST TO THE CITY.

16. TRIM TREE BRANCHES AS REQUIRED FOR INSTALLATION OF STREET LIGHTING STANDARD ASSEMBLY.

17. THE CONTRACTOR SHALL PROVIDE ADDITIONAL WIRING AS REQUIRED TO MAINTAIN OPERATIONAL EXISTING POLE LIGHTS, TRAFFIC SIGNAL LIGHTS, ETC INDICATED TO REMAIN.

ELECTRICAL SYMBOLS		
EXST	NEW	DESCRIPTION
		FLASHING SIGN
		STREET LIGHT PULLBOX, SLD-1 TYPE
		UTILITY POLE
		OVER HEAD LINE
		STREET LIGHT STANDARD ON UTILITY POLE

DESIGNED BY	DATE
DRAWN BY	
CHECKED BY	
IN CHARGE BY	
NOTED BY	
NO.	

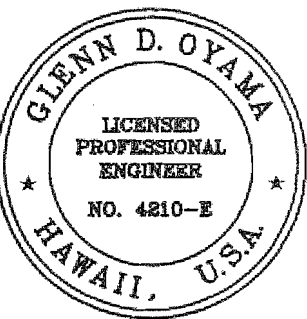

THIS WORK WAS PREPARED BY ME
OR UNDER MY SUPERVISION.

Glenn D. Oyama APR 30, 2014
NELSON OKAMOTO CORPORATION LIC. EXP. DATE

STATE OF HAWAII
DEPARTMENT OF TRANSPORTATION
HIGHWAYS DIVISION
**ELECTRICAL NOTES
AND SYMBOLS**
WAIEHU BEACH ROAD
REHABILITATION OF IAO STREAM BRIDGE
Federal Aid Project No. BR-STP-3400(5)

Date: October 2012

SHEET No. E-1 OF 2 SHEETS

FED. ROAD DIST. NO.	STATE	FED. AID PROJ. NO.	FISCAL YEAR	SHEET NO.	TOTAL SHEETS
HAWAII	HAW.	BR-STP-3400(5)	2012	108	108

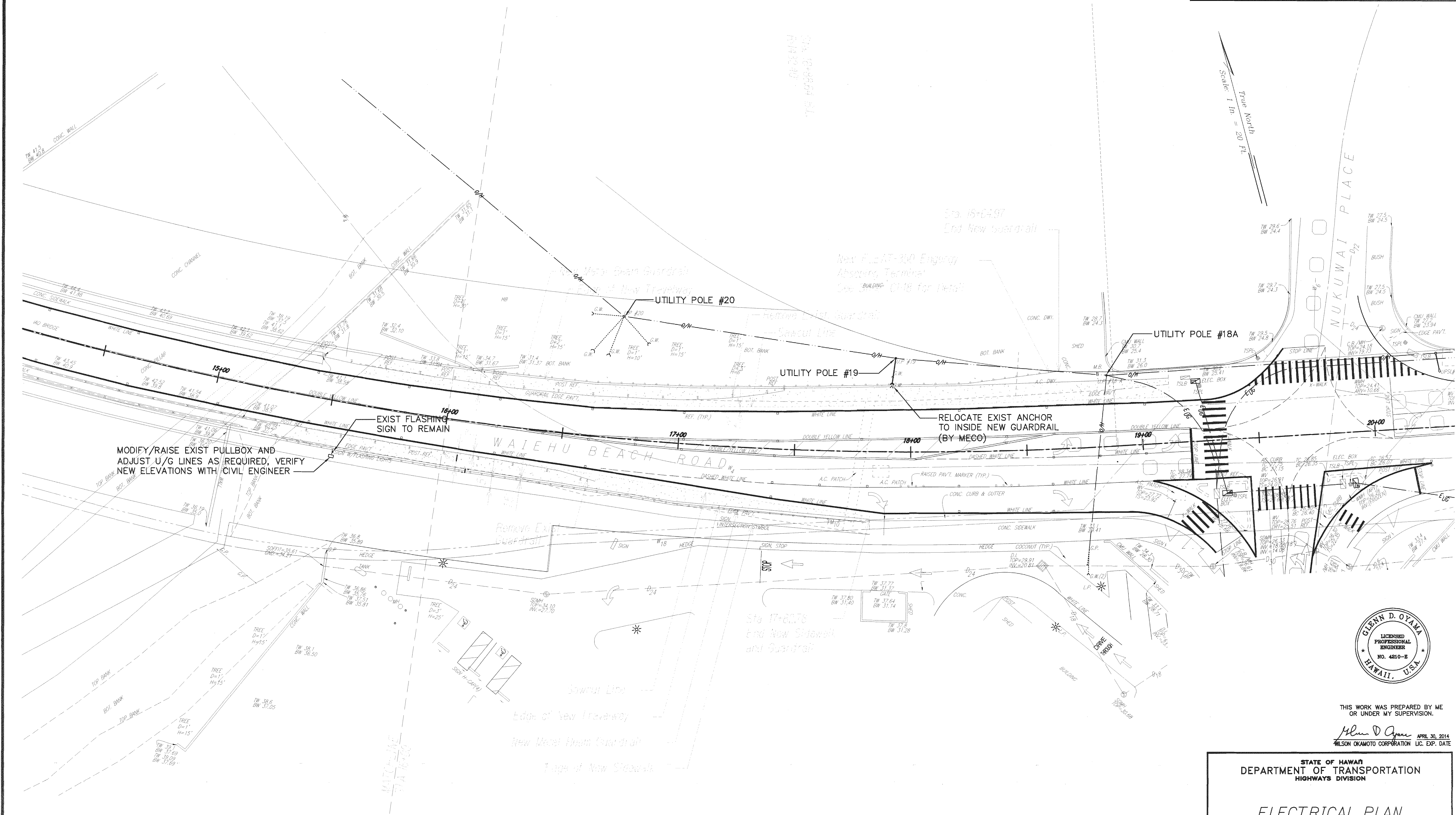

SURVEY PLOTTED BY	DATE
DRAWN BY	
CHECKED BY	
QUANTITIES BY	
CHECKED BY	
ORIGINAL PLAN	
NOTE BOOK	
No.	

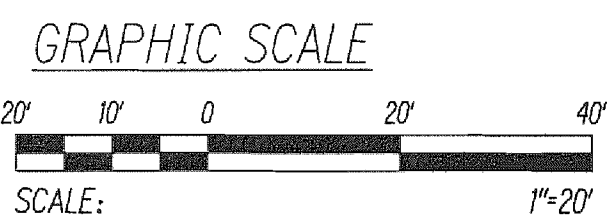

ELECTRICAL PLAN SCALE: 1"=20'

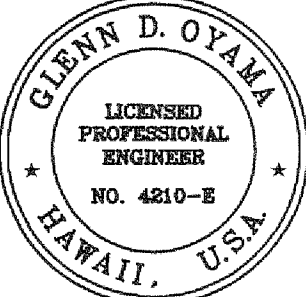

THIS WORK WAS PREPARED BY ME
 OR UNDER MY SUPERVISION.
Glenn D. Oyama
 MILSON OKAMOTO CORPORATION LIC. EXP. DATE: APRIL 30, 2014

STATE OF HAWAII
 DEPARTMENT OF TRANSPORTATION
 HIGHWAYS DIVISION

ELECTRICAL PLAN
 WAIEHU BEACH ROAD
 REHABILITATION OF IAO STREAM BRIDGE
 Federal Aid Project No. BR-STP-3400(5)
 Date: October 2012
 SHEET No. E-2 OF 2 SHEETS